

# Asbestos Register

(Hazardous Materials and Risk Assessment)

**School :** Wyong High School (8166)  
**Region :** Hunter/Central Coast  
**State Electorate :** Wyong  
**Local Government Area :** Wyong

**Initial Survey :** Noel Arnold & Associates : 28 - Mar - 2008  
**Reviewed By :** AECOM : 27 - Jun - 2016

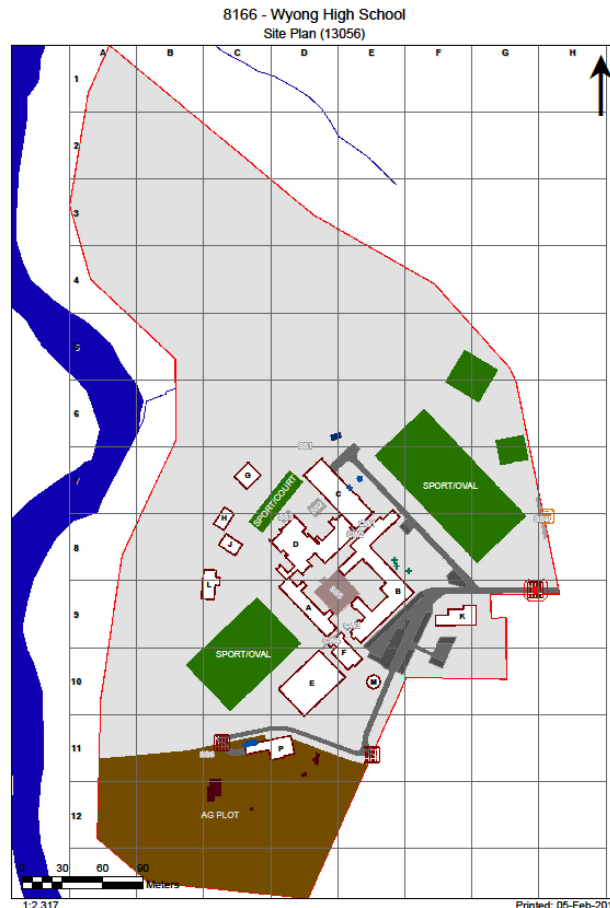

2017

Product	Material Description	Extent	Location Reference	Material Condition	Risk Status	Control Priority
Sample No					Test Result	

**B00A - General Learning/Science Learning - 1947 - Brick/Block (Brick/Block)****Exterior**

Ceiling Voids - Flat Roof	Non Accessible Area - Height Restriction 5m
Underfloor Voids - Slab on Ground	Non Accessible Area - Area inaccessible

**Interior****B00A - M0001 - Cleaning Store - Distributed (2.38 m2)**

Ceiling Structures/Linings	Flat AC Sheeting	4m2	Throughout	Good Condition (1)	Low (1)	Low Priority (2-3)
8166/B00A/M0001/Ceiling Structures/Linings/S36					<b>Chrysotile (white asbestos)</b>	

**B00A - M0002 - Staff - Toilet (3.75 m2)**

Ceiling Structures/Linings	Flat AC Sheeting	4m2	Throughout	Good Condition (1)	Low (1)	Low Priority (2-3)
8166/B00A/M0001/Ceiling Structures/Linings/S36					<b>Chrysotile (white asbestos)</b>	

**B00A - M0003 - Movement (5.53 m2)**

No Asbestos

**B00A - M0004 - Movement (5.61 m2)**

No Asbestos

**B00A - M1001 - Cleaning Store - Distributed (3.81 m2)**

Ceiling Structures/Linings	Flat AC Sheeting	4m2	Throughout	Good Condition (1)	Low (1)	Low Priority (2-3)
8166/B00A/M0001/Ceiling Structures/Linings/S36					<b>Chrysotile (white asbestos)</b>	

**B00A - M1002 - Movement (3.73 m2)**

Ceiling Structures/Linings	Flat AC Sheeting	4m2	Throughout	Good Condition (1)	Low (1)	Low Priority (2-3)
8166/B00A/M0001/Ceiling Structures/Linings/S36					<b>Chrysotile (white asbestos)</b>	

**B00A - M1003 - Staff - Toilet (5.38 m2)**

No Asbestos

**B00A - M1004 - Movement (5.35 m2)**

No Asbestos

**B00A - R0001 - General Learning Space (53.11 m2)**

Floor Coverings Res/Textile	Vinyl Tiles	2m2	North	Good Condition (1)	Low (1)	Low Priority (2-3)
8166/B00A/R0001/Floor Coverings Res/Textile/S26					<b>Chrysotile (white asbestos)</b>	

Ceiling Structures/Linings	Vermiculite	8166/B00A/R0001/Ceiling Structures/Linings/S27				<b>Limited Samples Taken</b>
<b>Vermiculite Ceilings may contain asbestos. Asbestos testing MUST be conducted prior to any disturbance works</b>						

**B00A - R0002 - Resources Store (12.65 m2)**

Floor Coverings Res/Textile	Vinyl Tiles	13m2	Throughout	Good Condition (1)	Low (1)	Low Priority (2-3)
8166/B00A/R0001/Floor Coverings Res/Textile/S26					<b>Chrysotile (white asbestos)</b>	

Ceiling Structures/Linings	Vermiculite	8166/B00A/R0001/Ceiling Structures/Linings/S27				<b>Limited Samples Taken</b>
<b>Vermiculite Ceilings may contain asbestos. Asbestos testing MUST be conducted prior to any disturbance works</b>						

**B00A - R0003 - General Learning Space (52.74 m2)**

Ceiling Structures/Linings	Vermiculite	8166/B00A/R0001/Ceiling Structures/Linings/S27				<b>Limited Samples Taken</b>
<b>Vermiculite Ceilings may contain asbestos. Asbestos testing MUST be conducted prior to any disturbance works</b>						

**B00A - R0005 - Movement (4.46 m2)**

Ceiling Structures/Linings	Vermiculite	8166/B00A/R0001/Ceiling Structures/Linings/S27				<b>Limited Samples Taken</b>
<b>Vermiculite Ceilings may contain asbestos. Asbestos testing MUST be conducted prior to any disturbance works</b>						

Product	Material Description	Extent	Location Reference	Material Condition	Risk Status	Control Priority
Sample No					Test Result	
<b>B00A - R0007 - Materials Technology L.S. (49.92 m2)</b>						
Ceiling Structures/Linings	Vermiculite					Limited Samples Taken
		8166/B00A/R0001/Ceiling Structures/Linings/S27				
<i>Vermiculite Ceilings may contain asbestos. Asbestos testing MUST be conducted prior to any disturbance works</i>						
<b>B00A - R0008 - Distribution Board Cupboard (0.78 m2)</b>						
					Note: No inspection of live electrical installation.	
Ceiling Structures/Linings	Vermiculite					Limited Samples Taken
		8166/B00A/R0001/Ceiling Structures/Linings/S27				
<i>Vermiculite Ceilings may contain asbestos. Asbestos testing MUST be conducted prior to any disturbance works</i>						
<b>B00A - R0009 - Fitness Laboratory (51.89 m2)</b>						
Floor Coverings Res/Textile	Vinyl Tiles					No Asbestos Detected
		8166/B00A/R0009/Floor Coverings Res/Textile/S28				
Ceiling Structures/Linings	Vermiculite					Limited Samples Taken
		8166/B00A/R0001/Ceiling Structures/Linings/S27				
<i>Vermiculite Ceilings may contain asbestos. Asbestos testing MUST be conducted prior to any disturbance works</i>						
<b>B00A - R0010 - Fitness Laboratory (65.41 m2)</b>						
Ceiling Structures/Linings	Vermiculite					Limited Samples Taken
		8166/B00A/R0001/Ceiling Structures/Linings/S27				
<i>Vermiculite Ceilings may contain asbestos. Asbestos testing MUST be conducted prior to any disturbance works</i>						
<b>B00A - R0011 - General Storeroom (7.22 m2)</b>						
Ceiling Structures/Linings	Vermiculite					Limited Samples Taken
		8166/B00A/R0001/Ceiling Structures/Linings/S27				
<i>Vermiculite Ceilings may contain asbestos. Asbestos testing MUST be conducted prior to any disturbance works</i>						
<b>B00A - R0012 - General Storeroom (12.65 m2)</b>						
Ceiling Structures/Linings	Vermiculite					Limited Samples Taken
		8166/B00A/R0001/Ceiling Structures/Linings/S27				
<i>Vermiculite Ceilings may contain asbestos. Asbestos testing MUST be conducted prior to any disturbance works</i>						
<b>B00A - R0013 - General Storeroom (5.35 m2)</b>						
Ceiling Structures/Linings	Vermiculite					Limited Samples Taken
		8166/B00A/R0001/Ceiling Structures/Linings/S27				
<i>Vermiculite Ceilings may contain asbestos. Asbestos testing MUST be conducted prior to any disturbance works</i>						
<b>B00A - R0015 - Sport Equipment Store (4.41 m2)</b>						
No Asbestos						
<b>B00A - R0016 - Cleaning Store - Distributed (4.5 m2)</b>						
No Asbestos						
<b>B00A - R0017 - General Storeroom (1.38 m2)</b>						
Ceiling Structures/Linings	Vermiculite					Limited Samples Taken
		8166/B00A/R0001/Ceiling Structures/Linings/S27				
<i>Vermiculite Ceilings may contain asbestos. Asbestos testing MUST be conducted prior to any disturbance works</i>						
<b>B00A - R0018 - External Stairs (4.49 m2)</b>						
No Asbestos						
<b>B00A - R0019 - External Stairs (4.55 m2)</b>						
No Asbestos						
<b>B00A - R0020 - Staff Study (45.52 m2)</b>						
No Asbestos						
<b>B00A - R0021 - Tea Room (2.06 m2)</b>						
No Asbestos						
<b>B00A - R0022 - Movement (7.28 m2)</b>						
No Asbestos						
<b>B00A - R0023 - Movement (7.27 m2)</b>						
No Asbestos						
<b>B00A - R0024 - External Movement (18.75 m2)</b>						
No Asbestos						

Product	Material Description	Extent	Location Reference	Material Condition	Risk Status	Control Priority
Sample No					Test Result	
No Asbestos						
<b>B00A - R0025 - External Movement (52.23 m2)</b>						
No Asbestos						
<b>B00A - R0026 - External Movement (17.62 m2)</b>						
No Asbestos						
<b>B00A - R1001 - General Learning Space (53.03 m2)</b>						
Ceiling Structures/Linings	Vermiculite					
	8166/B00A/R0001/Ceiling Structures/Linings/S27					Limited Samples Taken
<i>Vermiculite Ceilings may contain asbestos. Asbestos testing MUST be conducted prior to any disturbance works</i>						
<b>B00A - R1002 - Resources Store (11.19 m2)</b>						
Floor Coverings Res/Textile	Vinyl Tiles	12m2	North	Good Condition (1)	Low (1)	Low Priority (2-3)
	8166/B00A/R0001/Floor Coverings Res/Textile/S26					Chrysotile (white asbestos)
Ceiling Structures/Linings	Vermiculite					
	8166/B00A/R0001/Ceiling Structures/Linings/S27					Limited Samples Taken
<i>Vermiculite Ceilings may contain asbestos. Asbestos testing MUST be conducted prior to any disturbance works</i>						
<b>B00A - R1003 - Computer Learning Space (52.52 m2)</b>						
Ceiling Structures/Linings	Vermiculite					
	8166/B00A/R0001/Ceiling Structures/Linings/S27					Limited Samples Taken
<i>Vermiculite Ceilings may contain asbestos. Asbestos testing MUST be conducted prior to any disturbance works</i>						
<b>B00A - R1004 - Chemical Store (25.05 m2)</b>						
Ceiling Structures/Linings	Vermiculite					
	8166/B00A/R0001/Ceiling Structures/Linings/S27					Limited Samples Taken
<i>Vermiculite Ceilings may contain asbestos. Asbestos testing MUST be conducted prior to any disturbance works</i>						
<b>B00A - R1005 - Distribution Board Cupboard (0.74 m2)</b>						
Note: No inspection of live electrical installation.						
Ceiling Structures/Linings	Vermiculite					
	8166/B00A/R0001/Ceiling Structures/Linings/S27					Limited Samples Taken
<i>Vermiculite Ceilings may contain asbestos. Asbestos testing MUST be conducted prior to any disturbance works</i>						
<b>B00A - R1006 - Laboratory L.S. (92.97 m2)</b>						
Floor Coverings Res/Textile	Vinyl Sheet					
	8166/B00A/R0009/Floor Coverings Res/Textile/S28					No Asbestos Detected
Ceiling Structures/Linings	Vermiculite					
	8166/B00A/R0001/Ceiling Structures/Linings/S27					Limited Samples Taken
<i>Vermiculite Ceilings may contain asbestos. Asbestos testing MUST be conducted prior to any disturbance works</i>						
<b>B00A - R1007 - Office/Store (28.8 m2)</b>						
Fume Cupboard	Flat AC Sheeting	2Unit	North, South	Good Condition (1)	Low (1)	Low Priority (2-3)
	8166/B00A/R1007/Fume Cupboard/S29					Chrysotile (white asbestos)
Floor Coverings Res/Textile	Vinyl Tiles	29m2	North	Good Condition (1)	Low (1)	Low Priority (2-3)
	8166/B00A/R0001/Floor Coverings Res/Textile/S26					Chrysotile (white asbestos)
Ceiling Structures/Linings	Vermiculite					
	8166/B00A/R0001/Ceiling Structures/Linings/S27					Limited Samples Taken
<i>Vermiculite Ceilings may contain asbestos. Asbestos testing MUST be conducted prior to any disturbance works</i>						
<b>B00A - R1008 - Resources Store (9.89 m2)</b>						
Floor Coverings Res/Textile	Vinyl Tiles	10m2	North	Good Condition (1)	Low (1)	Low Priority (2-3)
	8166/B00A/R0001/Floor Coverings Res/Textile/S26					Chrysotile (white asbestos)
Ceiling Structures/Linings	Vermiculite					
	8166/B00A/R0001/Ceiling Structures/Linings/S27					Limited Samples Taken
<i>Vermiculite Ceilings may contain asbestos. Asbestos testing MUST be conducted prior to any disturbance works</i>						
<b>B00A - R1009 - Laboratory L.S. (93.28 m2)</b>						

Product	Material Description	Extent	Location Reference	Material Condition	Risk Status	Control Priority
Sample No					Test Result	
Floor Coverings Res/Textile	Vinyl Sheet					
	8166/B00A/R0009/Floor Coverings Res/Textile/S28					No Asbestos Detected
Ceiling Structures/Linings	Vermiculite					
	8166/B00A/R0001/Ceiling Structures/Linings/S27					Limited Samples Taken
<i>Vermiculite Ceilings may contain asbestos. Asbestos testing MUST be conducted prior to any disturbance works</i>						
<b>B00A - R1010 - External Movement (96.38 m2)</b>						
Ceiling Structures/Linings	Vermiculite					
	8166/B00A/R0001/Ceiling Structures/Linings/S27					Limited Samples Taken
<i>Vermiculite Ceilings may contain asbestos. Asbestos testing MUST be conducted prior to any disturbance works</i>						
<b>B00A - R1011 - External Stairs (9.8 m2)</b>						
No Asbestos						
<b>B00A - R1012 - External Stairs (9.63 m2)</b>						
No Asbestos						
<b>B00A - R2001 - General Learning Space (53.1 m2)</b>						
Ceiling Structures/Linings	Vermiculite					
	8166/B00A/R0001/Ceiling Structures/Linings/S27					Limited Samples Taken
<i>Vermiculite Ceilings may contain asbestos. Asbestos testing MUST be conducted prior to any disturbance works</i>						
<b>B00A - R2002 - Resources Store (11.74 m2)</b>						
Floor Coverings Res/Textile	Vinyl Tiles	11m2	North	Good Condition (1)	Low (1)	Low Priority (2-3)
	8166/B00A/R0001/Floor Coverings Res/Textile/S26					Chrysotile (white asbestos)
Ceiling Structures/Linings	Vermiculite					
	8166/B00A/R0001/Ceiling Structures/Linings/S27					Limited Samples Taken
<i>Vermiculite Ceilings may contain asbestos. Asbestos testing MUST be conducted prior to any disturbance works</i>						
<b>B00A - R2003 - General Learning Space (51.64 m2)</b>						
Chalk Board	Compressed AC Sheet					
	8166/B00A/R2003/Chalk Board/S30					No Asbestos Detected
Ceiling Structures/Linings	Vermiculite					
	8166/B00A/R0001/Ceiling Structures/Linings/S27					Limited Samples Taken
<i>Vermiculite Ceilings may contain asbestos. Asbestos testing MUST be conducted prior to any disturbance works</i>						
<b>B00A - R2004 - General Learning Space (52.52 m2)</b>						
Chalk Board	Compressed AC Sheet					
	8166/B00A/R2003/Chalk Board/S30					No Asbestos Detected
Ceiling Structures/Linings	Vermiculite					
	8166/B00A/R0001/Ceiling Structures/Linings/S27					Limited Samples Taken
<i>Vermiculite Ceilings may contain asbestos. Asbestos testing MUST be conducted prior to any disturbance works</i>						
<b>B00A - R2006 - Movement (9.06 m2)</b>						
Ceiling Structures/Linings	Vermiculite					
	8166/B00A/R0001/Ceiling Structures/Linings/S27					Limited Samples Taken
<i>Vermiculite Ceilings may contain asbestos. Asbestos testing MUST be conducted prior to any disturbance works</i>						
<b>B00A - R2007 - Office/Store (11.72 m2)</b>						
Ceiling Structures/Linings	Vermiculite					
	8166/B00A/R0001/Ceiling Structures/Linings/S27					Limited Samples Taken
<i>Vermiculite Ceilings may contain asbestos. Asbestos testing MUST be conducted prior to any disturbance works</i>						
<b>B00A - R2008 - Staff Lounge (16.08 m2)</b>						
Ceiling Structures/Linings	Vermiculite					
	8166/B00A/R0001/Ceiling Structures/Linings/S27					Limited Samples Taken
<i>Vermiculite Ceilings may contain asbestos. Asbestos testing MUST be conducted prior to any disturbance works</i>						
<b>B00A - R2009 - Resources Store (13.08 m2)</b>						
Ceiling Structures/Linings	Vermiculite					
	8166/B00A/R0001/Ceiling Structures/Linings/S27					Limited Samples Taken
<i>Vermiculite Ceilings may contain asbestos. Asbestos testing MUST be conducted prior to any disturbance works</i>						
<b>B00A - R2010 - Distribution Board Cupboard (0.81 m2)</b>					Note: No inspection of live electrical installation.	

Product	Material Description	Extent	Location Reference	Material Condition	Risk Status	Control Priority
Sample No					Test Result	

Ceiling Structures/Linings Vermiculite  
 8166/B00A/R0001/Ceiling Structures/Linings/S27 **Limited Samples Taken**  
*Vermiculite Ceilings may contain asbestos. Asbestos testing MUST be conducted prior to any disturbance works*

**B00A - R2013 - Careers Advisers Office (52.52 m2)**

Ceiling Structures/Linings Vermiculite  
 8166/B00A/R0001/Ceiling Structures/Linings/S27 **Limited Samples Taken**  
*Vermiculite Ceilings may contain asbestos. Asbestos testing MUST be conducted prior to any disturbance works*

**B00A - R2014 - General Learning Space (40.01 m2)**

Ceiling Structures/Linings Vermiculite  
 8166/B00A/R0001/Ceiling Structures/Linings/S27 **Limited Samples Taken**  
*Vermiculite Ceilings may contain asbestos. Asbestos testing MUST be conducted prior to any disturbance works*

**B00A - R2015 - External Movement (96.52 m2)**

No Asbestos

**B00A - R2016 - External Stairs (9.63 m2)**

No Asbestos

**B00A - R2017 - External Stairs (9.8 m2)**

No Asbestos

**B00A - R2018 - Careers Advisers Office (25.54 m2)**

No Asbestos

**B00A - R2019 - Tea Room (4.6 m2)**

No Asbestos

**B00A - R2020 - Staff Study (21.23 m2)**

No Asbestos

2017

Product	Material Description	Extent	Location Reference	Material Condition	Risk Status	Control Priority
Sample No					Test Result	

**B00B - Administration/General Learning - 1962 - Brick/Block (Brick/Block)**

**Exterior**

Underfloor Voids - Slab on Ground	Non Accessible Area - Area inaccessible
Ceiling Voids - Flat Roof	Non Accessible Area - Height Restriction 5m

**Interior**

**B00B - R0001 - Laundry (6.95 m2)**

Floor Coverings Res/Textile	Vinyl Sheet					
8166/B00B/R0003/Floor Coverings Res/Textile/S15					<b>No Asbestos Detected</b>	

**B00B - R0007 - Administration - Clerical (7.43 m2)**

Floor Coverings Res/Textile	Vinyl Tiles	8m2	Throughout	Good Condition (1)	Low (1)	Low Priority (2-3)
8166/B00B/R0007/Floor Coverings Res/Textile/S5					<b>Chrysotile (white asbestos)</b>	

**B00B - R0008 - Deputy Principal Office (15.55 m2)**

No Asbestos

**B00B - R0009 - Deputy Principal Office (16.16 m2)**

No Asbestos

**B00B - R0010 - Tea Room (4.5 m2)**

No Asbestos

**B00B - R0011 - Staff - Toilet (3.83 m2)**

No Asbestos

**B00B - R0012 - Staff - Toilet (3.84 m2)**

No Asbestos

**B00B - R0015 - Distribution Board Cupboard (0.71 m2)**

Note: No inspection of live electrical installation.

No Asbestos

**B00B - R0016 - External Movement (3.5 m2)**

No Asbestos

**B00B - R0018 - Staff - Toilet (3.41 m2)**

No Asbestos

**B00B - R0020 - Archive Store (3.87 m2)**

No Asbestos

**B00B - R0021 - Resources Store (3.9 m2)**

No Asbestos

**B00B - R0022 - Principal Office (19.37 m2)**

No Asbestos

**B00B - R0023 - Staff - Toilet (3.29 m2)**

No Asbestos

**B00B - R0024 - Administration - Clerical (10.6 m2)**

No Asbestos

**B00B - R0025 - Cleaning Store - Distributed (6.96 m2)**

No Asbestos

**B00B - R0027 - Main Switchroom (8.25 m2)**

No Asbestos

**B00B - R0028 - Cleaning Store - Distributed (6.91 m2)**

No Asbestos

**B00B - R0029 - Toilets-Girls (47.72 m2)**

No Asbestos

Product	Material Description	Extent	Location Reference	Material Condition	Risk Status	Control Priority
Sample No					Test Result	
<b>B00B - R0030 - General Learning Space (52.11 m2)</b>						
Chalk Board	Compressed AC Sheet					No Asbestos Detected
		8166/B00B/R0032/Chalk Board/S13				
<b>B00B - R0031 - General Learning Space (52.16 m2)</b>						
Chalk Board	Compressed AC Sheet					No Asbestos Detected
		8166/B00B/R0032/Chalk Board/S13				
<b>B00B - R0032 - General Learning Space (52.12 m2)</b>						
Chalk Board	Compressed AC Sheet					No Asbestos Detected
		8166/B00B/R0032/Chalk Board/S13				
<b>B00B - R0033 - Leading Teacher (13.43 m2)</b>						
No Asbestos						
<b>B00B - R0034 - Staff - Toilet (3.54 m2)</b>						
No Asbestos						
<b>B00B - R0035 - Tea Room (4.3 m2)</b>						
No Asbestos						
<b>B00B - R0036 - External Movement (2.36 m2)</b>						
No Asbestos						
<b>B00B - R0037 - Interview/Office - Type 1 (15.16 m2)</b>						
No Asbestos						
<b>B00B - R0038 - Dust Extraction Space (6.9 m2)</b>						
No Asbestos						
<b>B00B - R0039 - Wood Technology L.S. (89.65 m2)</b>						
Chalk Board	Compressed AC Sheet					No Asbestos Detected
		8166/B00B/R0032/Chalk Board/S13				
<b>B00B - R0040 - Project Store - Type 1 (13.69 m2)</b>						
Wall Linings Internal	Flat AC Sheeting					No Asbestos Detected
		8166/B00B/R0041/Wall Linings Internal/S16				
<b>B00B - R0041 - Resources Store (8.47 m2)</b>						
Wall Linings Internal	Flat AC Sheeting					No Asbestos Detected
		8166/B00B/R0041/Wall Linings Internal/S16				
<b>B00B - R0042 - Resources Store (9.22 m2)</b>						
Wall Linings Internal	Flat AC Sheeting					No Asbestos Detected
		8166/B00B/R0041/Wall Linings Internal/S16				
<b>B00B - R0043 - Metal Technology L.S. (83.37 m2)</b>						
Chalk Board	Compressed AC Sheet					No Asbestos Detected
		8166/B00B/R0032/Chalk Board/S13				
<b>B00B - R0044 - Class Tools Storage (14.73 m2)</b>						
Wall Linings Internal	Flat AC Sheeting					No Asbestos Detected
		8166/B00B/R0041/Wall Linings Internal/S16				
<b>B00B - R0045 - Welding Area (23.99 m2)</b>						
No Asbestos						
<b>B00B - R0046 - Project Store - Type 1 (7.98 m2)</b>						
Wall Linings Internal	Flat AC Sheeting					No Asbestos Detected
		8166/B00B/R0041/Wall Linings Internal/S16				
<b>B00B - R0047 - Materials Technology L.S. (90.37 m2)</b>						
Chalk Board	Compressed AC Sheet					No Asbestos Detected
		8166/B00B/R0032/Chalk Board/S13				
<b>B00B - R0048 - Materials Store (12.01 m2)</b>						
Wall Linings Internal	Flat AC Sheeting					No Asbestos Detected
		8166/B00B/R0041/Wall Linings Internal/S16				
<b>B00B - R0049 - Movement (85.05 m2)</b>						



Product	Material Description	Extent	Location Reference	Material Condition	Risk Status	Control Priority
Sample No					Test Result	
Floor Coverings Res/Textile	Vinyl Tiles	87m2	Throughout	Good Condition (1)	Low (1)	Low Priority (2-3)
8166/B00B/R0049/Floor Coverings Res/Textile/S14					Chrysotile (white asbestos)	

**B00B - R0050 - Archive Store (15.83 m2)**

No Asbestos

**B00B - R0051 - Cleaning Store - Distributed (4.92 m2)**

No Asbestos

**B00B - R0052 - Movement (89.95 m2)**

Floor Coverings Res/Textile	Vinyl Sheet					
8166/B00B/R0003/Floor Coverings Res/Textile/S15					No Asbestos Detected	

**B00B - R0053 - External Movement (3.15 m2)**

No Asbestos

**B00B - R0055 - Toilets-Boys (42.63 m2)**

No Asbestos

**B00B - R0056 - External Movement (3.59 m2)**

No Asbestos

**B00B - R0057 - Stairs (6.18 m2)**

No Asbestos

**B00B - R0058 - Stairs (4.85 m2)**

No Asbestos

**B00B - R0059 - Staff Study (60.69 m2)**

No Asbestos

**B00B - R0060 - Tea Room (1.91 m2)**

No Asbestos

**B00B - R0061 - Food Technology L.S. (100.78 m2)**

No Asbestos

**B00B - R0062 - Class Tools Storage (6.08 m2)**

No Asbestos

**B00B - R0063 - Preparation - Materials (7.83 m2)**

No Asbestos

**B00B - R0064 - Pantry (5.16 m2)**

No Asbestos

**B00B - R0065 - Movement (10.76 m2)**

No Asbestos

**B00B - R0066 - Movement (4.49 m2)**

No Asbestos

**B00B - R0067 - Duty Room (19.47 m2)**

No Asbestos

**B00B - R0068 - Movement (32.17 m2)**

No Asbestos

**B00B - R0069 - Administration - Clerical (48.37 m2)**

No Asbestos

**B00B - R0070 - Tea Room (18.06 m2)**

No Asbestos

**B00B - R0071 - Clinic (6.48 m2)**

No Asbestos

**B00B - R0072 - Movement (72.61 m2)**

No Asbestos

Product	Material Description	Extent	Location Reference	Material Condition	Risk Status	Control Priority
Sample No					Test Result	
<b>B00B - R0073 - External Movement (1.42 m2)</b>						
No Asbestos						
<b>B00B - R0074 - External Movement (1.85 m2)</b>						
Non Accessible						
<b>B00B - R0075 - Toilet - Lobby (4.01 m2)</b>						
No Asbestos						
<b>B00B - R0076 - Plant (5.46 m2)</b>						
No Asbestos						
<b>B00B - R0077 - Materials Store (42.13 m2)</b>						
No Asbestos						
<b>B00B - R0078 - General Storeroom (7.8 m2)</b>						
No Asbestos						
<b>B00B - R1001 - General Learning Space (52.1 m2)</b>						
Chalk Board	Compressed AC Sheet		8166/B00B/R0032/Chalk Board/S13			No Asbestos Detected
<b>B00B - R1002 - General Learning Space (52.1 m2)</b>						
Chalk Board	Compressed AC Sheet		8166/B00B/R0032/Chalk Board/S13			No Asbestos Detected
<b>B00B - R1005 - Computer Learning Space (52.32 m2)</b>						
No Asbestos						
<b>B00B - R1006 - General Learning Space (39.58 m2)</b>						
No Asbestos						
<b>B00B - R1007 - General Storeroom (5.96 m2)</b>						
No Asbestos						
<b>B00B - R1008 - Resources Store (7.5 m2)</b>						
No Asbestos						
<b>B00B - R1009 - Computer Learning Space (57.64 m2)</b>						
No Asbestos						
<b>B00B - R1010 - Office/Store (15.82 m2)</b>						
No Asbestos						
<b>B00B - R1011 - General Storeroom (5.19 m2)</b>						
No Asbestos						
<b>B00B - R1013 - Stairs (12.63 m2)</b>						
No Asbestos						
<b>B00B - R1014 - Stairs (7.69 m2)</b>						
No Asbestos						
<b>B00B - R1015 - Movement (93.17 m2)</b>						
No Asbestos						
<b>B00B - R1016 - Movement (18.29 m2)</b>						
No Asbestos						
<b>B00B - R1017 - Staff Study (49.24 m2)</b>						
No Asbestos						
<b>B00B - R1018 - Tea Room (2.7 m2)</b>						
No Asbestos						

Product	Material Description	Extent	Location Reference	Material Condition	Risk Status	Control Priority
Sample No					Test Result	

**B00C - Support Unit/Music/Art - 1978 - Brick/Block (Brick/Block)**

**Exterior**

Ceiling Voids - Flat Roof	Non Accessible Area - Height Restriction 5m
Underfloor Voids - Slab on Ground	Non Accessible Area - Area inaccessible
No Asbestos	

**Interior**

**B00C - R0001 - Machine Storage (25.38 m2)**

No Asbestos

**B00C - R0002 - Sport Equipment Store (25.35 m2)**

No Asbestos

**B00C - R0003 - Cleaning Store - Distributed (10.83 m2)**

No Asbestos

**B00C - R0004 - General Assistants (44.19 m2)**

No Asbestos

**B00C - R0005 - General Assistants (14.67 m2)**

No Asbestos

**B00C - R0006 - General Storeroom (20.31 m2)**

No Asbestos

**B00C - R0007 - Student Canteen (47.29 m2)**

No Asbestos

**B00C - R0008 - Store - Coolroom (5.74 m2)**

No Asbestos

**B00C - R0009 - Office/Store (5.74 m2)**

No Asbestos

**B00C - R0010 - Staff - Toilet (1.59 m2)**

No Asbestos

**B00C - R0011 - Design L.S. (130.27 m2)**

Floor Coverings Res/Textile	Vinyl Sheet	8166/B00C/R2004/Floor Coverings Res/Textile/S24	No Asbestos Detected
-----------------------------	-------------	---	----------------------

**B00C - R0013 - Resources Store (14.11 m2)**

Floor Coverings Res/Textile	Vinyl Tiles	8166/B00C/R2004/Floor Coverings Res/Textile/S24	No Asbestos Detected
-----------------------------	-------------	---	----------------------

**B00C - R0015 - Uniform Shop (24.21 m2)**

No Asbestos

**B00C - R0016 - Practical Activity Area (38.86 m2)**

No Asbestos

**B00C - R0017 - Movement (30.6 m2)**

No Asbestos

**B00C - R0018 - Stairs (5.7 m2)**

No Asbestos

**B00C - R0019 - Stairs (5.48 m2)**

No Asbestos

**B00C - R0021 - Movement (69 m2)**

No Asbestos

**B00C - R0022 - Movement (81.99 m2)**

Product	Material Description	Extent	Location Reference	Material Condition	Risk Status	Control Priority
Sample No					Test Result	
No Asbestos						
<b>B00C - R1004 - Staff Study (38.71 m2)</b>						
Ceiling Structures/Linings	Vermiculite		8166/B00C/R1015/Ceiling Structures/Linings/S17			Limited Samples Taken
<i>Vermiculite Ceilings may contain asbestos. Asbestos testing MUST be conducted prior to any disturbance works</i>						
<b>B00C - R1005 - Special Learning Space (39.44 m2)</b>						
Chalk Board	Compressed AC Sheet		8166/B00C/R1006/Chalk Board/S20			No Asbestos Detected
Ceiling Structures/Linings	Vermiculite		8166/B00C/R1015/Ceiling Structures/Linings/S17			Limited Samples Taken
<i>Vermiculite Ceilings may contain asbestos. Asbestos testing MUST be conducted prior to any disturbance works</i>						
<b>B00C - R1006 - Special Learning Space (38.33 m2)</b>						
Chalk Board	Compressed AC Sheet		8166/B00C/R1006/Chalk Board/S20			No Asbestos Detected
Ceiling Structures/Linings	Vermiculite		8166/B00C/R1015/Ceiling Structures/Linings/S17			Limited Samples Taken
<i>Vermiculite Ceilings may contain asbestos. Asbestos testing MUST be conducted prior to any disturbance works</i>						
<b>B00C - R1007 - Cleaning Store - Distributed (1.97 m2)</b>						
Ceiling Structures/Linings	Vermiculite		8166/B00C/R1015/Ceiling Structures/Linings/S17			Limited Samples Taken
<i>Vermiculite Ceilings may contain asbestos. Asbestos testing MUST be conducted prior to any disturbance works</i>						
<b>B00C - R1008 - General Storeroom (4.56 m2)</b>						
Ceiling Structures/Linings	Vermiculite		8166/B00C/R1015/Ceiling Structures/Linings/S17			Limited Samples Taken
<i>Vermiculite Ceilings may contain asbestos. Asbestos testing MUST be conducted prior to any disturbance works</i>						
<b>B00C - R1009 - Interview/Office - Type 1 (10.77 m2)</b>						
Ceiling Structures/Linings	Vermiculite		8166/B00C/R1015/Ceiling Structures/Linings/S17			Limited Samples Taken
<i>Vermiculite Ceilings may contain asbestos. Asbestos testing MUST be conducted prior to any disturbance works</i>						
<b>B00C - R1010 - Resources Store (10.06 m2)</b>						
Ceiling Structures/Linings	Vermiculite		8166/B00C/R1015/Ceiling Structures/Linings/S17			Limited Samples Taken
<i>Vermiculite Ceilings may contain asbestos. Asbestos testing MUST be conducted prior to any disturbance works</i>						
<b>B00C - R1011 - Interview/Office - Type 1 (15.68 m2)</b>						
Ceiling Structures/Linings	Vermiculite		8166/B00C/R1015/Ceiling Structures/Linings/S17			Limited Samples Taken
<i>Vermiculite Ceilings may contain asbestos. Asbestos testing MUST be conducted prior to any disturbance works</i>						
<b>B00C - R1013 - Staff - Toilet (3.2 m2)</b>						
Ceiling Structures/Linings	Vermiculite		8166/B00C/R1015/Ceiling Structures/Linings/S17			Limited Samples Taken
<i>Vermiculite Ceilings may contain asbestos. Asbestos testing MUST be conducted prior to any disturbance works</i>						
<b>B00C - R1014 - Resources Store (5.46 m2)</b>						
Ceiling Structures/Linings	Vermiculite		8166/B00C/R1015/Ceiling Structures/Linings/S17			Limited Samples Taken
<i>Vermiculite Ceilings may contain asbestos. Asbestos testing MUST be conducted prior to any disturbance works</i>						
<b>B00C - R1015 - Design L.S. (64.7 m2)</b>						
Ceiling Structures/Linings	Vermiculite		8166/B00C/R1015/Ceiling Structures/Linings/S17			Limited Samples Taken
<i>Vermiculite Ceilings may contain asbestos. Asbestos testing MUST be conducted prior to any disturbance works</i>						
<b>B00C - R1016 - Resources Store (3.11 m2)</b>						
Ceiling Structures/Linings	Vermiculite		8166/B00C/R1015/Ceiling Structures/Linings/S17			Limited Samples Taken
<i>Vermiculite Ceilings may contain asbestos. Asbestos testing MUST be conducted prior to any disturbance works</i>						
<b>B00C - R1017 - Preparation/Printing (24.73 m2)</b>						

Product	Material Description	Extent	Location Reference	Material Condition	Risk Status	Control Priority
Sample No					Test Result	
Ceiling Structures/Linings	Vermiculite					
	8166/B00C/R1015/Ceiling Structures/Linings/S17					Limited Samples Taken
<i>Vermiculite Ceilings may contain asbestos. Asbestos testing MUST be conducted prior to any disturbance works</i>						
<b>B00C - R1018 - Office/Store (12.43 m2)</b>						
Ceiling Structures/Linings	Vermiculite					
	8166/B00C/R1015/Ceiling Structures/Linings/S17					Limited Samples Taken
<i>Vermiculite Ceilings may contain asbestos. Asbestos testing MUST be conducted prior to any disturbance works</i>						
<b>B00C - R1019 - Printing/Photocopying (12.5 m2)</b>						
Ceiling Structures/Linings	Vermiculite					
	8166/B00C/R1015/Ceiling Structures/Linings/S17					Limited Samples Taken
<i>Vermiculite Ceilings may contain asbestos. Asbestos testing MUST be conducted prior to any disturbance works</i>						
<b>B00C - R1025 - Distribution Board Cupboard (0.89 m2)</b>						
Electrical Mounting Board	Flat AC Sheeting	1Unit	East	Good Condition (1)	Low (1)	Low Priority (2-3)
	8166/B00C/R1025/Electrical Mounting Board/S37					Chrysotile (white asbestos)
Note: No inspection of live electrical installation.						
<b>B00C - R1028 - External Movement (2.15 m2)</b>						
Ceiling Structures/Linings	Vermiculite					
	8166/B00C/R1015/Ceiling Structures/Linings/S17					Limited Samples Taken
<i>Vermiculite Ceilings may contain asbestos. Asbestos testing MUST be conducted prior to any disturbance works</i>						
<b>B00C - R1029 - External Movement (6.5 m2)</b>						
Ceiling Structures/Linings	Vermiculite					
	8166/B00C/R1015/Ceiling Structures/Linings/S17					Limited Samples Taken
<i>Vermiculite Ceilings may contain asbestos. Asbestos testing MUST be conducted prior to any disturbance works</i>						
<b>B00C - R1030 - Stairs (9.08 m2)</b>						
Ceiling Structures/Linings	Vermiculite					
	8166/B00C/R1015/Ceiling Structures/Linings/S17					Limited Samples Taken
<i>Vermiculite Ceilings may contain asbestos. Asbestos testing MUST be conducted prior to any disturbance works</i>						
<b>B00C - R1031 - Stairs (17.07 m2)</b>						
Ceiling Structures/Linings	Vermiculite					
	8166/B00C/R1015/Ceiling Structures/Linings/S17					Limited Samples Taken
<i>Vermiculite Ceilings may contain asbestos. Asbestos testing MUST be conducted prior to any disturbance works</i>						
<b>B00C - R1032 - Stairs (3.18 m2)</b>						
Ceiling Structures/Linings	Vermiculite					
	8166/B00C/R1015/Ceiling Structures/Linings/S17					Limited Samples Taken
<i>Vermiculite Ceilings may contain asbestos. Asbestos testing MUST be conducted prior to any disturbance works</i>						
<b>B00C - R1035 - Access Student Shower/Toilet/Change (8.05 m2)</b>						
No Asbestos						
<b>B00C - R1036 - Resources Store (6.21 m2)</b>						
No Asbestos						
<b>B00C - R1038 - Aboriginal Resource Centre (20.61 m2)</b>						
No Asbestos						
<b>B00C - R1039 - Tea Room (4.64 m2)</b>						
No Asbestos						
<b>B00C - R1040 - Food Technology L.S. (108.07 m2)</b>						
No Asbestos						
<b>B00C - R1041 - Class Tools Storage (13.96 m2)</b>						
No Asbestos						
<b>B00C - R1042 - Preparation (20.5 m2)</b>						
No Asbestos						
<b>B00C - R1043 - Pantry (14.9 m2)</b>						
No Asbestos						
<b>B00C - R1044 - Seminar (47.05 m2)</b>						
No Asbestos						

Product	Material Description	Extent	Location Reference	Material Condition	Risk Status	Control Priority
Sample No					Test Result	
No Asbestos						
<b>B00C - R1045 - General Learning Space - M (51.12 m2)</b>						
Recently Modified Space Requires Inspection						
<b>B00C - R1046 - Practical Activity Area (13 m2)</b>						
Recently Modified Space Requires Inspection						
<b>B00C - R1047 - Practical Activity Area (14.94 m2)</b>						
Recently Modified Space Requires Inspection						
<b>B00C - R1048 - General Learning Space - M (43.71 m2)</b>						
Recently Modified Space Requires Inspection						
<b>B00C - R1049 - General Storeroom (2.53 m2)</b>						
Recently Modified Space Requires Inspection						
<b>B00C - R1050 - Staff Lounge (16.67 m2)</b>						
Recently Modified Space Requires Inspection						
<b>B00C - R1051 - Staff Kitchen (21.03 m2)</b>						
Recently Modified Space Requires Inspection						
<b>B00C - R1052 - Movement (7.57 m2)</b>						
Recently Modified Space Requires Inspection						
<b>B00C - R1053 - Movement (89.4 m2)</b>						
Recently Modified Space Requires Inspection						
<b>B00C - R1054 - Movement (72.98 m2)</b>						
Recently Modified Space Requires Inspection						
<b>B00C - R1055 - Toilet - Lobby (2.31 m2)</b>						
Recently Modified Space Requires Inspection						
<b>B00C - R1056 - Staff - Toilet (1.47 m2)</b>						
Recently Modified Space Requires Inspection						
<b>B00C - R2001 - Computer Learning Space (51.73 m2)</b>						
No Asbestos						
<b>B00C - R2002 - Resources Store (4.55 m2)</b>						
No Asbestos						
<b>B00C - R2003 - General Learning Space (51.58 m2)</b>						
No Asbestos						
<b>B00C - R2006 - General Storeroom (17.09 m2)</b>						
No Asbestos						
<b>B00C - R2007 - General Storeroom (8.75 m2)</b>						
Floor Coverings Res/Textile	Vinyl Sheet					
8166/B00C/R2004/Floor Coverings Res/Textile/S24					No Asbestos Detected	
<b>B00C - R2009 - General Learning Space (51.66 m2)</b>						
No Asbestos						
<b>B00C - R2010 - Workshop (25.4 m2)</b>						
No Asbestos						
<b>B00C - R2011 - Art Learning Space (64.01 m2)</b>						
Floor Coverings Res/Textile	Vinyl Sheet					
8166/B00C/R2004/Floor Coverings Res/Textile/S24					No Asbestos Detected	
<b>B00C - R2012 - Resources Store (6.06 m2)</b>						
No Asbestos						
<b>B00C - R2013 - Cleaning Store - Distributed (7.87 m2)</b>						
No Asbestos						

Product	Material Description	Extent	Location Reference	Material Condition	Risk Status	Control Priority
Sample No					Test Result	
<b>B00C - R2014 - Staff - Toilet (5.97 m2)</b>						
No Asbestos						
<b>B00C - R2017 - General Storeroom (25.36 m2)</b>						
Floor Coverings Res/Textile	Vinyl Sheet					
8166/B00C/R1022/Floor Coverings Res/Textile/S21					<b>No Asbestos Detected</b>	
<b>B00C - R2018 - Distribution Board Cupboard (0.45 m2)</b>						
					Note: No inspection of live electrical installation.	
No Asbestos						
<b>B00C - R2019 - Music Learning Space (51.51 m2)</b>						
Wall Linings Internal	Flat AC Sheeting	20m2	North	Good Condition (1)	Low (1)	Low Priority (2-3)
8166/B00C/R2020/Wall Linings Internal/S23					<b>Chrysotile (white asbestos)</b>	
<b>B00C - R2020 - Music Learning Space (51.51 m2)</b>						
Wall Linings Internal	Flat AC Sheeting	20m2	South	Good Condition (1)	Low (1)	Low Priority (2-3)
8166/B00C/R2020/Wall Linings Internal/S23					<b>Chrysotile (white asbestos)</b>	
<b>B00C - R2021 - Music Store (7.84 m2)</b>						
No Asbestos						
<b>B00C - R2022 - Movement (161.5 m2)</b>						
Floor Coverings Res/Textile	Vinyl Tiles	163m2	Throughout	Good Condition (1)	Low (1)	Low Priority (2-3)
8166/B00C/R1027/Floor Coverings Res/Textile/S18					<b>Chrysotile (white asbestos)</b>	
<b>B00C - R2023 - Stairs (14.98 m2)</b>						
No Asbestos						
<b>B00C - R2024 - Stairs (14.94 m2)</b>						
No Asbestos						
<b>B00C - R2025 - Staff Kitchen (10.53 m2)</b>						
Floor Coverings Res/Textile	Vinyl Tiles	11m2	North	Good Condition (1)	Low (1)	Low Priority (2-3)
8166/B00C/R1027/Floor Coverings Res/Textile/S18					<b>Chrysotile (white asbestos)</b>	
<b>B00C - R2026 - Commonroom (93.5 m2)</b>						
No Asbestos						
<b>B00C - R2027 - Staff Study (19.07 m2)</b>						
No Asbestos						
<b>B00C - R2028 - Staff Study (36.2 m2)</b>						
No Asbestos						
<b>B00C - R2029 - Tea Room (2.24 m2)</b>						
No Asbestos						
<b>B00C - R2030 - Darkroom Space (4.13 m2)</b>						
No Asbestos						
<b>B00C - R2031 - Movement (2.44 m2)</b>						
No Asbestos						
<b>B00C - R2032 - Dark Room (18.02 m2)</b>						
No Asbestos						
<b>B00C - R2033 - Art Learning Space (104.67 m2)</b>						
No Asbestos						

Product	Material Description	Extent	Location Reference	Material Condition	Risk Status	Control Priority
Sample No					Test Result	

**B00D - General Learning/Science Learning - 1978 - Brick/Block (Brick/Block)****Exterior**

Underfloor Voids - Slab on Ground	Non Accessible Area - Area inaccessible					
Ceiling Voids - Flat Roof	Non Accessible Area - Height Restriction 5m					
Eaves Linings	Flat AC Sheeting	10m2	North	Good Condition (1)	Low (1)	Low Priority (2-3)
	8166/B00D/Eaves Linings/S38					<b>Chrysotile (white asbestos)</b>

**Interior****B00D - M0001 - Senior Study (42.55 m2)**

No Asbestos

**B00D - M0002 - Aboriginal Resource Centre (26.76 m2)**

No Asbestos

**B00D - M0003 - Senior Study (11.06 m2)**

No Asbestos

**B00D - M0004 - Interview/Office - Type 1 (11.06 m2)**

No Asbestos

**B00D - M0005 - Interview/Office - Type 1 (11.06 m2)**

No Asbestos

**B00D - R0001 - Tea Room (11.63 m2)**

Floor Coverings Res/Textile	Vinyl Tiles					
	8166/B00D/R2017/Floor Coverings Res/Textile/S34					<b>No Asbestos Detected</b>

**B00D - R0002 - Staff Study (51.1 m2)**

No Asbestos

**B00D - R0003 - General Learning Space (51.73 m2)**

Chalk Board	Compressed AC Sheet					
	8166/B00D/R0005/Chalk Board/S35					<b>No Asbestos Detected</b>

**B00D - R0004 - General Learning Space (50.43 m2)**

Chalk Board	Compressed AC Sheet					
	8166/B00D/R0005/Chalk Board/S35					<b>No Asbestos Detected</b>

**B00D - R0005 - General Learning Space (51.3 m2)**

Chalk Board	Compressed AC Sheet					
	8166/B00D/R0005/Chalk Board/S35					<b>No Asbestos Detected</b>

**B00D - R0006 - Staff - Toilet (9.72 m2)**

No Asbestos

**B00D - R0007 - Distribution Board Cupboard (0.74 m2)**

Note: No inspection of live electrical installation.

No Asbestos

**B00D - R0008 - General Storeroom (13.55 m2)**

Floor Coverings Res/Textile	Vinyl Tiles					
	8166/B00D/R2017/Floor Coverings Res/Textile/S34					<b>No Asbestos Detected</b>

**B00D - R0009 - Cleaning Store - Distributed (0.74 m2)**

No Asbestos

**B00D - R0010 - Staff - Toilet (9.74 m2)**

No Asbestos

**B00D - R0011 - Plant (22.16 m2)**

No Asbestos

**B00D - R0015 - Library Administration (48.97 m2)**



Product	Material Description	Extent	Location Reference	Material Condition	Risk Status	Control Priority
	Sample No					Test Result
		No Asbestos				
	<b>B00D - R0016 - Librarian (11.97 m2)</b>					
		No Asbestos				
	<b>B00D - R0017 - Office/Store (26.68 m2)</b>					
		No Asbestos				
	<b>B00D - R0018 - Audio Visual Workroom (8.06 m2)</b>					
		No Asbestos				
	<b>B00D - R0019 - Main Area (268.75 m2)</b>					
		No Asbestos				
	<b>B00D - R0022 - External Movement (30.31 m2)</b>					
		No Asbestos				
	<b>B00D - R0023 - External Movement (30.38 m2)</b>					
		No Asbestos				
	<b>B00D - R0024 - Seminar (63.86 m2)</b>					
		No Asbestos				
	<b>B00D - R0026 - External Stairs (1.36 m2)</b>					
		No Asbestos				
	<b>B00D - R0029 - External Stairs (3.15 m2)</b>					
		No Asbestos				
	<b>B00D - R0030 - General Storeroom (14.61 m2)</b>					
		No Asbestos				
	<b>B00D - R0033 - External Movement (230.02 m2)</b>					
		No Asbestos				
	<b>B00D - R0034 - Main Entry (47.37 m2)</b>					
		No Asbestos				
	<b>B00D - R0035 - General Learning Space (48.65 m2)</b>					
		No Asbestos				
	<b>B00D - R0036 - Stairs (0.75 m2)</b>					
		No Asbestos				
	<b>B00D - R0037 - Stairs (4.41 m2)</b>					
		No Asbestos				
	<b>B00D - R0038 - Stairs (4.38 m2)</b>					
		No Asbestos				
	<b>B00D - R0039 - Stairs (0.74 m2)</b>					
		No Asbestos				
	<b>B00D - R0040 - Movement (31.77 m2)</b>					
		No Asbestos				
	<b>B00D - R0041 - Tiered Learning Area (3.47 m2)</b>					
		No Asbestos				
	<b>B00D - R0042 - Tiered Learning Area (8.26 m2)</b>					
		No Asbestos				
	<b>B00D - R0043 - Tiered Learning Area (3.41 m2)</b>					
		No Asbestos				
	<b>B00D - R0044 - External Movement (9.37 m2)</b>					
		No Asbestos				
	<b>B00D - R0045 - External Movement (15.86 m2)</b>					
		No Asbestos				
	<b>B00D - R0046 - Movement (4.2 m2)</b>					

Product	Material Description	Extent	Location Reference	Material Condition	Risk Status	Control Priority
Sample No					Test Result	
Recently Modified Space	Requires Inspection					
<b>B00D - R0047 - Lift (2.24 m2)</b>						
Recently Modified Space	Requires Inspection					
<b>B00D - R1001 - Laboratory L.S. (95.56 m2)</b>						
Floor Coverings Res/Textile	Vinyl Tiles					
	8166/B00D/R2017/Floor Coverings Res/Textile/S34				No Asbestos Detected	
<b>B00D - R1002 - Preparation - Science (47.46 m2)</b>						
Floor Coverings Res/Textile	Vinyl Tiles					
	8166/B00D/R2017/Floor Coverings Res/Textile/S34				No Asbestos Detected	
<b>B00D - R1003 - Laboratory L.S. (96.9 m2)</b>						
Floor Coverings Res/Textile	Vinyl Tiles					
	8166/B00D/R2017/Floor Coverings Res/Textile/S34				No Asbestos Detected	
<b>B00D - R1004 - Resources Store (19.09 m2)</b>						
Floor Coverings Res/Textile	Vinyl Tiles					
	8166/B00D/R2017/Floor Coverings Res/Textile/S34				No Asbestos Detected	
<b>B00D - R1005 - Leading Teacher (11.05 m2)</b>						
No Asbestos						
<b>B00D - R1006 - Toilets-Girls (9.46 m2)</b>						
No Asbestos						
<b>B00D - R1007 - Distribution Board Cupboard (0.76 m2)</b>						
					Note: No inspection of live electrical installation.	
No Asbestos						
<b>B00D - R1008 - Staff - Toilet (3.98 m2)</b>						
No Asbestos						
<b>B00D - R1009 - Staff - Toilet (4.01 m2)</b>						
No Asbestos						
<b>B00D - R1010 - Cleaning Store - Distributed (0.68 m2)</b>						
No Asbestos						
<b>B00D - R1011 - Toilets-Boys (9.52 m2)</b>						
No Asbestos						
<b>B00D - R1012 - Laboratory L.S. (95.69 m2)</b>						
Floor Coverings Res/Textile	Vinyl Tiles					
	8166/B00D/R2017/Floor Coverings Res/Textile/S34				No Asbestos Detected	
<b>B00D - R1013 - Resources Store (48.26 m2)</b>						
Floor Coverings Res/Textile	Vinyl Tiles					
	8166/B00D/R2017/Floor Coverings Res/Textile/S34				No Asbestos Detected	
<b>B00D - R1014 - Apparatus Store (29.66 m2)</b>						
Floor Coverings Res/Textile	Vinyl Tiles					
	8166/B00D/R2017/Floor Coverings Res/Textile/S34				No Asbestos Detected	
<b>B00D - R1017 - External Stairs (18.35 m2)</b>						
No Asbestos						
<b>B00D - R1019 - External Stairs (18.44 m2)</b>						
No Asbestos						
<b>B00D - R1021 - External Movement (226.25 m2)</b>						
No Asbestos						
<b>B00D - R1022 - Staff Study (30 m2)</b>						

Product	Material Description	Extent	Location Reference	Material Condition	Risk Status	Control Priority
Sample No					Test Result	
No Asbestos						
<b>B00D - R1023 - Tea Room (2.05 m2)</b>						
No Asbestos						
<b>B00D - R1024 - Movement (4.2 m2)</b>						
Recently Modified Space Requires Inspection						
<b>B00D - R2001 - General Learning Space (50.97 m2)</b>						
Ceiling Structures/Linings	Vermiculite					
	8166/B00D/R2012/Ceiling Structures/Linings/S32					Limited Samples Taken
<i>Vermiculite Ceilings may contain asbestos. Asbestos testing MUST be conducted prior to any disturbance works</i>						
<b>B00D - R2002 - Computer Learning Space (51.37 m2)</b>						
Ceiling Structures/Linings	Vermiculite					
	8166/B00D/R2012/Ceiling Structures/Linings/S32					Limited Samples Taken
<i>Vermiculite Ceilings may contain asbestos. Asbestos testing MUST be conducted prior to any disturbance works</i>						
<b>B00D - R2003 - Computer Store (6.01 m2)</b>						
Floor Coverings Res/Textile	Vinyl Tiles					
	8166/B00D/R2017/Floor Coverings Res/Textile/S34					No Asbestos Detected
Ceiling Structures/Linings	Vermiculite					
	8166/B00D/R2012/Ceiling Structures/Linings/S32					Limited Samples Taken
<i>Vermiculite Ceilings may contain asbestos. Asbestos testing MUST be conducted prior to any disturbance works</i>						
<b>B00D - R2004 - Resources Store (6.02 m2)</b>						
Floor Coverings Res/Textile	Vinyl Tiles					
	8166/B00D/R2017/Floor Coverings Res/Textile/S34					No Asbestos Detected
Ceiling Structures/Linings	Vermiculite					
	8166/B00D/R2012/Ceiling Structures/Linings/S32					Limited Samples Taken
<i>Vermiculite Ceilings may contain asbestos. Asbestos testing MUST be conducted prior to any disturbance works</i>						
<b>B00D - R2005 - General Learning Space (50.51 m2)</b>						
Ceiling Structures/Linings	Vermiculite					
	8166/B00D/R2012/Ceiling Structures/Linings/S32					Limited Samples Taken
<i>Vermiculite Ceilings may contain asbestos. Asbestos testing MUST be conducted prior to any disturbance works</i>						
<b>B00D - R2006 - General Learning Space (51.37 m2)</b>						
Ceiling Structures/Linings	Vermiculite					
	8166/B00D/R2012/Ceiling Structures/Linings/S32					Limited Samples Taken
<i>Vermiculite Ceilings may contain asbestos. Asbestos testing MUST be conducted prior to any disturbance works</i>						
<b>B00D - R2007 - Toilets-Girls (9.48 m2)</b>						
Ceiling Structures/Linings	Vermiculite					
	8166/B00D/R2012/Ceiling Structures/Linings/S32					Limited Samples Taken
<i>Vermiculite Ceilings may contain asbestos. Asbestos testing MUST be conducted prior to any disturbance works</i>						
<b>B00D - R2008 - Distribution Board Cupboard (0.79 m2)</b>						
					Note: No inspection of live electrical installation.	
Ceiling Structures/Linings	Vermiculite					
	8166/B00D/R2012/Ceiling Structures/Linings/S32					Limited Samples Taken
<i>Vermiculite Ceilings may contain asbestos. Asbestos testing MUST be conducted prior to any disturbance works</i>						
<b>B00D - R2009 - Staff - Toilet (4 m2)</b>						
Ceiling Structures/Linings	Vermiculite					
	8166/B00D/R2012/Ceiling Structures/Linings/S32					Limited Samples Taken
<i>Vermiculite Ceilings may contain asbestos. Asbestos testing MUST be conducted prior to any disturbance works</i>						
<b>B00D - R2010 - Staff - Toilet (3.95 m2)</b>						
Ceiling Structures/Linings	Vermiculite					
	8166/B00D/R2012/Ceiling Structures/Linings/S32					Limited Samples Taken
<i>Vermiculite Ceilings may contain asbestos. Asbestos testing MUST be conducted prior to any disturbance works</i>						
<b>B00D - R2011 - Cleaning Store - Distributed (0.78 m2)</b>						

Product	Material Description	Extent	Location Reference	Material Condition	Risk Status	Control Priority
Sample No				Test Result		
Ceiling Structures/Linings	Vermiculite					
	8166/B00D/R2012/Ceiling Structures/Linings/S32					Limited Samples Taken
<i>Vermiculite Ceilings may contain asbestos. Asbestos testing MUST be conducted prior to any disturbance works</i>						
<b>B00D - R2012 - Toilets-Boys (9.51 m2)</b>						
Ceiling Structures/Linings	Vermiculite					
	8166/B00D/R2012/Ceiling Structures/Linings/S32					Limited Samples Taken
<i>Vermiculite Ceilings may contain asbestos. Asbestos testing MUST be conducted prior to any disturbance works</i>						
<b>B00D - R2013 - General Learning Space (51.52 m2)</b>						
Ceiling Structures/Linings	Vermiculite					
	8166/B00D/R2012/Ceiling Structures/Linings/S32					Limited Samples Taken
<i>Vermiculite Ceilings may contain asbestos. Asbestos testing MUST be conducted prior to any disturbance works</i>						
<b>B00D - R2014 - General Learning Space (51.02 m2)</b>						
Ceiling Structures/Linings	Vermiculite					
	8166/B00D/R2012/Ceiling Structures/Linings/S32					Limited Samples Taken
<i>Vermiculite Ceilings may contain asbestos. Asbestos testing MUST be conducted prior to any disturbance works</i>						
<b>B00D - R2015 - General Learning Space (51.15 m2)</b>						
Ceiling Structures/Linings	Vermiculite					
	8166/B00D/R2012/Ceiling Structures/Linings/S32					Limited Samples Taken
<i>Vermiculite Ceilings may contain asbestos. Asbestos testing MUST be conducted prior to any disturbance works</i>						
<b>B00D - R2016 - Resources Store (6.2 m2)</b>						
Floor Coverings Res/Textile	Vinyl Tiles					
	8166/B00D/R2017/Floor Coverings Res/Textile/S34					No Asbestos Detected
Ceiling Structures/Linings	Vermiculite					
	8166/B00D/R2012/Ceiling Structures/Linings/S32					Limited Samples Taken
<i>Vermiculite Ceilings may contain asbestos. Asbestos testing MUST be conducted prior to any disturbance works</i>						
<b>B00D - R2017 - Resources Store (6.13 m2)</b>						
Floor Coverings Res/Textile	Vinyl Tiles					
	8166/B00D/R2017/Floor Coverings Res/Textile/S34					No Asbestos Detected
Ceiling Structures/Linings	Vermiculite					
	8166/B00D/R2012/Ceiling Structures/Linings/S32					Limited Samples Taken
<i>Vermiculite Ceilings may contain asbestos. Asbestos testing MUST be conducted prior to any disturbance works</i>						
<b>B00D - R2018 - External Movement (179.31 m2)</b>						
Ceiling Structures/Linings	Flat AC Sheeting	169m2	Throughout	Good Condition (1)	Low (1)	Low Priority (2-3)
	8166/B00D/R2020/Ceiling Structures/Linings/S31					Chrysotile (white asbestos) , Amosite (brown asbestos)
<b>B00D - R2019 - External Stairs (19.16 m2)</b>						
Ceiling Structures/Linings	Flat AC Sheeting	22m2	Throughout	Good Condition (1)	Low (1)	Low Priority (2-3)
	8166/B00D/R2020/Ceiling Structures/Linings/S31					Chrysotile (white asbestos) , Amosite (brown asbestos)
<b>B00D - R2020 - External Stairs (19.32 m2)</b>						
Ceiling Structures/Linings	Flat AC Sheeting	23m2	Throughout	Good Condition (1)	Low (1)	Low Priority (2-3)
	8166/B00D/R2020/Ceiling Structures/Linings/S31					Chrysotile (white asbestos) , Amosite (brown asbestos)
<b>B00D - R2021 - Movement (4.2 m2)</b>						
Recently Modified Space	Requires Inspection					

Product	Material Description	Extent	Location Reference	Material Condition	Risk Status	Control Priority
Sample No					Test Result	

**B00E - Multi Purpose Facilities - 1971 - Brick/Block (Brick/Block)****Exterior**

Ceiling Voids - Flat Roof	No Asbestos Found
Underfloor Voids - Slab on Ground	Non Accessible Area - Area inaccessible

**Interior****B00E - M0001 - Control Room (6.4 m2)**

No Asbestos

**B00E - R0001 - Sport Equipment Store (33.82 m2)**

No Asbestos

**B00E - R0002 - Chair Store (17.14 m2)**

No Asbestos

**B00E - R0003 - Toilets-Disabled (4.4 m2)**

No Asbestos

**B00E - R0004 - Cleaning Store - Distributed (3.44 m2)**

No Asbestos

**B00E - R0006 - Change (33.8 m2)**

Partition Walls (Cubicles)	Compressed AC Sheet 8166/B00E/R0005/Partition Walls (Cubicles)/S9	<b>No Asbestos Detected</b>
----------------------------	--	-----------------------------

**B00E - R0008 - Stage (68.17 m2)**

No Asbestos

**B00E - R0010 - Change (33.88 m2)**

Partition Walls (Cubicles)	Compressed AC Sheet 8166/B00E/R0005/Partition Walls (Cubicles)/S9	<b>No Asbestos Detected</b>
----------------------------	--	-----------------------------

**B00E - R0011 - Distribution Board Cupboard (3.24 m2)**

Note: No inspection of live electrical installation.

No Asbestos

**B00E - R0012 - Staff Kitchen (15.27 m2)**

Floor Coverings Res/Textile	Vinyl Tiles 8166/B00E/R0013/Floor Coverings Res/Textile/S10	<b>No Asbestos Detected</b>
-----------------------------	--	-----------------------------

**B00E - R0013 - General Storeroom (5.95 m2)**

Floor Coverings Res/Textile	Vinyl Tiles 8166/B00E/R0013/Floor Coverings Res/Textile/S10	<b>No Asbestos Detected</b>
-----------------------------	--	-----------------------------

**B00E - R0014 - Chair Store (12.26 m2)**

No Asbestos

**B00E - R0015 - Sport Equipment Store (21 m2)**

No Asbestos

**B00E - R0017 - External Movement (245.7 m2)**

No Asbestos

**B00E - R0020 - Toilet - Lobby (3 m2)**

No Asbestos

**B00E - R0021 - Toilets-Girls (15.11 m2)**

No Asbestos

**B00E - R0022 - Toilet - Lobby (3.08 m2)**

No Asbestos

**B00E - R0023 - Toilets-Boys (15.14 m2)**

No Asbestos

**B00E - R0024 - Movement (15.36 m2)**

Product	Material Description	Extent	Location Reference	Material Condition	Risk Status	Control Priority
	<b>Sample No</b>					<b>Test Result</b>

No Asbestos

**B00E - R0025 - Movement (15.34 m2)**

No Asbestos

**B00E - R0026 - Multi-Purpose Space (486.79 m2)**

No Asbestos

**B00E - R0027 - General Storeroom (68.75 m2)**

No Asbestos

2017

Product	Material Description	Extent	Location Reference	Material Condition	Risk Status	Control Priority
Sample No					Test Result	

**B00F - Technological & Applied Studies - 1971 - Brick/Block (Brick/Block)**

**Exterior**

Ceiling Voids - Flat Roof	Non Accessible Area - Area inaccessible Height Restriction 5m
Underfloor Voids - Slab on Ground	Non Accessible Area - Area inaccessible

**Interior**

**B00F - R0005 - Materials Store (43.51 m2)**

No Asbestos

**B00F - R0006 - Distribution Board Cupboard (0.67 m2)**

Note: No inspection of live electrical installation.

No Asbestos

**B00F - R0007 - External Movement (8.61 m2)**

No Asbestos

**B00F - R0008 - Wood Technology L.S. (133.3 m2)**

No Asbestos

**B00F - R0009 - Outdoor Workshop (86.53 m2)**

No Asbestos

**B00F - R0010 - Class Tools Storage (5.07 m2)**

No Asbestos

**B00F - R0011 - Class Tools Storage (5.02 m2)**

No Asbestos

**B00F - R0012 - Dust Extraction Space (6.3 m2)**

No Asbestos

2017

Product	Material Description	Extent	Location Reference	Material Condition	Risk Status	Control Priority
Sample No					Test Result	

**B00G - Art - 1930 - Timber (Timber)**

**Exterior**

Ceiling Voids - Raked Ceiling	No Asbestos Found					
Underfloor Voids - Packing to Floor Joists	No Asbestos Found					
Eaves Linings	Flat AC Sheeting	3m2	West	Good Condition (1)	Low (1)	Low Priority (2-3)
	8166/B00G/Eaves Linings/S39					<b>Chrysotile (white asbestos)</b>

**Interior**

**B00G - R0001 - General Storeroom (5.41 m2)**

Ceiling Structures/Linings	Flat AC Sheeting					No Asbestos Detected
	8166/B00G/R0003/Ceiling Structures/Linings/S3					
Wall Linings Internal	Flat AC Sheeting					No Asbestos Detected
	8166/B00G/R0003/Wall Linings Internal/S2					

**B00G - R0002 - General Storeroom (18.36 m2)**

Ceiling Structures/Linings	Flat AC Sheeting					No Asbestos Detected
	8166/B00G/R0003/Ceiling Structures/Linings/S3					
Wall Linings Internal	Flat AC Sheeting					No Asbestos Detected
	8166/B00G/R0003/Wall Linings Internal/S2					

**B00G - R0003 - Art Learning Space (70.19 m2)**

Wall Linings Internal	Flat AC Sheeting					No Asbestos Detected
	8166/B00G/R0003/Wall Linings Internal/S2					
Ceiling Structures/Linings	Flat AC Sheeting					No Asbestos Detected
	8166/B00G/R0003/Ceiling Structures/Linings/S3					

**B00G - R0004 - Workshop (20.23 m2)**

Ceiling Structures/Linings	Flat AC Sheeting					No Asbestos Detected
	8166/B00G/R0003/Ceiling Structures/Linings/S3					
Wall Linings Internal	Flat AC Sheeting					No Asbestos Detected
	8166/B00G/R0003/Wall Linings Internal/S2					

**B00G - R0005 - General Storeroom (7.68 m2)**

Ceiling Structures/Linings	Flat AC Sheeting					No Asbestos Detected
	8166/B00G/R0003/Ceiling Structures/Linings/S3					
Wall Linings Internal	Flat AC Sheeting					No Asbestos Detected
	8166/B00G/R0003/Wall Linings Internal/S2					

**B00G - R0006 - Kiln Space (19.47 m2)**

Ceiling Structures/Linings	Flat AC Sheeting					No Asbestos Detected
	8166/B00G/R0003/Ceiling Structures/Linings/S3					
Wall Linings Internal	Flat AC Sheeting					No Asbestos Detected
	8166/B00G/R0003/Wall Linings Internal/S2					

**B00G - R0007 - External Movement (20.83 m2)**

Panel Above Entrance Door	Flat AC Sheeting					No Asbestos Detected
	8166/B00G/R0003/Wall Linings Internal/S2					

**B00G - R0008 - General Storeroom (21.69 m2)**

Wall Linings Internal	Flat AC Sheeting					No Asbestos Detected
	8166/B00G/R0003/Wall Linings Internal/S2					
Ceiling Structures/Linings	Flat AC Sheeting					No Asbestos Detected
	8166/B00G/R0003/Ceiling Structures/Linings/S3					



Product	Material Description	Extent	Location Reference	Material Condition	Risk Status	Control Priority
Sample No					Test Result	

**B00H - Performance Learning - 1930 - Timber (Timber)**

**Exterior**

Underfloor Voids - Packing to Floor Joists  
No Asbestos Found

Ceiling Voids - Raked Ceiling  
No Asbestos Found

**Interior**

**B00H - R0001 - Performance Workspace (89.05 m2)**

Wall Linings Internal	Flat AC Sheeting	80m2	Throughout, Upper portion	Good Condition (1)	Low (1)	Low Priority (2-3)
8166/B00H/R0001/Wall Linings Internal/S4				<b>Chrysotile (white asbestos) , Amosite (brown asbestos)</b>		

Ceiling Structures/Linings	Flat AC Sheeting	88m2	Throughout	Good Condition (1)	Low (1)	Low Priority (2-3)
8166/B00H/R0001/Ceiling Structures/Linings/S40				<b>Chrysotile (white asbestos) , Amosite (brown asbestos)</b>		

**B00H - R0002 - Performance Store (6.09 m2)**

No Asbestos

**B00H - R0004 - External Movement (10.74 m2)**

No Asbestos

**B00H - R0005 - Performance Store (4.36 m2)**

No Asbestos

**B00H - R0006 - Performance Store (12.23 m2)**

No Asbestos

2017

Product	Material Description	Extent	Location Reference	Material Condition	Risk Status	Control Priority
Sample No					Test Result	

**B00J - Support Unit - 1930 - Timber (Timber)****Exterior**

Ceiling Voids - Raked Ceiling	Non Accessible Area - Height Restriction 3.5m					
Underfloor Voids	Packing	0.2m2	Throughout	Some Damage - Unsealed (3)	Low (1)	Medium Priority (4-5)
	8166/B00J/Underfloor Voids/S41					<b>Chrysotile (white asbestos)</b>

**Interior****B00J - R0001 - Resources Store (6.46 m2)**

No Asbestos

**B00J - R0002 - Special Learning Space (52.3 m2)**

Wall Linings Internal	Flat AC Sheeting	80m2	Throughout, Upper portion	Good Condition (1)	Low (1)	Low Priority (2-3)
	8166/B00J/R0002/Wall Linings Internal/S1					<b>Chrysotile (white asbestos)</b>
Ceiling Structures/Linings	Flat AC Sheeting	53m2	Throughout	Good Condition (1)	Low (1)	Low Priority (2-3)
	8166/B00H/R0001/Ceiling Structures/Linings/S40					<b>Chrysotile (white asbestos) , Amosite (brown asbestos)</b>

**B00J - R0003 - Special Learning Space (52.45 m2)**

Wall Linings Internal	Flat AC Sheeting	80m2	Throughout, Upper portion	Good Condition (1)	Low (1)	Low Priority (2-3)
	8166/B00J/R0002/Wall Linings Internal/S1					<b>Chrysotile (white asbestos)</b>
Ceiling Structures/Linings	Flat AC Sheeting	54m2	Throughout	Good Condition (1)	Low (1)	Low Priority (2-3)
	8166/B00H/R0001/Ceiling Structures/Linings/S40					<b>Chrysotile (white asbestos) , Amosite (brown asbestos)</b>

**B00J - R0004 - External Movement (26.93 m2)**

No Asbestos

2017

Product	Material Description	Extent	Location Reference	Material Condition	Risk Status	Control Priority
Sample No					Test Result	

**B00K - Computer Learning - 2003 - Brick/Veneer (Brick/Veneer)**

**Exterior**

Underfloor Voids - Packing to Floor Joists	No Asbestos Found
Ceiling Voids	No Asbestos Found

**Interior**

**B00K - R0001 - Computer Learning Space (63.83 m2)**

Vinyl Tiles (Under Floor Covering/Carpet)	No Asbestos Found
---	-------------------

**B00K - R0002 - Computer Learning Space (64.37 m2)**

Vinyl Tiles (Under Floor Covering/Carpet)	No Asbestos Found
---	-------------------

**B00K - R0003 - Access Student Shower/Toilet/Change (4.69 m2)**

No Asbestos

**B00K - R0004 - Staff Study (12.43 m2)**

Vinyl Tiles (Under Floor Covering/Carpet)	No Asbestos Found
---	-------------------

**B00K - R0005 - Computer Store (22.88 m2)**

No Asbestos

**B00K - R0006 - Tea Room (2.1 m2)**

No Asbestos

**B00K - R0007 - Staff - Toilet (5.18 m2)**

No Asbestos

**B00K - R0008 - Computer Learning Space (64.85 m2)**

Vinyl Tiles (Under Floor Covering/Carpet)	No Asbestos Found
---	-------------------

**B00K - R0009 - Movement (52.95 m2)**

No Asbestos

**B00K - R0010 - External Movement (31.22 m2)**

No Asbestos

2017

Product	Material Description	Extent	Location Reference	Material Condition	Risk Status	Control Priority
Sample No					Test Result	

**B00L - Support Unit - 2006 - Brick/Veneer (Brick/Veneer)****Exterior**

Underfloor Voids - Slab on Ground	Non Accessible Area - Area inaccessible
Ceiling Voids	No Asbestos Found

**Interior****B00L - R0002 - Special Learning Space (43.44 m2)**

Vinyl Tiles (Under Floor Covering/Carpet)	No Asbestos Found
---	-------------------

**B00L - R0003 - Independent Learning Space (22.17 m2)**

Vinyl Tiles (Under Floor Covering/Carpet)	No Asbestos Found
---	-------------------

**B00L - R0004 - Movement (4.99 m2)**

No Asbestos

**B00L - R0006 - Special Learning Space (32.49 m2)**

Vinyl Tiles (Under Floor Covering/Carpet)	No Asbestos Found
---	-------------------

**B00L - R0007 - Laundry (2.92 m2)**

No Asbestos

**B00L - R0008 - Toilets-Boys (1.82 m2)**

No Asbestos

**B00L - R0009 - Toilet - Lobby (3.75 m2)**

No Asbestos

**B00L - R0010 - Toilets-Girls (1.86 m2)**

No Asbestos

**B00L - R0011 - Plant (0.48 m2)**

Vinyl Tiles (Under Floor Covering/Carpet)	No Asbestos Found
---	-------------------

**B00L - R0012 - Office/Store (9.25 m2)**

Vinyl Tiles (Under Floor Covering/Carpet)	No Asbestos Found
---	-------------------

**B00L - R0014 - External Movement (18.77 m2)**

No Asbestos

**B00L - R0015 - Movement (17.03 m2)**

No Asbestos

**B00L - R0016 - Staff Kitchen (10.5 m2)**

No Asbestos

**B00L - R0017 - External Movement (37.03 m2)**

No Asbestos

Product	Material Description	Extent	Location Reference	Material Condition	Risk Status	Control Priority
Sample No					Test Result	

**B00M - General Learning - 2006 - Fibre Cement Clad (Fibre Cement Clad)**

**Exterior**

Underfloor Voids - Slab on Ground	Non Accessible Area - Area inaccessible					
Eaves Linings	Flat AC Sheeting 8166/B00M/Eaves Linings/S11					<b>No Asbestos Detected</b>
Wall Cladding	Compressed AC Sheet 8166/B00M/Wall Cladding/S12					<b>No Asbestos Detected</b>
Ceiling Voids	No Asbestos Found					

**Interior**

**B00M - R0001 - General Learning Space (74.24 m2)**

No Asbestos

2017

Product	Material Description	Extent	Location Reference	Material Condition	Risk Status	Control Priority
	Sample No					Test Result

**B00P - Agricultural Science - 2011 - Brick/Block (Brick/Block)****Exterior**

Underfloor Voids - Slab on Ground	Non Accessible Area - Area inaccessible
Ceiling Voids	No Asbestos Found

**Interior****B00P - R0001 - General Learning Space (60.41 m2)**

No Asbestos

**B00P - R0002 - Growing/Breeding (19.39 m2)**

No Asbestos

**B00P - R0003 - Growing/Breeding (23.42 m2)**

No Asbestos

**B00P - R0004 - General Storeroom (8.83 m2)**

No Asbestos

**B00P - R0005 - General Storeroom (6.63 m2)**

No Asbestos

**B00P - R0006 - Staff Study (7.57 m2)**

No Asbestos

**B00P - R0007 - Tea Room (5.12 m2)**

No Asbestos

**B00P - R0008 - Access Student Shower/Toilet/Change (7.17 m2)**

No Asbestos

**B00P - R0009 - Class Tools Storage (9.58 m2)**

No Asbestos

**B00P - R0010 - Class Tools Storage (39.9 m2)**

No Asbestos

**B00P - R0011 - Machine Storage (33.81 m2)**

No Asbestos

**B00P - R0012 - Machine Storage (46.34 m2)**

No Asbestos

**B00P - R0013 - Outdoor Learning Space - Type 1 (81.61 m2)**

No Asbestos

**B00P - R0014 - External Movement (10.74 m2)**

No Asbestos

**B00P - R0015 - External Movement (3.52 m2)**

No Asbestos

2017

Product	Material Description	Extent	Location Reference	Material Condition	Risk Status	Control Priority
	Sample No					Test Result

### *Demountables*

**There are no Demountable(s) located at this school as per the AMS records as of 15 Feb 2017.**

2017

Product	Material Description	Extent	Location Reference	Material Condition	Risk Status	Control Priority
Sample No					Test Result	

*Listing of Electronic Attachments as of 22/03/2017*

**There are no asbestos related file attachment(s) for this school.**

2017