

Asbestos Register

(Hazardous Materials and Risk Assessment)

School : Wangee Park School (5568)
Region : South Western Sydney
State Electorate : Canterbury
Local Government Area : Canterbury

Initial Survey : Noel Arnold & Associates : 18 - Mar - 2008
Register Issue Date : 23 - Mar - 2017

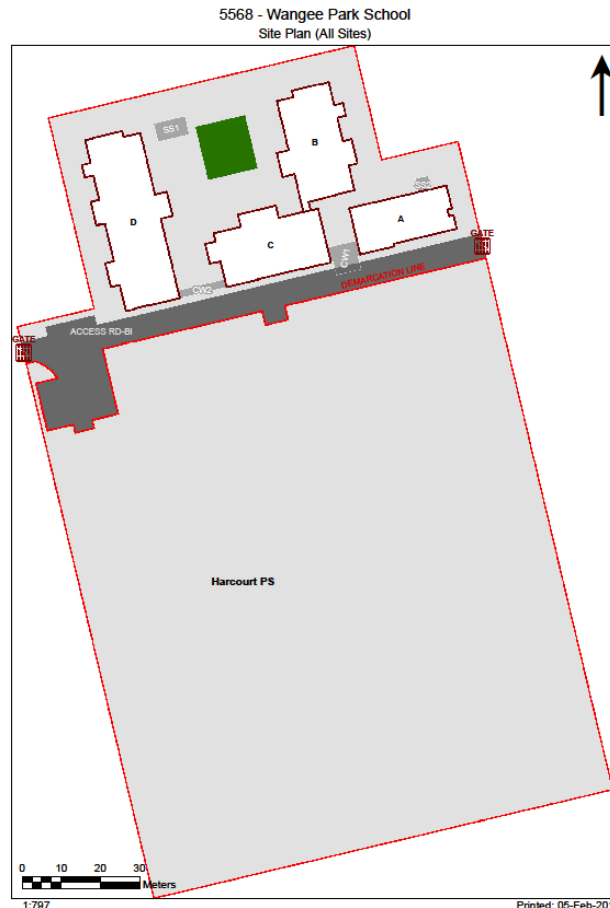

2017

| Product | Material Description | Extent | Location Reference | Material Condition | Risk Status | Control Priority |
|---------|----------------------|--------|--------------------|--------------------|-------------|------------------|
| | Sample No | | | | | Test Result |

B00A - Administration/Staff Facilities - 2014 - Brick/Veneer (Brick/Veneer)

Exterior

| | |
|------------------|---------------------|
| Ceiling Voids | No Asbestos Found |
| Underfloor Voids | Requires Inspection |

Interior

B00A - R0001 - Entry Vestibule

No Asbestos

B00A - R0002 - Principal

No Asbestos

B00A - R0003 - Interview

No Asbestos

B00A - R0004 - Movement

No Asbestos

B00A - R0005 - Interview

No Asbestos

B00A - R0006 - Sick Bay

No Asbestos

B00A - R0007 - Disabled Toilet

No Asbestos

B00A - R0008 - Staff Room

No Asbestos

B00A - R0009 - Staff Room Annexe

No Asbestos

B00A - R0010 - Security Store

No Asbestos

B00A - R0011 - Cleaning Distributed Store

No Asbestos

B00A - R0012 - Staff Toilet

No Asbestos

B00A - R0013 - Staff Toilet

No Asbestos

B00A - R0014 - Staff Toilet

No Asbestos

B00A - R0015 - Clerical Office

No Asbestos

B00A - R0016 - Clerical Office/Workroom

No Asbestos

B00A - R0017 - Staff Kitchen

No Asbestos

B00A - R0018 - External Movement

No Asbestos

B00A - R0019 - Plant

No Asbestos

B00A - R0020 - Distribution Board

Note: No inspection of live electrical installation.

No Asbestos

B00A - R0021 - External Movement

No Asbestos

| Product | Material Description | Extent | Location Reference | Material Condition | Risk Status | Control Priority |
|---------|----------------------|--------|--------------------|--------------------|-------------|------------------|
| | Sample No | | | | | Test Result |

B00B - Support Unit (M P S) - 2014 - Brick/Veneer (Brick/Veneer)**Exterior**

| | |
|------------------|---------------------|
| Ceiling Voids | No Asbestos Found |
| Underfloor Voids | Requires Inspection |

Interior**B00B - R0001 - Laundry - P**

No Asbestos

B00B - R0002 - Plant

No Asbestos

B00B - R0003 - Disabled Toilet

No Asbestos

B00B - R0004 - Home Base Store - M

No Asbestos

B00B - R0005 - Garden Store

No Asbestos

B00B - R0006 - Breakout Area

No Asbestos

B00B - R0007 - Practical Activities - M - 1hb

No Asbestos

B00B - R0008 - Home Base

No Asbestos

B00B - R0009 - Distribution Board

Note: No inspection of live electrical installation.

No Asbestos

B00B - R0010 - Practical Activities - M - 1hb

No Asbestos

B00B - R0011 - Home Base - M

No Asbestos

B00B - R0012 - Plant

No Asbestos

B00B - R0013 - Access Shower/Toilet/Change

No Asbestos

B00B - R0014 - Disabled Toilet

No Asbestos

B00B - R0015 - Home Base Store - M

No Asbestos

B00B - R0016 - Breakout Area

No Asbestos

B00B - R0017 - Home Base - M

No Asbestos

B00B - R0018 - External Movement

No Asbestos

B00B - R0019 - Practical Activities - M - 1hb

No Asbestos

B00B - R0020 - Home Base Store - M

No Asbestos

B00B - R0021 - Breakout Area

No Asbestos

| Product | Material Description | Extent | Location Reference | Material Condition | Risk Status | Control Priority |
|---------|----------------------|--------|--------------------|--------------------|-------------|------------------|
| | Sample No | | | | | Test Result |

B00C - Library - 2014 - Brick/Veneer (Brick/Veneer)**Exterior**

| | |
|------------------|---------------------|
| Ceiling Voids | No Asbestos Found |
| Underfloor Voids | Requires Inspection |

Interior**B00C - R0001 - Canteen**

No Asbestos

B00C - R0002 - Special Programs Room

No Asbestos

B00C - R0003 - Laundry - Type 3

No Asbestos

B00C - R0004 - Special Programs Store

No Asbestos

B00C - R0005 - Sports Store

No Asbestos

B00C - R0006 - Communal Space

No Asbestos

B00C - R0007 - P.E. Store

No Asbestos

B00C - R0008 - Hall Chair Store

No Asbestos

B00C - R0009 - K.L.A. Store

No Asbestos

B00C - R0010 - Communications Room

No Asbestos

B00C - R0011 - Library Office/Workroom

No Asbestos

B00C - R0012 - Reading Area

No Asbestos

B00C - R0013 - Distribution Board

Note: No inspection of live electrical installation.

No Asbestos

B00C - R0014 - Plant

No Asbestos

B00C - R0015 - External Movement

No Asbestos

B00C - R0016 - External Movement

No Asbestos

2017

| Product | Material Description | Extent | Location Reference | Material Condition | Risk Status | Control Priority |
|-----------|----------------------|--------|--------------------|--------------------|-------------|------------------|
| Sample No | | | | | Test Result | |

B00D - Support Unit (M P S) - 2014 - Brick/Veneer (Brick/Veneer)**Exterior**

| | |
|------------------|---------------------|
| Ceiling Voids | No Asbestos Found |
| Underfloor Voids | Requires Inspection |

Interior**B00D - R0001 - General Assistant/Bulk Store**

No Asbestos

B00D - R0002 - Disabled Toilet

No Asbestos

B00D - R0003 - Home Base Store - M

No Asbestos

B00D - R0004 - Breakout Area

No Asbestos

B00D - R0005 - Practical Activities - 1hb

No Asbestos

B00D - R0006 - Home Base - M

No Asbestos

B00D - R0007 - Plant

No Asbestos

B00D - R0008 - Distribution Board

Note: No inspection of live electrical installation.

No Asbestos

B00D - R0009 - Home Base - M

No Asbestos

B00D - R0010 - Practical Activities - M - 1hb

No Asbestos

B00D - R0011 - Disabled Toilet

No Asbestos

B00D - R0012 - Home Base Store - M

No Asbestos

B00D - R0013 - Home Base Store - M

No Asbestos

B00D - R0014 - Breakout Area

No Asbestos

B00D - R0015 - Breakout Area

No Asbestos

B00D - R0016 - Practical Activities - M - 1hb

No Asbestos

B00D - R0017 - Home Base - M

No Asbestos

B00D - R0018 - Practical Activities - M - 1hb

No Asbestos

B00D - R0019 - Home Base - M

No Asbestos

B00D - R0020 - Breakout Area

No Asbestos

B00D - R0021 - Home Base Store - M

No Asbestos

B00D - R0022 - Disabled Toilet

No Asbestos

B00D - R0023 - Disabled Shower/Toilet

| Product | Material Description | Extent | Location Reference | Material Condition | Risk Status | Control Priority |
|---------|----------------------|--------|--------------------|--------------------|-------------|--------------------|
| | Sample No | | | | | Test Result |

No Asbestos

B00D - R0024 - Home Base - M

No Asbestos

B00D - R0025 - Breakout Area

No Asbestos

B00D - R0026 - Home Base Store - M

No Asbestos

B00D - R0027 - Practical Activities - M - 1hb

No Asbestos

B00D - R0028 - External Movement

No Asbestos

2017

| Product | Material Description | Extent | Location Reference | Material Condition | Risk Status | Control Priority |
|-----------|----------------------|--------|--------------------|--------------------|-------------|------------------|
| Sample No | | | | | Test Result | |

Demountables

Demountable details as per the AMS records as of 15 Feb 2017.

OS 751 - D11900 - Learning Unit - ESL : Placement Date - 30/06/1995

Exterior

| | | | | |
|-------------|---------------------|------------------|--|----------|
| Landing | Compressed AC Sheet | Assumed Asbestos | | 1.2 m2 |
| Step Treads | Compressed AC Sheet | Assumed Asbestos | | 1.08 m2 |
| Eave Lining | Flat AC Sheet | Assumed Asbestos | | 11.52 m2 |

Interior

R1 - Es1

| | | | | |
|----------------|---------------|------------------|--|-------|
| End wall panel | Flat AC Sheet | Assumed Asbestos | | 18 m2 |
| Ceiling | Flat AC Sheet | Assumed Asbestos | | 36 m2 |

R2 - Es1

| | | | | |
|----------------|---------------|------------------|--|-------|
| End wall panel | Flat AC Sheet | Assumed Asbestos | | 18 m2 |
| Ceiling | Flat AC Sheet | Assumed Asbestos | | 36 m2 |

OS 501 - D12025 - Admin Staff/Principal/Deputy/Dup/Clinic : Placement Date - 30/06/1995

Exterior

| | | | | |
|-------------|---------------------|------------------|--|----------|
| Eave Lining | Flat AC Sheet | Assumed Asbestos | | 31.68 m2 |
| Landing | Compressed AC Sheet | Assumed Asbestos | | 1.2 m2 |
| Step Treads | Compressed AC Sheet | Assumed Asbestos | | 1.08 m2 |

2017

| Product | Material Description | Extent | Location Reference | Material Condition | Risk Status | Control Priority |
|--|----------------------|------------------|--------------------|--------------------|-------------|------------------|
| Sample No | | | | | Test Result | |
| Interior | | | | | | |
| R1 - Entry | | | | | | |
| End wall panel | Flat AC Sheet | Assumed Asbestos | | | | 18 m2 |
| Ceiling | Flat AC Sheet | Assumed Asbestos | | | | 25 m2 |
| R10 - Staff Toilet | | | | | | |
| Ceiling | Flat AC Sheet | Assumed Asbestos | | | | 2 m2 |
| Toilet partitions | Compressed AC Sheet | Assumed Asbestos | | | | 4 m2 |
| R11 - Cleaning Supplies | | | | | | |
| Ceiling | Flat AC Sheet | Assumed Asbestos | | | | 2 m2 |
| R12 - Handicap toilet | | | | | | |
| Ceiling | Flat AC Sheet | Assumed Asbestos | | | | 2 m2 |
| R13 - Clerk | | | | | | |
| End wall panel | Flat AC Sheet | Assumed Asbestos | | | | 18 m2 |
| Ceiling | Flat AC Sheet | Assumed Asbestos | | | | 16 m2 |
| R2 - Clinic-Waiting | | | | | | |
| Ceiling | Flat AC Sheet | Assumed Asbestos | | | | 16 m2 |
| R3 - Security Store | | | | | | |
| Ceiling | Flat AC Sheet | Assumed Asbestos | | | | 12 m2 |
| R4 - Duplicating Wookroom | | | | | | |
| Ceiling | Flat AC Sheet | Assumed Asbestos | | | | 12 m2 |
| R5 - Clerical Office | | | | | | |
| Ceiling | Flat AC Sheet | Assumed Asbestos | | | | 16 m2 |
| R6 - Staff Room | | | | | | |
| Ceiling | Flat AC Sheet | Assumed Asbestos | | | | 58 m2 |
| R7 - Deputy Principal | | | | | | |
| Ceiling | Flat AC Sheet | Assumed Asbestos | | | | 16 m2 |
| R8 - Principal | | | | | | |
| Ceiling | Flat AC Sheet | Assumed Asbestos | | | | 20 m2 |
| R9 - Staff Toilet | | | | | | |
| Toilet partitions | Compressed AC Sheet | Assumed Asbestos | | | | 4 m2 |
| Ceiling | Flat AC Sheet | Assumed Asbestos | | | | 2 m2 |
| OS 614 - D12026 - Learning Unit - Double Kindergarten : Placement Date - 30/06/1995 | | | | | | |
| Exterior | | | | | | |
| Eave Lining | Flat AC Sheet | Assumed Asbestos | | | | 28.8 m2 |
| Landing | Compressed AC Sheet | Assumed Asbestos | | | | 1.2 m2 |
| Step Treads | Compressed AC Sheet | Assumed Asbestos | | | | 1.08 m2 |

| Product | Material Description | Extent | Location Reference | Material Condition | Risk Status | Control Priority |
|--|----------------------|------------------|--------------------|--------------------|-------------|------------------|
| Sample No | | | | | Test Result | |
| Interior | | | | | | |
| R1 - Entry | | | | | | |
| End wall panel | Flat AC Sheet | Assumed Asbestos | | | | 18 m2 |
| Ceiling | Flat AC Sheet | Assumed Asbestos | | | | 8 m2 |
| R2 - Home Base Store/cupboard | | | | | | |
| Ceiling | Flat AC Sheet | Assumed Asbestos | | | | 1 m2 |
| R3 - Trainer toilet | | | | | | |
| Ceiling | Flat AC Sheet | Assumed Asbestos | | | | 1 m2 |
| R4 - Practical Activity Area | | | | | | |
| Ceiling | Flat AC Sheet | Assumed Asbestos | | | | 8 m2 |
| R5 - Home Base/kindergarten | | | | | | |
| Ceiling | Flat AC Sheet | Assumed Asbestos | | | | 146 m2 |
| R6 - Entry | | | | | | |
| Toilet partitions | Compressed AC Sheet | Assumed Asbestos | | | | 4 m2 |
| Ceiling | Flat AC Sheet | Assumed Asbestos | | | | 8 m2 |
| R7 - Home Base Store/cupboard | | | | | | |
| Ceiling | Flat AC Sheet | Assumed Asbestos | | | | 1 m2 |
| R8 - Trainer toilet | | | | | | |
| Ceiling | Flat AC Sheet | Assumed Asbestos | | | | 1 m2 |
| R9 - Practical Activity Area | | | | | | |
| Ceiling | Flat AC Sheet | Assumed Asbestos | | | | 8 m2 |
| OS 601 - D12027 - Learning Unit - Standard/Withdrawal : Placement Date - 30/06/1995 | | | | | | |
| Exterior | | | | | | |
| Step Treads | Compressed AC Sheet | Assumed Asbestos | | | | 1.08 m2 |
| Eave Lining | Flat AC Sheet | Assumed Asbestos | | | | 11.52 m2 |
| Landing | Compressed AC Sheet | Assumed Asbestos | | | | 1.2 m2 |
| Interior | | | | | | |
| R1 - Entry | | | | | | |
| End wall panel | Flat AC Sheet | Assumed Asbestos | | | | 18 m2 |
| Ceiling | Flat AC Sheet | Assumed Asbestos | | | | 8 m2 |
| R2 - General Learning Space | | | | | | |
| End wall panel | Flat AC Sheet | Assumed Asbestos | | | | 18 m2 |
| Ceiling | Flat AC Sheet | Assumed Asbestos | | | | 55 m2 |
| R3 - Store | | | | | | |
| Ceiling | Flat AC Sheet | Assumed Asbestos | | | | 10 m2 |
| OS 601 - D12028 - Learning Unit - Standard/Withdrawal : Placement Date - 30/06/1995 | | | | | | |
| Exterior | | | | | | |
| Landing | Compressed AC Sheet | Assumed Asbestos | | | | 1.2 m2 |
| Step Treads | Compressed AC Sheet | Assumed Asbestos | | | | 1.08 m2 |
| Eave Lining | Flat AC Sheet | Assumed Asbestos | | | | 11.52 m2 |

| Product | Material Description | Extent | Location Reference | Material Condition | Risk Status | Control Priority |
|---|----------------------|------------------|--------------------|--------------------|-------------|------------------|
| Sample No | | | | | Test Result | |
| Interior | | | | | | |
| R1 - Entry | | | | | | |
| End wall panel | Flat AC Sheet | Assumed Asbestos | | | | 18 m2 |
| Ceiling | Flat AC Sheet | Assumed Asbestos | | | | 8 m2 |
| R2 - General Learning Space | | | | | | |
| End wall panel | Flat AC Sheet | Assumed Asbestos | | | | 18 m2 |
| Ceiling | Flat AC Sheet | Assumed Asbestos | | | | 55 m2 |
| R3 - Store | | | | | | |
| Ceiling | Flat AC Sheet | Assumed Asbestos | | | | 10 m2 |
| OS 601 - D12029 - Learning Unit - Standard/Withdrawal : Placement Date - 30/06/1995 | | | | | | |
| Exterior | | | | | | |
| Eave Lining | Flat AC Sheet | Assumed Asbestos | | | | 11.52 m2 |
| Landing | Compressed AC Sheet | Assumed Asbestos | | | | 1.2 m2 |
| Step Treads | Compressed AC Sheet | Assumed Asbestos | | | | 1.08 m2 |
| Interior | | | | | | |
| R1 - Entry | | | | | | |
| End wall panel | Flat AC Sheet | Assumed Asbestos | | | | 18 m2 |
| Ceiling | Flat AC Sheet | Assumed Asbestos | | | | 8 m2 |
| R2 - General Learning Space | | | | | | |
| End wall panel | Flat AC Sheet | Assumed Asbestos | | | | 18 m2 |
| Ceiling | Flat AC Sheet | Assumed Asbestos | | | | 55 m2 |
| R3 - Store | | | | | | |
| Ceiling | Flat AC Sheet | Assumed Asbestos | | | | 10 m2 |
| NS 120 - D12030 - Learning Unit - Single Primary H/Cap PAA : Placement Date - 30/06/1995 | | | | | | |
| Exterior | | | | | | |
| No Asbestos Found. | | | | | | |
| Interior | | | | | | |
| R1 - Home Base-I.O. | | | | | | |
| No Asbestos Found. | | | | | | |
| R2 - Toilets-Disabled | | | | | | |
| No Asbestos Found. | | | | | | |
| R3 - Home Base Store-I.O. | | | | | | |
| No Asbestos Found. | | | | | | |
| R4 - Practical Activity Area | | | | | | |
| No Asbestos Found. | | | | | | |
| R5 - Entry | | | | | | |
| No Asbestos Found. | | | | | | |
| OS 831 - D12031 - Girls Shower/Change/Toilet : Placement Date - 30/06/1995 | | | | | | |
| Exterior | | | | | | |
| Eave Lining | Flat AC Sheet | Assumed Asbestos | | | | 14.4 m2 |
| Landing | Compressed AC Sheet | Assumed Asbestos | | | | 1.2 m2 |
| Step Treads | Compressed AC Sheet | Assumed Asbestos | | | | 1.08 m2 |

| Product | Material Description | Extent | Location Reference | Material Condition | Risk Status | Control Priority |
|--|----------------------|------------------|--------------------|--------------------|-------------|------------------|
| Sample No | | | | | Test Result | |
| Interior | | | | | | |
| R1 - Change Room | | | | | | |
| End wall panel | Flat AC Sheet | Assumed Asbestos | | | | 18 m2 |
| Ceiling | Flat AC Sheet | Assumed Asbestos | | | | 55 m2 |
| R2 - Staff Room | | | | | | |
| End wall panel | Flat AC Sheet | Assumed Asbestos | | | | 18 m2 |
| Ceiling | Flat AC Sheet | Assumed Asbestos | | | | 11 m2 |
| R3 - Toilets-Girls | | | | | | |
| Toilet partitions | Compressed AC Sheet | Assumed Asbestos | | | | 4 m2 |
| Ceiling | Flat AC Sheet | Assumed Asbestos | | | | 18 m2 |
| R4 - Hot water unit | | | | | | |
| Ceiling | Flat AC Sheet | Assumed Asbestos | | | | 2 m2 |
| R5 - Area in front of staff room | | | | | | |
| Ceiling | Flat AC Sheet | Assumed Asbestos | | | | 5 m2 |
| OS 620 - D13354 - Single Learning Unit - H/Cap : Placement Date - 27/05/2015 | | | | | | |
| Exterior | | | | | | |
| Eave Lining | Flat AC Sheet | Assumed Asbestos | | | | 11.52 m2 |
| Landing | Compressed AC Sheet | Assumed Asbestos | | | | 1.2 m2 |
| Step Treads | Compressed AC Sheet | Assumed Asbestos | | | | 1.08 m2 |
| Interior | | | | | | |
| R1 - Entry | | | | | | |
| End wall panel | Flat AC Sheet | Assumed Asbestos | | | | 18 m2 |
| Ceiling | Flat AC Sheet | Assumed Asbestos | | | | 8 m2 |
| R2 - Home Base-I.O. | | | | | | |
| End wall panel | Flat AC Sheet | Assumed Asbestos | | | | 18 m2 |
| Ceiling | Flat AC Sheet | Assumed Asbestos | | | | 55 m2 |
| R3 - Disabled Shower/laundry | | | | | | |
| Toilet partitions | Compressed AC Sheet | Assumed Asbestos | | | | 2 m2 |
| Ceiling | Flat AC Sheet | Assumed Asbestos | | | | 10 m2 |
| OS 620 - D13419 - Single Learning Unit - H/Cap : Placement Date - 27/05/2015 | | | | | | |
| Note: This refurbished demountable may have asbestos present in remnant mastic in window frames. | | | | | | |
| Exterior | | | | | | |
| No Asbestos Found. | | | | | | |
| Interior | | | | | | |
| R1 - Entry | | | | | | |
| No Asbestos Found. | | | | | | |
| R2 - Home Base-I.O. | | | | | | |
| No Asbestos Found. | | | | | | |
| R3 - Disabled Shower/laundry | | | | | | |
| No Asbestos Found. | | | | | | |

| Product | Material Description | Extent | Location Reference | Material Condition | Risk Status | Control Priority |
|-----------|----------------------|--------|--------------------|--------------------|-------------|------------------|
| Sample No | | | | | Test Result | |

Listing of Electronic Attachments as of 22/03/2017

There are no asbestos related file attachment(s) for this school.

2017