

Asbestos Register

(Hazardous Materials and Risk Assessment)

School : Wollongong Public School (3954)
Region : Illawarra and South East
State Electorate : Wollongong
Local Government Area : Wollongong

Initial Survey : Noel Arnold & Associates : 21 - Mar - 2008
Reviewed By : AECOM : 18 - Jun - 2015

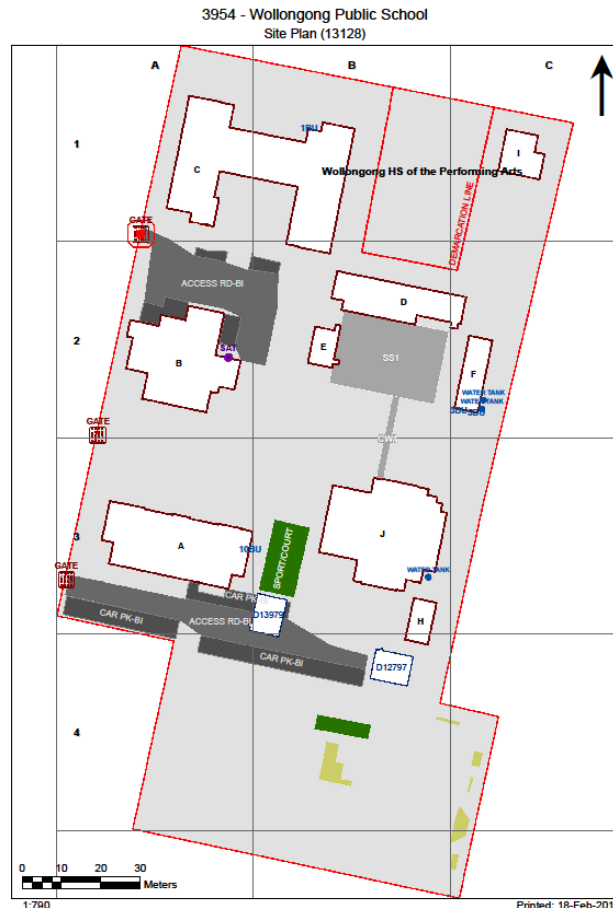

2017

Product	Material Description	Extent	Location Reference	Material Condition	Risk Status	Control Priority
Sample No				Test Result		

B00A - General Learning - 1884 - Brick/Block (Brick/Block)

Exterior

Eaves Linings	Flat AC Sheeting	50m2	Throughout, Upper portion, Middle portion	Good Condition (1)	Low (1)	Low Priority (2-3)
Assumed Asbestos - Height Restriction						
Ceiling Voids	Non Accessible Area - Height Restriction					
Underfloor Voids	Non Accessible Area - Area inaccessible due to storage.					

Interior

B00A - R0001 - Movement

No Asbestos

B00A - R0002 - Cleaning Supplies

Non Accessible

B00A - R0003 - Movement

No Asbestos

B00A - R0004 - Other-Vacant

Ceiling Structures/Linings	Flat AC Sheeting	13m2	Throughout	Good Condition (1)	Low (1)	Low Priority (2-3)
Assumed Asbestos - Height Restriction						

B00A - R0005 - General Storeroom

Ceiling Structures/Linings	Flat AC Sheeting	18m2	Throughout	Good Condition (1)	Low (1)	Low Priority (2-3)
Assumed Asbestos - Height Restriction						

B00A - R0006 - Home Base

Ceiling Structures/Linings	Flat AC Sheeting	67m2	Throughout	Good Condition (1)	Low (1)	Low Priority (2-3)
Assumed Asbestos - Height Restriction						

B00A - R0007 - Withdrawal Space - 1hb

Ceiling Structures/Linings	Flat AC Sheeting	3m2	Throughout	Good Condition (1)	Low (1)	Low Priority (2-3)
Assumed Asbestos - Height Restriction						

B00A - R0008 - Practical Activities - 1hb

Ceiling Structures/Linings	Flat AC Sheeting	17m2	Throughout	Good Condition (1)	Low (1)	Low Priority (2-3)
Assumed Asbestos - Height Restriction						

B00A - R0009 - Security Store

Ceiling Structures/Linings	Flat AC Sheeting	13m2	Throughout	Good Condition (1)	Low (1)	Low Priority (2-3)
Assumed Asbestos - Height Restriction						

B00A - R0010 - Cleaning Distributed Store

No Asbestos

B00A - R0011 - Movement

No Asbestos

B00A - R0012 - General Storeroom

No Asbestos

B00A - R0013 - Staff Toilet

No Asbestos

B00A - R0014 - Home Base

No Asbestos

B00A - R0015 - Home Base

No Asbestos

B00A - R0016 - Home Base

No Asbestos

Product	Material Description	Extent	Location Reference	Material Condition	Risk Status	Control Priority
Sample No				Test Result		
B00A - R0017 - Home Base						
No Asbestos						
B00A - R0018 - Movement						
Ceiling Structures/Linings	Flat AC Sheeting	64m2	Throughout	Good Condition (1)	Low (1)	Low Priority (2-3)
Assumed Asbestos - Height Restriction						
B00A - R0019 - Movement						
No Asbestos						
B00A - R0020 - Stairs						
Recently Modified Space	Requires Inspection					
B00A - R0021 - Stairs						
Recently Modified Space	Requires Inspection					
B00A - R0022 - Stairs						
Recently Modified Space	Requires Inspection					
B00A - R1001 - Cleaning Distributed Store						
Ceiling Structures/Linings	Flat AC Sheeting	3m2	Throughout	Good Condition (1)	Low (1)	Low Priority (2-3)
Assumed Asbestos - Height Restriction						
B00A - R1002 - Movement						
Ceiling Structures/Linings	Flat AC Sheeting	3m2	Throughout	Good Condition (1)	Low (1)	Low Priority (2-3)
Assumed Asbestos - Height Restriction						
B00A - R1003 - Movement						
Ceiling Structures/Linings	Flat AC Sheeting	4m2	Throughout	Good Condition (1)	Low (1)	Low Priority (2-3)
Assumed Asbestos - Height Restriction						
Wall Linings Internal	Flat AC Sheeting	4m2	East, Upper portion, Middle portion	Good Condition (1)	Low (1)	Low Priority (2-3)
	3954/B00A/R1013/Wall Linings Internal/S4					Chrysotile (white asbestos)
B00A - R1004 - General Storeroom						
Ceiling Structures/Linings	Flat AC Sheeting	7m2	Throughout	Good Condition (1)	Low (1)	Low Priority (2-3)
Assumed Asbestos - Height Restriction						
Floor Coverings Res/Textile	Vinyl Tiles	7m2	Throughout	Good Condition (1)	Low (1)	Low Priority (2-3)
	3954/B00A/R1016/Floor Coverings Res/Textile/S5					Chrysotile (white asbestos)
B00A - R1005 - Home Base						
Ceiling Structures/Linings	Flat AC Sheeting	50m2	Throughout	Good Condition (1)	Low (1)	Low Priority (2-3)
Assumed Asbestos - Height Restriction						
B00A - R1006 - Home Base						
Ceiling Structures/Linings	Flat AC Sheeting	50m2	Throughout	Good Condition (1)	Low (1)	Low Priority (2-3)
Assumed Asbestos - Height Restriction						
B00A - R1007 - Home Base						
Ceiling Structures/Linings	Flat AC Sheeting	50m2	Throughout	Good Condition (1)	Low (1)	Low Priority (2-3)
Assumed Asbestos - Height Restriction						
B00A - R1008 - Home Base						
Ceiling Structures/Linings	Flat AC Sheeting	50m2	Throughout	Good Condition (1)	Low (1)	Low Priority (2-3)
Assumed Asbestos - Height Restriction						
B00A - R1012 - Movement						
Ceiling Structures/Linings	Flat AC Sheeting	11m2	Throughout	Good Condition (1)	Low (1)	Low Priority (2-3)
Assumed Asbestos - Height Restriction						

Product	Material Description	Extent	Location Reference	Material Condition	Risk Status	Control Priority
Sample No				Test Result		
Wall Linings Internal	Flat AC Sheeting	2m2	North, Middle portion, Lower portion	Good Condition (1)	Low (1)	Low Priority (2-3)
	3954/B00A/R1013/Wall Linings Internal/S4				Chrysotile (white asbestos)	
In-fill-panel	Flat AC Sheeting	1m	East, Upper portion	Good Condition (1)	Low (1)	Low Priority (2-3)
	Assumed Asbestos - Height Restriction					
B00A - R1013 - General Storeroom						
Ceiling Structures/Linings	Flat AC Sheeting	9m2	Throughout	Good Condition (1)	Low (1)	Low Priority (2-3)
	Assumed Asbestos - Height Restriction					
Wall Linings Internal	Flat AC Sheeting	10m2	South, East	Good Condition (1)	Low (1)	Low Priority (2-3)
	3954/B00A/R1013/Wall Linings Internal/S4				Chrysotile (white asbestos)	
B00A - R1014 - Movement						
Ceiling Structures/Linings	Flat AC Sheeting	4m2	Throughout	Good Condition (1)	Low (1)	Low Priority (2-3)
	Assumed Asbestos - Height Restriction					
Wall Linings Internal	Flat AC Sheeting	8m2	West	Good Condition (1)	Low (1)	Low Priority (2-3)
	3954/B00A/R1013/Wall Linings Internal/S4				Chrysotile (white asbestos)	
B00A - R1015 - Movement						
Ceiling Structures/Linings	Flat AC Sheeting	5m2	Throughout	Good Condition (1)	Low (1)	Low Priority (2-3)
	Assumed Asbestos - Height Restriction					
B00A - R1016 - General Storeroom						
Ceiling Structures/Linings	Flat AC Sheeting	10m2	Throughout	Good Condition (1)	Low (1)	Low Priority (2-3)
	Assumed Asbestos - Height Restriction					
Wall Linings Internal	Flat AC Sheeting	4m2	West, Upper portion, Middle portion	Good Condition (1)	Low (1)	Low Priority (2-3)
	3954/B00A/R1013/Wall Linings Internal/S4				Chrysotile (white asbestos)	
Floor Coverings Res/Textile	Vinyl Tiles	10m2	Throughout	Good Condition (1)	Low (1)	Low Priority (2-3)
	3954/B00A/R1016/Floor Coverings Res/Textile/S5				Chrysotile (white asbestos)	
B00A - R1017 - Home Base						
Recently Modified Space	Requires Inspection					
B00A - R1018 - Practical Activities						
Recently Modified Space	Requires Inspection					
B00A - R1019 - Computer Room						
Recently Modified Space	Requires Inspection					
B00A - R1020 - Movement						
Recently Modified Space	Requires Inspection					
B00A - R1021 - Stairs						
Recently Modified Space	Requires Inspection					
B00A - R1022 - Stairs						
Recently Modified Space	Requires Inspection					
B00A - R9001 - Movement						
No Asbestos						
B00A - R9002 - General Storeroom						
No Asbestos						
B00A - R9003 - Handwashing Facilities						
No Asbestos						
B00A - R9004 - Kiln Room						
No Asbestos						
B00A - R9005 - Craft Store						
No Asbestos						

Product	Material Description	Extent	Location Reference	Material Condition	Risk Status	Control Priority
Sample No					Test Result	
	No Asbestos					
	B00A - R9006 - Sports Store					
	No Asbestos					
	B00A - R9007 - Staff Toilet					
	No Asbestos					
	B00A - R9008 - General Storeroom					
	No Asbestos					
	B00A - R9009 - General Assistant/Bulk Store					
	No Asbestos					
	B00A - R9010 - General Assistant/Bulk Store					
	No Asbestos					
	B00A - R9011 - General Assistants					
	Non Accessible					
	B00A - R9012 - Stairs					
	Recently Modified Space	Requires Inspection				

2017

Product	Material Description	Extent	Location Reference	Material Condition	Risk Status	Control Priority
Sample No					Test Result	

B00B - Administration/Staff Facilities - 1950 - Brick/Block (Brick/Block)

Exterior

Eaves Linings	Flat AC Sheeting	50m2	Throughout, Upper portion, Middle portion	Good Condition (1)	Low (1)	Low Priority (2-3)
	3954/B00B/Eaves Linings/S2			Chrysotile (white asbestos) , Amosite (brown asbestos)		
Gable Ends	Flat AC Sheeting	6m2	West	Good Condition (1)	Low (1)	Low Priority (2-3)
	3954/B00B/Eaves Linings/S2			Chrysotile (white asbestos) , Amosite (brown asbestos)		
Underfloor Voids - Slab on Ground	No Asbestos Found					
Ceiling Voids	No Asbestos Found					

Interior

B00B - R0001 - Deputy Principal

No Asbestos

B00B - R0002 - Movement

No Asbestos

B00B - R0003 - Staff Room

No Asbestos

B00B - R0004 - Movement

No Asbestos

B00B - R0005 - Staff Toilet

No Asbestos

B00B - R0006 - Cleaning Distributed Store

No Asbestos

B00B - R0007 - Staff Toilet

No Asbestos

B00B - R0008 - General Storeroom

No Asbestos

B00B - R0009 - Movement

Ceiling Structures/Linings	Flat AC Sheeting	3m2	Throughout	Good Condition (1)	Low (1)	Low Priority (2-3)
	3954/B00B/Eaves Linings/S2			Chrysotile (white asbestos) , Amosite (brown asbestos)		

B00B - R0010 - Duplicating Workroom

No Asbestos

B00B - R0011 - Security Store

No Asbestos

B00B - R0012 - Staff Room Annexe

No Asbestos

B00B - R0013 - Clerical Office/Workroom

Wall Linings Internal	Flat AC Sheeting					No Asbestos Detected
	3954/B00B/R0013/Wall Linings Internal/S1					

B00B - R0014 - Clerical Office

No Asbestos

B00B - R0015 - Entry Vestibule

No Asbestos

B00B - R0016 - Movement

No Asbestos

B00B - R0017 - Interview

No Asbestos

Product	Material Description	Extent	Location Reference	Material Condition	Risk Status	Control Priority
Sample No					Test Result	
B00B - R0018 - Movement						
No Asbestos						
B00B - R0019 - Movement						
No Asbestos						
B00B - R0020 - Sick Bay - Shower/Toilet						
No Asbestos						
B00B - R0021 - Sick Bay						
No Asbestos						
B00B - R0022 - Principal						
No Asbestos						
B00B - R0023 - Deputy Principal						
No Asbestos						
B00B - R0024 - Movement						
Wall Linings Internal	Flat AC Sheeting					
	3954/B00B/R0024/Wall Linings Internal/S3					No Asbestos Detected
B00B - R0025 - Movement						
No Asbestos						
B00B - R9001 - General Assistant/Bulk Store						
No Asbestos						

2017

Product	Material Description	Extent	Location Reference	Material Condition	Risk Status	Control Priority
Sample No					Test Result	

B00C - General Learning/Support Unit - 1925 - Brick/Block (Brick/Block)**Exterior**

Eaves Linings	Flat AC Sheeting	16m2	North	Good Condition (1)	Low (1)	Low Priority (2-3)
---------------	------------------	------	-------	--------------------	---------	--------------------

Assumed Asbestos - Height Restriction

Underfloor Voids	Non Accessible Area - Area inaccessible - limited access due to low clearance.					
------------------	---	--	--	--	--	--

Ceiling Voids	Non Accessible Area - Height Restriction					
---------------	---	--	--	--	--	--

Interior**B00C - R0001 - Home Base**

No Asbestos

B00C - R0002 - Home Base

Heater Backing Board	Flat AC Sheeting					
	3954/B00C/R0002/Heater Backing Board/S17					No Asbestos Detected

B00C - R0003 - Staff Room

Floor Coverings Res/Textile	Vinyl Tiles	25m2	Throughout	Good Condition (1)	Low (1)	Low Priority (2-3)
-----------------------------	-------------	------	------------	--------------------	---------	--------------------

3954/B00C/R0003/Floor Coverings Res/Textile/S16 **Chrysotile (white asbestos)****B00C - R0004 - Staff Room Annexe**

Flue Pipe	Fibre Cement Pipe	1m	East, Middle portion	Good Condition (1)	Low (1)	Low Priority (2-3)
-----------	-------------------	----	----------------------	--------------------	---------	--------------------

3954/B00C/R0005/Flue Pipe/S15 **Chrysotile (white asbestos) , Amosite (brown asbestos)**

Floor Coverings Res/Textile	Vinyl Tiles	15m2	Throughout	Good Condition (1)	Low (1)	Low Priority (2-3)
-----------------------------	-------------	------	------------	--------------------	---------	--------------------

3954/B00C/R0003/Floor Coverings Res/Textile/S16 **Chrysotile (white asbestos)****B00C - R0005 - Special Programs Room**

Flue Pipe	Fibre Cement Pipe	1m	West, Middle portion	Good Condition (1)	Low (1)	Low Priority (2-3)
-----------	-------------------	----	----------------------	--------------------	---------	--------------------

3954/B00C/R0005/Flue Pipe/S15 **Chrysotile (white asbestos) , Amosite (brown asbestos)****B00C - R0006 - Staff Room Annexe**

No Asbestos

B00C - R0007 - General Storeroom

No Asbestos

B00C - R0008 - Movement

No Asbestos

B00C - R0009 - Personal Effects Storage

No Asbestos

B00C - R0010 - Personal Effects Storage

No Asbestos

B00C - R0011 - Staff Room Annexe

No Asbestos

B00C - R0012 - Movement

No Asbestos

B00C - R0013 - Home Base

In-fill-panel	Flat AC Sheeting					
	3954/B00C/R0013/In-fill-panel/S18					No Asbestos Detected

B00C - R0014 - Movement

No Asbestos

B00C - R0015 - Movement

Ceiling Structures/Linings	Flat AC Sheeting	5m2	Throughout	Good Condition (1)	Low (1)	Low Priority (2-3)
----------------------------	------------------	-----	------------	--------------------	---------	--------------------

Assumed Asbestos - Height Restriction

Product	Material Description	Extent	Location Reference	Material Condition	Risk Status	Control Priority
Sample No					Test Result	
B00C - R0016 - Museum						
No Asbestos						
B00C - R0017 - Home Base - P						
In-fill-panel	Flat AC Sheeting					
	3954/B00C/R0013/In-fill-panel/S18					No Asbestos Detected
B00C - R0018 - Movement						
No Asbestos						
B00C - R0019 - Movement						
No Asbestos						
B00C - R0020 - Other-Community Use						
No Asbestos						
B00C - R0021 - Movement						
No Asbestos						
B00C - R0022 - Staff Room Annexe						
No Asbestos						
B00C - R0023 - Withdrawal Space - 1hb						
No Asbestos						
B00C - R0024 - Out Of School Hours Care Centre						
No Asbestos						
B00C - R0025 - Out Of School Hours Care Centre						
No Asbestos						
B00C - R0026 - Movement						
No Asbestos						
B00C - R0027 - Movement						
No Asbestos						
B00C - R0028 - Home Base - P						
No Asbestos						
B00C - R0029 - Practical Activities - P - 1hb						
No Asbestos						
B00C - R0030 - Staff Room Annexe						
No Asbestos						
B00C - R0031 - Toilet - P						
Wall Linings Internal	Flat AC Sheeting	10m2	Throughout	Good Condition (1)	Low (1)	Low Priority (2-3)
	3954/B00C/R0033/Wall Linings Internal/S19					Chrysotile (white asbestos)
Ceiling Structures/Linings	Flat AC Sheeting	3m2	Throughout	Good Condition (1)	Low (1)	Low Priority (2-3)
	3954/B00C/R0033/Ceiling Structures/Linings/S20					Chrysotile (white asbestos)
B00C - R0032 - Staff Room						
No Asbestos						
B00C - R0033 - Staff Toilet						
Wall Linings Internal	Flat AC Sheeting	11m2	Throughout	Good Condition (1)	Low (1)	Low Priority (2-3)
	3954/B00C/R0033/Wall Linings Internal/S19					Chrysotile (white asbestos)
Ceiling Structures/Linings	Flat AC Sheeting	4m2	Throughout	Good Condition (1)	Low (1)	Low Priority (2-3)
	3954/B00C/R0033/Ceiling Structures/Linings/S20					Chrysotile (white asbestos)
B00C - R0034 - Staff Kitchen						
No Asbestos						

Product	Material Description	Extent	Location Reference	Material Condition	Risk Status	Control Priority
Sample No				Test Result		

B00D - Library - 1930 - Timber (Timber)

Exterior

Eaves Linings	Flat AC Sheeting 3954/B00D/Eaves Linings/S13	92m2	Throughout, Upper portion, Middle portion	Good Condition (1)	Low (1)	Low Priority (2-3)
				Chrysotile (white asbestos) , Amosite (brown asbestos)		
Upstand Panel	Flat AC Sheeting 3954/B00D/Upstand Panel/S14	4m2	East, West, Upper portion	Good Condition (1)	Low (1)	Low Priority (2-3)
				Chrysotile (white asbestos) , Amosite (brown asbestos)		
Underfloor Voids	No Asbestos Found					
Ceiling Voids	No Asbestos Found					

Interior

B00D - R0001 - Reading Area

No Asbestos

B00D - R0002 - Reading Area

No Asbestos

B00D - R0003 - Library Office/Workroom

No Asbestos

B00D - R0004 - Movement

No Asbestos

B00D - R0005 - Movement

No Asbestos

B00D - R0006 - Movement

No Asbestos

B00D - R0007 - Movement

No Asbestos

B00D - R9001 - General Storeroom

No Asbestos

2017

Product	Material Description	Extent	Location Reference	Material Condition	Risk Status	Control Priority
Sample No					Test Result	

B00E - Pupil Facilities - 1950 - Timber (Timber)

Exterior

Underfloor Voids	No Asbestos Found
Ceiling Voids	No Asbestos Found

Interior

B00E - R0001 - Canteen

Wall Linings Internal	Flat AC Sheeting	14m2	North, South, West, Upper portion	Good Condition (1)	Low (1)	Low Priority (2-3)
3954/B00E/R0001/Wall Linings Internal/S12				Chrysotile (white asbestos) , Amosite (brown asbestos)		

B00E - R0002 - Canteen Office/Store

Wall Linings Internal	Flat AC Sheeting	4m2	South, West, Upper portion	Good Condition (1)	Low (1)	Low Priority (2-3)
3954/B00E/R0001/Wall Linings Internal/S12				Chrysotile (white asbestos) , Amosite (brown asbestos)		

B00E - R0003 - Movement

Wall Linings Internal	Flat AC Sheeting	3m2	North, South, Upper portion	Good Condition (1)	Low (1)	Low Priority (2-3)
3954/B00E/R0001/Wall Linings Internal/S12				Chrysotile (white asbestos) , Amosite (brown asbestos)		

B00E - R0004 - Movement

No Asbestos

B00E - R0005 - Movement

No Asbestos

2017

Product	Material Description	Extent	Location Reference	Material Condition	Risk Status	Control Priority
Sample No				Test Result		

B00F - Pupil Facilities - 1950 - Brick/Block (Brick/Block)**Exterior**

Eaves Linings	Flat AC Sheeting	60m2	Throughout	Minimal Damage (2)	Low (1)	Low Priority (2-3)
	3954/B00F/Eaves Linings/S7			Chrysotile (white asbestos) , Amosite (brown asbestos)		
Privacy Screens	Flat AC Sheeting					No Asbestos Detected
	3954/B00F/Privacy Screens/S8					
Underfloor Voids - Slab on Ground	No Asbestos Found					
Ceiling Voids	No Asbestos Found					

Interior**B00F - R0001 - Toilets - Girls**

Ceiling Structures/Linings	Flat AC Sheeting	30m2	Throughout	Good Condition (1)	Low (1)	Low Priority (2-3)
	3954/B00F/R0001/Ceiling Structures/Linings/S9			Chrysotile (white asbestos) , Amosite (brown asbestos)		

B00F - R0002 - Staff Toilet

Ceiling Structures/Linings	Flat AC Sheeting	3m2	Throughout	Good Condition (1)	Low (1)	Low Priority (2-3)
	3954/B00F/R0001/Ceiling Structures/Linings/S9			Chrysotile (white asbestos) , Amosite (brown asbestos)		

Incinerette	Encapsulated Insulation material within unit	1Unit(s)	West, Middle portion	Friable Asbestos (5)	Low (1)	Low Priority (2-3)
	Assumed Asbestos - Area inaccessible material					

Flue Pipe	Fibre Cement Pipe	2m	West, Upper portion, Middle portion	Good Condition (1)	Low (1)	Low Priority (2-3)
	3954/B00F/R0002/Flue Pipe/S11			Chrysotile (white asbestos)		

B00F - R0003 - Toilets - Girls

Ceiling Structures/Linings	Flat AC Sheeting	20m2	Throughout	Good Condition (1)	Low (1)	Low Priority (2-3)
	3954/B00F/R0001/Ceiling Structures/Linings/S9			Chrysotile (white asbestos) , Amosite (brown asbestos)		

B00F - R0004 - Staff Toilet

Ceiling Structures/Linings	Flat AC Sheeting	2.5m2	Throughout	Good Condition (1)	Low (1)	Low Priority (2-3)
	3954/B00F/R0001/Ceiling Structures/Linings/S9			Chrysotile (white asbestos) , Amosite (brown asbestos)		

B00F - R0005 - Sports Store

Ceiling Structures/Linings	Flat AC Sheeting	23m2	Throughout	Good Condition (1)	Low (1)	Low Priority (2-3)
	3954/B00F/R0001/Ceiling Structures/Linings/S9			Chrysotile (white asbestos) , Amosite (brown asbestos)		

B00F - R0006 - Toilets - Boys

Ceiling Structures/Linings	Flat AC Sheeting	18m2	Throughout	Good Condition (1)	Low (1)	Low Priority (2-3)
	3954/B00F/R0001/Ceiling Structures/Linings/S9			Chrysotile (white asbestos) , Amosite (brown asbestos)		

Product	Material Description	Extent	Location Reference	Material Condition	Risk Status	Control Priority
Sample No					Test Result	

B00H - Pupil Facilities - 1950 - Brick/Block (Brick/Block)

Exterior

Eaves Linings	Flat AC Sheeting	22m2	Throughout	Minimal Damage (2)	Low (1)	Low Priority (2-3)
	3954/B00H/Eaves Linings/S6				Chrysotile (white asbestos) , Amosite (brown asbestos)	
Ceiling Voids	No Asbestos Found					
Underfloor Voids - Slab on Ground	No Asbestos Found					

Interior

B00H - R0001 - Sports Store

No Asbestos

B00H - R0002 - Sports Store

No Asbestos

2017

Product	Material Description	Extent	Location Reference	Material Condition	Risk Status	Control Priority
Sample No					Test Result	

B001 - Other-Community Use - 1970 - Brick/Veneer (Brick/Veneer)**Exterior**

Eaves Linings	Flat AC Sheeting 3954/B001/Eaves Linings/S21					No Asbestos Detected
Gable Verge Lining	Flat AC Sheeting 3954/B001/Eaves Linings/S21					No Asbestos Detected
Underfloor Voids - Slab on Ground	No Asbestos Found					
Ceiling Voids - Raked Ceiling	Non Accessible Area - Area inaccessible					

Interior**B001 - R0001 - Dental Clinic**

No Asbestos

B001 - R0002 - Dental Clinic

No Asbestos

B001 - R0003 - Staff Room

No Asbestos

B001 - R0004 - Staff Kitchen

No Asbestos

B001 - R0005 - General Storeroom

Wall Linings Internal	Flat AC Sheeting 3954/B001/R0005/Wall Linings Internal/S23					No Asbestos Detected
-----------------------	---	--	--	--	--	----------------------

B001 - R0006 - Staff Toilet

No Asbestos

B001 - R0007 - Clerical Office

No Asbestos

B001 - R0008 - Dental Clinic

No Asbestos

B001 - R0009 - Toilets - Boys/Girls

No Asbestos

B001 - R0010 - Dental Clinic

No Asbestos

B001 - R0011 - Movement

No Asbestos

B001 - R0012 - Movement

No Asbestos

B001 - R0013 - Distribution Board

Note: No inspection of live electrical installation.

No Asbestos

B001 - R0014 - Dental Clinic

No Asbestos

B001 - R0015 - Cleaning Distributed Store

Wall Linings Internal	Flat AC Sheeting 3954/B001/R0005/Wall Linings Internal/S23					No Asbestos Detected
-----------------------	---	--	--	--	--	----------------------

B001 - R0016 - Movement

Ceiling Structures/Linings	Flat AC Sheeting 3954/B001/R0017/Ceiling Structures/Linings/S22					No Asbestos Detected
----------------------------	--	--	--	--	--	----------------------

B001 - R0017 - Movement

Ceiling Structures/Linings	Flat AC Sheeting 3954/B001/R0017/Ceiling Structures/Linings/S22					No Asbestos Detected
----------------------------	--	--	--	--	--	----------------------

Product	Material Description	Extent	Location Reference	Material Condition	Risk Status	Control Priority
Sample No					Test Result	

B00J - Pupil Facilities/Multi Purpose Facilities - 2010 - Brick/Veneer (Brick/Veneer)

Exterior

Ceiling Voids	No Asbestos Found
Underfloor Voids	No Asbestos Found

Interior

B00J - R0001 - Communal Space

No Asbestos

B00J - R0002 - Raised Platform

No Asbestos

B00J - R0003 - Communal/Performance Store

No Asbestos

B00J - R0004 - Movement

No Asbestos

B00J - R0005 - P.E. Store

No Asbestos

B00J - R0006 - Toilet - Lobby

No Asbestos

B00J - R0007 - Toilets - Boys

No Asbestos

B00J - R0008 - Chair Storeroom

No Asbestos

B00J - R0009 - Movement

No Asbestos

B00J - R0010 - Cleaning Distributed Store

No Asbestos

B00J - R0011 - Toilet - Lobby

No Asbestos

B00J - R0012 - Toilets - Girls

No Asbestos

B00J - R0013 - Sound Cupboard

No Asbestos

B00J - R0014 - Access Shower/Toilet/Change

No Asbestos

B00J - R0015 - Main Switch Board

No Asbestos

B00J - R0016 - Plant

No Asbestos

B00J - R0017 - External Movement

No Asbestos

B00J - R0018 - Covered Outdoor Learning Area

No Asbestos

B00J - R0019 - Movement

No Asbestos

B00J - R0020 - Movement

No Asbestos

B00J - R0021 - Ramp

No Asbestos

B00J - R0022 - External Movement

No Asbestos

B00J - R0023 - External Movement

Product	Material Description	Extent	Location Reference	Material Condition	Risk Status	Control Priority
	Sample No					Test Result

No Asbestos

B00J - R0024 - External Movement

No Asbestos

2017

Product	Material Description	Extent	Location Reference	Material Condition	Risk Status	Control Priority
Sample No					Test Result	

Demountables

Demountable details as per the AMS records as of 15 Feb 2017.

OS 602 - D12788 - Learning Unit - Standard With P.A.A. : Placement Date - 22/01/2011

Exterior

No Asbestos Found.

Interior

R1 - Learning space/withdrawal/entry

No Asbestos Found.

R2 - Home Base Store

No Asbestos Found.

OS 603 - D12797 - Learning Unit - Standard With P.A.A. A/C : Placement Date - 16/03/2012

Note: This refurbished demountable may have asbestos present in remnant mastic in window frames.

Exterior

No Asbestos Found.

Interior

R1 - Learning space/withdrawal/entry

No Asbestos Found.

R2 - Home Base Store

No Asbestos Found.

OS 602 - D13979 - Learning Unit - Standard With P.A.A. : Placement Date - 17/01/2012

Exterior

No Asbestos Found.

Interior

R1 - Learning space/withdrawal/entry

No Asbestos Found.

R2 - Home Base Store

No Asbestos Found.

2017

Product	Material Description	Extent	Location Reference	Material Condition	Risk Status	Control Priority
Sample No					Test Result	

Listing of Electronic Attachments as of 22/03/2017

There are no asbestos related file attachment(s) for this school.

2017