

Asbestos Register

(Hazardous Materials and Risk Assessment)

School : Wye Public School (3522)
Region : Hunter/Central Coast
State Electorate : Lake Macquarie
Local Government Area : Lake Macquarie

Initial Survey : Noel Arnold & Associates : 09 - Oct - 2015
Reviewed By : AECOM : 09 - Oct - 2015

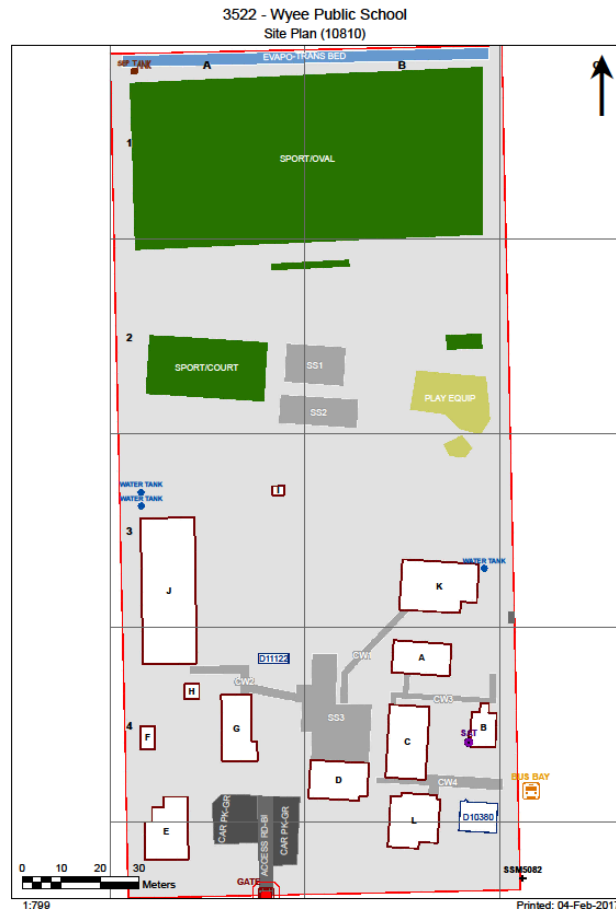

2017

| Product | Material Description | Extent | Location Reference | Material Condition | Risk Status | Control Priority |
|-----------|----------------------|--------|--------------------|--------------------|-------------|------------------|
| Sample No | | | | | Test Result | |

B00A - General Learning - 1967 - Timber (Timber)

Exterior

| | | | | | | |
|-----------------------------------|---|--|--|--|--|-----------------------------|
| Eaves Linings | Flat AC Sheeting 3522/B00A/Eaves Linings/S16 | | | | | No Asbestos Detected |
| Ceiling Voids - Raked Ceiling | No Asbestos Found | | | | | |
| Underfloor Voids - Slab on Ground | No Asbestos Found | | | | | |

Interior

B00A - R0001 - Home Base

No Asbestos

B00A - R0002 - Movement

No Asbestos

B00A - R0003 - Staff Room Annexe

No Asbestos

B00A - R0004 - General Storeroom

No Asbestos

B00A - R0005 - Movement

No Asbestos

B00A - R0006 - Interview

No Asbestos

2017

| Product | Material Description | Extent | Location Reference | Material Condition | Risk Status | Control Priority |
|-----------|----------------------|--------|--------------------|--------------------|-------------|------------------|
| Sample No | | | | | Test Result | |

B00B - General Learning - 1911 - Timber (Timber)

Exterior

| | | | | | | |
|-------------------------------|-----------------------------|------|------------|--------------------|---------|------------------------------------|
| Eaves Linings | Flat AC Sheeting | 19m2 | Throughout | Good Condition (1) | Low (1) | Low Priority (2-3) |
| | 3522/B00B/Eaves Linings/S15 | | | | | Chrysotile (white asbestos) |
| Ceiling Voids - Raked Ceiling | No Asbestos Found | | | | | |
| Underfloor Voids | No Asbestos Found | | | | | |

Interior

B00B - R0001 - Home Base

| | | | | | | |
|----------------------------|--|--|--|--|--|-----------------------------|
| Ceiling Structures/Linings | Flat AC Sheeting | | | | | |
| | 3522/B00B/R0001/Ceiling Structures/Linings/S14 | | | | | No Asbestos Detected |

B00B - R0002 - Movement

No Asbestos

2017

| Product | Material Description | Extent | Location Reference | Material Condition | Risk Status | Control Priority |
|-----------|----------------------|--------|--------------------|--------------------|-------------|------------------|
| Sample No | | | | | Test Result | |

B00C - General Learning - 1967 - Brick/Veneer (Brick/Veneer)**Exterior**

| | | | | | | |
|-----------------------------------|---|------|------------|--------------------|-----------------------------|--------------------|
| Eaves Linings | Flat AC Sheeting | 27m2 | East | Good Condition (1) | Low (1) | Low Priority (2-3) |
| | 3522/B00G/R0001/Ceiling Structures/Linings/S3 | | | | Chrysotile (white asbestos) | |
| Upstand Panels | Flat AC Sheeting | 30m2 | Throughout | Good Condition (1) | Low (1) | Low Priority (2-3) |
| | 3522/B00G/R0001/Ceiling Structures/Linings/S3 | | | | Chrysotile (white asbestos) | |
| In-fill-panel | Flat AC Sheeting | 18m2 | East, West | Good Condition (1) | Low (1) | Low Priority (2-3) |
| | 3522/B00C/In-fill-panel/S11 | | | | Chrysotile (white asbestos) | |
| Ceiling Voids - Flat Roof | No Asbestos Found | | | | | |
| Underfloor Voids - Slab on Ground | No Asbestos Found | | | | | |

Interior**B00C - R0001 - Home Base Store**

| | | | | | | |
|-----------------------------|---|-----|------------|--------------------|-----------------------------|--------------------|
| Floor Coverings Res/Textile | Vinyl Tiles | 7m2 | Throughout | Good Condition (1) | Low (1) | Low Priority (2-3) |
| | 3522/B00C/R0003/Floor Coverings Res/Textile/S12 | | | | Chrysotile (white asbestos) | |

B00C - R0002 - Main Switch Board

| | | | | | | |
|----------------------------|---|-----|------------|--------------------|-----------------------------|--------------------|
| Ceiling Structures/Linings | Flat AC Sheeting | 1m2 | Throughout | Good Condition (1) | Low (1) | Low Priority (2-3) |
| | 3522/B00G/R0001/Ceiling Structures/Linings/S3 | | | | Chrysotile (white asbestos) | |
| Wall Linings Internal | Flat AC Sheeting | 4m2 | Throughout | Good Condition (1) | Low (1) | Low Priority (2-3) |
| | 3522/B00C/R0002/Wall Linings Internal/S13 | | | | Chrysotile (white asbestos) | |

B00C - R0003 - Movement

| | | | | | | |
|-----------------------------|---|-----|------------|--------------------|-----------------------------|--------------------|
| Floor Coverings Res/Textile | Vinyl Tiles | 7m2 | Throughout | Good Condition (1) | Low (1) | Low Priority (2-3) |
| | 3522/B00C/R0003/Floor Coverings Res/Textile/S12 | | | | Chrysotile (white asbestos) | |

B00C - R0004 - Movement

| | | | | | | |
|----------------------------|---|------|------------|--------------------|-----------------------------|--------------------|
| Ceiling Structures/Linings | Flat AC Sheeting | 34m2 | Throughout | Good Condition (1) | Low (1) | Low Priority (2-3) |
| | 3522/B00G/R0001/Ceiling Structures/Linings/S3 | | | | Chrysotile (white asbestos) | |

B00C - R0005 - Home Base

No Asbestos

B00C - R0006 - Home Base

No Asbestos

B00C - R0007 - Home Base Store

| | | | | | | |
|-----------------------------|---|-----|------------|--------------------|-----------------------------|--------------------|
| Floor Coverings Res/Textile | Vinyl Tiles | 7m2 | Throughout | Good Condition (1) | Low (1) | Low Priority (2-3) |
| | 3522/B00C/R0003/Floor Coverings Res/Textile/S12 | | | | Chrysotile (white asbestos) | |

B00C - R0008 - Movement

No Asbestos

| Product | Material Description | Extent | Location Reference | Material Condition | Risk Status | Control Priority |
|-----------|----------------------|--------|--------------------|--------------------|-------------|------------------|
| Sample No | | | | | Test Result | |

B00D - General Learning/Other-After School Care - 1967 - Brick/Veneer (Brick/Veneer)**Exterior**

| | | | | | | |
|-----------------------------------|---|------|------------|--------------------|-----------------------------|--------------------|
| Eaves Linings | Flat AC Sheeting | 26m2 | South | Good Condition (1) | Low (1) | Low Priority (2-3) |
| | 3522/B00G/R0001/Ceiling Structures/Linings/S3 | | | | Chrysotile (white asbestos) | |
| Upstand Panels | Flat AC Sheeting | 30m2 | Throughout | Good Condition (1) | Low (1) | Low Priority (2-3) |
| | 3522/B00G/R0001/Ceiling Structures/Linings/S3 | | | | Chrysotile (white asbestos) | |
| Underfloor Voids - Slab on Ground | No Asbestos Found | | | | | |
| Ceiling Voids - Flat Roof | No Asbestos Found | | | | | |

Interior**B00D - R0001 - Movement**

| | | | | | | |
|----------------------------|---|------|------------|--------------------|-----------------------------|--------------------|
| Ceiling Structures/Linings | Flat AC Sheeting | 27m2 | Throughout | Good Condition (1) | Low (1) | Low Priority (2-3) |
| | 3522/B00G/R0001/Ceiling Structures/Linings/S3 | | | | Chrysotile (white asbestos) | |

B00D - R0002 - Out Of School Hours Care Centre

No Asbestos

B00D - R0003 - Uniform Shop

| | | | | | | |
|-----------------------------|---|-----|------------|--------------------|-----------------------------|--------------------|
| Floor Coverings Res/Textile | Vinyl Tiles | 8m2 | Throughout | Good Condition (1) | Low (1) | Low Priority (2-3) |
| | 3522/B00D/R0006/Floor Coverings Res/Textile/S10 | | | | Chrysotile (white asbestos) | |

B00D - R0004 - Home Base Store

| | | | | | | |
|-----------------------------|---|-----|------------|--------------------|-----------------------------|--------------------|
| Floor Coverings Res/Textile | Vinyl Tiles | 5m2 | Throughout | Good Condition (1) | Low (1) | Low Priority (2-3) |
| | 3522/B00D/R0006/Floor Coverings Res/Textile/S10 | | | | Chrysotile (white asbestos) | |

B00D - R0005 - Home Base

No Asbestos

B00D - R0006 - Movement

| | | | | | | |
|-----------------------------|---|-----|------------|--------------------|-----------------------------|--------------------|
| Floor Coverings Res/Textile | Vinyl Tiles | 9m2 | Throughout | Good Condition (1) | Low (1) | Low Priority (2-3) |
| | 3522/B00D/R0006/Floor Coverings Res/Textile/S10 | | | | Chrysotile (white asbestos) | |

2017

| Product | Material Description | Extent | Location Reference | Material Condition | Risk Status | Control Priority |
|-----------|----------------------|--------|--------------------|--------------------|-------------|------------------|
| Sample No | | | | Test Result | | |

B00E - Administration/Staff Facilities - 1967 - Timber (Timber)**Exterior**

| | | | | | | |
|------------------|---|------|---------------------------------|--------------------|---------|---|
| Wall Cladding | Flat AC Sheeting | 14m2 | North, West, Variable positions | Good Condition (1) | Low (1) | Low Priority (2-3) |
| | 3522/B00E/Wall Cladding/S2 | | | | | Chrysotile (white asbestos) , Amosite (brown asbestos) |
| Eaves Linings | Flat AC Sheeting | 11m2 | South, West | Good Condition (1) | Low (1) | Low Priority (2-3) |
| | 3522/B00E/R0013/Ceiling Structures/Linings/S6 | | | | | Chrysotile (white asbestos) |
| Ceiling Voids | No Asbestos Found | | | | | |
| Underfloor Voids | No Asbestos Found | | | | | |

Interior**B00E - R0001 - Staff Toilet**

| | | | | | | |
|----------------------------|---|-----|------------|--------------------|---------|------------------------------------|
| Ceiling Structures/Linings | Flat AC Sheeting | 5m2 | Throughout | Good Condition (1) | Low (1) | Low Priority (2-3) |
| | 3522/B00E/R0013/Ceiling Structures/Linings/S6 | | | | | Chrysotile (white asbestos) |

B00E - R0002 - Movement

| | | | | | | |
|----------------------------|---|-----|------------|--------------------|---------|------------------------------------|
| Ceiling Structures/Linings | Flat AC Sheeting | 6m2 | Throughout | Good Condition (1) | Low (1) | Low Priority (2-3) |
| | 3522/B00E/R0013/Ceiling Structures/Linings/S6 | | | | | Chrysotile (white asbestos) |

B00E - R0003 - Staff Toilet

| | | | | | | |
|----------------------------|---|-----|------------|--------------------|---------|------------------------------------|
| Ceiling Structures/Linings | Flat AC Sheeting | 3m2 | Throughout | Good Condition (1) | Low (1) | Low Priority (2-3) |
| | 3522/B00E/R0013/Ceiling Structures/Linings/S6 | | | | | Chrysotile (white asbestos) |

| | | | | | | |
|-----------------------|--|-----|------------|--------------------|---------|------------------------------------|
| Wall Linings Internal | Flat AC Sheeting | 9m2 | Throughout | Good Condition (1) | Low (1) | Low Priority (2-3) |
| | 3522/B00E/R0014/Wall Linings Internal/S7 | | | | | Chrysotile (white asbestos) |

B00E - R0004 - Staff Room

No Asbestos

B00E - R0005 - General Storeroom

| | | | | | | |
|-----------------------|--|------|------------|--------------------|---------|------------------------------------|
| Wall Linings Internal | Flat AC Sheeting | 18m2 | Throughout | Good Condition (1) | Low (1) | Low Priority (2-3) |
| | 3522/B00E/R0014/Wall Linings Internal/S7 | | | | | Chrysotile (white asbestos) |

B00E - R0006 - General Storeroom

| | | | | | | |
|-----------------------------|--|--|--|--|--|-----------------------------|
| Floor Coverings Res/Textile | Vinyl Tiles | | | | | |
| | 3522/B00E/R0006/Floor Coverings Res/Textile/S8 | | | | | No Asbestos Detected |

B00E - R0007 - Staff Room Annexe

| | | | | | | |
|----------------------------|---|------|------------|--------------------|---------|------------------------------------|
| Ceiling Structures/Linings | Flat AC Sheeting | 12m2 | Throughout | Good Condition (1) | Low (1) | Low Priority (2-3) |
| | 3522/B00E/R0013/Ceiling Structures/Linings/S6 | | | | | Chrysotile (white asbestos) |

| | | | | | | |
|-----------------------|--|------|---|--------------------|---------|------------------------------------|
| Wall Linings Internal | Flat AC Sheeting | 16m2 | Throughout, Upper portion, Middle portion | Good Condition (1) | Low (1) | Low Priority (2-3) |
| | 3522/B00E/R0014/Wall Linings Internal/S7 | | | | | Chrysotile (white asbestos) |

B00E - R0008 - Duplicating Workroom

| | | | | | | |
|----------------------------|---|------|------------|--------------------|---------|------------------------------------|
| Ceiling Structures/Linings | Flat AC Sheeting | 18m2 | Throughout | Good Condition (1) | Low (1) | Low Priority (2-3) |
| | 3522/B00E/R0013/Ceiling Structures/Linings/S6 | | | | | Chrysotile (white asbestos) |

| | | | | | | |
|-----------------------|--|------|---|--------------------|---------|------------------------------------|
| Wall Linings Internal | Flat AC Sheeting | 32m2 | Throughout, Upper portion, Middle portion | Good Condition (1) | Low (1) | Low Priority (2-3) |
| | 3522/B00E/R0014/Wall Linings Internal/S7 | | | | | Chrysotile (white asbestos) |

B00E - R0009 - Clerical Office/Workroom

| | | | | | | |
|----------------------------|---|-----|------------|--------------------|---------|------------------------------------|
| Ceiling Structures/Linings | Flat AC Sheeting | 7m2 | Throughout | Good Condition (1) | Low (1) | Low Priority (2-3) |
| | 3522/B00E/R0013/Ceiling Structures/Linings/S6 | | | | | Chrysotile (white asbestos) |

| Product | Material Description | Extent | Location Reference | Material Condition | Risk Status | Control Priority |
|---|----------------------|--------|---|------------------------------------|-------------|--------------------|
| Sample No | | | | Test Result | | |
| Wall Linings Internal | Flat AC Sheeting | 8m2 | North, West | Good Condition (1) | Low (1) | Low Priority (2-3) |
| 3522/B00E/R0014/Wall Linings Internal/S7 | | | | Chrysotile (white asbestos) | | |
| B00E - R0010 - Principal | | | | | | |
| Ceiling Structures/Linings | Flat AC Sheeting | 16m2 | Throughout | Good Condition (1) | Low (1) | Low Priority (2-3) |
| 3522/B00E/R0013/Ceiling Structures/Linings/S6 | | | | Chrysotile (white asbestos) | | |
| Wall Linings Internal | Flat AC Sheeting | 28m2 | Throughout, Upper portion, Middle portion | Good Condition (1) | Low (1) | Low Priority (2-3) |
| 3522/B00E/R0014/Wall Linings Internal/S7 | | | | Chrysotile (white asbestos) | | |
| B00E - R0011 - Movement | | | | | | |
| Ceiling Structures/Linings | Flat AC Sheeting | 5m2 | Throughout | Good Condition (1) | Low (1) | Low Priority (2-3) |
| 3522/B00E/R0013/Ceiling Structures/Linings/S6 | | | | Chrysotile (white asbestos) | | |
| Wall Linings Internal | Flat AC Sheeting | 18m2 | Throughout | Good Condition (1) | Low (1) | Low Priority (2-3) |
| 3522/B00E/R0014/Wall Linings Internal/S7 | | | | Chrysotile (white asbestos) | | |
| B00E - R0012 - Clerical Office | | | | | | |
| Ceiling Structures/Linings | Flat AC Sheeting | 16m2 | East | Good Condition (1) | Low (1) | Low Priority (2-3) |
| 3522/B00E/R0013/Ceiling Structures/Linings/S6 | | | | Chrysotile (white asbestos) | | |
| Wall Linings Internal | Flat AC Sheeting | 28m2 | Throughout | Good Condition (1) | Low (1) | Low Priority (2-3) |
| 3522/B00E/R0014/Wall Linings Internal/S7 | | | | Chrysotile (white asbestos) | | |
| Ceiling Structures/Linings | Flat AC Sheeting | 8m2 | West | Good Condition (1) | Low (1) | Low Priority (2-3) |
| 3522/B00E/R0013/Ceiling Structures/Linings/S6 | | | | Chrysotile (white asbestos) | | |
| B00E - R0013 - Entry Vestibule | | | | | | |
| Ceiling Structures/Linings | Flat AC Sheeting | 16m2 | Throughout | Good Condition (1) | Low (1) | Low Priority (2-3) |
| 3522/B00E/R0013/Ceiling Structures/Linings/S6 | | | | Chrysotile (white asbestos) | | |
| B00E - R0014 - Sick Bay | | | | | | |
| Ceiling Structures/Linings | Flat AC Sheeting | 6m2 | Throughout | Good Condition (1) | Low (1) | Low Priority (2-3) |
| 3522/B00E/R0013/Ceiling Structures/Linings/S6 | | | | Chrysotile (white asbestos) | | |
| Wall Linings Internal | Flat AC Sheeting | 2m2 | North | Good Condition (1) | Low (1) | Low Priority (2-3) |
| 3522/B00E/R0014/Wall Linings Internal/S7 | | | | Chrysotile (white asbestos) | | |

2017

| Product | Material Description | Extent | Location Reference | Material Condition | Risk Status | Control Priority |
|-----------|----------------------|--------|--------------------|--------------------|-------------|------------------|
| Sample No | | | | | Test Result | |

B00F - Communal Facilities - 1967 - Timber Shed (Timber Shed)

Exterior

| | | | | | | |
|-----------------------------------|--|--|--|--|--|-----------------------------|
| Wall Cladding | Flat AC Sheeting 3522/B00F/Wall Cladding/S1 | | | | | No Asbestos Detected |
| Ceiling Voids - Raked Ceiling | No Asbestos Found | | | | | |
| Underfloor Voids - Slab on Ground | No Asbestos Found | | | | | |

Interior

B00F - R0001 - P.E. Store

| | | | | | | |
|-----------------------|--|--|--|--|--|-----------------------------|
| Wall Linings Internal | Flat AC Sheeting 3522/B00F/Wall Cladding/S1 | | | | | No Asbestos Detected |
|-----------------------|--|--|--|--|--|-----------------------------|

2017

| Product | Material Description | Extent | Location Reference | Material Condition | Risk Status | Control Priority |
|-----------|----------------------|--------|--------------------|--------------------|-------------|------------------|
| Sample No | | | | | Test Result | |

B00G - Pupil Facilities - 1967 - Brick/Block (Brick/Block)**Exterior**

| | | | | | | |
|-----------------------------------|---|------|------------|--------------------|-----------------------------|--------------------|
| Eaves Linings | Flat AC Sheeting | 18m2 | West | Good Condition (1) | Low (1) | Low Priority (2-3) |
| | 3522/B00G/R0001/Ceiling Structures/Linings/S3 | | | | Chrysotile (white asbestos) | |
| Upstand Panels | Flat AC Sheeting | 26m2 | Throughout | Good Condition (1) | Low (1) | Low Priority (2-3) |
| | 3522/B00G/R0001/Ceiling Structures/Linings/S3 | | | | Chrysotile (white asbestos) | |
| Ceiling Voids - Flat Roof | No Asbestos Found | | | | | |
| Underfloor Voids - Slab on Ground | No Asbestos Found | | | | | |

Interior**B00G - R0001 - Movement**

| | | | | | | |
|----------------------------|---|------|---------------------|--------------------|-----------------------------|--------------------|
| Ceiling Structures/Linings | Flat AC Sheeting | 37m2 | Throughout | Good Condition (1) | Low (1) | Low Priority (2-3) |
| | 3522/B00G/R0001/Ceiling Structures/Linings/S3 | | | | Chrysotile (white asbestos) | |
| Upstand Panels | Flat AC Sheeting | 4m2 | West, Upper portion | Good Condition (1) | Low (1) | Low Priority (2-3) |
| | 3522/B00G/R0001/Upstand Panels/S5 | | | | Chrysotile (white asbestos) | |

B00G - R0002 - Toilets - Boys

| | | | | | | |
|----------------------------|---|------|------------|--------------------|-----------------------------|--------------------|
| Ceiling Structures/Linings | Flat AC Sheeting | 18m2 | Throughout | Good Condition (1) | Low (1) | Low Priority (2-3) |
| | 3522/B00G/R0001/Ceiling Structures/Linings/S3 | | | | Chrysotile (white asbestos) | |

B00G - R0003 - Toilets - Boys

| | | | | | | |
|----------------------------|---|-----|------------|--------------------|-----------------------------|--------------------|
| Ceiling Structures/Linings | Flat AC Sheeting | 2m2 | Throughout | Good Condition (1) | Low (1) | Low Priority (2-3) |
| | 3522/B00G/R0001/Ceiling Structures/Linings/S3 | | | | Chrysotile (white asbestos) | |

B00G - R0004 - Toilets - Girls

| | | | | | | |
|----------------------------|---|------|-----------------|--------------------|-----------------------------|--------------------|
| Ceiling Structures/Linings | Flat AC Sheeting | 22m2 | Throughout | Good Condition (1) | Low (1) | Low Priority (2-3) |
| | 3522/B00G/R0001/Ceiling Structures/Linings/S3 | | | | Chrysotile (white asbestos) | |
| Wall Linings Internal | Compressed AC Sheet | 3m2 | Adjacent GR0005 | Good Condition (1) | Low (1) | Low Priority (2-3) |
| | 3522/B00G/R0002/Partition Walls (Cubicles)/S4 | | | | Chrysotile (white asbestos) | |

B00G - R0005 - Toilets - Girls

| | | | | | | |
|----------------------------|---|-----|------------|--------------------|-----------------------------|--------------------|
| Ceiling Structures/Linings | Flat AC Sheeting | 2m2 | Throughout | Good Condition (1) | Low (1) | Low Priority (2-3) |
| | 3522/B00G/R0001/Ceiling Structures/Linings/S3 | | | | Chrysotile (white asbestos) | |
| Wall Linings Internal | Compressed AC Sheet | 3m2 | North | Good Condition (1) | Low (1) | Low Priority (2-3) |
| | 3522/B00G/R0002/Partition Walls (Cubicles)/S4 | | | | Chrysotile (white asbestos) | |

B00G - R0006 - Cleaning Supplies

| | | | | | | |
|----------------------------|---|------|------------|--------------------|-----------------------------|--------------------|
| Ceiling Structures/Linings | Flat AC Sheeting | 17m2 | Throughout | Good Condition (1) | Low (1) | Low Priority (2-3) |
| | 3522/B00G/R0001/Ceiling Structures/Linings/S3 | | | | Chrysotile (white asbestos) | |

B00G - R0007 - Canteen

| | | | | | | |
|----------------------------|---|-----|----------------------|--------------------|-----------------------------|--------------------|
| Ceiling Structures/Linings | Flat AC Sheeting | 2m2 | East, Middle portion | Good Condition (1) | Low (1) | Low Priority (2-3) |
| | 3522/B00G/R0001/Ceiling Structures/Linings/S3 | | | | Chrysotile (white asbestos) | |

B00G - R0008 - Movement

No Asbestos

B00G - R0009 - Canteen Office/Store

No Asbestos

B00G - R0010 - Staff Toilet

No Asbestos

| Product | Material Description | Extent | Location Reference | Material Condition | Risk Status | Control Priority |
|-----------|----------------------|--------|--------------------|--------------------|-------------|------------------|
| Sample No | | | | | Test Result | |

B00H - Communal Facilities - 1967 - Metal Shed (Metal Shed)

Exterior

| | |
|-----------------------------------|-------------------|
| Ceiling Voids | No Asbestos Found |
| Underfloor Voids - Slab on Ground | No Asbestos Found |

Interior

B00H - R0001 - P.E. Store

No Asbestos

2017

| Product | Material Description | Extent | Location Reference | Material Condition | Risk Status | Control Priority |
|-----------|----------------------|--------|--------------------|--------------------|-------------|------------------|
| Sample No | | | | | Test Result | |

B00I - Communal Facilities - 1967 - Metal Shed (Metal Shed)

Exterior

| | |
|-----------------|---------------------|
| Ceiling Void | Requires Inspection |
| Underfloor Void | Requires Inspection |

Interior

B00I - R0001 - Sports Store

No Asbestos

2017

| Product | Material Description | Extent | Location Reference | Material Condition | Risk Status | Control Priority |
|-----------|----------------------|--------|--------------------|--------------------|-------------|------------------|
| Sample No | | | | | Test Result | |

B00J - General Learning - 1997 - Brick/Veneer (Brick/Veneer)

Exterior

| | |
|------------------|-------------------|
| Ceiling Voids | No Asbestos Found |
| Underfloor Voids | No Asbestos Found |

Interior

B00J - R0001 - Movement

| | | |
|----------------------------|---|----------------------|
| Ceiling Structures/Linings | Flat AC Sheeting 3522/B00J/R0001/Ceiling Structures/Linings/S9 | No Asbestos Detected |
|----------------------------|---|----------------------|

B00J - R0002 - Practical Activities - 1hb

No Asbestos

B00J - R0003 - Home Base

| | |
|---|-------------------|
| Vinyl Tiles (Under Floor Covering/Carpet) | No Asbestos Found |
|---|-------------------|

B00J - R0004 - Home Base Store

| | |
|---|-------------------|
| Vinyl Tiles (Under Floor Covering/Carpet) | No Asbestos Found |
|---|-------------------|

B00J - R0005 - Movement

No Asbestos

B00J - R0006 - Withdrawal Space - 1hb

| | |
|---|-------------------|
| Vinyl Tiles (Under Floor Covering/Carpet) | No Asbestos Found |
|---|-------------------|

B00J - R0007 - Movement

No Asbestos

B00J - R0008 - Home Base Store

| | |
|---|-------------------|
| Vinyl Tiles (Under Floor Covering/Carpet) | No Asbestos Found |
|---|-------------------|

B00J - R0009 - Home Base

| | |
|---|-------------------|
| Vinyl Tiles (Under Floor Covering/Carpet) | No Asbestos Found |
|---|-------------------|

B00J - R0010 - Practical Activities - 1hb

No Asbestos

B00J - R0011 - Practical Activities - 1hb

No Asbestos

B00J - R0012 - Home Base

| | |
|---|-------------------|
| Vinyl Tiles (Under Floor Covering/Carpet) | No Asbestos Found |
|---|-------------------|

B00J - R0013 - Home Base Store

| | |
|---|-------------------|
| Vinyl Tiles (Under Floor Covering/Carpet) | No Asbestos Found |
|---|-------------------|

B00J - R0014 - Movement

No Asbestos

B00J - R0015 - Withdrawal Space - 1hb

| | |
|---|-------------------|
| Vinyl Tiles (Under Floor Covering/Carpet) | No Asbestos Found |
|---|-------------------|

B00J - R0016 - Movement

No Asbestos

B00J - R0017 - Home Base Store

| | |
|---|-------------------|
| Vinyl Tiles (Under Floor Covering/Carpet) | No Asbestos Found |
|---|-------------------|

B00J - R0018 - Home Base

| | |
|---|-------------------|
| Vinyl Tiles (Under Floor Covering/Carpet) | No Asbestos Found |
|---|-------------------|

B00J - R0019 - Practical Activities - 1hb

No Asbestos

| Product | Material Description | Extent | Location Reference | Material Condition | Risk Status | Control Priority |
|-----------|----------------------|--------|--------------------|--------------------|-------------|------------------|
| Sample No | | | | | Test Result | |

B00K - Communal Facilities - 2010 - Brick/Veneer (Brick/Veneer)

Exterior

| | |
|-----------------------------------|-------------------|
| Ceiling Voids | No Asbestos Found |
| Underfloor Voids - Slab on Ground | No Asbestos Found |

Interior

B00K - R0001 - Communal Space

No Asbestos

B00K - R0002 - P.E. Store

No Asbestos

B00K - R0003 - Distribution Board

Note: No inspection of live electrical installation.

No Asbestos

B00K - R0004 - Covered Outdoor Learning Area

No Asbestos

2017

| Product | Material Description | Extent | Location Reference | Material Condition | Risk Status | Control Priority |
|-----------|----------------------|--------|--------------------|--------------------|-------------|------------------|
| Sample No | | | | | Test Result | |

B00L - Library - 2010 - Brick/Veneer (Brick/Veneer)

Exterior

| | |
|------------------|-------------------|
| Ceiling Voids | No Asbestos Found |
| Underfloor Voids | No Asbestos Found |

Interior

B00L - R0001 - Reading Area

No Asbestos

B00L - R0002 - Library Office/Workroom

No Asbestos

B00L - R0003 - K.L.A. Store

No Asbestos

B00L - R0004 - Communications Room

No Asbestos

B00L - R0005 - Distribution Board

Note: No inspection of live electrical installation.

No Asbestos

B00L - R0006 - External Movement

No Asbestos

B00L - R0007 - External Movement

No Asbestos

2017

| Product | Material Description | Extent | Location Reference | Material Condition | Risk Status | Control Priority |
|-----------|----------------------|--------|--------------------|--------------------|-------------|------------------|
| Sample No | | | | | Test Result | |

Demountables

Demountable details as per the AMS records as of 15 Feb 2017.

OS 602 - D10380 - Learning Unit - Standard With P.A.A. : Placement Date - 30/12/2013

Note: This refurbished demountable may have asbestos present in remnant mastic in window frames.

Exterior

No Asbestos Found.

Interior

R1 - Learning space/withdrawal/entry

No Asbestos Found.

R2 - Home Base Store

No Asbestos Found.

OS 840 - D11122 - Girls Toilet : Placement Date - 19/06/2001

Exterior

| | | | |
|-------------|---------------------|------------------|---------|
| Step Treads | Compressed AC Sheet | Assumed Asbestos | 1.08 m2 |
| Landing | Compressed AC Sheet | Assumed Asbestos | 1.2 m2 |
| Eave Lining | Flat AC Sheet | Assumed Asbestos | 2.88 m2 |

Interior

R1 - Toilets-Girls

| | | | |
|-------------------|---------------------|------------------|-------|
| Toilet partitions | Compressed AC Sheet | Assumed Asbestos | 4 m2 |
| End wall panel | Flat AC Sheet | Assumed Asbestos | 36 m2 |
| Ceiling | Flat AC Sheet | Assumed Asbestos | 18 m2 |

2017

| Product | Material Description | Extent | Location Reference | Material Condition | Risk Status | Control Priority |
|-----------|----------------------|--------|--------------------|--------------------|-------------|------------------|
| Sample No | | | | | Test Result | |

Listing of Electronic Attachments as of 22/03/2017

There are no asbestos related file attachment(s) for this school.

2017