

Asbestos Register

(Hazardous Materials and Risk Assessment)

School : Woolgoolga Public School (3503)
Region : North Coast
State Electorate : Coffs Harbour
Local Government Area : Coffs Harbour

Initial Survey : Noel Arnold & Associates : 20 - May - 2008
Reviewed By : Grencap-NAA : 05 - May - 2016

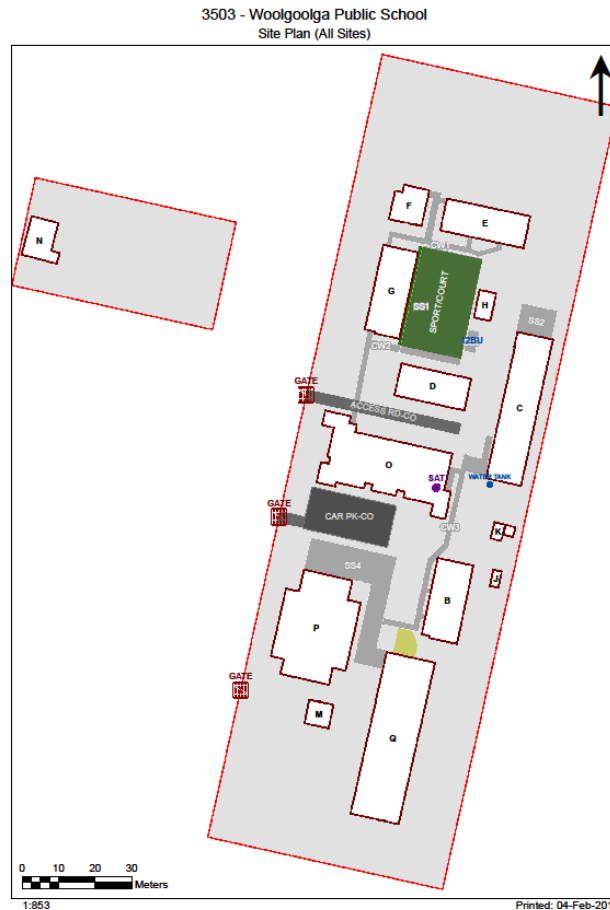

2017

Product	Material Description	Extent	Location Reference	Material Condition	Risk Status	Control Priority
Sample No					Test Result	

B00B - General Learning - 1950 - Timber (Timber)

Exterior

Eaves Linings	Flat AC Sheeting	10m2	East, West	Good Condition (1)	Low (1)	Low Priority (2-3)
	3503/B00B/Eaves Linings/S13					Chrysotile (white asbestos)
Ceiling Voids	Non Accessible Area - Height Restriction 4m height					
Underfloor Voids	No Asbestos Found					

Interior

B00B - R0001 - General Storeroom (23.7 m2)

No Asbestos

B00B - R0002 - Staff Toilet (2.58 m2)

Wall Linings Internal	Flat AC Sheeting					No Asbestos Detected
	3503/B00B/R0002/Wall Linings Internal/S5					

B00B - R0003 - Home Base Store (6 m2)

Floor Coverings Res/Textile	Vinyl Tiles					No Asbestos Detected
	3503/B00B/R0003/Floor Coverings Res/Textile/S6					

Floor Coverings Res/Textile	Adhesive					No Asbestos Detected
	3503/B00B/R0003/Floor Coverings Res/Textile/S12					

B00B - R0004 - Practical Activities - 1hb (38.37 m2)

Floor Coverings Res/Textile	Vinyl Tiles					No Asbestos Detected
	3503/B00B/R0003/Floor Coverings Res/Textile/S6					

Floor Coverings Res/Textile	Adhesive					No Asbestos Detected
	3503/B00B/R0003/Floor Coverings Res/Textile/S12					

B00B - R0005 - Home Base (53.43 m2)

No Asbestos

B00B - R0006 - Home Base (53.36 m2)

No Asbestos

B00B - R0007 - Toilets - Boys/Girls (3.18 m2)

Wall Linings Internal	Flat AC Sheeting					No Asbestos Detected
	3503/B00B/R0002/Wall Linings Internal/S5					

B00B - R0008 - Withdrawal Space - 1hb (18.78 m2)

No Asbestos

B00B - R0009 - Cleaning Distributed Store (2.69 m2)

Floor Coverings Res/Textile	Vinyl Tiles					No Asbestos Detected
	3503/B00B/R0003/Floor Coverings Res/Textile/S6					

Floor Coverings Res/Textile	Adhesive					No Asbestos Detected
	3503/B00B/R0003/Floor Coverings Res/Textile/S12					

Product	Material Description	Extent	Location Reference	Material Condition	Risk Status	Control Priority
Sample No					Test Result	

B00C - General Learning/Pupil Facilities - 1970 - Brick/Block (Brick/Block)

Exterior

Underfloor Voids - Slab on Ground	Non Accessible Area - Area inaccessible
Ceiling Voids - Flat Roof	Non Accessible Area - Area inaccessible no access point

Interior

B00C - R0001 - Staff Toilet (6.62 m2)

Partition Walls (Cubicles)	Compressed AC Sheet	3m2	Variable positions	Good Condition (1)	Low (1)	Low Priority (2-3)
3503/B00C/R0003/Partition Walls (Cubicles)/S14					Chrysotile (white asbestos)	

B00C - R0002 - Movement (5.41 m2)

No Asbestos

B00C - R0003 - Staff Toilet (6.53 m2)

Partition Walls (Cubicles)	Compressed AC Sheet	3m2	Variable positions	Good Condition (1)	Low (1)	Low Priority (2-3)
3503/B00C/R0003/Partition Walls (Cubicles)/S14					Chrysotile (white asbestos)	

B00C - R0004 - General Storeroom (21.28 m2)

No Asbestos

B00C - R0005 - General Storeroom (53.1 m2)

No Asbestos

B00C - R0006 - Cleaning Distributed Store (6.6 m2)

No Asbestos

B00C - R0007 - Movement (69.58 m2)

No Asbestos

B00C - R0008 - Canteen (41.28 m2)

No Asbestos

B00C - R0009 - Main Switch Board (7.1 m2)

No Asbestos

B00C - R0010 - Toilets - Girls (58.07 m2)

No Asbestos

B00C - R0011 - Toilets - Boys (56.61 m2)

No Asbestos

B00C - R0012 - Movement (35.31 m2)

No Asbestos

B00C - R1001 - Home Base (66.55 m2)

No Asbestos

B00C - R1002 - Practical Activities - 1hb (72.46 m2)

No Asbestos

B00C - R1003 - Home Base Store (6.39 m2)

No Asbestos

B00C - R1004 - Home Base Store (6.34 m2)

No Asbestos

B00C - R1005 - Home Base (66.22 m2)

No Asbestos

B00C - R1006 - Home Base (66.19 m2)

No Asbestos

B00C - R1007 - Home Base Store (6.26 m2)

No Asbestos

Product	Material Description	Extent	Location Reference	Material Condition	Risk Status	Control Priority
Sample No					Test Result	

B00C - R1008 - Home Base Store (6.24 m2)

No Asbestos

B00C - R1009 - Home Base (66.36 m2)

No Asbestos

2017

Product	Material Description	Extent	Location Reference	Material Condition	Risk Status	Control Priority
Sample No					Test Result	

B00D - General Learning - 1915 - Timber (Timber)

Exterior

Eaves Linings	Flat AC Sheeting 3503/B00D/Eaves Linings/S15					No Asbestos Detected
Ceiling Voids	Non Accessible Area - Height Restriction 4m height					
Underfloor Voids	No Asbestos Found					

Interior

B00D - R0001 - Home Base Store (5.38 m2)

No Asbestos

B00D - R0002 - Practical Activities - 1hb (5.56 m2)

No Asbestos

B00D - R0003 - Home Base (70.46 m2)

No Asbestos

B00D - R0004 - Home Base (55.96 m2)

No Asbestos

B00D - R0005 - Practical Activities - 1hb (5.66 m2)

No Asbestos

B00D - R0006 - Home Base Store (5.38 m2)

No Asbestos

B00D - R0007 - Interview (6.74 m2)

No Asbestos

B00D - R0008 - Interview (7.18 m2)

No Asbestos

2017

Product	Material Description	Extent	Location Reference	Material Condition	Risk Status	Control Priority
Sample No					Test Result	

B00E - Pupil Facilities/General Learning - 1915 - Timber (Timber)**Exterior**

Eaves Linings	Flat AC Sheeting 3503/B00E/Eaves Linings/S21					No Asbestos Detected
Ceiling Voids	Non Accessible Area - Height Restriction 4m height					
Underfloor Voids	No Asbestos Found					

Interior**B00E - R0001 - Practical Activities - 1hb (16.75 m2)**

No Asbestos

B00E - R0002 - Home Base (52.5 m2)

Floor Coverings Res/Textile	Vinyl Tiles (Under Floor Covering/Carpet) 3503/B00E/R0007/Floor Coverings Res/Textile/S19	53m2	Throughout	Good Condition (1)	Low (1)	Low Priority (2-3) Chrysotile (white asbestos)
Floor Coverings Res/Textile	Adhesive 3503/B00E/R0007/Floor Coverings Res/Textile/S20					No Asbestos Detected

B00E - R0003 - Home Base Store (5.22 m2)

No Asbestos

B00E - R0004 - Practical Activities - 1hb (10.53 m2)

No Asbestos

B00E - R0005 - Home Base (49.13 m2)

Floor Coverings Res/Textile	Adhesive 3503/B00E/R0007/Floor Coverings Res/Textile/S20					No Asbestos Detected
Floor Coverings Res/Textile	Vinyl Tiles (Under Floor Covering/Carpet) 3503/B00E/R0007/Floor Coverings Res/Textile/S19	50m2	Throughout	Good Condition (1)	Low (1)	Low Priority (2-3) Chrysotile (white asbestos)

B00E - R0006 - Practical Activities - 1hb (17.44 m2)

No Asbestos

B00E - R0007 - Home Base (43.93 m2)

Floor Coverings Res/Textile	Adhesive 3503/B00E/R0007/Floor Coverings Res/Textile/S20					No Asbestos Detected
Floor Coverings Res/Textile	Vinyl Tiles (Under Floor Covering/Carpet) 3503/B00E/R0007/Floor Coverings Res/Textile/S19	44m2	Throughout	Good Condition (1)	Low (1)	Low Priority (2-3) Chrysotile (white asbestos)

B00E - R9001 - Shower/Change (20.15 m2)

Ceiling Structures/Linings	Flat AC Sheeting 3503/B00E/R9003/Ceiling Structures/Linings/S22	21m2	Throughout	Good Condition (1)	Low (1)	Low Priority (2-3) Chrysotile (white asbestos) , Amosite (brown asbestos)
----------------------------	--	------	------------	--------------------	---------	---

B00E - R9002 - Shower/Change (15.82 m2)

Ceiling Structures/Linings	Flat AC Sheeting 3503/B00E/R9003/Ceiling Structures/Linings/S22	16m2	Throughout	Good Condition (1)	Low (1)	Low Priority (2-3) Chrysotile (white asbestos) , Amosite (brown asbestos)
----------------------------	--	------	------------	--------------------	---------	---

B00E - R9003 - Plant (2.17 m2)

Ceiling Structures/Linings	Flat AC Sheeting 3503/B00E/R9003/Ceiling Structures/Linings/S22	3m2	Throughout	Good Condition (1)	Low (1)	Low Priority (2-3) Chrysotile (white asbestos) , Amosite (brown asbestos)
----------------------------	--	-----	------------	--------------------	---------	---

B00E - R9004 - General Storeroom (15.36 m2)

No Asbestos

Product	Material Description	Extent	Location Reference	Material Condition	Risk Status	Control Priority
Sample No					Test Result	

B00F - General Learning - 1915 - Timber (Timber)

Exterior

Eaves Linings	Flat AC Sheeting 3503/B00F/Eaves Linings/S23					No Asbestos Detected
Ceiling Voids	Non Accessible Area - Height Restriction 4m height					
Underfloor Voids	No Asbestos Found					

Interior

B00F - R0001 - Practical Activities - 1hb (2.37 m2)

No Asbestos

B00F - R0002 - Home Base (65.26 m2)

No Asbestos

B00F - R0003 - Movement (9.34 m2)

No Asbestos

2017

Product	Material Description	Extent	Location Reference	Material Condition	Risk Status	Control Priority
Sample No					Test Result	

B00G - General Learning - 1908 - Timber (Timber)

Exterior

Eaves Linings	Flat AC Sheeting 3503/B00G/Eaves Linings/S16					No Asbestos Detected
Ceiling Voids	Non Accessible Area - Height Restriction 4m height					
Underfloor Voids	No Asbestos Found					

Interior

B00G - R0001 - General Storeroom (12.04 m2)

No Asbestos

B00G - R0002 - Staff Room (25.29 m2)

Floor Coverings Res/Textile	Adhesive 3503/B00G/R0006/Floor Coverings Res/Textile/S18					No Asbestos Detected
Floor Coverings Res/Textile	Vinyl Tiles (Under Floor Covering/Carpet) 3503/B00G/R0006/Floor Coverings Res/Textile/S17	26m2	Throughout	Good Condition (1)	Low (1) Low Priority (2-3)	Chrysotile (white asbestos)

B00G - R0003 - Practical Activities - 1hb (62.52 m2)

No Asbestos

B00G - R0004 - Cleaning Distributed Store (3.04 m2)

No Asbestos

B00G - R0005 - Home Base (66.7 m2)

Floor Coverings Res/Textile	Vinyl Tiles (Under Floor Covering/Carpet) 3503/B00G/R0006/Floor Coverings Res/Textile/S17	67m2	Throughout	Good Condition (1)	Low (1) Low Priority (2-3)	Chrysotile (white asbestos)
Floor Coverings Res/Textile	Adhesive 3503/B00G/R0006/Floor Coverings Res/Textile/S18					No Asbestos Detected

B00G - R0006 - Home Base (48.91 m2)

Floor Coverings Res/Textile	Adhesive 3503/B00G/R0006/Floor Coverings Res/Textile/S18					No Asbestos Detected
Floor Coverings Res/Textile	Vinyl Tiles (Under Floor Covering/Carpet) 3503/B00G/R0006/Floor Coverings Res/Textile/S17	49m2	Throughout	Good Condition (1)	Low (1) Low Priority (2-3)	Chrysotile (white asbestos)

2017

Product	Material Description	Extent	Location Reference	Material Condition	Risk Status	Control Priority
Sample No					Test Result	

B00H - General Learning - 1950 - Timber (Timber)

Exterior

Eaves Linings	Flat AC Sheeting	10m2	Throughout	Good Condition (1)	Low (1)	Low Priority (2-3)
	3503/B00H/Eaves Linings/S24					Chrysotile (white asbestos)
Ceiling Voids	No Asbestos Found					
Underfloor Voids - Slab on Ground	Non Accessible Area					
	- Area inaccessible					

Interior

B00H - R0001 - Special Programs Room (32.28 m2)

Ceiling Structures/Linings	Flat AC Sheeting	33m2	Throughout	Good Condition (1)	Low (1)	Low Priority (2-3)
	3503/B00H/R0001/Ceiling Structures/Linings/S4					Chrysotile (white asbestos)
Wall Linings Internal	Flat AC Sheeting	120m2	Throughout	Good Condition (1)	Low (1)	Low Priority (2-3)
	3503/B00H/R0001/Wall Linings Internal/S3					Chrysotile (white asbestos)

2017

Product	Material Description	Extent	Location Reference	Material Condition	Risk Status	Control Priority
Sample No					Test Result	

B00J - Pupil Facilities - 1966 - Timber (Timber)

Exterior

Underfloor Voids - Slab on Ground Non Accessible Area
 - Area inaccessible

Ceiling Voids No Asbestos Found

Interior

B00J - R0001 - Drinking Facilities (9.39 m2)

No Asbestos

2017

Product	Material Description	Extent	Location Reference	Material Condition	Risk Status	Control Priority
Sample No					Test Result	

B00K - Building Services - 1989 - Metal Shed (Metal Shed)

Exterior

Ceiling Voids	No Asbestos Found
Underfloor Voids	No Asbestos Found

Interior

B00K - R0001 - General Assistant/Bulk Store (12.93 m2)

No Asbestos

2017

Product	Material Description	Extent	Location Reference	Material Condition	Risk Status	Control Priority
Sample No					Test Result	

B00L - Building Services - 1970 - Brick/Block (Brick/Block)

Exterior

Underfloor Voids - Slab on Ground No Asbestos Found

Ceiling Voids No Asbestos Found

Interior

B00L - R0001 - General Storeroom (5.93 m2)

No Asbestos

2017

Product	Material Description	Extent	Location Reference	Material Condition	Risk Status	Control Priority
Sample No					Test Result	

B00M - Building Services - 1950 - Timber Shed (Timber Shed)

Exterior

Ceiling Voids	Requires Inspection
Underfloor Voids	Requires Inspection

Interior

B00M - R0001 - Garden Store (41.34 m2)

No Asbestos

2017

Product	Material Description	Extent	Location Reference	Material Condition	Risk Status	Control Priority
Sample No					Test Result	

B00N - Other-After School Care - 1950 - Timber (Timber)

Exterior

Eaves Linings	Flat AC Sheeting	14m2	East, West	Good Condition (1)	Low (1)	Low Priority (2-3)
	3503/B00N/Eaves Linings/S25				Chrysotile (white asbestos) , Amosite (brown asbestos)	
Ceiling Voids	No Asbestos Found					
Underfloor Voids	No Asbestos Found					
Wall Cladding	Corrugated AC Sheeting	200m2	Throughout	Good Condition (1)	Low (1)	Low Priority (2-3)
	3503/B00N/Wall Cladding/S26				Chrysotile (white asbestos) , Amosite (brown asbestos)	

Interior

B00N - R0001 - Movement (7.31 m2)

Ceiling Structures/Linings	Flat AC Sheeting	8m2	Throughout	Good Condition (1)	Low (1)	Low Priority (2-3)
	3503/B00N/R0001/Ceiling Structures/Linings/S2				Chrysotile (white asbestos) , Amosite (brown asbestos)	

B00N - R0002 - Out Of School Hours Care Centre (77.81 m2)

Ceiling Structures/Linings	Flat AC Sheeting	78m2	Throughout	Good Condition (1)	Low (1)	Low Priority (2-3)
	3503/B00N/R0001/Ceiling Structures/Linings/S2				Chrysotile (white asbestos) , Amosite (brown asbestos)	
Wall Linings Internal	Flat AC Sheeting	200m2	Throughout	Good Condition (1)	Low (1)	Low Priority (2-3)
	3503/B00N/R0001/Ceiling Structures/Linings/S2				Chrysotile (white asbestos) , Amosite (brown asbestos)	

2017

Product	Material Description	Extent	Location Reference	Material Condition	Risk Status	Control Priority
Sample No					Test Result	

B000 - Administration/Library - 1976 - Brick/Block (Brick/Block)**Exterior**

Ceiling Voids	No Asbestos Found
Underfloor Voids	No Asbestos Found

Interior**B000 - R0001 - Movement (5.31 m2)**

No Asbestos

B000 - R0002 - Cleaning Distributed Store (5.13 m2)

No Asbestos

B000 - R0003 - Home Base (57.17 m2)

Ceiling Structures/Linings	Vermiculite					
	3503/B000/R0003/Ceiling Structures/Linings/S7					Limited Samples Taken
<i>Vermiculite Ceilings may contain asbestos. Asbestos testing MUST be conducted prior to any disturbance works</i>						

B000 - R0004 - Cleaning Supplies (7.47 m2)

Ceiling Structures/Linings	Vermiculite					
	3503/B000/R0003/Ceiling Structures/Linings/S7					Limited Samples Taken
<i>Vermiculite Ceilings may contain asbestos. Asbestos testing MUST be conducted prior to any disturbance works</i>						

B000 - R0005 - Distribution Board (0.99 m2)

Note: No inspection of live electrical installation.

Electrical Mounting Board	Resinous Board	2Unit	East & West	Good Condition (1)	Low (1)	Low Priority (2-3)
	3503/B000/R0005/Electrical Mounting Board/S10					Chrysotile (white asbestos)

B000 - R0006 - General Storeroom (9.03 m2)

Ceiling Structures/Linings	Vermiculite					
	3503/B000/R0003/Ceiling Structures/Linings/S7					Limited Samples Taken
<i>Vermiculite Ceilings may contain asbestos. Asbestos testing MUST be conducted prior to any disturbance works</i>						

Floor Coverings Res/Textile	Vinyl Tiles					
	3503/B000/R0004/Floor Coverings Res/Textile/S9					No Asbestos Detected

B000 - R0007 - Practical Activities - 1hb (12.26 m2)

Ceiling Structures/Linings	Vermiculite					
	3503/B000/R0003/Ceiling Structures/Linings/S7					Limited Samples Taken
<i>Vermiculite Ceilings may contain asbestos. Asbestos testing MUST be conducted prior to any disturbance works</i>						

Floor Coverings Res/Textile	Vinyl Tiles					
	3503/B000/R0004/Floor Coverings Res/Textile/S9					No Asbestos Detected

B000 - R0008 - Movement (68.14 m2)

Ceiling Structures/Linings	Vermiculite					
	3503/B000/R0003/Ceiling Structures/Linings/S7					Limited Samples Taken
<i>Vermiculite Ceilings may contain asbestos. Asbestos testing MUST be conducted prior to any disturbance works</i>						

B000 - R0009 - Deputy Principal (12.9 m2)

Ceiling Structures/Linings	Vermiculite					
	3503/B000/R0003/Ceiling Structures/Linings/S7					Limited Samples Taken
<i>Vermiculite Ceilings may contain asbestos. Asbestos testing MUST be conducted prior to any disturbance works</i>						

B000 - R0010 - Practical Activities - 1hb (12.48 m2)

Ceiling Structures/Linings	Vermiculite					
	3503/B000/R0003/Ceiling Structures/Linings/S7					Limited Samples Taken
<i>Vermiculite Ceilings may contain asbestos. Asbestos testing MUST be conducted prior to any disturbance works</i>						

Floor Coverings Res/Textile	Vinyl Tiles					
	3503/B000/R0004/Floor Coverings Res/Textile/S9					No Asbestos Detected

B000 - R0011 - Home Base (56.09 m2)

Ceiling Structures/Linings	Vermiculite					
	3503/B000/R0003/Ceiling Structures/Linings/S7					Limited Samples Taken
<i>Vermiculite Ceilings may contain asbestos. Asbestos testing MUST be conducted prior to any disturbance works</i>						

Product	Material Description	Extent	Location Reference	Material Condition	Risk Status	Control Priority
Sample No					Test Result	
B000 - R0012 - Duplicating Workroom (24.63 m2)						
Ceiling Structures/Linings	Vermiculite					
	3503/B000/R0003/Ceiling Structures/Linings/S7					Limited Samples Taken
<i>Vermiculite Ceilings may contain asbestos. Asbestos testing MUST be conducted prior to any disturbance works</i>						
Floor Coverings Res/Textile	Vinyl Tiles					
	3503/B000/R0004/Floor Coverings Res/Textile/S9					No Asbestos Detected
B000 - R0013 - Clerical Office (29.51 m2)						
Ceiling Structures/Linings	Vermiculite					
	3503/B000/R0003/Ceiling Structures/Linings/S7					Limited Samples Taken
<i>Vermiculite Ceilings may contain asbestos. Asbestos testing MUST be conducted prior to any disturbance works</i>						
B000 - R0014 - Staff Room (69.33 m2)						
Ceiling Structures/Linings	Vermiculite					
	3503/B000/R0003/Ceiling Structures/Linings/S7					Limited Samples Taken
<i>Vermiculite Ceilings may contain asbestos. Asbestos testing MUST be conducted prior to any disturbance works</i>						
B000 - R0015 - Principal (23.41 m2)						
Ceiling Structures/Linings	Vermiculite					
	3503/B000/R0003/Ceiling Structures/Linings/S7					Limited Samples Taken
<i>Vermiculite Ceilings may contain asbestos. Asbestos testing MUST be conducted prior to any disturbance works</i>						
B000 - R0016 - Entry Vestibule (21.24 m2)						
Ceiling Structures/Linings	Vermiculite					
	3503/B000/R0003/Ceiling Structures/Linings/S7					Limited Samples Taken
<i>Vermiculite Ceilings may contain asbestos. Asbestos testing MUST be conducted prior to any disturbance works</i>						
B000 - R0017 - Sick Bay (11.06 m2)						
Ceiling Structures/Linings	Vermiculite					
	3503/B000/R0003/Ceiling Structures/Linings/S7					Limited Samples Taken
<i>Vermiculite Ceilings may contain asbestos. Asbestos testing MUST be conducted prior to any disturbance works</i>						
Floor Coverings Res/Textile	Vinyl Tiles					
	3503/B000/R0004/Floor Coverings Res/Textile/S9					No Asbestos Detected
B000 - R0018 - Movement (7.45 m2)						
Ceiling Structures/Linings	Vermiculite					
	3503/B000/R0003/Ceiling Structures/Linings/S7					Limited Samples Taken
<i>Vermiculite Ceilings may contain asbestos. Asbestos testing MUST be conducted prior to any disturbance works</i>						
B000 - R0019 - Movement (4.04 m2)						
No Asbestos						
B000 - R0020 - General Storeroom (19.35 m2)						
No Asbestos						
B000 - R0021 - Stairs (4.93 m2)						
No Asbestos						
B000 - R0022 - Stairs (6.47 m2)						
No Asbestos						
B000 - R1001 - Toilets - Boys (3.24 m2)						
Partition Walls (Cubicles)	Compressed AC Sheet	3m2	Throughout	Good Condition (1)	Low (1)	Low Priority (2-3)
	3503/B000/R1001/Partition Walls (Cubicles)/S8					Chrysotile (white asbestos)
B000 - R1002 - Toilets - Girls (3.24 m2)						
Partition Walls (Cubicles)	Compressed AC Sheet	3m2	Throughout	Good Condition (1)	Low (1)	Low Priority (2-3)
	3503/B000/R1019/Partition Walls (Cubicles)/S11					Chrysotile (white asbestos)
B000 - R1003 - Movement (6.92 m2)						
No Asbestos						
B000 - R1004 - Cleaning Distributed Store (7.2 m2)						
No Asbestos						

Product	Material Description	Extent	Location Reference	Material Condition	Risk Status	Control Priority
Sample No					Test Result	
B000 - R1005 - Distribution Board (1.14 m2)				Note: No inspection of live electrical installation.		
No Asbestos						
B000 - R1006 - General Storeroom (11.34 m2)						
Floor Coverings Res/Textile	Vinyl Tiles					
3503/B000/R0004/Floor Coverings Res/Textile/S9					No Asbestos Detected	
B000 - R1007 - Library Office/Workroom (23.18 m2)						
No Asbestos						
B000 - R1008 - Library Office/Workroom (17.77 m2)						
No Asbestos						
B000 - R1009 - Reading Area (265.83 m2)						
No Asbestos						
B000 - R1010 - Communications Room (23.3 m2)						
No Asbestos						
B000 - R1011 - Movement (18.79 m2)						
No Asbestos						
B000 - R1012 - Seminar/Study (12.77 m2)						
No Asbestos						
B000 - R1013 - Staff Toilet (3.22 m2)						
Partition Walls (Cubicles)	Compressed AC Sheet	3m2	Throughout	Good Condition (1)	Low (1)	Low Priority (2-3)
3503/B000/R1019/Partition Walls (Cubicles)/S11					Chrysotile (white asbestos)	
B000 - R1014 - K.L.A. Store (23.5 m2)						
No Asbestos						
B000 - R1015 - Raised Platform (11.88 m2)						
No Asbestos						
B000 - R1016 - Movement (5.26 m2)						
No Asbestos						
B000 - R1017 - Seminar/Study (12.9 m2)						
No Asbestos						
B000 - R1018 - Movement (7.87 m2)						
No Asbestos						
B000 - R1019 - Staff Toilet (3.24 m2)						
Partition Walls (Cubicles)	Compressed AC Sheet	3m2	Throughout	Good Condition (1)	Low (1)	Low Priority (2-3)
3503/B000/R1019/Partition Walls (Cubicles)/S11					Chrysotile (white asbestos)	
B000 - R1020 - Movement (5.42 m2)						
No Asbestos						
B000 - R1023 - Stairs (4.64 m2)						
No Asbestos						
B000 - R1024 - Stairs (6.47 m2)						
No Asbestos						
B000 - R9001 - Main Switch Board (13.8 m2)						
No Asbestos						

Product	Material Description	Extent	Location Reference	Material Condition	Risk Status	Control Priority
Sample No					Test Result	

B00P - Pupil Facilities - 1997 - Brick/Veneer (Brick/Veneer)

Exterior

Underfloor Voids - Slab on Ground No Asbestos Found

Ceiling Voids No Asbestos Found

Interior

B00P - R0001 - Movement (36.88 m2)

No Asbestos

B00P - R0002 - Communal Space (287.37 m2)

No Asbestos

B00P - R0003 - Raised Platform (48.76 m2)

No Asbestos

B00P - R0004 - Distribution Board (0.66 m2)

Note: No inspection of live electrical installation.

No Asbestos

B00P - R0005 - Cleaning Supplies (11.75 m2)

No Asbestos

B00P - R0006 - Plant (0.63 m2)

No Asbestos

B00P - R0007 - Garden Store (13.47 m2)

No Asbestos

B00P - R0008 - General Assistant/Bulk Store (14.2 m2)

No Asbestos

B00P - R0009 - Cleaning Supplies (12.45 m2)

No Asbestos

B00P - R0010 - Plant (0.71 m2)

No Asbestos

B00P - R0011 - Toilets - Girls (7.96 m2)

No Asbestos

B00P - R0012 - Disabled Toilet (6.43 m2)

No Asbestos

B00P - R0013 - Cleaning Distributed Store (3.27 m2)

No Asbestos

B00P - R0014 - Sports Store (16.39 m2)

No Asbestos

B00P - R0015 - General Storeroom (9.79 m2)

No Asbestos

B00P - R0016 - Hall Chair Store (16.3 m2)

No Asbestos

B00P - R0017 - Toilets - Boys (5.96 m2)

No Asbestos

B00P - R0018 - Shower/Change (2.45 m2)

No Asbestos

B00P - R0019 - Movement (1.33 m2)

No Asbestos

Product	Material Description	Extent	Location Reference	Material Condition	Risk Status	Control Priority
Sample No					Test Result	

B00Q - General Learning/Building Services - 2011 - Brick/Veneer (Brick/Veneer)

Exterior

Underfloor Voids - Slab on Ground No Asbestos Found

Ceiling Voids No Asbestos Found

Interior

B00Q - R0001 - External Movement (110.92 m2)

No Asbestos

B00Q - R0002 - Clerical Office (11.97 m2)

No Asbestos

B00Q - R0003 - Clerical Office (17 m2)

No Asbestos

B00Q - R0004 - Clerical Office (12.01 m2)

No Asbestos

B00Q - R0005 - No Access (4.19 m2)

No Asbestos

B00Q - R0006 - Special Programs Room (44.23 m2)

No Asbestos

B00Q - R0007 - Practical Activities/Movement - 1hb (19.14 m2)

No Asbestos

B00Q - R0008 - Home Base Store (6.25 m2)

No Asbestos

B00Q - R0009 - Home Base (59.7 m2)

No Asbestos

B00Q - R0010 - Withdrawal Space - 2hb (11.57 m2)

No Asbestos

B00Q - R0011 - Home Base (60.46 m2)

No Asbestos

B00Q - R0012 - Home Base Store (6.21 m2)

No Asbestos

B00Q - R0013 - Practical Activities/Movement - 1hb (18.85 m2)

No Asbestos

B00Q - R0014 - Practical Activities/Movement - 1hb (18.96 m2)

No Asbestos

B00Q - R0015 - Home Base Store (6.23 m2)

No Asbestos

B00Q - R0016 - Home Base (60.33 m2)

No Asbestos

B00Q - R0017 - Withdrawal Space - 2hb (11.61 m2)

No Asbestos

B00Q - R0018 - Home Base (60.98 m2)

No Asbestos

B00Q - R0019 - Home Base Store (6.21 m2)

No Asbestos

B00Q - R0020 - Practical Activities/Movement - 1hb (18.96 m2)

No Asbestos

B00Q - R0021 - No Access (0.68 m2)

No Asbestos

Product	Material Description	Extent	Location Reference	Material Condition	Risk Status	Control Priority
Sample No					Test Result	

B00Q - R0022 - No Access (0.76 m2)

No Asbestos

2017

Product	Material Description	Extent	Location Reference	Material Condition	Risk Status	Control Priority
Sample No					Test Result	

Demountables

There are no Demountable(s) located at this school as per the AMS records as of 15 Feb 2017.

2017

Product	Material Description	Extent	Location Reference	Material Condition	Risk Status	Control Priority
Sample No					Test Result	

Listing of Electronic Attachments as of 22/03/2017

There are no asbestos related file attachment(s) for this school.

2017