

# Asbestos Register

(Hazardous Materials and Risk Assessment)

**School :** Undercliffe Public School (3310)  
**Region :** Sydney  
**State Electorate :** Canterbury  
**Local Government Area :** Canterbury

**Initial Survey :** Noel Arnold & Associates : 06 - Apr - 2008  
**Register Issue Date :** 22 - Mar - 2017

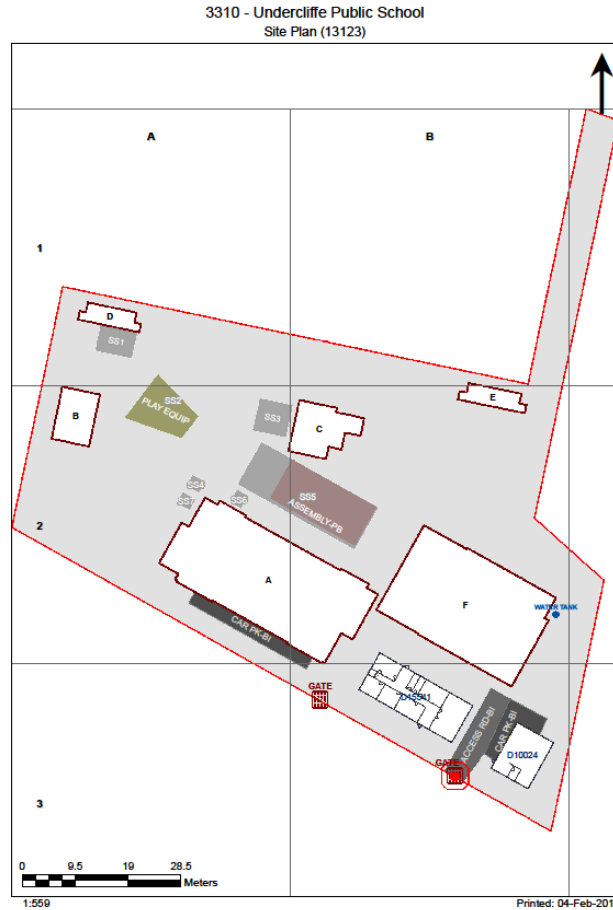

2017

Product	Material Description	Extent	Location Reference	Material Condition	Risk Status	Control Priority
Sample No					Test Result	

**B00A - General Learning/Library - 1927 - Brick/Block (Brick/Block)**

**Exterior**

Eaves Linings	Flat AC Sheeting	80m2	All surfaces	Good Condition (1)	Low (1)	Low Priority (2-3)
<b>Assumed Asbestos</b>						
Ceiling Voids	Requires Inspection					
Underfloor Voids	Requires Inspection					

**Interior**

**B00A - R0001 - Movement**

Ceiling Structures/Linings	Flat AC Sheeting	20m2	All surfaces	Good Condition (1)	Low (1)	Low Priority (2-3)
3310/B00A/R0009/Ceiling Structures/Linings/S6					<b>Chrysotile (white asbestos)</b>	

**B00A - R0002 - Cleaning Supplies**

No Asbestos

**B00A - R0003 - Movement**

No Asbestos

**B00A - R0004 - Home Base**

No Asbestos

**B00A - R0005 - Home Base**

No Asbestos

**B00A - R0006 - Home Base**

No Asbestos

**B00A - R0007 - Home Base**

No Asbestos

**B00A - R0008 - Staff Room Annexe**

No Asbestos

**B00A - R0009 - Movement**

Ceiling Structures/Linings	Flat AC Sheeting	10m2	North facing, Variable positions	Good Condition (1)	Low (1)	Low Priority (2-3)
3310/B00A/R0009/Ceiling Structures/Linings/S6					<b>Chrysotile (white asbestos)</b>	

**B00A - R0010 - Movement**

No Asbestos

**B00A - R0011 - Movement**

No Asbestos

**B00A - R0012 - Sports Store**

Floor Coverings Res/Textile	Vinyl Tiles					
3310/B00A/R0018/Floor Coverings Res/Textile/S8					<b>No Asbestos Detected</b>	

**B00A - R0013 - General Storeroom**

Floor Coverings Res/Textile	Vinyl Tiles					
3310/B00A/R0018/Floor Coverings Res/Textile/S8					<b>No Asbestos Detected</b>	

**B00A - R0014 - Staff Toilet**

Wall Linings Internal	Flat AC Sheeting					
3310/B00A/R0014/Wall Linings Internal/S5					<b>No Asbestos Detected</b>	

**B00A - R0015 - Practical Activities - 1hb**

Ceiling Structures/Linings	Flat AC Sheeting	55m2	All surfaces	Good Condition (1)	Low (1)	Low Priority (2-3)
3310/B00A/R0009/Ceiling Structures/Linings/S6					<b>Chrysotile (white asbestos)</b>	

**B00A - R0016 - Communal Space**

Ceiling Structures/Linings	Flat AC Sheeting	34m2	All surfaces	Good Condition (1)	Low (1)	Low Priority (2-3)
3310/B00A/R0009/Ceiling Structures/Linings/S6					<b>Chrysotile (white asbestos)</b>	

Product	Material Description	Extent	Location Reference	Material Condition	Risk Status	Control Priority
Sample No				Test Result		
<b>B00A - R0017 - Movement</b>						
Wall Linings Internal	Flat AC Sheeting	6m2	North facing, Variable positions	Good Condition (1)	Low (1)	Low Priority (2-3)
	3310/B00A/R0017/Wall Linings Internal/S7				Chrysotile (white asbestos)	
<b>B00A - R0018 - Security Store</b>						
Floor Coverings Res/Textile	Vinyl Tiles					
	3310/B00A/R0018/Floor Coverings Res/Textile/S8				No Asbestos Detected	
<b>B00A - R0019 - Raised Platform</b>						
Ceiling Structures/Linings	Flat AC Sheeting	24m2	All surfaces	Good Condition (1)	Low (1)	Low Priority (2-3)
	3310/B00A/R0009/Ceiling Structures/Linings/S6				Chrysotile (white asbestos)	
<b>B00A - R0020 - Stairs</b>						
Recently Modified Space	Requires Inspection					
<b>B00A - R0021 - Stairs</b>						
Recently Modified Space	Requires Inspection					
<b>B00A - R1001 - Cleaning Distributed Store</b>						
Ceiling Structures/Linings	Flat AC Sheeting	7m2	All surfaces	Good Condition (1)	Low (1)	Low Priority (2-3)
	3310/B00A/R0009/Ceiling Structures/Linings/S6				Chrysotile (white asbestos)	
Floor Coverings Res/Textile	Vinyl Tiles					
	3310/B00A/R1001/Floor Coverings Res/Textile/S9				No Asbestos Detected	
<b>B00A - R1002 - Movement</b>						
Ceiling Structures/Linings	Flat AC Sheeting	9m2	All surfaces	Good Condition (1)	Low (1)	Low Priority (2-3)
	3310/B00A/R0009/Ceiling Structures/Linings/S6				Chrysotile (white asbestos)	
Floor Coverings Res/Textile	Vinyl Tiles					
	3310/B00A/R0018/Floor Coverings Res/Textile/S8				No Asbestos Detected	
<b>B00A - R1003 - Movement</b>						
Ceiling Structures/Linings	Flat AC Sheeting	37m2	All surfaces	Good Condition (1)	Low (1)	Low Priority (2-3)
	3310/B00A/R0009/Ceiling Structures/Linings/S6				Chrysotile (white asbestos)	
<b>B00A - R1004 - Home Base</b>						
Ceiling Structures/Linings	Flat AC Sheeting	50m2	All surfaces	Good Condition (1)	Low (1)	Low Priority (2-3)
	3310/B00A/R0009/Ceiling Structures/Linings/S6				Chrysotile (white asbestos)	
<b>B00A - R1005 - Home Base</b>						
Ceiling Structures/Linings	Flat AC Sheeting	49m2	All surfaces	Good Condition (1)	Low (1)	Low Priority (2-3)
	3310/B00A/R0009/Ceiling Structures/Linings/S6				Chrysotile (white asbestos)	
<b>B00A - R1007 - Security Store</b>						
Ceiling Structures/Linings	Flat AC Sheeting	21m2	All surfaces	Good Condition (1)	Low (1)	Low Priority (2-3)
	3310/B00A/R0009/Ceiling Structures/Linings/S6				Chrysotile (white asbestos)	
Floor Coverings Res/Textile	Vinyl Tiles					
	3310/B00A/R1001/Floor Coverings Res/Textile/S9				No Asbestos Detected	
<b>B00A - R1008 - Library Office/Workroom</b>						
Ceiling Structures/Linings	Flat AC Sheeting	6m2	All surfaces	Good Condition (1)	Low (1)	Low Priority (2-3)
	3310/B00A/R0009/Ceiling Structures/Linings/S6				Chrysotile (white asbestos)	
<b>B00A - R1009 - K.L.A. Store</b>						
Ceiling Structures/Linings	Flat AC Sheeting	12m2	All surfaces	Good Condition (1)	Low (1)	Low Priority (2-3)
	3310/B00A/R0009/Ceiling Structures/Linings/S6				Chrysotile (white asbestos)	

Product	Material Description	Extent	Location Reference	Material Condition	Risk Status	Control Priority
Sample No					Test Result	
<b>B00A - R1011 - Movement</b>						
Ceiling Structures/Linings	Flat AC Sheeting	2m2	All surfaces	Good Condition (1)	Low (1)	Low Priority (2-3)
	3310/B00A/R0009/Ceiling Structures/Linings/S6					<b>Chrysotile (white asbestos)</b>
Floor Coverings Res/Textile	Vinyl Tiles					
	3310/B00A/R0018/Floor Coverings Res/Textile/S8					<b>No Asbestos Detected</b>
<b>B00A - R1012 - Toilets - Boys/Girls</b>						
Ceiling Structures/Linings	Flat AC Sheeting	2m2	All surfaces	Good Condition (1)	Low (1)	Low Priority (2-3)
	3310/B00A/R0009/Ceiling Structures/Linings/S6					<b>Chrysotile (white asbestos)</b>
<b>B00A - R1013 - Home Base</b>						
Recently Modified Space	Requires Inspection					
<b>B00A - R1014 - Reading Area</b>						
Recently Modified Space	Requires Inspection					
<b>B00A - R1015 - Reading Area</b>						
Recently Modified Space	Requires Inspection					
<b>B00A - R1016 - Stairs</b>						
Recently Modified Space	Requires Inspection					
<b>B00A - R1017 - Stairs</b>						
Recently Modified Space	Requires Inspection					

2017

Product	Material Description	Extent	Location Reference	Material Condition	Risk Status	Control Priority
Sample No					Test Result	

**B00B - Pupil Facilities/Building Services - 1927 - Timber (Timber)**

**Exterior**

Eaves Linings	Flat AC Sheeting	30m2	All surfaces	Good Condition (1)	Low (1)	Low Priority (2-3)
	3310/B00B/Eaves Linings/S4					<b>Chrysotile (white asbestos)</b>
Ceiling Voids	Requires Inspection					
Underfloor Voids	Requires Inspection					

**Interior**

**B00B - R0001 - Movement**

No Asbestos

**B00B - R0002 - Canteen**

No Asbestos

**B00B - R0003 - General Assistant/Bulk Store**

No Asbestos

2017

Product	Material Description	Extent	Location Reference	Material Condition	Risk Status	Control Priority
Sample No					Test Result	

**B00C - General Learning/Pupil Facilities - 1927 - Timber (Timber)**

**Exterior**

Eaves Linings	Flat AC Sheeting	30m2	All surfaces	Good Condition (1)	Low (1)	Low Priority (2-3)
	3310/B00B/Eaves Linings/S4					<b>Chrysotile (white asbestos)</b>
Ceiling Voids	Requires Inspection					
Underfloor Voids	Requires Inspection					

**Interior**

**B00C - R0001 - Movement**

No Asbestos

**B00C - R0002 - Home Base**

No Asbestos

**B00C - R0003 - Practical Activities - 1hb**

No Asbestos

**B00C - R0004 - Drinking Facilities**

No Asbestos

2017

Product	Material Description	Extent	Location Reference	Material Condition	Risk Status	Control Priority
Sample No					Test Result	

**B00D - Pupil Facilities - 1927 - Brick/Block (Brick/Block)**

**Exterior**

Wall lining	Flat AC Sheeting 3310/B00E/Wall lining/S3					<b>No Asbestos Detected</b>
Ceiling Voids	Requires Inspection					
Underfloor Voids	Requires Inspection					

**Interior**

**B00D - R0001 - Toilets - Girls**

Ceiling Structures/Linings	Flat AC Sheeting 3310/B00E/R0001/Ceiling Structures/Linings/S1					<b>No Asbestos Detected</b>
Partition Walls (Cubicles)	Compressed AC Sheet 3310/B00E/R0001/Partition Walls (Cubicles)/S2	16m2	Variable positions	Good Condition (1)	Low (1) Low Priority (2-3)	<b>Chrysotile (white asbestos)</b>
Wall Linings Internal	Flat AC Sheeting 3310/B00E/Wall lining/S3					<b>No Asbestos Detected</b>

**B00D - R0002 - Cleaning Distributed Store**

Ceiling Structures/Linings	Flat AC Sheeting 3310/B00E/R0001/Ceiling Structures/Linings/S1					<b>No Asbestos Detected</b>
Wall Linings Internal	Flat AC Sheeting 3310/B00E/Wall lining/S3					<b>No Asbestos Detected</b>

2017

Product	Material Description	Extent	Location Reference	Material Condition	Risk Status	Control Priority
Sample No					Test Result	

**B00E - Pupil Facilities - 1927 - Brick/Block (Brick/Block)**

**Exterior**

Wall lining	Flat AC Sheeting 3310/B00E/Wall lining/S3					<b>No Asbestos Detected</b>
Ceiling Voids	Requires Inspection					
Underfloor Voids	Requires Inspection					

**Interior**

**B00E - R0001 - Toilets - Boys**

Ceiling Structures/Linings	Flat AC Sheeting 3310/B00E/R0001/Ceiling Structures/Linings/S1					<b>No Asbestos Detected</b>
Partition Walls (Cubicles)	Compressed AC Sheet 3310/B00E/R0001/Partition Walls (Cubicles)/S2	8m2	Variable positions	Good Condition (1)	Low (1) Low Priority (2-3)	<b>Chrysotile (white asbestos)</b>
Wall Linings Internal	Flat AC Sheeting 3310/B00E/Wall lining/S3					<b>No Asbestos Detected</b>

**B00E - R0002 - Cleaning Distributed Store**

Ceiling Structures/Linings	Flat AC Sheeting 3310/B00E/R0001/Ceiling Structures/Linings/S1					<b>No Asbestos Detected</b>
Wall Linings Internal	Flat AC Sheeting 3310/B00E/Wall lining/S3					<b>No Asbestos Detected</b>

2017



Product	Material Description	Extent	Location Reference	Material Condition	Risk Status	Control Priority
	Sample No					Test Result

**B00F - Communal Facilities - 2010 - Brick/Veneer (Brick/Veneer)****Exterior**

Ceiling Voids	No Asbestos Found
Underfloor Voids	Requires Inspection

**Interior****B00F - R0001 - Communal Space**

No Asbestos

**B00F - R0002 - Raised Platform**

No Asbestos

**B00F - R0003 - Hall Chair Store**

No Asbestos

**B00F - R0004 - Communal/Performance Store**

No Asbestos

**B00F - R0005 - P.E. Store**

No Asbestos

**B00F - R0006 - Toilet - Lobby**

No Asbestos

**B00F - R0007 - Toilets - Girls**

No Asbestos

**B00F - R0008 - Sound Cupboard**

No Asbestos

**B00F - R0009 - Toilet - Lobby**

No Asbestos

**B00F - R0010 - Toilets - Boys**

No Asbestos

**B00F - R0011 - Cleaning Distributed Store**

No Asbestos

**B00F - R0012 - Plant**

No Asbestos

**B00F - R0013 - Main Switch Board**

No Asbestos

**B00F - R0014 - Access Shower/Toilet/Change**

No Asbestos

**B00F - R0015 - Covered Outdoor Learning Area**

No Asbestos

**B00F - R0016 - Movement**

No Asbestos

**B00F - R0017 - Movement**

No Asbestos

**B00F - R0018 - Other**

No Asbestos

**B00F - R0019 - Ramp**

No Asbestos

Product	Material Description	Extent	Location Reference	Material Condition	Risk Status	Control Priority
Sample No					Test Result	

## Demountables

**Demountable details as per the AMS records as of 15 Feb 2017.**

**OS 602 - D10024 - Learning Unit - Standard With P.A.A. : Placement Date - 14/12/2012**

### Exterior

No Asbestos Found.

### Interior

#### R1 - Learning space/withdrawal/entry

No Asbestos Found.

#### R2 - Home Base Store

No Asbestos Found.

**OS 502 - D15541 - Admin Staff/Principal/Clerk/Dup/Clinic : Placement Date - 30/06/1995**

### Exterior

Step Treads	Compressed AC Sheet	Assumed Asbestos	1.08 m2
Landing	Compressed AC Sheet	Assumed Asbestos	1.2 m2
Eave Lining	Flat AC Sheet	Assumed Asbestos	23.04 m2

### Interior

#### R1 - Clerical Office

End wall panel	Flat AC Sheet	Assumed Asbestos	18 m2
Ceiling	Flat AC Sheet	Assumed Asbestos	16 m2

#### R10 - Store

Ceiling	Flat AC Sheet	Assumed Asbestos	12 m2
---------	---------------	------------------	-------

#### R2 - Security Store

Ceiling	Flat AC Sheet	Assumed Asbestos	1 m2
---------	---------------	------------------	------

#### R3 - Duplicating Wookroom

Ceiling	Flat AC Sheet	Assumed Asbestos	12 m2
---------	---------------	------------------	-------

#### R4 - Clinic-Waiting

Ceiling	Flat AC Sheet	Assumed Asbestos	16 m2
---------	---------------	------------------	-------

#### R5 - Staff Room

Ceiling	Flat AC Sheet	Assumed Asbestos	36 m2
---------	---------------	------------------	-------

#### R6 - Principal

Ceiling	Flat AC Sheet	Assumed Asbestos	16 m2
---------	---------------	------------------	-------

#### R7 - Staff Toilet

Toilet partitions	Compressed AC Sheet	Assumed Asbestos	2 m2
Ceiling	Flat AC Sheet	Assumed Asbestos	5 m2

#### R8 - Staff Toilet

Toilet partitions	Compressed AC Sheet	Assumed Asbestos	2 m2
Ceiling	Flat AC Sheet	Assumed Asbestos	5 m2

#### R9 - Entry

End wall panel	Flat AC Sheet	Assumed Asbestos	18 m2
Ceiling	Flat AC Sheet	Assumed Asbestos	27 m2

Product	Material Description	Extent	Location Reference	Material Condition	Risk Status	Control Priority
Sample No					Test Result	

*Listing of Electronic Attachments as of 22/03/2017*

**There are no asbestos related file attachment(s) for this school.**

2017