

Asbestos Register

(Hazardous Materials and Risk Assessment)

School : Parramatta High School (8135)
Region : Western Sydney
State Electorate : Parramatta
Local Government Area : Parramatta

Initial Survey : Noel Arnold & Associates : 02 - May - 2008
Reviewed By : Parsons Brinckerhoff : 07 - Feb - 2017

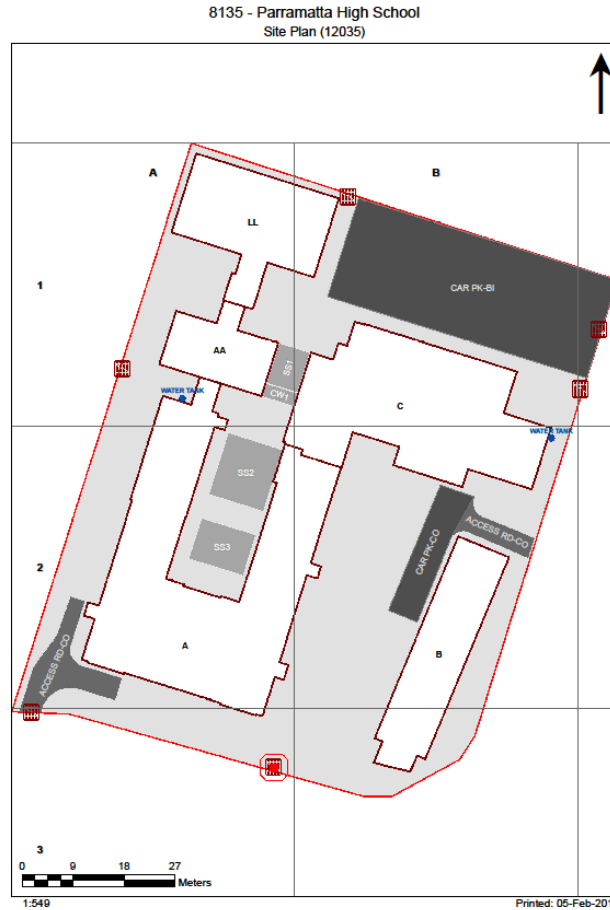

2017

Product	Material Description	Extent	Location Reference	Material Condition	Risk Status	Control Priority
Sample No					Test Result	

B00A - General Learning/Administration - 1913 - Brick/Block (Brick/Block)**Exterior**

Underfloor Voids	No Asbestos Found					
Ceiling Voids	No Asbestos Found					
Eaves Linings	Flat AC Sheeting	300m2	Throughout	Good Condition (1)	Low (1)	Low Priority (2-3)

Assumed Asbestos - No access due to height restriction**Interior****B00A - R0001 - General Learning Space (79.72 m2)**

Fume Cupboard	Flat AC Sheeting	1Unit	South	Good Condition (1)	Low (1)	Low Priority (2-3)
	8135/B00A/R0001/Fume Cupboard/S16					Chrysotile (white asbestos) , Amosite (brown asbestos)

B00A - R0002 - General Storeroom (9.86 m2)

Floor Coverings Res/Textile	Vinyl Tiles					
	8135/B00A/R0002/Floor Coverings Res/Textile/S17					No Asbestos Detected
Flue	Fibre Cement Pipe	2m	North, East	Good Condition (1)	Low (1)	Low Priority (2-3)
	8135/B00A/R0002/Flue/S18					Chrysotile (white asbestos) , Amosite (brown asbestos)

B00A - R0003 - Staff Study (16.77 m2)

No Asbestos

B00A - R0004 - General Learning Space (51.22 m2)

No Asbestos

B00A - R0005 - General Learning Space (48.23 m2)

No Asbestos

B00A - R0006 - Movement (74.76 m2)

No Asbestos

B00A - R0007 - Interview/Office - Type 1 (10.37 m2)

No Asbestos

B00A - R0008 - Staff - Toilet (3.16 m2)

No Asbestos

B00A - R0009 - General Storeroom (7.79 m2)

No Asbestos

B00A - R0010 - Movement (2.45 m2)

No Asbestos

B00A - R0011 - Movement (2.13 m2)

No Asbestos

B00A - R0012 - General Learning Space (53.7 m2)

No Asbestos

B00A - R0013 - Movement (22.23 m2)

No Asbestos

B00A - R0014 - Main Switchroom (6.75 m2)

Electrical Mounting Board	Resinous Board	1Unit	North	Good Condition (1)	Low (1)	Low Priority (2-3)
	8135/B00A/R0014/Electrical Mounting Board/S24					Chrysotile (white asbestos)

B00A - R0015 - Commonroom (74.34 m2)

No Asbestos

B00A - R0016 - Administration - Clerical (26.33 m2)

No Asbestos

Product	Material Description	Extent	Location Reference	Material Condition	Risk Status	Control Priority
Sample No					Test Result	
B00A - R0017 - Administration - Clerical (27.04 m2)						
No Asbestos						
B00A - R0018 - Duplicating Workroom (26.21 m2)						
No Asbestos						
B00A - R0019 - Movement (80.57 m2)						
No Asbestos						
B00A - R0020 - Cleaning Store - Distributed (7.49 m2)						
No Asbestos						
B00A - R0021 - Movement (2.72 m2)						
No Asbestos						
B00A - R0022 - General Learning Space (52.43 m2)						
No Asbestos						
B00A - R0023 - Food Technology L.S. (52.93 m2)						
No Asbestos						
B00A - R0028 - Movement (46.45 m2)						
Flue	Moulded FC	2m	North	Good Condition (1)	Low (1)	Low Priority (2-3)
	8135/B00A/R0024/Flue/S15				Chrysotile (white asbestos) , Amosite (brown asbestos)	
B00A - R0029 - External Movement (29.26 m2)						
No Asbestos						
B00A - R0030 - Clinic - Boys (11.45 m2)						
No Asbestos						
B00A - R0031 - Staff - Toilet (2.92 m2)						
No Asbestos						
B00A - R0033 - Deputy Principal Office (19.97 m2)						
No Asbestos						
B00A - R0034 - Principal Office (19.55 m2)						
No Asbestos						
B00A - R0035 - External Movement (4.08 m2)						
Wall Linings Internal	Flat AC Sheeting					No Asbestos Detected
	8135/B00A/R0035/Wall Linings Internal/S13					
B00A - R0036 - Movement (2.89 m2)						
No Asbestos						
B00A - R0037 - Stairs (8.97 m2)						
No Asbestos						
B00A - R0038 - Stairs (15.5 m2)						
No Asbestos						
B00A - R0039 - Stairs (10.23 m2)						
No Asbestos						
B00A - R0040 - Stairs (10.25 m2)						
No Asbestos						
B00A - R0041 - Stairs (5.37 m2)						
No Asbestos						
B00A - R0042 - Food Technology L.S. (87.1 m2)						
No Asbestos						
B00A - R0043 - Pantry (18.97 m2)						
No Asbestos						
B00A - R0044 - Toilet - Lobby (1.65 m2)						

Product	Material Description	Extent	Location Reference	Material Condition	Risk Status	Control Priority
Sample No					Test Result	
No Asbestos						
B00A - R0045 - Toilets-Girls (1.91 m2)						
No Asbestos						
B00A - R0046 - Toilets-Girls (2 m2)						
No Asbestos						
B00A - R0047 - Toilet - Lobby (1.73 m2)						
No Asbestos						
B00A - R1001 - General Storeroom (7.24 m2)						
No Asbestos						
B00A - R1002 - Movement (6.33 m2)						
No Asbestos						
B00A - R1003 - Movement (5.76 m2)						
No Asbestos						
B00A - R1004 - Staff Study (24.39 m2)						
No Asbestos						
B00A - R1005 - Staff Study (10.9 m2)						
No Asbestos						
B00A - R1006 - Staff Study (10.9 m2)						
No Asbestos						
B00A - R1007 - Staff Study (86.08 m2)						
No Asbestos						
B00A - R1008 - Movement (44.01 m2)						
Ceiling Structures/Linings	Flat AC Sheeting					
	8135/B00A/R1008/Ceiling Structures/Linings/S19					No Asbestos Detected
B00A - R1009 - General Learning Space (52.93 m2)						
No Asbestos						
B00A - R1010 - General Learning Space (53.23 m2)						
No Asbestos						
B00A - R1011 - Movement (4.68 m2)						
No Asbestos						
B00A - R1012 - Staff - Toilet (5.86 m2)						
No Asbestos						
B00A - R1013 - Staff - Toilet (3.83 m2)						
No Asbestos						
B00A - R1014 - General Storeroom (17.65 m2)						
No Asbestos						
B00A - R1015 - General Learning Space (40.16 m2)						
No Asbestos						
B00A - R1016 - General Learning Space (21.94 m2)						
No Asbestos						
B00A - R1017 - General Learning Space (54.9 m2)						
No Asbestos						
B00A - R1018 - General Learning Space (24.38 m2)						
No Asbestos						
B00A - R1019 - General Storeroom (11.38 m2)						
No Asbestos						
B00A - R1020 - General Learning Space (74.62 m2)						
No Asbestos						

Product	Material Description	Extent	Location Reference	Material Condition	Risk Status	Control Priority
Sample No					Test Result	
B00A - R1021 - Design L.S. (54 m2)						
No Asbestos						
B00A - R1022 - Materials Store (8.82 m2)						
No Asbestos						
B00A - R1023 - General Storeroom (4.58 m2)						
No Asbestos						
B00A - R1024 - Movement (69.25 m2)						
No Asbestos						
B00A - R1025 - Movement (4.71 m2)						
No Asbestos						
B00A - R1026 - General Learning Space (48.77 m2)						
No Asbestos						
B00A - R1027 - General Learning Space (52.41 m2)						
No Asbestos						
B00A - R1028 - General Learning Space (52.13 m2)						
No Asbestos						
B00A - R1029 - General Learning Space (52.19 m2)						
No Asbestos						
B00A - R1030 - Movement (68.84 m2)						
No Asbestos						
B00A - R1031 - Cleaning Store - Distributed (1.73 m2)						
No Asbestos						
B00A - R1032 - Stairs (15.3 m2)						
No Asbestos						
B00A - R1033 - Stairs (15.44 m2)						
No Asbestos						
B00A - R1034 - Stairs (15.4 m2)						
No Asbestos						
B00A - R1035 - Stairs (13.29 m2)						
No Asbestos						
B00A - R9001 - Cleaning Store - Distributed (4.12 m2)						
No Asbestos						
B00A - R9002 - Student Drinking Facilities (29.82 m2)						
No Asbestos						
B00A - R9003 - Staff - Toilet (9.54 m2)						
No Asbestos						
B00A - R9004 - Seminar (9.51 m2)						
No Asbestos						
B00A - R9005 - General Storeroom (20.82 m2)						
No Asbestos						
B00A - R9006 - Toilets-Girls (85.56 m2)						
No Asbestos						
B00A - R9007 - General Storeroom (11.88 m2)						
No Asbestos						
B00A - R9008 - General Assistants (52.42 m2)						
No Asbestos						
B00A - R9009 - Cleaning Store - Distributed (11.35 m2)						
No Asbestos						

Product	Material Description	Extent	Location Reference	Material Condition	Risk Status	Control Priority
Sample No					Test Result	
B00A - R9010 - Laboratory L.S. (77.86 m2)						
Fume Cupboard	Flat AC Sheeting	1Unit	South, East	Good Condition (1)	Low (1)	Low Priority (2-3)
8135/B00A/R0001/Fume Cupboard/S16				Chrysotile (white asbestos) , Amosite (brown asbestos)		
B00A - R9011 - Preparation (25.16 m2)						
Fume Cupboard	Flat AC Sheeting	1Unit	North, East	Good Condition (1)	Low (1)	Low Priority (2-3)
8135/B00A/R0001/Fume Cupboard/S16				Chrysotile (white asbestos) , Amosite (brown asbestos)		
B00A - R9014 - General Storeroom (6.46 m2)						
No Asbestos						
B00A - R9015 - Movement (25.32 m2)						
No Asbestos						
B00A - R9016 - General Storeroom (31.72 m2)						
No Asbestos						
B00A - R9017 - General Storeroom (8.49 m2)						
No Asbestos						
B00A - R9018 - Movement (6.51 m2)						
No Asbestos						
B00A - R9019 - General Storeroom (4.42 m2)						
No Asbestos						
B00A - R9020 - External Movement (1.68 m2)						
Ceiling Structures/Linings	Flat AC Sheeting	2m2	Throughout	Good Condition (1)	Low (1)	Low Priority (2-3)
8135/B00A/R9020/Ceiling Structures/Linings/S14				Chrysotile (white asbestos) , Amosite (brown asbestos)		
B00A - R9021 - Commonroom (24.57 m2)						
No Asbestos						
B00A - R9022 - External Movement (4.18 m2)						
No Asbestos						
B00A - R9023 - Stairs (6.43 m2)						
No Asbestos						
B00A - R9024 - Stairs (3.95 m2)						
No Asbestos						
B00A - R9025 - Plant (2.86 m2)						
No Asbestos						
B00A - R9026 - Plant (53.28 m2)						
No Asbestos						
B00A - R9027 - Plant (24.48 m2)						
No Asbestos						
B00A - R9028 - Stairs (7.25 m2)						
No Asbestos						
B00A - R9029 - Stairs (5.37 m2)						
No Asbestos						

Product	Material Description	Extent	Location Reference	Material Condition	Risk Status	Control Priority
Sample No					Test Result	

B00B - Technological & Applied Studies - 1963 - Brick/Block (Brick/Block)**Exterior**

Eaves Linings	Flat AC Sheeting	150m2	Throughout	Good Condition (1)	Low (1)	Low Priority (2-3)
	8135/B00B/Eaves Linings/S25				Chrysotile (white asbestos) , Amosite (brown asbestos) , Crocidolite (blue asbestos)	
Underfloor Voids	No Asbestos Found					
Ceiling Voids	No Asbestos Found					

Interior**B00B - R0001 - Materials Store (13.09 m2)**

Ceiling Structures/Linings	Flat AC Sheeting	14m2	Throughout	Good Condition (1)	Low (1)	Low Priority (2-3)
	8135/B00B/R0001/Ceiling Structures/Linings/S20				Chrysotile (white asbestos) , Amosite (brown asbestos)	

B00B - R0002 - Materials Technology L.S. (53.07 m2)

Floor Coverings Res/Textile	Vinyl Tiles					
	8135/B00B/R0002/Floor Coverings Res/Textile/S22				No Asbestos Detected	

B00B - R0003 - Staff - Toilet (1.81 m2)

Wall Linings Internal	Flat AC Sheeting	10m2	Variable positions	Good Condition (1)	Low (1)	Low Priority (2-3)
	8135/B00B/R0003/Wall Linings Internal/S21				Chrysotile (white asbestos)	

B00B - R0004 - General Storeroom (11.24 m2)

Floor Coverings Res/Textile	Vinyl Tiles					
	8135/B00B/R0002/Floor Coverings Res/Textile/S22				No Asbestos Detected	

B00B - R0005 - Materials Technology L.S. (88.26 m2)

No Asbestos

B00B - R0006 - Materials Store (17.74 m2)

Ceiling Structures/Linings	Flat AC Sheeting	18m2	Throughout	Good Condition (1)	Low (1)	Low Priority (2-3)
	8135/B00B/R0001/Ceiling Structures/Linings/S20				Chrysotile (white asbestos) , Amosite (brown asbestos)	

B00B - R0007 - Staff Study (17.74 m2)

Ceiling Structures/Linings	Flat AC Sheeting	18m2	Throughout	Good Condition (1)	Low (1)	Low Priority (2-3)
	8135/B00B/R0001/Ceiling Structures/Linings/S20				Chrysotile (white asbestos) , Amosite (brown asbestos)	

B00B - R0008 - Movement (31.64 m2)

No Asbestos

B00B - R0009 - Materials Technology L.S. (76.63 m2)

Floor Coverings Res/Textile	Vinyl Tiles					
	8135/B00B/R0002/Floor Coverings Res/Textile/S22				No Asbestos Detected	
Wall Linings Internal	Flat AC Sheeting	7m2	West, Upper portion	Good Condition (1)	Low (1)	Low Priority (2-3)
	8135/B00B/R0003/Wall Linings Internal/S21				Chrysotile (white asbestos)	

B00B - R0010 - Materials Store (11.13 m2)

No Asbestos

B00B - R0011 - Welding Area (10.98 m2)

No Asbestos

B00B - R0012 - Materials Store (23.2 m2)

No Asbestos

B00B - R9001 - Art Learning Space (52.2 m2)

Product	Material Description	Extent	Location Reference	Material Condition	Risk Status	Control Priority
	Sample No					Test Result

No Asbestos

B00B - R9002 - General Storeroom (4.45 m2)

No Asbestos

B00B - R9003 - Movement (7.62 m2)

No Asbestos

B00B - R9004 - Art Learning Space (66.02 m2)

No Asbestos

2017

Product	Material Description	Extent	Location Reference	Material Condition	Risk Status	Control Priority
Sample No					Test Result	

B00C - Multi Purpose Facilities/General Learning - 1955 - Brick/Block (Brick/Block)

Exterior

Eaves Linings	Flat AC Sheeting	300m2	Throughout	Good Condition (1)	Low (1)	Low Priority (2-3)
---------------	------------------	-------	------------	--------------------	---------	--------------------

Assumed Asbestos - No access due to height restrictions

Underfloor Voids	No Asbestos Found
------------------	-------------------

ceiling Voids	No Asbestos Found
---------------	-------------------

Interior

B00C - R0001 - Music Learning Space (64.99 m2)

No Asbestos

B00C - R0004 - Kiln Space (18.72 m2)

No Asbestos

B00C - R0005 - Art Learning Space (29.98 m2)

No Asbestos

B00C - R0006 - Bulk Store (14.04 m2)

No Asbestos

B00C - R0007 - Darkroom Space (9.24 m2)

No Asbestos

B00C - R0008 - Music Store (13.55 m2)

No Asbestos

B00C - R0009 - Toilets-Boys (80.42 m2)

Partition Walls (Cubicles)	Compressed AC Sheet	8135/B00C/R0009/Partition Walls (Cubicles)/S1	No Asbestos Detected
----------------------------	---------------------	---	-----------------------------

B00C - R0010 - Cleaning Store - Distributed (4.41 m2)

No Asbestos

B00C - R0011 - Movement (14.15 m2)

No Asbestos

B00C - R0012 - Movement (9.84 m2)

No Asbestos

B00C - R0013 - External Movement (1.63 m2)

No Asbestos

B00C - R0014 - Music Learning Space (65.9 m2)

No Asbestos

B00C - R0015 - General Storeroom (20.62 m2)

No Asbestos

B00C - R0016 - Stairs (6.81 m2)

No Asbestos

B00C - R0017 - General Storeroom (7.32 m2)

No Asbestos

B00C - R1001 - Movement (7.14 m2)

No Asbestos

B00C - R1003 - Cleaning Store - Distributed (11.26 m2)

Ceiling Structures/Linings	Vermiculite	8135/B00C/R1003/Ceiling Structures/Linings/S3	Limited Samples Taken
			Vermiculite Ceilings may contain asbestos. Asbestos testing MUST be conducted prior to any disturbance works

B00C - R1004 - Movement (51.87 m2)

Ceiling Structures/Linings	Vermiculite	8135/B00C/R1003/Ceiling Structures/Linings/S3	Limited Samples Taken
			Vermiculite Ceilings may contain asbestos. Asbestos testing MUST be conducted prior to any disturbance works

Product	Material Description	Extent	Location Reference	Material Condition	Risk Status	Control Priority
Sample No					Test Result	
B00C - R1005 - General Learning Space (51.47 m2)						
No Asbestos						
B00C - R1006 - Cleaning Store - Distributed (7.17 m2)						
No Asbestos						
B00C - R1007 - Cleaning Supplies Store (14.39 m2)						
No Asbestos						
B00C - R1008 - Student Canteen (63.38 m2)						
Ceiling Structures/Linings	Vermiculite					
	8135/B00C/R1003/Ceiling Structures/Linings/S3					Limited Samples Taken
	Vermiculite Ceilings may contain asbestos. Asbestos testing MUST be conducted prior to any disturbance works					
Floor Coverings Res/Textile	Vinyl Tiles	64m2	Throughout	Good Condition (1)	Low (1)	Low Priority (2-3)
	8135/B00C/R1008/Floor Coverings Res/Textile/S4					Chrysotile (white asbestos)
B00C - R1009 - General Storeroom (5.03 m2)						
Floor Coverings Res/Textile	Vinyl Tiles	6m2	Throughout	Good Condition (1)	Low (1)	Low Priority (2-3)
	8135/B00C/R1008/Floor Coverings Res/Textile/S4					Chrysotile (white asbestos)
B00C - R1010 - Staff - Toilet (6.75 m2)						
Floor Coverings Res/Textile	Vinyl Tiles	7m2	Throughout	Good Condition (1)	Low (1)	Low Priority (2-3)
	8135/B00C/R1008/Floor Coverings Res/Textile/S4					Chrysotile (white asbestos)
Ceiling Structures/Linings	Flat AC Sheeting	7m2	Throughout	Good Condition (1)	Low (1)	Low Priority (2-3)
	8135/B00C/R1015/Ceiling Structures/Linings/S2					Chrysotile (white asbestos)
B00C - R1011 - Movement (2.88 m2)						
No Asbestos						
B00C - R1015 - Staff Shower (10.14 m2)						
Ceiling Structures/Linings	Flat AC Sheeting	11m2	Throughout	Good Condition (1)	Low (1)	Low Priority (2-3)
	8135/B00C/R1015/Ceiling Structures/Linings/S2					Chrysotile (white asbestos)
B00C - R1018 - Staff Shower (10.07 m2)						
Floor Coverings Res/Textile	Vinyl Tiles	8m2	Throughout	Good Condition (1)	Low (1)	Low Priority (2-3)
	8135/B00C/R1018/Floor Coverings Res/Textile/S26					Chrysotile (white asbestos)
Ceiling Structures/Linings	Flat AC Sheeting	8m2	Throughout	Good Condition (1)	Low (1)	Low Priority (2-3)
	8135/B00C/R1018/Ceiling Structures/Linings/S27					Chrysotile (white asbestos) , Amosite (brown asbestos) , Crocidolite (blue asbestos)
B00C - R1019 - Movement (10.97 m2)						
Ceiling Structures/Linings	Flat AC Sheeting	11m2	Throughout	Good Condition (1)	Low (1)	Low Priority (2-3)
	8135/B00C/R1015/Ceiling Structures/Linings/S2					Chrysotile (white asbestos)
B00C - R1020 - Movement (9.74 m2)						
No Asbestos						
B00C - R1021 - External Movement (19 m2)						
No Asbestos						
B00C - R1022 - General Learning Space (41.07 m2)						
No Asbestos						
B00C - R1023 - External Movement (9.91 m2)						
Ceiling Structures/Linings	Flat AC Sheeting	10m2	Throughout	Good Condition (1)	Low (1)	Low Priority (2-3)
	8135/B00C/R1015/Ceiling Structures/Linings/S2					Chrysotile (white asbestos)
B00C - R1024 - Stairs (4 m2)						
No Asbestos						

Product	Material Description	Extent	Location Reference	Material Condition	Risk Status	Control Priority
Sample No					Test Result	
B00C - R1026 - Change (31.19 m2)						
No Asbestos						
B00C - R1027 - Stairs (11.52 m2)						
No Asbestos						
B00C - R1028 - Stairs (8.69 m2)						
No Asbestos						
B00C - R1032 - General Learning Space (59.86 m2)						
No Asbestos						
B00C - R1033 - Movement (11.95 m2)						
No Asbestos						
B00C - R1034 - General Storeroom (3.7 m2)						
No Asbestos						
B00C - R1035 - Garden Store Room (13.76 m2)						
No Asbestos						
B00C - R1036 - Student Change - Type 2 (31.28 m2)						
No Asbestos						
B00C - R1037 - Garden Store Room (1.59 m2)						
No Asbestos						
B00C - R1038 - Movement (233.47 m2)						
No Asbestos						
B00C - R2001 - Movement (12.56 m2)						
Ceiling Structures/Linings	Flat AC Sheeting	13m2	Throughout	Good Condition (1)	Low (1)	Low Priority (2-3)
8135/B00C/R2011/Ceiling Structures/Linings/S6				Chrysotile (white asbestos) , Amosite (brown asbestos)		
B00C - R2002 - Stage (121.13 m2)						
No Asbestos						
B00C - R2003 - Multi-Purpose Space (358.79 m2)						
No Asbestos						
B00C - R2004 - General Learning Space (51.84 m2)						
No Asbestos						
B00C - R2005 - Movement (7.9 m2)						
Wall Linings Internal	Flat AC Sheeting					
8135/B00C/R2005/Wall Linings Internal/S7				No Asbestos Detected		
B00C - R2006 - Distribution Board Cupboard (0.42 m2)						
						Note: No inspection of live electrical installation.
No Asbestos						
B00C - R2007 - Movement (31.89 m2)						
No Asbestos						
B00C - R2008 - Interview/Office - Type 1 (10.3 m2)						
Floor Coverings Res/Textile	Vinyl Tiles	11m2	Throughout	Good Condition (1)	Low (1)	Low Priority (2-3)
8135/B00C/R2009/Floor Coverings Res/Textile/S5				Chrysotile (white asbestos)		
B00C - R2009 - Interview/Office - Type 1 (8.56 m2)						
Floor Coverings Res/Textile	Vinyl Tiles	9m2	Throughout	Good Condition (1)	Low (1)	Low Priority (2-3)
8135/B00C/R2009/Floor Coverings Res/Textile/S5				Chrysotile (white asbestos)		
B00C - R2010 - Chair Store (16.61 m2)						
No Asbestos						
B00C - R2011 - Movement (14.2 m2)						

Product	Material Description	Extent	Location Reference	Material Condition	Risk Status	Control Priority
Sample No					Test Result	
Ceiling Structures/Linings	Flat AC Sheeting	15m2	Throughout	Good Condition (1)	Low (1)	Low Priority (2-3)
8135/B00C/R2011/Ceiling Structures/Linings/S6				Chrysotile (white asbestos) , Amosite (brown asbestos)		
B00C - R2012 - Distribution Board Cupboard (0.79 m2)				Note: No inspection of live electrical installation.		
No Asbestos						
B00C - R2017 - External Movement (7.45 m2)						
No Asbestos						
B00C - R2018 - Stairs (13.53 m2)						
No Asbestos						
B00C - R2019 - Stairs (4.86 m2)						
No Asbestos						
B00C - R2020 - Stairs (4.94 m2)						
No Asbestos						
B00C - R2021 - General Learning Space (44.15 m2)						
No Asbestos						
B00C - R2022 - General Learning Space (33.78 m2)						
No Asbestos						
B00C - R2023 - Movement (9.51 m2)						
No Asbestos						
B00C - R3001 - Control Room (17.34 m2)						
No Asbestos						
B00C - R3002 - General Learning Space (53.58 m2)						
No Asbestos						
B00C - R3003 - Movement (9.88 m2)						
Ceiling Structures/Linings	Flat AC Sheeting	10m2	Throughout	Good Condition (1)	Low (1)	Low Priority (2-3)
8135/B00C/R2011/Ceiling Structures/Linings/S6				Chrysotile (white asbestos) , Amosite (brown asbestos)		
B00C - R3004 - General Learning Space (53.61 m2)						
No Asbestos						
B00C - R3005 - Stairs (11.98 m2)						
No Asbestos						
B00C - R9001 - Cleaning Supplies Store (41.22 m2)						
No Asbestos						
B00C - R9002 - Sport Equipment Store (41.58 m2)						
No Asbestos						

2017

Product	Material Description	Extent	Location Reference	Material Condition	Risk Status	Control Priority
Sample No					Test Result	

B0AA - General Learning - 1970 - Brick/Block (Brick/Block)**Exterior**

In-fill-panel	Flat AC Sheeting 8135/B0AA/In-fill-panel/S23					No Asbestos Detected
Underfloor Voids	No Asbestos Found					
Ceiling Voids	No Asbestos Found					
Eaves Linings	Flat AC Sheeting	60m2	Throughout	Good Condition (1)	Low (1)	Low Priority (2-3)

Assumed Asbestos - No access due to height restrictions

Interior**B0AA - R0001 - General Learning Space (52.85 m2)**

Ceiling Structures/Linings	Vermiculite 8135/B0AA/R0003/Ceiling Structures/Linings/S12					Limited Samples Taken
Vermiculite Ceilings may contain asbestos. Asbestos testing MUST be conducted prior to any disturbance works						

B0AA - R0002 - Distribution Board Cupboard (0.23 m2)

Note: No inspection of live electrical installation.

No Asbestos

B0AA - R0003 - General Learning Space (52.92 m2)

Ceiling Structures/Linings	Vermiculite 8135/B0AA/R0003/Ceiling Structures/Linings/S12					Limited Samples Taken
Vermiculite Ceilings may contain asbestos. Asbestos testing MUST be conducted prior to any disturbance works						

B0AA - R0004 - General Storeroom (6.66 m2)

Ceiling Structures/Linings	Vermiculite 8135/B0AA/R0003/Ceiling Structures/Linings/S12					Limited Samples Taken
Vermiculite Ceilings may contain asbestos. Asbestos testing MUST be conducted prior to any disturbance works						

B0AA - R0005 - Movement (51.86 m2)

Ceiling Structures/Linings	Vermiculite 8135/B0AA/R0003/Ceiling Structures/Linings/S12					Limited Samples Taken
Vermiculite Ceilings may contain asbestos. Asbestos testing MUST be conducted prior to any disturbance works						

B0AA - R0006 - Movement (14.55 m2)

No Asbestos

B0AA - R1001 - Interview/Office - Type 1 (19.82 m2)

No Asbestos

B0AA - R1002 - Staff Study (13.1 m2)

No Asbestos

B0AA - R1003 - Staff Study (79.53 m2)

No Asbestos

B0AA - R1004 - Movement (15.38 m2)

No Asbestos

B0AA - R1005 - Staff Study (24.08 m2)

No Asbestos

B0AA - R1006 - Staff Study (13.1 m2)

No Asbestos

B0AA - R8001 - Movement (13.41 m2)

No Asbestos

B0AA - R8002 - General Learning Space (43.18 m2)

No Asbestos

B0AA - R8003 - General Learning Space (47.6 m2)

No Asbestos

B0AA - R9001 - General Learning Space (53 m2)

Product	Material Description	Extent	Location Reference	Material Condition	Risk Status	Control Priority
Sample No					Test Result	
Ceiling Structures/Linings	Vermiculite		8135/B0AA/R0003/Ceiling Structures/Linings/S12			Limited Samples Taken
<i>Vermiculite Ceilings may contain asbestos. Asbestos testing MUST be conducted prior to any disturbance works</i>						
B0AA - R9002 - General Learning Space (52.92 m2)						
Ceiling Structures/Linings	Vermiculite		8135/B0AA/R0003/Ceiling Structures/Linings/S12			Limited Samples Taken
<i>Vermiculite Ceilings may contain asbestos. Asbestos testing MUST be conducted prior to any disturbance works</i>						
B0AA - R9003 - General Storeroom (6.66 m2)						
Ceiling Structures/Linings	Vermiculite		8135/B0AA/R0003/Ceiling Structures/Linings/S12			Limited Samples Taken
<i>Vermiculite Ceilings may contain asbestos. Asbestos testing MUST be conducted prior to any disturbance works</i>						
B0AA - R9004 - Movement (39.21 m2)						
Ceiling Structures/Linings	Vermiculite		8135/B0AA/R0003/Ceiling Structures/Linings/S12			Limited Samples Taken
<i>Vermiculite Ceilings may contain asbestos. Asbestos testing MUST be conducted prior to any disturbance works</i>						
B0AA - R9005 - General Storeroom (13.5 m2)						
Ceiling Structures/Linings	Vermiculite		8135/B0AA/R0003/Ceiling Structures/Linings/S12			Limited Samples Taken
<i>Vermiculite Ceilings may contain asbestos. Asbestos testing MUST be conducted prior to any disturbance works</i>						
B0AA - R9006 - Movement (14.55 m2)						
No Asbestos						

2017

Product	Material Description	Extent	Location Reference	Material Condition	Risk Status	Control Priority
Sample No					Test Result	

B0LL - Science/Library - 1975 - Brick/Block (Brick/Block)**Exterior**

Underfloor Voids	No Asbestos Found					
Ceiling Voids	No Asbestos Found					
Eaves Linings	Flat AC Sheeting	50m2	Throughout	Good Condition (1)	Low (1)	Low Priority (2-3)

Assumed Asbestos - No access due to height restrictions

Interior**B0LL - R0001 - Laboratory L.S. (90.89 m2)**

Ceiling Structures/Linings	Vermiculite					Limited Samples Taken
8135/B0LL/R0002/Ceiling Structures/Linings/S8						Vermiculite Ceilings may contain asbestos. Asbestos testing MUST be conducted prior to any disturbance works
Floor Coverings Res/Textile	Vinyl Tiles	91m2	Throughout	Good Condition (1)	Low (1)	Low Priority (2-3)
8135/B0LL/R0002/Floor Coverings Res/Textile/S9						Chrysotile (white asbestos)

B0LL - R0002 - Preparation (47.51 m2)

Ceiling Structures/Linings	Vermiculite					Limited Samples Taken
8135/B0LL/R0002/Ceiling Structures/Linings/S8						Vermiculite Ceilings may contain asbestos. Asbestos testing MUST be conducted prior to any disturbance works
Floor Coverings Res/Textile	Vinyl Tiles	48m2	Throughout	Good Condition (1)	Low (1)	Low Priority (2-3)
8135/B0LL/R0002/Floor Coverings Res/Textile/S9						Chrysotile (white asbestos)

B0LL - R0003 - Lift (0.28 m2)

No Asbestos

B0LL - R0005 - Apparatus Store (30.02 m2)

No Asbestos

B0LL - R0006 - Staff - Toilet (4.54 m2)

Shelving unit	Compressed AC Sheet	2m2	South	Good Condition (1)	Low (1)	Low Priority (2-3)
8135/B0LL/R0006/Shelf/S10						Chrysotile (white asbestos)

B0LL - R0007 - Staff - Toilet (4.32 m2)

Shelving unit	Compressed AC Sheet	2m	South	Good Condition (1)	Low (1)	Low Priority (2-3)
8135/B0LL/R0006/Shelf/S10						Chrysotile (white asbestos)

B0LL - R0008 - Cleaning Store - Distributed (0.46 m2)

Floor Coverings Res/Textile	Vinyl Tiles	1m2	Throughout	Good Condition (1)	Low (1)	Low Priority (2-3)
8135/B0LL/R0002/Floor Coverings Res/Textile/S9						Chrysotile (white asbestos)

B0LL - R0009 - Cleaning Store - Distributed (0.22 m2)

No Asbestos

B0LL - R0010 - Distribution Board Cupboard (0.78 m2)

Note: No inspection of live electrical installation.

No Asbestos

B0LL - R0011 - Apparatus Store (15.95 m2)

Stored Item	Vermiculite					Limited Samples Taken
8135/B0LL/R0011/Bucket of Vermiculite/S11						Vermiculite Ceilings may contain asbestos. Asbestos testing MUST be conducted prior to any disturbance works

B0LL - R0012 - Sport Equipment Store (16.46 m2)

Ceiling Structures/Linings	Vermiculite					Limited Samples Taken
8135/B0LL/R0002/Ceiling Structures/Linings/S8						Vermiculite Ceilings may contain asbestos. Asbestos testing MUST be conducted prior to any disturbance works
Floor Coverings Res/Textile	Vinyl Tiles	17m2	Throughout	Good Condition (1)	Low (1)	Low Priority (2-3)
8135/B0LL/R0002/Floor Coverings Res/Textile/S9						Chrysotile (white asbestos)

B0LL - R0013 - Movement (25.7 m2)

Product	Material Description	Extent	Location Reference	Material Condition	Risk Status	Control Priority
Sample No				Test Result		
Ceiling Structures/Linings	Vermiculite 8135/B0LL/R0002/Ceiling Structures/Linings/S8					Limited Samples Taken Vermiculite Ceilings may contain asbestos. Asbestos testing MUST be conducted prior to any disturbance works
Floor Coverings Res/Textile	Vinyl Tiles 8135/B0LL/R0002/Floor Coverings Res/Textile/S9	26m2	Throughout	Good Condition (1)	Low (1)	Low Priority (2-3) Chrysotile (white asbestos)
B0LL - R0014 - Movement (17.44 m2)						
Ceiling Structures/Linings	Vermiculite 8135/B0LL/R0002/Ceiling Structures/Linings/S8					Limited Samples Taken Vermiculite Ceilings may contain asbestos. Asbestos testing MUST be conducted prior to any disturbance works
Floor Coverings Res/Textile	Vinyl Tiles 8135/B0LL/R0002/Floor Coverings Res/Textile/S9	18m2	Throughout	Good Condition (1)	Low (1)	Low Priority (2-3) Chrysotile (white asbestos)
B0LL - R0015 - General Storeroom (5.15 m2)						
No Asbestos						
B0LL - R0016 - Plant (0.2 m2)						
No Asbestos						
B0LL - R0017 - Laboratory L.S. (90.59 m2)						
No Asbestos						
B0LL - R0018 - Stairs (0.65 m2)						
No Asbestos						
B0LL - R1001 - Laboratory L.S. (90.89 m2)						
Ceiling Structures/Linings	Vermiculite 8135/B0LL/R0002/Ceiling Structures/Linings/S8					Limited Samples Taken Vermiculite Ceilings may contain asbestos. Asbestos testing MUST be conducted prior to any disturbance works
Floor Coverings Res/Textile	Vinyl Tiles 8135/B0LL/R0002/Floor Coverings Res/Textile/S9	91m2	Throughout	Good Condition (1)	Low (1)	Low Priority (2-3) Chrysotile (white asbestos)
B0LL - R1002 - Preparation (46.81 m2)						
Ceiling Structures/Linings	Vermiculite 8135/B0LL/R0002/Ceiling Structures/Linings/S8					Limited Samples Taken Vermiculite Ceilings may contain asbestos. Asbestos testing MUST be conducted prior to any disturbance works
Floor Coverings Res/Textile	Vinyl Tiles 8135/B0LL/R0002/Floor Coverings Res/Textile/S9	47m2	Throughout	Good Condition (1)	Low (1)	Low Priority (2-3) Chrysotile (white asbestos)
B0LL - R1003 - Lift (1.34 m2)						
No Asbestos						
B0LL - R1005 - Staff Study (29.95 m2)						
Ceiling Structures/Linings	Vermiculite 8135/B0LL/R0002/Ceiling Structures/Linings/S8					Limited Samples Taken Vermiculite Ceilings may contain asbestos. Asbestos testing MUST be conducted prior to any disturbance works
Floor Coverings Res/Textile	Vinyl Tiles 8135/B0LL/R0002/Floor Coverings Res/Textile/S9	30m2	Throughout	Good Condition (1)	Low (1)	Low Priority (2-3) Chrysotile (white asbestos)
B0LL - R1006 - Staff - Toilet (4.6 m2)						
No Asbestos						
B0LL - R1007 - Staff - Toilet (4.38 m2)						
No Asbestos						
B0LL - R1008 - Cleaning Store - Distributed (0.46 m2)						
Floor Coverings Res/Textile	Vinyl Tiles 8135/B0LL/R0002/Floor Coverings Res/Textile/S9	1m2	Throughout	Good Condition (1)	Low (1)	Low Priority (2-3) Chrysotile (white asbestos)
B0LL - R1009 - Distribution Board Cupboard (0.67 m2)						
						Note: No inspection of live electrical installation.

Product	Material Description	Extent	Location Reference	Material Condition	Risk Status	Control Priority
Sample No					Test Result	
Floor Coverings Res/Textile	Vinyl Tiles	1m2	West	Good Condition (1)	Low (1)	Low Priority (2-3)
8135/B0LL/R0002/Floor Coverings Res/Textile/S9					Chrysotile (white asbestos)	
Electrical Mounting Board	Resinous Board					
8135/B0LL/R1009/Electrical Mounting Board/S28					No Asbestos Detected	
B0LL - R1010 - Chemical Store (8.16 m2)						
No Asbestos						
B0LL - R1011 - Staff Study (16.38 m2)						
Ceiling Structures/Linings	Vermiculite					
8135/B0LL/R0002/Ceiling Structures/Linings/S8					Limited Samples Taken	
<i>Vermiculite Ceilings may contain asbestos. Asbestos testing MUST be conducted prior to any disturbance works</i>						
Floor Coverings Res/Textile	Vinyl Tiles	16m2	Throughout	Good Condition (1)	Low (1)	Low Priority (2-3)
8135/B0LL/R0002/Floor Coverings Res/Textile/S9					Chrysotile (white asbestos)	
B0LL - R1012 - Movement (33.32 m2)						
Ceiling Structures/Linings	Vermiculite					
8135/B0LL/R0002/Ceiling Structures/Linings/S8					Limited Samples Taken	
<i>Vermiculite Ceilings may contain asbestos. Asbestos testing MUST be conducted prior to any disturbance works</i>						
Floor Coverings Res/Textile	Vinyl Tiles	34m2	Throughout	Good Condition (1)	Low (1)	Low Priority (2-3)
8135/B0LL/R0002/Floor Coverings Res/Textile/S9					Chrysotile (white asbestos)	
B0LL - R1013 - Movement (17.44 m2)						
Floor Coverings Res/Textile	Vinyl Tiles	18m2	Throughout	Good Condition (1)	Low (1)	Low Priority (2-3)
8135/B0LL/R0002/Floor Coverings Res/Textile/S9					Chrysotile (white asbestos)	
B0LL - R1014 - Plant (0.2 m2)						
No Asbestos						
B0LL - R1015 - Laboratory L.S. (90.78 m2)						
No Asbestos						
B0LL - R1016 - Stairs (21.48 m2)						
No Asbestos						
B0LL - R2001 - Main Area (246.71 m2)						
No Asbestos						
B0LL - R2002 - Audio Visual Workroom (17.64 m2)						
No Asbestos						
B0LL - R2003 - Librarian (9.66 m2)						
No Asbestos						
B0LL - R2004 - Workroom (21.74 m2)						
No Asbestos						
B0LL - R2005 - Staff - Toilet (3.75 m2)						
No Asbestos						
B0LL - R2006 - Distribution Board Cupboard (0.3 m2)					Note: No inspection of live electrical installation.	
No Asbestos						
B0LL - R2007 - Movement (4.32 m2)						
Floor Coverings Res/Textile	Vinyl Tiles	5m2	Throughout	Good Condition (1)	Low (1)	Low Priority (2-3)
8135/B0LL/R0002/Floor Coverings Res/Textile/S9					Chrysotile (white asbestos)	
B0LL - R2008 - Cleaning Store - Distributed (0.32 m2)						
No Asbestos						
B0LL - R2009 - Staff - Toilet (5.03 m2)						
No Asbestos						
B0LL - R2010 - Seminar (13.11 m2)						

Product	Material Description	Extent	Location Reference	Material Condition	Risk Status	Control Priority
Sample No					Test Result	

No Asbestos

BOLL - R2011 - Seminar (12.82 m2)

No Asbestos

BOLL - R2012 - General Storeroom (13.28 m2)

No Asbestos

BOLL - R2013 - Movement (17.44 m2)

Floor Coverings Res/Textile	Vinyl Tiles	18m2	Throughout	Good Condition (1)	Low (1)	Low Priority (2-3)
-----------------------------	-------------	------	------------	--------------------	---------	--------------------

8135/BOLL/R0002/Floor Coverings Res/Textile/S9

Chrysotile (white asbestos)

BOLL - R2014 - Stairs (20.84 m2)

No Asbestos

2017

Product	Material Description	Extent	Location Reference	Material Condition	Risk Status	Control Priority
Sample No					Test Result	

Demountables

There are no Demountable(s) located at this school as per the AMS records as of 15 Feb 2017.

2017

Product	Material Description	Extent	Location Reference	Material Condition	Risk Status	Control Priority
Sample No					Test Result	

Listing of Electronic Attachments as of 22/03/2017

There are no asbestos related file attachment(s) for this school.

2017