

Asbestos Register

(Hazardous Materials and Risk Assessment)

School : Port Macquarie Public School (2899)
Region : North Coast
State Electorate : Port Macquarie
Local Government Area : Port Macquarie-Hastings

Initial Survey : Noel Arnold & Associates : 14 - Mar - 2008
Reviewed By : Parsons Brinckerhoff : 29 - Aug - 2016

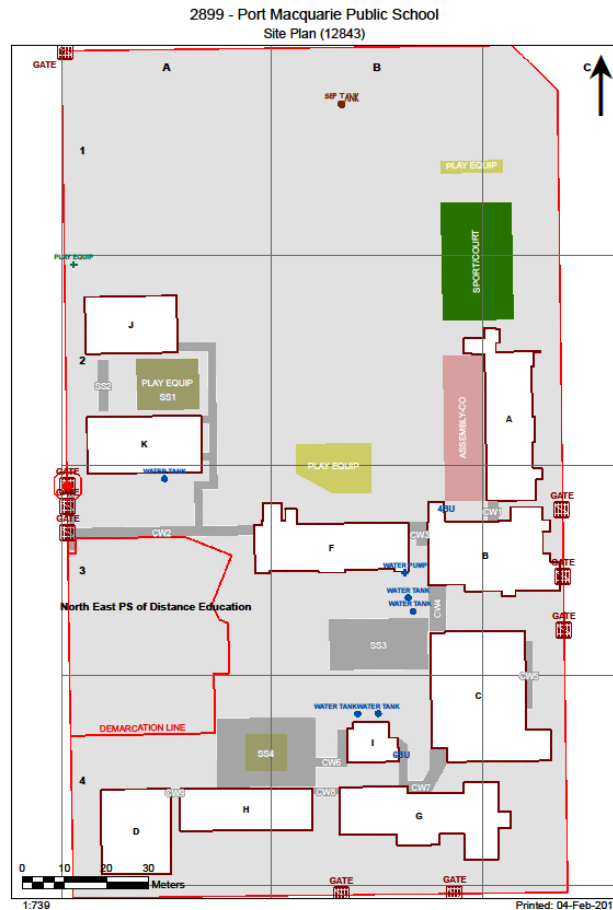

2017

Product	Material Description	Extent	Location Reference	Material Condition	Risk Status	Control Priority
Sample No					Test Result	

B00A - General Learning/Support Unit - 1977 - Brick/Block (Brick/Block)**Exterior**

Underfloor Voids - Slab on Ground	No Asbestos Found					
Ceiling Voids - Raked Ceiling	No Asbestos Found					
Eaves Linings	Flat AC Sheeting 2899/B00F/Eaves Linings/S24	100m2	Variable positions	Good Condition (1)	Low (1)	Low Priority (2-3) Chrysotile (white asbestos)

Interior**B00A - R0001 - Garden Store (4.71 m2)**

Ceiling Structures/Linings	Vermiculite 2899/B00F/R0003/Ceiling Structures/Linings/S23					Limited Samples Taken Vermiculite Ceilings may contain asbestos. Asbestos testing MUST be conducted prior to any disturbance works
----------------------------	---	--	--	--	--	--

B00A - R0002 - External Movement (138.23 m2)

Ceiling Structures/Linings	Vermiculite 2899/B00F/R0003/Ceiling Structures/Linings/S23					Limited Samples Taken Vermiculite Ceilings may contain asbestos. Asbestos testing MUST be conducted prior to any disturbance works
----------------------------	---	--	--	--	--	--

B00A - R0003 - Practical Activities - 1hb (22.46 m2)

Ceiling Structures/Linings	Vermiculite 2899/B00F/R0003/Ceiling Structures/Linings/S23					Limited Samples Taken Vermiculite Ceilings may contain asbestos. Asbestos testing MUST be conducted prior to any disturbance works
----------------------------	---	--	--	--	--	--

B00A - R0004 - Home Base (49.4 m2)

Ceiling Structures/Linings	Vermiculite 2899/B00F/R0003/Ceiling Structures/Linings/S23					Limited Samples Taken Vermiculite Ceilings may contain asbestos. Asbestos testing MUST be conducted prior to any disturbance works
----------------------------	---	--	--	--	--	--

B00A - R0005 - Home Base (49.71 m2)

Ceiling Structures/Linings	Vermiculite 2899/B00F/R0003/Ceiling Structures/Linings/S23					Limited Samples Taken Vermiculite Ceilings may contain asbestos. Asbestos testing MUST be conducted prior to any disturbance works
----------------------------	---	--	--	--	--	--

B00A - R0006 - Practical Activities - 1hb (22.46 m2)

Ceiling Structures/Linings	Vermiculite 2899/B00F/R0003/Ceiling Structures/Linings/S23					Limited Samples Taken Vermiculite Ceilings may contain asbestos. Asbestos testing MUST be conducted prior to any disturbance works
----------------------------	---	--	--	--	--	--

B00A - R0007 - Practical Activities - 1hb (22.21 m2)

Ceiling Structures/Linings	Vermiculite 2899/B00F/R0003/Ceiling Structures/Linings/S23					Limited Samples Taken Vermiculite Ceilings may contain asbestos. Asbestos testing MUST be conducted prior to any disturbance works
----------------------------	---	--	--	--	--	--

B00A - R0008 - Home Base (48.94 m2)

Ceiling Structures/Linings	Vermiculite 2899/B00F/R0003/Ceiling Structures/Linings/S23					Limited Samples Taken Vermiculite Ceilings may contain asbestos. Asbestos testing MUST be conducted prior to any disturbance works
----------------------------	---	--	--	--	--	--

B00A - R0009 - P.E. Store (8.29 m2)

Ceiling Structures/Linings	Vermiculite 2899/B00F/R0003/Ceiling Structures/Linings/S23					Limited Samples Taken Vermiculite Ceilings may contain asbestos. Asbestos testing MUST be conducted prior to any disturbance works
----------------------------	---	--	--	--	--	--

B00A - R0010 - Toilets - Girls (10.85 m2)

Ceiling Structures/Linings	Vermiculite 2899/B00F/R0003/Ceiling Structures/Linings/S23					Limited Samples Taken Vermiculite Ceilings may contain asbestos. Asbestos testing MUST be conducted prior to any disturbance works
----------------------------	---	--	--	--	--	--

Partition Walls (Cubicles)	Compressed AC Sheet 2899/B00C/R0004/Partition Walls (Cubicles)/S2	8m2	All surfaces	Good Condition (1)	Low (1)	Low Priority (2-3) Chrysotile (white asbestos)
----------------------------	--	-----	--------------	--------------------	---------	--

B00A - R0011 - Toilets - Boys (12.77 m2)

Product	Material Description	Extent	Location Reference	Material Condition	Risk Status	Control Priority
Sample No					Test Result	
Ceiling Structures/Linings	Vermiculite 2899/B00F/R0003/Ceiling Structures/Linings/S23					Limited Samples Taken Vermiculite Ceilings may contain asbestos. Asbestos testing MUST be conducted prior to any disturbance works
Partition Walls (Cubicles)	Compressed AC Sheet 2899/B00C/R0004/Partition Walls (Cubicles)/S2	8m2	All surfaces	Good Condition (1)	Low (1)	Low Priority (2-3) Chrysotile (white asbestos)
B00A - R0012 - Distribution Board (0.45 m2)					Note: No inspection of live electrical installation.	
Ceiling Structures/Linings	Vermiculite 2899/B00F/R0003/Ceiling Structures/Linings/S23					Limited Samples Taken Vermiculite Ceilings may contain asbestos. Asbestos testing MUST be conducted prior to any disturbance works
B00A - R0013 - Drinking Facilities (2.97 m2)						
Ceiling Structures/Linings	Vermiculite 2899/B00F/R0003/Ceiling Structures/Linings/S23					Limited Samples Taken Vermiculite Ceilings may contain asbestos. Asbestos testing MUST be conducted prior to any disturbance works
B00A - R0014 - External Stairs (11.95 m2)						
Wall Linings Internal	Flat AC Sheeting 2899/B00F/R0013/Wall Linings Internal/S29	4m2	West facing, Lower portion	Good Condition (1)	Low (1)	Low Priority (2-3) Chrysotile (white asbestos)
B00A - R1001 - Practical Activities - 1hb (19.79 m2)					No Asbestos	
B00A - R1002 - Home Base (47.95 m2)					No Asbestos	
B00A - R1003 - Home Base (47.95 m2)					No Asbestos	
B00A - R1004 - Practical Activities - 1hb (19.18 m2)					No Asbestos	
B00A - R1005 - Practical Activities - M - 1hb (19.79 m2)					No Asbestos	
B00A - R1006 - Home Base - M (47.19 m2)					No Asbestos	
B00A - R1007 - External Movement (132.8 m2)						
Ceiling Structures/Linings	Flat AC Sheeting 2899/B00F/R1003/Ceiling Structures/Linings/S28	133m2	All surfaces	Good Condition (1)	Low (1)	Low Priority (2-3) Chrysotile (white asbestos)
Wall Linings Internal	Flat AC Sheeting 2899/B00F/R0013/Wall Linings Internal/S29	50m2	North facing, West facing, Lower portion	Good Condition (1)	Low (1)	Low Priority (2-3) Chrysotile (white asbestos)
B00A - R1008 - General Storeroom (8.28 m2)					No Asbestos	
B00A - R1009 - Toilets - Girls (10.85 m2)						
Partition Walls (Cubicles)	Compressed AC Sheet 2899/B00C/R0004/Partition Walls (Cubicles)/S2	8m2	All surfaces	Good Condition (1)	Low (1)	Low Priority (2-3) Chrysotile (white asbestos)
B00A - R1010 - Toilets - Boys (11.98 m2)						
Partition Walls (Cubicles)	Compressed AC Sheet 2899/B00C/R0004/Partition Walls (Cubicles)/S2	12m2	All surfaces	Good Condition (1)	Low (1)	Low Priority (2-3) Chrysotile (white asbestos)
B00A - R1011 - Distribution Board (0.45 m2)					Note: No inspection of live electrical installation.	
B00A - R1012 - External Stairs (17.41 m2)						
Ceiling Structures/Linings	Flat AC Sheeting 2899/B00F/R1003/Ceiling Structures/Linings/S28	18m2	All surfaces	Good Condition (1)	Low (1)	Low Priority (2-3) Chrysotile (white asbestos)

Product	Material Description	Extent	Location Reference	Material Condition	Risk Status	Control Priority
Sample No					Test Result	

B00B - Administration/Library - 1952 - Brick/Block (Brick/Block)**Exterior**

Ceiling Voids - Raked Ceiling	No Asbestos Found					
Underfloor Voids - Slab on Ground	No Asbestos Found					
Eaves Linings	Flat AC Sheeting	100m2	Variable positions	Good Condition (1)	Low (1)	Low Priority (2-3)
	2899/B00F/Eaves Linings/S24					Chrysotile (white asbestos)

Interior**B00B - R0001 - Staff Room (91.92 m2)**

Ceiling Structures/Linings	Vermiculite					Limited Samples Taken
	2899/B00F/R0003/Ceiling Structures/Linings/S23					<i>Vermiculite Ceilings may contain asbestos. Asbestos testing MUST be conducted prior to any disturbance works</i>
Ceiling Structures/Linings	Vermiculite					Limited Samples Taken
	2899/B00B/R0001/Ceiling Structures/Linings/S37					<i>Vermiculite Ceilings may contain asbestos. Asbestos testing MUST be conducted prior to any disturbance works</i>

B00B - R0002 - Staff Kitchen (23.53 m2)

Ceiling Structures/Linings	Vermiculite					Limited Samples Taken
	2899/B00F/R0003/Ceiling Structures/Linings/S23					<i>Vermiculite Ceilings may contain asbestos. Asbestos testing MUST be conducted prior to any disturbance works</i>
Floor Coverings Res/Textile	Vinyl Tiles					No Asbestos Detected
	2899/B00G/R0013/Floor Coverings Res/Textile/S7					

B00B - R0003 - Principal (22.08 m2)

Ceiling Structures/Linings	Vermiculite					Limited Samples Taken
	2899/B00F/R0003/Ceiling Structures/Linings/S23					<i>Vermiculite Ceilings may contain asbestos. Asbestos testing MUST be conducted prior to any disturbance works</i>

B00B - R0004 - Clerical Office/Workroom (21.03 m2)

Ceiling Structures/Linings	Vermiculite					Limited Samples Taken
	2899/B00F/R0003/Ceiling Structures/Linings/S23					<i>Vermiculite Ceilings may contain asbestos. Asbestos testing MUST be conducted prior to any disturbance works</i>

B00B - R0005 - Entry Vestibule (9.93 m2)

Ceiling Structures/Linings	Vermiculite					Limited Samples Taken
	2899/B00F/R0003/Ceiling Structures/Linings/S23					<i>Vermiculite Ceilings may contain asbestos. Asbestos testing MUST be conducted prior to any disturbance works</i>

B00B - R0006 - Sick Bay (12.62 m2)

Ceiling Structures/Linings	Vermiculite					Limited Samples Taken
	2899/B00F/R0003/Ceiling Structures/Linings/S23					<i>Vermiculite Ceilings may contain asbestos. Asbestos testing MUST be conducted prior to any disturbance works</i>

B00B - R0007 - Staff Toilet (7.33 m2)

Ceiling Structures/Linings	Vermiculite					Limited Samples Taken
	2899/B00F/R0003/Ceiling Structures/Linings/S23					<i>Vermiculite Ceilings may contain asbestos. Asbestos testing MUST be conducted prior to any disturbance works</i>

Partition Walls (Cubicles)	Compressed AC Sheet	2m2	All surfaces	Good Condition (1)	Low (1)	Low Priority (2-3)
	2899/B00C/R0004/Partition Walls (Cubicles)/S2					Chrysotile (white asbestos)

B00B - R0008 - Staff Toilet (7.52 m2)

Ceiling Structures/Linings	Vermiculite					Limited Samples Taken
	2899/B00F/R0003/Ceiling Structures/Linings/S23					<i>Vermiculite Ceilings may contain asbestos. Asbestos testing MUST be conducted prior to any disturbance works</i>

B00B - R0009 - Duplicating Workroom (15.68 m2)

Ceiling Structures/Linings	Vermiculite					Limited Samples Taken
	2899/B00F/R0003/Ceiling Structures/Linings/S23					<i>Vermiculite Ceilings may contain asbestos. Asbestos testing MUST be conducted prior to any disturbance works</i>

Product	Material Description	Extent	Location Reference	Material Condition	Risk Status	Control Priority
Sample No					Test Result	
B00B - R0010 - Cleaning Supplies (9.17 m2)						
Ceiling Structures/Linings	Vermiculite					
	2899/B00F/R0003/Ceiling Structures/Linings/S23					Limited Samples Taken
<i>Vermiculite Ceilings may contain asbestos. Asbestos testing MUST be conducted prior to any disturbance works</i>						
B00B - R0011 - Deputy Principal (14.27 m2)						
Ceiling Structures/Linings	Vermiculite					
	2899/B00F/R0003/Ceiling Structures/Linings/S23					Limited Samples Taken
<i>Vermiculite Ceilings may contain asbestos. Asbestos testing MUST be conducted prior to any disturbance works</i>						
B00B - R0012 - Deputy Principal (13.7 m2)						
Ceiling Structures/Linings	Vermiculite					
	2899/B00F/R0003/Ceiling Structures/Linings/S23					Limited Samples Taken
<i>Vermiculite Ceilings may contain asbestos. Asbestos testing MUST be conducted prior to any disturbance works</i>						
B00B - R0013 - Teachers Aide Special Ed (12.23 m2)						
Ceiling Structures/Linings	Vermiculite					
	2899/B00F/R0003/Ceiling Structures/Linings/S23					Limited Samples Taken
<i>Vermiculite Ceilings may contain asbestos. Asbestos testing MUST be conducted prior to any disturbance works</i>						
B00B - R0014 - Movement (50.17 m2)						
Ceiling Structures/Linings	Vermiculite					
	2899/B00F/R0003/Ceiling Structures/Linings/S23					Limited Samples Taken
<i>Vermiculite Ceilings may contain asbestos. Asbestos testing MUST be conducted prior to any disturbance works</i>						
B00B - R0015 - Security Store (14.76 m2)						
Ceiling Structures/Linings	Vermiculite					
	2899/B00F/R0003/Ceiling Structures/Linings/S23					Limited Samples Taken
<i>Vermiculite Ceilings may contain asbestos. Asbestos testing MUST be conducted prior to any disturbance works</i>						
B00B - R0016 - External Movement (7.27 m2)						
Ceiling Structures/Linings	Flat AC Sheeting	8m2	All surfaces	Good Condition (1)	Low (1)	Low Priority (2-3)
	2899/B00F/Eaves Linings/S24					Chrysotile (white asbestos)
B00B - R0017 - External Movement (3.82 m2)						
Ceiling Structures/Linings	Flat AC Sheeting	4m2	All surfaces	Good Condition (1)	Low (1)	Low Priority (2-3)
	2899/B00F/Eaves Linings/S24					Chrysotile (white asbestos)
B00B - R0018 - External Movement (5.1 m2)						
Ceiling Structures/Linings	Vermiculite					
	2899/B00F/R0003/Ceiling Structures/Linings/S23					Limited Samples Taken
<i>Vermiculite Ceilings may contain asbestos. Asbestos testing MUST be conducted prior to any disturbance works</i>						
B00B - R0019 - External Movement (88.86 m2)						
Ceiling Structures/Linings	Vermiculite					
	2899/B00F/R0003/Ceiling Structures/Linings/S23					Limited Samples Taken
<i>Vermiculite Ceilings may contain asbestos. Asbestos testing MUST be conducted prior to any disturbance works</i>						
B00B - R0021 - External Movement (23.77 m2)						
No Asbestos						
B00B - R0022 - General Storeroom (3.57 m2)						
No Asbestos						
B00B - R0023 - External Stairs (13.04 m2)						
Wall Linings Internal	Flat AC Sheeting	4m2	North, Lower portion	Good Condition (1)	Low (1)	Low Priority (2-3)
	2899/B00B/R0023/Wall Linings Internal/S38					Chrysotile (white asbestos)
B00B - R1001 - Reading Area (223.97 m2)						
No Asbestos						
B00B - R1002 - Library Office/Workroom (14.15 m2)						
No Asbestos						
B00B - R1003 - Communications Room (28.93 m2)						
No Asbestos						

Product	Material Description	Extent	Location Reference	Material Condition	Risk Status	Control Priority
Sample No					Test Result	
B00B - R1004 - Security Store (8.62 m2)						
No Asbestos						
B00B - R1005 - Library Office/Workroom (12.65 m2)						
No Asbestos						
B00B - R1006 - Library Office/Workroom (8.49 m2)						
No Asbestos						
B00B - R1007 - Library Office/Workroom (9.01 m2)						
No Asbestos						
B00B - R1008 - Cleaning Supplies (1.53 m2)						
No Asbestos						
B00B - R1009 - Toilets - Boys (3.06 m2)						
No Asbestos						
B00B - R1010 - Movement (9.82 m2)						
No Asbestos						
B00B - R1011 - Movement (7.2 m2)						
No Asbestos						
B00B - R1012 - Toilets - Girls (3.07 m2)						
No Asbestos						
B00B - R1013 - Distribution Board (1.53 m2)					Note: No inspection of live electrical installation.	
No Asbestos						
B00B - R1014 - External Movement (73.19 m2)						
Ceiling Structures/Linings	Flat AC Sheeting	74m2	All surfaces	Good Condition (1)	Low (1)	Low Priority (2-3)
	2899/B00F/R1003/Ceiling Structures/Linings/S28				Chrysotile (white asbestos)	
Wall Linings Internal	Flat AC Sheeting	50m2	North facing, East facing, Lower portion	Good Condition (1)	Low (1)	Low Priority (2-3)
	2899/B00F/R0013/Wall Linings Internal/S29				Chrysotile (white asbestos)	
B00B - R1015 - External Stairs (17.41 m2)						
Ceiling Structures/Linings	Flat AC Sheeting	18m2	All surfaces	Good Condition (1)	Low (1)	Low Priority (2-3)
	2899/B00F/R1003/Ceiling Structures/Linings/S28				Chrysotile (white asbestos)	

2017

Product	Material Description	Extent	Location Reference	Material Condition	Risk Status	Control Priority
Sample No				Test Result		

B00C - Communal Facilities - 1975 - Brick/Block (Brick/Block)**Exterior**

Ceiling Voids - Raked Ceiling	No Asbestos Found					
Underfloor Voids - Slab on Ground	No Asbestos Found					
Eaves Linings	Flat AC Sheeting	100m2	All surfaces	Good Condition (1)	Low (1)	Low Priority (2-3)
	2899/B00C/Eaves Linings/S30					Chrysotile (white asbestos)

Interior**B00C - R0001 - Communal Space (258.83 m2)**

No Asbestos

B00C - R0002 - Hall Chair Store (5.08 m2)

No Asbestos

B00C - R0003 - Movement (5.89 m2)

No Asbestos

B00C - R0004 - Toilets - Boys (11 m2)

Partition Walls (Cubicles)	Compressed AC Sheet	3m2	All surfaces	Good Condition (1)	Low (1)	Low Priority (2-3)
	2899/B00C/R0004/Partition Walls (Cubicles)/S2					Chrysotile (white asbestos)

B00C - R0005 - Canteen Office/Store (5.35 m2)

Floor Coverings Res/Textile	Vinyl Tiles	6m2	All surfaces	Good Condition (1)	Low (1)	Low Priority (2-3)
	2899/B00C/R0007/Floor Coverings Res/Textile/S3					Chrysotile (white asbestos)

B00C - R0006 - Staff Toilet (5.45 m2)

No Asbestos

B00C - R0007 - Canteen Office/Store (7.99 m2)

Floor Coverings Res/Textile	Vinyl Tiles	8m2	All surfaces	Good Condition (1)	Low (1)	Low Priority (2-3)
	2899/B00C/R0007/Floor Coverings Res/Textile/S3					Chrysotile (white asbestos)

B00C - R0008 - Canteen (50.66 m2)

Floor Coverings Res/Textile	Vinyl Tiles	51m2	All surfaces	Good Condition (1)	Low (1)	Low Priority (2-3)
	2899/B00C/R0007/Floor Coverings Res/Textile/S3					Chrysotile (white asbestos)

B00C - R0009 - Toilets - Girls (11.7 m2)

No Asbestos

B00C - R0010 - Raised Platform (82.63 m2)

No Asbestos

B00C - R0011 - Movement (3.12 m2)

No Asbestos

B00C - R0012 - General Storeroom (4.71 m2)

No Asbestos

B00C - R0013 - External Movement (188.83 m2)

Ceiling Structures/Linings	Flat AC Sheeting	175m2	All surfaces	Good Condition (1)	Low (1)	Low Priority (2-3)
	2899/B00C/R0013/Ceiling Structures/Linings/S34					Chrysotile (white asbestos)

Wall Linings Internal	Flat AC Sheeting	25m2	South facing, West facing	Good Condition (1)	Low (1)	Low Priority (2-3)
	2899/B00C/R0013/Wall Linings Internal/S1					Chrysotile (white asbestos)

B00C - R0014 - External Movement (3.8 m2)

Ceiling Structures/Linings	Flat AC Sheeting	4m2	All surfaces	Good Condition (1)	Low (1)	Low Priority (2-3)
	2899/B00C/R0013/Ceiling Structures/Linings/S34					Chrysotile (white asbestos)

Product	Material Description	Extent	Location Reference	Material Condition	Risk Status	Control Priority
Sample No					Test Result	
B00C - R0015 - General Storeroom (30.12 m2)						
No Asbestos						
B00C - R9001 - General Storeroom (40.81 m2)						
No Asbestos						
B00C - R9002 - General Storeroom (9.97 m2)						
No Asbestos						
B00C - R9003 - Movement (27.14 m2)						
No Asbestos						
B00C - R9004 - Kiln Room (9.78 m2)						
No Asbestos						
B00C - R9005 - General Assistant/Bulk Store (20.06 m2)						
No Asbestos						
B00C - R9006 - Main Switch Board (18.42 m2)						
No Asbestos						
B00C - R9007 - Craft Store (5.01 m2)						
No Asbestos						
B00C - R9008 - Craft Store (21.44 m2)						
No Asbestos						
B00C - R9009 - No Access (13.81 m2)						
No Asbestos						

2017

Product	Material Description	Extent	Location Reference	Material Condition	Risk Status	Control Priority
Sample No					Test Result	

B00D - General Learning - 1977 - Brick/Veneer (Brick/Veneer)**Exterior**

Underfloor Voids - Slab on Ground	No Asbestos Found					
Ceiling Voids - Raked Ceiling	No Asbestos Found					
Eaves Linings	Flat AC Sheeting	15m2	South facing, Upper portion	Good Condition (1)	Low (1)	Low Priority (2-3)
	2899/B00D/Eaves Linings/S31					Chrysotile (white asbestos)

Interior**B00D - R0001 - External Movement (28.65 m2)**

Ceiling Structures/Linings	Flat AC Sheeting	29m2	All surfaces	Good Condition (1)	Low (1)	Low Priority (2-3)
	2899/B00D/R0001/Ceiling Structures/Linings/S17					Chrysotile (white asbestos)

B00D - R0002 - Toilets - Boys/Girls (3.25 m2)

No Asbestos

B00D - R0003 - Practical Activities - 1hb (27.93 m2)

No Asbestos

B00D - R0004 - Home Base (65.61 m2)

No Asbestos

B00D - R0005 - Home Base (65.62 m2)

No Asbestos

B00D - R0006 - Practical Activities - 1hb (27.94 m2)

No Asbestos

B00D - R0007 - Toilets - Boys/Girls (3.24 m2)

No Asbestos

B00D - R0008 - Movement (83.15 m2)

Ceiling Structures/Linings	Flat AC Sheeting	30m2	North facing	Good Condition (1)	Low (1)	Low Priority (2-3)
	2899/B00D/R0001/Ceiling Structures/Linings/S17					Chrysotile (white asbestos)

2017

Product	Material Description	Extent	Location Reference	Material Condition	Risk Status	Control Priority
Sample No					Test Result	

B00F - General Learning - 1977 - Brick/Block (Brick/Block)**Exterior**

Underfloor Voids - Slab on Ground	No Asbestos Found					
Ceiling Voids - Raked Ceiling	No Asbestos Found					
Eaves Linings	Flat AC Sheeting	100m2	Variable positions	Good Condition (1)	Low (1)	Low Priority (2-3)
	2899/B00F/Eaves Linings/S24					Chrysotile (white asbestos)

Interior**B00F - R0001 - Practical Activities - 1hb (21.09 m2)**

Ceiling Structures/Linings	Vermiculite					
	2899/B00F/R0003/Ceiling Structures/Linings/S23					Limited Samples Taken
Vermiculite Ceilings may contain asbestos. Asbestos testing MUST be conducted prior to any disturbance works						

B00F - R0002 - Home Base (48.82 m2)

Ceiling Structures/Linings	Vermiculite					
	2899/B00F/R0003/Ceiling Structures/Linings/S23					Limited Samples Taken
Vermiculite Ceilings may contain asbestos. Asbestos testing MUST be conducted prior to any disturbance works						

B00F - R0003 - External Movement (113.87 m2)

Ceiling Structures/Linings	Vermiculite					
	2899/B00F/R0003/Ceiling Structures/Linings/S23					Limited Samples Taken
Vermiculite Ceilings may contain asbestos. Asbestos testing MUST be conducted prior to any disturbance works						

B00F - R0004 - Home Base (48.82 m2)

Ceiling Structures/Linings	Vermiculite					
	2899/B00F/R0003/Ceiling Structures/Linings/S23					Limited Samples Taken
Vermiculite Ceilings may contain asbestos. Asbestos testing MUST be conducted prior to any disturbance works						

B00F - R0005 - Practical Activities - 1hb (20.31 m2)

Ceiling Structures/Linings	Vermiculite					
	2899/B00F/R0003/Ceiling Structures/Linings/S23					Limited Samples Taken
Vermiculite Ceilings may contain asbestos. Asbestos testing MUST be conducted prior to any disturbance works						

B00F - R0006 - Practical Activities - 1hb (20.3 m2)

Ceiling Structures/Linings	Vermiculite					
	2899/B00F/R0003/Ceiling Structures/Linings/S23					Limited Samples Taken
Vermiculite Ceilings may contain asbestos. Asbestos testing MUST be conducted prior to any disturbance works						

B00F - R0007 - Home Base (48.82 m2)

Ceiling Structures/Linings	Vermiculite					
	2899/B003/R0001/Ceiling Structures/Linings/S21					Limited Samples Taken
Vermiculite Ceilings may contain asbestos. Asbestos testing MUST be conducted prior to any disturbance works						

B00F - R0008 - Home Base Store (13.99 m2)

Ceiling Structures/Linings	Vermiculite					
	2899/B00F/R0003/Ceiling Structures/Linings/S23					Limited Samples Taken
Vermiculite Ceilings may contain asbestos. Asbestos testing MUST be conducted prior to any disturbance works						

B00F - R0009 - General Storeroom (15.32 m2)

Ceiling Structures/Linings	Vermiculite					
	2899/B00F/R0003/Ceiling Structures/Linings/S23					Limited Samples Taken
Vermiculite Ceilings may contain asbestos. Asbestos testing MUST be conducted prior to any disturbance works						

Floor Coverings Res/Textile	Vinyl Tiles	16m2	All surfaces	Good Condition (1)	Low (1)	Low Priority (2-3)
	2899/B00F/R0009/Floor Coverings Res/Textile/S25					Chrysotile (white asbestos)

B00F - R0010 - Distribution Board (0.54 m2)

Note: No inspection of live electrical installation.

Ceiling Structures/Linings	Vermiculite					
	2899/B00F/R0003/Ceiling Structures/Linings/S23					Limited Samples Taken
Vermiculite Ceilings may contain asbestos. Asbestos testing MUST be conducted prior to any disturbance works						

B00F - R0011 - Toilets - Boys (11.89 m2)

Product	Material Description	Extent	Location Reference	Material Condition	Risk Status	Control Priority
Sample No					Test Result	
Ceiling Structures/Linings	Vermiculite 2899/B00F/R0003/Ceiling Structures/Linings/S23					Limited Samples Taken Vermiculite Ceilings may contain asbestos. Asbestos testing MUST be conducted prior to any disturbance works
Partition Walls (Cubicles)	Compressed AC Sheet 2899/B00C/R0004/Partition Walls (Cubicles)/S2	8m2	All surfaces	Good Condition (1)	Low (1)	Low Priority (2-3) Chrysotile (white asbestos)
B00F - R0012 - Toilets - Girls (11.72 m2)						
Ceiling Structures/Linings	Vermiculite 2899/B003/R0001/Ceiling Structures/Linings/S21					Limited Samples Taken Vermiculite Ceilings may contain asbestos. Asbestos testing MUST be conducted prior to any disturbance works
Partition Walls (Cubicles)	Compressed AC Sheet 2899/B00F/R0003/Ceiling Structures/Linings/S23					No Asbestos Detected
B00F - R0014 - Lift (2.1 m2)						
No Asbestos						
B00F - R0015 - General Storeroom (3.36 m2)						
No Asbestos						
B00F - R0016 - External Stairs (13.26 m2)						
Wall Linings Internal	Flat AC Sheeting 2899/B00B/R0023/Wall Linings Internal/S38	4m2	North, Lower portion	Good Condition (1)	Low (1)	Low Priority (2-3) Chrysotile (white asbestos)
B00F - R1001 - Practical Activities - 1hb (20.31 m2)						
No Asbestos						
B00F - R1002 - Home Base (49.99 m2)						
No Asbestos						
B00F - R1004 - Home Base (49.21 m2)						
No Asbestos						
B00F - R1005 - Practical Activities - 1hb (20.31 m2)						
No Asbestos						
B00F - R1006 - Practical Activities - 1hb (20.31 m2)						
No Asbestos						
B00F - R1007 - Home Base (49.21 m2)						
No Asbestos						
B00F - R1008 - Home Base (49.21 m2)						
No Asbestos						
B00F - R1009 - Practical Activities - 1hb (20.31 m2)						
No Asbestos						
B00F - R1010 - External Stairs (17.4 m2)						
Ceiling Structures/Linings	Flat AC Sheeting 2899/B00F/R1003/Ceiling Structures/Linings/S28	18m2	All surfaces	Good Condition (1)	Low (1)	Low Priority (2-3) Chrysotile (white asbestos)
B00F - R1011 - External Movement (97.02 m2)						
Ceiling Structures/Linings	Flat AC Sheeting 2899/B00F/R1011/Ceiling Structures/Linings/S35					No Asbestos Detected

Product	Material Description	Extent	Location Reference	Material Condition	Risk Status	Control Priority
Sample No					Test Result	

B00G - General Learning - 1951 - Brick/Block (Brick/Block)

Exterior

Eaves Linings	Flat AC Sheeting	200m2	All surfaces	Good Condition (1)	Low (1)	Low Priority (2-3)
	2899/B00G/Eaves Linings/S9					Chrysotile (white asbestos)
Ceiling Void	No Asbestos Found					
Underfloor Void	AC Fragments/Debris	1m2	Variable positions	Poor Condition - Extensive Damage (4)	Low (1)	Medium Priority (4-5)
	2899/B00G/Underfloor Void/S33					Chrysotile (white asbestos) , Amosite (brown asbestos) , Crocidolite (blue asbestos)

Interior

B00G - R0001 - Home Base Store (8.45 m2)

No Asbestos

B00G - R0002 - Home Base (65.7 m2)

No Asbestos

B00G - R0003 - Staff Room Annexe (21.06 m2)

No Asbestos

B00G - R0004 - Movement (80 m2)

Wall Linings Internal	Flat AC Sheeting					
	2899/B00G/R0004/Wall Linings Internal/S5					No Asbestos Detected

B00G - R0005 - Distribution Board (0.46 m2)

Note: No inspection of live electrical installation.

Floor Coverings Res/Textile	Vinyl Tiles					
	2899/B00G/R0013/Floor Coverings Res/Textile/S7					No Asbestos Detected

B00G - R0006 - Home Base (61.71 m2)

No Asbestos

B00G - R0007 - General Storeroom (7.61 m2)

No Asbestos

B00G - R0008 - Interview (13.01 m2)

No Asbestos

B00G - R0009 - Home Base Store (11.19 m2)

No Asbestos

B00G - R0010 - Staff Toilet (6.55 m2)

Ceiling Structures/Linings	Flat AC Sheeting	7m2	All surfaces	Good Condition (1)	Low (1)	Low Priority (2-3)
	2899/B00G/R0010/Ceiling Structures/Linings/S4					Chrysotile (white asbestos)

B00G - R0011 - Home Base (51.55 m2)

No Asbestos

B00G - R0012 - Home Base (51.51 m2)

No Asbestos

B00G - R0013 - Practical Activities - 1hb (22.64 m2)

Ceiling Structures/Linings	Fibre Cement Casting (Monocrete)	23m2	All surfaces	Good Condition (1)	Low (1)	Low Priority (2-3)
	2899/B00G/R0013/Ceiling Structures/Linings/S6					Chrysotile (white asbestos) , Amosite (brown asbestos)

Floor Coverings Res/Textile	Vinyl Tiles					
	2899/B00G/R0013/Floor Coverings Res/Textile/S7					No Asbestos Detected

B00G - R0015 - External Movement (4.45 m2)

Ceiling Structures/Linings	Flat AC Sheeting	5m2	All surfaces	Good Condition (1)	Low (1)	Low Priority (2-3)
	2899/B00G/R0015/Ceiling Structures/Linings/S8					Chrysotile (white asbestos)

Product	Material Description	Extent	Location Reference	Material Condition	Risk Status	Control Priority
Sample No					Test Result	

B00G - R0016 - External Movement (27.88 m2)

No Asbestos

2017

Product	Material Description	Extent	Location Reference	Material Condition	Risk Status	Control Priority
Sample No					Test Result	

B00H - General Learning - 1951 - Brick/Veneer (Brick/Veneer)

Exterior

Eaves Linings	Flat AC Sheeting	20m2	South facing	Good Condition (1)	Low (1)	Low Priority (2-3)
	2899/B00G/R0013/Ceiling Structures/Linings/S6			Chrysotile (white asbestos) , Amosite (brown asbestos)		
Wall Cladding	Flat AC Sheeting					No Asbestos Detected
	2899/B00H/Wall Cladding/S14					
Ceiling Void	No Asbestos Found					
Underfloor Void	No Asbestos Found					
Gable Verge Lining	Flat AC Sheeting					No Asbestos Detected
	2899/B00I/Gable Verge Lining/S32					

Interior

B00H - R0001 - Staff Toilet (3.11 m2)

No Asbestos

B00H - R0002 - Staff Room Annexe (16.75 m2)

No Asbestos

B00H - R0003 - Movement (1.98 m2)

No Asbestos

B00H - R0004 - Movement (8.33 m2)

No Asbestos

B00H - R0005 - Distribution Board (0.81 m2)

Note: No inspection of live electrical installation.

Wall Linings Internal	Flat AC Sheeting	6m2	All surfaces	Some Damage / Unsealed (3)	Low (1)	Low Priority (2-3)
	2899/B00H/R0005/Wall Linings Internal/S27			Chrysotile (white asbestos) , Amosite (brown asbestos)		

B00H - R0006 - Home Base Store (4.5 m2)

No Asbestos

B00H - R0007 - Home Base (57.46 m2)

No Asbestos

B00H - R0008 - Home Base (57.54 m2)

No Asbestos

B00H - R0009 - Home Base Store (4.56 m2)

No Asbestos

B00H - R0010 - Movement (19.27 m2)

Floor Coverings Res/Textile	Vinyl Tiles					No Asbestos Detected
	2899/B00H/R0010/Floor Coverings Res/Textile/S15					

B00H - R0011 - Home Base (57.75 m2)

No Asbestos

B00H - R0012 - Home Base Store (4.56 m2)

No Asbestos

B00H - R0013 - External Movement (51.7 m2)

Ceiling Structures/Linings	Flat AC Sheeting	52m2	All surfaces	Good Condition (1)	Low (1)	Low Priority (2-3)
	2899/B00G/R0013/Ceiling Structures/Linings/S6			Chrysotile (white asbestos) , Amosite (brown asbestos)		

In-fill panels	Flat AC Sheeting					No Asbestos Detected
	2899/B00H/Wall Cladding/S14					

Wall Linings Internal	Flat AC Sheeting	3m2	East facing, West facing	Good Condition (1)	Low (1)	Low Priority (2-3)
	2899/B00H/R0013/Wall Linings Internal/S16			Chrysotile (white asbestos)		

Product	Material Description	Extent	Location Reference	Material Condition	Risk Status	Control Priority
Sample No					Test Result	

B001 - Pupil Facilities - 1977 - Brick/Block (Brick/Block)**Exterior**

Underfloor Voids - Slab on Ground	No Asbestos Found					
Eaves Linings	Flat AC Sheeting	40m2	South facing, East facing, West facing	Good Condition (1)	Low (1)	Low Priority (2-3)
	2899/B001/Eaves Linings/S11					Chrysotile (white asbestos)
Wall Cladding	Flat AC Sheeting					No Asbestos Detected
	2899/B001/Wall Cladding/S10					
Ceiling Void	Non Accessible Area - No manhole in building					
Gable Verge Lining	Flat AC Sheeting					No Asbestos Detected
	2899/B001/Gable Verge Lining/S32					

Interior**B001 - R0001 - Toilets - Girls (36.42 m2)**

Partition Walls (Cubicles)	Compressed AC Sheet	14m2	All surfaces	Good Condition (1)	Low (1)	Low Priority (2-3)
	2899/B001/R0003/Partition Walls (Cubicles)/S12					Chrysotile (white asbestos)
Ceiling Structures/Linings	Flat AC Sheeting	37m2	All surfaces	Good Condition (1)	Low (1)	Low Priority (2-3)
	2899/B001/R0003/Ceiling Structures/Linings/S13					Chrysotile (white asbestos) , Amosite (brown asbestos)

B001 - R0002 - Cleaning Supplies (10.73 m2)

Ceiling Structures/Linings	Flat AC Sheeting	11m2	All surfaces	Some Damage / Unsealed (3)	Low (1)	Low Priority (2-3)
	2899/B001/R0002/Ceiling Structures/Linings/S26					Chrysotile (white asbestos)

B001 - R0003 - Toilets - Boys (28.5 m2)

Partition Walls (Cubicles)	Compressed AC Sheet	10m2	All surfaces	Good Condition (1)	Low (1)	Low Priority (2-3)
	2899/B001/R0003/Partition Walls (Cubicles)/S12					Chrysotile (white asbestos)
Ceiling Structures/Linings	Flat AC Sheeting	29m2	All surfaces	Good Condition (1)	Low (1)	Low Priority (2-3)
	2899/B001/R0003/Ceiling Structures/Linings/S13					Chrysotile (white asbestos) , Amosite (brown asbestos)

B001 - R0004 - External Movement (4.91 m2)

No Asbestos

B001 - R0005 - External Movement (7.5 m2)

Wall Linings Internal	Flat AC Sheeting					No Asbestos Detected
	2899/B001/R0005/Wall Linings Internal/S36					

2017

Product	Material Description	Extent	Location Reference	Material Condition	Risk Status	Control Priority
	Sample No					Test Result

B00J - Support Unit (M P S) - 2011 - Brick/Veneer (Brick/Veneer)**Exterior**

Ceiling Voids	No Asbestos Found
Underfloor Void	No Asbestos Found

Interior**B00J - R0001 - External Movement (59.86 m2)**

No Asbestos

B00J - R0002 - Home Base - M (68.09 m2)

No Asbestos

B00J - R0003 - No Access (5.59 m2)

No Asbestos

B00J - R0004 - Access Shower/Toilet/Change (18.11 m2)

No Asbestos

B00J - R0005 - No Access (5.1 m2)

No Asbestos

B00J - R0006 - Access Shower/Toilet (6.14 m2)

No Asbestos

B00J - R0007 - No Access (0.63 m2)

No Asbestos

B00J - R0008 - Practical Activities - M - 2hb (38.47 m2)

No Asbestos

B00J - R0009 - No Access (0.51 m2)

No Asbestos

B00J - R0010 - Home Base - M (68.05 m2)

No Asbestos

B00J - R0011 - Home Base Store - M (6.01 m2)

No Asbestos

2017

Product	Material Description	Extent	Location Reference	Material Condition	Risk Status	Control Priority
	Sample No					Test Result

B00K - General Learning/Administration - 2011 - Brick/Veneer (Brick/Veneer)**Exterior**

Ceiling Voids	No Asbestos Found
Underfloor Void	No Asbestos Found

Interior**B00K - R0001 - External Movement (67.14 m2)**

No Asbestos

B00K - R0002 - Staff Toilet (4.96 m2)

No Asbestos

B00K - R0003 - Entry Vestibule (18.18 m2)

No Asbestos

B00K - R0004 - Clerical Office (18.02 m2)

No Asbestos

B00K - R0005 - Security Store (15.24 m2)

No Asbestos

B00K - R0006 - Staff Room (27.48 m2)

No Asbestos

B00K - R0007 - Staff Kitchen (2.64 m2)

No Asbestos

B00K - R0008 - No Access (0.56 m2)

No Asbestos

B00K - R0009 - Practical Activities/Movement - 1hb (18.57 m2)

No Asbestos

B00K - R0010 - No Access (6.31 m2)

No Asbestos

B00K - R0011 - Home Base (61.09 m2)

No Asbestos

B00K - R0012 - Withdrawal Space - 2hb (11.76 m2)

No Asbestos

B00K - R0013 - Home Base (60.53 m2)

No Asbestos

B00K - R0014 - No Access (6.55 m2)

No Asbestos

B00K - R0015 - Practical Activities/Movement - 1hb (20.2 m2)

No Asbestos

2017

Product	Material Description	Extent	Location Reference	Material Condition	Risk Status	Control Priority
Sample No					Test Result	

Demountables

There are no Demountable(s) located at this school as per the AMS records as of 15 Feb 2017.

2017

Product	Material Description	Extent	Location Reference	Material Condition	Risk Status	Control Priority
Sample No					Test Result	

Listing of Electronic Attachments as of 22/03/2017

Available Asbestos Related Electronic Files

2899_ASB_221112_AMP.pdf

* Note : Refer to AMS for details of the attachment(s).

2017