

# Asbestos Register

(Hazardous Materials and Risk Assessment)

**School :** Lurnea High School (8401)  
**Region :** South Western Sydney  
**State Electorate :** Holsworthy  
**Local Government Area :** Liverpool

**Initial Survey :** Noel Arnold & Associates : 14 - May - 2008  
**Reviewed By :** WSP : 02 - Jun - 2017

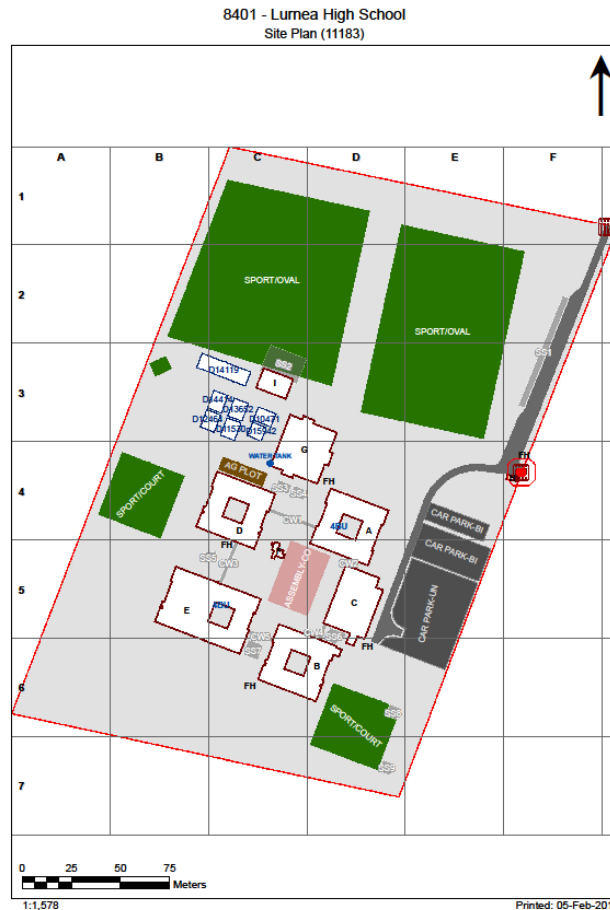

2017

Product	Material Description	Extent	Location Reference	Material Condition	Risk Status	Control Priority
Sample No					Test Result	

**B00A - Administration/General Learning - 1965 - Brick/Block (Brick/Block)****Exterior**

Louvers	Compressed AC Sheet	45m2	East, West	Good Condition (1)	Low (1)	Low Priority (2-3)
	8401/B00A/Louvers/S1					<b>Chrysotile (white asbestos)</b>
Eaves Linings	Vermiculite					<b>Limited Samples Taken</b>
	8401/B00C/R0018/Ceiling Structures/Linings/S4					<b>Vermiculite Ceilings may contain asbestos. Asbestos testing MUST be conducted prior to any disturbance works</b>
Ceiling Voids - Flat Roof	Non Accessible Area					
	- Area inaccessible					

**Interior****B00A - R0003 - Movement (28.23 m2)**

Ceiling Structures/Linings	Vermiculite					<b>Limited Samples Taken</b>
	8401/B00A/R0026/Ceiling Structures/Linings/S24					<b>Vermiculite Ceilings may contain asbestos. Asbestos testing MUST be conducted prior to any disturbance works</b>

**B00A - R0004 - Clinic (8.35 m2)**

Ceiling Structures/Linings	Vermiculite					<b>Limited Samples Taken</b>
	8401/B00A/R0026/Ceiling Structures/Linings/S24					<b>Vermiculite Ceilings may contain asbestos. Asbestos testing MUST be conducted prior to any disturbance works</b>

**B00A - R0005 - Staff - Toilet (4.02 m2)**

Ceiling Structures/Linings	Vermiculite					<b>Limited Samples Taken</b>
	8401/B00A/R0026/Ceiling Structures/Linings/S24					<b>Vermiculite Ceilings may contain asbestos. Asbestos testing MUST be conducted prior to any disturbance works</b>

**B00A - R0006 - Staff - Toilet (4.04 m2)**

Ceiling Structures/Linings	Vermiculite					<b>Limited Samples Taken</b>
	8401/B00A/R0026/Ceiling Structures/Linings/S24					<b>Vermiculite Ceilings may contain asbestos. Asbestos testing MUST be conducted prior to any disturbance works</b>

**B00A - R0007 - Staff Kitchen (8.35 m2)**

Ceiling Structures/Linings	Vermiculite					<b>Limited Samples Taken</b>
	8401/B00A/R0026/Ceiling Structures/Linings/S24					<b>Vermiculite Ceilings may contain asbestos. Asbestos testing MUST be conducted prior to any disturbance works</b>

**B00A - R0008 - Deputy Principal Office (8.35 m2)**

Ceiling Structures/Linings	Vermiculite					<b>Limited Samples Taken</b>
	8401/B00A/R0026/Ceiling Structures/Linings/S24					<b>Vermiculite Ceilings may contain asbestos. Asbestos testing MUST be conducted prior to any disturbance works</b>

Floor Coverings Res/Textile	Adhesive					<b>No Asbestos Detected</b>
	8401/B00A/R0013/Floor Coverings Res/Textile/S9					

Floor Coverings Res/Textile	Vinyl Tiles (Under Floor Covering/Carpet)	8.34m2	Throughout	Good Condition (1)	Low (1)	Low Priority (2-3)
	8401/B00A/R0013/Floor Coverings Res/Textile/S8					<b>Chrysotile (white asbestos)</b>

**B00A - R0010 - Cleaning Store - Distributed (4.34 m2)**

Ceiling Structures/Linings	Vermiculite					<b>Limited Samples Taken</b>
	8401/B00A/R0026/Ceiling Structures/Linings/S24					<b>Vermiculite Ceilings may contain asbestos. Asbestos testing MUST be conducted prior to any disturbance works</b>

Floor Coverings Res/Textile	Adhesive					<b>No Asbestos Detected</b>
	8401/B00A/R0013/Floor Coverings Res/Textile/S9					

Floor Coverings Res/Textile	Vinyl Tiles (Under Floor Covering/Carpet)	4.34m2	Throughout	Good Condition (1)	Low (1)	Low Priority (2-3)
	8401/B00A/R0013/Floor Coverings Res/Textile/S8					<b>Chrysotile (white asbestos)</b>

**B00A - R0011 - Administration - Clerical (10.83 m2)**

Ceiling Structures/Linings	Vermiculite					<b>Limited Samples Taken</b>
	8401/B00A/R0026/Ceiling Structures/Linings/S24					<b>Vermiculite Ceilings may contain asbestos. Asbestos testing MUST be conducted prior to any disturbance works</b>

Product	Material Description	Extent	Location Reference	Material Condition	Risk Status	Control Priority
Sample No		Test Result				
Floor Coverings Res/Textile	Adhesive 8401/B00A/R0013/Floor Coverings Res/Textile/S9					<b>No Asbestos Detected</b>
Floor Coverings Res/Textile	Vinyl Tiles (Under Floor Covering/Carpet) 8401/B00A/R0013/Floor Coverings Res/Textile/S8	10.83m2	Throughout	Good Condition (1)	Low (1)	Low Priority (2-3) <b>Chrysotile (white asbestos)</b>
<b>B00A - R0013 - Principal Office (19.93 m2)</b>						
Ceiling Structures/Linings	Vermiculite 8401/B00A/R0026/Ceiling Structures/Linings/S24					<b>Limited Samples Taken</b> <b>Vermiculite Ceilings may contain asbestos. Asbestos testing MUST be conducted prior to any disturbance works</b>
Floor Coverings Res/Textile	Vinyl Tiles (Under Floor Covering/Carpet) 8401/B00A/R0013/Floor Coverings Res/Textile/S8	19.93m2	Throughout	Good Condition (1)	Low (1)	Low Priority (2-3) <b>Chrysotile (white asbestos)</b>
Floor Coverings Res/Textile	Adhesive 8401/B00A/R0013/Floor Coverings Res/Textile/S9					<b>No Asbestos Detected</b>
<b>B00A - R0014 - General Storeroom (3.17 m2)</b>						
Ceiling Structures/Linings	Vermiculite 8401/B00A/R0026/Ceiling Structures/Linings/S24					<b>Limited Samples Taken</b> <b>Vermiculite Ceilings may contain asbestos. Asbestos testing MUST be conducted prior to any disturbance works</b>
<b>B00A - R0015 - Staff - Toilet (3.01 m2)</b>						
Ceiling Structures/Linings	Vermiculite 8401/B00A/R0026/Ceiling Structures/Linings/S24					<b>Limited Samples Taken</b> <b>Vermiculite Ceilings may contain asbestos. Asbestos testing MUST be conducted prior to any disturbance works</b>
<b>B00A - R0019 - Art Learning Space (91.09 m2)</b>						
Ceiling Structures/Linings	Vermiculite 8401/B00A/R0026/Ceiling Structures/Linings/S24					<b>Limited Samples Taken</b> <b>Vermiculite Ceilings may contain asbestos. Asbestos testing MUST be conducted prior to any disturbance works</b>
<b>B00A - R0023 - Public Reception (58.46 m2)</b>						
Ceiling Structures/Linings	Vermiculite 8401/B00A/R0026/Ceiling Structures/Linings/S24					<b>Limited Samples Taken</b> <b>Vermiculite Ceilings may contain asbestos. Asbestos testing MUST be conducted prior to any disturbance works</b>
Floor Coverings Res/Textile	Adhesive 8401/B00A/R0013/Floor Coverings Res/Textile/S9					<b>No Asbestos Detected</b>
Floor Coverings Res/Textile	Vinyl Tiles (Under Floor Covering/Carpet) 8401/B00A/R0013/Floor Coverings Res/Textile/S8	58.44m2	Throughout	Good Condition (1)	Low (1)	Low Priority (2-3) <b>Chrysotile (white asbestos)</b>
<b>B00A - R0024 - Deputy Principal Office (13.18 m2)</b>						
Ceiling Structures/Linings	Vermiculite 8401/B00A/R0026/Ceiling Structures/Linings/S24					<b>Limited Samples Taken</b> <b>Vermiculite Ceilings may contain asbestos. Asbestos testing MUST be conducted prior to any disturbance works</b>
Floor Coverings Res/Textile	Adhesive 8401/B00A/R0013/Floor Coverings Res/Textile/S9					<b>No Asbestos Detected</b>
Floor Coverings Res/Textile	Vinyl Tiles (Under Floor Covering/Carpet) 8401/B00A/R0013/Floor Coverings Res/Textile/S8	13.17m2	Throughout	Good Condition (1)	Low (1)	Low Priority (2-3) <b>Chrysotile (white asbestos)</b>
<b>B00A - R0025 - Deputy Principal Office (12.96 m2)</b>						
Ceiling Structures/Linings	Vermiculite 8401/B00A/R0026/Ceiling Structures/Linings/S24					<b>Limited Samples Taken</b> <b>Vermiculite Ceilings may contain asbestos. Asbestos testing MUST be conducted prior to any disturbance works</b>
Floor Coverings Res/Textile	Adhesive 8401/B00A/R0013/Floor Coverings Res/Textile/S9					<b>No Asbestos Detected</b>

Product	Material Description	Extent	Location Reference	Material Condition	Risk Status	Control Priority
Sample No					Test Result	
Floor Coverings Res/Textile	Vinyl Tiles (Under Floor Covering/Carpet) 8401/B00A/R0013/Floor Coverings Res/Textile/S8	12.95m2	Throughout	Good Condition (1)	Low (1)	Low Priority (2-3) <b>Chrysotile (white asbestos)</b>
<b>B00A - R0026 - Printing/Photocopying (24.96 m2)</b>						
Ceiling Structures/Linings	Vermiculite 8401/B00A/R0026/Ceiling Structures/Linings/S24					<b>Limited Samples Taken</b> <i>Vermiculite Ceilings may contain asbestos. Asbestos testing MUST be conducted prior to any disturbance works</i>
Floor Coverings Res/Textile	Adhesive 8401/B00A/R0013/Floor Coverings Res/Textile/S9					<b>No Asbestos Detected</b>
Floor Coverings Res/Textile	Vinyl Tiles (Under Floor Covering/Carpet) 8401/B00A/R0013/Floor Coverings Res/Textile/S8	24.96m2	Throughout	Good Condition (1)	Low (1)	Low Priority (2-3) <b>Chrysotile (white asbestos)</b>
Window Sills	Dust Samples 8401/B00A/R0026/Window Sills/S33					<b>No Asbestos Detected</b>
Floor Coverings Res/Textile	Dust Samples 8401/B00A/R0026/Floor Coverings Res/Textile/S34					<b>No Asbestos Detected</b>
<b>B00A - R0027 - Tea Room (4.37 m2)</b>						
No Asbestos						
<b>B00A - R0028 - Tea Room (9.59 m2)</b>						
No Asbestos						
<b>B00A - R0029 - Staff Study (16.34 m2)</b>						
No Asbestos						
<b>B00A - R0030 - Darkroom Space (2.07 m2)</b>						
No Asbestos						
<b>B00A - R0031 - Dark Room (30.27 m2)</b>						
No Asbestos						
<b>B00A - R0032 - Art Learning Space (56.91 m2)</b>						
No Asbestos						
<b>B00A - R0033 - Tea Room (1.95 m2)</b>						
No Asbestos						
<b>B00A - R0034 - Plant (0.87 m2)</b>						
No Asbestos						
<b>B00A - R0035 - General Storeroom (6.27 m2)</b>						
No Asbestos						
<b>B00A - R0036 - External Stairs (3.97 m2)</b>						
No Asbestos						
<b>B00A - R0037 - Toilets-Boys (3.07 m2)</b>						
Wall lining external	Flat AC Sheeting 8401/B00A/R0037/Wall lining external/S10					<b>No Asbestos Detected</b>
<b>B00A - R0038 - Toilets-Girls (5.69 m2)</b>						
No Asbestos						
<b>B00A - R0039 - Plant (0.88 m2)</b>						
No Asbestos						
<b>B00A - R0040 - Cleaning Store - Distributed (2.34 m2)</b>						
No Asbestos						
<b>B00A - R0041 - External Stairs (2.92 m2)</b>						
No Asbestos						
<b>B00A - R0042 - External Movement (292.64 m2)</b>						
No Asbestos						

Product	Material Description	Extent	Location Reference	Material Condition	Risk Status	Control Priority
Sample No					Test Result	
<b>B00A - R0043 - External Movement (1.6 m2)</b>						
No Asbestos						
<b>B00A - R1001 - General Learning Space (53.53 m2)</b>						
Ceiling Structures/Linings	Vermiculite	8401/B00C/R0018/Ceiling Structures/Linings/S4				Limited Samples Taken
<i>Vermiculite Ceilings may contain asbestos. Asbestos testing MUST be conducted prior to any disturbance works</i>						
<b>B00A - R1002 - Commonroom (72.91 m2)</b>						
Ceiling Structures/Linings	Vermiculite	8401/B00C/R0018/Ceiling Structures/Linings/S4				Limited Samples Taken
<i>Vermiculite Ceilings may contain asbestos. Asbestos testing MUST be conducted prior to any disturbance works</i>						
<b>B00A - R1003 - Staff Study (12.68 m2)</b>						
Ceiling Structures/Linings	Vermiculite	8401/B00C/R0018/Ceiling Structures/Linings/S4				Limited Samples Taken
<i>Vermiculite Ceilings may contain asbestos. Asbestos testing MUST be conducted prior to any disturbance works</i>						
<b>B00A - R1004 - Staff Study (13.03 m2)</b>						
Ceiling Structures/Linings	Vermiculite	8401/B00C/R0018/Ceiling Structures/Linings/S4				Limited Samples Taken
<i>Vermiculite Ceilings may contain asbestos. Asbestos testing MUST be conducted prior to any disturbance works</i>						
<b>B00A - R1005 - Staff Kitchen (9.45 m2)</b>						
Ceiling Structures/Linings	Vermiculite	8401/B00C/R0018/Ceiling Structures/Linings/S4				Limited Samples Taken
<i>Vermiculite Ceilings may contain asbestos. Asbestos testing MUST be conducted prior to any disturbance works</i>						
<b>B00A - R1006 - General Storeroom (9.16 m2)</b>						
Ceiling Structures/Linings	Vermiculite	8401/B00C/R0018/Ceiling Structures/Linings/S4				Limited Samples Taken
<i>Vermiculite Ceilings may contain asbestos. Asbestos testing MUST be conducted prior to any disturbance works</i>						
<b>B00A - R1009 - Special Learning Space (39.45 m2)</b>						
Ceiling Structures/Linings	Vermiculite	8401/B00C/R0018/Ceiling Structures/Linings/S4				Limited Samples Taken
<i>Vermiculite Ceilings may contain asbestos. Asbestos testing MUST be conducted prior to any disturbance works</i>						
<b>B00A - R1010 - Craft Room (72.18 m2)</b>						
Ceiling Structures/Linings	Vermiculite	8401/B00C/R0018/Ceiling Structures/Linings/S4				Limited Samples Taken
<i>Vermiculite Ceilings may contain asbestos. Asbestos testing MUST be conducted prior to any disturbance works</i>						
<b>B00A - R1011 - Special Learning Space (39.23 m2)</b>						
Ceiling Structures/Linings	Vermiculite	8401/B00C/R0018/Ceiling Structures/Linings/S4				Limited Samples Taken
<i>Vermiculite Ceilings may contain asbestos. Asbestos testing MUST be conducted prior to any disturbance works</i>						
<b>B00A - R1012 - Special Learning Space (40.05 m2)</b>						
Ceiling Structures/Linings	Vermiculite	8401/B00C/R0018/Ceiling Structures/Linings/S4				Limited Samples Taken
<i>Vermiculite Ceilings may contain asbestos. Asbestos testing MUST be conducted prior to any disturbance works</i>						
<b>B00A - R1013 - Cleaning Store - Distributed (2.04 m2)</b>						
No Asbestos						
<b>B00A - R1014 - General Learning Space (59.09 m2)</b>						
Ceiling Structures/Linings	Vermiculite	8401/B00C/R0018/Ceiling Structures/Linings/S4				Limited Samples Taken
<i>Vermiculite Ceilings may contain asbestos. Asbestos testing MUST be conducted prior to any disturbance works</i>						
<b>B00A - R1015 - Tea Room (12.52 m2)</b>						
Ceiling Structures/Linings	Vermiculite	8401/B00C/R0018/Ceiling Structures/Linings/S4				Limited Samples Taken
<i>Vermiculite Ceilings may contain asbestos. Asbestos testing MUST be conducted prior to any disturbance works</i>						
<b>B00A - R1016 - Staff Study (39.4 m2)</b>						

Product	Material Description	Extent	Location Reference	Material Condition	Risk Status	Control Priority
Sample No					Test Result	
Ceiling Structures/Linings	Vermiculite	8401/B00C/R0018/Ceiling Structures/Linings/S4				Limited Samples Taken
<i>Vermiculite Ceilings may contain asbestos. Asbestos testing MUST be conducted prior to any disturbance works</i>						
<b>B00A - R1017 - General Learning Space (52.65 m2)</b>						
Ceiling Structures/Linings	Vermiculite	8401/B00C/R0018/Ceiling Structures/Linings/S4				Limited Samples Taken
<i>Vermiculite Ceilings may contain asbestos. Asbestos testing MUST be conducted prior to any disturbance works</i>						
<b>B00A - R1020 - Distribution Board Cupboard (0.87 m2)</b>					Note: No inspection of live electrical installation.	
No Asbestos						
<b>B00A - R1021 - Distribution Board Cupboard (0.87 m2)</b>					Note: No inspection of live electrical installation.	
No Asbestos						
<b>B00A - R1022 - Interview/Office - Type 1 (19.26 m2)</b>						
Ceiling Structures/Linings	Vermiculite	8401/B00C/R0018/Ceiling Structures/Linings/S4				Limited Samples Taken
<i>Vermiculite Ceilings may contain asbestos. Asbestos testing MUST be conducted prior to any disturbance works</i>						
<b>B00A - R1023 - Handwashing Facilities (0.19 m2)</b>						
No Asbestos						
<b>B00A - R1024 - General Learning Space (55.2 m2)</b>						
Ceiling Structures/Linings	Vermiculite	8401/B00A/R1024/Ceiling Structures/Linings/S11				Limited Samples Taken
<i>Vermiculite Ceilings may contain asbestos. Asbestos testing MUST be conducted prior to any disturbance works</i>						
<b>B00A - R1025 - Resources Store (3.61 m2)</b>						
Ceiling Structures/Linings	Vermiculite	8401/B00A/R1024/Ceiling Structures/Linings/S11				Limited Samples Taken
<i>Vermiculite Ceilings may contain asbestos. Asbestos testing MUST be conducted prior to any disturbance works</i>						
<b>B00A - R1026 - External Movement (119.92 m2)</b>						
No Asbestos						
<b>B00A - R1027 - External Stairs (5.79 m2)</b>						
No Asbestos						
<b>B00A - R1028 - External Stairs (5.92 m2)</b>						
No Asbestos						

2017

Product	Material Description	Extent	Location Reference	Material Condition	Risk Status	Control Priority
Sample No				Test Result		

**B00B - Technological & Applied Studies/Music - 1965 - Brick/Block (Brick/Block)****Exterior**

Eaves Linings	Flat AC Sheeting	10m2	East, Lower portion, Variable positions	Good Condition (1)	Low (1)	Low Priority (2-3)
<b>Assumed Asbestos - Height Restriction</b>						
Eaves Linings	Vermiculite 8401/B00C/R0018/Ceiling Structures/Linings/S4					<b>Limited Samples Taken</b>
<b>Vermiculite Ceilings may contain asbestos. Asbestos testing MUST be conducted prior to any disturbance works</b>						
Underfloor Voids - Slab on Ground	Non Accessible Area - Area inaccessible					
Façade	Compressed AC Sheet 8401/B00B/Façade/S15	60m2	East & West	Good Condition (1)	Low (1)	Low Priority (2-3)
<b>Chrysotile (white asbestos)</b>						
Ceiling Voids	Non Accessible Area - Area inaccessible					

**Interior****B00B - R0001 - Senior Learning Centre (90.22 m2)**

Ceiling Structures/Linings	Vermiculite 8401/B00B/R0001/Ceiling Structures/Linings/S25					<b>Limited Samples Taken</b>
<b>Vermiculite Ceilings may contain asbestos. Asbestos testing MUST be conducted prior to any disturbance works</b>						
Window Sills	Dust Samples 8401/B00B/R0001/Window Sills/S42					<b>No Asbestos Detected</b>
Floor Coverings Res/Textile	Dust Samples 8401/B00B/R0001/Floor Coverings Res/Textile/S43					<b>No Asbestos Detected</b>

**B00B - R0002 - Office/Store (16.27 m2)**

Ceiling Structures/Linings	Vermiculite 8401/B00B/R0001/Ceiling Structures/Linings/S25					<b>Limited Samples Taken</b>
<b>Vermiculite Ceilings may contain asbestos. Asbestos testing MUST be conducted prior to any disturbance works</b>						

**B00B - R0003 - Computer Learning Space (25.33 m2)**

Ceiling Structures/Linings	Vermiculite 8401/B00B/R0001/Ceiling Structures/Linings/S25					<b>Limited Samples Taken</b>
<b>Vermiculite Ceilings may contain asbestos. Asbestos testing MUST be conducted prior to any disturbance works</b>						

**B00B - R0004 - Plant (1.06 m2)**

No Asbestos

**B00B - R0005 - Food Technology L.S. (71.71 m2)**

Ceiling Structures/Linings	Vermiculite 8401/B00B/R0001/Ceiling Structures/Linings/S25					<b>Limited Samples Taken</b>
<b>Vermiculite Ceilings may contain asbestos. Asbestos testing MUST be conducted prior to any disturbance works</b>						

**B00B - R0010 - Archive Store (10.29 m2)**

Ceiling Structures/Linings	Vermiculite 8401/B00B/R0001/Ceiling Structures/Linings/S25					<b>Limited Samples Taken</b>
<b>Vermiculite Ceilings may contain asbestos. Asbestos testing MUST be conducted prior to any disturbance works</b>						
Floor Coverings Res/Textile	Vinyl Tiles 8401/B00D/R0009/Floor Coverings Res/Textile/S5	11m2	Throughout	Good Condition (1)	Low (1)	Low Priority (2-3)
<b>Chrysotile (white asbestos)</b>						

**B00B - R0011 - Computer Learning Space (53.53 m2)**

Ceiling Structures/Linings	Vermiculite 8401/B00B/R0001/Ceiling Structures/Linings/S25					<b>Limited Samples Taken</b>
<b>Vermiculite Ceilings may contain asbestos. Asbestos testing MUST be conducted prior to any disturbance works</b>						

**B00B - R0012 - Resources Store (3.26 m2)**



Product	Material Description	Extent	Location Reference	Material Condition	Risk Status	Control Priority
Sample No					Test Result	
Ceiling Structures/Linings	Vermiculite 8401/B00B/R0001/Ceiling Structures/Linings/S25					Limited Samples Taken <b>Vermiculite Ceilings may contain asbestos. Asbestos testing MUST be conducted prior to any disturbance works</b>
Floor Coverings Res/Textile	Vinyl Tiles 8401/B00D/R0009/Floor Coverings Res/Textile/S5	4m2	Throughout	Good Condition (1)	Low (1)	Low Priority (2-3) <b>Chrysotile (white asbestos)</b>
<b>B00B - R0013 - Staff - Toilet (3.61 m2)</b>						
Ceiling Structures/Linings	Vermiculite 8401/B00B/R0001/Ceiling Structures/Linings/S25					Limited Samples Taken <b>Vermiculite Ceilings may contain asbestos. Asbestos testing MUST be conducted prior to any disturbance works</b>
<b>B00B - R0014 - Staff - Toilet (3.78 m2)</b>						
Ceiling Structures/Linings	Vermiculite 8401/B00B/R0001/Ceiling Structures/Linings/S25					Limited Samples Taken <b>Vermiculite Ceilings may contain asbestos. Asbestos testing MUST be conducted prior to any disturbance works</b>
<b>B00B - R0017 - Welding Area (3.17 m2)</b>						
Ceiling Structures/Linings	Vermiculite 8401/B00B/R0001/Ceiling Structures/Linings/S25					Limited Samples Taken <b>Vermiculite Ceilings may contain asbestos. Asbestos testing MUST be conducted prior to any disturbance works</b>
<b>B00B - R0018 - Materials Store (12.53 m2)</b>						
Ceiling Structures/Linings	Vermiculite 8401/B00B/R0001/Ceiling Structures/Linings/S25					Limited Samples Taken <b>Vermiculite Ceilings may contain asbestos. Asbestos testing MUST be conducted prior to any disturbance works</b>
<b>B00B - R0020 - Distribution Board Cupboard (1.06 m2)</b>						
No Asbestos				Note: No inspection of live electrical installation.		
<b>B00B - R0025 - Food Technology L.S. (84.11 m2)</b>						
Ceiling Structures/Linings	Vermiculite 8401/B00B/R0001/Ceiling Structures/Linings/S25					Limited Samples Taken <b>Vermiculite Ceilings may contain asbestos. Asbestos testing MUST be conducted prior to any disturbance works</b>
<b>B00B - R0026 - Food/Research Space (21.37 m2)</b>						
Ceiling Structures/Linings	Vermiculite 8401/B00B/R0001/Ceiling Structures/Linings/S25					Limited Samples Taken <b>Vermiculite Ceilings may contain asbestos. Asbestos testing MUST be conducted prior to any disturbance works</b>
<b>B00B - R0027 - Laundry (8.81 m2)</b>						
Ceiling Structures/Linings	Vermiculite 8401/B00B/R0001/Ceiling Structures/Linings/S25					Limited Samples Taken <b>Vermiculite Ceilings may contain asbestos. Asbestos testing MUST be conducted prior to any disturbance works</b>
<b>B00B - R0028 - Preparation - Materials (26.04 m2)</b>						
Ceiling Structures/Linings	Vermiculite 8401/B00B/R0001/Ceiling Structures/Linings/S25					Limited Samples Taken <b>Vermiculite Ceilings may contain asbestos. Asbestos testing MUST be conducted prior to any disturbance works</b>
<b>B00B - R0029 - Tea Room (7.13 m2)</b>						
Ceiling Structures/Linings	Vermiculite 8401/B00B/R0001/Ceiling Structures/Linings/S25					Limited Samples Taken <b>Vermiculite Ceilings may contain asbestos. Asbestos testing MUST be conducted prior to any disturbance works</b>
<b>B00B - R0030 - Staff Study (24.76 m2)</b>						
Ceiling Structures/Linings	Vermiculite 8401/B00B/R0001/Ceiling Structures/Linings/S25					Limited Samples Taken <b>Vermiculite Ceilings may contain asbestos. Asbestos testing MUST be conducted prior to any disturbance works</b>
<b>B00B - R0031 - Materials Learning Space - Type 1 (72.76 m2)</b>						
Ceiling Structures/Linings	Vermiculite 8401/B00B/R0001/Ceiling Structures/Linings/S25					Limited Samples Taken <b>Vermiculite Ceilings may contain asbestos. Asbestos testing MUST be conducted prior to any disturbance works</b>
<b>B00B - R0032 - Computer Learning Space (27.53 m2)</b>						



Product	Material Description	Extent	Location Reference	Material Condition	Risk Status	Control Priority
Sample No					Test Result	
Ceiling Structures/Linings	Vermiculite					
	8401/B00B/R0001/Ceiling Structures/Linings/S25				<b>Limited Samples Taken</b>	
<i>Vermiculite Ceilings may contain asbestos. Asbestos testing MUST be conducted prior to any disturbance works</i>						
<b>B00B - R0033 - Garden Store Room (4.17 m2)</b>						
Ceiling Structures/Linings	Vermiculite					
	8401/B00B/R0001/Ceiling Structures/Linings/S25				<b>Limited Samples Taken</b>	
<i>Vermiculite Ceilings may contain asbestos. Asbestos testing MUST be conducted prior to any disturbance works</i>						
<b>B00B - R0034 - General Storeroom (2.73 m2)</b>						
Ceiling Structures/Linings	Vermiculite					
	8401/B00B/R0001/Ceiling Structures/Linings/S25				<b>Limited Samples Taken</b>	
<i>Vermiculite Ceilings may contain asbestos. Asbestos testing MUST be conducted prior to any disturbance works</i>						
<b>B00B - R0035 - External Stairs (3.54 m2)</b>						
No Asbestos						
<b>B00B - R0036 - Cleaning Store - Distributed (4.09 m2)</b>						
No Asbestos						
<b>B00B - R0037 - External Stairs (3.59 m2)</b>						
Wall lining external	Flat AC Sheeting					
	8401/B00B/R0037/Wall lining external/S14				<b>No Asbestos Detected</b>	
<b>B00B - R0038 - External Movement (152.78 m2)</b>						
Ceiling Structures/Linings	Vermiculite					
	8401/B00B/R0001/Ceiling Structures/Linings/S25				<b>Limited Samples Taken</b>	
<i>Vermiculite Ceilings may contain asbestos. Asbestos testing MUST be conducted prior to any disturbance works</i>						
<b>B00B - R0039 - Plant (7.48 m2)</b>						
No Asbestos						
<b>B00B - R0040 - Plant (1.01 m2)</b>						
No Asbestos						
<b>B00B - R0041 - External Movement (1.6 m2)</b>						
No Asbestos						
<b>B00B - R1001 - Wood Technology L.S. (79.49 m2)</b>						
Ceiling Structures/Linings	Vermiculite	80m2	Throughout	Friable Asbestos (5)	High (3)	High Priority (6-8)
	8401/B00B/R1017/Ceiling Structures/Linings/S26				<b>Chrysotile (white asbestos)</b>	
<b>B00B - R1002 - Materials Store (16.19 m2)</b>						
Ceiling Structures/Linings	Vermiculite	16m2	Throughout	Friable Asbestos (5)	High (3)	High Priority (6-8)
	8401/B00B/R1017/Ceiling Structures/Linings/S26				<b>Chrysotile (white asbestos)</b>	
<b>B00B - R1003 - Materials Store (15.74 m2)</b>						
Ceiling Structures/Linings	Vermiculite	16m2	Throughout	Friable Asbestos (5)	High (3)	High Priority (6-8)
	8401/B00B/R1017/Ceiling Structures/Linings/S26				<b>Chrysotile (white asbestos)</b>	
<b>B00B - R1006 - Materials Store (12.2 m2)</b>						
Ceiling Structures/Linings	Vermiculite	13m2	Throughout	Friable Asbestos (5)	High (3)	High Priority (6-8)
	8401/B00B/R1017/Ceiling Structures/Linings/S26				<b>Chrysotile (white asbestos)</b>	
<b>B00B - R1007 - Materials Technology L.S. (67.49 m2)</b>						
Ceiling Structures/Linings	Vermiculite	69m2	Throughout	Friable Asbestos (5)	High (3)	High Priority (6-8)
	8401/B00B/R1017/Ceiling Structures/Linings/S26				<b>Chrysotile (white asbestos)</b>	
<b>B00B - R1008 - Materials Store (5.98 m2)</b>						
Ceiling Structures/Linings	Vermiculite	7m2	Throughout	Friable Asbestos (5)	High (3)	High Priority (6-8)
	8401/B00B/R1017/Ceiling Structures/Linings/S26				<b>Chrysotile (white asbestos)</b>	
<b>B00B - R1009 - Materials Store (6.2 m2)</b>						

Product	Material Description	Extent	Location Reference	Material Condition	Risk Status	Control Priority
Sample No					Test Result	
Ceiling Structures/Linings	Vermiculite	7m2	Throughout	Friable Asbestos (5)	High (3)	High Priority (6-8)
8401/B00B/R1017/Ceiling Structures/Linings/S26					<b>Chrysotile (white asbestos)</b>	
<b>B00B - R1010 - Music Learning Space (58.5 m2)</b>						
Ceiling Structures/Linings	Vermiculite	57m2	Throughout	Friable Asbestos (5)	High (3)	High Priority (6-8)
8401/B00B/R1017/Ceiling Structures/Linings/S26					<b>Chrysotile (white asbestos)</b>	
<b>B00B - R1012 - Art Learning Space (52.65 m2)</b>						
Ceiling Structures/Linings	Vermiculite	53m2	Throughout	Friable Asbestos (5)	Low (1)	Low Priority (2-3)
8401/B00B/R1017/Ceiling Structures/Linings/S26					<b>Chrysotile (white asbestos)</b>	
Floor Coverings Res/Textile	Vinyl Tiles	53m2	Throughout	Good Condition (1)	Low (1)	Low Priority (2-3)
8401/B00D/R0009/Floor Coverings Res/Textile/S5					<b>Chrysotile (white asbestos)</b>	
<b>B00B - R1013 - Art Learning Space (52.28 m2)</b>						
Ceiling Structures/Linings	Vermiculite	53m2	Throughout	Friable Asbestos (5)	High (3)	High Priority (6-8)
8401/B00B/R1017/Ceiling Structures/Linings/S26					<b>Chrysotile (white asbestos)</b>	
Floor Coverings Res/Textile	Vinyl Tiles	53m2	Throughout	Good Condition (1)	Low (1)	Low Priority (2-3)
8401/B00D/R0009/Floor Coverings Res/Textile/S5					<b>Chrysotile (white asbestos)</b>	
<b>B00B - R1014 - Kiln Space (21.41 m2)</b>						
Ceiling Structures/Linings	Vermiculite	22m2	Throughout	Friable Asbestos (5)	High (3)	High Priority (6-8)
8401/B00B/R1017/Ceiling Structures/Linings/S26					<b>Chrysotile (white asbestos)</b>	
Floor Coverings Res/Textile	Vinyl Tiles	22m2	Throughout	Good Condition (1)	Low (1)	Low Priority (2-3)
8401/B00D/R0009/Floor Coverings Res/Textile/S5					<b>Chrysotile (white asbestos)</b>	
<b>B00B - R1015 - Craft Store (10.62 m2)</b>						
Ceiling Structures/Linings	Vermiculite	11m2	Throughout	Friable Asbestos (5)	High (3)	High Priority (6-8)
8401/B00B/R1017/Ceiling Structures/Linings/S26					<b>Chrysotile (white asbestos)</b>	
Floor Coverings Res/Textile	Vinyl Tiles	11m2	Throughout	Good Condition (1)	Low (1)	Low Priority (2-3)
8401/B00D/R0009/Floor Coverings Res/Textile/S5					<b>Chrysotile (white asbestos)</b>	
<b>B00B - R1016 - Music Store (8.9 m2)</b>						
Ceiling Structures/Linings	Vermiculite	8m2	Throughout	Friable Asbestos (5)	High (3)	High Priority (6-8)
8401/B00B/R1017/Ceiling Structures/Linings/S26					<b>Chrysotile (white asbestos)</b>	
<b>B00B - R1017 - Music Learning Space (50.53 m2)</b>						
Ceiling Structures/Linings	Vermiculite	51m2	Throughout	Friable Asbestos (5)	High (3)	High Priority (6-8)
8401/B00B/R1017/Ceiling Structures/Linings/S26					<b>Chrysotile (white asbestos)</b>	
Window Sills	Dust Samples	4m2	East & West	Friable Asbestos (5)	High (3)	High Priority (6-8)
8401/B00B/R1017/Window Sills/S44					<b>Chrysotile (white asbestos)</b>	
Floor Coverings Res/Textile	Dust Samples					<b>No Asbestos Detected</b>
8401/B00B/R1017/Floor Coverings Res/Textile/S45						
<b>B00B - R1018 - Music Store (4.13 m2)</b>						
Ceiling Structures/Linings	Vermiculite	5m2	Throughout	Friable Asbestos (5)	High (3)	High Priority (6-8)
8401/B00B/R1017/Ceiling Structures/Linings/S26					<b>Chrysotile (white asbestos)</b>	
<b>B00B - R1020 - Distribution Board Cupboard (0.9 m2)</b>				Note: No inspection of live electrical installation.		
No Asbestos						
<b>B00B - R1021 - Distribution Board Cupboard (0.88 m2)</b>				Note: No inspection of live electrical installation.		
No Asbestos						

Product	Material Description	Extent	Location Reference	Material Condition	Risk Status	Control Priority
Sample No					Test Result	
<b>B00B - R1022 - Staff Study (21.24 m2)</b>						
Ceiling Structures/Linings	Vermiculite	21.23m2	Throughout	Friable Asbestos (5)	High (3)	High Priority (6-8)
8401/B00B/R1017/Ceiling Structures/Linings/S26					<b>Chrysotile (white asbestos)</b>	
<b>B00B - R1023 - Tea Room (4.53 m2)</b>						
Ceiling Structures/Linings	Vermiculite	4.53m2	Throughout	Friable Asbestos (5)	High (3)	High Priority (6-8)
8401/B00B/R1017/Ceiling Structures/Linings/S26					<b>Chrysotile (white asbestos)</b>	
<b>B00B - R1024 - Music Store (3.11 m2)</b>						
Wall lining external	Flat AC Sheeting					
8401/B00B/R0037/Wall lining external/S14					<b>No Asbestos Detected</b>	
<b>B00B - R1025 - Metal Technology L.S. (85.97 m2)</b>						
Ceiling Structures/Linings	Vermiculite	85.94m2	Throughout	Friable Asbestos (5)	High (3)	High Priority (6-8)
8401/B00B/R1017/Ceiling Structures/Linings/S26					<b>Chrysotile (white asbestos)</b>	
<b>B00B - R1026 - Materials Store (13.37 m2)</b>						
Ceiling Structures/Linings	Vermiculite	13.37m2	Throughout	Friable Asbestos (5)	High (3)	High Priority (6-8)
8401/B00B/R1017/Ceiling Structures/Linings/S26					<b>Chrysotile (white asbestos)</b>	
<b>B00B - R1027 - Resources Store (3.11 m2)</b>						
Wall lining external	Flat AC Sheeting					
8401/B00B/R0037/Wall lining external/S14					<b>No Asbestos Detected</b>	
<b>B00B - R1028 - External Stairs (5.65 m2)</b>						
No Asbestos						
<b>B00B - R1029 - External Stairs (5.89 m2)</b>						
No Asbestos						
<b>B00B - R1030 - Handwashing Facilities (0.33 m2)</b>						
No Asbestos						
<b>B00B - R1031 - External Movement (134.4 m2)</b>						
No Asbestos						
<b>B00B - R1032 - External Movement (1.54 m2)</b>						
No Asbestos						

2017

Product	Material Description	Extent	Location Reference	Material Condition	Risk Status	Control Priority
Sample No					Test Result	

**B00C - Pupil Facilities/Physical Education - 1965 - Brick/Block (Brick/Block)**

**Exterior**

Underfloor Voids - Slab on Ground	Non Accessible Area - Area inaccessible
Ceiling Voids	No Asbestos Found

**Interior**

**B00C - R0001 - Machine Storage (39.54 m2)**

No Asbestos

**B00C - R0002 - Movement (318.14 m2)**

No Asbestos

**B00C - R0004 - General Storeroom (6.99 m2)**

Ceiling Structures/Linings	Vermiculite 8401/B00C/R0020/Ceiling Structures/Linings/S28	Limited Samples Taken
<i>Vermiculite Ceilings may contain asbestos. Asbestos testing MUST be conducted prior to any disturbance works</i>		

**B00C - R0005 - Sport Equipment Store (5.81 m2)**

Ceiling Structures/Linings	Vermiculite 8401/B00C/R0020/Ceiling Structures/Linings/S28	Limited Samples Taken
<i>Vermiculite Ceilings may contain asbestos. Asbestos testing MUST be conducted prior to any disturbance works</i>		

**B00C - R0006 - Student Canteen (56.35 m2)**

Ceiling Structures/Linings	Vermiculite 8401/B00C/R0020/Ceiling Structures/Linings/S28	Limited Samples Taken
<i>Vermiculite Ceilings may contain asbestos. Asbestos testing MUST be conducted prior to any disturbance works</i>		

**B00C - R0008 - Pantry (3.65 m2)**

Ceiling Structures/Linings	Vermiculite 8401/B00C/R0020/Ceiling Structures/Linings/S28	Limited Samples Taken
<i>Vermiculite Ceilings may contain asbestos. Asbestos testing MUST be conducted prior to any disturbance works</i>		

**B00C - R0009 - Uniform Shop (14.04 m2)**

Ceiling Structures/Linings	Vermiculite 8401/B00C/R0020/Ceiling Structures/Linings/S28	Limited Samples Taken
<i>Vermiculite Ceilings may contain asbestos. Asbestos testing MUST be conducted prior to any disturbance works</i>		

**B00C - R0010 - Bulk Store (19.46 m2)**

Ceiling Structures/Linings	Vermiculite 8401/B00C/R0020/Ceiling Structures/Linings/S28	Limited Samples Taken
<i>Vermiculite Ceilings may contain asbestos. Asbestos testing MUST be conducted prior to any disturbance works</i>		

**B00C - R0011 - Cleaning Supplies Store (2.03 m2)**

Ceiling Structures/Linings	Vermiculite 8401/B00C/R0020/Ceiling Structures/Linings/S28	Limited Samples Taken
<i>Vermiculite Ceilings may contain asbestos. Asbestos testing MUST be conducted prior to any disturbance works</i>		

**B00C - R0012 - Sport Equipment Store (16.16 m2)**

Ceiling Structures/Linings	Vermiculite 8401/B00C/R0020/Ceiling Structures/Linings/S28	Limited Samples Taken
<i>Vermiculite Ceilings may contain asbestos. Asbestos testing MUST be conducted prior to any disturbance works</i>		

**B00C - R0013 - General Storeroom (1.32 m2)**

Ceiling Structures/Linings	Vermiculite 8401/B00C/R0020/Ceiling Structures/Linings/S28	Limited Samples Taken
<i>Vermiculite Ceilings may contain asbestos. Asbestos testing MUST be conducted prior to any disturbance works</i>		

**B00C - R0014 - Movement (5.52 m2)**

Ceiling Structures/Linings	Vermiculite 8401/B00C/R0020/Ceiling Structures/Linings/S28	Limited Samples Taken
<i>Vermiculite Ceilings may contain asbestos. Asbestos testing MUST be conducted prior to any disturbance works</i>		

**B00C - R0016 - Sport Equipment Store (6.68 m2)**

Product	Material Description	Extent	Location Reference	Material Condition	Risk Status	Control Priority
Sample No					Test Result	
Ceiling Structures/Linings	Vermiculite	8401/B00C/R0020/Ceiling Structures/Linings/S28				Limited Samples Taken
<i>Vermiculite Ceilings may contain asbestos. Asbestos testing MUST be conducted prior to any disturbance works</i>						
<b>B00C - R0019 - External Movement (59.93 m2)</b>						
No Asbestos						
<b>B00C - R0020 - Vending Machines (17.14 m2)</b>						
Ceiling Structures/Linings	Vermiculite	8401/B00C/R0020/Ceiling Structures/Linings/S28				Limited Samples Taken
<i>Vermiculite Ceilings may contain asbestos. Asbestos testing MUST be conducted prior to any disturbance works</i>						
Top of Display Board	Dust Sample	8401/B00C/R0020/Top of Display Board/S35				No Asbestos Detected
Top of Door Frame	Dust Sample	8401/B00C/R0020/Top of Door Frame/S36				No Asbestos Detected
Concrete Floor	Dust Sample	8401/B00C/R0020/Concrete Floor/S37				No Asbestos Detected
<b>B00C - R0021 - External Movement (6.31 m2)</b>						
Ceiling Structures/Linings	Vermiculite	8401/B00C/R0021/Ceiling Structures/Linings/S27				Limited Samples Taken
<i>Vermiculite Ceilings may contain asbestos. Asbestos testing MUST be conducted prior to any disturbance works</i>						
<b>B00C - R0022 - Cleaning Store - Distributed (1.4 m2)</b>						
No Asbestos						
<b>B00C - R0023 - Staff - Toilet (1.49 m2)</b>						
No Asbestos						
<b>B00C - R0024 - Movement (8.75 m2)</b>						
No Asbestos						
<b>B00C - R0025 - General Storeroom (9.31 m2)</b>						
No Asbestos						
<b>B00C - R0026 - Stairs (3.93 m2)</b>						
No Asbestos						
<b>B00C - R0027 - Movement (8.75 m2)</b>						
No Asbestos						
<b>B00C - R0028 - Stairs (3.55 m2)</b>						
No Asbestos						
<b>B00C - R0029 - General Storeroom (9.81 m2)</b>						
No Asbestos						
<b>B00C - R0030 - Outdoor Equipment Store (18.21 m2)</b>						
No Asbestos						
<b>B00C - R1001 - Cleaning Store - Distributed (7.12 m2)</b>						
No Asbestos						
<b>B00C - R1003 - Change (38.77 m2)</b>						
No Asbestos						
<b>B00C - R1006 - Cleaning Store - Distributed (7.18 m2)</b>						
No Asbestos						
<b>B00C - R1007 - Movement (8.91 m2)</b>						
No Asbestos						
<b>B00C - R1008 - Movement (8.81 m2)</b>						
No Asbestos						
<b>B00C - R1009 - Stairs (13.74 m2)</b>						
No Asbestos						
<b>B00C - R1010 - Stairs (14.09 m2)</b>						

Product	Material Description	Extent	Location Reference	Material Condition	Risk Status	Control Priority
	<b>Sample No</b>					<b>Test Result</b>

No Asbestos

**B00C - R1011 - Change (35.93 m2)**

No Asbestos

**B00C - R1012 - Plant (2.42 m2)**

No Asbestos

**B00C - R1013 - Toilets-Girls (35.83 m2)**

No Asbestos

**B00C - R1014 - Plant (2.38 m2)**

No Asbestos

**B00C - R1015 - Toilets-Boys (32.84 m2)**

No Asbestos

**B00C - R1016 - Plant (2.37 m2)**

No Asbestos

**B00C - R1017 - Plant (2.37 m2)**

No Asbestos

2017



Product	Material Description	Extent	Location Reference	Material Condition	Risk Status	Control Priority
Sample No					Test Result	

**B00D - Science Learning/General Learning - 1965 - Brick/Block (Brick/Block)**

**Exterior**

Louvers	Compressed AC Sheet	50m2	East, West	Good Condition (1)	Low (1)	Low Priority (2-3)
	8401/B00A/Louvers/S1					<b>Chrysotile (white asbestos)</b>
Eaves Linings	Vermiculite					<b>Limited Samples Taken</b>
	8401/B00D/R0023/Ceiling Structures/Linings/S21					<b>Vermiculite Ceilings may contain asbestos. Asbestos testing MUST be conducted prior to any disturbance works</b>
Underfloor Voids - Slab on Ground	Non Accessible Area					
	- Area inaccessible					
Ceiling Voids - Flat Roof	Non Accessible Area					
	- Area inaccessible					

**Interior**

**B00D - R0001 - General Learning Space (65.06 m2)**

Ceiling Structures/Linings	Vermiculite					<b>Limited Samples Taken</b>
	8401/B00D/R0001/Ceiling Structures/Linings/S29					<b>Vermiculite Ceilings may contain asbestos. Asbestos testing MUST be conducted prior to any disturbance works</b>
Window Sills	Dust Samples					<b>No Asbestos Detected</b>
	8401/B00D/R0001/Window Sills/S46					
Floor Coverings Res/Textile	Dust Samples					<b>No Asbestos Detected</b>
	8401/B00D/R0001/Floor Coverings Res/Textile/S47					

**B00D - R0002 - Distribution Board Cupboard (0.9 m2)**

Note: No inspection of live electrical installation.

No Asbestos

**B00D - R0004 - Staff - Toilet (4.51 m2)**

Ceiling Structures/Linings	Vermiculite					<b>Limited Samples Taken</b>
	8401/B00D/R0001/Ceiling Structures/Linings/S29					<b>Vermiculite Ceilings may contain asbestos. Asbestos testing MUST be conducted prior to any disturbance works</b>

**B00D - R0005 - Cleaning Store - Distributed (3.58 m2)**

No Asbestos

**B00D - R0006 - Staff - Toilet (4.55 m2)**

Ceiling Structures/Linings	Vermiculite					<b>Limited Samples Taken</b>
	8401/B00D/R0001/Ceiling Structures/Linings/S29					<b>Vermiculite Ceilings may contain asbestos. Asbestos testing MUST be conducted prior to any disturbance works</b>

**B00D - R0008 - General Storeroom (19.07 m2)**

Ceiling Structures/Linings	Vermiculite					<b>Limited Samples Taken</b>
	8401/B00D/R0001/Ceiling Structures/Linings/S29					<b>Vermiculite Ceilings may contain asbestos. Asbestos testing MUST be conducted prior to any disturbance works</b>
Floor Coverings Res/Textile	Vinyl Tiles	20m2	Throughout	Good Condition (1)	Low (1)	Low Priority (2-3)
	8401/B00D/R0009/Floor Coverings Res/Textile/S5					<b>Chrysotile (white asbestos)</b>

**B00D - R0009 - Other-Vacant (6.52 m2)**

Ceiling Structures/Linings	Vermiculite					<b>Limited Samples Taken</b>
	8401/B00D/R0001/Ceiling Structures/Linings/S29					<b>Vermiculite Ceilings may contain asbestos. Asbestos testing MUST be conducted prior to any disturbance works</b>
Floor Coverings Res/Textile	Vinyl Tiles	7m2	Throughout	Good Condition (1)	Low (1)	Low Priority (2-3)
	8401/B00D/R0009/Floor Coverings Res/Textile/S5					<b>Chrysotile (white asbestos)</b>

**B00D - R0010 - Laboratory L.S. (85.97 m2)**

Ceiling Structures/Linings	Vermiculite					<b>Limited Samples Taken</b>
	8401/B00D/R0001/Ceiling Structures/Linings/S29					<b>Vermiculite Ceilings may contain asbestos. Asbestos testing MUST be conducted prior to any disturbance works</b>

Product	Material Description	Extent	Location Reference	Material Condition	Risk Status	Control Priority
Sample No				Test Result		
Floor Coverings Res/Textile	Vinyl Tiles	86m2	Throughout	Good Condition (1)	Low (1)	Low Priority (2-3)
	8401/B00D/R0009/Floor Coverings Res/Textile/S5				<b>Chrysotile (white asbestos)</b>	
Workbench	Compressed AC Sheet	2m2	West	Good Condition (1)	Low (1)	Low Priority (2-3)
	8401/B00D/R0010/Workbench/S6				<b>Chrysotile (white asbestos) , Amosite (brown asbestos)</b>	
<b>B00D - R0011 - Plant (0.9 m2)</b>						
No Asbestos						
<b>B00D - R0012 - Apparatus Store (13.29 m2)</b>						
No Asbestos						
<b>B00D - R0013 - Resources Store (13.36 m2)</b>						
Ceiling Structures/Linings	Vermiculite					
	8401/B00D/R0001/Ceiling Structures/Linings/S29				<b>Limited Samples Taken</b>	
<b>Vermiculite Ceilings may contain asbestos. Asbestos testing MUST be conducted prior to any disturbance works</b>						
Floor Coverings Res/Textile	Vinyl Tiles	14m2	Throughout	Good Condition (1)	Low (1)	Low Priority (2-3)
	8401/B00D/R0009/Floor Coverings Res/Textile/S5				<b>Chrysotile (white asbestos)</b>	
<b>B00D - R0014 - General Learning Space (51.4 m2)</b>						
Ceiling Structures/Linings	Vermiculite					
	8401/B00D/R0001/Ceiling Structures/Linings/S29				<b>Limited Samples Taken</b>	
<b>Vermiculite Ceilings may contain asbestos. Asbestos testing MUST be conducted prior to any disturbance works</b>						
Floor Coverings Res/Textile	Vinyl Tiles	52m2	Throughout	Good Condition (1)	Low (1)	Low Priority (2-3)
	8401/B00D/R0009/Floor Coverings Res/Textile/S5				<b>Chrysotile (white asbestos)</b>	
<b>B00D - R0015 - Laboratory L.S. (92.65 m2)</b>						
Ceiling Structures/Linings	Vermiculite					
	8401/B00D/R0001/Ceiling Structures/Linings/S29				<b>Limited Samples Taken</b>	
<b>Vermiculite Ceilings may contain asbestos. Asbestos testing MUST be conducted prior to any disturbance works</b>						
<b>B00D - R0016 - Preparation - Science (29.01 m2)</b>						
Ceiling Structures/Linings	Vermiculite					
	8401/B00D/R0001/Ceiling Structures/Linings/S29				<b>Limited Samples Taken</b>	
<b>Vermiculite Ceilings may contain asbestos. Asbestos testing MUST be conducted prior to any disturbance works</b>						
<b>B00D - R0017 - General Storeroom (9.78 m2)</b>						
Ceiling Structures/Linings	Vermiculite					
	8401/B00D/R0001/Ceiling Structures/Linings/S29				<b>Limited Samples Taken</b>	
<b>Vermiculite Ceilings may contain asbestos. Asbestos testing MUST be conducted prior to any disturbance works</b>						
<b>B00D - R0018 - Laboratory L.S. (93.05 m2)</b>						
Ceiling Structures/Linings	Vermiculite					
	8401/B00D/R0001/Ceiling Structures/Linings/S29				<b>Limited Samples Taken</b>	
<b>Vermiculite Ceilings may contain asbestos. Asbestos testing MUST be conducted prior to any disturbance works</b>						
<b>B00D - R0020 - Toilets-Girls (40.42 m2)</b>						
Ceiling Structures/Linings	Vermiculite					
	8401/B00D/R0001/Ceiling Structures/Linings/S29				<b>Limited Samples Taken</b>	
<b>Vermiculite Ceilings may contain asbestos. Asbestos testing MUST be conducted prior to any disturbance works</b>						
<b>B00D - R0021 - Plant (1.04 m2)</b>						
Non Accessible						
<b>B00D - R0022 - Plant (2.85 m2)</b>						
Non Accessible						
<b>B00D - R0023 - Toilets-Boys (31.48 m2)</b>						
Ceiling Structures/Linings	Vermiculite					
	8401/B00D/R0001/Ceiling Structures/Linings/S29				<b>Limited Samples Taken</b>	
<b>Vermiculite Ceilings may contain asbestos. Asbestos testing MUST be conducted prior to any disturbance works</b>						
<b>B00D - R0024 - Plant (2.39 m2)</b>						

Product	Material Description	Extent	Location Reference	Material Condition	Risk Status	Control Priority
Sample No					Test Result	
Non Accessible						
<b>B00D - R0025 - Plant (2.38 m2)</b>						
Non Accessible						
<b>B00D - R0026 - Cleaning Store - Distributed (6.5 m2)</b>						
No Asbestos						
<b>B00D - R0027 - External Stairs (3.86 m2)</b>						
No Asbestos						
<b>B00D - R0028 - General Storeroom (6.25 m2)</b>						
No Asbestos						
<b>B00D - R0029 - External Stairs (3.61 m2)</b>						
No Asbestos						
<b>B00D - R0030 - External Movement (150.56 m2)</b>						
Ceiling Structures/Linings	Vermiculite	150.51m2	Throughout	Friable Asbestos (5)	High (3)	High Priority (6-8)
	8401/B00D/R1003/Ceiling Structures/Linings/S30					<b>Chrysotile (white asbestos)</b>
Upper Infill Panels	Flat AC Sheeting					<b>No Asbestos Detected</b>
	8401/B00D/R0030/Upper Infill Panels/S22					
<b>B00D - R0031 - External Movement (1.81 m2)</b>						
No Asbestos						
<b>B00D - R1001 - Resources Store (12.27 m2)</b>						
Ceiling Structures/Linings	Vermiculite	13m2	Throughout	Friable Asbestos (5)	High (3)	High Priority (6-8)
	8401/B00D/R1003/Ceiling Structures/Linings/S30					<b>Chrysotile (white asbestos)</b>
Floor Coverings Res/Textile	Vinyl Tiles	13m2	Throughout	Good Condition (1)	Low (1)	Low Priority (2-3)
	8401/B00D/R0009/Floor Coverings Res/Textile/S5					<b>Chrysotile (white asbestos)</b>
<b>B00D - R1002 - Resources Store (5.11 m2)</b>						
Ceiling Structures/Linings	Vermiculite	6m2	Throughout	Friable Asbestos (5)	High (3)	High Priority (6-8)
	8401/B00D/R1003/Ceiling Structures/Linings/S30					<b>Chrysotile (white asbestos)</b>
Floor Coverings Res/Textile	Vinyl Tiles	6m2	Throughout	Good Condition (1)	Low (1)	Low Priority (2-3)
	8401/B00D/R0009/Floor Coverings Res/Textile/S5					<b>Chrysotile (white asbestos)</b>
<b>B00D - R1003 - General Learning Space (53.53 m2)</b>						
Ceiling Structures/Linings	Vermiculite	55m2	Throughout	Friable Asbestos (5)	High (3)	High Priority (6-8)
	8401/B00D/R1003/Ceiling Structures/Linings/S30					<b>Chrysotile (white asbestos)</b>
Floor Coverings Res/Textile	Vinyl Tiles	55m2	Throughout	Good Condition (1)	Low (1)	Low Priority (2-3)
	8401/B00D/R0009/Floor Coverings Res/Textile/S5					<b>Chrysotile (white asbestos)</b>
Window Sills	Dust Sample	2m2	East	Friable Asbestos (5)	High (3)	High Priority (6-8)
	8401/B00D/R1003/Window Sills/S48					<b>Chrysotile (white asbestos)</b>
Window Sills	Dust Sample					<b>No Asbestos Detected</b>
	8401/B00D/R1003/Window Sills/S49					
Floor Coverings Res/Textile	Dust Samples					<b>No Asbestos Detected</b>
	8401/B00D/R1003/Floor Coverings Res/Textile/S50					
<b>B00D - R1004 - General Learning Space (58.76 m2)</b>						
Ceiling Structures/Linings	Vermiculite	60m2	Throughout	Friable Asbestos (5)	High (3)	High Priority (6-8)
	8401/B00D/R1003/Ceiling Structures/Linings/S30					<b>Chrysotile (white asbestos)</b>

Product	Material Description	Extent	Location Reference	Material Condition	Risk Status	Control Priority
Sample No					Test Result	
Floor Coverings Res/Textile	Vinyl Tiles	60m2	Throughout	Good Condition (1)	Low (1)	Low Priority (2-3)
8401/B00D/R0009/Floor Coverings Res/Textile/S5					Chrysotile (white asbestos)	
<b>B00D - R1006 - Computer Learning Space (65.65 m2)</b>						
Ceiling Structures/Linings	Vermiculite	66m2	Throughout	Friable Asbestos (5)	High (3)	High Priority (6-8)
8401/B00D/R1003/Ceiling Structures/Linings/S30					Chrysotile (white asbestos)	
Floor Coverings Res/Textile	Vinyl Tiles	66m2	Throughout	Good Condition (1)	Low (1)	Low Priority (2-3)
8401/B00D/R0009/Floor Coverings Res/Textile/S5					Chrysotile (white asbestos)	
<b>B00D - R1007 - Computer Learning Space (58.67 m2)</b>						
Ceiling Structures/Linings	Vermiculite	60m2	Throughout	Friable Asbestos (5)	High (3)	High Priority (6-8)
8401/B00D/R1003/Ceiling Structures/Linings/S30					Chrysotile (white asbestos)	
<b>B00D - R1008 - General Learning Space (53.53 m2)</b>						
Ceiling Structures/Linings	Vermiculite	55m2	Throughout	Friable Asbestos (5)	High (3)	High Priority (6-8)
8401/B00D/R1003/Ceiling Structures/Linings/S30					Chrysotile (white asbestos)	
Floor Coverings Res/Textile	Vinyl Tiles	55m2	Throughout	Good Condition (1)	Low (1)	Low Priority (2-3)
8401/B00D/R0009/Floor Coverings Res/Textile/S5					Chrysotile (white asbestos)	
<b>B00D - R1010 - General Learning Space (58.75 m2)</b>						
Ceiling Structures/Linings	Vermiculite	59m2	Throughout	Friable Asbestos (5)	High (3)	High Priority (6-8)
8401/B00D/R1003/Ceiling Structures/Linings/S30					Chrysotile (white asbestos)	
Floor Coverings Res/Textile	Vinyl Tiles	59m2	Throughout	Good Condition (1)	Low (1)	Low Priority (2-3)
8401/B00D/R0009/Floor Coverings Res/Textile/S5					Chrysotile (white asbestos)	
<b>B00D - R1011 - General Learning Space (52.43 m2)</b>						
Ceiling Structures/Linings	Vermiculite	53m2	Throughout	Friable Asbestos (5)	High (3)	High Priority (6-8)
8401/B00D/R1003/Ceiling Structures/Linings/S30					Chrysotile (white asbestos)	
Floor Coverings Res/Textile	Vinyl Tiles	53m2	Throughout	Good Condition (1)	Low (1)	Low Priority (2-3)
8401/B00D/R0009/Floor Coverings Res/Textile/S5					Chrysotile (white asbestos)	
<b>B00D - R1012 - General Learning Space (52.51 m2)</b>						
Ceiling Structures/Linings	Vermiculite	53m2	Throughout	Friable Asbestos (5)	High (3)	High Priority (6-8)
8401/B00D/R1003/Ceiling Structures/Linings/S30					Chrysotile (white asbestos)	
Floor Coverings Res/Textile	Vinyl Tiles	53m2	Throughout	Good Condition (1)	Low (1)	Low Priority (2-3)
8401/B00D/R0009/Floor Coverings Res/Textile/S5					Chrysotile (white asbestos)	
<b>B00D - R1013 - General Learning Space (59 m2)</b>						
Ceiling Structures/Linings	Vermiculite	59m2	Throughout	Friable Asbestos (5)	High (3)	High Priority (6-8)
8401/B00D/R1003/Ceiling Structures/Linings/S30					Chrysotile (white asbestos)	
<b>B00D - R1015 - Distribution Board Cupboard (0.92 m2)</b>						
No Asbestos				Note: No inspection of live electrical installation.		
<b>B00D - R1016 - Distribution Board Cupboard (0.89 m2)</b>						
No Asbestos				Note: No inspection of live electrical installation.		
<b>B00D - R1017 - Staff Study (19.92 m2)</b>						
Ceiling Structures/Linings	Vermiculite	19.91m2	Throughout	Friable Asbestos (5)	High (3)	High Priority (6-8)
8401/B00D/R1003/Ceiling Structures/Linings/S30					Chrysotile (white asbestos)	
<b>B00D - R1018 - Tea Room (3.92 m2)</b>						

Product	Material Description	Extent	Location Reference	Material Condition	Risk Status	Control Priority
Sample No					Test Result	
Ceiling Structures/Linings	Vermiculite	3.92m2	Throughout	Friable Asbestos (5)	High (3)	High Priority (6-8)
8401/B00D/R1003/Ceiling Structures/Linings/S30					<b>Chrysotile (white asbestos)</b>	
<b>B00D - R1019 - Staff Study (19.07 m2)</b>						
Ceiling Structures/Linings	Vermiculite	19.06m2	Throughout	Friable Asbestos (5)	High (3)	High Priority (6-8)
8401/B00D/R1003/Ceiling Structures/Linings/S30					<b>Chrysotile (white asbestos)</b>	
<b>B00D - R1020 - Tea Room (3.48 m2)</b>						
Ceiling Structures/Linings	Vermiculite	3.48m2	Throughout	Friable Asbestos (5)	High (3)	High Priority (6-8)
8401/B00D/R1003/Ceiling Structures/Linings/S30					<b>Chrysotile (white asbestos)</b>	
<b>B00D - R1021 - Cleaning Store - Distributed (2.87 m2)</b>						
Wall Linings Internal	Flat AC Sheeting					
8401/B00D/R1021/Wall Linings Internal/S23					<b>No Asbestos Detected</b>	
<b>B00D - R1022 - External Stairs (5.86 m2)</b>						
No Asbestos						
<b>B00D - R1023 - External Stairs (5.81 m2)</b>						
No Asbestos						
<b>B00D - R1024 - External Movement (146.94 m2)</b>						
No Asbestos						

2017

Product	Material Description	Extent	Location Reference	Material Condition	Risk Status	Control Priority
Sample No					Test Result	

**B00E - Library/General Learning/Science Learning - 1965 - Brick/Block (Brick/Block)****Exterior**

Louvers	Compressed AC Sheet	50m2	East, West	Good Condition (1)	Low (1)	Low Priority (2-3)
	8401/B00A/Louvers/S1					<b>Chrysotile (white asbestos)</b>
Eaves Linings	Vermiculite					<b>Limited Samples Taken</b>
	8401/B00E/R1029/Ceiling Structures/Linings/S17					<b>Vermiculite Ceilings may contain asbestos. Asbestos testing MUST be conducted prior to any disturbance works</b>
Underfloor Voids - Slab on Ground	Non Accessible Area					
	- Area inaccessible					
Ceiling Voids - Flat Roof	Non Accessible Area					
	- Area inaccessible					

**Interior****B00E - R0001 - Interview/Office - Type 1 (15.61 m2)**

Ceiling Structures/Linings	Vermiculite					<b>Limited Samples Taken</b>
	8401/B00E/R0004/Ceiling Structures/Linings/S31					<b>Vermiculite Ceilings may contain asbestos. Asbestos testing MUST be conducted prior to any disturbance works</b>

**B00E - R0002 - Tea Room (11.04 m2)**

Ceiling Structures/Linings	Vermiculite					<b>Limited Samples Taken</b>
	8401/B00E/R0004/Ceiling Structures/Linings/S31					<b>Vermiculite Ceilings may contain asbestos. Asbestos testing MUST be conducted prior to any disturbance works</b>

**B00E - R0003 - Staff Study (26.03 m2)**

Ceiling Structures/Linings	Vermiculite					<b>Limited Samples Taken</b>
	8401/B00E/R0004/Ceiling Structures/Linings/S31					<b>Vermiculite Ceilings may contain asbestos. Asbestos testing MUST be conducted prior to any disturbance works</b>

**B00E - R0004 - Staff Study (79.91 m2)**

Ceiling Structures/Linings	Vermiculite					<b>Limited Samples Taken</b>
	8401/B00E/R0004/Ceiling Structures/Linings/S31					<b>Vermiculite Ceilings may contain asbestos. Asbestos testing MUST be conducted prior to any disturbance works</b>

Floor Coverings Res/Textile	Vinyl Tiles	81m2	Throughout	Good Condition (1)	Low (1)	Low Priority (2-3)
	8401/B00D/R0009/Floor Coverings Res/Textile/S5					<b>Chrysotile (white asbestos)</b>

Window Sills	Dust Sample					<b>No Asbestos Detected</b>
	8401/B00E/R0004/Window Sills/S38					

Floor Coverings Res/Textile	Dust Samples					<b>No Asbestos Detected</b>
	8401/B00E/R0004/Floor Coverings Res/Textile/S39					

**B00E - R0005 - Tea Room (5.59 m2)**

Ceiling Structures/Linings	Vermiculite					<b>Limited Samples Taken</b>
	8401/B00E/R0004/Ceiling Structures/Linings/S31					<b>Vermiculite Ceilings may contain asbestos. Asbestos testing MUST be conducted prior to any disturbance works</b>

Floor Coverings Res/Textile	Vinyl Tiles	6m2	Throughout	Good Condition (1)	Low (1)	Low Priority (2-3)
	8401/B00D/R0009/Floor Coverings Res/Textile/S5					<b>Chrysotile (white asbestos)</b>

**B00E - R0006 - Staff Study (52.65 m2)**

Ceiling Structures/Linings	Vermiculite					<b>Limited Samples Taken</b>
	8401/B00E/R0004/Ceiling Structures/Linings/S31					<b>Vermiculite Ceilings may contain asbestos. Asbestos testing MUST be conducted prior to any disturbance works</b>

Floor Coverings Res/Textile	Vinyl Tiles	54m2	Throughout	Good Condition (1)	Low (1)	Low Priority (2-3)
	8401/B00D/R0009/Floor Coverings Res/Textile/S5					<b>Chrysotile (white asbestos)</b>

**B00E - R0007 - General Storeroom (7.51 m2)**



Product	Material Description	Extent	Location Reference	Material Condition	Risk Status	Control Priority
Sample No					Test Result	
Ceiling Structures/Linings	Vermiculite 8401/B00E/R0004/Ceiling Structures/Linings/S31					Limited Samples Taken <i>Vermiculite Ceilings may contain asbestos. Asbestos testing MUST be conducted prior to any disturbance works</i>
<b>B00E - R0008 - Sport Equipment Store (2.94 m2)</b>						
Ceiling Structures/Linings	Vermiculite 8401/B00E/R0004/Ceiling Structures/Linings/S31					Limited Samples Taken <i>Vermiculite Ceilings may contain asbestos. Asbestos testing MUST be conducted prior to any disturbance works</i>
<b>B00E - R0009 - Plant (0.84 m2)</b>						
No Asbestos						
<b>B00E - R0010 - Staff - Toilet (2.63 m2)</b>						
No Asbestos						
<b>B00E - R0011 - Computer Learning Space (32.25 m2)</b>						
Ceiling Structures/Linings	Vermiculite 8401/B00E/R0004/Ceiling Structures/Linings/S31					Limited Samples Taken <i>Vermiculite Ceilings may contain asbestos. Asbestos testing MUST be conducted prior to any disturbance works</i>
<b>B00E - R0012 - General Learning Space (52.94 m2)</b>						
Ceiling Structures/Linings	Vermiculite 8401/B00E/R0004/Ceiling Structures/Linings/S31					Limited Samples Taken <i>Vermiculite Ceilings may contain asbestos. Asbestos testing MUST be conducted prior to any disturbance works</i>
<b>B00E - R0013 - General Storeroom (0.64 m2)</b>						
No Asbestos						
<b>B00E - R0014 - Chemical Store (25.92 m2)</b>						
Ceiling Structures/Linings	Vermiculite 8401/B00E/R0004/Ceiling Structures/Linings/S31					Limited Samples Taken <i>Vermiculite Ceilings may contain asbestos. Asbestos testing MUST be conducted prior to any disturbance works</i>
<b>B00E - R0015 - Laboratory L.S. (92.72 m2)</b>						
Ceiling Structures/Linings	Vermiculite 8401/B00E/R0004/Ceiling Structures/Linings/S31					Limited Samples Taken <i>Vermiculite Ceilings may contain asbestos. Asbestos testing MUST be conducted prior to any disturbance works</i>
Workbench	Compressed AC Sheet 8401/B00D/R0010/Workbench/S6	1m2	West	Good Condition (1)	Low (1)	Low Priority (2-3) <i>Chrysotile (white asbestos) , Amosite (brown asbestos)</i>
<b>B00E - R0016 - General Storeroom (9.74 m2)</b>						
Ceiling Structures/Linings	Vermiculite 8401/B00E/R0004/Ceiling Structures/Linings/S31					Limited Samples Taken <i>Vermiculite Ceilings may contain asbestos. Asbestos testing MUST be conducted prior to any disturbance works</i>
<b>B00E - R0017 - Preparation - Science (29.06 m2)</b>						
Ceiling Structures/Linings	Vermiculite 8401/B00E/R0004/Ceiling Structures/Linings/S31					Limited Samples Taken <i>Vermiculite Ceilings may contain asbestos. Asbestos testing MUST be conducted prior to any disturbance works</i>
<b>B00E - R0018 - Laboratory L.S. (85.9 m2)</b>						
Ceiling Structures/Linings	Vermiculite 8401/B00E/R0004/Ceiling Structures/Linings/S31					Limited Samples Taken <i>Vermiculite Ceilings may contain asbestos. Asbestos testing MUST be conducted prior to any disturbance works</i>
Workbench	Compressed AC Sheet 8401/B00D/R0010/Workbench/S6	1m2	West	Good Condition (1)	Low (1)	Low Priority (2-3) <i>Chrysotile (white asbestos) , Amosite (brown asbestos)</i>
<b>B00E - R0019 - Cleaning Store - Distributed (3.49 m2)</b>						
No Asbestos						
<b>B00E - R0021 - Main Entry (10.08 m2)</b>						
No Asbestos						
<b>B00E - R0022 - Main Area (291.78 m2)</b>						

Product	Material Description	Extent	Location Reference	Material Condition	Risk Status	Control Priority
Sample No					Test Result	
Ceiling Structures/Linings	Vermiculite					
	8401/B00E/R0004/Ceiling Structures/Linings/S31					Limited Samples Taken
<i>Vermiculite Ceilings may contain asbestos. Asbestos testing MUST be conducted prior to any disturbance works</i>						
<b>B00E - R0023 - Seminar/Study (13.25 m2)</b>						
No Asbestos						
<b>B00E - R0024 - Seminar/Study (13.14 m2)</b>						
No Asbestos						
<b>B00E - R0025 - Staff Study (13.43 m2)</b>						
No Asbestos						
<b>B00E - R0027 - Audio Visual Workroom (26.84 m2)</b>						
No Asbestos						
<b>B00E - R0028 - Librarian (10.99 m2)</b>						
No Asbestos						
<b>B00E - R0030 - Toilet - Lobby (0.82 m2)</b>						
No Asbestos						
<b>B00E - R0031 - Plant (0.85 m2)</b>						
No Asbestos						
<b>B00E - R0032 - General Storeroom (8.35 m2)</b>						
No Asbestos						
<b>B00E - R0033 - External Stairs (3.37 m2)</b>						
No Asbestos						
<b>B00E - R0034 - Library Administration (29.93 m2)</b>						
No Asbestos						
<b>B00E - R0035 - Tea Room (5.96 m2)</b>						
No Asbestos						
<b>B00E - R0036 - Other-Vacant (3.04 m2)</b>						
No Asbestos						
<b>B00E - R0037 - External Stairs (2.96 m2)</b>						
No Asbestos						
<b>B00E - R0038 - External Stairs (3.29 m2)</b>						
No Asbestos						
<b>B00E - R0039 - Garden Store Room (2.72 m2)</b>						
No Asbestos						
<b>B00E - R0040 - External Movement (180.66 m2)</b>						
Ceiling Structures/Linings	Flat AC Sheeting					
	8401/B00E/R0040/Ceiling Structures/Linings/S16					No Asbestos Detected
Upper infill panel	Flat AC Sheeting					
	8401/B00E/R0040/Upper infill panel/S20					No Asbestos Detected
<b>B00E - R0041 - External Movement (2 m2)</b>						
No Asbestos						
<b>B00E - R1001 - General Learning Space (53.82 m2)</b>						
Ceiling Structures/Linings	Vermiculite					
	8401/B00E/R1023/Ceiling Structures/Linings/S32					Limited Samples Taken
<i>Vermiculite Ceilings may contain asbestos. Asbestos testing MUST be conducted prior to any disturbance works</i>						
Floor Coverings Res/Textile	Adhesive					
	8401/B00E/R1029/Floor Coverings Res/Textile/S19					No Asbestos Detected
Floor Coverings Res/Textile	Vinyl Tiles (Under Floor Covering/Carpet)	53.8m2	Throughout	Good Condition (1)	Low (1)	Low Priority (2-3)
	8401/B00E/R1029/Floor Coverings Res/Textile/S18					Chrysotile (white asbestos)

Product	Material Description	Extent	Location Reference	Material Condition	Risk Status	Control Priority
Sample No					Test Result	
<b>B00E - R1002 - General Learning Space (71.66 m2)</b>						
Ceiling Structures/Linings	Vermiculite					
	8401/B00E/R1023/Ceiling Structures/Linings/S32					Limited Samples Taken
<i>Vermiculite Ceilings may contain asbestos. Asbestos testing MUST be conducted prior to any disturbance works</i>						
<b>B00E - R1003 - Resources Store (7.09 m2)</b>						
Ceiling Structures/Linings	Vermiculite					
	8401/B00E/R1023/Ceiling Structures/Linings/S32					Limited Samples Taken
<i>Vermiculite Ceilings may contain asbestos. Asbestos testing MUST be conducted prior to any disturbance works</i>						
<b>B00E - R1004 - Resources Store (6.13 m2)</b>						
Ceiling Structures/Linings	Vermiculite					
	8401/B00E/R1023/Ceiling Structures/Linings/S32					Limited Samples Taken
<i>Vermiculite Ceilings may contain asbestos. Asbestos testing MUST be conducted prior to any disturbance works</i>						
<b>B00E - R1006 - Staff Study (5.01 m2)</b>						
Ceiling Structures/Linings	Vermiculite					
	8401/B00E/R1023/Ceiling Structures/Linings/S32					Limited Samples Taken
<i>Vermiculite Ceilings may contain asbestos. Asbestos testing MUST be conducted prior to any disturbance works</i>						
Floor Coverings Res/Textile	Adhesive					
	8401/B00E/R1029/Floor Coverings Res/Textile/S19					No Asbestos Detected
Floor Coverings Res/Textile	Vinyl Tiles (Under Floor Covering/Carpet)	5.01m2	Throughout	Good Condition (1)	Low (1)	Low Priority (2-3)
	8401/B00E/R1029/Floor Coverings Res/Textile/S18					Chrysotile (white asbestos)
<b>B00E - R1007 - General Storeroom (5.13 m2)</b>						
Ceiling Structures/Linings	Vermiculite					
	8401/B00E/R1023/Ceiling Structures/Linings/S32					Limited Samples Taken
<i>Vermiculite Ceilings may contain asbestos. Asbestos testing MUST be conducted prior to any disturbance works</i>						
<b>B00E - R1008 - Cleaning Supplies Store (5.29 m2)</b>						
Ceiling Structures/Linings	Vermiculite					
	8401/B00E/R1023/Ceiling Structures/Linings/S32					Limited Samples Taken
<i>Vermiculite Ceilings may contain asbestos. Asbestos testing MUST be conducted prior to any disturbance works</i>						
<b>B00E - R1009 - Staff - Toilet (2.62 m2)</b>						
Ceiling Structures/Linings	Vermiculite					
	8401/B00E/R1023/Ceiling Structures/Linings/S32					Limited Samples Taken
<i>Vermiculite Ceilings may contain asbestos. Asbestos testing MUST be conducted prior to any disturbance works</i>						
<b>B00E - R1010 - General Learning Space (58.64 m2)</b>						
Ceiling Structures/Linings	Vermiculite					
	8401/B00E/R1023/Ceiling Structures/Linings/S32					Limited Samples Taken
<i>Vermiculite Ceilings may contain asbestos. Asbestos testing MUST be conducted prior to any disturbance works</i>						
<b>B00E - R1011 - General Learning Space (52.21 m2)</b>						
Ceiling Structures/Linings	Vermiculite					
	8401/B00E/R1023/Ceiling Structures/Linings/S32					Limited Samples Taken
<i>Vermiculite Ceilings may contain asbestos. Asbestos testing MUST be conducted prior to any disturbance works</i>						
Floor Coverings Res/Textile	Adhesive					
	8401/B00E/R1029/Floor Coverings Res/Textile/S19					No Asbestos Detected
Floor Coverings Res/Textile	Vinyl Tiles (Under Floor Covering/Carpet)	52.19m2	Throughout	Good Condition (1)	Low (1)	Low Priority (2-3)
	8401/B00E/R1029/Floor Coverings Res/Textile/S18					Chrysotile (white asbestos)
<b>B00E - R1012 - General Learning Space (52.29 m2)</b>						
Ceiling Structures/Linings	Vermiculite					
	8401/B00E/R1023/Ceiling Structures/Linings/S32					Limited Samples Taken
<i>Vermiculite Ceilings may contain asbestos. Asbestos testing MUST be conducted prior to any disturbance works</i>						
Floor Coverings Res/Textile	Adhesive					
	8401/B00E/R1029/Floor Coverings Res/Textile/S19					No Asbestos Detected

Product	Material Description	Extent	Location Reference	Material Condition	Risk Status	Control Priority
Sample No				Test Result		
Floor Coverings Res/Textile	Vinyl Tiles (Under Floor Covering/Carpet)	52.27m2	Throughout	Good Condition (1)	Low (1)	Low Priority (2-3)
8401/B00E/R1029/Floor Coverings Res/Textile/S18				<b>Chrysotile (white asbestos)</b>		
<b>B00E - R1013 - General Storeroom (6.14 m2)</b>						
Ceiling Structures/Linings	Vermiculite					Limited Samples Taken
8401/B00E/R1023/Ceiling Structures/Linings/S32				<b>Vermiculite Ceilings may contain asbestos. Asbestos testing MUST be conducted prior to any disturbance works</b>		
Floor Coverings Res/Textile	Adhesive					No Asbestos Detected
8401/B00E/R1029/Floor Coverings Res/Textile/S19						
Floor Coverings Res/Textile	Vinyl Tiles (Under Floor Covering/Carpet)	6.14m2	Throughout	Good Condition (1)	Low (1)	Low Priority (2-3)
8401/B00E/R1029/Floor Coverings Res/Textile/S18				<b>Chrysotile (white asbestos)</b>		
<b>B00E - R1014 - Archive Store (6.12 m2)</b>						
Ceiling Structures/Linings	Vermiculite					Limited Samples Taken
8401/B00E/R1023/Ceiling Structures/Linings/S32				<b>Vermiculite Ceilings may contain asbestos. Asbestos testing MUST be conducted prior to any disturbance works</b>		
Floor Coverings Res/Textile	Adhesive					No Asbestos Detected
8401/B00E/R1029/Floor Coverings Res/Textile/S19						
Floor Coverings Res/Textile	Vinyl Tiles (Under Floor Covering/Carpet)	6.12m2	Throughout	Good Condition (1)	Low (1)	Low Priority (2-3)
8401/B00E/R1029/Floor Coverings Res/Textile/S18				<b>Chrysotile (white asbestos)</b>		
<b>B00E - R1015 - General Storeroom (6.23 m2)</b>						
Ceiling Structures/Linings	Vermiculite					Limited Samples Taken
8401/B00E/R1023/Ceiling Structures/Linings/S32				<b>Vermiculite Ceilings may contain asbestos. Asbestos testing MUST be conducted prior to any disturbance works</b>		
Floor Coverings Res/Textile	Adhesive					No Asbestos Detected
8401/B00E/R1029/Floor Coverings Res/Textile/S19						
Floor Coverings Res/Textile	Vinyl Tiles (Under Floor Covering/Carpet)	6.23m2	Throughout	Good Condition (1)	Low (1)	Low Priority (2-3)
8401/B00E/R1029/Floor Coverings Res/Textile/S18				<b>Chrysotile (white asbestos)</b>		
<b>B00E - R1016 - Resources Store (6.23 m2)</b>						
Ceiling Structures/Linings	Vermiculite					Limited Samples Taken
8401/B00E/R1023/Ceiling Structures/Linings/S32				<b>Vermiculite Ceilings may contain asbestos. Asbestos testing MUST be conducted prior to any disturbance works</b>		
Floor Coverings Res/Textile	Adhesive					No Asbestos Detected
8401/B00E/R1029/Floor Coverings Res/Textile/S19						
Floor Coverings Res/Textile	Vinyl Tiles (Under Floor Covering/Carpet)	6.23m2	Throughout	Good Condition (1)	Low (1)	Low Priority (2-3)
8401/B00E/R1029/Floor Coverings Res/Textile/S18				<b>Chrysotile (white asbestos)</b>		
<b>B00E - R1018 - General Learning Space (59.23 m2)</b>						
Ceiling Structures/Linings	Vermiculite					Limited Samples Taken
8401/B00E/R1023/Ceiling Structures/Linings/S32				<b>Vermiculite Ceilings may contain asbestos. Asbestos testing MUST be conducted prior to any disturbance works</b>		
Floor Coverings Res/Textile	Adhesive					No Asbestos Detected
8401/B00E/R1029/Floor Coverings Res/Textile/S19						
Floor Coverings Res/Textile	Vinyl Tiles (Under Floor Covering/Carpet)	59.21m2	Throughout	Good Condition (1)	Low (1)	Low Priority (2-3)
8401/B00E/R1029/Floor Coverings Res/Textile/S18				<b>Chrysotile (white asbestos)</b>		
<b>B00E - R1019 - General Learning Space (53.75 m2)</b>						
Ceiling Structures/Linings	Vermiculite					Limited Samples Taken
8401/B00E/R1023/Ceiling Structures/Linings/S32				<b>Vermiculite Ceilings may contain asbestos. Asbestos testing MUST be conducted prior to any disturbance works</b>		

Product	Material Description	Extent	Location Reference	Material Condition	Risk Status	Control Priority
Sample No					Test Result	
Floor Coverings Res/Textile	Adhesive					
	8401/B00E/R1029/Floor Coverings Res/Textile/S19					<b>No Asbestos Detected</b>
Floor Coverings Res/Textile	Vinyl Tiles (Under Floor Covering/Carpet)	53.73m2	Throughout	Good Condition (1)	Low (1)	Low Priority (2-3)
	8401/B00E/R1029/Floor Coverings Res/Textile/S18					<b>Chrysotile (white asbestos)</b>
<b>B00E - R1020 - Staff Study (20.98 m2)</b>						
Ceiling Structures/Linings	Vermiculite					
	8401/B00E/R1023/Ceiling Structures/Linings/S32					<b>Limited Samples Taken</b>
<i>Vermiculite Ceilings may contain asbestos. Asbestos testing MUST be conducted prior to any disturbance works</i>						
<b>B00E - R1022 - General Learning Space (59.01 m2)</b>						
Ceiling Structures/Linings	Vermiculite					
	8401/B00E/R1023/Ceiling Structures/Linings/S32					<b>Limited Samples Taken</b>
<i>Vermiculite Ceilings may contain asbestos. Asbestos testing MUST be conducted prior to any disturbance works</i>						
Floor Coverings Res/Textile	Adhesive					
	8401/B00E/R1029/Floor Coverings Res/Textile/S19					<b>No Asbestos Detected</b>
Floor Coverings Res/Textile	Vinyl Tiles (Under Floor Covering/Carpet)	58.99m2	Throughout	Good Condition (1)	Low (1)	Low Priority (2-3)
	8401/B00E/R1029/Floor Coverings Res/Textile/S18					<b>Chrysotile (white asbestos)</b>
<b>B00E - R1023 - General Learning Space (52.65 m2)</b>						
Ceiling Structures/Linings	Vermiculite					
	8401/B00E/R1023/Ceiling Structures/Linings/S32					<b>Limited Samples Taken</b>
<i>Vermiculite Ceilings may contain asbestos. Asbestos testing MUST be conducted prior to any disturbance works</i>						
Floor Coverings Res/Textile	Vinyl Tiles	54m2	Throughout	Good Condition (1)	Low (1)	Low Priority (2-3)
	8401/B00D/R0009/Floor Coverings Res/Textile/S5					<b>Chrysotile (white asbestos)</b>
Floor Coverings Res/Textile	Adhesive					
	8401/B00E/R1029/Floor Coverings Res/Textile/S19					<b>No Asbestos Detected</b>
Floor Coverings Res/Textile	Vinyl Tiles (Under Floor Covering/Carpet)	52.63m2	Throughout	Good Condition (1)	Low (1)	Low Priority (2-3)
	8401/B00E/R1029/Floor Coverings Res/Textile/S18					<b>Chrysotile (white asbestos)</b>
Window Sills	Dust Samples					
	8401/B00E/R1023/Window Sills/S40					<b>No Asbestos Detected</b>
Floor Coverings Res/Textile	Dust Samples					
	8401/B00E/R1023/Floor Coverings Res/Textile/S41					<b>No Asbestos Detected</b>
<b>B00E - R1024 - General Learning Space (53.6 m2)</b>						
Ceiling Structures/Linings	Vermiculite					
	8401/B00E/R1023/Ceiling Structures/Linings/S32					<b>Limited Samples Taken</b>
<i>Vermiculite Ceilings may contain asbestos. Asbestos testing MUST be conducted prior to any disturbance works</i>						
Floor Coverings Res/Textile	Adhesive					
	8401/B00E/R1029/Floor Coverings Res/Textile/S19					<b>No Asbestos Detected</b>
Floor Coverings Res/Textile	Vinyl Tiles (Under Floor Covering/Carpet)	53.58m2	Throughout	Good Condition (1)	Low (1)	Low Priority (2-3)
	8401/B00E/R1029/Floor Coverings Res/Textile/S18					<b>Chrysotile (white asbestos)</b>
<b>B00E - R1026 - Toilet - Lobby (0.83 m2)</b>						
No Asbestos						
<b>B00E - R1027 - Distribution Board Cupboard (0.84 m2)</b>						
No Asbestos						
<b>B00E - R1028 - General Learning Space (52.21 m2)</b>						
Ceiling Structures/Linings	Vermiculite					
	8401/B00E/R1023/Ceiling Structures/Linings/S32					<b>Limited Samples Taken</b>
<i>Vermiculite Ceilings may contain asbestos. Asbestos testing MUST be conducted prior to any disturbance works</i>						

Product	Material Description	Extent	Location Reference	Material Condition	Risk Status	Control Priority
Sample No					Test Result	
<b>B00E - R1029 - Performance Workshop (25.96 m2)</b>						
Ceiling Structures/Linings	Vermiculite 8401/B00E/R1023/Ceiling Structures/Linings/S32					Limited Samples Taken <i>Vermiculite Ceilings may contain asbestos. Asbestos testing MUST be conducted prior to any disturbance works</i>
Floor Coverings Res/Textile	Vinyl Tiles (Under Floor Covering/Carpet) 8401/B00E/R1029/Floor Coverings Res/Textile/S18	25.95m2	Throughout	Good Condition (1)	Low (1)	Low Priority (2-3) <b>Chrysotile (white asbestos)</b>
Floor Coverings Res/Textile	Adhesive 8401/B00E/R1029/Floor Coverings Res/Textile/S19					No Asbestos Detected
<b>B00E - R1030 - Staff Study (36.22 m2)</b>						
Ceiling Structures/Linings	Vermiculite 8401/B00E/R1023/Ceiling Structures/Linings/S32					Limited Samples Taken <i>Vermiculite Ceilings may contain asbestos. Asbestos testing MUST be conducted prior to any disturbance works</i>
Floor Coverings Res/Textile	Adhesive 8401/B00E/R1029/Floor Coverings Res/Textile/S19					No Asbestos Detected
Floor Coverings Res/Textile	Vinyl Tiles (Under Floor Covering/Carpet) 8401/B00E/R1029/Floor Coverings Res/Textile/S18	36.21m2	Throughout	Good Condition (1)	Low (1)	Low Priority (2-3) <b>Chrysotile (white asbestos)</b>
<b>B00E - R1031 - Tea Room (2.28 m2)</b>						
Ceiling Structures/Linings	Vermiculite 8401/B00E/R1023/Ceiling Structures/Linings/S32					Limited Samples Taken <i>Vermiculite Ceilings may contain asbestos. Asbestos testing MUST be conducted prior to any disturbance works</i>
<b>B00E - R1032 - Distribution Board Cupboard (0.87 m2)</b> <span style="float: right;">Note: No inspection of live electrical installation.</span>						
No Asbestos						
<b>B00E - R1033 - External Stairs (4.75 m2)</b>						
No Asbestos						
<b>B00E - R1034 - External Stairs (4.69 m2)</b>						
No Asbestos						
<b>B00E - R1035 - External Movement (2.29 m2)</b>						
No Asbestos						
<b>B00E - R1036 - External Stairs (4.88 m2)</b>						
No Asbestos						
<b>B00E - R1037 - External Movement (216.54 m2)</b>						
Ceiling Structures/Linings	Vermiculite 8401/B00E/R1023/Ceiling Structures/Linings/S32					Limited Samples Taken <i>Vermiculite Ceilings may contain asbestos. Asbestos testing MUST be conducted prior to any disturbance works</i>
<b>B00E - R1038 - Cleaning Store - Distributed (3.49 m2)</b>						
No Asbestos						

2017



Product	Material Description	Extent	Location Reference	Material Condition	Risk Status	Control Priority
Sample No					Test Result	

**B00F - Building Services - 1965 - Brick/Block (Brick/Block)**

**Exterior**

Underfloor Voids No Asbestos Found

Ceiling Voids No Asbestos Found

**Interior**

**B00F - R0002 - Movement (1.01 m2)**

No Asbestos

**B00F - R0003 - Main Switchroom (7.99 m2)**

No Asbestos

**B00F - R0004 - Stairs (3.78 m2)**

No Asbestos

**B00F - R9001 - Plant (10 m2)**

No Asbestos

**B00F - R9002 - Stairs (3.78 m2)**

No Asbestos

2017

Product	Material Description	Extent	Location Reference	Material Condition	Risk Status	Control Priority
Sample No					Test Result	

**B00G - Multi Purpose Facilities - 1985 - Brick/Block (Brick/Block)**

**Exterior**

Awnings	Flat AC Sheeting 8401/B00G/Awnings/S12					No Asbestos Detected
In-fill-panel	Flat AC Sheeting 8401/B00G/In-fill-panel/S3					No Asbestos Detected
Underfloor Voids - Slab on Ground	Non Accessible Area - Area inaccessible					
Ceiling Voids	No Asbestos Found					

**Interior**

**B00G - R0002 - Sport Equipment Store (29.5 m2)**

No Asbestos

**B00G - R0007 - Staff Kitchen (12 m2)**

No Asbestos

**B00G - R0008 - Cleaning Store - Distributed (9.8 m2)**

No Asbestos

**B00G - R0009 - General Storeroom (7.73 m2)**

No Asbestos

**B00G - R0010 - Distribution Board Cupboard (0.52 m2)**

Note: No inspection of live electrical installation.

No Asbestos

**B00G - R0011 - Gymnasium (442.29 m2)**

No Asbestos

**B00G - R0012 - Toilet - Lobby (3.05 m2)**

No Asbestos

**B00G - R0013 - Toilets-Boys (17.78 m2)**

No Asbestos

**B00G - R0014 - Toilet - Lobby (3.03 m2)**

No Asbestos

**B00G - R0015 - Toilets-Girls (18.75 m2)**

No Asbestos

**B00G - R0016 - Plant (0.48 m2)**

No Asbestos

**B00G - R0017 - External Movement (12.56 m2)**

No Asbestos

**B00G - R0018 - External Movement (10.82 m2)**

No Asbestos

**B00G - R0019 - Stairs (2.59 m2)**

No Asbestos

**B00G - R0020 - Stairs (2.47 m2)**

No Asbestos

**B00G - R0021 - Stage (86.05 m2)**

No Asbestos

**B00G - R0022 - Movement (18.16 m2)**

No Asbestos

**B00G - R0023 - Stairs (1.87 m2)**

No Asbestos

**B00G - R0024 - Stairs (1.92 m2)**

No Asbestos

Product	Material Description	Extent	Location Reference	Material Condition	Risk Status	Control Priority
Sample No					Test Result	
<b>B00G - R0025 - External Movement (10.82 m2)</b>						
No Asbestos						
<b>B00G - R1001 - Control Room (5.95 m2)</b>						
No Asbestos						
<b>B00G - R1002 - Performing Arts Changeroom (45.03 m2)</b>						
No Asbestos						
<b>B00G - R1003 - Cleaning Store - Distributed (6.07 m2)</b>						
No Asbestos						
<b>B00G - R1004 - Performing Arts Changeroom (45.14 m2)</b>						
No Asbestos						
<b>B00G - R1005 - Stairs (2.79 m2)</b>						
No Asbestos						
<b>B00G - R1006 - Stairs (2.87 m2)</b>						
No Asbestos						
<b>B00G - R1007 - Movement (2.07 m2)</b>						
No Asbestos						
<b>B00G - R1008 - Movement (1.99 m2)</b>						
No Asbestos						

2017

Product	Material Description	Extent	Location Reference	Material Condition	Risk Status	Control Priority
Sample No					Test Result	

**B00H - Building Services - 2009 - Brick/Block (Brick/Block)**

**Exterior**

Ceiling Voids - Flat Roof	Non Accessible Area - Area inaccessible
Underfloor Voids - Slab on Ground	Non Accessible Area - Area inaccessible

**Interior**

**B00H - R0001 - Plant (10 m2)**

No Asbestos

2017

Product	Material Description	Extent	Location Reference	Material Condition	Risk Status	Control Priority
Sample No					Test Result	

**B00I - Library - 2012 - Fibre Cement Clad (Fibre Cement Clad)**

**Exterior**

Ceiling Voids - Flat Roof	No Asbestos Found
Underfloor Voids - Slab on Ground	Non Accessible Area - Area inaccessible

**Interior**

**B00I - R0001 - Main Area (92.01 m2)**

No Asbestos

**B00I - R0002 - General Storeroom (9.82 m2)**

No Asbestos

**B00I - R0003 - Communication Space (8.45 m2)**

No Asbestos

**B00I - R0004 - Librarian (20.42 m2)**

No Asbestos

**B00I - R0005 - External Movement (31.55 m2)**

No Asbestos

2017

Product	Material Description	Extent	Location Reference	Material Condition	Risk Status	Control Priority
Sample No					Test Result	

## Demountables

Demountable details as per the AMS records as of 15 Feb 2017.

**NS 110 - D10471 - Learning Unit - Single Secondary/Secure : Placement Date - 21/02/2007**

### Exterior

No Asbestos Found.

### Interior

#### R1 - General Learning Space

No Asbestos Found.

#### R2 - Entry

No Asbestos Found.

#### R3 - Secure Storeroom

No Asbestos Found.

**OS 601 - D11530 - Learning Unit - Standard/Withdrawal : Placement Date - 3/02/2006**

### Exterior

Eave Lining	Flat AC Sheet	Assumed Asbestos	11.52 m2
Landing	Compressed AC Sheet	Assumed Asbestos	1.2 m2
Step Treads	Compressed AC Sheet	Assumed Asbestos	1.08 m2

### Interior

#### R1 - Entry

End wall panel	Flat AC Sheet	Assumed Asbestos	18 m2
Ceiling	Flat AC Sheet	Assumed Asbestos	8 m2

#### R2 - General Learning Space

End wall panel	Flat AC Sheet	Assumed Asbestos	18 m2
Ceiling	Flat AC Sheet	Assumed Asbestos	55 m2

#### R3 - Store

Ceiling	Flat AC Sheet	Assumed Asbestos	10 m2
---------	---------------	------------------	-------

**OS 601 - D12464 - Learning Unit - Standard/Withdrawal : Placement Date - 13/01/2006**

### Exterior

Eave Lining	Flat AC Sheet	Assumed Asbestos	11.52 m2
Landing	Compressed AC Sheet	Assumed Asbestos	1.2 m2
Step Treads	Compressed AC Sheet	Assumed Asbestos	1.08 m2

### Interior

#### R1 - Entry

End wall panel	Flat AC Sheet	Assumed Asbestos	18 m2
Ceiling	Flat AC Sheet	Assumed Asbestos	8 m2

#### R2 - General Learning Space

End wall panel	Flat AC Sheet	Assumed Asbestos	18 m2
Ceiling	Flat AC Sheet	Assumed Asbestos	55 m2

#### R3 - Store

Ceiling	Flat AC Sheet	Assumed Asbestos	10 m2
---------	---------------	------------------	-------

**OS 601 - D13652 - Learning Unit - Standard/Withdrawal : Placement Date - 22/02/2007**

### Exterior

Step Treads	Compressed AC Sheet	Assumed Asbestos	1.08 m2
Landing	Compressed AC Sheet	Assumed Asbestos	1.2 m2
Eave Lining	Flat AC Sheet	Assumed Asbestos	11.52 m2



Product	Material Description	Extent	Location Reference	Material Condition	Risk Status	Control Priority
Sample No					Test Result	

**Interior**

**R1 - Entry**

End wall panel	Flat AC Sheet	Assumed Asbestos				18 m2
Ceiling	Flat AC Sheet	Assumed Asbestos				8 m2

**R2 - General Learning Space**

End wall panel	Flat AC Sheet	Assumed Asbestos				18 m2
Ceiling	Flat AC Sheet	Assumed Asbestos				55 m2

**R3 - Store**

Ceiling	Flat AC Sheet	Assumed Asbestos				10 m2
---------	---------------	------------------	--	--	--	-------

**OS 501 - D14119 - Admin Staff/Principal/Deputy/Dup/Clinic : Placement Date - 4/01/2012**

Note: This refurbished demountable may have asbestos present in remnant mastic in window frames.

**Exterior**

No Asbestos Found.

**Interior**

**R1 - Entry**

No Asbestos Found.

**R10 - Staff Toilet**

No Asbestos Found.

**R11 - Cleaning Supplies**

No Asbestos Found.

**R12 - Handicap toilet**

No Asbestos Found.

**R13 - Clerk**

No Asbestos Found.

**R2 - Clinic-Waiting**

No Asbestos Found.

**R3 - Security Store**

No Asbestos Found.

**R4 - Duplicating Wookroom**

No Asbestos Found.

**R5 - Clerical Office**

No Asbestos Found.

**R6 - Staff Room**

No Asbestos Found.

**R7 - Deputy Principal**

No Asbestos Found.

**R8 - Principal**

No Asbestos Found.

**R9 - Staff Toilet**

No Asbestos Found.

**OS 601 - D14414 - Learning Unit - Standard/Withdrawal : Placement Date - 9/01/2006**

**Exterior**

Eave Lining	Flat AC Sheet	Assumed Asbestos				11.52 m2
Landing	Compressed AC Sheet	Assumed Asbestos				1.2 m2
Step Treads	Compressed AC Sheet	Assumed Asbestos				1.08 m2

Product	Material Description	Extent	Location Reference	Material Condition	Risk Status	Control Priority
Sample No					Test Result	
<b>Interior</b>						
<b>R1 - Entry</b>						
End wall panel	Flat AC Sheet	Assumed Asbestos				18 m2
Ceiling	Flat AC Sheet	Assumed Asbestos				8 m2
<b>R2 - General Learning Space</b>						
End wall panel	Flat AC Sheet	Assumed Asbestos				18 m2
Ceiling	Flat AC Sheet	Assumed Asbestos				55 m2
<b>R3 - Store</b>						
Ceiling	Flat AC Sheet	Assumed Asbestos				10 m2
<b>OS 600 - D15942 - Learning Unit - Small : Placement Date - 8/02/2007</b>						
<b>Exterior</b>						
Step Treads	Compressed AC Sheet	Assumed Asbestos				1.08 m2
Eave Lining	Flat AC Sheet	Assumed Asbestos				8.64 m2
Landing	Compressed AC Sheet	Assumed Asbestos				1.2 m2
<b>Interior</b>						
<b>R1 - General Learning Space</b>						
End wall panel	Flat AC Sheet	Assumed Asbestos				50 m2
Ceiling	Flat AC Sheet	Assumed Asbestos				55 m2

2017

Product	Material Description	Extent	Location Reference	Material Condition	Risk Status	Control Priority
Sample No					Test Result	

*Listing of Electronic Attachments as of 22/03/2017*

**There are no asbestos related file attachment(s) for this school.**

2017