

Asbestos Register

(Hazardous Materials and Risk Assessment)

School : Lansvale Public School (5220)
Region : South Western Sydney
State Electorate : Cabramatta
Local Government Area : Fairfield

Initial Survey : Noel Arnold & Associates : 12 - Mar - 2008
Reviewed By : Parsons Brinckerhoff : 07 - Dec - 2016

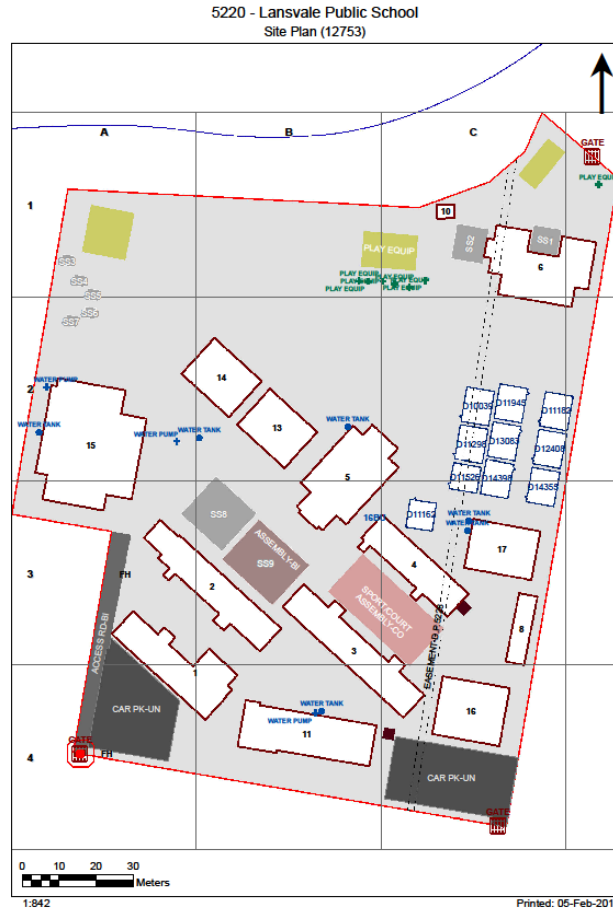

2017

Product	Material Description	Extent	Location Reference	Material Condition	Risk Status	Control Priority
Sample No					Test Result	

B001 - General Learning - 1950 - Brick/Block (Brick/Block)**Exterior**

Eaves Linings	Flat AC Sheeting	60m2	North, South	Good Condition (1)	Low (1)	Low Priority (2-3)
	5220/B002/Eaves Linings/S14					Chrysotile (white asbestos)
Gable Verge Lining	Flat AC Sheeting	20m2	East, West	Good Condition (1)	Low (1)	Low Priority (2-3)
	5220/B002/Gable Verge Lining/S18					Chrysotile (white asbestos) , Amosite (brown asbestos)
Ceiling Void	No Asbestos Found					
Underfloor Voids	No Asbestos Found					

Interior**B001 - R0001 - Movement**

Ceiling Structures/Linings	Flat AC Sheeting					No Asbestos Detected
	5220/B001/R0001/Ceiling Structures/Linings/S1					
In-fill-panel	Flat AC Sheeting	1m	South, Upper portion	Good Condition (1)	Low (1)	Low Priority (2-3)
	5220/B001/R0001/In-fill-panel/S2					Chrysotile (white asbestos) , Amosite (brown asbestos)

B001 - R0002 - Movement

Electrical Mounting Board	Resinous Board	1Unit	South, West	Good Condition (1)	Low (1)	Low Priority (2-3)
	5220/B001/R0002/Electrical Mounting Board/S3					Chrysotile (white asbestos)

B001 - R0003 - Toilets - Boys/Girls

No Asbestos

B001 - R0004 - Personal Effects Storage

No Asbestos

B001 - R0005 - Home Base

No Asbestos

B001 - R0006 - Home Base

No Asbestos

B001 - R0007 - Movement

No Asbestos

B001 - R0008 - Movement

No Asbestos

B001 - R0009 - Plant

No Asbestos

B001 - R0010 - Staff Room Annexe

No Asbestos

B001 - R0011 - General Storeroom

No Asbestos

B001 - R0012 - Personal Effects Storage

No Asbestos

B001 - R0013 - Home Base

No Asbestos

B001 - R0014 - Home Base Store

No Asbestos

B001 - R0015 - Movement

Ceiling Structures/Linings	Flat AC Sheeting					No Asbestos Detected
	5220/B001/R0001/Ceiling Structures/Linings/S1					
In-fill-panel	Flat AC Sheeting	1m	South, Upper portion	Good Condition (1)	Low (1)	Low Priority (2-3)
	5220/B001/R0001/In-fill-panel/S2					Chrysotile (white asbestos) , Amosite (brown asbestos)

Product	Material Description	Extent	Location Reference	Material Condition	Risk Status	Control Priority
Sample No					Test Result	

B001 - R0016 - General Storeroom

No Asbestos

2017

Product	Material Description	Extent	Location Reference	Material Condition	Risk Status	Control Priority
Sample No					Test Result	

B002 - General Learning - 1950 - Brick/Block (Brick/Block)

Exterior

Eaves Linings	Flat AC Sheeting	60m2	North, South	Good Condition (1)	Low (1)	Low Priority (2-3)
	5220/B002/Eaves Linings/S14					Chrysotile (white asbestos)
Gable Verge Lining	Flat AC Sheeting	20m2	East, West	Good Condition (1)	Low (1)	Low Priority (2-3)
	5220/B002/Gable Verge Lining/S18					Chrysotile (white asbestos) , Amosite (brown asbestos)
Ceiling Void	No Asbestos Found					
Underfloor Voids	No Asbestos Found					

Interior

B002 - R0001 - Home Base

No Asbestos

B002 - R0002 - Home Base Store

No Asbestos

B002 - R0003 - Toilets - Boys/Girls

No Asbestos

B002 - R0004 - Special Programs Room

No Asbestos

B002 - R0005 - Personal Effects Storage

No Asbestos

B002 - R0006 - Movement

No Asbestos

B002 - R0007 - Movement

In-fill-panel	Flat AC Sheeting	1m	North	Good Condition (1)	Low (1)	Low Priority (2-3)
	5220/B002/R0007/In-fill-panel/S4					Chrysotile (white asbestos) , Amosite (brown asbestos)
Ceiling Structures/Linings	Flat AC Sheeting					No Asbestos Detected
	5220/B002/R0007/Ceiling Structures/Linings/S5					

B002 - R0008 - Home Base

No Asbestos

B002 - R0009 - Home Base

No Asbestos

B002 - R0010 - Personal Effects Storage

No Asbestos

B002 - R0011 - General Storeroom

No Asbestos

B002 - R0012 - Movement

In-fill-panel	Flat AC Sheeting	1m	North	Good Condition (1)	Low (1)	Low Priority (2-3)
	5220/B002/R0007/In-fill-panel/S4					Chrysotile (white asbestos) , Amosite (brown asbestos)
Ceiling Structures/Linings	Flat AC Sheeting					No Asbestos Detected
	5220/B002/R0007/Ceiling Structures/Linings/S5					

B002 - R0013 - Movement

No Asbestos

B002 - R0014 - Staff Room Annexe

No Asbestos

B002 - R0015 - Cleaning Distributed Store

No Asbestos

B002 - R0016 - Movement

Product	Material Description	Extent	Location Reference	Material Condition	Risk Status	Control Priority
Sample No					Test Result	

No Asbestos

B002 - R0017 - Movement

Ceiling Structures/Linings	Flat AC Sheeting	14m2	Throughout	Good Condition (1)	Low (1)	Low Priority (2-3)
----------------------------	------------------	------	------------	--------------------	---------	--------------------

5220/B002/R0017/Ceiling Structures/Linings/S6

Chrysotile (white asbestos)

B002 - R0018 - Canteen

No Asbestos

B002 - R0019 - Canteen Office/Store

No Asbestos

B002 - R0020 - Canteen Office/Store

No Asbestos

2017

Product	Material Description	Extent	Location Reference	Material Condition	Risk Status	Control Priority
Sample No					Test Result	

B003 - General Learning - 1950 - Brick/Block (Brick/Block)**Exterior**

Eaves Linings	Flat AC Sheeting	10m2	North, South	Good Condition (1)	Low (1)	Low Priority (2-3)
	5220/B004/Eaves Linings/S15				Chrysotile (white asbestos) , Amosite (brown asbestos) , Crocidolite (blue asbestos)	
Gable Verge Lining	Flat AC Sheeting	20m2	East, West	Good Condition (1)	Low (1)	Low Priority (2-3)
	5220/B004/Gable Verge Lining/S19				Chrysotile (white asbestos) , Amosite (brown asbestos)	

Interior**B003 - R0001 - Home Base**

Floor Coverings Res/Textile	Vinyl Tiles					
	5220/B003/R0003/Floor Coverings Res/Textile/S7				No Asbestos Detected	

B003 - R0002 - Home Base Store

Floor Coverings Res/Textile	Vinyl Tiles					
	5220/B003/R0003/Floor Coverings Res/Textile/S7				No Asbestos Detected	

B003 - R0003 - Personal Effects Storage

Floor Coverings Res/Textile	Vinyl Tiles					
	5220/B003/R0003/Floor Coverings Res/Textile/S7				No Asbestos Detected	

Manhole	Flat AC Sheeting	1m2	Middle portion	Minimal Damage (2)	Low (1)	Low Priority (2-3)
	5220/B003/R0003/Manhole/S20				Chrysotile (white asbestos) , Amosite (brown asbestos) , Crocidolite (blue asbestos)	

B003 - R0004 - Cleaning Distributed Store

No Asbestos

B003 - R0005 - General Storeroom

No Asbestos

B003 - R0006 - Movement

Floor Coverings Res/Textile	Vinyl Tiles					
	5220/B003/R0003/Floor Coverings Res/Textile/S7				No Asbestos Detected	

B003 - R0007 - Staff Room Annexe

No Asbestos

B003 - R0008 - General Storeroom

No Asbestos

B003 - R0009 - Personal Effects Storage

Floor Coverings Res/Textile	Vinyl Tiles					
	5220/B003/R0003/Floor Coverings Res/Textile/S7				No Asbestos Detected	

B003 - R0010 - Movement

Floor Coverings Res/Textile	Vinyl Tiles					
	5220/B003/R0003/Floor Coverings Res/Textile/S7				No Asbestos Detected	

B003 - R0011 - Movement

In-fill-panel	Flat AC Sheeting	1m	South, Upper portion	Good Condition (1)	Low (1)	Low Priority (2-3)
	5220/B002/R0007/In-fill-panel/S4				Chrysotile (white asbestos) , Amosite (brown asbestos)	

Ceiling Structures/Linings	Flat AC Sheeting					
	5220/B002/R0007/Ceiling Structures/Linings/S5				No Asbestos Detected	

B003 - R0012 - Home Base

No Asbestos

B003 - R0013 - Home Base Store

Product	Material Description	Extent	Location Reference	Material Condition	Risk Status	Control Priority
Sample No					Test Result	
No Asbestos						
B003 - R0014 - Home Base						
No Asbestos						
B003 - R0015 - Home Base Store						
No Asbestos						
B003 - R0016 - Personal Effects Storage						
Floor Coverings Res/Textile	Vinyl Tiles					
5220/B003/R0003/Floor Coverings Res/Textile/S7					No Asbestos Detected	
B003 - R0017 - Special Programs Room						
No Asbestos						
B003 - R0018 - Toilets - Boys/Girls						
No Asbestos						
B003 - R0019 - Personal Effects Storage						
Floor Coverings Res/Textile	Vinyl Tiles					
5220/B003/R0003/Floor Coverings Res/Textile/S7					No Asbestos Detected	
B003 - R0020 - Movement						
In-fill-panel	Flat AC Sheeting	1m	South, Upper portion	Good Condition (1)	Low (1)	Low Priority (2-3)
5220/B002/R0007/In-fill-panel/S4				Chrysotile (white asbestos) , Amosite (brown asbestos)		
Ceiling Structures/Linings	Flat AC Sheeting					
5220/B002/R0007/Ceiling Structures/Linings/S5					No Asbestos Detected	
B003 - R0021 - Home Base Store						
Floor Coverings Res/Textile	Vinyl Tiles					
5220/B003/R0003/Floor Coverings Res/Textile/S7					No Asbestos Detected	
B003 - R0022 - Home Base						
No Asbestos						

2017

Product	Material Description	Extent	Location Reference	Material Condition	Risk Status	Control Priority
Sample No					Test Result	

B004 - General Learning - 1950 - Brick/Block (Brick/Block)**Exterior**

Eaves Linings	Flat AC Sheeting	60m2	North, South	Good Condition (1)	Low (1)	Low Priority (2-3)
	5220/B004/Eaves Linings/S15				Chrysotile (white asbestos) , Amosite (brown asbestos) , Crocidolite (blue asbestos)	
Gable Verge Lining	Flat AC Sheeting	20m2	East, West	Good Condition (1)	Low (1)	Low Priority (2-3)
	5220/B004/Gable Verge Lining/S19				Chrysotile (white asbestos) , Amosite (brown asbestos)	
Ceiling Void	No Asbestos Found					
Underfloor Voids	No Asbestos Found					

Interior**B004 - R0001 - Home Base**

In-fill-panel	Flat AC Sheeting	1m	West	Good Condition (1)	Low (1)	Low Priority (2-3)
	5220/B004/R0001/In-fill-panel/S8				Chrysotile (white asbestos)	

B004 - R0002 - Home Base Store

Floor Coverings Res/Textile	Vinyl Tiles					
	5220/B003/R0003/Floor Coverings Res/Textile/S7				No Asbestos Detected	

B004 - R0003 - Personal Effects Storage

Floor Coverings Res/Textile	Vinyl Tiles					
	5220/B003/R0003/Floor Coverings Res/Textile/S7				No Asbestos Detected	

B004 - R0004 - General Storeroom

Floor Coverings Res/Textile	Vinyl Tiles					
	5220/B003/R0003/Floor Coverings Res/Textile/S7				No Asbestos Detected	

B004 - R0005 - Personal Effects Storage

Floor Coverings Res/Textile	Vinyl Tiles					
	5220/B003/R0003/Floor Coverings Res/Textile/S7				No Asbestos Detected	

B004 - R0006 - Movement

Floor Coverings Res/Textile	Vinyl Tiles					
	5220/B003/R0003/Floor Coverings Res/Textile/S7				No Asbestos Detected	

B004 - R0007 - Movement

Ceiling Structures/Linings	Flat AC Sheeting					
	5220/B001/R0001/Ceiling Structures/Linings/S1				No Asbestos Detected	

In-fill-panel	Flat AC Sheeting	1m	North, Upper portion	Good Condition (1)	Low (1)	Low Priority (2-3)
	5220/B001/R0001/In-fill-panel/S2				Chrysotile (white asbestos) , Amosite (brown asbestos)	

B004 - R0008 - Home Base Store

No Asbestos

B004 - R0009 - Home Base

No Asbestos

B004 - R0010 - Home Base

No Asbestos

B004 - R0011 - Home Base Store

No Asbestos

B004 - R0012 - Personal Effects Storage

No Asbestos

B004 - R0013 - General Storeroom

No Asbestos

Product	Material Description	Extent	Location Reference	Material Condition	Risk Status	Control Priority
Sample No					Test Result	
B004 - R0014 - General Storeroom						
No Asbestos						
B004 - R0015 - Movement						
No Asbestos						
B004 - R0016 - Movement						
Ceiling Structures/Linings	Flat AC Sheeting 5220/B001/R0001/Ceiling Structures/Linings/S1				No Asbestos Detected	
In-fill-panel	Flat AC Sheeting 5220/B001/R0001/In-fill-panel/S2	1m	North, Upper portion	Good Condition (1)	Low (1)	Low Priority (2-3)
					Chrysotile (white asbestos) , Amosite (brown asbestos)	

2017

Product	Material Description	Extent	Location Reference	Material Condition	Risk Status	Control Priority
Sample No					Test Result	

B005 - Library - 1995 - Brick/Veneer (Brick/Veneer)

Exterior

Underfloor Voids - Slab on Ground	No Asbestos Found					
Eaves Linings	Flat AC Sheeting 5220/B005/Eaves Linings/S16					No Asbestos Detected
Ceiling Voids	No Asbestos Found					

Interior

B005 - R0001 - Cleaning Distributed Store

No Asbestos

B005 - R0002 - Security Store

Vinyl Tiles (Under Floor Covering/Carpet) No Asbestos Found

B005 - R0003 - Special Programs Room

Vinyl Tiles (Under Floor Covering/Carpet) No Asbestos Found

B005 - R0004 - Plant

No Asbestos

B005 - R0005 - Distribution Board

Note: No inspection of live electrical installation.

No Asbestos

B005 - R0006 - Movement

Ceiling Structures/Linings	Flat AC Sheeting 5220/B005/R0006/Ceiling Structures/Linings/S9					No Asbestos Detected
----------------------------	---	--	--	--	--	-----------------------------

B005 - R0007 - Reading Area

Vinyl Tiles (Under Floor Covering/Carpet) No Asbestos Found

B005 - R0008 - Security Store

Vinyl Tiles (Under Floor Covering/Carpet) No Asbestos Found

B005 - R0009 - Library Office/Workroom

Vinyl Tiles (Under Floor Covering/Carpet) No Asbestos Found

B005 - R0010 - Movement

Ceiling Structures/Linings	Flat AC Sheeting 5220/B005/R0006/Ceiling Structures/Linings/S9					No Asbestos Detected
----------------------------	---	--	--	--	--	-----------------------------

2017

Product	Material Description	Extent	Location Reference	Material Condition	Risk Status	Control Priority
Sample No					Test Result	

B006 - Pre-School Facilities - 1975 - Brick/Veneer (Brick/Veneer)**Exterior**

Underfloor Voids - Slab on Ground No Asbestos Found

Ceiling Void No Asbestos Found

Interior**B006 - R0001 - Staff Room Annexe**

No Asbestos

B006 - R0002 - Staff Toilet - Pre

No Asbestos

B006 - R0005 - Communal/Performance Store

Wall Linings Internal	Flat AC Sheeting	6m2	Throughout	Good Condition (1)	Low (1)	Low Priority (2-3)
5220/B006/R0007/Ceiling Structures/Linings/S11					Chrysotile (white asbestos)	

B006 - R0006 - Communal/Performance Store

Wall Linings Internal	Flat AC Sheeting	6m2	Throughout	Good Condition (1)	Low (1)	Low Priority (2-3)
5220/B006/R0007/Ceiling Structures/Linings/S11					Chrysotile (white asbestos)	

B006 - R0007 - Cleaning Distributed Store

Floor Coverings Res/Textile	Vinyl Tiles					
5220/B006/R0008/Floor Coverings Res/Textile/S10					No Asbestos Detected	

Wall Linings Internal	Flat AC Sheeting	6m2	Throughout	Good Condition (1)	Low (1)	Low Priority (2-3)
5220/B006/R0007/Ceiling Structures/Linings/S11					Chrysotile (white asbestos)	

B006 - R0008 - Movement

Floor Coverings Res/Textile	Vinyl Tiles					
5220/B006/R0008/Floor Coverings Res/Textile/S10					No Asbestos Detected	

B006 - R0009 - Entry Vestibule

No Asbestos

B006 - R0010 - Kitchen - Pre

No Asbestos

B006 - R0011 - Withdrawal - Pre

No Asbestos

B006 - R0012 - General Storeroom

Floor Coverings Res/Textile	Vinyl Tiles					
5220/B006/R0008/Floor Coverings Res/Textile/S10					No Asbestos Detected	

Wall Linings Internal	Flat AC Sheeting	20m2	Throughout	Good Condition (1)	Low (1)	Low Priority (2-3)
5220/B006/R0007/Ceiling Structures/Linings/S11					Chrysotile (white asbestos)	

B006 - R0013 - Home Base - Pre

No Asbestos

B006 - R0014 - Toilets - Boys/Girls - Pre

No Asbestos

B006 - R0015 - Movement

No Asbestos

B006 - R0016 - Movement

No Asbestos

B006 - R0017 - Movement

No Asbestos

B006 - R0018 - Withdrawal - Pre

No Asbestos

Product	Material Description	Extent	Location Reference	Material Condition	Risk Status	Control Priority
Sample No					Test Result	
B006 - R0019 - Withdrawal - Pre						
No Asbestos						
B006 - R0020 - General Storeroom						
Floor Coverings Res/Textile	Vinyl Tiles					
	5220/B006/R0008/Floor Coverings Res/Textile/S10					No Asbestos Detected
Wall Linings Internal	Flat AC Sheeting	20m2	Throughout	Good Condition (1)	Low (1)	Low Priority (2-3)
	5220/B006/R0007/Ceiling Structures/Linings/S11					Chrysotile (white asbestos)
B006 - R0021 - Home Base - Pre						
No Asbestos						
B006 - R0022 - Toilets - Boys/Girls - Pre						
No Asbestos						
B006 - R0023 - Movement						
No Asbestos						
B006 - R0024 - Movement						
No Asbestos						
B006 - R0026 - Laundry - Pre						
No Asbestos						
B006 - R0027 - Movement						
No Asbestos						
B006 - R0028 - Movement						
No Asbestos						
B006 - R0029 - Movement						
No Asbestos						
B006 - R0030 - External Movement						
No Asbestos						

2017

Product	Material Description	Extent	Location Reference	Material Condition	Risk Status	Control Priority
Sample No					Test Result	

B008 - Pupil Facilities - 1950 - Brick/Block (Brick/Block)

Exterior

Underfloor Voids - Slab on Ground	No Asbestos Found					
Eaves Linings	Flat AC Sheeting 5220/B008/Eaves Linings/S17					No Asbestos Detected
Ceiling Void	No Asbestos Found					

Interior

B008 - R0001 - Toilets - Girls

No Asbestos

B008 - R0002 - Toilets - Boys

No Asbestos

B008 - R0003 - Drinking Facilities

No Asbestos

B008 - R0004 - Drinking Facilities

No Asbestos

2017

Product	Material Description	Extent	Location Reference	Material Condition	Risk Status	Control Priority
Sample No					Test Result	

B010 - Pre-School Facilities - 2003 - Timber (Timber)

Exterior

Underfloor Voids - Slab on Ground	No Asbestos Found
Ceiling Voids	No Asbestos Found

Interior

B010 - R0001 - Movement

No Asbestos

B010 - R0002 - General Storeroom - Pre

No Asbestos

2017

Product	Material Description	Extent	Location Reference	Material Condition	Risk Status	Control Priority
Sample No					Test Result	

B011 - Administration/Staff Facilities - 2002 - Brick/Veneer (Brick/Veneer)

Exterior

Underfloor Voids - Slab on Ground	No Asbestos Found
Ceiling Voids	No Asbestos Found

Interior

B011 - R0001 - Staff Room Annexe

Vinyl Tiles (Under Floor Covering/Carpet)	No Asbestos Found
---	-------------------

B011 - R0002 - Staff Room

Vinyl Tiles (Under Floor Covering/Carpet)	No Asbestos Found
---	-------------------

B011 - R0003 - Staff Kitchen

No Asbestos

B011 - R0004 - Cleaning Distributed Store

No Asbestos

B011 - R0005 - Main Switch Board

No Asbestos

B011 - R0006 - Interview

Vinyl Tiles (Under Floor Covering/Carpet)	No Asbestos Found
---	-------------------

B011 - R0007 - Deputy Principal

Vinyl Tiles (Under Floor Covering/Carpet)	No Asbestos Found
---	-------------------

B011 - R0008 - Principal

Vinyl Tiles (Under Floor Covering/Carpet)	No Asbestos Found
---	-------------------

B011 - R0009 - Interview

Vinyl Tiles (Under Floor Covering/Carpet)	No Asbestos Found
---	-------------------

B011 - R0010 - Entry Vestibule

Vinyl Tiles (Under Floor Covering/Carpet)	No Asbestos Found
---	-------------------

B011 - R0011 - Movement

No Asbestos

B011 - R0012 - Clerical Office/Workroom

Vinyl Tiles (Under Floor Covering/Carpet)	No Asbestos Found
---	-------------------

B011 - R0013 - Sick Bay

No Asbestos

B011 - R0014 - Access Shower/Toilet

No Asbestos

B011 - R0015 - Security Store

No Asbestos

B011 - R0016 - Staff Toilet

No Asbestos

B011 - R0017 - Staff Toilet

No Asbestos

B011 - R0018 - Staff Toilet

No Asbestos

B011 - R0019 - Movement

Vinyl Tiles (Under Floor Covering/Carpet)	No Asbestos Found
---	-------------------

Product	Material Description	Extent	Location Reference	Material Condition	Risk Status	Control Priority
Sample No					Test Result	

B013 - General Learning - 2004 - Fibre Cement Clad (Fibre Cement Clad)**Exterior**

Ceiling Voids	No Asbestos Found
Underfloor Voids	No Asbestos Found

Interior**B013 - R0001 - Movement**

No Asbestos

B013 - R0002 - Practical Activities - 1hb

No Asbestos

B013 - R0003 - Home Base StoreVinyl Tiles (Under Floor
Covering/Carpet) No Asbestos Found**B013 - R0004 - Home Base**Vinyl Tiles (Under Floor
Covering/Carpet) No Asbestos Found**B013 - R0005 - Withdrawal Space - 2hb**Vinyl Tiles (Under Floor
Covering/Carpet) No Asbestos Found**B013 - R0006 - Home Base**Vinyl Tiles (Under Floor
Covering/Carpet) No Asbestos Found**B013 - R0007 - Home Base Store**Vinyl Tiles (Under Floor
Covering/Carpet) No Asbestos Found**B013 - R0008 - Practical Activities - 1hb**

No Asbestos

2017

Product	Material Description	Extent	Location Reference	Material Condition	Risk Status	Control Priority
Sample No					Test Result	

B014 - General Learning - 2004 - Fibre Cement Clad (Fibre Cement Clad)

Exterior

Ceiling Voids	No Asbestos Found
Underfloor Voids	No Asbestos Found

Interior

B014 - R0001 - Movement

No Asbestos

B014 - R0002 - Practical Activities - 1hb

No Asbestos

B014 - R0003 - Home Base Store

Vinyl Tiles (Under Floor Covering/Carpet) No Asbestos Found

B014 - R0004 - Home Base

Vinyl Tiles (Under Floor Covering/Carpet) No Asbestos Found

B014 - R0005 - Withdrawal Space - 2hb

Vinyl Tiles (Under Floor Covering/Carpet) No Asbestos Found

B014 - R0006 - Home Base

Vinyl Tiles (Under Floor Covering/Carpet) No Asbestos Found

B014 - R0007 - Home Base Store

Vinyl Tiles (Under Floor Covering/Carpet) No Asbestos Found

B014 - R0008 - Practical Activities - 1hb

No Asbestos

2017

Product	Material Description	Extent	Location Reference	Material Condition	Risk Status	Control Priority
	Sample No					Test Result

B015 - Communal Facilities/Pupil Facilities - 2009 - Brick/Veneer (Brick/Veneer)

Exterior

Underfloor Voids - Slab on Ground No Asbestos Found

Ceiling Voids No Asbestos Found

Interior

B015 - R0001 - P.E. Store

No Asbestos

B015 - R0002 - Movement

No Asbestos

B015 - R0003 - Raised Platform

No Asbestos

B015 - R0004 - Movement

No Asbestos

B015 - R0005 - Movement

No Asbestos

B015 - R0006 - Communal/Performance Store

No Asbestos

B015 - R0007 - Sports Store

No Asbestos

B015 - R0008 - Hall Chair Store

No Asbestos

B015 - R0009 - Cleaning Distributed Store

No Asbestos

B015 - R0010 - Distribution Board

Note: No inspection of live electrical installation.

No Asbestos

B015 - R0011 - External Movement

No Asbestos

B015 - R0012 - Movement

No Asbestos

B015 - R0013 - Toilets - Girls/Disabled Cubicle

No Asbestos

B015 - R0014 - Toilets - Boys/Disabled Cubicle

No Asbestos

B015 - R0015 - Communal Space

No Asbestos

B015 - R0016 - Covered Outdoor Learning Area

No Asbestos

B015 - R0017 - Sound Cupboard

No Asbestos

B015 - R0018 - Access Shower/Toilet

No Asbestos

B015 - R0019 - Plant

No Asbestos

B015 - R0020 - Garden Store

No Asbestos

B015 - R0021 - General Assistant/Bulk Store

No Asbestos

Product	Material Description	Extent	Location Reference	Material Condition	Risk Status	Control Priority
	Sample No					Test Result

B016 - General Learning - 2010 - Brick/Veneer (Brick/Veneer)**Exterior**

Underfloor Voids - Slab on Ground No Asbestos Found

Ceiling Voids No Asbestos Found

Interior**B016 - R0001 - External Movement**

No Asbestos

B016 - R0002 - Practical Activities

No Asbestos

B016 - R0003 - Home Base Store

No Asbestos

B016 - R0004 - Home Base

No Asbestos

B016 - R0005 - Withdrawal Space - 2hb

No Asbestos

B016 - R0006 - Home Base

No Asbestos

B016 - R0007 - Home Base Store

No Asbestos

B016 - R0008 - Practical Activities

No Asbestos

B016 - R0009 - Main Switch Board

No Asbestos

B016 - R0010 - External Stairs

No Asbestos

B016 - R0011 - External Stairs

No Asbestos

B016 - R1001 - External Movement

No Asbestos

B016 - R1002 - Practical Activities

No Asbestos

B016 - R1003 - Home Base Store

No Asbestos

B016 - R1004 - Home Base

No Asbestos

B016 - R1005 - Withdrawal Space - 2hb

No Asbestos

B016 - R1006 - Home Base

No Asbestos

B016 - R1007 - Home Base Store

No Asbestos

B016 - R1008 - Practical Activities

No Asbestos

B016 - R1009 - External Stairs

No Asbestos

B016 - R1010 - External Stairs

No Asbestos

Product	Material Description	Extent	Location Reference	Material Condition	Risk Status	Control Priority
Sample No					Test Result	

B017 - General Learning - 2010 - Brick/Veneer (Brick/Veneer)

Exterior

Underfloor Voids - Slab on Ground	No Asbestos Found
Ceiling Voids	No Asbestos Found

Interior

B017 - R0001 - External Movement

No Asbestos

B017 - R0002 - Practical Activities

No Asbestos

B017 - R0003 - Home Base Store

No Asbestos

B017 - R0004 - Home Base

No Asbestos

B017 - R0005 - Withdrawal Space - 2hb

No Asbestos

B017 - R0006 - Home Base

No Asbestos

B017 - R0007 - Home Base Store

No Asbestos

B017 - R0008 - Practical Activities

No Asbestos

B017 - R0009 - Main Switch Board

No Asbestos

2017

Product	Material Description	Extent	Location Reference	Material Condition	Risk Status	Control Priority
Sample No					Test Result	

Demountables

Demountable details as per the AMS records as of 15 Feb 2017.

OS 601 - D10039 - Learning Unit - Standard/Withdrawal : Placement Date - 10/08/2001

Exterior

Landing	Compressed AC Sheet	Assumed Asbestos	1.2 m2
Step Treads	Compressed AC Sheet	Assumed Asbestos	1.08 m2
Eave Lining	Flat AC Sheet	Assumed Asbestos	11.52 m2

Interior

R1 - Entry

End wall panel	Flat AC Sheet	Assumed Asbestos	18 m2
Ceiling	Flat AC Sheet	Assumed Asbestos	8 m2

R2 - General Learning Space

End wall panel	Flat AC Sheet	Assumed Asbestos	18 m2
Ceiling	Flat AC Sheet	Assumed Asbestos	55 m2

R3 - Store

Ceiling	Flat AC Sheet	Assumed Asbestos	10 m2
---------	---------------	------------------	-------

OS 600 - D11162 - Learning Unit - Small : Placement Date - 24/09/1996

Exterior

Eave Lining	Flat AC Sheet	Assumed Asbestos	8.64 m2
Landing	Compressed AC Sheet	Assumed Asbestos	1.2 m2
Step Treads	Compressed AC Sheet	Assumed Asbestos	1.08 m2

Interior

R1 - General Learning Space

End wall panel	Flat AC Sheet	Assumed Asbestos	50 m2
Ceiling	Flat AC Sheet	Assumed Asbestos	55 m2

OS 601 - D11182 - Learning Unit - Standard/Withdrawal : Placement Date - 19/01/2008

Exterior

Eave Lining	Flat AC Sheet	Assumed Asbestos	11.52 m2
Landing	Compressed AC Sheet	Assumed Asbestos	1.2 m2
Step Treads	Compressed AC Sheet	Assumed Asbestos	1.08 m2

Interior

R1 - Entry

End wall panel	Flat AC Sheet	Assumed Asbestos	18 m2
Ceiling	Flat AC Sheet	Assumed Asbestos	8 m2

R2 - General Learning Space

End wall panel	Flat AC Sheet	Assumed Asbestos	18 m2
Ceiling	Flat AC Sheet	Assumed Asbestos	55 m2

R3 - Store

Ceiling	Flat AC Sheet	Assumed Asbestos	10 m2
---------	---------------	------------------	-------

OS 601 - D11298 - Learning Unit - Standard/Withdrawal : Placement Date - 30/06/1995

Exterior

Step Treads	Compressed AC Sheet	Assumed Asbestos	1.08 m2
Eave Lining	Flat AC Sheet	Assumed Asbestos	11.52 m2
Landing	Compressed AC Sheet	Assumed Asbestos	1.2 m2

Product	Material Description	Extent	Location Reference	Material Condition	Risk Status	Control Priority
Sample No					Test Result	
Interior						
R1 - Entry						
End wall panel	Flat AC Sheet	Assumed Asbestos				18 m2
Ceiling	Flat AC Sheet	Assumed Asbestos				8 m2
R2 - General Learning Space						
End wall panel	Flat AC Sheet	Assumed Asbestos				18 m2
Ceiling	Flat AC Sheet	Assumed Asbestos				55 m2
R3 - Store						
Ceiling	Flat AC Sheet	Assumed Asbestos				10 m2
OS 600 - D11526 - Learning Unit - Small : Placement Date - 5/11/1996						
Exterior						
Landing	Compressed AC Sheet	Assumed Asbestos				1.2 m2
Step Treads	Compressed AC Sheet	Assumed Asbestos				1.08 m2
Eave Lining	Flat AC Sheet	Assumed Asbestos				8.64 m2
Interior						
R1 - General Learning Space						
End wall panel	Flat AC Sheet	Assumed Asbestos				50 m2
Ceiling	Flat AC Sheet	Assumed Asbestos				55 m2
OS 601 - D11945 - Learning Unit - Standard/Withdrawal : Placement Date - 3/01/2002						
Exterior						
Eave Lining	Flat AC Sheet	Assumed Asbestos				11.52 m2
Landing	Compressed AC Sheet	Assumed Asbestos				1.2 m2
Step Treads	Compressed AC Sheet	Assumed Asbestos				1.08 m2
Interior						
R1 - Entry						
End wall panel	Flat AC Sheet	Assumed Asbestos				18 m2
Ceiling	Flat AC Sheet	Assumed Asbestos				8 m2
R2 - General Learning Space						
End wall panel	Flat AC Sheet	Assumed Asbestos				18 m2
Ceiling	Flat AC Sheet	Assumed Asbestos				55 m2
R3 - Store						
Ceiling	Flat AC Sheet	Assumed Asbestos				10 m2
OS 601 - D12408 - Learning Unit - Standard/Withdrawal : Placement Date - 2/01/2006						
Exterior						
Eave Lining	Flat AC Sheet	Assumed Asbestos				11.52 m2
Landing	Compressed AC Sheet	Assumed Asbestos				1.2 m2
Step Treads	Compressed AC Sheet	Assumed Asbestos				1.08 m2
Interior						
R1 - Entry						
End wall panel	Flat AC Sheet	Assumed Asbestos				18 m2
Ceiling	Flat AC Sheet	Assumed Asbestos				8 m2
R2 - General Learning Space						
End wall panel	Flat AC Sheet	Assumed Asbestos				18 m2
Ceiling	Flat AC Sheet	Assumed Asbestos				55 m2
R3 - Store						
Ceiling	Flat AC Sheet	Assumed Asbestos				10 m2

Product	Material Description	Extent	Location Reference	Material Condition	Risk Status	Control Priority
Sample No					Test Result	

OS 602 - D13083 - Learning Unit - Standard With P.A.A. : Placement Date - 15/08/2012

Note: This refurbished demountable may have asbestos present in remnant mastic in window frames.

Exterior

No Asbestos Found.

Interior

R1 - Learning space/withdrawal/entry

No Asbestos Found.

R2 - Home Base Store

No Asbestos Found.

OS 601 - D14355 - Learning Unit - Standard/Withdrawal : Placement Date - 3/01/2003

Exterior

Eave Lining	Flat AC Sheet	Assumed Asbestos	11.52 m2
Landing	Compressed AC Sheet	Assumed Asbestos	1.2 m2
Step Treads	Compressed AC Sheet	Assumed Asbestos	1.08 m2

Interior

R1 - Entry

End wall panel	Flat AC Sheet	Assumed Asbestos	18 m2
Ceiling	Flat AC Sheet	Assumed Asbestos	8 m2

R2 - General Learning Space

End wall panel	Flat AC Sheet	Assumed Asbestos	18 m2
Ceiling	Flat AC Sheet	Assumed Asbestos	55 m2

R3 - Store

Ceiling	Flat AC Sheet	Assumed Asbestos	10 m2
---------	---------------	------------------	-------

OS 601 - D14398 - Learning Unit - Standard/Withdrawal : Placement Date - 10/12/2008

Note: This refurbished demountable may have asbestos present in remnant mastic in window frames.

Exterior

No Asbestos Found.

Interior

R1 - Entry

No Asbestos Found.

R2 - General Learning Space

No Asbestos Found.

R3 - Store

No Asbestos Found.

2017

Product	Material Description	Extent	Location Reference	Material Condition	Risk Status	Control Priority
Sample No					Test Result	

Listing of Electronic Attachments as of 22/03/2017

There are no asbestos related file attachment(s) for this school.

2017