

Asbestos Register

(Hazardous Materials and Risk Assessment)

School : Lismore South Public School (2409)
Region : North Coast
State Electorate : Lismore
Local Government Area : Lismore

Initial Survey : Noel Arnold & Associates : 10 - Jun - 2008
Reviewed By : Parsons Brinckerhoff : 31 - Oct - 2016

2409 - Lismore South Public School
Site Plan (All Sites)

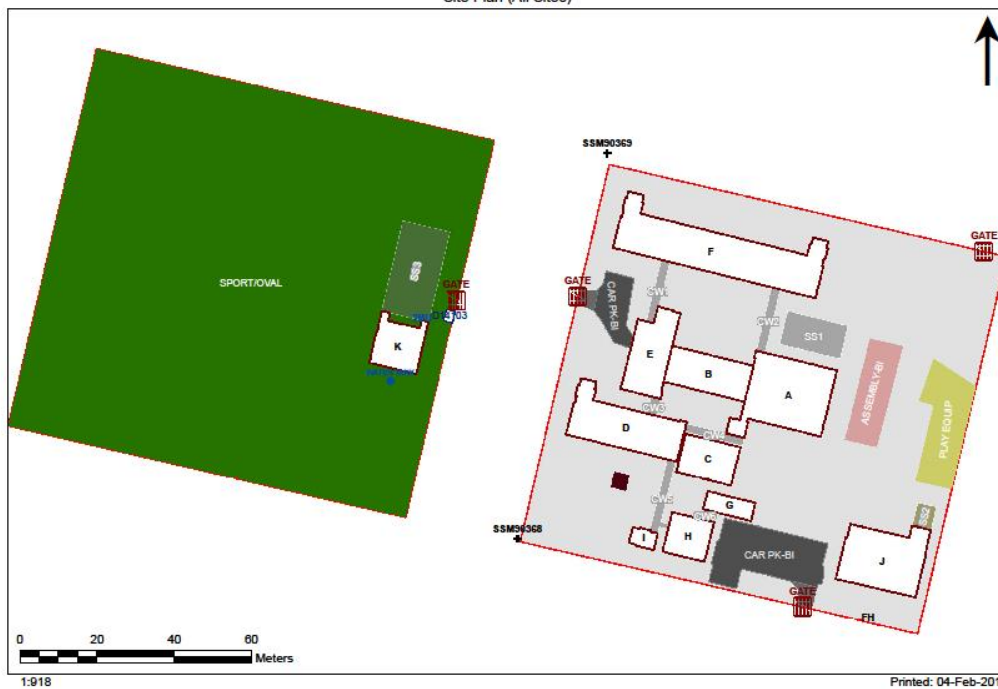

2017

Product	Material Description	Extent	Location Reference	Material Condition	Risk Status	Control Priority
Sample No					Test Result	

B00A - Communal Facilities/Library - 1978 - Brick/Block (Brick/Block)

Exterior

Underfloor Voids - Slab on Ground	No Asbestos Found					
Ceiling Void	No Asbestos Found					
Eaves Linings	Flat AC Sheeting	30m2	North & South	Good Condition (1)	Low (1)	Low Priority (2-3)
	2409/B00F/Eaves Linings/S15			Chrysotile (white asbestos) , Amosite (brown asbestos)		
Gable Ends	Flat AC Sheeting	60m2	Throughout	Good Condition (1)	Low (1)	Low Priority (2-3)
	2409/B00F/Gable Ends/S16			Chrysotile (white asbestos) , Amosite (brown asbestos)		

Interior

B00A - R0001 - Movement

No Asbestos

B00A - R0002 - Communal Space

No Asbestos

B00A - R0003 - Movement

No Asbestos

B00A - R0004 - Music Store

No Asbestos

B00A - R0005 - Garden Store

No Asbestos

B00A - R0006 - Shower/Change

No Asbestos

B00A - R0007 - Movement

No Asbestos

B00A - R0008 - Raised Platform

No Asbestos

B00A - R0009 - P.E. Store

No Asbestos

B00A - R0010 - Movement

No Asbestos

B00A - R0011 - Shower/Change

No Asbestos

B00A - R0012 - Cleaning Supplies

No Asbestos

B00A - R0013 - Hall Chair Store

No Asbestos

B00A - R0014 - Movement

No Asbestos

B00A - R0015 - Movement

No Asbestos

B00A - R0016 - Stairs

Ceiling Structures/Linings	Flat AC Sheeting	6m2	Throughout	Good Condition (1)	Low (1)	Low Priority (2-3)
	2409/B00F/R1001/Ceiling Structures/Linings/S1			Chrysotile (white asbestos)		

B00A - R1001 - Movement

No Asbestos

B00A - R1002 - Reading Area

No Asbestos

B00A - R1003 - Seminar/Study

Product	Material Description	Extent	Location Reference	Material Condition	Risk Status	Control Priority
Sample No					Test Result	

No Asbestos

B00A - R1004 - Seminar/Study

No Asbestos

B00A - R1005 - Library Office/Workroom

No Asbestos

B00A - R1006 - Library Office/Workroom

No Asbestos

B00A - R1007 - Communications Room

No Asbestos

B00A - R1008 - Toilets - Boys

No Asbestos

B00A - R1009 - Toilets - Girls

No Asbestos

B00A - R1010 - Cleaning Distributed Store

No Asbestos

B00A - R1011 - Movement

Ceiling Structures/Linings Flat AC Sheeting 41m2 Throughout Good Condition (1) Low (1) Low Priority (2-3)

2409/B00A/R1011/Ceiling Structures/Linings/S3

Chrysotile (white asbestos)

B00A - R1012 - Staff Room

No Asbestos

B00A - R1013 - Distribution Board

Note: No inspection of live electrical installation.

No Asbestos

B00A - R1014 - Stairs

Ceiling Structures/Linings Flat AC Sheeting 8m2 Throughout Good Condition (1) Low (1) Low Priority (2-3)

2409/B00A/R1011/Ceiling Structures/Linings/S3

Chrysotile (white asbestos)

2017

Product	Material Description	Extent	Location Reference	Material Condition	Risk Status	Control Priority
Sample No					Test Result	

B00B - Administration/Pupil Facilities - 1978 - Brick/Block (Brick/Block)**Exterior**

Underfloor Voids - Slab on Ground	No Asbestos Found					
Ceiling Void	No Asbestos Found					
Eaves Linings	Flat AC Sheeting	20m2	North & South	Good Condition (1)	Low (1)	Low Priority (2-3)
	2409/B00F/Eaves Linings/S15					Chrysotile (white asbestos) , Amosite (brown asbestos)
Gable Ends	Flat AC Sheeting	60m2	Throughout	Good Condition (1)	Low (1)	Low Priority (2-3)
	2409/B00F/Gable Ends/S16					Chrysotile (white asbestos) , Amosite (brown asbestos)

Interior**B00B - R0001 - Toilets - Boys**

No Asbestos

B00B - R0002 - Movement

No Asbestos

B00B - R0003 - Toilets - Girls

No Asbestos

B00B - R0004 - Movement

No Asbestos

B00B - R1001 - General Storeroom

Floor Coverings Res/Textile	Vinyl Tiles	15m2	Throughout	Good Condition (1)	Low (1)	Low Priority (2-3)
	2409/B00B/R1001/Floor Coverings Res/Textile/S4					Chrysotile (white asbestos)

B00B - R1002 - Movement

Ceiling Structures/Linings	Flat AC Sheeting	1m2	Throughout	Good Condition (1)	Low (1)	Low Priority (2-3)
	2409/B00A/R1011/Ceiling Structures/Linings/S3					Chrysotile (white asbestos)

B00B - R1003 - Movement

No Asbestos

B00B - R1004 - Staff Toilet

No Asbestos

B00B - R1005 - Staff Toilet

No Asbestos

B00B - R1006 - Sick Bay

Floor Coverings Res/Textile	Vinyl Tiles	8m2	Throughout	Good Condition (1)	Low (1)	Low Priority (2-3)
	2409/B00B/R1001/Floor Coverings Res/Textile/S4					Chrysotile (white asbestos)

B00B - R1007 - Duplicating Workroom

Floor Coverings Res/Textile	Vinyl Tiles	12m2	Throughout	Good Condition (1)	Low (1)	Low Priority (2-3)
	2409/B00B/R1001/Floor Coverings Res/Textile/S4					Chrysotile (white asbestos)

B00B - R1008 - Clerical Office

No Asbestos

B00B - R1009 - Deputy Principal

No Asbestos

B00B - R1010 - Movement

Ceiling Structures/Linings	Flat AC Sheeting	1m2	Throughout	Good Condition (1)	Low (1)	Low Priority (2-3)
	2409/B00A/R1011/Ceiling Structures/Linings/S3					Chrysotile (white asbestos)

B00B - R1011 - Principal

No Asbestos

B00B - R1012 - Deputy Principal

Product	Material Description	Extent	Location Reference	Material Condition	Risk Status	Control Priority
Sample No					Test Result	

No Asbestos

B00B - R1013 - Interview

No Asbestos

B00B - R1014 - General Storeroom

Floor Coverings Res/Textile	Vinyl Tiles	12m2	Throughout	Good Condition (1)	Low (1)	Low Priority (2-3)
	2409/B00B/R1001/Floor Coverings Res/Textile/S4				Chrysotile (white asbestos)	

2017

Product	Material Description	Extent	Location Reference	Material Condition	Risk Status	Control Priority
Sample No					Test Result	

B00C - General Learning - 1977 - Timber (Timber)**Exterior**

Underfloor Voids - Slab on Ground No Asbestos Found

Interior**B00C - R0003 - Craft Store**

Floor Coverings Res/Textile Vinyl Tiles 27m2 Throughout Good Condition (1) Low (1) Low Priority (2-3)
2409/B00B/R1001/Floor Coverings Res/Textile/S4 **Chrysotile (white asbestos)**

B00C - R0004 - Other

Ceiling Structures/Linings Flat AC Sheeting 2409/B00C/R0004/Ceiling Structures/Linings/S10 **No Asbestos Detected**

B00C - R1001 - Sports Store

Ceiling Structures/Linings Flat AC Sheeting 11m2 Throughout Good Condition (1) Low (1) Low Priority (2-3)
2409/B00C/R1005/Ceiling Structures/Linings/S5 **Chrysotile (white asbestos)**

Wall Linings Internal Flat AC Sheeting 14m2 North, East, West Good Condition (1) Low (1) Low Priority (2-3)
2409/B00C/R1006/Wall Linings Internal/S6 **Chrysotile (white asbestos)**

B00C - R1002 - Home Base

Wall Linings Internal Flat AC Sheeting 40m2 Throughout, Upper portion Good Condition (1) Low (1) Low Priority (2-3)
2409/B00C/R1006/Wall Linings Internal/S6 **Chrysotile (white asbestos)**

Ceiling Structures/Linings Flat AC Sheeting 71m2 Throughout Good Condition (1) Low (1) Low Priority (2-3)
2409/B00C/R1006/Wall Linings Internal/S6 **Chrysotile (white asbestos)**

B00C - R1003 - Practical Activities - 1hb

Ceiling Structures/Linings Flat AC Sheeting 13m2 Throughout Good Condition (1) Low (1) Low Priority (2-3)
2409/B00C/R1006/Wall Linings Internal/S6 **Chrysotile (white asbestos)**

Wall Linings Internal Flat AC Sheeting 10m2 North, South, West Good Condition (1) Low (1) Low Priority (2-3)
2409/B00C/R1006/Wall Linings Internal/S6 **Chrysotile (white asbestos)**

B00C - R1004 - Toilets - Boys/Girls

Wall Linings Internal Flat AC Sheeting 10m2 Throughout Good Condition (1) Low (1) Low Priority (2-3)
2409/B00C/R1006/Wall Linings Internal/S6 **Chrysotile (white asbestos)**

Ceiling Structures/Linings Flat AC Sheeting 3m2 Throughout Good Condition (1) Low (1) Low Priority (2-3)
2409/B00C/R1006/Wall Linings Internal/S6 **Chrysotile (white asbestos)**

B00C - R1006 - General Storeroom

Wall Linings Internal Flat AC Sheeting 28m2 North, South, West Good Condition (1) Low (1) Low Priority (2-3)
2409/B00C/R1006/Wall Linings Internal/S6 **Chrysotile (white asbestos)**

Ceiling Structures/Linings Flat AC Sheeting 17m2 Throughout Good Condition (1) Low (1) Low Priority (2-3)
2409/B00C/R1006/Wall Linings Internal/S6 **Chrysotile (white asbestos)**

B00C - R1007 - Movement

Ceiling Structures/Linings Flat AC Sheeting 2409/B00C/R1007/Ceiling Structures/Linings/S11 **No Asbestos Detected**

B00C - R1008 - Other

No Asbestos

Product	Material Description	Extent	Location Reference	Material Condition	Risk Status	Control Priority
Sample No					Test Result	

B00D - General Learning - 1978 - Brick/Block (Brick/Block)

Exterior

Underfloor Voids - Slab on Ground	No Asbestos Found
Ceiling Void	No Asbestos Found

Interior

B00D - R0001 - Movement

No Asbestos

B00D - R0002 - Stairs

Ceiling Structures/Linings	Flat AC Sheeting	10m2	Throughout	Good Condition (1)	Low (1)	Low Priority (2-3)
2409/B00D/R0002/Ceiling Structures/Linings/S12				Chrysotile (white asbestos) , Amosite (brown asbestos)		

B00D - R1001 - Movement

Ceiling Structures/Linings	Flat AC Sheeting	67m2	Throughout	Good Condition (1)	Low (1)	Low Priority (2-3)
2409/B00D/R0002/Ceiling Structures/Linings/S12				Chrysotile (white asbestos) , Amosite (brown asbestos)		

B00D - R1002 - Distribution Board

Note: No inspection of live electrical installation.

No Asbestos

B00D - R1003 - Practical Activities - 1hb

Floor Coverings Res/Textile	Vinyl Tiles	18m2	Throughout	Good Condition (1)	Low (1)	Low Priority (2-3)
2409/B00F/R1010/Floor Coverings Res/Textile/S2				Chrysotile (white asbestos)		

B00D - R1004 - Home Base

No Asbestos

B00D - R1005 - Home Base

No Asbestos

B00D - R1006 - Practical Activities - 1hb

Floor Coverings Res/Textile	Vinyl Tiles	19m2	Throughout	Good Condition (1)	Low (1)	Low Priority (2-3)
2409/B00F/R1010/Floor Coverings Res/Textile/S2				Chrysotile (white asbestos)		

B00D - R1007 - Practical Activities - 1hb

Floor Coverings Res/Textile	Vinyl Tiles	19m2	Throughout	Good Condition (1)	Low (1)	Low Priority (2-3)
2409/B00F/R1010/Floor Coverings Res/Textile/S2				Chrysotile (white asbestos)		

B00D - R1008 - Home Base

No Asbestos

B00D - R1009 - Stairs

Ceiling Structures/Linings	Flat AC Sheeting	5m2	Throughout	Good Condition (1)	Low (1)	Low Priority (2-3)
2409/B00D/R0002/Ceiling Structures/Linings/S12				Chrysotile (white asbestos) , Amosite (brown asbestos)		

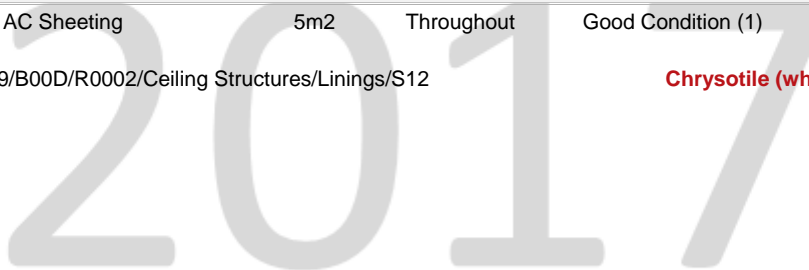

Product	Material Description	Extent	Location Reference	Material Condition	Risk Status	Control Priority
Sample No					Test Result	

B00E - General Learning/Pupil Facilities - 1978 - Brick/Block (Brick/Block)

Exterior

Underfloor Voids - Slab on Ground	No Asbestos Found					
Ceiling Void	No Asbestos Found					
Eaves Linings	Flat AC Sheeting	20m2	Throughout	Good Condition (1)	Low (1)	Low Priority (2-3)
	2409/B00F/Eaves Linings/S15			Chrysotile (white asbestos) , Amosite (brown asbestos)		
Gable Ends	Flat AC Sheeting	60m2	Throughout	Good Condition (1)	Low (1)	Low Priority (2-3)
	2409/B00F/Gable Ends/S16			Chrysotile (white asbestos) , Amosite (brown asbestos)		

Interior

B00E - R0001 - Movement

No Asbestos

B00E - R0002 - Canteen

Floor Coverings Res/Textile	Vinyl Tiles	30m2	Throughout	Good Condition (1)	Low (1)	Low Priority (2-3)
	2409/B00F/R1010/Floor Coverings Res/Textile/S2			Chrysotile (white asbestos)		

B00E - R0003 - Canteen Office/Store

No Asbestos

B00E - R0004 - Canteen Office/Store

No Asbestos

B00E - R0005 - Staff Toilet

No Asbestos

B00E - R0006 - Stairs

Ceiling Structures/Linings	Flat AC Sheeting	6m2	Throughout	Good Condition (1)	Low (1)	Low Priority (2-3)
	2409/B00A/R1011/Ceiling Structures/Linings/S3			Chrysotile (white asbestos)		

B00E - R0007 - Kiln Room

Wall Linings Internal	Flat AC Sheeting					No Asbestos Detected
	2409/B00E/R0007/Wall Linings Internal/S13					

B00E - R1001 - Movement

Ceiling Structures/Linings	Flat AC Sheeting	43m2	Throughout	Good Condition (1)	Low (1)	Low Priority (2-3)
	2409/B00A/R1011/Ceiling Structures/Linings/S3			Chrysotile (white asbestos)		

B00E - R1002 - Home Base

No Asbestos

B00E - R1003 - Practical Activities - 1hb

Floor Coverings Res/Textile	Vinyl Tiles	19m2	Throughout	Good Condition (1)	Low (1)	Low Priority (2-3)
	2409/B00F/R1010/Floor Coverings Res/Textile/S2			Chrysotile (white asbestos)		

B00E - R1004 - Practical Activities - 1hb

Floor Coverings Res/Textile	Vinyl Tiles	19m2	Throughout	Good Condition (1)	Low (1)	Low Priority (2-3)
	2409/B00F/R1010/Floor Coverings Res/Textile/S2			Chrysotile (white asbestos)		

B00E - R1005 - Home Base

No Asbestos

B00E - R1006 - Stairs

Ceiling Structures/Linings	Flat AC Sheeting	11m2	Throughout	Good Condition (1)	Low (1)	Low Priority (2-3)
	2409/B00A/R1011/Ceiling Structures/Linings/S3			Chrysotile (white asbestos)		

Product	Material Description	Extent	Location Reference	Material Condition	Risk Status	Control Priority
Sample No					Test Result	

B00F - General Learning - 1978 - Brick/Block (Brick/Block)**Exterior**

Underfloor Voids - Slab on Ground	No Asbestos Found					
Ceiling Void	No Asbestos Found					
Eaves Linings	Flat AC Sheeting	40m2	Throughout	Good Condition (1)	Low (1)	Low Priority (2-3)
	2409/B00F/Eaves Linings/S15					Chrysotile (white asbestos) , Amosite (brown asbestos)
Gable Ends	Flat AC Sheeting	100m2	Throughout	Good Condition (1)	Low (1)	Low Priority (2-3)
	2409/B00F/Gable Ends/S16					Chrysotile (white asbestos) , Amosite (brown asbestos)

Interior**B00F - R0001 - Distribution Board**

Note: No inspection of live electrical installation.

Electrical Backing Board	Resinous Board	1m2	South	Good Condition (1)	Low (1)	Low Priority (2-3)
	2409/B00F/R0001/Electrical Backing Board/S14					Chrysotile (white asbestos)

B00F - R0002 - Movement

No Asbestos

B00F - R0003 - Stairs

Ceiling Structures/Linings	Flat AC Sheeting	12m2	Throughout	Good Condition (1)	Low (1)	Low Priority (2-3)
	2409/B00F/R1001/Ceiling Structures/Linings/S1					Chrysotile (white asbestos)

B00F - R0004 - Stairs

Ceiling Structures/Linings	Flat AC Sheeting	12m2	Throughout	Good Condition (1)	Low (1)	Low Priority (2-3)
	2409/B00F/R1001/Ceiling Structures/Linings/S1					Chrysotile (white asbestos)

B00F - R1001 - Movement

Ceiling Structures/Linings	Flat AC Sheeting	125m2	Throughout	Good Condition (1)	Low (1)	Low Priority (2-3)
	2409/B00F/R1001/Ceiling Structures/Linings/S1					Chrysotile (white asbestos)

B00F - R1002 - Home Base

No Asbestos

B00F - R1003 - Practical Activities - 1hb

Floor Coverings Res/Textile	Vinyl Tiles	19m2	Throughout	Good Condition (1)	Low (1)	Low Priority (2-3)
	2409/B00F/R1010/Floor Coverings Res/Textile/S2					Chrysotile (white asbestos)

B00F - R1004 - Home Base

No Asbestos

B00F - R1005 - Practical Activities - 1hb

Floor Coverings Res/Textile	Vinyl Tiles	19m2	Throughout	Good Condition (1)	Low (1)	Low Priority (2-3)
	2409/B00F/R1010/Floor Coverings Res/Textile/S2					Chrysotile (white asbestos)

B00F - R1006 - Practical Activities - 1hb

Floor Coverings Res/Textile	Vinyl Tiles	19m2	Throughout	Good Condition (1)	Low (1)	Low Priority (2-3)
	2409/B00F/R1010/Floor Coverings Res/Textile/S2					Chrysotile (white asbestos)

B00F - R1007 - Home Base

No Asbestos

B00F - R1008 - Home Base

No Asbestos

B00F - R1009 - Practical Activities - 1hb

Floor Coverings Res/Textile	Vinyl Tiles	19m2	Throughout	Good Condition (1)	Low (1)	Low Priority (2-3)
	2409/B00F/R1010/Floor Coverings Res/Textile/S2					Chrysotile (white asbestos)

Product	Material Description	Extent	Location Reference	Material Condition	Risk Status	Control Priority
Sample No					Test Result	
B00F - R1010 - General Storeroom						
Floor Coverings Res/Textile	Vinyl Tiles	25m2	Throughout	Good Condition (1)	Low (1)	Low Priority (2-3)
2409/B00F/R1010/Floor Coverings Res/Textile/S2					Chrysotile (white asbestos)	
B00F - R1011 - Distribution Board						
No Asbestos Note: No inspection of live electrical installation.						
B00F - R1012 - Home Base						
No Asbestos						
B00F - R1013 - Practical Activities - 1hb						
Floor Coverings Res/Textile	Vinyl Tiles	19m2	Throughout	Good Condition (1)	Low (1)	Low Priority (2-3)
2409/B00F/R1010/Floor Coverings Res/Textile/S2					Chrysotile (white asbestos)	
B00F - R1014 - Stairs						
Ceiling Structures/Linings	Flat AC Sheeting	5m2	Throughout	Good Condition (1)	Low (1)	Low Priority (2-3)
2409/B00F/R1001/Ceiling Structures/Linings/S1					Chrysotile (white asbestos)	
B00F - R1015 - Stairs						
Ceiling Structures/Linings	Flat AC Sheeting	5m2	Throughout	Good Condition (1)	Low (1)	Low Priority (2-3)
2409/B00F/R1001/Ceiling Structures/Linings/S1					Chrysotile (white asbestos)	

2017

Product	Material Description	Extent	Location Reference	Material Condition	Risk Status	Control Priority
Sample No					Test Result	

B00G - Pupil Facilities - 1955 - Timber (Timber)

Exterior

Underfloor Voids - Slab on Ground	No Asbestos Found					
Eaves Linings	Flat AC Sheeting	12m2	Throughout	Good Condition (1)	Low (1)	Low Priority (2-3)
	2409/B00G/Eaves Linings/S8			Chrysotile (white asbestos) , Amosite (brown asbestos)		
Ceiling Void	No Asbestos Found					

Interior

B00G - R0005 - External Movement

No Asbestos

B00G - R0006 - Toilets - Girls

No Asbestos

B00G - R0007 - Disabled Shower/Toilet

No Asbestos

B00G - R0008 - Toilets - Boys

No Asbestos

2017

Product	Material Description	Extent	Location Reference	Material Condition	Risk Status	Control Priority
Sample No					Test Result	

B00H - General Learning - 1977 - Timber (Timber)

Exterior

Underfloor Voids - Slab on Ground	No Asbestos Found					
Ceiling Void	No Asbestos Found					
Gable Ends	Corrugated AC Sheeting	12m2	East & West	Minimal Damage (2)	Low (1)	Low Priority (2-3)
	2409/B00H/Gable Ends/S9			Chrysotile (white asbestos) , Amosite (brown asbestos)		

Interior

B00H - R0001 - Movement

Ceiling Structures/Linings	Flat AC Sheeting					No Asbestos Detected
	2409/B00H/R0001/Ceiling Structures/Linings/S7					

B00H - R1001 - Toilets - Boys/Girls

No Asbestos

B00H - R1002 - Personal Effects Storage

No Asbestos

B00H - R1003 - Home Base

No Asbestos

B00H - R1004 - Practical Activities - 1hb

No Asbestos

B00H - R1005 - Withdrawal Space - 1hb

No Asbestos

2017

Product	Material Description	Extent	Location Reference	Material Condition	Risk Status	Control Priority
Sample No					Test Result	

B00I - Building Services - 1978 - Brick/Block (Brick/Block)

Exterior

Underfloor Voids - Slab on Ground	No Asbestos Found
Ceiling Void	No Asbestos Found

Interior

B00I - R0001 - Movement

No Asbestos

B00I - R0002 - Stairs

Ceiling Structures/Linings	Flat AC Sheeting	12m2	Throughout	Good Condition (1)	Low (1)	Low Priority (2-3)
2409/B00A/R1011/Ceiling Structures/Linings/S3					Chrysotile (white asbestos)	

B00I - R1001 - Movement

Ceiling Structures/Linings	Flat AC Sheeting	7m2	Throughout	Good Condition (1)	Low (1)	Low Priority (2-3)
2409/B00A/R1011/Ceiling Structures/Linings/S3					Chrysotile (white asbestos)	

B00I - R1002 - Stairs

Ceiling Structures/Linings	Flat AC Sheeting	5m2	Throughout	Good Condition (1)	Low (1)	Low Priority (2-3)
2409/B00A/R1011/Ceiling Structures/Linings/S3					Chrysotile (white asbestos)	

2017

Product	Material Description	Extent	Location Reference	Material Condition	Risk Status	Control Priority
Sample No					Test Result	

B00J - Pre-School Facilities - 2004 - Brick/Veneer (Brick/Veneer)

Exterior

Underfloor Voids - Slab on Ground	No Asbestos Found
Ceiling Voids	No Asbestos Found

Interior

B00J - R0001 - Movement

No Asbestos

B00J - R0002 - Entry Vestibule

No Asbestos

B00J - R0003 - Security Store

No Asbestos

B00J - R0004 - General Storeroom - Pre

No Asbestos

B00J - R0005 - Home Base - Pre

Vinyl Tiles (Under Floor Covering/Carpet) No Asbestos Found

B00J - R0006 - Practical Activities - Pre

No Asbestos

B00J - R0007 - Toilets - Boys/Girls - Pre

No Asbestos

B00J - R0008 - Laundry - Pre

No Asbestos

B00J - R0009 - Access Shower/Toilet - Type 2

No Asbestos

B00J - R0010 - Cleaning Distributed Store

No Asbestos

B00J - R0011 - Kitchen - Pre

No Asbestos

B00J - R0012 - Clerical Office - Pre

Vinyl Tiles (Under Floor Covering/Carpet) No Asbestos Found

B00J - R0013 - Clerical Office - Pre

Vinyl Tiles (Under Floor Covering/Carpet) No Asbestos Found

B00J - R0014 - General Storeroom - Pre

No Asbestos

B00J - R0015 - External Movement

No Asbestos

2017

Product	Material Description	Extent	Location Reference	Material Condition	Risk Status	Control Priority
Sample No					Test Result	

B00K - Communal Facilities/Pupil Facilities - 2011 - Brick/Veneer (Brick/Veneer)**Exterior**

Ceiling Voids	No Asbestos Found
Underfloor Void	No Asbestos Found

Interior**B00K - R0001 - Sports Store**

No Asbestos

B00K - R0002 - External Movement

No Asbestos

B00K - R0003 - Ramp

No Asbestos

B00K - R0004 - External Stairs

No Asbestos

B00K - R1001 - Toilets - Girls

No Asbestos

B00K - R1002 - Toilets - Boys

No Asbestos

B00K - R1003 - Access Shower/Toilet/Change

No Asbestos

B00K - R1004 - External Movement

No Asbestos

B00K - R1005 - Ramp

No Asbestos

B00K - R1006 - External Stairs

No Asbestos

2017

Product	Material Description	Extent	Location Reference	Material Condition	Risk Status	Control Priority
Sample No					Test Result	

Demountables

Demountable details as per the AMS records as of 15 Feb 2017.

OS 844 - D14103 - Country Toilet - Reltc - Boys/Girls : Placement Date - 30/06/1995

Exterior

Step Treads	Compressed AC Sheet	Assumed Asbestos	1.08 m2
Landing	Compressed AC Sheet	Assumed Asbestos	1.2 m2
Eave Lining	Flat AC Sheet	Assumed Asbestos	2.88 m2

Interior

R1 - Staff Toilet

End wall panel	Flat AC Sheet	Assumed Asbestos	18 m2
Ceiling	Flat AC Sheet	Assumed Asbestos	9 m2

R2 - Staff Toilet

End wall panel	Flat AC Sheet	Assumed Asbestos	18 m2
Ceiling	Flat AC Sheet	Assumed Asbestos	9 m2

2017

Product	Material Description	Extent	Location Reference	Material Condition	Risk Status	Control Priority
Sample No					Test Result	

Listing of Electronic Attachments as of 22/03/2017

There are no asbestos related file attachment(s) for this school.

2017