

Asbestos Register

(Hazardous Materials and Risk Assessment)

School : Lindfield Public School (2403)
Region : Northern Sydney
State Electorate : Davidson
Local Government Area : Ku-Ring-Gai

Initial Survey : Noel Arnold & Associates : 04 - Jun - 2008
Reviewed By : AECOM : 28 - Jun - 2016

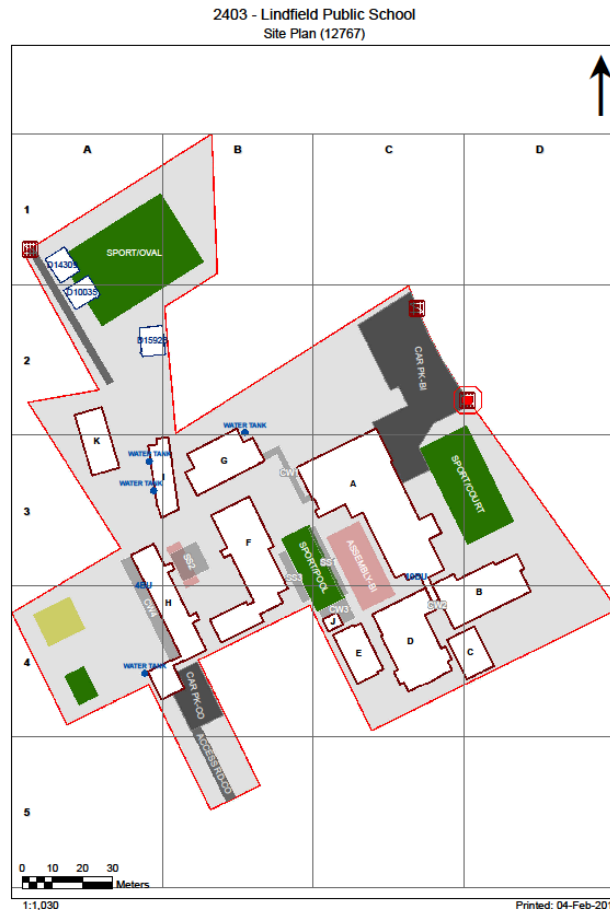

2017

Product	Material Description	Extent	Location Reference	Material Condition	Risk Status	Control Priority
Sample No				Test Result		

B00A - Administration/General Learning - 1976 - Brick/Block (Brick/Block)

Exterior

Ceiling Voids - Flat Roof	No Asbestos Found					
Eaves Linings	Flat AC Sheeting	30m2	South/west. Eaves to 1021	Good Condition (1)	Low (1)	Low Priority (2-3)
Assumed Asbestos - Height Restrictions						
Wall Cladding	Flat AC Sheeting	400m2	East facing, West facing	Good Condition (1)	Low (1)	Low Priority (2-3)
	2403/B00A/Eaves Linings/S79			Chrysotile (white asbestos) , Amosite (brown asbestos)		
Infill panels	Flat AC Sheeting	4m2	North facing, above library windows	Good Condition (1)	Low (1)	Low Priority (2-3)
	2403/B00A/Infill panels/S80			Chrysotile (white asbestos)		

Interior

B00A - R0001 - Staff Room (80.97 m2)

Ceiling Structures/Linings	Vermiculite					
	2403/B00A/R0026/Ceiling Structures/Linings/S10					Limited Samples Taken
Vermiculite Ceilings may contain asbestos. Asbestos testing MUST be conducted prior to any disturbance works						
Floor Coverings Res/Textile	Vinyl Tiles (Under Floor Covering/Carpet)	8m2	All surfaces	Good Condition (1)	Low (1)	Low Priority (2-3)
	2403/B00A/R0027/Floor Coverings Res/Textile/S12					Chrysotile (white asbestos)
Floor Coverings Res/Textile	Vinyl Sheet					
	2403/B00A/R0001/Floor Coverings Res/Textile/S105					No Asbestos Detected

B00A - R0002 - Cleaning Distributed Store (3.86 m2)

Ceiling Structures/Linings	Vermiculite					
	2403/B00A/R0026/Ceiling Structures/Linings/S10					Limited Samples Taken
Vermiculite Ceilings may contain asbestos. Asbestos testing MUST be conducted prior to any disturbance works						
Floor Coverings Res/Textile	Vinyl Tiles	4m2	All surfaces	Good Condition (1)	Low (1)	Low Priority (2-3)
	2403/B00A/R0027/Floor Coverings Res/Textile/S12					Chrysotile (white asbestos)

B00A - R0003 - General Storeroom (10.81 m2)

Ceiling Structures/Linings	Vermiculite					
	2403/B00A/R0026/Ceiling Structures/Linings/S10					Limited Samples Taken
Vermiculite Ceilings may contain asbestos. Asbestos testing MUST be conducted prior to any disturbance works						
Floor Coverings Res/Textile	Vinyl Tiles	11m2	All surfaces	Good Condition (1)	Low (1)	Low Priority (2-3)
	2403/B00A/R0027/Floor Coverings Res/Textile/S12					Chrysotile (white asbestos)

B00A - R0004 - Duplicating Workroom (18.79 m2)

Ceiling Structures/Linings	Vermiculite					
	2403/B00A/R0026/Ceiling Structures/Linings/S10					Limited Samples Taken
Vermiculite Ceilings may contain asbestos. Asbestos testing MUST be conducted prior to any disturbance works						
Floor Coverings Res/Textile	Vinyl Tiles (Under Floor Covering/Carpet)	19m2	All surfaces	Good Condition (1)	Low (1)	Low Priority (2-3)
	2403/B00A/R0027/Floor Coverings Res/Textile/S12					Chrysotile (white asbestos)

B00A - R0005 - Principal (20.08 m2)

Ceiling Structures/Linings	Vermiculite					
	2403/B00A/R0026/Ceiling Structures/Linings/S10					Limited Samples Taken
Vermiculite Ceilings may contain asbestos. Asbestos testing MUST be conducted prior to any disturbance works						

B00A - R0006 - General Storeroom (2.29 m2)

Ceiling Structures/Linings	Vermiculite					
	2403/B00A/R0026/Ceiling Structures/Linings/S10					Limited Samples Taken
Vermiculite Ceilings may contain asbestos. Asbestos testing MUST be conducted prior to any disturbance works						

B00A - R0007 - Sick Bay (7.53 m2)

Product	Material Description	Extent	Location Reference	Material Condition	Risk Status	Control Priority
Sample No					Test Result	
Ceiling Structures/Linings	Vermiculite 2403/B00A/R0026/Ceiling Structures/Linings/S10					Limited Samples Taken <i>Vermiculite Ceilings may contain asbestos. Asbestos testing MUST be conducted prior to any disturbance works</i>
Floor Coverings Res/Textile	Vinyl Tiles 2403/B00A/R0007/Floor Coverings Res/Textile/S106					No Asbestos Detected
B00A - R0008 - Clerical Office (14.12 m2)						
Ceiling Structures/Linings	Vermiculite 2403/B00A/R0026/Ceiling Structures/Linings/S10					Limited Samples Taken <i>Vermiculite Ceilings may contain asbestos. Asbestos testing MUST be conducted prior to any disturbance works</i>
B00A - R0009 - Entry Vestibule (20.53 m2)						
Ceiling Structures/Linings	Vermiculite 2403/B00A/R0026/Ceiling Structures/Linings/S10					Limited Samples Taken <i>Vermiculite Ceilings may contain asbestos. Asbestos testing MUST be conducted prior to any disturbance works</i>
Floor Coverings Res/Textile	Vinyl Sheet 2403/B00A/R0009/Floor Coverings Res/Textile/S107					No Asbestos Detected
Floor Coverings Res/Textile	Vinyl Tiles (Under Floor Covering/Carpet) 2403/B00A/R0027/Floor Coverings Res/Textile/S12	21m2	All surfaces	Good Condition (1)	Low (1)	Low Priority (2-3) <i>Chrysotile (white asbestos)</i>
B00A - R0010 - Music Store (5.87 m2)						
Ceiling Structures/Linings	Vermiculite 2403/B00A/R0026/Ceiling Structures/Linings/S10					Limited Samples Taken <i>Vermiculite Ceilings may contain asbestos. Asbestos testing MUST be conducted prior to any disturbance works</i>
B00A - R0011 - Movement (58.47 m2)						
Ceiling Structures/Linings	Vermiculite 2403/B00A/R0026/Ceiling Structures/Linings/S10					Limited Samples Taken <i>Vermiculite Ceilings may contain asbestos. Asbestos testing MUST be conducted prior to any disturbance works</i>
B00A - R0012 - General Storeroom (14.43 m2)						
Ceiling Structures/Linings	Vermiculite 2403/B00A/R0026/Ceiling Structures/Linings/S10					Limited Samples Taken <i>Vermiculite Ceilings may contain asbestos. Asbestos testing MUST be conducted prior to any disturbance works</i>
Floor Coverings Res/Textile	Vinyl Tiles 2403/B00A/R0027/Floor Coverings Res/Textile/S12	14m2	All surfaces	Good Condition (1)	Low (1)	Low Priority (2-3) <i>Chrysotile (white asbestos)</i>
B00A - R0013 - Clerical Office (12.22 m2)						
Ceiling Structures/Linings	Vermiculite 2403/B00A/R0026/Ceiling Structures/Linings/S10					Limited Samples Taken <i>Vermiculite Ceilings may contain asbestos. Asbestos testing MUST be conducted prior to any disturbance works</i>
B00A - R0014 - Staff Room Annexe (12.32 m2)						
Ceiling Structures/Linings	Vermiculite 2403/B00A/R0026/Ceiling Structures/Linings/S10					Limited Samples Taken <i>Vermiculite Ceilings may contain asbestos. Asbestos testing MUST be conducted prior to any disturbance works</i>
B00A - R0015 - Staff Toilet (4.87 m2)						
Ceiling Structures/Linings	Vermiculite 2403/B00A/R0026/Ceiling Structures/Linings/S10					Limited Samples Taken <i>Vermiculite Ceilings may contain asbestos. Asbestos testing MUST be conducted prior to any disturbance works</i>
B00A - R0016 - Staff Toilet (5.92 m2)						
Ceiling Structures/Linings	Vermiculite 2403/B00A/R0026/Ceiling Structures/Linings/S10					Limited Samples Taken <i>Vermiculite Ceilings may contain asbestos. Asbestos testing MUST be conducted prior to any disturbance works</i>
Infill panel	Flat AC Sheeting 2403/B00A/R0016/Infill panel/S109	0.5m2	Above north door	Good Condition (1)	Low (1)	Low Priority (2-3) <i>Chrysotile (white asbestos)</i>

Product	Material Description	Extent	Location Reference	Material Condition	Risk Status	Control Priority
Sample No					Test Result	
Bulkhead	Flat AC Sheeting	2m2	North	Good Condition (1)	Low (1)	Low Priority (2-3)
2403/B00A/R0016/Bulkhead/S108					Chrysotile (white asbestos)	
B00A - R0017 - Deputy Principal (12.25 m2)						
Ceiling Structures/Linings	Vermiculite					Limited Samples Taken
2403/B00A/R0026/Ceiling Structures/Linings/S10					Vermiculite Ceilings may contain asbestos. Asbestos testing MUST be conducted prior to any disturbance works	
Bulkhead	Flat AC Sheeting	3m2	North	Good Condition (1)	Low (1)	Low Priority (2-3)
2403/B00A/R0017/Bulkhead/S110					Chrysotile (white asbestos)	
Infill panel	Flat AC Sheeting	0.5m2	Above north door	Good Condition (1)	Low (1)	Low Priority (2-3)
2403/B00A/R0017/Infill panel/S111					Chrysotile (white asbestos)	
B00A - R0018 - Movement (41.99 m2)						
Floor Coverings Res/Textile	Vinyl Sheet					No Asbestos Detected
2403/B00A/R0018/Floor Coverings Res/Textile/S112						
Floor Coverings Res/Textile	Vinyl Tiles (Under Floor Covering/Carpet)	42m2	All surfaces	Good Condition (1)	Low (1)	Low Priority (2-3)
2403/B00A/R0027/Floor Coverings Res/Textile/S12					Chrysotile (white asbestos)	
Ceiling Structures/Linings	Vermiculite					Limited Samples Taken
2403/B00A/R0026/Ceiling Structures/Linings/S10					Vermiculite Ceilings may contain asbestos. Asbestos testing MUST be conducted prior to any disturbance works	
B00A - R0019 - Movement (1.24 m2)						
No Asbestos						
B00A - R0020 - Distribution Board (0.37 m2)						
No Asbestos						
B00A - R0021 - Canteen (42.13 m2)						
Ceiling Structures/Linings	Vermiculite					Limited Samples Taken
2403/B00A/R0026/Ceiling Structures/Linings/S10					Vermiculite Ceilings may contain asbestos. Asbestos testing MUST be conducted prior to any disturbance works	
Floor Coverings Res/Textile	Vinyl Sheet					No Asbestos Detected
2403/B00A/R0021/Floor Coverings Res/Textile/S113						
Floor Coverings Res/Textile	Vinyl Tiles (Under Floor Covering/Carpet)	42m2	All surfaces	Good Condition (1)	Low (1)	Low Priority (2-3)
2403/B00A/R0027/Floor Coverings Res/Textile/S12					Chrysotile (white asbestos)	
B00A - R0022 - Canteen Office/Store (3.12 m2)						
Ceiling Structures/Linings	Vermiculite					Limited Samples Taken
2403/B00A/R0026/Ceiling Structures/Linings/S10					Vermiculite Ceilings may contain asbestos. Asbestos testing MUST be conducted prior to any disturbance works	
Floor Coverings Res/Textile	Vinyl Tiles (Under Floor Covering/Carpet)	3m2	All surfaces	Good Condition (1)	Low (1)	Low Priority (2-3)
2403/B00A/R0027/Floor Coverings Res/Textile/S12					Chrysotile (white asbestos)	
Floor Coverings Res/Textile	Vinyl Sheet					No Asbestos Detected
2403/B00A/R0022/Floor Coverings Res/Textile/S114						
B00A - R0023 - Staff Toilet (3.64 m2)						
Ceiling Structures/Linings	Vermiculite					Limited Samples Taken
2403/B00A/R0026/Ceiling Structures/Linings/S10					Vermiculite Ceilings may contain asbestos. Asbestos testing MUST be conducted prior to any disturbance works	
B00A - R0024 - Canteen Office/Store (7.26 m2)						
Ceiling Structures/Linings	Vermiculite					Limited Samples Taken
2403/B00A/R0026/Ceiling Structures/Linings/S10					Vermiculite Ceilings may contain asbestos. Asbestos testing MUST be conducted prior to any disturbance works	

Product	Material Description	Extent	Location Reference	Material Condition	Risk Status	Control Priority
Sample No					Test Result	
Floor Coverings Res/Textile	Vinyl Tiles (Under Floor Covering/Carpet) 2403/B00A/R0027/Floor Coverings Res/Textile/S12	7m2	All surfaces	Good Condition (1)	Low (1)	Low Priority (2-3) Chrysotile (white asbestos)
Floor Coverings Res/Textile	Vinyl Sheet 2403/B00A/R0024/Floor Coverings Res/Textile/S18					No Asbestos Detected
B00A - R0026 - Movement (128.49 m2)						
Ceiling Structures/Linings	Vermiculite 2403/B00A/R0026/Ceiling Structures/Linings/S10					Limited Samples Taken Vermiculite Ceilings may contain asbestos. Asbestos testing MUST be conducted prior to any disturbance works
B00A - R0027 - General Storeroom (7.88 m2)						
Floor Coverings Res/Textile	Vinyl Tiles 2403/B00A/R0027/Floor Coverings Res/Textile/S12	8m2	All surfaces	Good Condition (1)	Low (1)	Low Priority (2-3) Chrysotile (white asbestos)
B00A - R0028 - Sports Store (10.53 m2)						
Boxing to Door Housing	Flat AC Sheeting 2403/B00A/R0028/Boxing to Door Housing/S11	11m2	Upper portion	Some Damage / Unsealed (3)	Low (1)	Medium Priority (4-5) Chrysotile (white asbestos) , Amosite (brown asbestos)
B00A - R0029 - Garden Store (10.59 m2)						
No Asbestos						
B00A - R0030 - Garden Store (5.91 m2)						
No Asbestos						
B00A - R0031 - Movement (5.5 m2)						
No Asbestos						
B00A - R0032 - Toilets - Boys (12.96 m2)						
Ceiling Structures/Linings	Vermiculite 2403/B00A/R0026/Ceiling Structures/Linings/S10					Limited Samples Taken Vermiculite Ceilings may contain asbestos. Asbestos testing MUST be conducted prior to any disturbance works
Bulkhead	Flat AC Sheeting 2403/B00A/R0032/Bulkhead/S19	4m2	North, East and South walls	Good Condition (1)	Low (1)	Low Priority (2-3) Chrysotile (white asbestos) , Amosite (brown asbestos)
B00A - R0033 - Shower/Change (31.38 m2)						
Ceiling Structures/Linings	Vermiculite 2403/B00A/R0026/Ceiling Structures/Linings/S10					Limited Samples Taken Vermiculite Ceilings may contain asbestos. Asbestos testing MUST be conducted prior to any disturbance works
B00A - R0034 - Shower/Change (31.38 m2)						
Ceiling Structures/Linings	Vermiculite 2403/B00A/R0026/Ceiling Structures/Linings/S10					Limited Samples Taken Vermiculite Ceilings may contain asbestos. Asbestos testing MUST be conducted prior to any disturbance works
B00A - R0035 - Movement (82.27 m2)						
No Asbestos						
B00A - R0036 - Movement (64.61 m2)						
No Asbestos						
B00A - R0037 - Movement (141.36 m2)						
No Asbestos						
B00A - R0038 - Stairs (12.03 m2)						
Ceiling Structures/Linings	Flat AC Sheeting 2403/B00A/R1029/Ceiling Structures/Linings/S13					No Asbestos Detected
B00A - R0039 - Stairs (4.79 m2)						
No Asbestos						
B00A - R0040 - Stairs (5.07 m2)						
No Asbestos						

Product	Material Description	Extent	Location Reference	Material Condition	Risk Status	Control Priority
Sample No					Test Result	
B00A - R1001 - Reading Area (263.09 m2)						
No Asbestos						
B00A - R1002 - Toilets - Girls (8.03 m2)						
Ceiling Structures/Linings	Flat AC Sheeting	9m2	All surfaces	Good Condition (1)	Low (1)	Low Priority (2-3)
2403/B00A/R1002/Ceiling Structures/Linings/S20					Chrysotile (white asbestos)	
B00A - R1003 - Toilets - Boys (8.03 m2)						
Ceiling Structures/Linings	Flat AC Sheeting	9m2	All surfaces	Good Condition (1)	Low (1)	Low Priority (2-3)
2403/B00A/R1003/Ceiling Structures/Linings/S21					Chrysotile (white asbestos)	
B00A - R1004 - Distribution Board (1.39 m2)						
					Note: No inspection of live electrical installation.	
No Asbestos						
B00A - R1005 - Cleaning Distributed Store (1.39 m2)						
No Asbestos						
B00A - R1006 - Movement (11.69 m2)						
No Asbestos						
B00A - R1007 - Library Office/Workroom (7.3 m2)						
No Asbestos						
B00A - R1008 - Library Office/Workroom (20.95 m2)						
Floor Coverings Res/Textile	Vinyl Tiles	21m2	All surfaces	Good Condition (1)	Low (1)	Low Priority (2-3)
2403/B00A/R0027/Floor Coverings Res/Textile/S12					Chrysotile (white asbestos)	
B00A - R1009 - Communications Room (14.06 m2)						
Floor Coverings Res/Textile	Vinyl Tiles	15m2	All surfaces	Good Condition (1)	Low (1)	Low Priority (2-3)
2403/B00A/R0027/Floor Coverings Res/Textile/S12					Chrysotile (white asbestos)	
B00A - R1010 - Movement (4.13 m2)						
Floor Coverings Res/Textile	Vinyl Tiles	5m2	All surfaces	Good Condition (1)	Low (1)	Low Priority (2-3)
2403/B00A/R0027/Floor Coverings Res/Textile/S12					Chrysotile (white asbestos)	
B00A - R1011 - General Storeroom (16.56 m2)						
Floor Coverings Res/Textile	Vinyl Tiles	17m2	All surfaces	Good Condition (1)	Low (1)	Low Priority (2-3)
2403/B00A/R0027/Floor Coverings Res/Textile/S12					Chrysotile (white asbestos)	
B00A - R1012 - K.L.A. Store (19.12 m2)						
No Asbestos						
B00A - R1013 - Seminar/Study (18.86 m2)						
No Asbestos						
B00A - R1014 - Communications Room (18.51 m2)						
No Asbestos						
B00A - R1015 - Distribution Board (0.7 m2)						
					Note: No inspection of live electrical installation.	
Wall Linings Internal	Flat AC Sheeting	1m2	West, upper	Good Condition (1)	Low (1)	Low Priority (2-3)
2403/B00A/R1015/Wall Linings Internal/S22					Chrysotile (white asbestos) , Amosite (brown asbestos)	
B00A - R1019 - Home Base (56.27 m2)						
No Asbestos						
B00A - R1020 - Practical Activities - 1hb (20.5 m2)						
Floor Coverings Res/Textile	Vinyl Tiles	21m2	All surfaces	Good Condition (1)	Low (1)	Low Priority (2-3)
2403/B00A/R0027/Floor Coverings Res/Textile/S12					Chrysotile (white asbestos)	
B00A - R1021 - Movement (81.12 m2)						

Product	Material Description	Extent	Location Reference	Material Condition	Risk Status	Control Priority
Sample No					Test Result	
Ceiling Structures/Linings	Flat AC Sheeting	82m2	All surfaces	Good Condition (1)	Low (1)	Low Priority (2-3)
2403/B00A/R1021/Ceiling Structures/Linings/S23				Chrysotile (white asbestos) , Amosite (brown asbestos)		

B00A - R1022 - Home Base (49.88 m2)

No Asbestos

B00A - R1023 - Home Base Store (1.35 m2)

No Asbestos

B00A - R1024 - Practical Activities - 1hb (16.96 m2)

Floor Coverings Res/Textile	Vinyl Tiles	8m2	All surfaces	Good Condition (1)	Low (1)	Low Priority (2-3)
2403/B00A/R0027/Floor Coverings Res/Textile/S12				Chrysotile (white asbestos)		

B00A - R1025 - Toilets - Girls (12.1 m2)

Ceiling Structures/Linings	Flat AC Sheeting	2403/B00A/R1025/Ceiling Structures/Linings/S1		No Asbestos Detected		
----------------------------	------------------	---	--	-----------------------------	--	--

B00A - R1026 - Practical Activities - 1hb (16.96 m2)

Floor Coverings Res/Textile	Vinyl Tiles	17m2	All surfaces	Good Condition (1)	Low (1)	Low Priority (2-3)
2403/B00A/R0027/Floor Coverings Res/Textile/S12				Chrysotile (white asbestos)		

B00A - R1027 - Home Base (49.88 m2)

No Asbestos

B00A - R1028 - Home Base Store (1.35 m2)

No Asbestos

B00A - R1029 - Movement (171.33 m2)

Floor Coverings Res/Textile	Vinyl Tiles	172m2	All surfaces	Good Condition (1)	Low (1)	Low Priority (2-3)
2403/B00A/R0027/Floor Coverings Res/Textile/S12				Chrysotile (white asbestos)		

Ceiling Structures/Linings	Flat AC Sheeting	2403/B00A/R1029/Ceiling Structures/Linings/S13		No Asbestos Detected		
----------------------------	------------------	--	--	-----------------------------	--	--

B00A - R1030 - Stairs (17.22 m2)

Ceiling Structures/Linings	Flat AC Sheeting	2403/B00A/R1029/Ceiling Structures/Linings/S13		No Asbestos Detected		
----------------------------	------------------	--	--	-----------------------------	--	--

B00A - R1031 - Home Base (69.3 m2)

No Asbestos

B00A - R1032 - Stairs (15.12 m2)

Ceiling Structures/Linings	Flat AC Sheeting	2403/B00A/R1029/Ceiling Structures/Linings/S13		No Asbestos Detected		
----------------------------	------------------	--	--	-----------------------------	--	--

2017

Product	Material Description	Extent	Location Reference	Material Condition	Risk Status	Control Priority
Sample No				Test Result		

B00B - General Learning - 1903 - Brick/Block (Brick/Block)**Exterior**

Ceiling Voids - Flat Roof	Non Accessible Area - Area inaccessible Height Restriction <3.5m					
Eaves Linings	Flat AC Sheeting 2403/B00B/Eaves Linings/S101					No Asbestos Detected
Underfloor Voids	Flat AC Sheeting 2403/B00B/Underfloor Voids/S151					No Asbestos Detected
Bulkhead	Flat AC Sheeting	4m2	North, central, outside R1006, Between roof levels	Good Condition (1)	Low (1)	Low Priority (2-3)
Assumed Asbestos - Could not be sampled, height						

Interior**B00B - R0001 - Home Base (50.47 m2)**

Floor Coverings Res/Textile	Vinyl Tiles (Under Floor Covering/Carpet) 2403/B00A/R0027/Floor Coverings Res/Textile/S12	50m2	All surfaces	Good Condition (1)	Low (1)	Low Priority (2-3)
Chrysotile (white asbestos)						

B00B - R0002 - Home Base (51.46 m2)

Floor Coverings Res/Textile	Vinyl Tiles (Under Floor Covering/Carpet) 2403/B00A/R0027/Floor Coverings Res/Textile/S12	51m2	All surfaces	Good Condition (1)	Low (1)	Low Priority (2-3)
Chrysotile (white asbestos)						

Floor Coverings Res/Textile	Vinyl Sheet 2403/B00B/R0002/Floor Coverings Res/Textile/S110					No Asbestos Detected
-----------------------------	---	--	--	--	--	-----------------------------

B00B - R0004 - Practical Activities - 1hb (14.68 m2)

Floor Coverings Res/Textile	Vinyl Sheet 2403/B00B/R0004/Floor Coverings Res/Textile/S111					No Asbestos Detected
-----------------------------	---	--	--	--	--	-----------------------------

Floor Coverings Res/Textile	Vinyl Tiles (Under Floor Covering/Carpet) 2403/B00A/R0027/Floor Coverings Res/Textile/S12	15m2	All surfaces	Good Condition (1)	Low (1)	Low Priority (2-3)
Chrysotile (white asbestos)						

B00B - R0005 - Home Base (79.43 m2)

No Asbestos

B00B - R0006 - Cleaning Distributed Store (1.85 m2)

No Asbestos

B00B - R0007 - Uniform Shop (15.18 m2)

Floor Coverings Res/Textile	Vinyl Tiles (Under Floor Covering/Carpet) 2403/B00B/R0007/Floor Coverings Res/Textile/S113					No Asbestos Detected
-----------------------------	---	--	--	--	--	-----------------------------

Ceiling Structures/Linings	Flat AC Sheeting 2403/B00B/R0007/Ceiling Structures/Linings/S112	15m2	Throughout	Good Condition (1)	Low (1)	Low Priority (2-3)
Chrysotile (white asbestos)						

B00B - R0008 - Staff Room Annexe (12.27 m2)

Floor Coverings Res/Textile	Vinyl Tiles (Under Floor Covering/Carpet) 2403/B00B/R0008/Floor Coverings Res/Textile/S114					No Asbestos Detected
-----------------------------	---	--	--	--	--	-----------------------------

B00B - R0009 - Toilets - Girls (11.81 m2)

Ceiling Structures/Linings	Flat AC Sheeting 2403/B00B/R0009/Ceiling Structures/Linings/S115	12m2	All surfaces	Good Condition (1)	Low (1)	Low Priority (2-3)
Chrysotile (white asbestos)						

B00B - R0010 - No Access (3.87 m2)

No Asbestos

B00B - R0011 - Toilets - Boys (11.74 m2)

No Asbestos

Product	Material Description	Extent	Location Reference	Material Condition	Risk Status	Control Priority
Sample No					Test Result	
B00B - R0012 - Movement (12.88 m2)						
No Asbestos						
B00B - R0013 - Movement (66.68 m2)						
Floor Coverings Res/Textile	Vinyl Sheet					
	2403/B00B/R0013/Floor Coverings Res/Textile/S116					No Asbestos Detected
B00B - R0014 - Stairs (3.11 m2)						
Floor Coverings Res/Textile	Vinyl Sheet					
	2403/B00B/R0014/Floor Coverings Res/Textile/S117					No Asbestos Detected
B00B - R0015 - Movement (1.13 m2)						
Floor Coverings Res/Textile	Vinyl Sheet					
	2403/B00B/R0015/Floor Coverings Res/Textile/S118					No Asbestos Detected
B00B - R0016 - Stairs (5.77 m2)						
Floor Coverings Res/Textile	Vinyl Sheet					
	2403/B00B/R0016/Floor Coverings Res/Textile/S119					No Asbestos Detected
B00B - R0017 - Stairs (6.82 m2)						
No Asbestos						
B00B - R1001 - Home Base (50.95 m2)						
Floor Coverings Res/Textile	Vinyl Tiles (Under Floor Covering/Carpet)	51m2	All surfaces	Good Condition (1)	Low (1)	Low Priority (2-3)
	2403/B00A/R0027/Floor Coverings Res/Textile/S12					Chrysotile (white asbestos)
B00B - R1002 - Home Base (51.99 m2)						
Floor Coverings Res/Textile	Vinyl Tiles (Under Floor Covering/Carpet)	52m2	All surfaces	Good Condition (1)	Low (1)	Low Priority (2-3)
	2403/B00A/R0027/Floor Coverings Res/Textile/S12					Chrysotile (white asbestos)
Bench top	Vinyl Sheet					
	2403/B00B/R1002/Bench top/S120					No Asbestos Detected
B00B - R1006 - General Storeroom (12.17 m2)						
Floor Coverings Res/Textile	Vinyl Sheet					
	2403/B00B/R1006/Floor Coverings Res/Textile/S121					No Asbestos Detected
B00B - R1007 - Craft Store (7.81 m2)						
Floor Coverings Res/Textile	Vinyl Sheet					
	2403/B00B/R1007/Floor Coverings Res/Textile/S123					No Asbestos Detected
Floor Coverings Res/Textile	Vinyl Tiles (Under Floor Covering/Carpet)					
	2403/B00B/R1007/Floor Coverings Res/Textile/S122					No Asbestos Detected
Floor Coverings Res/Textile	Vinyl Tiles (Under Floor Covering/Carpet)					
	2403/B00B/R1007/Floor Coverings Res/Textile/S124					No Asbestos Detected
B00B - R1008 - Movement (70.29 m2)						
Floor Coverings Res/Textile	Vinyl Sheet					
	2403/B00B/R1008/Floor Coverings Res/Textile/S125					No Asbestos Detected
B00B - R1009 - Stairs (15.93 m2)						
Floor Coverings Res/Textile	Vinyl Sheet					
	2403/B00B/R1009/Floor Coverings Res/Textile/S126					No Asbestos Detected
B00B - R1010 - Stairs (13.44 m2)						
Floor Coverings Res/Textile	Vinyl Sheet					
	2403/B00B/R1010/Floor Coverings Res/Textile/S127					No Asbestos Detected

Product	Material Description	Extent	Location Reference	Material Condition	Risk Status	Control Priority
Sample No					Test Result	

B00B - R1011 - Home Base (93.26 m2)

No Asbestos

B00B - R1012 - Practical Activity Area (1.95 m2)

Floor Coverings Res/Textile	Vinyl Tiles	2m2	All surfaces	Good Condition (1)	Low (1)	Low Priority (2-3)
2403/B00A/R0027/Floor Coverings Res/Textile/S12					Chrysotile (white asbestos)	

2017

Product	Material Description	Extent	Location Reference	Material Condition	Risk Status	Control Priority
Sample No					Test Result	

B00C - General Learning - 1976 - Timber (Timber)

Exterior

Underfloor Voids - Packing to Floor Joists No Asbestos Found

Ceiling Voids - Flat Roof No Asbestos Found

Interior

B00C - R0001 - Home Base (52.77 m2)

No Asbestos

B00C - R0002 - Home Base (52.85 m2)

No Asbestos

B00C - R0003 - General Storeroom (5.89 m2)

No Asbestos

B00C - R0004 - Movement (28.96 m2)

No Asbestos

2017

Product	Material Description	Extent	Location Reference	Material Condition	Risk Status	Control Priority
Sample No					Test Result	

B00D - Communal Facilities - 1903 - Brick/Block (Brick/Block)

Exterior

Underfloor Voids - Slab on Ground	Non Accessible Area - Area inaccessible
Underfloor Voids - Packing to Floor Joists	Non Accessible Area - Area inaccessible no void hatch located.
Ceiling Voids - Flat Roof	Non Accessible Area - Area inaccessible void hatch not located.

Interior

B00D - R0003 - Movement (3.94 m2)						
No Asbestos						
B00D - R0004 - Staff Toilet (1.71 m2)						
No Asbestos						
B00D - R0005 - Movement (3.14 m2)						
No Asbestos						
B00D - R0006 - General Storeroom (5.98 m2)						
No Asbestos						
B00D - R0007 - Raised Platform (48.79 m2)						
No Asbestos						
B00D - R0008 - Movement (3.16 m2)						
No Asbestos						
B00D - R0009 - Store (6.01 m2)						
No Asbestos						
B00D - R0010 - Staff Toilet (1.71 m2)						
No Asbestos						
B00D - R0012 - Movement (3.94 m2)						
No Asbestos						
B00D - R0013 - Movement (6.27 m2)						
No Asbestos						
B00D - R0014 - Movement (6.27 m2)						
No Asbestos						
B00D - R0015 - Communal Space (212.73 m2)						
No Asbestos						
B00D - R0016 - Covered Outdoor Learning Area (156.32 m2)						
No Asbestos						
B00D - R9001 - General Storeroom (1.91 m2)						
No Asbestos						
B00D - R9002 - Movement (2.96 m2)						
Floor Coverings Res/Textile	Vinyl Tiles	3m2	All surfaces	Good Condition (1)	Low (1)	Low Priority (2-3)
2403/B00D/R9002/Floor Coverings Res/Textile/S16					Chrysotile (white asbestos)	
B00D - R9003 - Craft Store (6.07 m2)						
Floor Coverings Res/Textile	Vinyl Tiles	7m2	All surfaces	Good Condition (1)	Low (1)	Low Priority (2-3)
2403/B00D/R9002/Floor Coverings Res/Textile/S16					Chrysotile (white asbestos)	
B00D - R9004 - Special Programs Room (46.74 m2)						
Floor Coverings Res/Textile	Vinyl Tiles	47m2	All surfaces	Good Condition (1)	Low (1)	Low Priority (2-3)
2403/B00D/R9002/Floor Coverings Res/Textile/S16					Chrysotile (white asbestos)	

Product	Material Description	Extent	Location Reference	Material Condition	Risk Status	Control Priority
Sample No					Test Result	

B00D - R9005 - Craft Store (3.99 m2)

No Asbestos

B00D - R9006 - General Storeroom (9.24 m2)

No Asbestos

2017

Product	Material Description	Extent	Location Reference	Material Condition	Risk Status	Control Priority
Sample No					Test Result	

B00E - General Learning - 1976 - Timber (Timber)

Exterior

Underfloor Voids - Packing to Floor Joists	No Asbestos Found					
Ceiling Voids - Flat Roof	Non Accessible Area - Height Restriction <3.3m					
Eaves Linings	Flat AC Sheeting	60m2	East facing, West facing	Good Condition (1)	Low (1)	Low Priority (2-3)
	2403/B00E/Eaves Linings/S100			Chrysotile (white asbestos) , Amosite (brown asbestos)		

Interior

B00E - R0001 - Home Base (53.88 m2)

No Asbestos

B00E - R0002 - Home Base Store (5.17 m2)

Ceiling Structures/Linings	Flat AC Sheeting	6m2	All surfaces	Good Condition (1)	Low (1)	Low Priority (2-3)
	2403/B00E/R0002/Ceiling Structures/Linings/S14			Chrysotile (white asbestos) , Amosite (brown asbestos)		

B00E - R0004 - Movement (26.59 m2)

Ceiling Structures/Linings	Flat AC Sheeting	28m2	All surfaces	Good Condition (1)	Low (1)	Low Priority (2-3)
	2403/B00E/R0002/Ceiling Structures/Linings/S14			Chrysotile (white asbestos) , Amosite (brown asbestos)		

B00E - R0005 - Special Programs Room (53.88 m2)

Floor Coverings Res/Textile	Vinyl Tiles (Under Floor Covering/Carpet)					
	2403/B00E/R0005/Floor Coverings Res/Textile/S136			No Asbestos Detected		

B00E - R0006 - General Storeroom (3.15 m2)

Ceiling Structures/Linings	Flat AC Sheeting	4m2	All surfaces	Good Condition (1)	Low (1)	Low Priority (2-3)
	2403/B00E/R0002/Ceiling Structures/Linings/S14			Chrysotile (white asbestos) , Amosite (brown asbestos)		
Floor Coverings Res/Textile	Vinyl Sheet					
	2403/B00E/R0006/Floor Coverings Res/Textile/S137			No Asbestos Detected		

B00E - R0007 - Home Base Store (18.97 m2)

Ceiling Structures/Linings	Flat AC Sheeting	19m2	All surfaces	Good Condition (1)	Low (1)	Low Priority (2-3)
	2403/B00E/R0002/Ceiling Structures/Linings/S14			Chrysotile (white asbestos) , Amosite (brown asbestos)		
Floor Coverings Res/Textile	Vinyl Tiles (Under Floor Covering/Carpet)					
	2403/B00E/R0007/Floor Coverings Res/Textile/S138			No Asbestos Detected		

B00E - R0008 - General Storeroom (5.19 m2)

Ceiling Structures/Linings	Flat AC Sheeting	6m2	All surfaces	Good Condition (1)	Low (1)	Low Priority (2-3)
	2403/B00E/R0002/Ceiling Structures/Linings/S14			Chrysotile (white asbestos) , Amosite (brown asbestos)		
Floor Coverings Res/Textile	Vinyl Tiles					
	2403/B00E/R0008/Floor Coverings Res/Textile/S15			Chrysotile (white asbestos)		

Product	Material Description	Extent	Location Reference	Material Condition	Risk Status	Control Priority
Sample No					Test Result	

B00F - General Learning - 1976 - Brick/Veneer (Brick/Veneer)

Exterior

Underfloor Voids - Packing to Floor Joists	No Asbestos Found
Ceiling Voids - Flat Roof	Non Accessible Area - Height Restriction <3.3m

Interior

B00F - R0001 - Home Base (56.92 m2)

No Asbestos

B00F - R0002 - Home Base Store (10.32 m2)

Ceiling Structures/Linings	Flat AC Sheeting 2403/B00F/R0002/Ceiling Structures/Linings/S139					No Asbestos Detected
----------------------------	---	--	--	--	--	-----------------------------

B00F - R0003 - Cleaning Distributed Store (2.64 m2)

No Asbestos

B00F - R0004 - General Storeroom (0.77 m2)

No Asbestos

B00F - R0005 - Staff Room Annexe (13.8 m2)

Floor Coverings Res/Textile	Vinyl Tiles (Under Floor Covering/Carpet) 2403/B00F/R0005/Floor Coverings Res/Textile/S140					No Asbestos Detected
-----------------------------	---	--	--	--	--	-----------------------------

B00F - R0006 - Distribution Board (0.71 m2)

Note: No inspection of live electrical installation.

No Asbestos

B00F - R0007 - Movement (29.52 m2)

Floor Coverings Res/Textile	Vinyl Sheet 2403/B00F/R0007/Floor Coverings Res/Textile/S141					No Asbestos Detected
-----------------------------	---	--	--	--	--	-----------------------------

Infill panel	Flat AC Sheeting	1m2	Above both east and west doors	Good Condition (1)	Low (1)	Low Priority (2-3)
	2403/B00F/R0007/Infill panel/S142					Chrysotile (white asbestos) , Amosite (brown asbestos)

B00F - R0008 - Movement (4.95 m2)

Ceiling Structures/Linings	Flat AC Sheeting	5m2	All surfaces	Good Condition (1)	Low (1)	Low Priority (2-3)
	2403/B00F/R0015/Ceiling Structures/Linings/S8					Chrysotile (white asbestos) , Amosite (brown asbestos)

B00F - R0009 - Home Base Store (10.44 m2)

No Asbestos

B00F - R0010 - Home Base (57.47 m2)

No Asbestos

B00F - R0011 - Home Base (71.82 m2)

No Asbestos

B00F - R0012 - Home Base Store (13.88 m2)

No Asbestos

B00F - R0014 - Toilets - Boys/Girls (3.4 m2)

Wall Linings Internal	Flat AC Sheeting	8m2	All surfaces	Good Condition (1)	Low (1)	Low Priority (2-3)
	2403/B00F/R0014/Wall Linings Internal/S9					Chrysotile (white asbestos) , Amosite (brown asbestos)

Ceiling Structures/Linings	Flat AC Sheeting	4m2	All surfaces	Good Condition (1)	Low (1)	Low Priority (2-3)
	2403/B00F/R0015/Ceiling Structures/Linings/S8					Chrysotile (white asbestos) , Amosite (brown asbestos)

B00F - R0015 - Movement (5.52 m2)

Product	Material Description	Extent	Location Reference	Material Condition	Risk Status	Control Priority
Sample No					Test Result	
Ceiling Structures/Linings	Flat AC Sheeting	6m2	All surfaces	Good Condition (1)	Low (1)	Low Priority (2-3)
2403/B00F/R0015/Ceiling Structures/Linings/S8				Chrysotile (white asbestos) , Amosite (brown asbestos)		
High Level Gable Panel	Flat AC Sheeting	2m2	North facing	Good Condition (1)	Low (1)	Low Priority (2-3)
2403/B00F/R0015/Ceiling Structures/Linings/S8				Chrysotile (white asbestos) , Amosite (brown asbestos)		
B00F - R0016 - Movement (16.29 m2)						
No Asbestos						
B00F - R0017 - Toilets - Boys/Girls (3.62 m2)						
No Asbestos						
B00F - R0018 - Home Base (86.64 m2)						
No Asbestos						
B00F - R0019 - Movement (52.1 m2)						
No Asbestos						
B00F - R0021 - Movement (102.3 m2)						
No Asbestos						
B00F - R9001 - Sports Store (69.89 m2)						
Floor Coverings Res/Textile	Vinyl Sheet					
2403/B00F/R9001/Floor Coverings Res/Textile/S128				No Asbestos Detected		

2017

Product	Material Description	Extent	Location Reference	Material Condition	Risk Status	Control Priority
Sample No					Test Result	

B00G - General Learning - 2011 - Brick/Veneer (Brick/Veneer)**Exterior**

Underfloor Voids - Packing to Floor Joists No Asbestos Found

Ceiling Voids No Asbestos Found

Interior**B00G - R0001 - Home Base (60.88 m2)**

No Asbestos

B00G - R0002 - Home Base (60.88 m2)

No Asbestos

B00G - R0003 - Home Base Store (6.12 m2)

No Asbestos

B00G - R0004 - Practical Activities - 1hb (18.8 m2)

No Asbestos

B00G - R0005 - Withdrawal Space - 2hb (11.51 m2)

No Asbestos

B00G - R0006 - Practical Activities - 1hb (18.91 m2)

No Asbestos

B00G - R0007 - Home Base Store (6.12 m2)

No Asbestos

B00G - R0008 - General Storeroom (4.15 m2)

No Asbestos

B00G - R0009 - External Movement (67.96 m2)

No Asbestos

B00G - R0010 - Stairs (4.47 m2)

No Asbestos

B00G - R0011 - Stairs (14.04 m2)

No Asbestos

B00G - R0012 - Stairs (11.91 m2)

No Asbestos

B00G - R1001 - Home Base (60.88 m2)

No Asbestos

B00G - R1002 - Home Base (60.78 m2)

No Asbestos

B00G - R1003 - Home Base Store (6.12 m2)

No Asbestos

B00G - R1004 - Practical Activities - 1hb (18.65 m2)

No Asbestos

B00G - R1005 - Withdrawal Space - 2hb (11.51 m2)

No Asbestos

B00G - R1006 - Practical Activities - 1hb (18.7 m2)

No Asbestos

B00G - R1007 - Home Base Store (6.12 m2)

No Asbestos

B00G - R1008 - External Movement (67.96 m2)

No Asbestos

B00G - R1009 - External Stairs (18.45 m2)

No Asbestos

Product	Material Description	Extent	Location Reference	Material Condition	Risk Status	Control Priority
Sample No					Test Result	
B00G - R1010 - External Stairs (18.98 m2)						
No Asbestos						
B00G - R9001 - Home Base (58.58 m2)						
No Asbestos						
B00G - R9002 - Practical Activities - 1hb (18.65 m2)						
No Asbestos						
B00G - R9003 - Home Base Store (5.95 m2)						
No Asbestos						
B00G - R9004 - Withdrawal Space - 1hb (8.81 m2)						
No Asbestos						
B00G - R9005 - General Storeroom (3.8 m2)						
No Asbestos						
B00G - R9006 - External Movement (35.15 m2)						
No Asbestos						
B00G - R9007 - External Movement (14.93 m2)						
No Asbestos						
B00G - R9008 - Stairs (14.34 m2)						
No Asbestos						

2017

Product	Material Description	Extent	Location Reference	Material Condition	Risk Status	Control Priority
Sample No					Test Result	

B00H - General Learning - 1976 - Brick/Block (Brick/Block)

Exterior

Ceiling Voids - Flat Roof	Non Accessible Area - Area inaccessible Height Restriction <3-3m.					
Underfloor Voids - Packing to Floor Joists	Non Accessible Area - Area inaccessible no void hatch located.					
Eaves Linings	Flat AC Sheeting 2403/B00H/Eaves Linings/S106	200m2	North facing, South facing	Good Condition (1)	Low (1)	Low Priority (2-3) Chrysotile (white asbestos) , Amosite (brown asbestos)
Base of overhead walkway	Flat AC Sheeting 2403/B00H/Base of overhead walkway/S105					No Asbestos Detected

Interior

B00H - R0001 - Home Base (57.67 m2)

No Asbestos

B00H - R0002 - Home Base Store (4.99 m2)

No Asbestos

B00H - R0003 - Home Base Store (11.5 m2)

Floor Coverings Res/Textile	Vinyl Tiles 2403/B00H/R0003/Floor Coverings Res/Textile/S144					No Asbestos Detected
-----------------------------	---	--	--	--	--	-----------------------------

B00H - R0005 - Movement (5.64 m2)

Infill Panels	Flat AC Sheeting 2403/B00H/R0005/Infill Panels/S145	0.5m2	East, above door	Good Condition (1)	Low (1)	Low Priority (2-3) Chrysotile (white asbestos) , Amosite (brown asbestos)
---------------	--	-------	------------------	--------------------	---------	---

B00H - R0006 - Movement (4.56 m2)

Ceiling Structures/Linings	Flat AC Sheeting 2403/B00H/R0006/Ceiling Structures/Linings/S7	5m2	All surfaces	Good Condition (1)	Low (1)	Low Priority (2-3) Chrysotile (white asbestos) , Amosite (brown asbestos)
----------------------------	---	-----	--------------	--------------------	---------	---

B00H - R0007 - Home Base Store (4.99 m2)

No Asbestos

B00H - R0008 - Home Base (57.28 m2)

No Asbestos

B00H - R0009 - Home Base (57.28 m2)

No Asbestos

B00H - R0010 - Home Base Store (4.99 m2)

No Asbestos

B00H - R0011 - Home Base Store (11.5 m2)

Floor Coverings Res/Textile	Vinyl Tiles 2403/B00H/R0011/Floor Coverings Res/Textile/S146					No Asbestos Detected
-----------------------------	---	--	--	--	--	-----------------------------

B00H - R0012 - Movement (5.64 m2)

Infill Panels	Flat AC Sheeting 2403/B00H/R0012/Infill Panels/S147					No Asbestos Detected
---------------	--	--	--	--	--	-----------------------------

B00H - R0013 - Movement (4.56 m2)

Ceiling Structures/Linings	Flat AC Sheeting 2403/B00H/R0006/Ceiling Structures/Linings/S7	5m2	All surfaces	Good Condition (1)	Low (1)	Low Priority (2-3) Chrysotile (white asbestos) , Amosite (brown asbestos)
----------------------------	---	-----	--------------	--------------------	---------	---

B00H - R0014 - Home Base Store (4.99 m2)

Product	Material Description	Extent	Location Reference	Material Condition	Risk Status	Control Priority
Sample No					Test Result	
No Asbestos						
B00H - R0015 - Home Base (57.04 m2)						
No Asbestos						
B00H - R0016 - Movement (1.38 m2)						
Ceiling Structures/Linings	Flat AC Sheeting	1.4m2	All surfaces	Good Condition (1)	Low (1)	Low Priority (2-3)
2403/B00H/R0006/Ceiling Structures/Linings/S7				Chrysotile (white asbestos) , Amosite (brown asbestos)		
B00H - R0017 - Movement (22.65 m2)						
No Asbestos						
B00H - R0018 - Home Base (57.51 m2)						
No Asbestos						
B00H - R0019 - Home Base Store (7.65 m2)						
No Asbestos						
B00H - R0020 - Home Base Store (7.24 m2)						
No Asbestos						
B00H - R9001 - Out Of School Hours Care Centre (70.17 m2)						
Floor Coverings Res/Textile	Vinyl Sheet					
2403/B00H/R9001/Floor Coverings Res/Textile/S148				No Asbestos Detected		
B00H - R9002 - Out Of School Hours Care Centre (77.27 m2)						
Floor Coverings Res/Textile	Vinyl Sheet					
2403/B00H/R9002/Floor Coverings Res/Textile/S150				No Asbestos Detected		
Ceiling Structures/Linings	Flat AC Sheeting					
2403/B00H/R9002/Ceiling Structures/Linings/S149				No Asbestos Detected		
B00H - R9003 - Special Programs Room (21.12 m2)						
Floor Coverings Res/Textile	Vinyl Tiles	6m2	All surfaces	Good Condition (1)	Low (1)	Low Priority (2-3)
2403/B00H/R9005/Floor Coverings Res/Textile/S6				Chrysotile (white asbestos)		
Floor Coverings Res/Textile	Vinyl Tiles (Under Floor Covering/Carpet)	15m2	All surfaces	Good Condition (1)	Low (1)	Low Priority (2-3)
2403/B00H/R9005/Ceiling Structures/Linings/S5				Chrysotile (white asbestos)		
B00H - R9004 - Craft Store (9.91 m2)						
Floor Coverings Res/Textile	Vinyl Tiles	10m2	All surfaces	Good Condition (1)	Low (1)	Low Priority (2-3)
2403/B00H/R9005/Floor Coverings Res/Textile/S6				Chrysotile (white asbestos)		
B00H - R9005 - Cleaning Distributed Store (0.75 m2)						
Ceiling Structures/Linings	Flat AC Sheeting	1m2	All surfaces	Good Condition (1)	Low (1)	Low Priority (2-3)
2403/B00H/R9005/Ceiling Structures/Linings/S5				Chrysotile (white asbestos)		
Floor Coverings Res/Textile	Vinyl Tiles	1m2	All surfaces	Good Condition (1)	Low (1)	Low Priority (2-3)
2403/B00H/R9005/Floor Coverings Res/Textile/S6				Chrysotile (white asbestos)		
B00H - R9006 - General Storeroom (23.7 m2)						
Floor Coverings Res/Textile	Vinyl Tiles	24m2	All surfaces	Good Condition (1)	Low (1)	Low Priority (2-3)
2403/B00H/R9005/Floor Coverings Res/Textile/S6				Chrysotile (white asbestos)		
B00H - R9007 - Toilets - Boys/Girls (4.03 m2)						
Partition Walls (Cubicles)	Flat AC Sheeting					
2403/B00H/R9007/Partition Walls (Cubicles)/S4				No Asbestos Detected		
B00H - R9008 - Movement (13.29 m2)						
Floor Coverings Res/Textile	Vinyl Tiles	14m2	All surfaces	Good Condition (1)	Low (1)	Low Priority (2-3)
2403/B00H/R9005/Floor Coverings Res/Textile/S6				Chrysotile (white asbestos)		

Product	Material Description	Extent	Location Reference	Material Condition	Risk Status	Control Priority
Sample No					Test Result	

B001 - Pupil Facilities - 1976 - Brick/Block (Brick/Block)**Exterior**

Ceiling Voids - Flat Roof	Non Accessible Area - Area inaccessible no void hatch located.					
Underfloor Voids - Packing to Floor Joists	Non Accessible Area - Area inaccessible no void hatch located.					
Eaves Linings	Flat AC Sheeting 2403/B001/Eaves Linings/S105	60m2	All surfaces	Good Condition (1)	Low (1)	Low Priority (2-3) Chrysotile (white asbestos) , Amosite (brown asbestos)
Wall Cladding	Flat AC Sheeting 2403/B001/Wall Cladding/S106					No Asbestos Detected

Interior**B001 - R0001 - Toilets - Girls (32.1 m2)**

Partition Walls (Cubicles)	Flat AC Sheeting 2403/B001/R0001/Partition Walls (Cubicles)/S2	16m2	All surfaces	Good Condition (1)	Low (1)	Low Priority (2-3) Chrysotile (white asbestos)
Ceiling Structures/Linings	Flat AC Sheeting 2403/B001/R0001/Ceiling Structures/Linings/S3	32m2	All surfaces	Good Condition (1)	Low (1)	Low Priority (2-3) Chrysotile (white asbestos) , Amosite (brown asbestos)

B001 - R0002 - Drinking Facilities (13.79 m2)

Ceiling Structures/Linings	Flat AC Sheeting 2403/B001/R0001/Ceiling Structures/Linings/S3	14m2	All surfaces	Good Condition (1)	Low (1)	Low Priority (2-3) Chrysotile (white asbestos) , Amosite (brown asbestos)
----------------------------	---	------	--------------	--------------------	---------	---

B001 - R0003 - Drinking Facilities (13.79 m2)

Ceiling Structures/Linings	Flat AC Sheeting 2403/B001/R0001/Ceiling Structures/Linings/S3	14m2	All surfaces	Good Condition (1)	Low (1)	Low Priority (2-3) Chrysotile (white asbestos) , Amosite (brown asbestos)
----------------------------	---	------	--------------	--------------------	---------	---

B001 - R0004 - Toilets - Boys (32.1 m2)

Partition Walls (Cubicles)	Flat AC Sheeting 2403/B001/R0001/Partition Walls (Cubicles)/S2	16m2	All surfaces	Good Condition (1)	Low (1)	Low Priority (2-3) Chrysotile (white asbestos)
Ceiling Structures/Linings	Flat AC Sheeting 2403/B001/R0001/Ceiling Structures/Linings/S3	32m2	All surfaces	Good Condition (1)	Low (1)	Low Priority (2-3) Chrysotile (white asbestos) , Amosite (brown asbestos)

B001 - R0005 - General Assistant/Bulk Store (52.07 m2)

No Asbestos

Product	Material Description	Extent	Location Reference	Material Condition	Risk Status	Control Priority
Sample No					Test Result	

B00J - Building Services - 1976 - Brick/Block (Brick/Block)

Exterior

Underfloor Voids - Slab on Ground	Non Accessible Area - Area inaccessible					
Ceiling Voids - Flat Roof	Non Accessible Area - Area inaccessible					
Gable Ends	Flat AC Sheeting 2403/B00J/Gable Ends/S110	4m2	East and west	Good Condition (1)	Low (1)	Low Priority (2-3)
					Chrysotile (white asbestos)	

Interior

B00J - R0001 - Plant (21.04 m2)

No Asbestos

2017

Product	Material Description	Extent	Location Reference	Material Condition	Risk Status	Control Priority
Sample No					Test Result	

B00K - Other-Community Use - 2005 - Steel (Steel)

Exterior

Underfloor Voids - Packing to Floor Joists	No Asbestos Found
Ceiling Voids	No Asbestos Found

Interior

B00K - R0001 - Other-Community Use (66.28 m2)

Vinyl Tiles (Under Floor Covering/Carpet)	No Asbestos Found
---	-------------------

B00K - R0002 - Other-Community Use (10.25 m2)

Floor Coverings Res/Textile	Vinyl Sheet	2403/B00K/R0002/Floor Coverings Res/Textile/S129	No Asbestos Detected
-----------------------------	-------------	--	-----------------------------

B00K - R0003 - Other-Community Use (66.12 m2)

Vinyl Tiles (Under Floor Covering/Carpet)	No Asbestos Found
---	-------------------

B00K - R0004 - Other-Community Use (10.36 m2)

Floor Coverings Res/Textile	Vinyl Sheet	2403/B00K/R0004/Floor Coverings Res/Textile/S130	No Asbestos Detected
-----------------------------	-------------	--	-----------------------------

B00K - R0005 - Other-Community Use (37.05 m2)

Floor Coverings Res/Textile	Flat AC Sheeting	2403/B00K/R0005/Floor Coverings Res/Textile/S131	No Asbestos Detected
-----------------------------	------------------	--	-----------------------------

2017

Product	Material Description	Extent	Location Reference	Material Condition	Risk Status	Control Priority
Sample No					Test Result	

Demountables

Demountable details as per the AMS records as of 15 Feb 2017.

OS 602 - D10035 - Learning Unit - Standard With P.A.A. : Placement Date - 30/12/2009

Note: This refurbished demountable may have asbestos present in remnant mastic in window frames.

Exterior

No Asbestos Found.

Interior

R1 - Learning space/withdrawal/entry

No Asbestos Found.

R2 - Home Base Store

No Asbestos Found.

OS 602 - D14309 - Learning Unit - Standard With P.A.A. : Placement Date - 9/01/2016

Note: This refurbished demountable may have asbestos present in remnant mastic in window frames.

Exterior

No Asbestos Found.

Interior

R1 - Learning space/withdrawal/entry

No Asbestos Found.

R2 - Home Base Store

No Asbestos Found.

OS 603 - D15928 - Learning Unit - Standard With P.A.A. A/C : Placement Date - 16/12/2004

Exterior

No Asbestos Found.

Interior

R1 - Learning space/withdrawal/entry

No Asbestos Found.

R2 - Home Base Store

No Asbestos Found.

2017

Product	Material Description	Extent	Location Reference	Material Condition	Risk Status	Control Priority
Sample No					Test Result	

Listing of Electronic Attachments as of 22/03/2017

There are no asbestos related file attachment(s) for this school.

2017