

# Asbestos Register

(Hazardous Materials and Risk Assessment)

**School :** Largs Public School (2374)  
**Region :** Hunter/Central Coast  
**State Electorate :** Maitland  
**Local Government Area :** Maitland

**Initial Survey :** Noel Arnold & Associates : 12 - Jun - 2008  
**Reviewed By :** AECOM : 17 - Jun - 2016

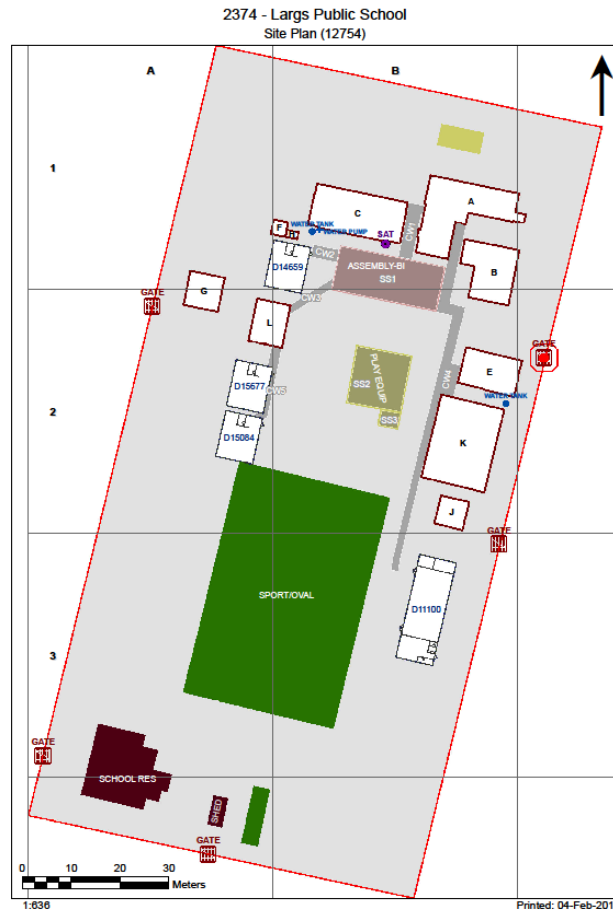

2017

Product	Material Description	Extent	Location Reference	Material Condition	Risk Status	Control Priority
Sample No					Test Result	

**B00A - General Learning - 1872 - Brick/Block (Brick/Block)**

**Exterior**

Ceiling Voids - Raked Ceiling	Non Accessible Area - Area inaccessible room has been installed with floating ceiling of new materials with raked ceiling above.					
Underfloor Voids - Packing to Floor Joists	Non Accessible Area - Area inaccessible void height too low to safely access.					
Eaves Linings	Flat AC Sheeting 2374/B00B/Eaves Linings/S3					<b>No Asbestos Detected</b>

**Interior**

**B00A - R0001 - External Movement**

No Asbestos

**B00A - R0002 - Movement**

No Asbestos

**B00A - R0003 - Library Office/Workroom**

No Asbestos

**B00A - R0004 - Reading Area**

No Asbestos

**B00A - R0005 - Canteen**

Floor Coverings Res/Textile	Vinyl Tiles	24m2	Throughout	Good Condition (1)	Low (1)	Low Priority (2-3)
	2374/B00A/R0005/Floor Coverings Res/Textile/S4					<b>Chrysotile (white asbestos)</b>

**B00A - R0006 - External Movement**

No Asbestos

**B00A - R0007 - Movement**

No Asbestos

**B00A - R0008 - K.L.A. Store**

No Asbestos

2017

Product	Material Description	Extent	Location Reference	Material Condition	Risk Status	Control Priority
Sample No					Test Result	

**B00B - Administration - 1935 - Timber (Timber)**

**Exterior**

Underfloor Voids - Packing to Floor Joists	Non Accessible Area - Area inaccessible void height too low to safely access.					
Ceiling Voids - Flat Roof	Non Accessible Area - Height Restriction Area inaccessible manhole located in BR0004.					
Wall Cladding	Flat AC Sheeting 2374/B00B/Wall Cladding/S2					<b>No Asbestos Detected</b>
Eaves Linings	Flat AC Sheeting 2374/B00B/Eaves Linings/S3					<b>No Asbestos Detected</b>

**Interior**

**B00B - R0001 - Staff Toilet**

Ceiling Structures/Linings	Flat AC Sheeting	3m2	Throughout	Good Condition (1)	Low (1)	Low Priority (2-3)
2374/B00B/R0001/Ceiling Structures/Linings/S1					<b>Chrysotile (white asbestos)</b>	

**B00B - R0004 - Clerical Office**

No Asbestos

**B00B - R0005 - General Storeroom**

No Asbestos

**B00B - R0007 - External Movement**

No Asbestos

**B00B - R0008 - Entry Vestibule**

No Asbestos

**B00B - R0009 - Clerical Office**

No Asbestos

**B00B - R0010 - Principal**

No Asbestos

**B00B - R0011 - Toilets-Unisex**

No Asbestos

**B00B - R0012 - Toilet - Lobby**

No Asbestos

**B00B - R0013 - Clerical Office**

No Asbestos

**B00B - R0014 - Sick Bay**

No Asbestos

**B00B - R0015 - Staff Room**

No Asbestos

2017

Product	Material Description	Extent	Location Reference	Material Condition	Risk Status	Control Priority
Sample No					Test Result	

**B00C - General Learning - 1885 - Timber (Timber)**

**Exterior**

Ceiling Voids - Flat Roof	Non Accessible Area - Area inaccessible Height Restriction manhole located in CR0004.					
Awnings	Flat AC Sheeting	4m2	West	Good Condition (1)	Low (1)	Low Priority (2-3)
<b>Assumed Asbestos - Height Restriction</b>						
Underfloor Voids - Packing to Floor Joists	No Asbestos Found					

**Interior**

<b>B00C - R0001 - External Movement</b>						
No Asbestos						
<b>B00C - R0002 - Home Base Store</b>						
No Asbestos						
<b>B00C - R0003 - Home Base</b>						
No Asbestos						
<b>B00C - R0004 - Withdrawal Space - 1hb</b>						
No Asbestos						
<b>B00C - R0005 - Home Base Store</b>						
No Asbestos						

2017

Product	Material Description	Extent	Location Reference	Material Condition	Risk Status	Control Priority
Sample No					Test Result	

**B00E - Pupil Facilities - 1955 - Timber (Timber)**

**Exterior**

Underfloor Voids - Slab on Ground	Non Accessible Area - Area inaccessible					
Ceiling Voids - Raked Ceiling	No Asbestos Found					
Wall Cladding	Flat AC Sheeting 2374/B00B/Wall Cladding/S2					<b>No Asbestos Detected</b>
Eaves Linings	Flat AC Sheeting 2374/B00E/R0001/Ceiling Structures/Linings/S5	4m2	North	Good Condition (1)	Low (1)	Low Priority (2-3) <b>Chrysotile (white asbestos)</b>

**Interior**

**B00E - R0003 - Sports Store**

Recently Modified Space Requires Inspection

**B00E - R0004 - Covered Outdoor Learning Area**

Recently Modified Space Requires Inspection

2017

Product	Material Description	Extent	Location Reference	Material Condition	Risk Status	Control Priority
Sample No					Test Result	

**B00F - Communal Facilities - 1999 - Metal Shed (Metal Shed)**

**Exterior**

Underfloor Voids - Packing to Floor Joists      No Asbestos Found

Ceiling Voids      No Asbestos Found

**Interior**

**B00F - R0001 - Sports Store**

No Asbestos

2017

Product	Material Description	Extent	Location Reference	Material Condition	Risk Status	Control Priority
Sample No					Test Result	

**B00G - Other-Museum - 1830 - Timber (Timber)**

**Exterior**

Underfloor Voids - Slab on Ground      Non Accessible Area  
 - Area inaccessible

Ceiling Voids - Raked Ceiling      Non Accessible Area  
 - Area inaccessible

**Interior**

**B00G - R0001 - No Access**

No Asbestos

2017

Product	Material Description	Extent	Location Reference	Material Condition	Risk Status	Control Priority
Sample No					Test Result	

**B00H - Storage - 2004 - Metal Shed (Metal Shed)**

**Exterior**

Ceiling Voids                      No Asbestos Found

**Interior**

**B00H - R0001 - Sports Store**

No Asbestos

2017



Product	Material Description	Extent	Location Reference	Material Condition	Risk Status	Control Priority
Sample No					Test Result	

**B00J - Building Services - 2008 - Steel (Steel)**

**Exterior**

Underfloor Voids - Slab on Ground	Non Accessible Area - Area inaccessible
Ceiling Voids	No Asbestos Found

**Interior**

**B00J - R0001 - General Storeroom**

No Asbestos

**B00J - R0002 - General Storeroom**

No Asbestos

2017

Product	Material Description	Extent	Location Reference	Material Condition	Risk Status	Control Priority
Sample No					Test Result	

**B00K - General Learning - 2010 - Fibre Cement Clad (Fibre Cement Clad)**

**Exterior**

Underfloor Voids - Packing to Floor Joists	No Asbestos Found
Ceiling Voids	No Asbestos Found

**Interior**

**B00K - R0001 - External Movement**

No Asbestos

**B00K - R0002 - Practical Activities - 1hb**

No Asbestos

**B00K - R0003 - Home Base**

No Asbestos

**B00K - R0004 - Home Base Store**

No Asbestos

**B00K - R0005 - Withdrawal Space - 2hb**

No Asbestos

**B00K - R0006 - Practical Activities - 1hb**

No Asbestos

**B00K - R0007 - Home Base**

No Asbestos

**B00K - R0008 - Home Base Store**

No Asbestos

2017

Product	Material Description	Extent	Location Reference	Material Condition	Risk Status	Control Priority
Sample No					Test Result	

**B00L - Pupil Facilities - 2011 - Brick/Veneer (Brick/Veneer)**

**Exterior**

Underfloor Voids - Slab on Ground	Non Accessible Area - Area inaccessible
Ceiling Voids	No Asbestos Found

**Interior**

**B00L - R0001 - External Movement**

No Asbestos

**B00L - R0002 - Toilets - Boys**

No Asbestos

**B00L - R0003 - Toilets - Girls**

No Asbestos

**B00L - R0004 - Staff Toilet**

No Asbestos

2017

Product	Material Description	Extent	Location Reference	Material Condition	Risk Status	Control Priority
Sample No					Test Result	

**Demountables**

**Demountable details as per the AMS records as of 15 Feb 2017.**

**OS 810 - D11100 - FSU/Shelter/Stores : Placement Date - 3/09/2013**

Note: This refurbished demountable may have asbestos present in remnant mastic in window frames.

**Exterior**

No Asbestos Found.

**Interior**

**R1 - Canteen**

No Asbestos Found.

**R2 - Covered Area**

No Asbestos Found.

**R3 - Store**

No Asbestos Found.

**R4 - Sports Store**

No Asbestos Found.

**R5 - Garden Store**

No Asbestos Found.

**R6 - Change Room**

No Asbestos Found.

**R7 - Store**

No Asbestos Found.

**OS 602 - D14659 - Learning Unit - Standard With P.A.A. : Placement Date - 24/11/2008**

Note: This refurbished demountable may have asbestos present in remnant mastic in window frames.

**Exterior**

No Asbestos Found.

**Interior**

**R1 - Learning space/withdrawal/entry**

No Asbestos Found.

**R2 - Home Base Store**

No Asbestos Found.

**OS 602 - D15084 - Learning Unit - Standard With P.A.A. : Placement Date - 21/06/2013**

Note: This refurbished demountable may have asbestos present in remnant mastic in window frames.

**Exterior**

No Asbestos Found.

**Interior**

**R1 - Learning space/withdrawal/entry**

No Asbestos Found.

**R2 - Home Base Store**

No Asbestos Found.

**OS 602 - D15677 - Learning Unit - Standard With P.A.A. : Placement Date - 20/04/2011**

Note: This refurbished demountable may have asbestos present in remnant mastic in window frames.

**Exterior**

No Asbestos Found.



Product	Material Description	Extent	Location Reference	Material Condition	Risk Status	Control Priority
Sample No					Test Result	
<b>Interior</b>						
<b>R1 - Learning space/withdrawal/entry</b>						
No Asbestos Found.						
<b>R2 - Home Base Store</b>						
No Asbestos Found.						

2017

Product	Material Description	Extent	Location Reference	Material Condition	Risk Status	Control Priority
Sample No					Test Result	

*Listing of Electronic Attachments as of 22/03/2017*

**There are no asbestos related file attachment(s) for this school.**

2017