

Asbestos Register

(Hazardous Materials and Risk Assessment)

School : Kingswood High School (8458)
Region : Western Sydney
State Electorate : Penrith
Local Government Area : Penrith

Initial Survey : Noel Arnold & Associates : 14 - Jan - 2010
Reviewed By : Parsons Brinckerhoff : 26 - Feb - 2015

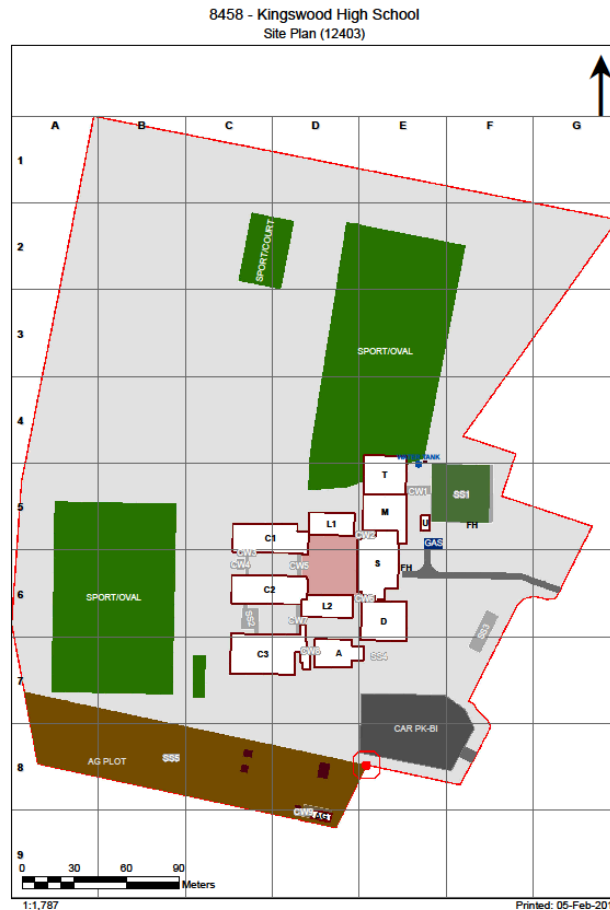

2017

Product	Material Description	Extent	Location Reference	Material Condition	Risk Status	Control Priority
Sample No					Test Result	

B00A - Administration - 1970 - Brick/Block (Brick/Block)

Exterior

Ceiling Voids	No Asbestos Found
Underfloor Voids	No Asbestos Found

Interior

B00A - R0001 - Movement (1.35 m2)

No Asbestos

B00A - R0002 - Administration - Clerical (28.51 m2)

No Asbestos

B00A - R0003 - Administration - Clerical (13.4 m2)

No Asbestos

B00A - R0004 - Principal Office (16.38 m2)

No Asbestos

B00A - R0005 - Staff - Toilet (3.42 m2)

No Asbestos

B00A - R0006 - General Storeroom (3.22 m2)

No Asbestos

B00A - R0007 - Interview/Office - Type 1 (13.69 m2)

No Asbestos

B00A - R0008 - Movement (1.37 m2)

No Asbestos

B00A - R0009 - Administration - Clerical (12.59 m2)

No Asbestos

B00A - R0010 - Movement (1.37 m2)

No Asbestos

B00A - R0011 - Deputy Principal Office (16.59 m2)

No Asbestos

B00A - R0012 - Staff - Toilet (8.33 m2)

Floor Coverings Res/Textile	Vinyl Tiles	3m2	South	Minimal Damage (2)	Low (1)	Low Priority (2-3)
	8458/B00A/R0012/Floor Coverings Res/Textile/S11					Chrysotile (white asbestos)

Floor Coverings Res/Textile	Vinyl Tiles					
	8458/B00A/R0012/Floor Coverings Res/Textile/S10					No Asbestos Detected

B00A - R0013 - Cleaning Store - Distributed (1.53 m2)

No Asbestos

B00A - R0014 - Staff - Toilet (10.11 m2)

Floor Coverings Res/Textile	Vinyl Tiles	4m2	South	Minimal Damage (2)	Low (1)	Low Priority (2-3)
	8458/B00A/R0014/Floor Coverings Res/Textile/S12					Chrysotile (white asbestos)

B00A - R0015 - Clinic - Boys (13.58 m2)

Floor Coverings Res/Textile	Vinyl Tiles	14m2	Throughout	Minimal Damage (2)	Low (1)	Low Priority (2-3)
	8458/B00A/R0015/Floor Coverings Res/Textile/S13					Chrysotile (white asbestos)

B00A - R0016 - Clinic - Boys (6.77 m2)

No Asbestos

B00A - R0017 - Duplicating Workroom (6.83 m2)

No Asbestos

B00A - R0018 - Interview/Office - Type 1 (14 m2)

No Asbestos

Product	Material Description	Extent	Location Reference	Material Condition	Risk Status	Control Priority
Sample No					Test Result	
B00A - R0019 - Movement (1.35 m2)						
No Asbestos						
B00A - R0020 - Distribution Board Cupboard (0.81 m2)				Note: No inspection of live electrical installation.		
No Asbestos						
B00A - R0021 - General Storeroom (2.37 m2)						
No Asbestos						
B00A - R0022 - Administration - Clerical (11.48 m2)						
No Asbestos						
B00A - R0023 - Movement (104.42 m2)						
No Asbestos						
B00A - R0024 - External Movement (55.86 m2)						
No Asbestos						

2017

Product	Material Description	Extent	Location Reference	Material Condition	Risk Status	Control Priority
Sample No					Test Result	

B00D - Technological & Applied Studies - 1970 - Brick/Block (Brick/Block)**Exterior**

Ceiling Voids	No Asbestos Found
Underfloor Voids	No Asbestos Found

Interior**B00D - R0001 - Food Technology L.S. (84.19 m2)**

Ceiling Structures/Linings	Vermiculite					
	8458/B0L2/R1005/Ceiling Structures/Linings/S6					Limited Samples Taken
<i>Vermiculite Ceilings may contain asbestos. Asbestos testing MUST be conducted prior to any disturbance works</i>						

B00D - R0002 - Food/Research Space (15.54 m2)

Ceiling Structures/Linings	Vermiculite					
	8458/B0L2/R1005/Ceiling Structures/Linings/S6					Limited Samples Taken
<i>Vermiculite Ceilings may contain asbestos. Asbestos testing MUST be conducted prior to any disturbance works</i>						

B00D - R0003 - Pantry (15.89 m2)

Ceiling Structures/Linings	Vermiculite					
	8458/B0L2/R1005/Ceiling Structures/Linings/S6					Limited Samples Taken
<i>Vermiculite Ceilings may contain asbestos. Asbestos testing MUST be conducted prior to any disturbance works</i>						

B00D - R0004 - Food Technology L.S. (83.72 m2)

Ceiling Structures/Linings	Vermiculite					
	8458/B0L2/R1005/Ceiling Structures/Linings/S6					Limited Samples Taken
<i>Vermiculite Ceilings may contain asbestos. Asbestos testing MUST be conducted prior to any disturbance works</i>						

B00D - R0005 - Laundry (15.4 m2)

Floor Coverings Res/Textile	Vinyl Tiles	15m2	Throughout	Minimal Damage (2)	Low (1)	Low Priority (2-3)
	8458/B00D/R0005/Floor Coverings Res/Textile/S15					Chrysotile (white asbestos)
Decorative Coating	Vermiculite					
	8458/B00D/R0005/Decorative Coating/S14					Limited Samples Taken
<i>Vermiculite Ceilings may contain asbestos. Asbestos testing MUST be conducted prior to any disturbance works</i>						

B00D - R0006 - General Storeroom (6.55 m2)

No Asbestos

B00D - R0007 - General Storeroom (4.52 m2)

Ceiling Structures/Linings	Vermiculite					
	8458/B0L2/R1005/Ceiling Structures/Linings/S6					Limited Samples Taken
<i>Vermiculite Ceilings may contain asbestos. Asbestos testing MUST be conducted prior to any disturbance works</i>						
Floor Coverings Res/Textile	Vinyl Tiles	5m2	Throughout	Good Condition (1)	Low (1)	Low Priority (2-3)
	8458/B0L2/R1005/Floor Coverings Res/Textile/S5					Chrysotile (white asbestos)

B00D - R0008 - Cleaning Store - Distributed (4.55 m2)

Ceiling Structures/Linings	Vermiculite					
	8458/B0L2/R1005/Ceiling Structures/Linings/S6					Limited Samples Taken
<i>Vermiculite Ceilings may contain asbestos. Asbestos testing MUST be conducted prior to any disturbance works</i>						
Floor Coverings Res/Textile	Vinyl Tiles	5m2	Throughout	Good Condition (1)	Low (1)	Low Priority (2-3)
	8458/B0L2/R1005/Floor Coverings Res/Textile/S5					Chrysotile (white asbestos)

B00D - R0009 - Commonroom (66.44 m2)

Ceiling Structures/Linings	Vermiculite					
	8458/B0L2/R1005/Ceiling Structures/Linings/S6					Limited Samples Taken
<i>Vermiculite Ceilings may contain asbestos. Asbestos testing MUST be conducted prior to any disturbance works</i>						

B00D - R0010 - Commonroom (7.01 m2)

Floor Coverings Res/Textile	Vinyl Tiles	8m2	Throughout	Good Condition (1)	Low (1)	Low Priority (2-3)
	8458/B0L2/R1005/Floor Coverings Res/Textile/S5					Chrysotile (white asbestos)

Product	Material Description	Extent	Location Reference	Material Condition	Risk Status	Control Priority
Sample No					Test Result	
Ceiling Structures/Linings	Vermiculite 8458/B0L2/R1005/Ceiling Structures/Linings/S6					Limited Samples Taken <i>Vermiculite Ceilings may contain asbestos. Asbestos testing MUST be conducted prior to any disturbance works</i>
B00D - R0011 - General Storeroom (10.37 m2)						
Ceiling Structures/Linings	Vermiculite 8458/B0L2/R1005/Ceiling Structures/Linings/S6					Limited Samples Taken <i>Vermiculite Ceilings may contain asbestos. Asbestos testing MUST be conducted prior to any disturbance works</i>
B00D - R0012 - Staff Study (30.67 m2)						
Ceiling Structures/Linings	Vermiculite 8458/B0L2/R1005/Ceiling Structures/Linings/S6					Limited Samples Taken <i>Vermiculite Ceilings may contain asbestos. Asbestos testing MUST be conducted prior to any disturbance works</i>
B00D - R0013 - Shower/Change (21.79 m2)						
Ceiling Structures/Linings	Vermiculite 8458/B0L2/R1005/Ceiling Structures/Linings/S6					Limited Samples Taken <i>Vermiculite Ceilings may contain asbestos. Asbestos testing MUST be conducted prior to any disturbance works</i>
B00D - R0014 - Distribution Board Cupboard (1.36 m2) Note: No inspection of live electrical installation.						
Electrical Backing Board	Resinous Board	1Unit	Throughout	Minimal Damage (2)	Low (1)	Low Priority (2-3) Assumed Asbestos - Electrical Hazard Assumed Asbestos
B00D - R0015 - Toilets-Girls (66.62 m2)						
Partition Walls (Cubicles)	Compressed AC Sheet 8458/B00S/R1004/Partition Walls (Cubicles)/S8	20m2	Throughout	Good Condition (1)	Low (1)	Low Priority (2-3) Chrysotile (white asbestos)
Ceiling Structures/Linings	Vermiculite 8458/B0L2/R1005/Ceiling Structures/Linings/S6					Limited Samples Taken <i>Vermiculite Ceilings may contain asbestos. Asbestos testing MUST be conducted prior to any disturbance works</i>
B00D - R0016 - Movement (1.25 m2)						
No Asbestos						
B00D - R0017 - Movement (85.64 m2)						
Floor Coverings Res/Textile	Vinyl Tiles 8458/B0L2/R1005/Floor Coverings Res/Textile/S5	86m2	Throughout	Good Condition (1)	Low (1)	Low Priority (2-3) Chrysotile (white asbestos)
Ceiling Structures/Linings	Vermiculite 8458/B0L2/R1005/Ceiling Structures/Linings/S6					Limited Samples Taken <i>Vermiculite Ceilings may contain asbestos. Asbestos testing MUST be conducted prior to any disturbance works</i>
B00D - R0018 - Movement (1.29 m2)						
No Asbestos						
B00D - R1001 - Art Learning Space (66.58 m2)						
Floor Coverings Res/Textile	Vinyl Tiles 8458/B0L2/R1005/Floor Coverings Res/Textile/S5	67m2	Throughout	Good Condition (1)	Low (1)	Low Priority (2-3) Chrysotile (white asbestos)
B00D - R1002 - Bulk Store (13.21 m2)						
Floor Coverings Res/Textile	Vinyl Tiles 8458/B0L2/R1005/Floor Coverings Res/Textile/S5	14m2	Throughout	Good Condition (1)	Low (1)	Low Priority (2-3) Chrysotile (white asbestos)
B00D - R1003 - Art Learning Space (66.58 m2)						
Floor Coverings Res/Textile	Vinyl Tiles 8458/B0L2/R1005/Floor Coverings Res/Textile/S5	67m2	Throughout	Good Condition (1)	Low (1)	Low Priority (2-3) Chrysotile (white asbestos)
B00D - R1004 - Distribution Board Cupboard (1.56 m2) Note: No inspection of live electrical installation.						
Electrical Backing Board	Resinous Board	1Unit	Throughout	Minimal Damage (2)	Low (1)	Low Priority (2-3) Assumed Asbestos - Electrical Hazard Assumed Asbestos
B00D - R1005 - Cleaning Store - Distributed (0.9 m2)						

Product	Material Description	Extent	Location Reference	Material Condition	Risk Status	Control Priority
Sample No					Test Result	
Floor Coverings Res/Textile	Vinyl Tiles	1m2	Throughout	Good Condition (1)	Low (1)	Low Priority (2-3)
8458/B0L2/R1005/Floor Coverings Res/Textile/S5					Chrysotile (white asbestos)	
B00D - R1006 - Design L.S. (66.76 m2)						
Floor Coverings Res/Textile	Vinyl Tiles	67m2	Throughout	Good Condition (1)	Low (1)	Low Priority (2-3)
8458/B0L2/R1005/Floor Coverings Res/Textile/S5					Chrysotile (white asbestos)	
B00D - R1007 - Materials Store (4.4 m2)						
Floor Coverings Res/Textile	Vinyl Tiles	4m2	Throughout	Minimal Damage (2)	Low (1)	Low Priority (2-3)
8458/B00D/R1007/Floor Coverings Res/Textile/S16					Chrysotile (white asbestos)	
B00D - R1008 - General Storeroom (10.18 m2)						
No Asbestos						
B00D - R1009 - Design L.S. (67.16 m2)						
Floor Coverings Res/Textile	Vinyl Tiles	68m2	Throughout	Good Condition (1)	Low (1)	Low Priority (2-3)
8458/B0L2/R1005/Floor Coverings Res/Textile/S5					Chrysotile (white asbestos)	
B00D - R1010 - Staff Study (32.03 m2)						
No Asbestos						
B00D - R1011 - Music Learning Space (66.25 m2)						
No Asbestos						
B00D - R1012 - Music Learning Space (66.8 m2)						
No Asbestos						
B00D - R1013 - Movement (63.64 m2)						
Floor Coverings Res/Textile	Vinyl Tiles	64m2	Throughout	Good Condition (1)	Low (1)	Low Priority (2-3)
8458/B0L2/R1005/Floor Coverings Res/Textile/S5					Chrysotile (white asbestos)	

2017

Product	Material Description	Extent	Location Reference	Material Condition	Risk Status	Control Priority
Sample No					Test Result	

B00M - Art/Technological & Applied Studies - 1970 - Brick/Block (Brick/Block)**Exterior**

Ceiling Voids	No Asbestos Found
Underfloor Voids	No Asbestos Found

Interior**B00M - R0001 - Toilets-Boys (68.08 m2)**

Ceiling Structures/Linings	Vermiculite								Limited Samples Taken
	8458/B0L2/R1005/Ceiling Structures/Linings/S6								Vermiculite Ceilings may contain asbestos. Asbestos testing MUST be conducted prior to any disturbance works

Partition Walls (Cubicles)	Compressed AC Sheet	20m2	Throughout	Good Condition (1)	Low (1)	Low Priority (2-3)			
	8458/B00S/R1004/Partition Walls (Cubicles)/S8								Chrysotile (white asbestos)

B00M - R0002 - Cleaning Store - Distributed (1.8 m2)

Ceiling Structures/Linings	Vermiculite								Limited Samples Taken
	8458/B0L2/R1005/Ceiling Structures/Linings/S6								Vermiculite Ceilings may contain asbestos. Asbestos testing MUST be conducted prior to any disturbance works

B00M - R0003 - Distribution Board Cupboard (2.75 m2)

Note: No inspection of live electrical installation.

No Asbestos

B00M - R0004 - No Access (82.8 m2)

Ceiling Structures/Linings	Vermiculite								Limited Samples Taken
	8458/B0L2/R1005/Ceiling Structures/Linings/S6								Vermiculite Ceilings may contain asbestos. Asbestos testing MUST be conducted prior to any disturbance works

B00M - R0008 - General Storeroom (15.35 m2)

Ceiling Structures/Linings	Vermiculite								Limited Samples Taken
	8458/B0L2/R1005/Ceiling Structures/Linings/S6								Vermiculite Ceilings may contain asbestos. Asbestos testing MUST be conducted prior to any disturbance works

B00M - R0009 - Art Learning Space (64.63 m2)

Ceiling Structures/Linings	Vermiculite								Limited Samples Taken
	8458/B0L2/R1005/Ceiling Structures/Linings/S6								Vermiculite Ceilings may contain asbestos. Asbestos testing MUST be conducted prior to any disturbance works

B00M - R0010 - Bulk Store (7.52 m2)

Ceiling Structures/Linings	Vermiculite								Limited Samples Taken
	8458/B0L2/R1005/Ceiling Structures/Linings/S6								Vermiculite Ceilings may contain asbestos. Asbestos testing MUST be conducted prior to any disturbance works

B00M - R0011 - Kiln Space (13.82 m2)

Ceiling Structures/Linings	Vermiculite								Limited Samples Taken
	8458/B0L2/R1005/Ceiling Structures/Linings/S6								Vermiculite Ceilings may contain asbestos. Asbestos testing MUST be conducted prior to any disturbance works

B00M - R0013 - Movement (26.38 m2)

No Asbestos

B00M - R0014 - Metal Technology Bay (106.13 m2)

No Asbestos

B00M - R0015 - Welding/Hot Metals Area (5.33 m2)

No Asbestos

B00M - R0016 - Welding/Hot Metals Area (5.45 m2)

No Asbestos

B00M - R0017 - General Storeroom (11.28 m2)

No Asbestos

B00M - R0018 - External Movement (87.77 m2)

No Asbestos

B00M - R1001 - Wood Technology Bay (83.53 m2)

Product	Material Description	Extent	Location Reference	Material Condition	Risk Status	Control Priority
Sample No					Test Result	
Floor Coverings Res/Textile	Vinyl Tiles	84m2	Throughout	Good Condition (1)	Low (1)	Low Priority (2-3)
8458/B0L2/R1005/Floor Coverings Res/Textile/S5					Chrysotile (white asbestos)	
B00M - R1002 - Dust Extraction Space (3.84 m2)						
No Asbestos						
B00M - R1003 - Dust Extraction Space (5.94 m2)						
No Asbestos						
B00M - R1004 - Materials Store (21.42 m2)						
No Asbestos						
B00M - R1005 - Materials Technology L.S. (83.63 m2)						
No Asbestos						
B00M - R1006 - Wood Technology Bay (0.68 m2)						
No Asbestos						
B00M - R1007 - General Storeroom (12.78 m2)						
Floor Coverings Res/Textile	Vinyl Tiles	13m2	Throughout	Good Condition (1)	Low (1)	Low Priority (2-3)
8458/B0L2/R1005/Floor Coverings Res/Textile/S5					Chrysotile (white asbestos)	
B00M - R1008 - Design L.S. (53.87 m2)						
No Asbestos						
B00M - R1009 - Staff Study (25.94 m2)						
No Asbestos						
B00M - R1010 - General Learning Space (53.49 m2)						
No Asbestos						
B00M - R1011 - Materials Store (13.23 m2)						
Floor Coverings Res/Textile	Vinyl Tiles	13m2	Throughout	Minimal Damage (2)	Low (1)	Low Priority (2-3)
8458/B00M/R1011/Floor Coverings Res/Textile/S17					Chrysotile (white asbestos)	
B00M - R1012 - Distribution Board Cupboard (1.03 m2)						
Note: No inspection of live electrical installation.						
Electrical Backing Board	Resinous Board	1Unit	Throughout	Minimal Damage (2)	Low (1)	Low Priority (2-3)
Assumed Asbestos - Electrical Hazard					Assumed Asbestos	
Fibre Cement Sheeting Debris	Flat AC Sheeting					
8458/B00M/R1012/Fibre Cement Sheeting Debris/S18					No Asbestos Detected	
B00M - R1013 - Movement (57.23 m2)						
Floor Coverings Res/Textile	Vinyl Tiles	58m2	Throughout	Good Condition (1)	Low (1)	Low Priority (2-3)
8458/B0L2/R1005/Floor Coverings Res/Textile/S5					Chrysotile (white asbestos)	

2017

Product	Material Description	Extent	Location Reference	Material Condition	Risk Status	Control Priority
Sample No					Test Result	

B00S - Multi Purpose Facilities - 1970 - Brick/Block (Brick/Block)

Exterior

Ceiling Voids	No Asbestos Found
Underfloor Voids	No Asbestos Found

Interior

B00S - R0001 - Darkroom Space (19.26 m2)

No Asbestos

B00S - R0002 - Cleaning Store - Distributed (1.06 m2)

No Asbestos

B00S - R0003 - General Storeroom (16.57 m2)

No Asbestos

B00S - R0004 - Distribution Board Cupboard (0.74 m2)

Note: No inspection of live electrical installation.

No Asbestos

B00S - R0005 - Staff - Toilet (3.37 m2)

No Asbestos

B00S - R0006 - Cleaning Supplies Store (6.41 m2)

No Asbestos

B00S - R0007 - Staff - Toilet (3.39 m2)

No Asbestos

B00S - R0008 - Movement (79.73 m2)

No Asbestos

B00S - R0009 - Student Canteen (50.23 m2)

Floor Coverings Res/Textile	Vinyl Tiles	8458/B00S/R0009/Floor Coverings Res/Textile/S20	No Asbestos Detected
Decorative Coating	Vermiculite	8458/B00S/R0009/Decorative Coating/S19	Limited Samples Taken

Vermiculite Ceilings may contain asbestos. Asbestos testing MUST be conducted prior to any disturbance works

B00S - R0010 - General Storeroom (1.02 m2)

No Asbestos

B00S - R0011 - General Storeroom (6.54 m2)

Floor Coverings Res/Textile	Vinyl Tiles	8458/B00S/R0011/Floor Coverings Res/Textile/S21	No Asbestos Detected
-----------------------------	-------------	---	----------------------

B00S - R0012 - Main Switchroom (10.2 m2)

No Asbestos

B00S - R0013 - Sport Equipment Store (16.25 m2)

No Asbestos

B00S - R0014 - Sport Equipment Store (18.67 m2)

No Asbestos

B00S - R0015 - Multi-Purpose Space (309.07 m2)

No Asbestos

B00S - R0016 - External Stairs (1.02 m2)

No Asbestos

B00S - R0017 - General Storeroom (13.07 m2)

No Asbestos

B00S - R0018 - Chair Store (17 m2)

No Asbestos

B00S - R0019 - General Storeroom (17 m2)

Product	Material Description	Extent	Location Reference	Material Condition	Risk Status	Control Priority
Sample No					Test Result	

No Asbestos

B00S - R0020 - Materials Store (13.07 m2)

No Asbestos

B00S - R0021 - External Stairs (2.38 m2)

No Asbestos

B00S - R0022 - External Movement (37.37 m2)

No Asbestos

B00S - R0024 - External Movement (91.55 m2)

No Asbestos

B00S - R1001 - Cleaning Store - Distributed (3.39 m2)

No Asbestos

B00S - R1002 - Staff Change (9.66 m2)

No Asbestos

B00S - R1003 - Staff - Toilet (9.18 m2)

No Asbestos

B00S - R1004 - Shower/Change (61.83 m2)

Partition Walls (Cubicles) Compressed AC Sheet 20m2 Throughout Good Condition (1) Low (1) Low Priority (2-3)

8458/B00S/R1004/Partition Walls (Cubicles)/S8

Chrysotile (white asbestos)

B00S - R1005 - Shower/Change (61.49 m2)

Partition Walls (Cubicles) Compressed AC Sheet 20m2 Throughout Good Condition (1) Low (1) Low Priority (2-3)

8458/B00S/R1004/Partition Walls (Cubicles)/S8

Chrysotile (white asbestos)

B00S - R1006 - Staff - Toilet (8.55 m2)

No Asbestos

B00S - R1007 - General Storeroom (9.66 m2)

No Asbestos

B00S - R1008 - Cleaning Store - Distributed (3.39 m2)

No Asbestos

B00S - R1009 - Movement (70.71 m2)

No Asbestos

B00S - R1010 - External Stairs (14.23 m2)

No Asbestos

B00S - R1011 - External Movement (37.37 m2)

No Asbestos

B00S - R1012 - External Stairs (14.45 m2)

No Asbestos

B00S - R1013 - External Movement (39 m2)

No Asbestos

2017

Product	Material Description	Extent	Location Reference	Material Condition	Risk Status	Control Priority
Sample No					Test Result	

B00T - Technological & Applied Studies - 2010 - Brick/Veneer (Brick/Veneer)

Exterior

Ceiling Void	No Asbestos Found
Underfloor Void	No Asbestos Found

Interior

B00T - R0001 - Materials Technology L.S. (233.36 m2)

No Asbestos

B00T - R0002 - Toilets-Disabled (3.9 m2)

No Asbestos

B00T - R0003 - Materials Store (6.47 m2)

No Asbestos

B00T - R0004 - Materials Store (9.32 m2)

No Asbestos

B00T - R0005 - Welding/Hot Metals Area (3.7 m2)

No Asbestos

B00T - R0006 - Welding/Hot Metals Area (3.74 m2)

No Asbestos

B00T - R0007 - Welding/Hot Metals Area (3.85 m2)

No Asbestos

B00T - R0008 - Welding/Hot Metals Area (3.85 m2)

No Asbestos

B00T - R0009 - Computer Room (40.02 m2)

No Asbestos

B00T - R0010 - General Storeroom (13.9 m2)

No Asbestos

B00T - R0011 - Plant (0.39 m2)

No Asbestos

B00T - R0012 - Staff Study (14.47 m2)

No Asbestos

B00T - R0013 - External Movement (179.07 m2)

No Asbestos

2017

Product	Material Description	Extent	Location Reference	Material Condition	Risk Status	Control Priority
Sample No					Test Result	

B00U - Physical Education - 2007 - Metal Shed (Metal Shed)

Exterior

Ceiling Void	No Asbestos Found
Underfloor Void	No Asbestos Found

Interior

B00U - R0001 - Sport Equipment Store (42.3 m2)

No Asbestos

2017

Product	Material Description	Extent	Location Reference	Material Condition	Risk Status	Control Priority
	Sample No					Test Result

B0AG - Agricultural Science - 1970 - Brick/Block (Brick/Block)

Exterior

Ceiling Voids	No Asbestos Found
Underfloor Voids	No Asbestos Found

Interior

B0AG - R0001 - Shower/Change (8.42 m2)

No Asbestos

B0AG - R0002 - General Assistants (12.69 m2)

No Asbestos

B0AG - R0003 - Machine Storage (20.61 m2)

No Asbestos

B0AG - R0004 - Shower/Change (8.42 m2)

No Asbestos

2017

Product	Material Description	Extent	Location Reference	Material Condition	Risk Status	Control Priority
Sample No					Test Result	
B0C1 - General Learning - 1970 - Brick/Block (Brick/Block)						
Exterior						
Ceiling Voids	No Asbestos Found					
Underfloor Voids	No Asbestos Found					
Interior						
B0C1 - R0001 - General Learning Space (53.65 m2)						
Ceiling Structures/Linings	Vermiculite					Limited Samples Taken
	8458/B0C2/R0017/Ceiling Structures/Linings/S2					
<i>Vermiculite Ceilings may contain asbestos. Asbestos testing MUST be conducted prior to any disturbance works</i>						
B0C1 - R0002 - General Learning Space (53.07 m2)						
Ceiling Structures/Linings	Vermiculite					Limited Samples Taken
	8458/B0C2/R0017/Ceiling Structures/Linings/S2					
<i>Vermiculite Ceilings may contain asbestos. Asbestos testing MUST be conducted prior to any disturbance works</i>						
B0C1 - R0003 - General Storeroom (12.04 m2)						
Ceiling Structures/Linings	Vermiculite					Limited Samples Taken
	8458/B0C2/R0017/Ceiling Structures/Linings/S2					
<i>Vermiculite Ceilings may contain asbestos. Asbestos testing MUST be conducted prior to any disturbance works</i>						
B0C1 - R0004 - General Learning Space (53.07 m2)						
Ceiling Structures/Linings	Vermiculite					Limited Samples Taken
	8458/B0C2/R0017/Ceiling Structures/Linings/S2					
<i>Vermiculite Ceilings may contain asbestos. Asbestos testing MUST be conducted prior to any disturbance works</i>						
B0C1 - R0005 - Staff Study (25.91 m2)						
Ceiling Structures/Linings	Vermiculite					Limited Samples Taken
	8458/B0C2/R0017/Ceiling Structures/Linings/S2					
<i>Vermiculite Ceilings may contain asbestos. Asbestos testing MUST be conducted prior to any disturbance works</i>						
B0C1 - R0006 - General Learning Space (53.65 m2)						
Ceiling Structures/Linings	Vermiculite					Limited Samples Taken
	8458/B0C2/R0017/Ceiling Structures/Linings/S2					
<i>Vermiculite Ceilings may contain asbestos. Asbestos testing MUST be conducted prior to any disturbance works</i>						
B0C1 - R0007 - General Learning Space (53.58 m2)						
Ceiling Structures/Linings	Vermiculite					Limited Samples Taken
	8458/B0C2/R0017/Ceiling Structures/Linings/S2					
<i>Vermiculite Ceilings may contain asbestos. Asbestos testing MUST be conducted prior to any disturbance works</i>						
B0C1 - R0008 - General Storeroom (11.4 m2)						
Ceiling Structures/Linings	Vermiculite					Limited Samples Taken
	8458/B0C2/R0017/Ceiling Structures/Linings/S2					
<i>Vermiculite Ceilings may contain asbestos. Asbestos testing MUST be conducted prior to any disturbance works</i>						
B0C1 - R0009 - Staff Study (50.79 m2)						
Ceiling Structures/Linings	Vermiculite					Limited Samples Taken
	8458/B0C2/R0017/Ceiling Structures/Linings/S2					
<i>Vermiculite Ceilings may contain asbestos. Asbestos testing MUST be conducted prior to any disturbance works</i>						
B0C1 - R0010 - Cleaning Store - Distributed (3.31 m2)						
Ceiling Structures/Linings	Vermiculite					Limited Samples Taken
	8458/B0C2/R0017/Ceiling Structures/Linings/S2					
<i>Vermiculite Ceilings may contain asbestos. Asbestos testing MUST be conducted prior to any disturbance works</i>						
B0C1 - R0011 - Interview/Office - Type 1 (10.92 m2)						
Ceiling Structures/Linings	Vermiculite					Limited Samples Taken
	8458/B0C2/R0017/Ceiling Structures/Linings/S2					
<i>Vermiculite Ceilings may contain asbestos. Asbestos testing MUST be conducted prior to any disturbance works</i>						
B0C1 - R0012 - Distribution Board Cupboard (0.93 m2)						
				Note: No inspection of live electrical installation.		
Infill panel to wall	Flat AC Sheeting	<1m2	South	Minimal Damage (2)	Medium (2)	Medium Priority (4-5)
	8458/B0C1/R0012/Infill panel to wall/S23					Chrysotile (white asbestos)

Product	Material Description	Extent	Location Reference	Material Condition	Risk Status	Control Priority
Sample No					Test Result	
Ceiling Structures/Linings	Flat AC Sheeting	1m2	Throughout	Poor Condition - Extensive Damage (4)	High (3)	High Priority (6-8)
8458/B0C1/R0012/Ceiling Structures/Linings/S22					Chrysotile (white asbestos)	
B0C1 - R0013 - General Storeroom (32.13 m2)						
Ceiling Structures/Linings	Vermiculite					Limited Samples Taken
8458/B0C2/R0017/Ceiling Structures/Linings/S2					Vermiculite Ceilings may contain asbestos. Asbestos testing MUST be conducted prior to any disturbance works	
Floor Coverings Res/Textile	Vinyl Tiles	33m2	Throughout	Good Condition (1)	Low (1)	Low Priority (2-3)
8458/B0C2/R0017/Floor Coverings Res/Textile/S3					Chrysotile (white asbestos)	
B0C1 - R0014 - Staff - Toilet (7.56 m2)						
Ceiling Structures/Linings	Vermiculite					Limited Samples Taken
8458/B0C2/R0017/Ceiling Structures/Linings/S2					Vermiculite Ceilings may contain asbestos. Asbestos testing MUST be conducted prior to any disturbance works	
B0C1 - R0015 - Staff - Toilet (5.25 m2)						
Ceiling Structures/Linings	Vermiculite					Limited Samples Taken
8458/B0C2/R0017/Ceiling Structures/Linings/S2					Vermiculite Ceilings may contain asbestos. Asbestos testing MUST be conducted prior to any disturbance works	
B0C1 - R0016 - General Storeroom (5.12 m2)						
Ceiling Structures/Linings	Vermiculite					Limited Samples Taken
8458/B0C2/R0017/Ceiling Structures/Linings/S2					Vermiculite Ceilings may contain asbestos. Asbestos testing MUST be conducted prior to any disturbance works	
B0C1 - R0017 - External Movement (2.33 m2)						
Ceiling Structures/Linings	Vermiculite					Limited Samples Taken
8458/B0C2/R0017/Ceiling Structures/Linings/S2					Vermiculite Ceilings may contain asbestos. Asbestos testing MUST be conducted prior to any disturbance works	
B0C1 - R0018 - Movement (85.31 m2)						
Floor Coverings Res/Textile	Vinyl Tiles	86m2	Throughout	Good Condition (1)	Low (1)	Low Priority (2-3)
8458/B0C2/R0017/Floor Coverings Res/Textile/S3					Chrysotile (white asbestos)	
Ceiling Structures/Linings	Vermiculite					Limited Samples Taken
8458/B0C2/R0017/Ceiling Structures/Linings/S2					Vermiculite Ceilings may contain asbestos. Asbestos testing MUST be conducted prior to any disturbance works	
B0C1 - R0019 - External Movement (0.96 m2)						
No Asbestos						
B0C1 - R0020 - External Movement (0.96 m2)						
No Asbestos						
B0C1 - R0021 - Stairs (5.72 m2)						
No Asbestos						
B0C1 - R0022 - External Movement (51.72 m2)						
No Asbestos						
B0C1 - R0023 - General Storeroom (10.85 m2)						
No Asbestos						
B0C1 - R0024 - External Stairs (16.9 m2)						
No Asbestos						
B0C1 - R1001 - Staff Study (39.67 m2)						
No Asbestos						
B0C1 - R1002 - Interview/Office - Type 1 (10.8 m2)						
No Asbestos						
B0C1 - R1003 - Cleaning Store - Distributed (3.71 m2)						
No Asbestos						
B0C1 - R1004 - Distribution Board Cupboard (1.19 m2)					Note: No inspection of live electrical installation.	

Product	Material Description	Extent	Location Reference	Material Condition	Risk Status	Control Priority
Sample No					Test Result	

No Asbestos

B0C1 - R1005 - Movement (28.35 m2)

No Asbestos

B0C1 - R1006 - Movement (2 m2)

Ceiling Structures/Linings	Flat AC Sheeting	2m2	Throughout	Good Condition (1)	Low (1)	Low Priority (2-3)
----------------------------	------------------	-----	------------	--------------------	---------	--------------------

8458/B0C2/R1008/Ceiling Structures/Linings/S4

Chrysotile (white asbestos)

B0C1 - R1007 - General Learning Space (53.73 m2)

No Asbestos

B0C1 - R1008 - General Storeroom (19 m2)

No Asbestos

B0C1 - R1009 - General Learning Space (53.51 m2)

No Asbestos

B0C1 - R1010 - General Learning Space (53.51 m2)

No Asbestos

B0C1 - R1011 - General Learning Space (53.51 m2)

No Asbestos

B0C1 - R1012 - General Learning Space (53.51 m2)

No Asbestos

B0C1 - R1013 - Staff Study (19 m2)

No Asbestos

B0C1 - R1014 - General Learning Space (53.5 m2)

No Asbestos

B0C1 - R1015 - General Learning Space (53.5 m2)

No Asbestos

B0C1 - R1016 - Movement (17.63 m2)

Floor Coverings Res/Textile	Vinyl Tiles	18m2	Throughout	Good Condition (1)	Low (1)	Low Priority (2-3)
-----------------------------	-------------	------	------------	--------------------	---------	--------------------

8458/B0C2/R0017/Floor Coverings Res/Textile/S3

Chrysotile (white asbestos)

B0C1 - R1019 - Stairs (9.24 m2)

No Asbestos

B0C1 - R1020 - External Movement (52.19 m2)

No Asbestos

B0C1 - R1021 - External Stairs (23.47 m2)

No Asbestos

2017

Product	Material Description	Extent	Location Reference	Material Condition	Risk Status	Control Priority
Sample No				Test Result		
B0C2 - General Learning - 1970 - Brick/Block (Brick/Block)						
Exterior						
Ceiling Voids	No Asbestos Found					
Underfloor Voids	No Asbestos Found					
Interior						
B0C2 - R0001 - General Learning Space (53.43 m2)						
Ceiling Structures/Linings	Vermiculite					
	8458/B0C2/R0017/Ceiling Structures/Linings/S2					Limited Samples Taken
<i>Vermiculite Ceilings may contain asbestos. Asbestos testing MUST be conducted prior to any disturbance works</i>						
B0C2 - R0002 - General Learning Space (52.85 m2)						
Ceiling Structures/Linings	Vermiculite					
	8458/B0C2/R0017/Ceiling Structures/Linings/S2					Limited Samples Taken
<i>Vermiculite Ceilings may contain asbestos. Asbestos testing MUST be conducted prior to any disturbance works</i>						
B0C2 - R0003 - Duplicating Workroom (39.38 m2)						
Ceiling Structures/Linings	Vermiculite					
	8458/B0C2/R0017/Ceiling Structures/Linings/S2					Limited Samples Taken
<i>Vermiculite Ceilings may contain asbestos. Asbestos testing MUST be conducted prior to any disturbance works</i>						
B0C2 - R0004 - General Learning Space (52.41 m2)						
Ceiling Structures/Linings	Vermiculite					
	8458/B0C2/R0017/Ceiling Structures/Linings/S2					Limited Samples Taken
<i>Vermiculite Ceilings may contain asbestos. Asbestos testing MUST be conducted prior to any disturbance works</i>						
B0C2 - R0005 - General Learning Space (53.58 m2)						
Ceiling Structures/Linings	Vermiculite					
	8458/B0C2/R0017/Ceiling Structures/Linings/S2					Limited Samples Taken
<i>Vermiculite Ceilings may contain asbestos. Asbestos testing MUST be conducted prior to any disturbance works</i>						
B0C2 - R0006 - General Learning Space (53.58 m2)						
Ceiling Structures/Linings	Vermiculite					
	8458/B0C2/R0017/Ceiling Structures/Linings/S2					Limited Samples Taken
<i>Vermiculite Ceilings may contain asbestos. Asbestos testing MUST be conducted prior to any disturbance works</i>						
B0C2 - R0007 - General Storeroom (11.22 m2)						
Ceiling Structures/Linings	Vermiculite					
	8458/B0C2/R0017/Ceiling Structures/Linings/S2					Limited Samples Taken
<i>Vermiculite Ceilings may contain asbestos. Asbestos testing MUST be conducted prior to any disturbance works</i>						
B0C2 - R0008 - General Learning Space (49.98 m2)						
Ceiling Structures/Linings	Vermiculite					
	8458/B0C2/R0017/Ceiling Structures/Linings/S2					Limited Samples Taken
<i>Vermiculite Ceilings may contain asbestos. Asbestos testing MUST be conducted prior to any disturbance works</i>						
B0C2 - R0009 - Cleaning Store - Distributed (3.24 m2)						
Ceiling Structures/Linings	Vermiculite					
	8458/B0C2/R0017/Ceiling Structures/Linings/S2					Limited Samples Taken
<i>Vermiculite Ceilings may contain asbestos. Asbestos testing MUST be conducted prior to any disturbance works</i>						
B0C2 - R0010 - Staff Study (11.12 m2)						
Ceiling Structures/Linings	Vermiculite					
	8458/B0C2/R0017/Ceiling Structures/Linings/S2					Limited Samples Taken
<i>Vermiculite Ceilings may contain asbestos. Asbestos testing MUST be conducted prior to any disturbance works</i>						
B0C2 - R0011 - Distribution Board Cupboard (0.86 m2)						
Note: No inspection of live electrical installation.						
Fibre cement sheeting Debris on floor	Flat AC Sheeting	<1m2	Throughout	Poor Condition - Extensive Damage (4)	High (3)	High Priority (6-8)
	8458/B0C2/R0011/Fibre cement sheeting Debris on floor/S25					Chrysotile (white asbestos)
Infill panel above Doors	Flat AC Sheeting	1m2	Throughout	Minimal Damage (2)	Medium (2)	Medium Priority (4-5)
	8458/B0C2/R0011/Infill panel above Doors/S26					Chrysotile (white asbestos)

Product	Material Description	Extent	Location Reference	Material Condition	Risk Status	Control Priority
Sample No					Test Result	
Electrical Backing Board	Resinous Board	<1m2	East	Minimal Damage (2)	Low (1)	Low Priority (2-3)
8458/B0C2/R0011/Electrical Backing Board/S24					Chrysotile (white asbestos)	
B0C2 - R0012 - General Storeroom (32.24 m2)						
Ceiling Structures/Linings	Vermiculite					Limited Samples Taken
8458/B0C2/R0017/Ceiling Structures/Linings/S2					Vermiculite Ceilings may contain asbestos. Asbestos testing MUST be conducted prior to any disturbance works	
B0C2 - R0013 - Staff - Toilet (7.16 m2)						
Ceiling Structures/Linings	Vermiculite					Limited Samples Taken
8458/B0C2/R0017/Ceiling Structures/Linings/S2					Vermiculite Ceilings may contain asbestos. Asbestos testing MUST be conducted prior to any disturbance works	
B0C2 - R0014 - Sport Equipment Store (5.19 m2)						
Ceiling Structures/Linings	Vermiculite					Limited Samples Taken
8458/B0C2/R0017/Ceiling Structures/Linings/S2					Vermiculite Ceilings may contain asbestos. Asbestos testing MUST be conducted prior to any disturbance works	
B0C2 - R0015 - Staff - Toilet (5.24 m2)						
Ceiling Structures/Linings	Vermiculite					Limited Samples Taken
8458/B0C2/R0017/Ceiling Structures/Linings/S2					Vermiculite Ceilings may contain asbestos. Asbestos testing MUST be conducted prior to any disturbance works	
B0C2 - R0016 - External Movement (2.45 m2)						
No Asbestos						
B0C2 - R0017 - Movement (85.51 m2)						
Floor Coverings Res/Textile	Vinyl Tiles	86m2	Throughout	Good Condition (1)	Low (1)	Low Priority (2-3)
8458/B0C2/R0017/Floor Coverings Res/Textile/S3					Chrysotile (white asbestos)	
Ceiling Structures/Linings	Vermiculite					Limited Samples Taken
8458/B0C2/R0017/Ceiling Structures/Linings/S2					Vermiculite Ceilings may contain asbestos. Asbestos testing MUST be conducted prior to any disturbance works	
B0C2 - R0018 - External Movement (0.96 m2)						
No Asbestos						
B0C2 - R0019 - External Movement (0.96 m2)						
No Asbestos						
B0C2 - R0020 - Stairs (5.68 m2)						
No Asbestos						
B0C2 - R0021 - External Movement (62.18 m2)						
No Asbestos						
B0C2 - R0022 - Cleaning Store - Distributed (10.85 m2)						
No Asbestos						
B0C2 - R0023 - External Stairs (16.33 m2)						
No Asbestos						
B0C2 - R1001 - General Learning Space (53.87 m2)						
No Asbestos						
B0C2 - R1002 - General Storeroom (18.83 m2)						
No Asbestos						
B0C2 - R1003 - Distribution Board Cupboard (1.19 m2)						
					Note: No inspection of live electrical installation.	
Electrical Backing Board	Resinous Board	1Unit	Throughout	Minimal Damage (2)	Low (1)	Low Priority (2-3)
					Assumed Asbestos - Electrical Hazard	
B0C2 - R1004 - Cleaning Store - Distributed (3.71 m2)						
No Asbestos						
B0C2 - R1005 - General Storeroom (10.79 m2)						
No Asbestos						

Product	Material Description	Extent	Location Reference	Material Condition	Risk Status	Control Priority
Sample No					Test Result	
B0C2 - R1006 - Staff Study (39.56 m2)						
No Asbestos						
B0C2 - R1007 - Movement (28.54 m2)						
Floor Coverings Res/Textile	Vinyl Tiles	29m2	Throughout	Good Condition (1)	Low (1)	Low Priority (2-3)
8458/B0C2/R0017/Floor Coverings Res/Textile/S3					Chrysotile (white asbestos)	
B0C2 - R1008 - External Movement (2.01 m2)						
Ceiling Structures/Linings	Flat AC Sheeting	2m2	Throughout	Good Condition (1)	Low (1)	Low Priority (2-3)
8458/B0C2/R1008/Ceiling Structures/Linings/S4					Chrysotile (white asbestos)	
B0C2 - R1009 - General Learning Space (53.06 m2)						
No Asbestos						
B0C2 - R1010 - General Learning Space (53.06 m2)						
No Asbestos						
B0C2 - R1011 - General Learning Space (53.21 m2)						
No Asbestos						
B0C2 - R1012 - General Learning Space (53.21 m2)						
No Asbestos						
B0C2 - R1013 - Movement (17.73 m2)						
Floor Coverings Res/Textile	Vinyl Tiles	18m2	Throughout	Good Condition (1)	Low (1)	Low Priority (2-3)
8458/B0C2/R0017/Floor Coverings Res/Textile/S3					Chrysotile (white asbestos)	
B0C2 - R1014 - Staff Study (18.85 m2)						
No Asbestos						
B0C2 - R1015 - Special Learning Space (53.58 m2)						
No Asbestos						
B0C2 - R1016 - Special Learning Space (53.58 m2)						
No Asbestos						
B0C2 - R1017 - Stairs (9.22 m2)						
No Asbestos						
B0C2 - R1018 - External Movement (62.18 m2)						
No Asbestos						
B0C2 - R1019 - External Stairs (22.57 m2)						
No Asbestos						

2017

Product	Material Description	Extent	Location Reference	Material Condition	Risk Status	Control Priority
Sample No					Test Result	

B0C3 - General Learning/Library - 1970 - Brick/Block (Brick/Block)**Exterior**

Ceiling Voids	No Asbestos Found
Underfloor Voids	No Asbestos Found

Interior**B0C3 - R0001 - Seminar (12.41 m2)**

No Asbestos

B0C3 - R0002 - Seminar (11.73 m2)

No Asbestos

B0C3 - R0003 - Senior Study (81.23 m2)

No Asbestos

B0C3 - R0004 - Seminar (17.73 m2)

No Asbestos

B0C3 - R0005 - Seminar (15.31 m2)

No Asbestos

B0C3 - R0007 - Security Store (6.59 m2)

No Asbestos

B0C3 - R0008 - Librarian (11.94 m2)

No Asbestos

B0C3 - R0009 - Computer Room (29.76 m2)

No Asbestos

B0C3 - R0010 - Workroom (45.61 m2)

No Asbestos

B0C3 - R0012 - Distribution Board Cupboard (1.06 m2)

Note: No inspection of live electrical installation.

No Asbestos

B0C3 - R0016 - Toilets-Boys (14.85 m2)

No Asbestos

B0C3 - R0017 - General Storeroom (4.25 m2)

No Asbestos

B0C3 - R0018 - Toilets-Girls (13.59 m2)

No Asbestos

B0C3 - R0019 - Cleaning Store - Distributed (1.43 m2)

No Asbestos

B0C3 - R0020 - Stairs (7.69 m2)

No Asbestos

B0C3 - R0021 - Movement (17.72 m2)

No Asbestos

B0C3 - R0022 - Computer Room (51.84 m2)

No Asbestos

B0C3 - R0023 - Computer Room (35.98 m2)

No Asbestos

B0C3 - R0024 - Entry (25.97 m2)

Decorative Coating Vermiculite
8458/B0C3/R0024/Decorative Coating/S27

Limited Samples Taken

Vermiculite Ceilings may contain asbestos. Asbestos testing MUST be conducted prior to any disturbance works**B0C3 - R0025 - Main Area (257.02 m2)**

Decorative Coating Vermiculite
8458/B0C3/R0025/Decorative Coating/S28

Limited Samples Taken

Vermiculite Ceilings may contain asbestos. Asbestos testing MUST be conducted prior to any disturbance works

Product	Material Description	Extent	Location Reference	Material Condition	Risk Status	Control Priority
Sample No					Test Result	
B0C3 - R0026 - External Movement (51 m2)						
No Asbestos						
B0C3 - R0027 - General Assistants (10.85 m2)						
No Asbestos						
B0C3 - R0028 - External Stairs (17.17 m2)						
No Asbestos						
B0C3 - R0029 - Toilets-Disabled (11.73 m2)						
No Asbestos						
B0C3 - R0030 - Lift (2.1 m2)						
No Asbestos						
B0C3 - R0031 - External Movement (23.65 m2)						
No Asbestos						
B0C3 - R0032 - Movement (24.01 m2)						
No Asbestos						
B0C3 - R0033 - Computer Room (39.67 m2)						
No Asbestos						
B0C3 - R0034 - Movement (31.55 m2)						
No Asbestos						
B0C3 - R1001 - General Learning Space (53.72 m2)						
No Asbestos						
B0C3 - R1002 - General Learning Space (53.72 m2)						
No Asbestos						
B0C3 - R1003 - Careers Advisers Office (19.25 m2)						
No Asbestos						
B0C3 - R1004 - Movement (16.65 m2)						
Floor Coverings Res/Textile	Vinyl Tiles	17m2	Throughout	Good Condition (1)	Low (1)	Low Priority (2-3)
8458/B0C3/R1004/Floor Coverings Res/Textile/S1					Chrysotile (white asbestos)	
B0C3 - R1005 - General Learning Space (68.02 m2)						
No Asbestos						
B0C3 - R1006 - General Learning Space (51 m2)						
No Asbestos						
B0C3 - R1007 - General Learning Space (54.53 m2)						
No Asbestos						
B0C3 - R1008 - General Storeroom (6.55 m2)						
No Asbestos						
B0C3 - R1009 - Cleaning Store - Distributed (6.64 m2)						
No Asbestos						
B0C3 - R1010 - Staff Study (40.11 m2)						
No Asbestos						
B0C3 - R1011 - Distribution Board Cupboard (1.15 m2)				Note: No inspection of live electrical installation.		
No Asbestos						
B0C3 - R1012 - General Storeroom (18.05 m2)						
No Asbestos						
B0C3 - R1013 - General Learning Space (53.43 m2)						
No Asbestos						
B0C3 - R1014 - General Learning Space (53.5 m2)						
No Asbestos						
B0C3 - R1015 - Movement (19.66 m2)						

Product	Material Description	Extent	Location Reference	Material Condition	Risk Status	Control Priority
	Sample No					Test Result

No Asbestos

B0C3 - R1016 - Stairs (4.48 m2)

No Asbestos

B0C3 - R1017 - External Movement (50.54 m2)

No Asbestos

B0C3 - R1018 - External Stairs (22.81 m2)

No Asbestos

B0C3 - R1019 - Lift (2.1 m2)

No Asbestos

B0C3 - R1020 - External Movement (12.21 m2)

No Asbestos

2017

Product	Material Description	Extent	Location Reference	Material Condition	Risk Status	Control Priority
Sample No					Test Result	

B0L1 - Science Learning - 1970 - Brick/Block (Brick/Block)**Exterior**

Ceiling Voids	No Asbestos Found
Underfloor Voids	No Asbestos Found

Interior**B0L1 - R0001 - Laboratory L.S. (91.84 m2)**

Ceiling Structures/Linings	Vermiculite					
	8458/B0L2/R1005/Ceiling Structures/Linings/S6					Limited Samples Taken
<i>Vermiculite Ceilings may contain asbestos. Asbestos testing MUST be conducted prior to any disturbance works</i>						

B0L1 - R0002 - Preparation (30.25 m2)

Floor Coverings Res/Textile	Vinyl Tiles	31m2	Throughout	Good Condition (1)	Low (1)	Low Priority (2-3)
	8458/B0L2/R1005/Floor Coverings Res/Textile/S5					Chrysotile (white asbestos)

Ceiling Structures/Linings	Vermiculite					
	8458/B0L2/R1005/Ceiling Structures/Linings/S6					Limited Samples Taken
<i>Vermiculite Ceilings may contain asbestos. Asbestos testing MUST be conducted prior to any disturbance works</i>						

B0L1 - R0003 - General Storeroom (3.5 m2)

Floor Coverings Res/Textile	Vinyl Tiles	4m2	Throughout	Good Condition (1)	Low (1)	Low Priority (2-3)
	8458/B0L2/R1005/Floor Coverings Res/Textile/S5					Chrysotile (white asbestos)

Ceiling Structures/Linings	Vermiculite					
	8458/B0L2/R1005/Ceiling Structures/Linings/S6					Limited Samples Taken
<i>Vermiculite Ceilings may contain asbestos. Asbestos testing MUST be conducted prior to any disturbance works</i>						

B0L1 - R0004 - Preparation (13.72 m2)

No Asbestos

B0L1 - R0005 - Lift (0.26 m2)

No Asbestos

B0L1 - R0006 - Laboratory L.S. (92.03 m2)

Ceiling Structures/Linings	Vermiculite					
	8458/B0L2/R1005/Ceiling Structures/Linings/S6					Limited Samples Taken
<i>Vermiculite Ceilings may contain asbestos. Asbestos testing MUST be conducted prior to any disturbance works</i>						

B0L1 - R0007 - Cleaning Store - Distributed (0.91 m2)

No Asbestos

B0L1 - R0008 - Distribution Board Cupboard (0.91 m2)

Note: No inspection of live electrical installation.

No Asbestos

B0L1 - R0009 - Movement (67.05 m2)

No Asbestos

B0L1 - R1001 - Laboratory L.S. (91.46 m2)

No Asbestos

B0L1 - R1003 - General Storeroom (3.5 m2)

Floor Coverings Res/Textile	Vinyl Tiles	4m2	Throughout	Good Condition (1)	Low (1)	Low Priority (2-3)
	8458/B0L2/R1005/Floor Coverings Res/Textile/S5					Chrysotile (white asbestos)

B0L1 - R1004 - Darkroom Space (13.71 m2)

Floor Coverings Res/Textile	Vinyl Tiles	14m2	Throughout	Good Condition (1)	Low (1)	Low Priority (2-3)
	8458/B0L2/R1005/Floor Coverings Res/Textile/S5					Chrysotile (white asbestos)

B0L1 - R1005 - Lift (0.27 m2)

No Asbestos

B0L1 - R1006 - Performance Workspace (91.72 m2)

No Asbestos

B0L1 - R1007 - Cleaning Store - Distributed (0.99 m2)

Product	Material Description	Extent	Location Reference	Material Condition	Risk Status	Control Priority
Sample No					Test Result	

No Asbestos

B0L1 - R1008 - Distribution Board Cupboard (0.99 m2) Note: No inspection of live electrical installation.

Ceiling Structures/Linings	Compressed AC Sheet	1m2	Throughout	Some Damage - Unsealed (3)	Medium (2)	Medium Priority (4-5)
8458/B0L1/R1008/Ceiling Structures/Linings/S29				Chrysotile (white asbestos) , Amosite (brown asbestos)		

B0L1 - R1009 - Movement (62.88 m2)

In-fill-panel	Compressed AC Sheet	4m	Above brick boxing	Some Damage / Unsealed (3)	Low (1)	Low Priority (2-3)
8458/B0L2/R1012/Panels above brick boxing/S7				Chrysotile (white asbestos)		

B0L1 - R1010 - Staff Kitchen (21.02 m2)

No Asbestos

B0L1 - R1011 - Performing Arts Changeroom (8.86 m2)

No Asbestos

B0L1 - R1012 - Plant (0.8 m2)

No Asbestos

2017

Product	Material Description	Extent	Location Reference	Material Condition	Risk Status	Control Priority
Sample No					Test Result	

B0L2 - Science Learning - 1970 - Brick/Block (Brick/Block)**Exterior**

Ceiling Voids	No Asbestos Found
Underfloor Voids	No Asbestos Found

Interior**B0L2 - R0001 - Cleaning Supplies Store (12.39 m2)**

No Asbestos

B0L2 - R0002 - Movement (2.34 m2)

No Asbestos

B0L2 - R0003 - General Storeroom (12.06 m2)

No Asbestos

B0L2 - R0004 - Laboratory L.S. (91.75 m2)

Ceiling Structures/Linings	Vermiculite					
	8458/B0L2/R1005/Ceiling Structures/Linings/S6					Limited Samples Taken
<i>Vermiculite Ceilings may contain asbestos. Asbestos testing MUST be conducted prior to any disturbance works</i>						

B0L2 - R0005 - Preparation (30.53 m2)

Floor Coverings Res/Textile	Vinyl Tiles	31m2	Throughout	Good Condition (1)	Low (1)	Low Priority (2-3)
	8458/B0L2/R1005/Floor Coverings Res/Textile/S5					Chrysotile (white asbestos)

Ceiling Structures/Linings	Vermiculite					
	8458/B0L2/R1005/Ceiling Structures/Linings/S6					Limited Samples Taken
<i>Vermiculite Ceilings may contain asbestos. Asbestos testing MUST be conducted prior to any disturbance works</i>						

B0L2 - R0006 - Lift (0.26 m2)

No Asbestos

B0L2 - R0007 - Apparatus Store (3.74 m2)

Floor Coverings Res/Textile	Vinyl Tiles	4m2	Throughout	Good Condition (1)	Low (1)	Low Priority (2-3)
	8458/B0L2/R1005/Floor Coverings Res/Textile/S5					Chrysotile (white asbestos)

Ceiling Structures/Linings	Vermiculite					
	8458/B0L2/R1005/Ceiling Structures/Linings/S6					Limited Samples Taken
<i>Vermiculite Ceilings may contain asbestos. Asbestos testing MUST be conducted prior to any disturbance works</i>						

B0L2 - R0008 - Preparation (13.17 m2)

Floor Coverings Res/Textile	Vinyl Tiles	14m2	Throughout	Good Condition (1)	Low (1)	Low Priority (2-3)
	8458/B0L2/R1005/Floor Coverings Res/Textile/S5					Chrysotile (white asbestos)

Ceiling Structures/Linings	Vermiculite					
	8458/B0L2/R1005/Ceiling Structures/Linings/S6					Limited Samples Taken
<i>Vermiculite Ceilings may contain asbestos. Asbestos testing MUST be conducted prior to any disturbance works</i>						

B0L2 - R0009 - Laboratory L.S. (91.75 m2)

No Asbestos

B0L2 - R0010 - Distribution Board Cupboard (0.6 m2)

Note: No inspection of live electrical installation.

Electrical Backing Board	Resinous Board	1Unit	Throughout	Minimal Damage (2)	Low (1)	Low Priority (2-3)
Assumed Asbestos - Electrical Hazard						Assumed Asbestos

B0L2 - R0011 - Cleaning Store - Distributed (0.6 m2)

No Asbestos

B0L2 - R0012 - Movement (67.73 m2)

No Asbestos

B0L2 - R1001 - Plant Space (11.67 m2)

No Asbestos

B0L2 - R1002 - Movement (2.38 m2)

No Asbestos

Product	Material Description	Extent	Location Reference	Material Condition	Risk Status	Control Priority
Sample No					Test Result	
B0L2 - R1003 - General Storeroom (12.17 m2)						
No Asbestos						
B0L2 - R1004 - Laboratory L.S. (91.75 m2)						
No Asbestos						
B0L2 - R1005 - Preparation (30.53 m2)						
Floor Coverings Res/Textile	Vinyl Tiles	31m2	Throughout	Good Condition (1)	Low (1)	Low Priority (2-3)
8458/B0L2/R1005/Floor Coverings Res/Textile/S5					Chrysotile (white asbestos)	
Ceiling Structures/Linings	Vermiculite					
8458/B0L2/R1005/Ceiling Structures/Linings/S6					Limited Samples Taken	
Vermiculite Ceilings may contain asbestos. Asbestos testing MUST be conducted prior to any disturbance works						
B0L2 - R1006 - Lift (0.26 m2)						
No Asbestos						
B0L2 - R1007 - Chemical Store (3.74 m2)						
Floor Coverings Res/Textile	Vinyl Tiles	4m2	Throughout	Good Condition (1)	Low (1)	Low Priority (2-3)
8458/B0L2/R1005/Floor Coverings Res/Textile/S5					Chrysotile (white asbestos)	
Ceiling Structures/Linings	Vermiculite					
8458/B0L2/R1005/Ceiling Structures/Linings/S6					Limited Samples Taken	
Vermiculite Ceilings may contain asbestos. Asbestos testing MUST be conducted prior to any disturbance works						
B0L2 - R1008 - Apparatus Store (13.17 m2)						
Floor Coverings Res/Textile	Vinyl Tiles	14m2	Throughout	Good Condition (1)	Low (1)	Low Priority (2-3)
8458/B0L2/R1005/Floor Coverings Res/Textile/S5					Chrysotile (white asbestos)	
Ceiling Structures/Linings	Vermiculite					
8458/B0L2/R1005/Ceiling Structures/Linings/S6					Limited Samples Taken	
Vermiculite Ceilings may contain asbestos. Asbestos testing MUST be conducted prior to any disturbance works						
B0L2 - R1009 - Laboratory L.S. (91.75 m2)						
Ceiling Structures/Linings	Vermiculite					
8458/B0L2/R1005/Ceiling Structures/Linings/S6					Limited Samples Taken	
Vermiculite Ceilings may contain asbestos. Asbestos testing MUST be conducted prior to any disturbance works						
B0L2 - R1010 - Distribution Board Cupboard (0.6 m2)						
Note: No inspection of live electrical installation.						
Ceiling Structures/Linings	Compressed AC Sheet	1m2	Throughout	Some Damage - Unsealed (3)	Medium (2)	Medium Priority (4-5)
8458/B0L2/R1010/Ceiling Structures/Linings/S30					Chrysotile (white asbestos) , Amosite (brown asbestos)	
B0L2 - R1011 - Lift (0.6 m2)						
No Asbestos						
B0L2 - R1012 - Movement (63.53 m2)						
In-fill-panel	Compressed AC Sheet	4m	Above brick boxing	Some Damage / Unsealed (3)	Low (1)	Low Priority (2-3)
8458/B0L2/R1012/Panels above brick boxing/S7					Chrysotile (white asbestos)	

Product	Material Description	Extent	Location Reference	Material Condition	Risk Status	Control Priority
Sample No					Test Result	

Build+1 - Added Building

Exterior

No Asbestos

2017

Product	Material Description	Extent	Location Reference	Material Condition	Risk Status	Control Priority
Sample No					Test Result	

Build+2 - Added Building

Exterior

No Asbestos

2017

Product	Material Description	Extent	Location Reference	Material Condition	Risk Status	Control Priority
Sample No					Test Result	

Build+3 - Added Building

Exterior

No Asbestos

2017

Product	Material Description	Extent	Location Reference	Material Condition	Risk Status	Control Priority
Sample No					Test Result	

Build+4 - Added Building

Exterior

No Asbestos

2017

Product	Material Description	Extent	Location Reference	Material Condition	Risk Status	Control Priority
Sample No					Test Result	

Demountables

There are no Demountable(s) located at this school as per the AMS records as of 15 Feb 2017.

2017

Product	Material Description	Extent	Location Reference	Material Condition	Risk Status	Control Priority
Sample No					Test Result	

Listing of Electronic Attachments as of 22/03/2017

There are no asbestos related file attachment(s) for this school.

2017