

Asbestos Register

(Hazardous Materials and Risk Assessment)

School : Kurrajong Public School (2342)
Region : Western Sydney
State Electorate : Hawkesbury
Local Government Area : Hawkesbury

Initial Survey : Noel Arnold & Associates : 16 - May - 2008
Reviewed By : Greencap-NAA : 22 - Jun - 2015

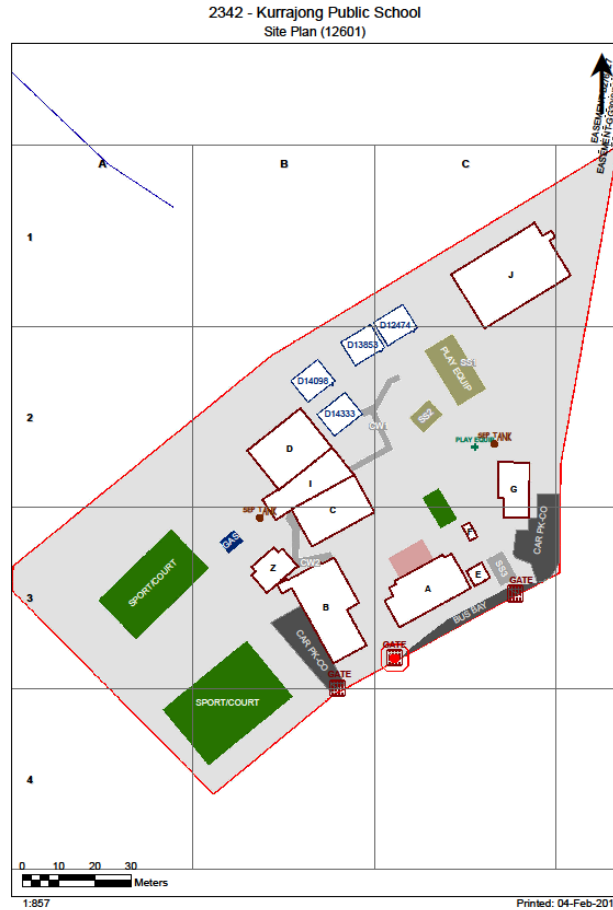

2017

Product	Material Description	Extent	Location Reference	Material Condition	Risk Status	Control Priority
Sample No					Test Result	

B00A - General Learning/Administration - 1963 - Brick/Veneer (Brick/Veneer)**Exterior**

Eaves Linings	Flat AC Sheeting	30m2	East, West	Good Condition (1)	Low (1)	Low Priority (2-3)
	2342/B00A/R0001/Ceiling Structures/Linings/S25				Chrysotile (white asbestos) , Amosite (brown asbestos) , Crocidolite (blue asbestos)	
Gable Verge Lining	Flat AC Sheeting	20m2	North, South	Good Condition (1)	Low (1)	Low Priority (2-3)
	2342/B00A/R0001/Ceiling Structures/Linings/S25				Chrysotile (white asbestos) , Amosite (brown asbestos) , Crocidolite (blue asbestos)	
Underfloor Voids	No Asbestos Found					
Ceiling Voids	No Asbestos Found					

Interior**B00A - R0001 - Movement**

Ceiling Structures/Linings	Flat AC Sheeting	5m2	Throughout	Good Condition (1)	Low (1)	Low Priority (2-3)
	2342/B00A/R0001/Ceiling Structures/Linings/S25				Chrysotile (white asbestos) , Amosite (brown asbestos) , Crocidolite (blue asbestos)	

B00A - R0002 - Movement

No Asbestos

B00A - R0003 - Personal Effects Storage

No Asbestos

B00A - R0004 - Home Base Store

Electrical Backing Board	Resinous Board	1Unit	North	Good Condition (1)	Low (1)	Low Priority (2-3)
	Assumed Asbestos - Electrical Hazard					

B00A - R0005 - Home Base

Heater Backing	Compressed AC Sheet	2m2	North lower portion	Good Condition (1)	Low (1)	Low Priority (2-3)
	2342/B00A/R0005/Heater Backing/S22				Chrysotile (white asbestos)	

B00A - R0006 - Home Base

Heater Backing	Compressed AC Sheet	2m2	South lower portion	Good Condition (1)	Low (1)	Low Priority (2-3)
	2342/B00A/R0005/Heater Backing/S22				Chrysotile (white asbestos)	

B00A - R0007 - Home Base Store

No Asbestos

B00A - R0008 - General Storeroom

No Asbestos

B00A - R0009 - Movement

Floor Coverings Res/Textile	Vinyl Tiles (Under Floor Covering/Carpet)					No Asbestos Detected
	2342/B00A/R0009/Floor Coverings Res/Textile/S23					

Floor Coverings Res/Textile	Adhesive					No Asbestos Detected
	2342/B00A/R0009/Floor Coverings Res/Textile/S24					

B00A - R0010 - Principal

Floor Coverings Res/Textile	Vinyl Sheet					No Asbestos Detected
	2342/B00A/R0010/Floor Coverings Res/Textile/S20					

Floor Coverings Res/Textile	Underlay					No Asbestos Detected
	2342/B00A/R0010/Floor Coverings Res/Textile/S21					

B00A - R0011 - Clerical Office

No Asbestos

B00A - R0012 - Movement

Product	Material Description	Extent	Location Reference	Material Condition	Risk Status	Control Priority
Sample No					Test Result	
Ceiling Structures/Linings	Flat AC Sheeting	5m2	Throughout	Good Condition (1)	Low (1)	Low Priority (2-3)
2342/B00A/R0001/Ceiling Structures/Linings/S25				Chrysotile (white asbestos) , Amosite (brown asbestos) , Crocidolite (blue asbestos)		

B00A - R0013 - External Movement

No Asbestos

B00A - R9001 - General Assistant/Bulk Store

No Asbestos

2017

Product	Material Description	Extent	Location Reference	Material Condition	Risk Status	Control Priority
Sample No					Test Result	

B00B - General Learning/Pupil Facilities - 1971 - Brick/Block (Brick/Block)**Exterior**

Eaves Linings	Flat AC Sheeting	10m2	South	Good Condition (1)	Low (1)	Low Priority (2-3)
	2342/B00B/R0002/Ceiling Structures/Linings/S14				Chrysotile (white asbestos)	
Gable Verge Lining	Flat AC Sheeting	20m2	East, West	Good Condition (1)	Low (1)	Low Priority (2-3)
	2342/B00B/R0002/Ceiling Structures/Linings/S14				Chrysotile (white asbestos)	
In-fill-panel	Flat AC Sheeting	22m2	North, South, Lower portion	Good Condition (1)	Low (1)	Low Priority (2-3)
	2342/B00B/In-fill-panel/S2				Chrysotile (white asbestos)	
Ceiling Voids	No Asbestos Found					
Underfloor Voids	No Asbestos Found					

Interior**B00B - R0001 - Toilets - Boys/Girls**

No Asbestos

B00B - R0002 - External Movement

Ceiling Structures/Linings	Flat AC Sheeting	44m2	Throughout	Good Condition (1)	Low (1)	Low Priority (2-3)
	2342/B00B/R0002/Ceiling Structures/Linings/S14				Chrysotile (white asbestos)	

B00B - R0003 - Special Programs Room

Floor Coverings Res/Textile	Vinyl Tiles	29m2	Throughout	Good Condition (1)	Low (1)	Low Priority (2-3)
	2342/B00B/R0003/Floor Coverings Res/Textile/S3				Chrysotile (white asbestos)	
Floor Coverings Res/Textile	Adhesive					
	2342/B00B/R0003/Floor Coverings Res/Textile/S15				No Asbestos Detected	

B00B - R0004 - Personal Effects Storage

No Asbestos

B00B - R0005 - Home Base Store

No Asbestos

B00B - R0006 - Home Base

No Asbestos

B00B - R0007 - Home Base

No Asbestos

B00B - R0008 - Practical Activities - 1hb

No Asbestos

B00B - R0009 - Toilets - Boys/Girls

No Asbestos

B00B - R0010 - Home Base Store

No Asbestos

B00B - R0011 - Personal Effects Storage

No Asbestos

B00B - R0012 - External Movement

No Asbestos

B00B - R9002 - Canteen

Heat Pad	Resinous Membrane					
	2342/B00B/R9002/Heat Pad/S16				No Asbestos Detected	
Sink Heat Pad	Bituminous adhesive attached to S16	0.5m2	South	Good Condition (1)	Low (1)	Low Priority (2-3)
	2342/B00B/R9002/Sink Heat Pad/S26				Chrysotile (white asbestos)	

B00B - R9003 - Special Programs Room

No Asbestos

B00B - R9005 - Garden Store

Product	Material Description	Extent	Location Reference	Material Condition	Risk Status	Control Priority
Sample No					Test Result	

No Asbestos

B00B - R9006 - Garden Store

No Asbestos

B00B - R9007 - Canteen Covered Area

Wall Linings Internal	Flat AC Sheeting					
	2342/B00B/R9010/Wall Linings Internal/S17					No Asbestos Detected

B00B - R9008 - General Storeroom

Wall Linings Internal	Flat AC Sheeting					
	2342/B00B/R9010/Wall Linings Internal/S17					No Asbestos Detected

B00B - R9009 - External Movement

No Asbestos

B00B - R9010 - General Storeroom

Wall Linings Internal	Flat AC Sheeting					
	2342/B00B/R9010/Wall Linings Internal/S17					No Asbestos Detected

2017

Product	Material Description	Extent	Location Reference	Material Condition	Risk Status	Control Priority
Sample No					Test Result	

B00C - Library - 1963 - Brick/Veneer (Brick/Veneer)

Exterior

Ceiling Voids - Raked Ceiling	Non Accessible Area - Area inaccessible
Underfloor Voids - Slab on Ground	Non Accessible Area - Area inaccessible

Interior

B00C - R0001 - Movement

No Asbestos

B00C - R0002 - Communications Room

No Asbestos

B00C - R0003 - Library Office/Workroom

Floor Coverings Res/Textile	Vinyl Tiles					No Asbestos Detected
2342/B00C/R0003/Floor Coverings Res/Textile/S5						

B00C - R0004 - Distribution Board

Note: No inspection of live electrical installation.

Wall Linings Internal	Flat AC Sheeting	8m2	North, West	Good Condition (1)	Low (1)	Low Priority (2-3)
2342/B00C/R0004/Wall Linings Internal/S18						Chrysotile (white asbestos)

B00C - R0005 - Reading Area

No Asbestos

2017

Product	Material Description	Extent	Location Reference	Material Condition	Risk Status	Control Priority
Sample No					Test Result	

B00D - General Learning - 1963 - Brick/Veneer (Brick/Veneer)

Exterior

Underfloor Voids	No Asbestos Found
Ceiling Voids	No Asbestos Found

Interior

B00D - R0001 - Home Base Store

No Asbestos

B00D - R0002 - Home Base

No Asbestos

B00D - R0003 - Practical Activities - 1hb

No Asbestos

B00D - R0004 - Movement

No Asbestos

B00D - R0005 - Practical Activities - 1hb

No Asbestos

B00D - R0006 - Home Base

No Asbestos

B00D - R0007 - Home Base Store

No Asbestos

B00D - R0008 - Movement

No Asbestos

B00D - R0009 - Withdrawal Space - 1hb

No Asbestos

B00D - R0010 - Movement

No Asbestos

2017

Product	Material Description	Extent	Location Reference	Material Condition	Risk Status	Control Priority
Sample No					Test Result	

B00E - Administration - 1963 - Fibre Cement Clad (Fibre Cement Clad)

Exterior

Eaves Linings	Flat AC Sheeting 2342/B00E/R0002/Ceiling Structures/Linings/S12					No Asbestos Detected
Wall Cladding	Flat AC Sheeting 2342/B00E/Wall Cladding/S7					No Asbestos Detected
Ceiling Voids - Flat Roof	Non Accessible Area - Area inaccessible					
Underfloor Voids	Packing 2342/B00E/Underfloor Voids/S11	1m2	Variable positions	Minimal Damage (2)	Low (1) Low Priority (2-3)	Chrysotile (white asbestos)
Entry Ramp	Compressed AC Sheet 2342/B00E/Entry Ramp/S13					No Asbestos Detected

Interior

B00E - R0001 - Community Clinic

Wall Linings Internal	Flat AC Sheeting 2342/B00G/R0004/Wall Linings Internal/S6	14m2	Throughout	Good Condition (1)	Low (1) Low Priority (2-3)	Chrysotile (white asbestos)
Ceiling Structures/Linings	Flat AC Sheeting 2342/B00E/R0002/Ceiling Structures/Linings/S12					No Asbestos Detected
Floor Coverings Res/Textile	Vinyl Tiles 2342/B00E/R0001/Floor Coverings Res/Textile/S8					No Asbestos Detected

B00E - R0002 - Community Clinic

Wall Linings Internal	Flat AC Sheeting 2342/B00G/R0004/Wall Linings Internal/S6	20m2	Throughout	Good Condition (1)	Low (1) Low Priority (2-3)	Chrysotile (white asbestos)
Ceiling Structures/Linings	Flat AC Sheeting 2342/B00E/R0002/Ceiling Structures/Linings/S12					No Asbestos Detected
Floor Coverings Res/Textile	Vinyl Tiles 2342/B00E/R0001/Floor Coverings Res/Textile/S8					No Asbestos Detected

B00E - R0003 - Community Clinic

Wall Linings Internal	Flat AC Sheeting 2342/B00G/R0004/Wall Linings Internal/S6	10m2	Throughout	Good Condition (1)	Low (1) Low Priority (2-3)	Chrysotile (white asbestos)
Ceiling Structures/Linings	Flat AC Sheeting 2342/B00E/R0002/Ceiling Structures/Linings/S12					No Asbestos Detected
Floor Coverings Res/Textile	Vinyl Tiles 2342/B00E/R0001/Floor Coverings Res/Textile/S8					No Asbestos Detected

2017

Product	Material Description	Extent	Location Reference	Material Condition	Risk Status	Control Priority
Sample No					Test Result	

B00F - Shed - 1950 - Timber Shed (Timber Shed)

Exterior

Ceiling Voids	No Asbestos Found
Underfloor Voids - Slab on Ground	Non Accessible Area - Area inaccessible

Interior

B00F - R0001 - Sports Store

Wall Linings Internal	Flat AC Sheeting 2342/B00F/R0001/Wall Linings Internal/S4	No Asbestos Detected
-----------------------	--	-----------------------------

2017

Product	Material Description	Extent	Location Reference	Material Condition	Risk Status	Control Priority
Sample No					Test Result	

B00G - Administration - 1999 - Brick/Veneer (Brick/Veneer)

Exterior

Eaves Linings	Flat AC Sheeting	20m2	Throughout	Good Condition (1)	Low (1)	Low Priority (2-3)
	2342/B00G/R0004/Wall Linings Internal/S6					Chrysotile (white asbestos)
Ceiling Voids	No Asbestos Found					
Underfloor Voids	No Asbestos Found					

Interior

B00G - R0001 - Entry Vestibule

Floor Coverings Res/Textile	Vinyl Sheet					
	2342/B00G/R0009/Floor Coverings Res/Textile/S9					No Asbestos Detected

B00G - R0002 - Clerical Office

No Asbestos

B00G - R0003 - Movement

Floor Coverings Res/Textile	Vinyl Sheet					
	2342/B00G/R0009/Floor Coverings Res/Textile/S9					No Asbestos Detected

B00G - R0004 - Staff Toilet

Wall Linings Internal	Flat AC Sheeting	12m2	Throughout	Good Condition (1)	Low (1)	Low Priority (2-3)
	2342/B00G/R0004/Wall Linings Internal/S6					Chrysotile (white asbestos)

B00G - R0005 - Sick Bay

Floor Coverings Res/Textile	Vinyl Sheet					
	2342/B00G/R0009/Floor Coverings Res/Textile/S9					No Asbestos Detected

B00G - R0006 - Staff Shower/Change

Wall Linings Internal	Flat AC Sheeting	14m2	Throughout	Good Condition (1)	Low (1)	Low Priority (2-3)
	2342/B00G/R0004/Wall Linings Internal/S6					Chrysotile (white asbestos)
Ceiling Structures/Linings	Flat AC Sheeting	4m2	Throughout	Good Condition (1)	Low (1)	Low Priority (2-3)
	2342/B00G/R0011/Ceiling Structures/Linings/S10					Chrysotile (white asbestos)

B00G - R0007 - Cleaning Supplies

Ceiling Structures/Linings	Flat AC Sheeting	1m2	Throughout	Good Condition (1)	Low (1)	Low Priority (2-3)
	2342/B00G/R0011/Ceiling Structures/Linings/S10					Chrysotile (white asbestos)

B00G - R0008 - Principal

Floor Coverings Res/Textile	Vinyl Sheet					
	2342/B00G/R0009/Floor Coverings Res/Textile/S9					No Asbestos Detected

B00G - R0009 - Staff Room

Floor Coverings Res/Textile	Vinyl Sheet					
	2342/B00G/R0009/Floor Coverings Res/Textile/S9					No Asbestos Detected

B00G - R0010 - Staff Kitchen

Wall Linings Internal	Flat AC Sheeting	20m2	Throughout	Good Condition (1)	Low (1)	Low Priority (2-3)
	2342/B00G/R0004/Wall Linings Internal/S6					Chrysotile (white asbestos)

B00G - R0011 - Duplicating Workroom

Wall Linings Internal	Flat AC Sheeting	10m2	Throughout	Good Condition (1)	Low (1)	Low Priority (2-3)
	2342/B00G/R0004/Wall Linings Internal/S6					Chrysotile (white asbestos)
Ceiling Structures/Linings	Flat AC Sheeting	5m2	Throughout	Good Condition (1)	Low (1)	Low Priority (2-3)
	2342/B00G/R0011/Ceiling Structures/Linings/S10					Chrysotile (white asbestos)

B00G - R0012 - Security Store

Product	Material Description	Extent	Location Reference	Material Condition	Risk Status	Control Priority
Sample No					Test Result	
Wall Linings Internal	Flat AC Sheeting	8m2	Throughout	Good Condition (1)	Low (1)	Low Priority (2-3)
2342/B00G/R0004/Wall Linings Internal/S6					Chrysotile (white asbestos)	
Ceiling Structures/Linings	Flat AC Sheeting	3m2	Throughout	Good Condition (1)	Low (1)	Low Priority (2-3)
2342/B00G/R0011/Ceiling Structures/Linings/S10					Chrysotile (white asbestos)	
B00G - R0013 - Movement						
Ceiling Structures/Linings	Flat AC Sheeting	3m2	Throughout	Good Condition (1)	Low (1)	Low Priority (2-3)
2342/B00G/R0011/Ceiling Structures/Linings/S10					Chrysotile (white asbestos)	

2017

Product	Material Description	Extent	Location Reference	Material Condition	Risk Status	Control Priority
Sample No					Test Result	

B001 - Pupil Facilities - 2008 - Brick/Veneer (Brick/Veneer)

Exterior

Ceiling Voids	No Asbestos Found
Underfloor Voids - Slab on Ground	Non Accessible Area - Area inaccessible

Interior

B001 - R0001 - Raised Platform

No Asbestos

B001 - R0002 - Stairs

No Asbestos

B001 - R0003 - Covered Outdoor Learning Area

No Asbestos

2017

Product	Material Description	Extent	Location Reference	Material Condition	Risk Status	Control Priority
Sample No					Test Result	

B00J - Pupil Facilities/Multi Purpose Facilities - 2010 - Brick/Veneer (Brick/Veneer)

Exterior

Ceiling Voids	No Asbestos Found
Underfloor Voids - Slab on Ground	Non Accessible Area - Area inaccessible

Interior

B00J - R0001 - Communal Space

No Asbestos

B00J - R0002 - Raised Platform

No Asbestos

B00J - R0003 - Chair Storeroom

No Asbestos

B00J - R0004 - Communal/Performance Store

No Asbestos

B00J - R0005 - P.E. Store

No Asbestos

B00J - R0006 - Toilet - Lobby

No Asbestos

B00J - R0007 - Toilets - Girls

No Asbestos

B00J - R0008 - Sound Cupboard

No Asbestos

B00J - R0009 - Toilet - Lobby

No Asbestos

B00J - R0010 - Toilets - Boys

No Asbestos

B00J - R0011 - Cleaning Distributed Store

No Asbestos

B00J - R0012 - Plant

No Asbestos

B00J - R0013 - Main Switch Board

No Asbestos

B00J - R0014 - Access Shower/Toilet/Change

No Asbestos

B00J - R0015 - Covered Outdoor Learning Area

No Asbestos

B00J - R0016 - Movement

No Asbestos

B00J - R0017 - Movement

No Asbestos

B00J - R0018 - Ramp

No Asbestos

B00J - R0019 - External Movement

No Asbestos



Product	Material Description	Extent	Location Reference	Material Condition	Risk Status	Control Priority
Sample No					Test Result	

B00Z - Pupil Facilities - 1963 - Brick/Block (Brick/Block)

Exterior

Eaves Linings	Flat AC Sheeting	10m2	Throughout	Good Condition (1)	Low (1)	Low Priority (2-3)
	2342/B00Z/Eaves Linings/S19					Chrysotile (white asbestos)
Underfloor Voids - Slab on Ground	Non Accessible Area - Area inaccessible					
Ceiling Voids - Flat Roof	Non Accessible Area - Area inaccessible					

Interior

B00Z - R0001 - External Movement

No Asbestos

B00Z - R0002 - Toilets - Girls

Partition Walls (Cubicles)	Compressed AC Sheet 2342/B00Z/R0002/Partition Walls (Cubicles)/S1					No Asbestos Detected
Ceiling Structures/Linings	Flat AC Sheeting	19m2	Throughout	Good Condition (1)	Low (1)	Low Priority (2-3)
	2342/B00Z/Eaves Linings/S19					Chrysotile (white asbestos)

B00Z - R0003 - Toilets - Boys

Partition Walls (Cubicles)	Compressed AC Sheet 2342/B00Z/R0002/Partition Walls (Cubicles)/S1					No Asbestos Detected
Ceiling Structures/Linings	Flat AC Sheeting	19m2	Throughout	Good Condition (1)	Low (1)	Low Priority (2-3)
	2342/B00Z/Eaves Linings/S19					Chrysotile (white asbestos)

B00Z - R0004 - External Movement

No Asbestos

B00Z - R0005 - External Movement

No Asbestos

2017

Product	Material Description	Extent	Location Reference	Material Condition	Risk Status	Control Priority
Sample No					Test Result	

Demountables

Demountable details as per the AMS records as of 15 Feb 2017.

OS 602 - D12474 - Learning Unit - Standard With P.A.A. : Placement Date - 7/02/2014

Note: This refurbished demountable may have asbestos present in remnant mastic in window frames.

Exterior

No Asbestos Found.

Interior

R1 - Learning space/withdrawal/entry

No Asbestos Found.

R2 - Home Base Store

No Asbestos Found.

OS 602 - D13853 - Learning Unit - Standard With P.A.A. : Placement Date - 30/12/2011

Note: This refurbished demountable may have asbestos present in remnant mastic in window frames.

Exterior

No Asbestos Found.

Interior

R1 - Learning space/withdrawal/entry

No Asbestos Found.

R2 - Home Base Store

No Asbestos Found.

OS 601 - D14098 - Learning Unit - Standard/Withdrawal : Placement Date - 18/04/2008

Exterior

Step Treads	Compressed AC Sheet	Assumed Asbestos	1.08 m2
Landing	Compressed AC Sheet	Assumed Asbestos	1.2 m2
Eave Lining	Flat AC Sheet	Assumed Asbestos	11.52 m2

Interior

R1 - Entry

End wall panel	Flat AC Sheet	Assumed Asbestos	18 m2
Ceiling	Flat AC Sheet	Assumed Asbestos	8 m2

R2 - General Learning Space

End wall panel	Flat AC Sheet	Assumed Asbestos	18 m2
Ceiling	Flat AC Sheet	Assumed Asbestos	55 m2

R3 - Store

Ceiling	Flat AC Sheet	Assumed Asbestos	10 m2
---------	---------------	------------------	-------

OS 601 - D14333 - Learning Unit - Standard/Withdrawal : Placement Date - 30/06/1995

Exterior

Step Treads	Compressed AC Sheet	Assumed Asbestos	1.08 m2
Landing	Compressed AC Sheet	Assumed Asbestos	1.2 m2
Eave Lining	Flat AC Sheet	Assumed Asbestos	11.52 m2

Product	Material Description	Extent	Location Reference	Material Condition	Risk Status	Control Priority
Sample No					Test Result	
Interior						
R1 - Entry						
End wall panel	Flat AC Sheet	Assumed Asbestos				18 m2
Ceiling	Flat AC Sheet	Assumed Asbestos				8 m2
R2 - General Learning Space						
End wall panel	Flat AC Sheet	Assumed Asbestos				18 m2
Ceiling	Flat AC Sheet	Assumed Asbestos				55 m2
R3 - Store						
Ceiling	Flat AC Sheet	Assumed Asbestos				10 m2

2017

Product	Material Description	Extent	Location Reference	Material Condition	Risk Status	Control Priority
Sample No					Test Result	

Listing of Electronic Attachments as of 22/03/2017

Available Asbestos Related Electronic Files

2342_ASB_231112_AMP.pdf

* Note : Refer to AMS for details of the attachment(s).

2017