

Asbestos Register

(Hazardous Materials and Risk Assessment)

School : Kandos Public School (2254)
Region : Western NSW
State Electorate : Bathurst
Local Government Area : Mid-Western

Initial Survey : Noel Arnold & Associates : 27 - May - 2008
Reviewed By : Grencap-NAA : 17 - Apr - 2015

2254 - Kandos Public School
Site Plan (11754)

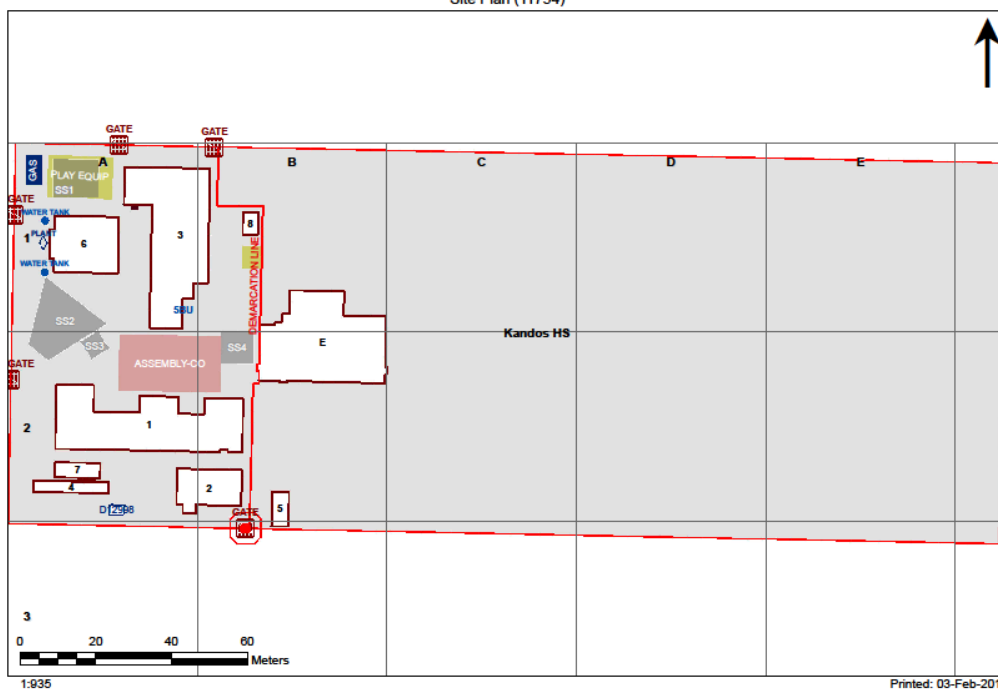

1:936

Printed: 03-Feb-2017

2017

Product	Material Description	Extent	Location Reference	Material Condition	Risk Status	Control Priority
Sample No					Test Result	

B001 - General Learning/Library - 1924 - Timber (Timber)**Exterior**

Eaves Linings	Flat AC Sheeting 2254/B001/Eaves Linings/S1					No Asbestos Detected
Electrical Backing Board	Resinous Board	1Unit	South	Good Condition (1)	Low (1)	Low Priority (2-3)
	Assumed Asbestos - Electrical Hazard					
Ceiling Voids	No Asbestos Found					
Underfloor Voids	No Asbestos Found					

Interior**B001 - R0001 - General Assistant/Bulk Store**

No Asbestos

B001 - R0002 - K.L.A. Store

No Asbestos

B001 - R0003 - Library Office/Workroom

No Asbestos

B001 - R0004 - General Storeroom

No Asbestos

B001 - R0005 - Special Programs Room

No Asbestos

B001 - R0007 - Home Base

No Asbestos

B001 - R0008 - Home Base

No Asbestos

B001 - R0009 - Home Base - M

No Asbestos

B001 - R0011 - Movement

No Asbestos

B001 - R0012 - Movement

No Asbestos

B001 - R0013 - Movement

No Asbestos

B001 - R0014 - Staff Toilet

No Asbestos

B001 - R0015 - Staff Toilet

No Asbestos

B001 - R0016 - Staff Room

No Asbestos

B001 - R0018 - Seminar/Study

No Asbestos

B001 - R0019 - Sick Bay

No Asbestos

B001 - R0020 - Principal

No Asbestos

B001 - R0021 - Duplicating Workroom

No Asbestos

B001 - R0022 - Clerical Office

No Asbestos

B001 - R0023 - Interview

No Asbestos

B001 - R0024 - Deputy Principal

Product	Material Description	Extent	Location Reference	Material Condition	Risk Status	Control Priority
Sample No					Test Result	
No Asbestos						
B001 - R0025 - Security Store						
No Asbestos						
B001 - R0026 - Movement						
Infil panel	Compressed AC Sheet					
	2254/B001/R0026/Infil panel/S3					No Asbestos Detected
B001 - R0027 - Cleaning Distributed Store						
No Asbestos						
B001 - R0029 - Movement						
No Asbestos						
B001 - R0030 - Home Base						
No Asbestos						
B001 - R0031 - Staff Kitchen						
No Asbestos						
B001 - R0032 - Staff Room						
No Asbestos						
B001 - Room+1 - Added Room						
Ceiling Structures/Linings	Flat AC Sheeting					
	2254/B001/Room+1/Ceiling Structures/Linings/S2					No Asbestos Detected
Infil panel	Compressed AC Sheet					
	2254/B001/R0026/Infil panel/S3					No Asbestos Detected

2017

Product	Material Description	Extent	Location Reference	Material Condition	Risk Status	Control Priority
Sample No					Test Result	

B002 - General Learning - 1918 - Timber (Timber)**Exterior**

Eaves Linings	Flat AC Sheeting 2254/B001/Eaves Linings/S1					No Asbestos Detected
Ceiling Voids	No Asbestos Found					
Underfloor Voids	No Asbestos Found					

Interior**B002 - R0001 - Withdrawal Space - 1hb**

No Asbestos

B002 - R0003 - Movement

No Asbestos

B002 - R0004 - Movement

Electrical Backing Board	Resinous Board	1Unit	South	Good Condition (1)	Low (1)	Low Priority (2-3)
--------------------------	----------------	-------	-------	--------------------	---------	--------------------

Assumed Asbestos - Electrical Hazard**B002 - R0005 - Sports Store**

No Asbestos

B002 - R0006 - Sports Store

No Asbestos

B002 - R0007 - Home Base

No Asbestos

B002 - R0008 - Home Base

No Asbestos

B002 - R0009 - Practical Activities - 1hb

No Asbestos

B002 - R0010 - Main Switch Board

No Asbestos

B002 - R0011 - External Movement

No Asbestos

2017

Product	Material Description	Extent	Location Reference	Material Condition	Risk Status	Control Priority
Sample No					Test Result	

B003 - General Learning - 1962 - Brick/Block (Brick/Block)**Exterior**

Eaves Linings	Flat AC Sheeting 2254/B001/Eaves Linings/S1					No Asbestos Detected
Ceiling Voids	No Asbestos Found					
Underfloor Voids	No Asbestos Found					

Interior**B003 - R0001 - Toilets - Boys/Girls**

No Asbestos

B003 - R0002 - Practical Activities - 1hb

No Asbestos

B003 - R0003 - Distribution Board

Note: No inspection of live electrical installation.

Electrical Backing Board	Resinous Board	1m2	South	Good Condition (1)	Low (1)	Low Priority (2-3)
--------------------------	----------------	-----	-------	--------------------	---------	--------------------

Assumed Asbestos - Electrical Hazard**B003 - R0004 - Home Base Store**

No Asbestos

B003 - R0005 - Home Base Store

Floor Coverings Res/Textile	Vinyl Sheet 2254/B003/R0012/Floor Coverings Res/Textile/S5					No Asbestos Detected
Floor Coverings Res/Textile	Adhesive 2254/B003/R0012/Floor Coverings Res/Textile/S6					No Asbestos Detected

B003 - R0006 - Home Base

Floor Coverings Res/Textile	Vinyl Tiles (Under Floor Covering/Carpet) 2254/B003/R0012/Floor Coverings Res/Textile/S5					No Asbestos Detected
Floor Coverings Res/Textile	Adhesive 2254/B003/R0012/Floor Coverings Res/Textile/S6					No Asbestos Detected

B003 - R0007 - Home Base

Floor Coverings Res/Textile	Vinyl Tiles (Under Floor Covering/Carpet) 2254/B003/R0012/Floor Coverings Res/Textile/S5					No Asbestos Detected
Floor Coverings Res/Textile	Adhesive 2254/B003/R0012/Floor Coverings Res/Textile/S6					No Asbestos Detected

B003 - R0008 - Movement

Floor Coverings Res/Textile	Vinyl Sheet 2254/B003/R0012/Floor Coverings Res/Textile/S5					No Asbestos Detected
Floor Coverings Res/Textile	Adhesive 2254/B003/R0012/Floor Coverings Res/Textile/S6					No Asbestos Detected

B003 - R0010 - Deputy Principal

No Asbestos

B003 - R0011 - General Storeroom

No Asbestos

B003 - R0012 - Movement

Floor Coverings Res/Textile	Vinyl Sheet 2254/B003/R0012/Floor Coverings Res/Textile/S5					No Asbestos Detected
Floor Coverings Res/Textile	Adhesive 2254/B003/R0012/Floor Coverings Res/Textile/S6					No Asbestos Detected

Product	Material Description	Extent	Location Reference	Material Condition	Risk Status	Control Priority
Sample No					Test Result	
B003 - R0013 - Cleaning Distributed Store						
No Asbestos						
B003 - R0014 - Staff Toilet						
No Asbestos						
B003 - R0015 - Withdrawal Space - 1hb						
Floor Coverings Res/Textile	Vinyl Sheet					
	2254/B003/R0012/Floor Coverings Res/Textile/S5					No Asbestos Detected
Floor Coverings Res/Textile	Adhesive					
	2254/B003/R0012/Floor Coverings Res/Textile/S6					No Asbestos Detected
B003 - R0016 - Home Base						
Floor Coverings Res/Textile	Vinyl Tiles (Under Floor Covering/Carpet)					
	2254/B003/R0012/Floor Coverings Res/Textile/S5					No Asbestos Detected
Floor Coverings Res/Textile	Adhesive					
	2254/B003/R0012/Floor Coverings Res/Textile/S6					No Asbestos Detected
B003 - R0017 - Home Base Store						
No Asbestos						
B003 - R0018 - Home Base						
Floor Coverings Res/Textile	Vinyl Tiles (Under Floor Covering/Carpet)					
	2254/B003/R0012/Floor Coverings Res/Textile/S5					No Asbestos Detected
Floor Coverings Res/Textile	Adhesive					
	2254/B003/R0012/Floor Coverings Res/Textile/S6					No Asbestos Detected
B003 - R0020 - Toilets - Girls						
Partition Walls (Cubicles)	Compressed AC Sheet	15m2	East, West	Good Condition (1)	Low (1)	Low Priority (2-3)
	2254/B003/R0020/Partition Walls (Cubicles)/S7					Chrysotile (white asbestos) , Amosite (brown asbestos)
Ceiling Structures/Linings	Flat AC Sheeting					
	2254/B001/Room+1/Ceiling Structures/Linings/S2					No Asbestos Detected
B003 - R0021 - No Access						
No Asbestos						
B003 - R0022 - Covered Outdoor Learning Area						
No Asbestos						
B003 - R0023 - Disabled Toilet						
Recently Modified Space	Requires Inspection					
B003 - R0024 - Toilets - Boys						
Recently Modified Space	Requires Inspection					
B003 - R0025 - General Storeroom						
Recently Modified Space	Requires Inspection					
B003 - R0026 - Practical Activities - 1hb						
Recently Modified Space	Requires Inspection					

Product	Material Description	Extent	Location Reference	Material Condition	Risk Status	Control Priority
Sample No					Test Result	

B004 - Railway Carriage - 2007 - Steel (Steel)

Exterior

Ceiling Voids - Raked Ceiling	No Asbestos Found					
Underfloor Voids	Encapsulated Insulation material within unit					
	2254/B004/Underfloor Voids/S4					No Asbestos Detected

Interior

B004 - R0001 - No Access

No Asbestos

2017

Product	Material Description	Extent	Location Reference	Material Condition	Risk Status	Control Priority
Sample No					Test Result	

B005 - Storage - 2010 - Metal Shed (Metal Shed)

Exterior

Ceiling Voids	No Asbestos Found
Underfloor Voids	No Asbestos Found

Interior

B005 - R0001 - Garden Store

No Asbestos

2017

Product	Material Description	Extent	Location Reference	Material Condition	Risk Status	Control Priority
Sample No					Test Result	

B006 - Library - 2011 - Brick/Veneer (Brick/Veneer)**Exterior**

Ceiling Voids	No Asbestos Found
Underfloor Voids - Slab on Ground	No Asbestos Found

Interior**B006 - R0001 - External Movement**

No Asbestos

B006 - R0002 - K.L.A. Store

No Asbestos

B006 - R0003 - Reading Area

No Asbestos

B006 - R0004 - Library Office/Workroom

No Asbestos

B006 - R0005 - Communications Room

No Asbestos

B006 - R0006 - Cleaning Distributed Store

No Asbestos

B006 - R0007 - Movement

No Asbestos

B006 - R0008 - Staff Toilet

No Asbestos

B006 - R0009 - Distribution Board

No Asbestos

Note: No inspection of live electrical installation.

2017

Product	Material Description	Extent	Location Reference	Material Condition	Risk Status	Control Priority
Sample No					Test Result	

B007 - Storage - 2012 - Metal Shed (Metal Shed)

Exterior

Ceiling Void	No Asbestos Found
Underfloor Void	No Asbestos Found

Interior

B007 - R0001 - General Storeroom

No Asbestos

B007 - R0002 - General Storeroom

No Asbestos

2017

Product	Material Description	Extent	Location Reference	Material Condition	Risk Status	Control Priority
Sample No					Test Result	

B008 - Storage - 2012 - Metal Shed (Metal Shed)

Exterior

Ceiling Void	No Asbestos Found
Underfloor Void	No Asbestos Found

Interior

B008 - R0001 - Sports Store

No Asbestos

2017

Product	Material Description	Extent	Location Reference	Material Condition	Risk Status	Control Priority
	Sample No					Test Result

B00E - Other - 1969 - Brick/Block (Brick/Block)**Exterior**

Eaves Linings	Flat AC Sheeting 2254/B001/Eaves Linings/S1					No Asbestos Detected
Ceiling Voids - Flat Roof	No Asbestos Found					
Underfloor Voids - Slab on Ground	No Asbestos Found					

Interior**B00E - R0002 - Adjoining School**

No Asbestos

B00E - R0003 - Adjoining School

No Asbestos

B00E - R0004 - Adjoining School

No Asbestos

B00E - R0005 - Adjoining School

No Asbestos

B00E - R0006 - Adjoining School

No Asbestos

B00E - R0007 - Adjoining School

No Asbestos

B00E - R0008 - Adjoining School

No Asbestos

B00E - R0009 - Adjoining School

No Asbestos

B00E - R0010 - Adjoining School

No Asbestos

B00E - R0011 - Adjoining School

No Asbestos

B00E - R0012 - Adjoining School

No Asbestos

B00E - R0013 - Adjoining School

No Asbestos

B00E - R0014 - Adjoining School

No Asbestos

B00E - R0015 - Adjoining School

Ceiling Structures/Linings	Flat AC Sheeting 2254/B001/Room+1/Ceiling Structures/Linings/S2					No Asbestos Detected
----------------------------	--	--	--	--	--	----------------------

B00E - R0016 - Adjoining School

Ceiling Structures/Linings	Flat AC Sheeting 2254/B001/Room+1/Ceiling Structures/Linings/S2					No Asbestos Detected
----------------------------	--	--	--	--	--	----------------------

B00E - R0017 - Adjoining School

No Asbestos

B00E - R0018 - Adjoining School

No Asbestos

B00E - R0019 - Adjoining School

No Asbestos

B00E - R0020 - Adjoining School

No Asbestos

B00E - R0021 - Adjoining School

No Asbestos

B00E - R0022 - Adjoining School

Product	Material Description	Extent	Location Reference	Material Condition	Risk Status	Control Priority
Sample No					Test Result	

No Asbestos

B00E - R0023 - Toilets - Boys

Ceiling Structures/Linings	Flat AC Sheeting 2254/B001/Room+1/Ceiling Structures/Linings/S2					No Asbestos Detected
Partition Walls (Cubicles)	Compressed AC Sheet 2254/B003/R0020/Partition Walls (Cubicles)/S7	20m2	South	Good Condition (1)	Low (1)	Low Priority (2-3) Chrysotile (white asbestos) , Amosite (brown asbestos)

B00E - R0024 - General Storeroom

Ceiling Structures/Linings	Flat AC Sheeting 2254/B001/Room+1/Ceiling Structures/Linings/S2					No Asbestos Detected
----------------------------	--	--	--	--	--	-----------------------------

B00E - R0025 - Cleaning Supplies

Ceiling Structures/Linings	Flat AC Sheeting 2254/B001/Room+1/Ceiling Structures/Linings/S2					No Asbestos Detected
----------------------------	--	--	--	--	--	-----------------------------

B00E - R0026 - Toilets - Girls

Ceiling Structures/Linings	Flat AC Sheeting 2254/B001/Room+1/Ceiling Structures/Linings/S2					No Asbestos Detected
Partition Walls (Cubicles)	Compressed AC Sheet 2254/B003/R0020/Partition Walls (Cubicles)/S7	22m2	South	Good Condition (1)	Low (1)	Low Priority (2-3) Chrysotile (white asbestos) , Amosite (brown asbestos)

B00E - R0027 - Staff Toilet

Ceiling Structures/Linings	Flat AC Sheeting 2254/B001/Room+1/Ceiling Structures/Linings/S2					No Asbestos Detected
----------------------------	--	--	--	--	--	-----------------------------

2017

Product	Material Description	Extent	Location Reference	Material Condition	Risk Status	Control Priority
Sample No					Test Result	

Demountables

Demountable details as per the AMS records as of 15 Feb 2017.

OS 837 - D12998 - Hcap Shower/Change/Toilet : Placement Date - 21/05/2003

Note: This refurbished demountable may have asbestos present in remnant mastic in window frames.

Exterior

No Asbestos Found.

Interior

R1 - Disabled Shower/Toilet

No Asbestos Found.

2017

Product	Material Description	Extent	Location Reference	Material Condition	Risk Status	Control Priority
Sample No					Test Result	

Listing of Electronic Attachments as of 22/03/2017

There are no asbestos related file attachment(s) for this school.

2017