

# Asbestos Register

(Hazardous Materials and Risk Assessment)

**School :** Girraween High School (8500)  
**Region :** Western Sydney  
**State Electorate :** Prospect  
**Local Government Area :** Holroyd

**Initial Survey :** Noel Arnold & Associates : 28 - Mar - 2008  
**Reviewed By :** Parsons Brinckerhoff : 10 - Feb - 2017

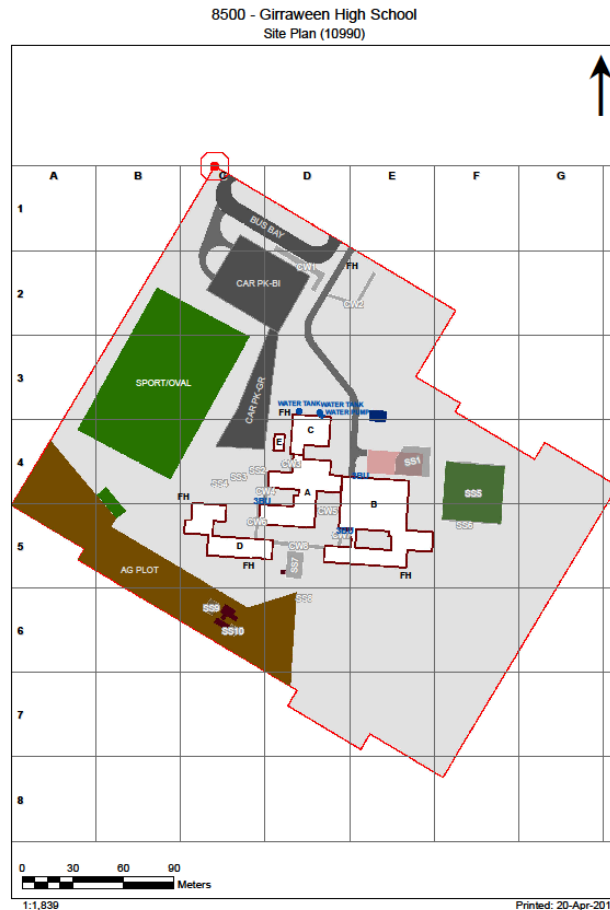

2017

Product	Material Description	Extent	Location Reference	Material Condition	Risk Status	Control Priority
Sample No					Test Result	

**B00A - Administration/General Learning - 1974 - Brick/Block (Brick/Block)****Exterior**

Gable Verge Lining	Flat AC Sheeting	70m2	East, West	Good Condition (1)	Low (1)	Low Priority (2-3)
	8500/B00A/Gable Verge Lining/S11					<b>Chrysotile (white asbestos)</b>
Eaves Linings	Flat AC Sheeting	25m2	North	Good Condition (1)	Low (1)	Low Priority (2-3)
	8500/B00D/R1009/Ceiling Structures/Linings/S1					<b>Chrysotile (white asbestos)</b>
Ceiling void	No Asbestos Found					
Under floor void	No Asbestos Found					

**Interior****B00A - R0001 - General Storeroom (27.65 m2)**

No Asbestos

**B00A - R0002 - Distribution Board Cupboard (0.67 m2)**

Note: No inspection of live electrical installation.

No Asbestos

**B00A - R0003 - Staff Study (32.03 m2)**

Ceiling Structures/Linings	Vermiculite					<b>Limited Samples Taken</b>
	8500/B00A/R1005/Ceiling Structures/Linings/S5					<b>Vermiculite Ceilings may contain asbestos. Asbestos testing MUST be conducted prior to any disturbance works</b>

**B00A - R0004 - Laboratory L.S. (91.17 m2)**

Ceiling Structures/Linings	Vermiculite					<b>Limited Samples Taken</b>
	8500/B00A/R1005/Ceiling Structures/Linings/S5					<b>Vermiculite Ceilings may contain asbestos. Asbestos testing MUST be conducted prior to any disturbance works</b>
Floor Coverings Res/Textile	Vinyl Tiles	92m2	Throughout	Good Condition (1)	Low (1)	Low Priority (2-3)
	8500/B00D/R1005/Floor Coverings Res/Textile/S3					<b>Chrysotile (white asbestos)</b>

**B00A - R0005 - Preparation (48.26 m2)**

Ceiling Structures/Linings	Vermiculite					<b>Limited Samples Taken</b>
	8500/B00A/R1005/Ceiling Structures/Linings/S5					<b>Vermiculite Ceilings may contain asbestos. Asbestos testing MUST be conducted prior to any disturbance works</b>
Floor Coverings Res/Textile	Vinyl Tiles	49m2	Throughout	Good Condition (1)	Low (1)	Low Priority (2-3)
	8500/B00D/R1005/Floor Coverings Res/Textile/S3					<b>Chrysotile (white asbestos)</b>

**B00A - R0006 - Lift (0.25 m2)**

No Asbestos

**B00A - R0007 - Laboratory L.S. (91.27 m2)**

Ceiling Structures/Linings	Vermiculite					<b>Limited Samples Taken</b>
	8500/B00A/R1005/Ceiling Structures/Linings/S5					<b>Vermiculite Ceilings may contain asbestos. Asbestos testing MUST be conducted prior to any disturbance works</b>
Floor Coverings Res/Textile	Vinyl Tiles	92m2	Throughout	Good Condition (1)	Low (1)	Low Priority (2-3)
	8500/B00D/R1005/Floor Coverings Res/Textile/S3					<b>Chrysotile (white asbestos)</b>

**B00A - R0008 - Movement (73.28 m2)**

No Asbestos

**B00A - R0009 - Commonroom (125.34 m2)**

Ceiling Structures/Linings	Vermiculite					<b>Limited Samples Taken</b>
	8500/B00A/R1005/Ceiling Structures/Linings/S5					<b>Vermiculite Ceilings may contain asbestos. Asbestos testing MUST be conducted prior to any disturbance works</b>

**B00A - R0010 - General Storeroom (2.42 m2)**

No Asbestos

**B00A - R0011 - Movement (2.21 m2)**

Product	Material Description	Extent	Location Reference	Material Condition	Risk Status	Control Priority
Sample No					Test Result	
Ceiling Structures/Linings	Vermiculite 8500/B00A/R1005/Ceiling Structures/Linings/S5					Limited Samples Taken <i>Vermiculite Ceilings may contain asbestos. Asbestos testing MUST be conducted prior to any disturbance works</i>
<b>B00A - R0012 - Staff Shower (8.44 m2)</b>						
Partition Walls (Cubicles)	Compressed AC Sheet 8500/B00D/R1015/Partition Walls (Cubicles)/S4	2m2	South	Good Condition (1)	Low (1)	Low Priority (2-3) <b>Chrysotile (white asbestos)</b>
<b>B00A - R0013 - Staff Shower (7.93 m2)</b>						
Partition Walls (Cubicles)	Compressed AC Sheet 8500/B00D/R1015/Partition Walls (Cubicles)/S4	2m2	North	Good Condition (1)	Low (1)	Low Priority (2-3) <b>Chrysotile (white asbestos)</b>
<b>B00A - R0014 - Movement (33.75 m2)</b>						
Ceiling Structures/Linings	Vermiculite 8500/B00A/R1005/Ceiling Structures/Linings/S5					Limited Samples Taken <i>Vermiculite Ceilings may contain asbestos. Asbestos testing MUST be conducted prior to any disturbance works</i>
<b>B00A - R0015 - Administration - Clerical (12.93 m2)</b>						
Ceiling Structures/Linings	Vermiculite 8500/B00A/R1005/Ceiling Structures/Linings/S5					Limited Samples Taken <i>Vermiculite Ceilings may contain asbestos. Asbestos testing MUST be conducted prior to any disturbance works</i>
<b>B00A - R0016 - Main Switchroom (10.24 m2)</b>						
No Asbestos						
<b>B00A - R0017 - Cleaning Store - Distributed (2.34 m2)</b>						
No Asbestos						
<b>B00A - R0018 - Principal Office (25.71 m2)</b>						
Ceiling Structures/Linings	Vermiculite 8500/B00A/R1005/Ceiling Structures/Linings/S5					Limited Samples Taken <i>Vermiculite Ceilings may contain asbestos. Asbestos testing MUST be conducted prior to any disturbance works</i>
<b>B00A - R0019 - Administration - Clerical (27.5 m2)</b>						
Ceiling Structures/Linings	Vermiculite 8500/B00A/R1005/Ceiling Structures/Linings/S5					Limited Samples Taken <i>Vermiculite Ceilings may contain asbestos. Asbestos testing MUST be conducted prior to any disturbance works</i>
<b>B00A - R0020 - Duplicating Workroom (24.76 m2)</b>						
Ceiling Structures/Linings	Vermiculite 8500/B00A/R1005/Ceiling Structures/Linings/S5					Limited Samples Taken <i>Vermiculite Ceilings may contain asbestos. Asbestos testing MUST be conducted prior to any disturbance works</i>
Floor Coverings Res/Textile	Vinyl Tiles 8500/B00D/R1005/Floor Coverings Res/Textile/S3	25m2	Throughout	Good Condition (1)	Low (1)	Low Priority (2-3) <b>Chrysotile (white asbestos)</b>
<b>B00A - R0021 - Staff - Toilet (4.92 m2)</b>						
No Asbestos						
<b>B00A - R0022 - Staff - Toilet (3.53 m2)</b>						
No Asbestos						
<b>B00A - R0023 - Public Entry (53.88 m2)</b>						
Ceiling Structures/Linings	Vermiculite 8500/B00A/R1005/Ceiling Structures/Linings/S5					Limited Samples Taken <i>Vermiculite Ceilings may contain asbestos. Asbestos testing MUST be conducted prior to any disturbance works</i>
<b>B00A - R0024 - Deputy Principal Office (16.04 m2)</b>						
Ceiling Structures/Linings	Vermiculite 8500/B00A/R1005/Ceiling Structures/Linings/S5					Limited Samples Taken <i>Vermiculite Ceilings may contain asbestos. Asbestos testing MUST be conducted prior to any disturbance works</i>
<b>B00A - R0025 - Ancillary Staff (23.07 m2)</b>						
Ceiling Structures/Linings	Vermiculite 8500/B00A/R1005/Ceiling Structures/Linings/S5					Limited Samples Taken <i>Vermiculite Ceilings may contain asbestos. Asbestos testing MUST be conducted prior to any disturbance works</i>

Product	Material Description	Extent	Location Reference	Material Condition	Risk Status	Control Priority
Sample No					Test Result	
<b>B00A - R0026 - Clinic (12.82 m2)</b>						
Ceiling Structures/Linings	Vermiculite					Limited Samples Taken
	8500/B00A/R1005/Ceiling Structures/Linings/S5					<b>Vermiculite Ceilings may contain asbestos. Asbestos testing MUST be conducted prior to any disturbance works</b>
Floor Coverings Res/Textile	Vinyl Tiles	13m2	Throughout	Good Condition (1)	Low (1)	Low Priority (2-3)
	8500/B00D/R1005/Floor Coverings Res/Textile/S3					<b>Chrysotile (white asbestos)</b>
<b>B00A - R0027 - Interview/Office - Type 1 (12.82 m2)</b>						
Ceiling Structures/Linings	Vermiculite					Limited Samples Taken
	8500/B00A/R1005/Ceiling Structures/Linings/S5					<b>Vermiculite Ceilings may contain asbestos. Asbestos testing MUST be conducted prior to any disturbance works</b>
<b>B00A - R0028 - Interview/Office - Type 1 (12.86 m2)</b>						
Ceiling Structures/Linings	Vermiculite					Limited Samples Taken
	8500/B00A/R1005/Ceiling Structures/Linings/S5					<b>Vermiculite Ceilings may contain asbestos. Asbestos testing MUST be conducted prior to any disturbance works</b>
<b>B00A - R0029 - Interview/Office - Type 1 (12.86 m2)</b>						
Ceiling Structures/Linings	Vermiculite					Limited Samples Taken
	8500/B00A/R1005/Ceiling Structures/Linings/S5					<b>Vermiculite Ceilings may contain asbestos. Asbestos testing MUST be conducted prior to any disturbance works</b>
<b>B00A - R0030 - Movement (13.99 m2)</b>						
No Asbestos						
<b>B00A - R0032 - Clinic-Toilets (2.96 m2)</b>						
No Asbestos						
<b>B00A - R0033 - Movement (34.77 m2)</b>						
No Asbestos						
<b>B00A - R0034 - Staff Study (12.61 m2)</b>						
Ceiling Structures/Linings	Vermiculite					Limited Samples Taken
	8500/B00A/R1005/Ceiling Structures/Linings/S5					<b>Vermiculite Ceilings may contain asbestos. Asbestos testing MUST be conducted prior to any disturbance works</b>
<b>B00A - R0035 - Staff Study (12.64 m2)</b>						
Ceiling Structures/Linings	Vermiculite					Limited Samples Taken
	8500/B00A/R1005/Ceiling Structures/Linings/S5					<b>Vermiculite Ceilings may contain asbestos. Asbestos testing MUST be conducted prior to any disturbance works</b>
<b>B00A - R0037 - Movement (6.01 m2)</b>						
No Asbestos						
<b>B00A - R0038 - Movement (20.08 m2)</b>						
No Asbestos						
<b>B00A - R0039 - Store (7.95 m2)</b>						
No Asbestos						
<b>B00A - R0040 - Stairs (15.96 m2)</b>						
Ceiling Structures/Linings	Vermiculite					Limited Samples Taken
	8500/B00A/R1005/Ceiling Structures/Linings/S5					<b>Vermiculite Ceilings may contain asbestos. Asbestos testing MUST be conducted prior to any disturbance works</b>
<b>B00A - R0041 - Stairs (5.12 m2)</b>						
Ceiling Structures/Linings	Flat AC Sheeting	6m2	Throughout	Good Condition (1)	Low (1)	Low Priority (2-3)
	8500/B00D/R1009/Ceiling Structures/Linings/S1					<b>Chrysotile (white asbestos)</b>
<b>B00A - R0042 - Study Space (76.57 m2)</b>						
Ceiling Structures/Linings	Vermiculite					Limited Samples Taken
	8500/B00A/R1005/Ceiling Structures/Linings/S5					<b>Vermiculite Ceilings may contain asbestos. Asbestos testing MUST be conducted prior to any disturbance works</b>
Floor Coverings Res/Textile	Vinyl Tiles					No Asbestos Detected
	8500/B00A/R0042/Floor Coverings Res/Textile/S12					

Product	Material Description	Extent	Location Reference	Material Condition	Risk Status	Control Priority
Sample No					Test Result	
Wall Linings Internal	Flat AC Sheeting 8500/B00A/R0042/Wall Linings Internal/S13					No Asbestos Detected
<b>B00A - R0043 - General Storeroom (15.45 m2)</b>						
Ceiling Structures/Linings	Vermiculite 8500/B00A/R1005/Ceiling Structures/Linings/S5					Limited Samples Taken <i>Vermiculite Ceilings may contain asbestos. Asbestos testing MUST be conducted prior to any disturbance works</i>
Floor Coverings Res/Textile	Vinyl Tiles 8500/B00D/R1009/Ceiling Structures/Linings/S1	15m2	Throughout	Good Condition (1)	Low (1)	Low Priority (2-3) <b>Chrysotile (white asbestos)</b>
Partition Walls (Cubicles)	Flat AC Sheeting 8500/B00D/R1004/Ceiling Structures/Linings/S2					No Asbestos Detected
<b>B00A - R1001 - Chemical Store (27.5 m2)</b>						
Ceiling Structures/Linings	Flat AC Sheeting 8500/B00A/R1001/Ceiling Structures/Linings/S6	28m2	Throughout	Good Condition (1)	Low (1)	Low Priority (2-3) <b>Chrysotile (white asbestos)</b>
Wall Linings Internal	Flat AC Sheeting 8500/B00A/R1001/Ceiling Structures/Linings/S6	3m2	South, Upper portion	Good Condition (1)	Low (1)	Low Priority (2-3) <b>Chrysotile (white asbestos)</b>
<b>B00A - R1002 - Distribution Board Cupboard (0.72 m2)</b> <span style="float: right;">Note: No inspection of live electrical installation.</span>						
Ceiling Structures/Linings	Flat AC Sheeting 8500/B00A/R1001/Ceiling Structures/Linings/S6	1m2	Throughout	Minimal Damage (2)	Low (1)	Low Priority (2-3) <b>Chrysotile (white asbestos)</b>
<b>B00A - R1003 - Darkroom Space (23.2 m2)</b>						
Ceiling Structures/Linings	Flat AC Sheeting 8500/B00A/R1001/Ceiling Structures/Linings/S6	24m2	Throughout	Good Condition (1)	Low (1)	Low Priority (2-3) <b>Chrysotile (white asbestos)</b>
Wall Linings Internal	Flat AC Sheeting 8500/B00A/R1001/Ceiling Structures/Linings/S6	3m2	North, South, Upper portion	Good Condition (1)	Low (1)	Low Priority (2-3) <b>Chrysotile (white asbestos)</b>
<b>B00A - R1004 - Movement (7.86 m2)</b>						
No Asbestos						
<b>B00A - R1005 - Laboratory L.S. (91.08 m2)</b>						
Ceiling Structures/Linings	Vermiculite 8500/B00A/R1005/Ceiling Structures/Linings/S5					Limited Samples Taken <i>Vermiculite Ceilings may contain asbestos. Asbestos testing MUST be conducted prior to any disturbance works</i>
Wall Linings Internal	Vermiculite 8500/B00A/R1005/Ceiling Structures/Linings/S5					Limited Samples Taken <i>Vermiculite Ceilings may contain asbestos. Asbestos testing MUST be conducted prior to any disturbance works</i>
Floor Coverings Res/Textile	Vinyl Tiles 8500/B00D/R1005/Floor Coverings Res/Textile/S3	92m2	Throughout	Good Condition (1)	Low (1)	Low Priority (2-3) <b>Chrysotile (white asbestos)</b>
<b>B00A - R1006 - Preparation (47.65 m2)</b>						
Ceiling Structures/Linings	Vermiculite 8500/B00A/R1005/Ceiling Structures/Linings/S5					Limited Samples Taken <i>Vermiculite Ceilings may contain asbestos. Asbestos testing MUST be conducted prior to any disturbance works</i>
Wall Linings Internal	Vermiculite 8500/B00A/R1005/Ceiling Structures/Linings/S5					Limited Samples Taken <i>Vermiculite Ceilings may contain asbestos. Asbestos testing MUST be conducted prior to any disturbance works</i>
Floor Coverings Res/Textile	Vinyl Tiles 8500/B00D/R1005/Floor Coverings Res/Textile/S3	48m2	Throughout	Good Condition (1)	Low (1)	Low Priority (2-3) <b>Chrysotile (white asbestos)</b>
<b>B00A - R1007 - Lift (0.38 m2)</b>						
No Asbestos						
<b>B00A - R1008 - Lift (0.25 m2)</b>						
No Asbestos						

Product	Material Description	Extent	Location Reference	Material Condition	Risk Status	Control Priority
Sample No					Test Result	
<b>B00A - R1009 - Laboratory L.S. (90.98 m2)</b>						
Ceiling Structures/Linings	Vermiculite 8500/B00A/R1005/Ceiling Structures/Linings/S5					Limited Samples Taken <i>Vermiculite Ceilings may contain asbestos. Asbestos testing MUST be conducted prior to any disturbance works</i>
Wall Linings Internal	Vermiculite 8500/B00A/R1005/Ceiling Structures/Linings/S5					Limited Samples Taken <i>Vermiculite Ceilings may contain asbestos. Asbestos testing MUST be conducted prior to any disturbance works</i>
Floor Coverings Res/Textile	Vinyl Tiles 8500/B00D/R1005/Floor Coverings Res/Textile/S3	91m2	Throughout	Good Condition (1)	Low (1)	Low Priority (2-3) <b>Chrysotile (white asbestos)</b>
<b>B00A - R1010 - Movement (217.1 m2)</b>						
Ceiling Structures/Linings	Flat AC Sheeting 8500/B00D/R1009/Ceiling Structures/Linings/S1	218m2	Throughout	Good Condition (1)	Low (1)	Low Priority (2-3) <b>Chrysotile (white asbestos)</b>
<b>B00A - R1011 - Staff - Toilet (4.49 m2)</b>						
Partition Walls (Cubicles)	Compressed AC Sheet 8500/B00D/R1015/Partition Walls (Cubicles)/S4	2m2	West	Good Condition (1)	Low (1)	Low Priority (2-3) <b>Chrysotile (white asbestos)</b>
Ceiling Structures/Linings	Flat AC Sheeting 8500/B00A/R1001/Ceiling Structures/Linings/S6	5m2	Throughout	Good Condition (1)	Low (1)	Low Priority (2-3) <b>Chrysotile (white asbestos)</b>
<b>B00A - R1012 - Staff - Toilet (4.51 m2)</b>						
Partition Walls (Cubicles)	Compressed AC Sheet 8500/B00D/R1015/Partition Walls (Cubicles)/S4	2m2	West	Good Condition (1)	Low (1)	Low Priority (2-3) <b>Chrysotile (white asbestos)</b>
Ceiling Structures/Linings	Flat AC Sheeting 8500/B00A/R1001/Ceiling Structures/Linings/S6	5m2	Throughout	Good Condition (1)	Low (1)	Low Priority (2-3) <b>Chrysotile (white asbestos)</b>
<b>B00A - R1013 - Cleaning Store - Distributed (3.26 m2)</b>						
Ceiling Structures/Linings	Flat AC Sheeting 8500/B00A/R1001/Ceiling Structures/Linings/S6	4m2	Throughout	Good Condition (1)	Low (1)	Low Priority (2-3) <b>Chrysotile (white asbestos)</b>
<b>B00A - R1014 - General Learning Space (52.37 m2)</b>						
Wall Linings Internal	Vermiculite 8500/B00A/R1005/Ceiling Structures/Linings/S5					Limited Samples Taken <i>Vermiculite Ceilings may contain asbestos. Asbestos testing MUST be conducted prior to any disturbance works</i>
Ceiling Structures/Linings	Vermiculite 8500/B00A/R1005/Ceiling Structures/Linings/S5					Limited Samples Taken <i>Vermiculite Ceilings may contain asbestos. Asbestos testing MUST be conducted prior to any disturbance works</i>
<b>B00A - R1015 - General Learning Space (51.87 m2)</b>						
Wall Linings Internal	Vermiculite 8500/B00A/R1005/Ceiling Structures/Linings/S5					Limited Samples Taken <i>Vermiculite Ceilings may contain asbestos. Asbestos testing MUST be conducted prior to any disturbance works</i>
Ceiling Structures/Linings	Vermiculite 8500/B00A/R1005/Ceiling Structures/Linings/S5					Limited Samples Taken <i>Vermiculite Ceilings may contain asbestos. Asbestos testing MUST be conducted prior to any disturbance works</i>
<b>B00A - R1016 - Distribution Board Cupboard (0.76 m2)</b>						
Ceiling Structures/Linings	Flat AC Sheeting 8500/B00A/R1001/Ceiling Structures/Linings/S6	1m2	Throughout	Good Condition (1)	Low (1)	Low Priority (2-3) <b>Chrysotile (white asbestos)</b>
<b>B00A - R1017 - General Learning Space (52.58 m2)</b>						
Wall Linings Internal	Vermiculite 8500/B00A/R1005/Ceiling Structures/Linings/S5					Limited Samples Taken <i>Vermiculite Ceilings may contain asbestos. Asbestos testing MUST be conducted prior to any disturbance works</i>

Product	Material Description	Extent	Location Reference	Material Condition	Risk Status	Control Priority
Sample No				Test Result		
Ceiling Structures/Linings	Vermiculite 8500/B00A/R1005/Ceiling Structures/Linings/S5					Limited Samples Taken <i>Vermiculite Ceilings may contain asbestos. Asbestos testing MUST be conducted prior to any disturbance works</i>
<b>B00A - R1018 - General Learning Space (52.59 m2)</b>						
Wall Linings Internal	Vermiculite 8500/B00A/R1005/Ceiling Structures/Linings/S5					Limited Samples Taken <i>Vermiculite Ceilings may contain asbestos. Asbestos testing MUST be conducted prior to any disturbance works</i>
Ceiling Structures/Linings	Vermiculite 8500/B00A/R1005/Ceiling Structures/Linings/S5					Limited Samples Taken <i>Vermiculite Ceilings may contain asbestos. Asbestos testing MUST be conducted prior to any disturbance works</i>
<b>B00A - R1019 - General Learning Space (52.72 m2)</b>						
Wall Linings Internal	Vermiculite 8500/B00A/R1005/Ceiling Structures/Linings/S5					Limited Samples Taken <i>Vermiculite Ceilings may contain asbestos. Asbestos testing MUST be conducted prior to any disturbance works</i>
Ceiling Structures/Linings	Vermiculite 8500/B00A/R1005/Ceiling Structures/Linings/S5					Limited Samples Taken <i>Vermiculite Ceilings may contain asbestos. Asbestos testing MUST be conducted prior to any disturbance works</i>
<b>B00A - R1020 - General Learning Space (52.71 m2)</b>						
Wall Linings Internal	Vermiculite 8500/B00A/R1005/Ceiling Structures/Linings/S5					Limited Samples Taken <i>Vermiculite Ceilings may contain asbestos. Asbestos testing MUST be conducted prior to any disturbance works</i>
Ceiling Structures/Linings	Vermiculite 8500/B00A/R1005/Ceiling Structures/Linings/S5					Limited Samples Taken <i>Vermiculite Ceilings may contain asbestos. Asbestos testing MUST be conducted prior to any disturbance works</i>
<b>B00A - R1021 - Staff Study (11.59 m2)</b>						
Wall Linings Internal	Vermiculite 8500/B00A/R1005/Ceiling Structures/Linings/S5					Limited Samples Taken <i>Vermiculite Ceilings may contain asbestos. Asbestos testing MUST be conducted prior to any disturbance works</i>
Ceiling Structures/Linings	Vermiculite 8500/B00A/R1005/Ceiling Structures/Linings/S5					Limited Samples Taken <i>Vermiculite Ceilings may contain asbestos. Asbestos testing MUST be conducted prior to any disturbance works</i>
Floor Coverings Res/Textile	Vinyl Tiles 8500/B00D/R1005/Floor Coverings Res/Textile/S3	12m2	Throughout	Good Condition (1)	Low (1)	Low Priority (2-3) <i>Chrysotile (white asbestos)</i>
<b>B00A - R1022 - Staff Study (32.66 m2)</b>						
Ceiling Structures/Linings	Vermiculite 8500/B00A/R1005/Ceiling Structures/Linings/S5					Limited Samples Taken <i>Vermiculite Ceilings may contain asbestos. Asbestos testing MUST be conducted prior to any disturbance works</i>
Wall Linings Internal	Vermiculite 8500/B00A/R1005/Ceiling Structures/Linings/S5					Limited Samples Taken <i>Vermiculite Ceilings may contain asbestos. Asbestos testing MUST be conducted prior to any disturbance works</i>
<b>B00A - R1023 - Staff Study (25.78 m2)</b>						
Wall Linings Internal	Vermiculite 8500/B00A/R1005/Ceiling Structures/Linings/S5					Limited Samples Taken <i>Vermiculite Ceilings may contain asbestos. Asbestos testing MUST be conducted prior to any disturbance works</i>
Ceiling Structures/Linings	Vermiculite 8500/B00A/R1005/Ceiling Structures/Linings/S5					Limited Samples Taken <i>Vermiculite Ceilings may contain asbestos. Asbestos testing MUST be conducted prior to any disturbance works</i>
Floor Coverings Res/Textile	Vinyl Tiles 8500/B00D/R1005/Floor Coverings Res/Textile/S3	26m2	Throughout	Good Condition (1)	Low (1)	Low Priority (2-3) <i>Chrysotile (white asbestos)</i>
<b>B00A - R1024 - General Learning Space (52.58 m2)</b>						
Wall Linings Internal	Vermiculite 8500/B00A/R1005/Ceiling Structures/Linings/S5					Limited Samples Taken <i>Vermiculite Ceilings may contain asbestos. Asbestos testing MUST be conducted prior to any disturbance works</i>

Product	Material Description	Extent	Location Reference	Material Condition	Risk Status	Control Priority
Sample No					Test Result	
Ceiling Structures/Linings	Vermiculite 8500/B00A/R1005/Ceiling Structures/Linings/S5					Limited Samples Taken <i>Vermiculite Ceilings may contain asbestos. Asbestos testing MUST be conducted prior to any disturbance works</i>
<b>B00A - R1025 - General Learning Space (52.57 m2)</b>						
Wall Linings Internal	Vermiculite 8500/B00A/R1005/Ceiling Structures/Linings/S5					Limited Samples Taken <i>Vermiculite Ceilings may contain asbestos. Asbestos testing MUST be conducted prior to any disturbance works</i>
Ceiling Structures/Linings	Vermiculite 8500/B00A/R1005/Ceiling Structures/Linings/S5					Limited Samples Taken <i>Vermiculite Ceilings may contain asbestos. Asbestos testing MUST be conducted prior to any disturbance works</i>
<b>B00A - R1026 - Stairs (5.12 m2)</b>						
Ceiling Structures/Linings	Flat AC Sheeting 8500/B00D/R1009/Ceiling Structures/Linings/S1	6m2	Throughout	Good Condition (1)	Low (1)	Low Priority (2-3) <i>Chrysotile (white asbestos)</i>
<b>B00A - R1027 - Stairs (12.93 m2)</b>						
Ceiling Structures/Linings	Vermiculite 8500/B00A/R1005/Ceiling Structures/Linings/S5					Limited Samples Taken <i>Vermiculite Ceilings may contain asbestos. Asbestos testing MUST be conducted prior to any disturbance works</i>

2017



Product	Material Description	Extent	Location Reference	Material Condition	Risk Status	Control Priority
Sample No					Test Result	

**B00B - Art/Technological & Applied Studies - 1974 - Brick/Block (Brick/Block)****Exterior**

Gable Verge Lining	Flat AC Sheeting	70m2	East, West	Good Condition (1)	Low (1)	Low Priority (2-3)
	8500/B00B/Gable Verge Lining/S14					<b>Chrysotile (white asbestos)</b>
Ceiling voids	No Asbestos Found					
Under floor voids	No Asbestos Found					

**Interior****B00B - R0001 - Staff Study (35.24 m2)**

Ceiling Structures/Linings	Vermiculite					<b>Limited Samples Taken</b>
	8500/B00B/R1001/Ceiling Structures/Linings/S9					<b>Vermiculite Ceilings may contain asbestos. Asbestos testing MUST be conducted prior to any disturbance works</b>

Floor Coverings Res/Textile	Vinyl Tiles	36m2	Throughout	Good Condition (1)	Low (1)	Low Priority (2-3)
	8500/B00B/R1002/Floor Coverings Res/Textile/S10					<b>Chrysotile (white asbestos)</b>

**B00B - R0002 - General Storeroom (3.56 m2)**

No Asbestos

**B00B - R0003 - Staff - Toilet (2.35 m2)**

No Asbestos

**B00B - R0004 - Staff - Toilet (10.37 m2)**

Partition Walls (Cubicles)	Compressed AC Sheet	2m2	South	Good Condition (1)	Low (1)	Low Priority (2-3)
	8500/B00D/R1015/Partition Walls (Cubicles)/S4					<b>Chrysotile (white asbestos)</b>

**B00B - R0005 - Movement (4.6 m2)**

No Asbestos

**B00B - R0006 - Staff - Toilet (10.5 m2)**

No Asbestos

**B00B - R0007 - Cleaning Store - Distributed (2.27 m2)**

No Asbestos

**B00B - R0008 - Distribution Board Cupboard (0.77 m2)**

Note: No inspection of live electrical installation.

No Asbestos

**B00B - R0009 - Toilets-Boys (25.85 m2)**

Partition Walls (Cubicles)	Compressed AC Sheet	10m2	East	Good Condition (1)	Low (1)	Low Priority (2-3)
	8500/B00D/R1015/Partition Walls (Cubicles)/S4					<b>Chrysotile (white asbestos)</b>

**B00B - R0010 - Toilets-Girls (25.56 m2)**

Partition Walls (Cubicles)	Compressed AC Sheet	10m2	West	Good Condition (1)	Low (1)	Low Priority (2-3)
	8500/B00D/R1015/Partition Walls (Cubicles)/S4					<b>Chrysotile (white asbestos)</b>

**B00B - R0011 - Art Learning Space (84.28 m2)**

Ceiling Structures/Linings	Vermiculite					<b>Limited Samples Taken</b>
	8500/B00B/R1001/Ceiling Structures/Linings/S9					<b>Vermiculite Ceilings may contain asbestos. Asbestos testing MUST be conducted prior to any disturbance works</b>

Floor Coverings Res/Textile	Vinyl Tiles	85m2	Throughout	Good Condition (1)	Low (1)	Low Priority (2-3)
	8500/B00B/R1002/Floor Coverings Res/Textile/S10					<b>Chrysotile (white asbestos)</b>

**B00B - R0012 - Art Learning Space (79.9 m2)**

Ceiling Structures/Linings	Vermiculite					<b>Limited Samples Taken</b>
	8500/B00B/R1001/Ceiling Structures/Linings/S9					<b>Vermiculite Ceilings may contain asbestos. Asbestos testing MUST be conducted prior to any disturbance works</b>

Floor Coverings Res/Textile	Vinyl Tiles	80m2	Throughout	Good Condition (1)	Low (1)	Low Priority (2-3)
	8500/B00B/R1002/Floor Coverings Res/Textile/S10					<b>Chrysotile (white asbestos)</b>

Product	Material Description	Extent	Location Reference	Material Condition	Risk Status	Control Priority
Sample No					Test Result	
<b>B00B - R0013 - General Learning Space (79.06 m2)</b>						
Ceiling Structures/Linings	Vermiculite					
	8500/B00B/R1001/Ceiling Structures/Linings/S9					Limited Samples Taken
<i>Vermiculite Ceilings may contain asbestos. Asbestos testing MUST be conducted prior to any disturbance works</i>						
<b>B00B - R0014 - Distribution Board Cupboard (0.77 m2)</b>						
					Note: No inspection of live electrical installation.	
No Asbestos						
<b>B00B - R0020 - Movement (401.35 m2)</b>						
No Asbestos						
<b>B00B - R0021 - Garden Store Room (9.38 m2)</b>						
No Asbestos						
<b>B00B - R0022 - Materials Store (32.42 m2)</b>						
No Asbestos						
<b>B00B - R0023 - Shower/Change (78.74 m2)</b>						
Partition Walls (Cubicles)	Compressed AC Sheet	0.5m2	South	Good Condition (1)	Low (1)	Low Priority (2-3)
	8500/B00D/R1015/Partition Walls (Cubicles)/S4					Chrysotile (white asbestos)
<b>B00B - R0024 - Staff Shower (10.86 m2)</b>						
Floor Coverings Res/Textile	Vinyl Tiles	11m2	Throughout	Good Condition (1)	Low (1)	Low Priority (2-3)
	8500/B00B/R1002/Floor Coverings Res/Textile/S10					Chrysotile (white asbestos)
<b>B00B - R0025 - Staff Shower (11.1 m2)</b>						
Floor Coverings Res/Textile	Vinyl Tiles	12m2	Throughout	Good Condition (1)	Low (1)	Low Priority (2-3)
	8500/B00B/R1002/Floor Coverings Res/Textile/S10					Chrysotile (white asbestos)
<b>B00B - R0026 - Shower/Change (70.88 m2)</b>						
Partition Walls (Cubicles)	Compressed AC Sheet	5m2	South	Good Condition (1)	Low (1)	Low Priority (2-3)
	8500/B00D/R1015/Partition Walls (Cubicles)/S4					Chrysotile (white asbestos)
<b>B00B - R0027 - Distribution Board Cupboard (0.62 m2)</b>						
					Note: No inspection of live electrical installation.	
Electrical Mounting Board	Resinous Board	1Unit	North	Good Condition (1)	Low (1)	Low Priority (2-3)
	8500/B00B/R0027/Electrical Mounting Board/S15					Chrysotile (white asbestos)
<b>B00B - R0028 - Cleaning Supplies Store (15.7 m2)</b>						
Floor Coverings Res/Textile	Vinyl Tiles	16m2	Throughout	Good Condition (1)	Low (1)	Low Priority (2-3)
	8500/B00B/R1002/Floor Coverings Res/Textile/S10					Chrysotile (white asbestos)
<b>B00B - R0029 - Sport Equipment Store (7.26 m2)</b>						
No Asbestos						
<b>B00B - R0030 - Sport Equipment Store (19.53 m2)</b>						
No Asbestos						
<b>B00B - R0031 - Movement (19.8 m2)</b>						
No Asbestos						
<b>B00B - R0032 - Chair Store (11.14 m2)</b>						
No Asbestos						
<b>B00B - R0033 - Multi-Purpose Space (453.36 m2)</b>						
No Asbestos						
<b>B00B - R0034 - Movement (13.64 m2)</b>						
No Asbestos						
<b>B00B - R0035 - Sport Equipment Store (50.11 m2)</b>						
No Asbestos						
<b>B00B - R0036 - Office/Store (12.99 m2)</b>						

Product	Material Description	Extent	Location Reference	Material Condition	Risk Status	Control Priority
Sample No					Test Result	
Floor Coverings Res/Textile	Vinyl Tiles	13m2	Throughout	Good Condition (1)	Low (1)	Low Priority (2-3)
8500/B00B/R1002/Floor Coverings Res/Textile/S10					Chrysotile (white asbestos)	
<b>B00B - R0037 - Staff - Toilet (6.46 m2)</b>						
No Asbestos						
<b>B00B - R0038 - Student Canteen (46.92 m2)</b>						
Floor Coverings Res/Textile	Vinyl Tiles	47m2	Throughout	Good Condition (1)	Low (1)	Low Priority (2-3)
8500/B00B/R1002/Floor Coverings Res/Textile/S10					Chrysotile (white asbestos)	
<b>B00B - R0039 - Stairs (6.04 m2)</b>						
No Asbestos						
<b>B00B - R0040 - Music Learning Space (64.86 m2)</b>						
Ceiling Structures/Linings	Vermiculite					
8500/B00B/R1001/Ceiling Structures/Linings/S9					Limited Samples Taken	
<i>Vermiculite Ceilings may contain asbestos. Asbestos testing MUST be conducted prior to any disturbance works</i>						
<b>B00B - R0041 - Music Learning Space (19.46 m2)</b>						
Ceiling Structures/Linings	Vermiculite					
8500/B00B/R1001/Ceiling Structures/Linings/S9					Limited Samples Taken	
<i>Vermiculite Ceilings may contain asbestos. Asbestos testing MUST be conducted prior to any disturbance works</i>						
<b>B00B - R0042 - Music Learning Space (3.41 m2)</b>						
Ceiling Structures/Linings	Vermiculite					
8500/B00B/R1001/Ceiling Structures/Linings/S9					Limited Samples Taken	
<i>Vermiculite Ceilings may contain asbestos. Asbestos testing MUST be conducted prior to any disturbance works</i>						
<b>B00B - R0043 - Staff Study (13.97 m2)</b>						
Ceiling Structures/Linings	Vermiculite					
8500/B00B/R1001/Ceiling Structures/Linings/S9					Limited Samples Taken	
<i>Vermiculite Ceilings may contain asbestos. Asbestos testing MUST be conducted prior to any disturbance works</i>						
<b>B00B - R0044 - Movement (24.02 m2)</b>						
Ceiling Structures/Linings	Vermiculite					
8500/B00B/R1001/Ceiling Structures/Linings/S9					Limited Samples Taken	
<i>Vermiculite Ceilings may contain asbestos. Asbestos testing MUST be conducted prior to any disturbance works</i>						
<b>B00B - R0045 - Music Learning Space (3.5 m2)</b>						
Ceiling Structures/Linings	Vermiculite					
8500/B00B/R1001/Ceiling Structures/Linings/S9					Limited Samples Taken	
<i>Vermiculite Ceilings may contain asbestos. Asbestos testing MUST be conducted prior to any disturbance works</i>						
<b>B00B - R0046 - Staff Kitchen (3.67 m2)</b>						
Ceiling Structures/Linings	Vermiculite					
8500/B00B/R1001/Ceiling Structures/Linings/S9					Limited Samples Taken	
<i>Vermiculite Ceilings may contain asbestos. Asbestos testing MUST be conducted prior to any disturbance works</i>						
<b>B00B - R0047 - Music Learning Space (60.65 m2)</b>						
Ceiling Structures/Linings	Vermiculite					
8500/B00B/R1001/Ceiling Structures/Linings/S9					Limited Samples Taken	
<i>Vermiculite Ceilings may contain asbestos. Asbestos testing MUST be conducted prior to any disturbance works</i>						
<b>B00B - R1001 - General Learning Space (52.58 m2)</b>						
Ceiling Structures/Linings	Vermiculite					
8500/B00B/R1001/Ceiling Structures/Linings/S9					Limited Samples Taken	
<i>Vermiculite Ceilings may contain asbestos. Asbestos testing MUST be conducted prior to any disturbance works</i>						
Wall Linings Internal	Vermiculite					
8500/B00B/R1001/Ceiling Structures/Linings/S9					Limited Samples Taken	
<i>Vermiculite Ceilings may contain asbestos. Asbestos testing MUST be conducted prior to any disturbance works</i>						
<b>B00B - R1002 - Materials Store (18.15 m2)</b>						
Ceiling Structures/Linings	Vermiculite					
8500/B00B/R1001/Ceiling Structures/Linings/S9					Limited Samples Taken	
<i>Vermiculite Ceilings may contain asbestos. Asbestos testing MUST be conducted prior to any disturbance works</i>						

Product	Material Description	Extent	Location Reference	Material Condition	Risk Status	Control Priority
Sample No				Test Result		
Wall Linings Internal	Vermiculite 8500/B00B/R1001/Ceiling Structures/Linings/S9					Limited Samples Taken <b>Vermiculite Ceilings may contain asbestos. Asbestos testing MUST be conducted prior to any disturbance works</b>
Floor Coverings Res/Textile	Vinyl Tiles 8500/B00B/R1002/Floor Coverings Res/Textile/S10	19m2	Throughout	Good Condition (1)	Low (1)	Low Priority (2-3) <b>Chrysotile (white asbestos)</b>
<b>B00B - R1003 - Distribution Board Cupboard (0.76 m2)</b>				Note: No inspection of live electrical installation.		
Ceiling Structures/Linings	Flat AC Sheeting 8500/B00D/R1009/Ceiling Structures/Linings/S1	1m2	Throughout	Good Condition (1)	Low (1)	Low Priority (2-3) <b>Chrysotile (white asbestos)</b>
<b>B00B - R1004 - Design L.S. (52.43 m2)</b>						
Ceiling Structures/Linings	Vermiculite 8500/B00B/R1001/Ceiling Structures/Linings/S9					Limited Samples Taken <b>Vermiculite Ceilings may contain asbestos. Asbestos testing MUST be conducted prior to any disturbance works</b>
Wall Linings Internal	Vermiculite 8500/B00B/R1001/Ceiling Structures/Linings/S9					Limited Samples Taken <b>Vermiculite Ceilings may contain asbestos. Asbestos testing MUST be conducted prior to any disturbance works</b>
<b>B00B - R1005 - Staff Study (39.36 m2)</b>						
Ceiling Structures/Linings	Vermiculite 8500/B00B/R1001/Ceiling Structures/Linings/S9					Limited Samples Taken <b>Vermiculite Ceilings may contain asbestos. Asbestos testing MUST be conducted prior to any disturbance works</b>
Wall Linings Internal	Vermiculite 8500/B00B/R1001/Ceiling Structures/Linings/S9					Limited Samples Taken <b>Vermiculite Ceilings may contain asbestos. Asbestos testing MUST be conducted prior to any disturbance works</b>
Floor Coverings Res/Textile	Vinyl Tiles 8500/B00B/R1002/Floor Coverings Res/Textile/S10	40m2	Throughout	Good Condition (1)	Low (1)	Low Priority (2-3) <b>Chrysotile (white asbestos)</b>
<b>B00B - R1006 - Cleaning Store - Distributed (2.04 m2)</b>						
Ceiling Structures/Linings	Flat AC Sheeting 8500/B00D/R1009/Ceiling Structures/Linings/S1	3m2	Throughout	Good Condition (1)	Low (1)	Low Priority (2-3) <b>Chrysotile (white asbestos)</b>
Wall Linings Internal	Vermiculite 8500/B00D/R1009/Ceiling Structures/Linings/S1	0.5m2	North, Upper portion	Friable Asbestos (5)	Low (1)	Low Priority (2-3) <b>Chrysotile (white asbestos)</b>
<b>B00B - R1007 - General Storeroom (25.85 m2)</b>						
Ceiling Structures/Linings	Vermiculite 8500/B00B/R1001/Ceiling Structures/Linings/S9					Limited Samples Taken <b>Vermiculite Ceilings may contain asbestos. Asbestos testing MUST be conducted prior to any disturbance works</b>
Wall Linings Internal	Vermiculite 8500/B00B/R1001/Ceiling Structures/Linings/S9					Limited Samples Taken <b>Vermiculite Ceilings may contain asbestos. Asbestos testing MUST be conducted prior to any disturbance works</b>
Floor Coverings Res/Textile	Vinyl Tiles 8500/B00B/R1002/Floor Coverings Res/Textile/S10	26m2	Throughout	Good Condition (1)	Low (1)	Low Priority (2-3) <b>Chrysotile (white asbestos)</b>
<b>B00B - R1008 - General Learning Space (65.88 m2)</b>						
Ceiling Structures/Linings	Vermiculite 8500/B00B/R1001/Ceiling Structures/Linings/S9					Limited Samples Taken <b>Vermiculite Ceilings may contain asbestos. Asbestos testing MUST be conducted prior to any disturbance works</b>
Wall Linings Internal	Vermiculite 8500/B00B/R1001/Ceiling Structures/Linings/S9					Limited Samples Taken <b>Vermiculite Ceilings may contain asbestos. Asbestos testing MUST be conducted prior to any disturbance works</b>
<b>B00B - R1009 - G.L.S. Store (8.32 m2)</b>						
Ceiling Structures/Linings	Vermiculite 8500/B00B/R1001/Ceiling Structures/Linings/S9					Limited Samples Taken <b>Vermiculite Ceilings may contain asbestos. Asbestos testing MUST be conducted prior to any disturbance works</b>

Product	Material Description	Extent	Location Reference	Material Condition	Risk Status	Control Priority
Sample No					Test Result	
Wall Linings Internal	Vermiculite 8500/B00B/R1001/Ceiling Structures/Linings/S9					Limited Samples Taken <b>Vermiculite Ceilings may contain asbestos. Asbestos testing MUST be conducted prior to any disturbance works</b>
Floor Coverings Res/Textile	Vinyl Tiles 8500/B00B/R1002/Floor Coverings Res/Textile/S10	6m2	Throughout	Good Condition (1)	Low (1)	Low Priority (2-3) <b>Chrysotile (white asbestos)</b>
<b>B00B - R1010 - G.L.S. Store (10.78 m2)</b>						
Ceiling Structures/Linings	Vermiculite 8500/B00B/R1001/Ceiling Structures/Linings/S9					Limited Samples Taken <b>Vermiculite Ceilings may contain asbestos. Asbestos testing MUST be conducted prior to any disturbance works</b>
Wall Linings Internal	Vermiculite 8500/B00B/R1001/Ceiling Structures/Linings/S9					Limited Samples Taken <b>Vermiculite Ceilings may contain asbestos. Asbestos testing MUST be conducted prior to any disturbance works</b>
Floor Coverings Res/Textile	Vinyl Tiles 8500/B00B/R1002/Floor Coverings Res/Textile/S10	11m2	Throughout	Good Condition (1)	Low (1)	Low Priority (2-3) <b>Chrysotile (white asbestos)</b>
<b>B00B - R1011 - Movement (2.74 m2)</b>						
No Asbestos						
<b>B00B - R1012 - General Learning Space (65.73 m2)</b>						
Ceiling Structures/Linings	Vermiculite 8500/B00B/R1001/Ceiling Structures/Linings/S9					Limited Samples Taken <b>Vermiculite Ceilings may contain asbestos. Asbestos testing MUST be conducted prior to any disturbance works</b>
Wall Linings Internal	Vermiculite 8500/B00B/R1001/Ceiling Structures/Linings/S9					Limited Samples Taken <b>Vermiculite Ceilings may contain asbestos. Asbestos testing MUST be conducted prior to any disturbance works</b>
<b>B00B - R1013 - Movement (275.26 m2)</b>						
Ceiling Structures/Linings	Flat AC Sheeting 8500/B00D/R1009/Ceiling Structures/Linings/S1	276m2	Throughout	Good Condition (1)	Low (1)	Low Priority (2-3) <b>Chrysotile (white asbestos)</b>
Wall Linings Internal	Flat AC Sheeting 8500/B00D/R1009/Ceiling Structures/Linings/S1	10m2	Upper portion, Variable positions	Good Condition (1)	Low (1)	Low Priority (2-3) <b>Chrysotile (white asbestos)</b>
<b>B00B - R1014 - Distribution Board Cupboard (0.77 m2)</b>						
No Asbestos						
<b>B00B - R1015 - Materials Technology L.S. (82.12 m2)</b>						
Ceiling Structures/Linings	Vermiculite 8500/B00B/R1001/Ceiling Structures/Linings/S9					Limited Samples Taken <b>Vermiculite Ceilings may contain asbestos. Asbestos testing MUST be conducted prior to any disturbance works</b>
Wall Linings Internal	Vermiculite 8500/B00B/R1001/Ceiling Structures/Linings/S9					Limited Samples Taken <b>Vermiculite Ceilings may contain asbestos. Asbestos testing MUST be conducted prior to any disturbance works</b>
<b>B00B - R1016 - Materials Store (13.31 m2)</b>						
Ceiling Structures/Linings	Vermiculite 8500/B00B/R1001/Ceiling Structures/Linings/S9					Limited Samples Taken <b>Vermiculite Ceilings may contain asbestos. Asbestos testing MUST be conducted prior to any disturbance works</b>
<b>B00B - R1017 - Dust Extraction Space (5.6 m2)</b>						
No Asbestos						
<b>B00B - R1018 - Wood Technology Bay (12.54 m2)</b>						
Ceiling Structures/Linings	Vermiculite 8500/B00B/R1001/Ceiling Structures/Linings/S9					Limited Samples Taken <b>Vermiculite Ceilings may contain asbestos. Asbestos testing MUST be conducted prior to any disturbance works</b>
Wall Linings Internal	Vermiculite 8500/B00B/R1001/Ceiling Structures/Linings/S9					Limited Samples Taken <b>Vermiculite Ceilings may contain asbestos. Asbestos testing MUST be conducted prior to any disturbance works</b>

Product	Material Description	Extent	Location Reference	Material Condition	Risk Status	Control Priority
Sample No					Test Result	
<b>B00B - R1019 - Materials Technology L.S. (82.38 m2)</b>						
Ceiling Structures/Linings	Vermiculite 8500/B00B/R1001/Ceiling Structures/Linings/S9					Limited Samples Taken <i>Vermiculite Ceilings may contain asbestos. Asbestos testing MUST be conducted prior to any disturbance works</i>
Wall Linings Internal	Vermiculite 8500/B00B/R1001/Ceiling Structures/Linings/S9					Limited Samples Taken <i>Vermiculite Ceilings may contain asbestos. Asbestos testing MUST be conducted prior to any disturbance works</i>
<b>B00B - R1020 - Movement (40.54 m2)</b>						
Ceiling Structures/Linings	Flat AC Sheeting 8500/B00D/R1009/Ceiling Structures/Linings/S1	41m2	Throughout	Good Condition (1)	Low (1)	Low Priority (2-3) <i>Chrysotile (white asbestos)</i>
<b>B00B - R1021 - Food Technology L.S. (99.6 m2)</b>						
Ceiling Structures/Linings	Vermiculite 8500/B00B/R1001/Ceiling Structures/Linings/S9					Limited Samples Taken <i>Vermiculite Ceilings may contain asbestos. Asbestos testing MUST be conducted prior to any disturbance works</i>
Wall Linings Internal	Vermiculite 8500/B00B/R1001/Ceiling Structures/Linings/S9					Limited Samples Taken <i>Vermiculite Ceilings may contain asbestos. Asbestos testing MUST be conducted prior to any disturbance works</i>
Floor Coverings Res/Textile	Vinyl Tiles 8500/B00B/R1002/Floor Coverings Res/Textile/S10	101m2	Throughout	Good Condition (1)	Low (1)	Low Priority (2-3) <i>Chrysotile (white asbestos)</i>
<b>B00B - R1025 - Food/Research Space (15.93 m2)</b>						
Ceiling Structures/Linings	Vermiculite 8500/B00B/R1001/Ceiling Structures/Linings/S9					Limited Samples Taken <i>Vermiculite Ceilings may contain asbestos. Asbestos testing MUST be conducted prior to any disturbance works</i>
<b>B00B - R1026 - General Learning Space (99.32 m2)</b>						
Ceiling Structures/Linings	Vermiculite 8500/B00B/R1001/Ceiling Structures/Linings/S9					Limited Samples Taken <i>Vermiculite Ceilings may contain asbestos. Asbestos testing MUST be conducted prior to any disturbance works</i>
Wall Linings Internal	Vermiculite 8500/B00B/R1001/Ceiling Structures/Linings/S9					Limited Samples Taken <i>Vermiculite Ceilings may contain asbestos. Asbestos testing MUST be conducted prior to any disturbance works</i>
<b>B00B - R1027 - Distribution Board Cupboard (0.68 m2)</b>						
No Asbestos				Note: No inspection of live electrical installation.		
<b>B00B - R1028 - General Learning Space (78.46 m2)</b>						
Ceiling Structures/Linings	Vermiculite 8500/B00B/R1001/Ceiling Structures/Linings/S9					Limited Samples Taken <i>Vermiculite Ceilings may contain asbestos. Asbestos testing MUST be conducted prior to any disturbance works</i>
Wall Linings Internal	Vermiculite 8500/B00B/R1001/Ceiling Structures/Linings/S9					Limited Samples Taken <i>Vermiculite Ceilings may contain asbestos. Asbestos testing MUST be conducted prior to any disturbance works</i>
<b>B00B - R1029 - General Learning Space (80.53 m2)</b>						
Ceiling Structures/Linings	Vermiculite 8500/B00B/R1001/Ceiling Structures/Linings/S9					Limited Samples Taken <i>Vermiculite Ceilings may contain asbestos. Asbestos testing MUST be conducted prior to any disturbance works</i>
Wall Linings Internal	Vermiculite 8500/B00B/R1001/Ceiling Structures/Linings/S9					Limited Samples Taken <i>Vermiculite Ceilings may contain asbestos. Asbestos testing MUST be conducted prior to any disturbance works</i>
<b>B00B - R1030 - Toilets-Boys (22.84 m2)</b>						
Ceiling Structures/Linings	Flat AC Sheeting 8500/B00D/R1009/Ceiling Structures/Linings/S1	23m2	Throughout	Good Condition (1)	Low (1)	Low Priority (2-3) <i>Chrysotile (white asbestos)</i>
Wall Linings Internal	Flat AC Sheeting 8500/B00D/R1009/Ceiling Structures/Linings/S1	4m2	North, South, Upper portion	Good Condition (1)	Low (1)	Low Priority (2-3) <i>Chrysotile (white asbestos)</i>

Product	Material Description	Extent	Location Reference	Material Condition	Risk Status	Control Priority
Sample No					Test Result	
Partition Walls (Cubicles)	Compressed AC Sheet	8m2	East	Good Condition (1)	Low (1)	Low Priority (2-3)
8500/B00D/R1015/Partition Walls (Cubicles)/S4					Chrysotile (white asbestos)	
<b>B00B - R1031 - Toilets-Girls (23.41 m2)</b>						
Ceiling Structures/Linings	Flat AC Sheeting	23m2	Throughout	Good Condition (1)	Low (1)	Low Priority (2-3)
8500/B00D/R1009/Ceiling Structures/Linings/S1					Chrysotile (white asbestos)	
Wall Linings Internal	Flat AC Sheeting	4m2	North, South	Good Condition (1)	Low (1)	Low Priority (2-3)
8500/B00D/R1009/Ceiling Structures/Linings/S1					Chrysotile (white asbestos)	
Partition Walls (Cubicles)	Compressed AC Sheet	16m2	East, West	Good Condition (1)	Low (1)	Low Priority (2-3)
8500/B00D/R1015/Partition Walls (Cubicles)/S4					Chrysotile (white asbestos)	
<b>B00B - R1032 - Cleaning Supplies Store (3.51 m2)</b>						
Ceiling Structures/Linings	Flat AC Sheeting	4m2	Throughout	Good Condition (1)	Low (1)	Low Priority (2-3)
8500/B00D/R1009/Ceiling Structures/Linings/S1					Chrysotile (white asbestos)	
Wall Linings Internal	Flat AC Sheeting	2m2	North, Upper portion	Good Condition (1)	Low (1)	Low Priority (2-3)
8500/B00D/R1009/Ceiling Structures/Linings/S1					Chrysotile (white asbestos)	
<b>B00B - R1033 - Plant (0.59 m2)</b>						
No Asbestos						
<b>B00B - R1034 - Stairs (6.04 m2)</b>						
Ceiling Structures/Linings	Flat AC Sheeting	7m2	Throughout	Good Condition (1)	Low (1)	Low Priority (2-3)
8500/B00D/R1009/Ceiling Structures/Linings/S1					Chrysotile (white asbestos)	
<b>B00B - R1035 - Preparation (21.17 m2)</b>						
No Asbestos						
<b>B00B - R1036 - Staff Study (5.07 m2)</b>						
No Asbestos						
<b>B00B - R1037 - Laundry (4.82 m2)</b>						
No Asbestos						

2017

Product	Material Description	Extent	Location Reference	Material Condition	Risk Status	Control Priority
Sample No					Test Result	

**B00C - Library - 1974 - Brick/Block (Brick/Block)****Exterior**

Gable Verge Lining	Flat AC Sheeting	40m2	East, West	Good Condition (1)	Low (1)	Low Priority (2-3)
	8500/B00C/Gable Verge Lining/S16			<b>Chrysotile (white asbestos) , Amosite (brown asbestos)</b>		
Eaves Linings	Flat AC Sheeting	20m2	North	Good Condition (1)	Low (1)	Low Priority (2-3)
	8500/B00D/R1009/Ceiling Structures/Linings/S1			<b>Chrysotile (white asbestos)</b>		
Ceiling Voids - Raked Ceiling	No Asbestos Found					
Underfloor void	No Asbestos Found					

**Interior****B00C - R0001 - Seminar (8.62 m2)**

Ceiling Structures/Linings	Vermiculite					Limited Samples Taken
	8500/B00C/R1002/Ceiling Structures/Linings/S8			<b>Vermiculite Ceilings may contain asbestos. Asbestos testing MUST be conducted prior to any disturbance works</b>		

**B00C - R0002 - Seminar (11.69 m2)**

Ceiling Structures/Linings	Vermiculite					Limited Samples Taken
	8500/B00C/R1002/Ceiling Structures/Linings/S8			<b>Vermiculite Ceilings may contain asbestos. Asbestos testing MUST be conducted prior to any disturbance works</b>		

**B00C - R0003 - Seminar (12.03 m2)**

Ceiling Structures/Linings	Vermiculite					Limited Samples Taken
	8500/B00C/R1002/Ceiling Structures/Linings/S8			<b>Vermiculite Ceilings may contain asbestos. Asbestos testing MUST be conducted prior to any disturbance works</b>		

**B00C - R0004 - Main Area (8.79 m2)**

Ceiling Structures/Linings	Vermiculite					Limited Samples Taken
	8500/B00C/R1002/Ceiling Structures/Linings/S8			<b>Vermiculite Ceilings may contain asbestos. Asbestos testing MUST be conducted prior to any disturbance works</b>		

**B00C - R0005 - Main Area (266.38 m2)**

Ceiling Structures/Linings	Vermiculite					Limited Samples Taken
	8500/B00C/R1002/Ceiling Structures/Linings/S8			<b>Vermiculite Ceilings may contain asbestos. Asbestos testing MUST be conducted prior to any disturbance works</b>		

**B00C - R0006 - Tiered Learning Area (10.37 m2)**

Ceiling Structures/Linings	Vermiculite					Limited Samples Taken
	8500/B00C/R1002/Ceiling Structures/Linings/S8			<b>Vermiculite Ceilings may contain asbestos. Asbestos testing MUST be conducted prior to any disturbance works</b>		

**B00C - R0008 - Librarian (14.1 m2)**

Ceiling Structures/Linings	Vermiculite					Limited Samples Taken
	8500/B00C/R1002/Ceiling Structures/Linings/S8			<b>Vermiculite Ceilings may contain asbestos. Asbestos testing MUST be conducted prior to any disturbance works</b>		

**B00C - R0009 - Staff - Toilet (3.84 m2)**

No Asbestos

**B00C - R0010 - Staff - Toilet (3.84 m2)**

No Asbestos

**B00C - R0011 - Distribution Board Cupboard (0.81 m2)**

Note: No inspection of live electrical installation.

No Asbestos

**B00C - R0012 - Workroom (22.45 m2)**

Ceiling Structures/Linings	Vermiculite					Limited Samples Taken
	8500/B00C/R1002/Ceiling Structures/Linings/S8			<b>Vermiculite Ceilings may contain asbestos. Asbestos testing MUST be conducted prior to any disturbance works</b>		

**B00C - R0014 - General Storeroom (5.53 m2)**



Product	Material Description	Extent	Location Reference	Material Condition	Risk Status	Control Priority
Sample No					Test Result	
Floor Coverings Res/Textile	Vinyl Tiles	6m2	Throughout	Good Condition (1)	Low (1)	Low Priority (2-3)
8500/B00D/R1005/Floor Coverings Res/Textile/S3					<b>Chrysotile (white asbestos)</b>	
<b>B00C - R0015 - Stairs (5.53 m2)</b>						
Floor Coverings Res/Textile	Vinyl Tiles	6m2	Throughout	Good Condition (1)	Low (1)	Low Priority (2-3)
8500/B00D/R1005/Floor Coverings Res/Textile/S3					<b>Chrysotile (white asbestos)</b>	
<b>B00C - R0016 - General Storeroom (24.56 m2)</b>						
Ceiling Structures/Linings	Vermiculite					
8500/B00C/R1002/Ceiling Structures/Linings/S8					<b>Limited Samples Taken</b>	
<b>Vermiculite Ceilings may contain asbestos. Asbestos testing MUST be conducted prior to any disturbance works</b>						
<b>B00C - R1001 - Main Area (76.82 m2)</b>						
Ceiling Structures/Linings	Vermiculite					
8500/B00C/R1002/Ceiling Structures/Linings/S8					<b>Limited Samples Taken</b>	
<b>Vermiculite Ceilings may contain asbestos. Asbestos testing MUST be conducted prior to any disturbance works</b>						
Wall Linings Internal	Vermiculite					
8500/B00C/R1002/Ceiling Structures/Linings/S8					<b>Limited Samples Taken</b>	
<b>Vermiculite Ceilings may contain asbestos. Asbestos testing MUST be conducted prior to any disturbance works</b>						
<b>B00C - R1002 - Main Area (161.15 m2)</b>						
Ceiling Structures/Linings	Vermiculite					
8500/B00C/R1002/Ceiling Structures/Linings/S8					<b>Limited Samples Taken</b>	
<b>Vermiculite Ceilings may contain asbestos. Asbestos testing MUST be conducted prior to any disturbance works</b>						
Wall Linings Internal	Vermiculite					
8500/B00C/R1002/Ceiling Structures/Linings/S8					<b>Limited Samples Taken</b>	
<b>Vermiculite Ceilings may contain asbestos. Asbestos testing MUST be conducted prior to any disturbance works</b>						
<b>B00C - R1003 - Stairs (12.61 m2)</b>						
Ceiling Structures/Linings	Vermiculite					
8500/B00C/R1002/Ceiling Structures/Linings/S8					<b>Limited Samples Taken</b>	
<b>Vermiculite Ceilings may contain asbestos. Asbestos testing MUST be conducted prior to any disturbance works</b>						
<b>B00C - R1004 - Stairs (11.32 m2)</b>						
Ceiling Structures/Linings	Vermiculite					
8500/B00C/R1002/Ceiling Structures/Linings/S8					<b>Limited Samples Taken</b>	
<b>Vermiculite Ceilings may contain asbestos. Asbestos testing MUST be conducted prior to any disturbance works</b>						

2017

Product	Material Description	Extent	Location Reference	Material Condition	Risk Status	Control Priority
Sample No					Test Result	

**B00D - General Learning/Science Learning - 1974 - Brick/Block (Brick/Block)****Exterior**

Gable Verge Lining	Flat AC Sheeting	60m2	East, West	Good Condition (1)	Low (1)	Low Priority (2-3)
	8500/B00D/Gable Verge Lining/S17					<b>Chrysotile (white asbestos)</b>
Eaves Linings	Flat AC Sheeting	20m2	North	Good Condition (1)	Low (1)	Low Priority (2-3)
	8500/B00D/R1009/Ceiling Structures/Linings/S1					<b>Chrysotile (white asbestos)</b>
Ceiling voids	No Asbestos Found					
Underfloor void	No Asbestos Found					

**Interior****B00D - R0001 - Cleaning Supplies Store (15.9 m2)**

Non Accessible

**B00D - R0002 - Cleaning Supplies Store (8.22 m2)**

Non Accessible

**B00D - R0003 - Distribution Board Cupboard (0.66 m2)**

Note: No inspection of live electrical installation.

Electrical Backing Board	Resinous Board	0.5m2	East, West	Good Condition (1)	Low (1)	Low Priority (2-3)
	8500/B00D/R0003/Electrical Backing Board/S18					<b>Chrysotile (white asbestos)</b>

**B00D - R0004 - General Learning Space (51.21 m2)**

Ceiling Structures/Linings	Vermiculite					<b>Limited Samples Taken</b>
	8500/B00D/R1004/Ceiling Structures/Linings/S2					<b>Vermiculite Ceilings may contain asbestos. Asbestos testing MUST be conducted prior to any disturbance works</b>

**B00D - R0005 - General Learning Space (51.21 m2)**

Ceiling Structures/Linings	Vermiculite					<b>Limited Samples Taken</b>
	8500/B00D/R1004/Ceiling Structures/Linings/S2					<b>Vermiculite Ceilings may contain asbestos. Asbestos testing MUST be conducted prior to any disturbance works</b>

**B00D - R0006 - General Learning Space (50.85 m2)**

Ceiling Structures/Linings	Vermiculite					<b>Limited Samples Taken</b>
	8500/B00D/R1004/Ceiling Structures/Linings/S2					<b>Vermiculite Ceilings may contain asbestos. Asbestos testing MUST be conducted prior to any disturbance works</b>

**B00D - R0007 - General Learning Space (51 m2)**

Ceiling Structures/Linings	Vermiculite					<b>Limited Samples Taken</b>
	8500/B00D/R1004/Ceiling Structures/Linings/S2					<b>Vermiculite Ceilings may contain asbestos. Asbestos testing MUST be conducted prior to any disturbance works</b>

**B00D - R0008 - Movement (154.64 m2)**

No Asbestos

**B00D - R0009 - Laboratory L.S. (96.42 m2)**

Ceiling Structures/Linings	Vermiculite					<b>Limited Samples Taken</b>
	8500/B00D/R1004/Ceiling Structures/Linings/S2					<b>Vermiculite Ceilings may contain asbestos. Asbestos testing MUST be conducted prior to any disturbance works</b>

Floor Coverings Res/Textile	Vinyl Tiles	97m2	Throughout	Good Condition (1)	Low (1)	Low Priority (2-3)
	8500/B00D/R1005/Floor Coverings Res/Textile/S3					<b>Chrysotile (white asbestos)</b>

**B00D - R0010 - Preparation (48.8 m2)**

Ceiling Structures/Linings	Vermiculite					<b>Limited Samples Taken</b>
	8500/B00D/R1004/Ceiling Structures/Linings/S2					<b>Vermiculite Ceilings may contain asbestos. Asbestos testing MUST be conducted prior to any disturbance works</b>

Floor Coverings Res/Textile	Vinyl Tiles	49m2	Throughout	Good Condition (1)	Low (1)	Low Priority (2-3)
	8500/B00D/R1005/Floor Coverings Res/Textile/S3					<b>Chrysotile (white asbestos)</b>

**B00D - R0011 - Laboratory L.S. (96.15 m2)**

Product	Material Description	Extent	Location Reference	Material Condition	Risk Status	Control Priority
Sample No					Test Result	
Ceiling Structures/Linings	Vermiculite 8500/B00D/R1004/Ceiling Structures/Linings/S2					Limited Samples Taken <b>Vermiculite Ceilings may contain asbestos. Asbestos testing MUST be conducted prior to any disturbance works</b>
Floor Coverings Res/Textile	Vinyl Tiles 8500/B00D/R1005/Floor Coverings Res/Textile/S3	97m2	Throughout	Good Condition (1)	Low (1)	Low Priority (2-3) <b>Chrysotile (white asbestos)</b>
<b>B00D - R0012 - General Assistants (9.7 m2)</b>						
No Asbestos						
<b>B00D - R0013 - Study Space (24.98 m2)</b>						
Ceiling Structures/Linings	Vermiculite 8500/B00D/R1004/Ceiling Structures/Linings/S2					Limited Samples Taken <b>Vermiculite Ceilings may contain asbestos. Asbestos testing MUST be conducted prior to any disturbance works</b>
<b>B00D - R0014 - Toilets-Girls (18.57 m2)</b>						
Partition Walls (Cubicles)	Compressed AC Sheet 8500/B00D/R1015/Partition Walls (Cubicles)/S4	8m2	North	Good Condition (1)	Low (1)	Low Priority (2-3) <b>Chrysotile (white asbestos)</b>
<b>B00D - R0015 - Cleaning Store - Distributed (1.36 m2)</b>						
No Asbestos						
<b>B00D - R0016 - Distribution Board Cupboard (0.79 m2)</b>						
No Asbestos						
<b>B00D - R0017 - Stairs (6.01 m2)</b>						
Ceiling Structures/Linings	Flat AC Sheeting 8500/B00D/R1009/Ceiling Structures/Linings/S1	6m2	Throughout	Good Condition (1)	Low (1)	Low Priority (2-3) <b>Chrysotile (white asbestos)</b>
<b>B00D - R0018 - Stairs (11 m2)</b>						
Ceiling Structures/Linings	Flat AC Sheeting 8500/B00D/R1009/Ceiling Structures/Linings/S1	11m2	Throughout	Good Condition (1)	Low (1)	Low Priority (2-3) <b>Chrysotile (white asbestos)</b>
<b>B00D - R1001 - General Learning Space (51.14 m2)</b>						
Ceiling Structures/Linings	Vermiculite 8500/B00D/R1004/Ceiling Structures/Linings/S2					Limited Samples Taken <b>Vermiculite Ceilings may contain asbestos. Asbestos testing MUST be conducted prior to any disturbance works</b>
Wall Linings Internal	Vermiculite 8500/B00D/R1004/Ceiling Structures/Linings/S2					Limited Samples Taken <b>Vermiculite Ceilings may contain asbestos. Asbestos testing MUST be conducted prior to any disturbance works</b>
<b>B00D - R1002 - General Learning Space (51.14 m2)</b>						
Ceiling Structures/Linings	Vermiculite 8500/B00D/R1004/Ceiling Structures/Linings/S2					Limited Samples Taken <b>Vermiculite Ceilings may contain asbestos. Asbestos testing MUST be conducted prior to any disturbance works</b>
Wall Linings Internal	Vermiculite 8500/B00D/R1004/Ceiling Structures/Linings/S2					Limited Samples Taken <b>Vermiculite Ceilings may contain asbestos. Asbestos testing MUST be conducted prior to any disturbance works</b>
<b>B00D - R1003 - Staff Study (38.14 m2)</b>						
Ceiling Structures/Linings	Vermiculite 8500/B00D/R1004/Ceiling Structures/Linings/S2					Limited Samples Taken <b>Vermiculite Ceilings may contain asbestos. Asbestos testing MUST be conducted prior to any disturbance works</b>
Wall Linings Internal	Vermiculite 8500/B00D/R1004/Ceiling Structures/Linings/S2					Limited Samples Taken <b>Vermiculite Ceilings may contain asbestos. Asbestos testing MUST be conducted prior to any disturbance works</b>
<b>B00D - R1004 - General Learning Space (52.58 m2)</b>						
Ceiling Structures/Linings	Vermiculite 8500/B00D/R1004/Ceiling Structures/Linings/S2					Limited Samples Taken <b>Vermiculite Ceilings may contain asbestos. Asbestos testing MUST be conducted prior to any disturbance works</b>

Product	Material Description	Extent	Location Reference	Material Condition	Risk Status	Control Priority
Sample No					Test Result	
Wall Linings Internal	Vermiculite 8500/B00D/R1004/Ceiling Structures/Linings/S2					Limited Samples Taken <i>Vermiculite Ceilings may contain asbestos. Asbestos testing MUST be conducted prior to any disturbance works</i>
<b>B00D - R1005 - G.L.S. Store (4.03 m2)</b>						
Floor Coverings Res/Textile	Vinyl Tiles 8500/B00D/R1005/Floor Coverings Res/Textile/S3	5m2	Throughout	Good Condition (1)	Low (1)	Low Priority (2-3) <b>Chrysotile (white asbestos)</b>
<b>B00D - R1006 - Cleaning Store - Distributed (1.01 m2)</b>						
Ceiling Structures/Linings	Flat AC Sheeting 8500/B00D/R1009/Ceiling Structures/Linings/S1	2m2	Throughout	Good Condition (1)	Low (1)	Low Priority (2-3) <b>Chrysotile (white asbestos)</b>
<b>B00D - R1007 - Distribution Board Cupboard (0.58 m2)</b> <span style="float: right;">Note: No inspection of live electrical installation.</span>						
Ceiling Structures/Linings	Flat AC Sheeting 8500/B00D/R1009/Ceiling Structures/Linings/S1	1m2	Throughout	Good Condition (1)	Low (1)	Low Priority (2-3) <b>Chrysotile (white asbestos)</b>
Electrical Backing Board	Resinous Board 8500/B00D/R1007/Electrical Backing Board/S19	0.5m2	East, West	Good Condition (1)	Low (1)	Low Priority (2-3) <b>Chrysotile (white asbestos)</b>
<b>B00D - R1008 - Staff - Toilet (4.42 m2)</b>						
No Asbestos						
<b>B00D - R1009 - Movement (145.34 m2)</b>						
Ceiling Structures/Linings	Flat AC Sheeting 8500/B00D/R1009/Ceiling Structures/Linings/S1	146m2	Throughout	Good Condition (1)	Low (1)	Low Priority (2-3) <b>Chrysotile (white asbestos)</b>
Wall Linings Internal	Flat AC Sheeting 8500/B00D/R1009/Ceiling Structures/Linings/S1	8m2	Variable positions	Good Condition (1)	Low (1)	Low Priority (2-3) <b>Chrysotile (white asbestos)</b>
<b>B00D - R1010 - General Learning Space (63.96 m2)</b>						
Ceiling Structures/Linings	Vermiculite 8500/B00D/R1004/Ceiling Structures/Linings/S2					Limited Samples Taken <i>Vermiculite Ceilings may contain asbestos. Asbestos testing MUST be conducted prior to any disturbance works</i>
Wall Linings Internal	Vermiculite 8500/B00D/R1004/Ceiling Structures/Linings/S2					Limited Samples Taken <i>Vermiculite Ceilings may contain asbestos. Asbestos testing MUST be conducted prior to any disturbance works</i>
<b>B00D - R1011 - General Learning Space (55.83 m2)</b>						
Ceiling Structures/Linings	Vermiculite 8500/B00D/R1004/Ceiling Structures/Linings/S2					Limited Samples Taken <i>Vermiculite Ceilings may contain asbestos. Asbestos testing MUST be conducted prior to any disturbance works</i>
Wall Linings Internal	Vermiculite 8500/B00D/R1004/Ceiling Structures/Linings/S2					Limited Samples Taken <i>Vermiculite Ceilings may contain asbestos. Asbestos testing MUST be conducted prior to any disturbance works</i>
<b>B00D - R1012 - General Learning Space (55.83 m2)</b>						
Ceiling Structures/Linings	Vermiculite 8500/B00D/R1004/Ceiling Structures/Linings/S2					Limited Samples Taken <i>Vermiculite Ceilings may contain asbestos. Asbestos testing MUST be conducted prior to any disturbance works</i>
Wall Linings Internal	Vermiculite 8500/B00D/R1004/Ceiling Structures/Linings/S2					Limited Samples Taken <i>Vermiculite Ceilings may contain asbestos. Asbestos testing MUST be conducted prior to any disturbance works</i>
<b>B00D - R1013 - General Learning Space (63.96 m2)</b>						
Ceiling Structures/Linings	Vermiculite 8500/B00D/R1004/Ceiling Structures/Linings/S2					Limited Samples Taken <i>Vermiculite Ceilings may contain asbestos. Asbestos testing MUST be conducted prior to any disturbance works</i>
Wall Linings Internal	Vermiculite 8500/B00D/R1004/Ceiling Structures/Linings/S2					Limited Samples Taken <i>Vermiculite Ceilings may contain asbestos. Asbestos testing MUST be conducted prior to any disturbance works</i>

Product	Material Description	Extent	Location Reference	Material Condition	Risk Status	Control Priority
Sample No					Test Result	
<b>B00D - R1014 - Staff Study (25.2 m2)</b>						
Ceiling Structures/Linings	Vermiculite 8500/B00D/R1004/Ceiling Structures/Linings/S2					Limited Samples Taken <b>Vermiculite Ceilings may contain asbestos. Asbestos testing MUST be conducted prior to any disturbance works</b>
Wall Linings Internal	Vermiculite 8500/B00D/R1004/Ceiling Structures/Linings/S2					Limited Samples Taken <b>Vermiculite Ceilings may contain asbestos. Asbestos testing MUST be conducted prior to any disturbance works</b>
<b>B00D - R1015 - Toilets-Boys (18.66 m2)</b>						
Partition Walls (Cubicles)	Compressed AC Sheet 8500/B00D/R1015/Partition Walls (Cubicles)/S4	3m2	North	Good Condition (1)	Low (1)	Low Priority (2-3) <b>Chrysotile (white asbestos)</b>
<b>B00D - R1016 - Cleaning Store - Distributed (1.39 m2)</b>						
Ceiling Structures/Linings	Flat AC Sheeting 8500/B00D/R1009/Ceiling Structures/Linings/S1	2m2	Throughout	Good Condition (1)	Low (1)	Low Priority (2-3) <b>Chrysotile (white asbestos)</b>
<b>B00D - R1017 - Distribution Board Cupboard (0.79 m2)</b> <span style="float: right;">Note: No inspection of live electrical installation.</span>						
Ceiling Structures/Linings	Flat AC Sheeting 8500/B00D/R1009/Ceiling Structures/Linings/S1	1m2	Throughout	Good Condition (1)	Low (1)	Low Priority (2-3) <b>Chrysotile (white asbestos)</b>
Electrical Backing Board	Resinous Board 8500/B00D/R1017/Electrical Backing Board/S20	1m2	South, East, West	Good Condition (1)	Low (1)	Low Priority (2-3) <b>Chrysotile (white asbestos)</b>
<b>B00D - R1018 - Stairs (28.97 m2)</b>						
Ceiling Structures/Linings	Flat AC Sheeting 8500/B00D/R1009/Ceiling Structures/Linings/S1	29m2	Throughout	Good Condition (1)	Low (1)	Low Priority (2-3) <b>Chrysotile (white asbestos)</b>
Wall Linings Internal	Flat AC Sheeting 8500/B00D/R1009/Ceiling Structures/Linings/S1	4m2	South	Good Condition (1)	Low (1)	Low Priority (2-3) <b>Chrysotile (white asbestos)</b>
<b>B00D - R1019 - Stairs (12.39 m2)</b>						
Ceiling Structures/Linings	Flat AC Sheeting 8500/B00D/R1009/Ceiling Structures/Linings/S1	13m2	Throughout	Good Condition (1)	Low (1)	Low Priority (2-3) <b>Chrysotile (white asbestos)</b>

2017

Product	Material Description	Extent	Location Reference	Material Condition	Risk Status	Control Priority
Sample No					Test Result	

**B00E - Other/Pupil Facilities - 2009 - Steel (Steel)**

**Exterior**

Ceiling Voids	No Asbestos Found
Underfloor voids	No Asbestos Found

**Interior**

**B00E - R0001 - Uniform Shop (46.86 m2)**

No Asbestos

**B00E - R0002 - General Storeroom (3.78 m2)**

No Asbestos

**B00E - R0003 - Change (1.91 m2)**

No Asbestos

**B00E - R0004 - Change (1.91 m2)**

No Asbestos

2017

Product	Material Description	Extent	Location Reference	Material Condition	Risk Status	Control Priority
Sample No					Test Result	

***Demountables***

**There are no Demountable(s) located at this school as per the AMS records as of 15 Feb 2017.**

2017

Product	Material Description	Extent	Location Reference	Material Condition	Risk Status	Control Priority
Sample No					Test Result	

***Listing of Electronic Attachments as of 22/03/2017***

**Available Asbestos Related Electronic Files**

8500\_ASB\_150514\_AMP.pdf

\* Note : Refer to AMS for details of the attachment(s).

2017