

# Asbestos Register

(Hazardous Materials and Risk Assessment)

**School :** Grafton High School (8117)  
**Region :** North Coast  
**State Electorate :** Clarence  
**Local Government Area :** Clarence Valley

**Initial Survey :** Noel Arnold & Associates : 23 - May - 2008  
**Reviewed By :** Parsons Brinckerhoff : 24 - Feb - 2015

8117 - Grafton High School  
Site Plan (All Sites)

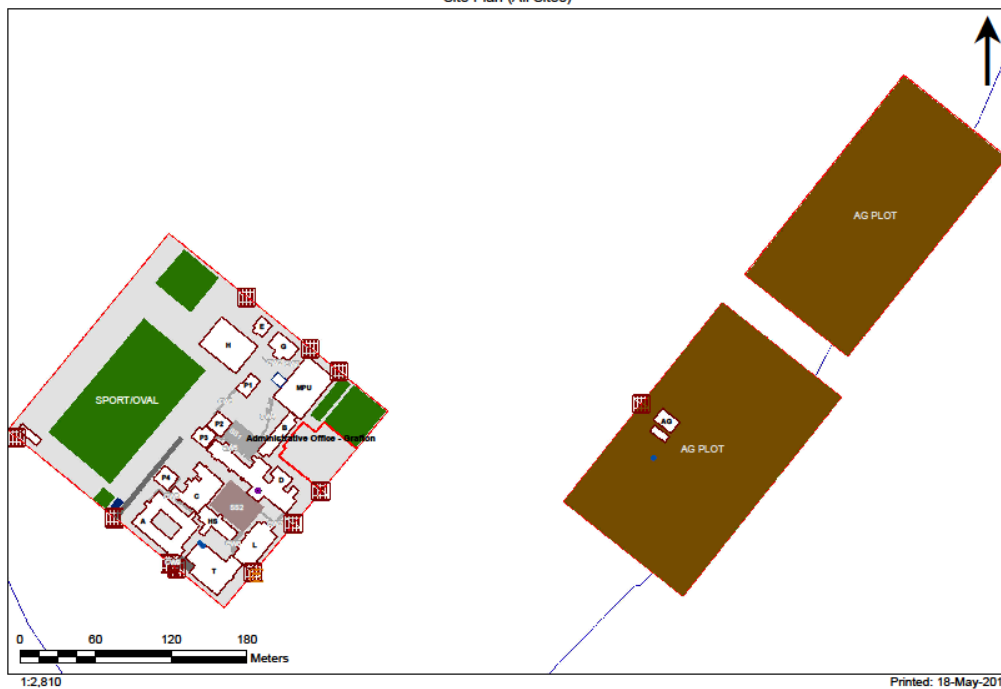

2017

Product	Material Description	Extent	Location Reference	Material Condition	Risk Status	Control Priority
Sample No					Test Result	

**B00A - General Learning/Science Learning - 1965 - Brick/Block (Brick/Block)**

**Exterior**

Ceiling Voids	No Asbestos Found
Underfloor Voids	No Asbestos Found

**Interior**

**B00A - R0001 - Cleaning Store - Distributed (0.37 m2)**

Ceiling Structures/Linings	Flat AC Sheeting	1m2	Throughout	Good Condition (1)	Low (1)	Low Priority (2-3)
8117/B00A/R0001/Ceiling Structures/Linings/S26					<b>Chrysotile (white asbestos)</b>	

**B00A - R0002 - General Storeroom (20.12 m2)**

Floor Coverings Res/Textile	Vinyl Tiles	21m2	Throughout	Good Condition (1)	Low (1)	Low Priority (2-3)
8117/B00A/R0002/Floor Coverings Res/Textile/S16					<b>Chrysotile (white asbestos)</b>	

**B00A - R0012 - General Learning Space (53.63 m2)**

Ceiling Structures/Linings	Vermiculite					
8117/B00T/R0021/Ceiling Structures/Linings/S11					<b>Limited Samples Taken</b>	
<b>Vermiculite Ceilings may contain asbestos. Asbestos testing MUST be conducted prior to any disturbance works</b>						

**B00A - R0013 - Staff Study (53.93 m2)**

Ceiling Structures/Linings	Vermiculite					
8117/B00T/R0021/Ceiling Structures/Linings/S11					<b>Limited Samples Taken</b>	
<b>Vermiculite Ceilings may contain asbestos. Asbestos testing MUST be conducted prior to any disturbance works</b>						

**B00A - R0014 - Cleaning Store - Distributed (0.31 m2)**

Wall Linings Internal	Vinyl Tiles					
8117/B00C/R0002/Wall Linings Internal/S9					<b>No Asbestos Detected</b>	
Ceiling Structures/Linings	Flat AC Sheeting					
8117/B00C/R0011/Ceiling Structures/Linings/S6					<b>No Asbestos Detected</b>	

**B00A - R0015 - Cleaning Supplies Store (8.68 m2)**

Floor Coverings Res/Textile	Vinyl Tiles	9m2	Throughout	Good Condition (1)	Low (1)	Low Priority (2-3)
8117/B00A/R0002/Floor Coverings Res/Textile/S16					<b>Chrysotile (white asbestos)</b>	

**B00A - R0016 - Toilets-Girls (14.62 m2)**

Wall Linings Internal	Vinyl Tiles					
8117/B00C/R0002/Wall Linings Internal/S9					<b>No Asbestos Detected</b>	
Partition Walls (Cubicles)	Compressed AC Sheet	6m2	Throughout	Good Condition (1)	Low (1)	Low Priority (2-3)
8117/B00C/R0007/Partition Walls (Cubicles)/S8					<b>Chrysotile (white asbestos)</b>	

**B00A - R0017 - Cleaning Store - Distributed (6.63 m2)**

No Asbestos

**B00A - R0018 - Main Switchroom (12.9 m2)**

Door linings (internal)	Flat AC Sheeting	3m2	South	Good Condition (1)	Low (1)	Low Priority (2-3)
8117/B00A/R0018/Door linings (internal)/S27					<b>Chrysotile (white asbestos)</b>	
Electrical Backing Board	Resinous Board	3Unit	North	Minimal Damage (2)	Low (1)	Low Priority (2-3)
8117/B00A/R0018/Electrical Backing Board/S28					<b>Chrysotile (white asbestos)</b>	
Metal Cased Control Panel	Resinous Board	1Unit	Middle portion	Good Condition (1)	Low (1)	Low Priority (2-3)
<b>Assumed Asbestos</b>						

**B00A - R0024 - Preparation (11.9 m2)**

Floor Coverings Res/Textile	Vinyl Tiles	12m2	Throughout	Good Condition (1)	Low (1)	Low Priority (2-3)
8117/B00A/R0002/Floor Coverings Res/Textile/S16					<b>Chrysotile (white asbestos)</b>	

Product	Material Description	Extent	Location Reference	Material Condition	Risk Status	Control Priority
Sample No					Test Result	
Ceiling Structures/Linings	Vermiculite					
	8117/B00T/R0021/Ceiling Structures/Linings/S11					Limited Samples Taken
	<i>Vermiculite Ceilings may contain asbestos. Asbestos testing MUST be conducted prior to any disturbance works</i>					
<b>B00A - R0025 - Preparation (21.71 m2)</b>						
Floor Coverings Res/Textile	Vinyl Tiles	22m2	Throughout	Good Condition (1)	Low (1)	Low Priority (2-3)
	8117/B00A/R0002/Floor Coverings Res/Textile/S16					Chrysotile (white asbestos)
Ceiling Structures/Linings	Vermiculite					
	8117/B00T/R0021/Ceiling Structures/Linings/S11					Limited Samples Taken
	<i>Vermiculite Ceilings may contain asbestos. Asbestos testing MUST be conducted prior to any disturbance works</i>					
<b>B00A - R0026 - Chemical Store (20.85 m2)</b>						
Floor Coverings Res/Textile	Vinyl Tiles	21m2	Throughout	Good Condition (1)	Low (1)	Low Priority (2-3)
	8117/B00A/R0002/Floor Coverings Res/Textile/S16					Chrysotile (white asbestos)
<b>B00A - R0027 - Distribution Board Cupboard (1 m2)</b>						
						Note: No inspection of live electrical installation.
Door lining (internal)	Flat AC Sheeting	5m2	North	Good Condition (1)	Low (1)	Low Priority (2-3)
	8117/B00A/R0027/Door lining (internal)/S29					Chrysotile (white asbestos)
Electrical Backing Board	Resinous Board	3Unit	South	Minimal Damage (2)	Low (1)	Low Priority (2-3)
	8117/B00A/R0027/Electrical Backing Board/S30					Chrysotile (white asbestos)
<b>B00A - R0028 - Staff - Toilet (1.81 m2)</b>						
No Asbestos						
<b>B00A - R0029 - General Assistants (12.29 m2)</b>						
No Asbestos						
<b>B00A - R0030 - No Access (7.36 m2)</b>						
No Asbestos						
<b>B00A - R0031 - Movement (214.26 m2)</b>						
No Asbestos						
<b>B00A - R0032 - Covered Area (38.16 m2)</b>						
No Asbestos						
<b>B00A - R0033 - Stairs (1.07 m2)</b>						
No Asbestos						
<b>B00A - R0034 - Stairs (0.76 m2)</b>						
No Asbestos						
<b>B00A - R0035 - External Movement (19.54 m2)</b>						
Ceiling Structures/Linings	Flat AC Sheeting	20m2	Throughout	Good Condition (1)	Low (1)	Low Priority (2-3)
	8117/B00C/R0010/Ceiling Structures/Linings/S7					Chrysotile (white asbestos)
<b>B00A - R0036 - Kiln Space (10.82 m2)</b>						
No Asbestos						
<b>B00A - R0037 - General Learning Space (73.34 m2)</b>						
Ceiling Structures/Linings	Vermiculite					
	8117/B00A/R0037/Ceiling Structures/Linings/S31					Limited Samples Taken
	<i>Vermiculite Ceilings may contain asbestos. Asbestos testing MUST be conducted prior to any disturbance works</i>					
<b>B00A - R0046 - Preparation - Science (44.81 m2)</b>						
Ceiling Structures/Linings	Vermiculite					
	8117/B00A/R0046/Ceiling Structures/Linings/S32					Limited Samples Taken
	<i>Vermiculite Ceilings may contain asbestos. Asbestos testing MUST be conducted prior to any disturbance works</i>					
<b>B00A - R0049 - Other (3.68 m2)</b>						
No Asbestos						
<b>B00A - R0050 - General Learning Space (86.93 m2)</b>						

Product	Material Description	Extent	Location Reference	Material Condition	Risk Status	Control Priority
Sample No					Test Result	
Ceiling Structures/Linings	Vermiculite					
	8117/B00A/R0050/Ceiling Structures/Linings/S33					Limited Samples Taken
<i>Vermiculite Ceilings may contain asbestos. Asbestos testing MUST be conducted prior to any disturbance works</i>						
<b>B00A - R0051 - General Learning Space (87.59 m2)</b>						
Ceiling Structures/Linings	Vermiculite					
	8117/B00A/R0051/Ceiling Structures/Linings/S34					Limited Samples Taken
<i>Vermiculite Ceilings may contain asbestos. Asbestos testing MUST be conducted prior to any disturbance works</i>						
<b>B00A - R0052 - General Learning Space (90.61 m2)</b>						
Ceiling Structures/Linings	Vermiculite					
	8117/B00A/R0052/Ceiling Structures/Linings/S35					Limited Samples Taken
<i>Vermiculite Ceilings may contain asbestos. Asbestos testing MUST be conducted prior to any disturbance works</i>						
<b>B00A - R0053 - General Learning Space (74.84 m2)</b>						
Ceiling Structures/Linings	Vermiculite					
	8117/B00A/R0053/Ceiling Structures/Linings/S36					Limited Samples Taken
<i>Vermiculite Ceilings may contain asbestos. Asbestos testing MUST be conducted prior to any disturbance works</i>						
<b>B00A - R0054 - General Learning Space (79.49 m2)</b>						
Ceiling Structures/Linings	Vermiculite					
	8117/B00A/R0054/Ceiling Structures/Linings/S37					Limited Samples Taken
<i>Vermiculite Ceilings may contain asbestos. Asbestos testing MUST be conducted prior to any disturbance works</i>						
<b>B00A - R1001 - Distribution Board Cupboard (0.97 m2)</b>						
					Note: No inspection of live electrical installation.	
Wall Linings Internal	Flat AC Sheeting	4m2	Door lining	Some Damage / Unsealed (3)	Low (1)	Low Priority (2-3)
	8117/B00A/R0018/Wall Linings Internal/S14					Chrysotile (white asbestos)
Ceiling Structures/Linings	Flat AC Sheeting	1m2	Throughout	Some Damage - Unsealed (3)	Medium (2)	Medium Priority (4-5)
	8117/B00A/R1001/Ceiling Structures/Linings/S38					Chrysotile (white asbestos)
Electrical Backing Board	Resinous Board	3Unit	South	Minimal Damage (2)	Low (1)	Low Priority (2-3)
	8117/B00A/R1001/Electrical Backing Board/S39					Chrysotile (white asbestos)
<b>B00A - R1002 - Staff Study (38.63 m2)</b>						
Ceiling Structures/Linings	Vermiculite					
	8117/B00T/R0021/Ceiling Structures/Linings/S11					Limited Samples Taken
<i>Vermiculite Ceilings may contain asbestos. Asbestos testing MUST be conducted prior to any disturbance works</i>						
<b>B00A - R1003 - Staff Study (9.32 m2)</b>						
Ceiling Structures/Linings	Vermiculite					
	8117/B00T/R0021/Ceiling Structures/Linings/S11					Limited Samples Taken
<i>Vermiculite Ceilings may contain asbestos. Asbestos testing MUST be conducted prior to any disturbance works</i>						
<b>B00A - R1004 - Staff Study (20.7 m2)</b>						
Ceiling Structures/Linings	Vermiculite					
	8117/B00T/R0021/Ceiling Structures/Linings/S11					Limited Samples Taken
<i>Vermiculite Ceilings may contain asbestos. Asbestos testing MUST be conducted prior to any disturbance works</i>						
<b>B00A - R1005 - Resources Store (2.41 m2)</b>						
Ceiling Structures/Linings	Flat AC Sheeting					
	8117/B00C/R0011/Ceiling Structures/Linings/S6					No Asbestos Detected
Floor Coverings Res/Textile	Vinyl Tiles					
	8117/B00T/R0016/Floor Coverings Res/Textile/S13					No Asbestos Detected
<b>B00A - R1006 - Darkroom Space (20.06 m2)</b>						
Ceiling Structures/Linings	Vermiculite					
	8117/B00T/R0021/Ceiling Structures/Linings/S11					Limited Samples Taken
<i>Vermiculite Ceilings may contain asbestos. Asbestos testing MUST be conducted prior to any disturbance works</i>						
<b>B00A - R1007 - Music Learning Space (63.72 m2)</b>						
Ceiling Structures/Linings	Vermiculite					
	8117/B00T/R0021/Ceiling Structures/Linings/S11					Limited Samples Taken
<i>Vermiculite Ceilings may contain asbestos. Asbestos testing MUST be conducted prior to any disturbance works</i>						

Product	Material Description	Extent	Location Reference	Material Condition	Risk Status	Control Priority
Sample No				Test Result		
<b>B00A - R1008 - Practice/Seminar (18.21 m2)</b>						
Ceiling Structures/Linings	Vermiculite					
	8117/B00T/R0021/Ceiling Structures/Linings/S11					Limited Samples Taken
<i>Vermiculite Ceilings may contain asbestos. Asbestos testing MUST be conducted prior to any disturbance works</i>						
<b>B00A - R1009 - Music Store (12.7 m2)</b>						
Ceiling Structures/Linings	Vermiculite					
	8117/B00T/R0021/Ceiling Structures/Linings/S11					Limited Samples Taken
<i>Vermiculite Ceilings may contain asbestos. Asbestos testing MUST be conducted prior to any disturbance works</i>						
<b>B00A - R1010 - Practice/Seminar (12.7 m2)</b>						
Ceiling Structures/Linings	Vermiculite					
	8117/B00T/R0021/Ceiling Structures/Linings/S11					Limited Samples Taken
<i>Vermiculite Ceilings may contain asbestos. Asbestos testing MUST be conducted prior to any disturbance works</i>						
<b>B00A - R1011 - Music Learning Space (52.75 m2)</b>						
Ceiling Structures/Linings	Vermiculite					
	8117/B00T/R0021/Ceiling Structures/Linings/S11					Limited Samples Taken
<i>Vermiculite Ceilings may contain asbestos. Asbestos testing MUST be conducted prior to any disturbance works</i>						
<b>B00A - R1012 - Music Store (6.12 m2)</b>						
Ceiling Structures/Linings	Flat AC Sheeting	7m2	Throughout	Good Condition (1)	Low (1)	Low Priority (2-3)
	8117/B00C/R0010/Ceiling Structures/Linings/S7					Chrysotile (white asbestos)
<b>B00A - R1013 - Art Learning Space (52.75 m2)</b>						
Ceiling Structures/Linings	Vermiculite					
	8117/B00T/R0021/Ceiling Structures/Linings/S11					Limited Samples Taken
<i>Vermiculite Ceilings may contain asbestos. Asbestos testing MUST be conducted prior to any disturbance works</i>						
<b>B00A - R1014 - Resources Store (6.13 m2)</b>						
Ceiling Structures/Linings	Flat AC Sheeting	7m2	Throughout	Good Condition (1)	Low (1)	Low Priority (2-3)
	8117/B00C/R0010/Ceiling Structures/Linings/S7					Chrysotile (white asbestos)
<b>B00A - R1015 - Computer Learning Space (59.64 m2)</b>						
Ceiling Structures/Linings	Vermiculite					
	8117/B00T/R0021/Ceiling Structures/Linings/S11					Limited Samples Taken
<i>Vermiculite Ceilings may contain asbestos. Asbestos testing MUST be conducted prior to any disturbance works</i>						
<b>B00A - R1016 - Computer Resource (7.72 m2)</b>						
Ceiling Structures/Linings	Vermiculite					
	8117/B00T/R0021/Ceiling Structures/Linings/S11					Limited Samples Taken
<i>Vermiculite Ceilings may contain asbestos. Asbestos testing MUST be conducted prior to any disturbance works</i>						
<b>B00A - R1017 - Distribution Board Cupboard (0.85 m2)</b>						
Wall Linings Internal	Flat AC Sheeting	4m2	Door lining	Some Damage / Unsealed (3)	Low (1)	Low Priority (2-3)
	8117/B00A/R0018/Wall Linings Internal/S14					Chrysotile (white asbestos)
Ceiling Structures/Linings	Flat AC Sheeting					
	8117/B00C/R0011/Ceiling Structures/Linings/S6					No Asbestos Detected
Electrical Backing Board	Resinous Board	2m2	East	Minimal Damage (2)	Low (1)	Low Priority (2-3)
	8117/B00A/R1017/Electrical Backing Board/S40					Chrysotile (white asbestos)
<b>B00A - R1018 - Cleaning Store - Distributed (0.31 m2)</b>						
Wall Linings Internal	Vinyl Tiles					
	8117/B00A/R1018/Wall Linings Internal/S42					No Asbestos Detected
Ceiling Structures/Linings	Flat AC Sheeting	1m2	Throughout	Good Condition (1)	Low (1)	Low Priority (2-3)
	8117/B00A/R1018/Ceiling Structures/Linings/S41					Chrysotile (white asbestos)
<b>B00A - R1019 - Art Learning Space (55.73 m2)</b>						
Ceiling Structures/Linings	Vermiculite					
	8117/B00T/R0021/Ceiling Structures/Linings/S11					Limited Samples Taken
<i>Vermiculite Ceilings may contain asbestos. Asbestos testing MUST be conducted prior to any disturbance works</i>						

Product	Material Description	Extent	Location Reference	Material Condition	Risk Status	Control Priority
Sample No				Test Result		
<b>B00A - R1020 - Resources Store (6.97 m2)</b>						
Ceiling Structures/Linings	Vermiculite					
	8117/B00T/R0021/Ceiling Structures/Linings/S11					Limited Samples Taken
	<i>Vermiculite Ceilings may contain asbestos. Asbestos testing MUST be conducted prior to any disturbance works</i>					
<b>B00A - R1021 - Art Learning Space (77.32 m2)</b>						
Ceiling Structures/Linings	Vermiculite					
	8117/B00T/R0021/Ceiling Structures/Linings/S11					Limited Samples Taken
	<i>Vermiculite Ceilings may contain asbestos. Asbestos testing MUST be conducted prior to any disturbance works</i>					
<b>B00A - R1022 - Kiln Space (26.62 m2)</b>						
Ceiling Structures/Linings	Vermiculite					
	8117/B00T/R0021/Ceiling Structures/Linings/S11					Limited Samples Taken
	<i>Vermiculite Ceilings may contain asbestos. Asbestos testing MUST be conducted prior to any disturbance works</i>					
<b>B00A - R1023 - Resources Store (13.59 m2)</b>						
Ceiling Structures/Linings	Vermiculite					
	8117/B00T/R0021/Ceiling Structures/Linings/S11					Limited Samples Taken
	<i>Vermiculite Ceilings may contain asbestos. Asbestos testing MUST be conducted prior to any disturbance works</i>					
<b>B00A - R1024 - Resources Store (25.67 m2)</b>						
Ceiling Structures/Linings	Vermiculite					
	8117/B00T/R0021/Ceiling Structures/Linings/S11					Limited Samples Taken
	<i>Vermiculite Ceilings may contain asbestos. Asbestos testing MUST be conducted prior to any disturbance works</i>					
Floor Coverings Res/Textile	Vinyl Tiles					
	8117/B00T/R0016/Floor Coverings Res/Textile/S13					No Asbestos Detected
<b>B00A - R1025 - Resources Store (6.1 m2)</b>						
Floor Coverings Res/Textile	Vinyl Tiles					
	8117/B00T/R0016/Floor Coverings Res/Textile/S13					No Asbestos Detected
Ceiling Structures/Linings	Flat AC Sheeting	7m2	Throughout	Good Condition (1)	Low (1)	Low Priority (2-3)
	8117/B00C/R0010/Ceiling Structures/Linings/S7					Chrysotile (white asbestos)
<b>B00A - R1026 - General Learning Space (52.82 m2)</b>						
Ceiling Structures/Linings	Vermiculite					
	8117/B00T/R0021/Ceiling Structures/Linings/S11					Limited Samples Taken
	<i>Vermiculite Ceilings may contain asbestos. Asbestos testing MUST be conducted prior to any disturbance works</i>					
<b>B00A - R1027 - Resources Store (6.13 m2)</b>						
Ceiling Structures/Linings	Flat AC Sheeting	7m2	Throughout	Good Condition (1)	Low (1)	Low Priority (2-3)
	8117/B00C/R0010/Ceiling Structures/Linings/S7					Chrysotile (white asbestos)
<b>B00A - R1028 - General Learning Space (52.82 m2)</b>						
Ceiling Structures/Linings	Vermiculite					
	8117/B00T/R0021/Ceiling Structures/Linings/S11					Limited Samples Taken
	<i>Vermiculite Ceilings may contain asbestos. Asbestos testing MUST be conducted prior to any disturbance works</i>					
<b>B00A - R1029 - Staff Study (59.72 m2)</b>						
Ceiling Structures/Linings	Vermiculite					
	8117/B00T/R0021/Ceiling Structures/Linings/S11					Limited Samples Taken
	<i>Vermiculite Ceilings may contain asbestos. Asbestos testing MUST be conducted prior to any disturbance works</i>					
<b>B00A - R1030 - Cleaning Store - Distributed (0.3 m2)</b>						
Ceiling Structures/Linings	Flat AC Sheeting	1m2	Throughout	Good Condition (1)	Low (1)	Low Priority (2-3)
	8117/B00A/R1030/Ceiling Structures/Linings/S43					Chrysotile (white asbestos)
<b>B00A - R1031 - Staff - Toilet (6.07 m2)</b>						
Wall Linings Internal	Vinyl Tiles					
	8117/B00C/R0002/Wall Linings Internal/S9					No Asbestos Detected

Product	Material Description	Extent	Location Reference	Material Condition	Risk Status	Control Priority
Sample No					Test Result	
Ceiling Structures/Linings	Flat AC Sheeting	7m2	Throughout	Good Condition (1)	Low (1)	Low Priority (2-3)

8117/B00C/R0010/Ceiling Structures/Linings/S7

Chrysotile (white asbestos)

**B00A - R1032 - Movement (219.78 m2)**

No Asbestos

**B00A - R1033 - Stairs (5.58 m2)**

No Asbestos

**B00A - R1034 - Stairs (5.38 m2)**

No Asbestos

2017

Product	Material Description	Extent	Location Reference	Material Condition	Risk Status	Control Priority
Sample No					Test Result	

**B00B - General Learning - 1996 - Brick/Veneer (Brick/Veneer)****Exterior**

Ceiling Voids	No Asbestos Found
Underfloor Voids	No Asbestos Found

**Interior****B00B - R0001 - General Learning Space (47.83 m2)**

Vinyl Tiles (Under Floor Covering/Carpet)	No Asbestos Found
---	-------------------

**B00B - R0002 - Staff Study (18.46 m2)**

Vinyl Tiles (Under Floor Covering/Carpet)	No Asbestos Found
---	-------------------

**B00B - R0003 - No Access (0.7 m2)**

No Asbestos

**B00B - R0004 - General Learning Space (48.04 m2)**

Vinyl Tiles (Under Floor Covering/Carpet)	No Asbestos Found
---	-------------------

**B00B - R0005 - General Learning Space (48.03 m2)**

Vinyl Tiles (Under Floor Covering/Carpet)	No Asbestos Found
---	-------------------

**B00B - R0006 - Study Space (15.58 m2)**

Vinyl Tiles (Under Floor Covering/Carpet)	No Asbestos Found
---	-------------------

**B00B - R0007 - General Learning Space (47.76 m2)**

Vinyl Tiles (Under Floor Covering/Carpet)	No Asbestos Found
---	-------------------

**B00B - R0008 - External Movement (100.91 m2)**

No Asbestos

**B00B - R0009 - External Stairs (10.47 m2)**

No Asbestos

**B00B - R0010 - External Stairs (12.27 m2)**

No Asbestos

**B00B - R1001 - General Learning Space (47.76 m2)**

Vinyl Tiles (Under Floor Covering/Carpet)	No Asbestos Found
---	-------------------

**B00B - R1002 - Staff Study (18.46 m2)**

Vinyl Tiles (Under Floor Covering/Carpet)	No Asbestos Found
---	-------------------

**B00B - R1003 - No Access (0.81 m2)**

No Asbestos

**B00B - R1004 - General Learning Space (47.92 m2)**

Vinyl Tiles (Under Floor Covering/Carpet)	No Asbestos Found
---	-------------------

**B00B - R1005 - General Learning Space (47.84 m2)**

Vinyl Tiles (Under Floor Covering/Carpet)	No Asbestos Found
---	-------------------

**B00B - R1006 - General Storeroom (15.58 m2)**

Vinyl Tiles (Under Floor Covering/Carpet)	No Asbestos Found
---	-------------------

**B00B - R1007 - General Learning Space (47.75 m2)**

Vinyl Tiles (Under Floor Covering/Carpet)	No Asbestos Found
---	-------------------

**B00B - R1008 - Movement (91.96 m2)**



Product	Material Description	Extent	Location Reference	Material Condition	Risk Status	Control Priority
Sample No					Test Result	

No Asbestos

**B00B - R1009 - Stairs (12.89 m2)**

No Asbestos

**B00B - R1010 - Stairs (12.27 m2)**

No Asbestos

2017

Product	Material Description	Extent	Location Reference	Material Condition	Risk Status	Control Priority
Sample No					Test Result	

**B00C - Pupil Facilities - 1940 - Brick/Block (Brick/Block)**

**Exterior**

Ceiling Voids	No Asbestos Found					
Underfloor Voids	No Asbestos Found					

**Interior**

**B00C - R0002 - Cleaning Supplies Store (6.02 m2)**

Ceiling Structures/Linings	Flat AC Sheeting	7m2	Throughout	Good Condition (1)	Low (1)	Low Priority (2-3)
	8117/B00C/R0010/Ceiling Structures/Linings/S7					<b>Chrysotile (white asbestos)</b>
Wall Linings Internal	Vinyl Tiles					<b>No Asbestos Detected</b>
	8117/B00C/R0002/Wall Linings Internal/S9					

**B00C - R0003 - Cleaning Supplies Store (36.54 m2)**

Ceiling Structures/Linings	Flat AC Sheeting	37m2	Throughout	Good Condition (1)	Low (1)	Low Priority (2-3)
	8117/B00C/R0010/Ceiling Structures/Linings/S7					<b>Chrysotile (white asbestos)</b>
Wall Linings Internal	Vinyl Tiles					<b>No Asbestos Detected</b>
	8117/B00C/R0002/Wall Linings Internal/S9					

**B00C - R0010 - Office/Store (10.68 m2)**

Ceiling Structures/Linings	Flat AC Sheeting	11m2	Throughout	Good Condition (1)	Low (1)	Low Priority (2-3)
	8117/B00C/R0010/Ceiling Structures/Linings/S7					<b>Chrysotile (white asbestos)</b>

**B00C - R0011 - Staff Change (9.94 m2)**

Ceiling Structures/Linings	Flat AC Sheeting					<b>No Asbestos Detected</b>
	8117/B00C/R0011/Ceiling Structures/Linings/S6					

**B00C - R0012 - External Movement (257.35 m2)**

Ceiling Structures/Linings	Flat AC Sheeting					<b>No Asbestos Detected</b>
	8117/B00C/R0011/Ceiling Structures/Linings/S6					

**B00C - R0013 - External Movement (14.39 m2)**

No Asbestos						
-------------	--	--	--	--	--	--

**B00C - R0014 - Chair Store (20.44 m2)**

Ceiling Structures/Linings	Flat AC Sheeting	21m2	Throughout	Good Condition (1)	Low (1)	Low Priority (2-3)
	8117/B00C/R0010/Ceiling Structures/Linings/S7					<b>Chrysotile (white asbestos)</b>
Wall Linings Internal	Vinyl Tiles					<b>No Asbestos Detected</b>
	8117/B00C/R0002/Wall Linings Internal/S9					

Partition Walls (Cubicles)	Compressed AC Sheet	8m2	Throughout	Good Condition (1)	Low (1)	Low Priority (2-3)
	8117/B00C/R0007/Partition Walls (Cubicles)/S8					<b>Chrysotile (white asbestos)</b>

**B00C - R0015 - Toilets-Disabled (5.51 m2)**

Ceiling Structures/Linings	Flat AC Sheeting	6m2	Throughout	Good Condition (1)	Low (1)	Low Priority (2-3)
	8117/B00C/R0010/Ceiling Structures/Linings/S7					<b>Chrysotile (white asbestos)</b>

**B00C - R0016 - Toilets-Boys (55.74 m2)**

Ceiling Structures/Linings	Flat AC Sheeting	56m2	Throughout	Good Condition (1)	Low (1)	Low Priority (2-3)
	8117/B00C/R0016/Ceiling Structures/Linings/S44					<b>Chrysotile (white asbestos) , Amosite (brown asbestos)</b>

**B00C - R0017 - Toilets-Boys (24.23 m2)**

Ceiling Structures/Linings	Flat AC Sheeting	24m2	Throughout	Good Condition (1)	Low (1)	Low Priority (2-3)
	8117/B00C/R0017/Ceiling Structures/Linings/S45					<b>Chrysotile (white asbestos) , Amosite (brown asbestos)</b>

**B00C - R0018 - Movement (5.79 m2)**

Product	Material Description	Extent	Location Reference	Material Condition	Risk Status	Control Priority
Sample No				Test Result		
Ceiling Structures/Linings	Flat AC Sheeting	6m2	Throughout	Good Condition (1)	Low (1)	Low Priority (2-3)
8117/B00C/R0018/Ceiling Structures/Linings/S46				Chrysotile (white asbestos) , Amosite (brown asbestos)		
<b>B00C - R0019 - Cleaning Supplies Store (2.16 m2)</b>						
Ceiling Structures/Linings	Flat AC Sheeting	2m2	Throughout	Good Condition (1)	Low (1)	Low Priority (2-3)
8117/B00C/R0019/Ceiling Structures/Linings/S47				Chrysotile (white asbestos)		
<b>B00C - R0020 - General Assistants (6.68 m2)</b>						
Ceiling Structures/Linings	Flat AC Sheeting	7m2	Throughout	Good Condition (1)	Low (1)	Low Priority (2-3)
8117/B00C/R0020/Ceiling Structures/Linings/S48				Chrysotile (white asbestos)		
<b>B00C - R0021 - Movement (14.65 m2)</b>						
Ceiling Structures/Linings	Flat AC Sheeting	15m2	Throughout	Good Condition (1)	Low (1)	Low Priority (2-3)
8117/B00C/R0021/Ceiling Structures/Linings/S49				Chrysotile (white asbestos) , Amosite (brown asbestos)		
<b>B00C - R0022 - Toilets-Girls (12 m2)</b>						
Ceiling Structures/Linings	Flat AC Sheeting	12m2	Throughout	Good Condition (1)	Low (1)	Low Priority (2-3)
8117/B00C/R0022/Ceiling Structures/Linings/S50				Chrysotile (white asbestos) , Amosite (brown asbestos)		
<b>B00C - R0023 - Toilets-Girls (63.46 m2)</b>						
Ceiling Structures/Linings	Flat AC Sheeting	63m2	Throughout	Good Condition (1)	Low (1)	Low Priority (2-3)
8117/B00C/R0023/Ceiling Structures/Linings/S51				Chrysotile (white asbestos) , Amosite (brown asbestos)		
<b>B00C - R0024 - Uniform Shop (21.65 m2)</b>						
Recently Modified Space	Requires Inspection					
<b>B00C - R0025 - Student Kitchen (21.8 m2)</b>						
Recently Modified Space	Requires Inspection					
<b>B00C - R0026 - Student Canteen (28.28 m2)</b>						
Recently Modified Space	Requires Inspection					
<b>B00C - R0027 - Office/Store (11.27 m2)</b>						
Recently Modified Space	Requires Inspection					
<b>B00C - R0028 - Movement (58.09 m2)</b>						
Recently Modified Space	Requires Inspection					

2017

Product	Material Description	Extent	Location Reference	Material Condition	Risk Status	Control Priority
Sample No					Test Result	

**B00D - Administration/General Learning - 1915 - Brick/Block (Brick/Block)**

**Exterior**

Ceiling Void	Fibre Cement Pipe 8117/B00D/Ceiling Void/S20	3m	Access Hatch from R1004	Minimal Damage (2)	Low (1)	Low Priority (2-3) <b>Chrysotile (white asbestos) , Amosite (brown asbestos)</b>
Eaves Linings	Flat AC Sheeting 8117/B00D/Eaves Linings/S21	40m2	West	Good Condition (1)	Low (1)	Low Priority (2-3) <b>Chrysotile (white asbestos)</b>
Wall Cladding	Flat AC Sheeting 8117/B00D/Wall Cladding/S22					<b>No Asbestos Detected</b>
Underfloor Voids	No Asbestos Found					
Roof	Fibre Cement Pipe 8117/B00D/Roof/S60	2m	North-West Roof	Minimal Damage (2)	Low (1)	Low Priority (2-3) <b>Chrysotile (white asbestos) , Amosite (brown asbestos)</b>

**Interior**

**B00D - R0001 - Laboratory L.S. (74.04 m2)**

No Asbestos

**B00D - R0007 - Apparatus Store (11.49 m2)**

Floor Coverings Res/Textile	Vinyl Tiles 8117/B0P1/R0003/Floor Coverings Res/Textile/S5					<b>No Asbestos Detected</b>
-----------------------------	---	--	--	--	--	-----------------------------

**B00D - R0010 - Clinic - Boys (21.23 m2)**

No Asbestos

**B00D - R0011 - Toilets-Disabled (3.5 m2)**

Ceiling Structures/Linings	Flat AC Sheeting 8117/B00C/R0011/Ceiling Structures/Linings/S6					<b>No Asbestos Detected</b>
----------------------------	---	--	--	--	--	-----------------------------

**B00D - R0012 - Resources Store (12.34 m2)**

No Asbestos

**B00D - R0013 - Staff Study (36.48 m2)**

No Asbestos

**B00D - R0014 - External Movement (27.18 m2)**

Wall Linings Internal	Flat AC Sheeting 8117/B00C/R0002/Wall Linings Internal/S9					<b>No Asbestos Detected</b>
-----------------------	--	--	--	--	--	-----------------------------

**B00D - R0015 - Movement (6.66 m2)**

No Asbestos

**B00D - R0016 - Cleaning Store - Distributed (3.09 m2)**

No Asbestos

**B00D - R0017 - Administration - Clerical (10.01 m2)**

No Asbestos

**B00D - R0018 - General Storeroom (14.15 m2)**

No Asbestos

**B00D - R0019 - Movement (76.09 m2)**

No Asbestos

**B00D - R0020 - Pupil Entry (4.66 m2)**

No Asbestos

**B00D - R0021 - General Storeroom (3.4 m2)**

No Asbestos

**B00D - R0024 - Deputy Principal Office (24.62 m2)**

Product	Material Description	Extent	Location Reference	Material Condition	Risk Status	Control Priority
Sample No						Test Result
Ceiling Structures/Linings	Vermiculite					
	8117/B00T/R0021/Ceiling Structures/Linings/S11					Limited Samples Taken
<b>Vermiculite Ceilings may contain asbestos. Asbestos testing MUST be conducted prior to any disturbance works</b>						
<b>B00D - R0027 - Commonroom (116.61 m2)</b>						
No Asbestos						
<b>B00D - R0030 - Movement (18 m2)</b>						
No Asbestos						
<b>B00D - R0031 - Duplicating Workroom (24.46 m2)</b>						
No Asbestos						
<b>B00D - R0032 - General Learning Space (51.38 m2)</b>						
No Asbestos						
<b>B00D - R0033 - General Learning Space (50.91 m2)</b>						
No Asbestos						
<b>B00D - R0039 - General Storeroom (3.28 m2)</b>						
No Asbestos						
<b>B00D - R0040 - Movement (6.75 m2)</b>						
No Asbestos						
<b>B00D - R0041 - External Movement (3.18 m2)</b>						
No Asbestos						
<b>B00D - R0042 - Movement (6.82 m2)</b>						
No Asbestos						
<b>B00D - R0043 - Interview/Office - Type 1 (9.3 m2)</b>						
No Asbestos						
<b>B00D - R0044 - Interview/Office - Type 1 (7.48 m2)</b>						
No Asbestos						
<b>B00D - R0045 - Staff - Toilet (2.48 m2)</b>						
No Asbestos						
<b>B00D - R0046 - Machine Storage (4.32 m2)</b>						
No Asbestos						
<b>B00D - R0047 - External Movement (46.98 m2)</b>						
Ceiling Structures/Linings	Flat AC Sheeting					
	8117/B00C/R0011/Ceiling Structures/Linings/S6					No Asbestos Detected
<b>B00D - R0048 - External Movement (2.64 m2)</b>						
No Asbestos						
<b>B00D - R0049 - External Movement (3.61 m2)</b>						
No Asbestos						
<b>B00D - R0050 - External Movement (7.58 m2)</b>						
No Asbestos						
<b>B00D - R0051 - External Movement (4.61 m2)</b>						
No Asbestos						
<b>B00D - R0052 - Interview/Office - Type 1 (10.48 m2)</b>						
Ceiling Structures/Linings	Flat AC Sheeting	2m2	South	Good Condition (1)	Low (1)	Low Priority (2-3)
	8117/B00C/R0010/Ceiling Structures/Linings/S7					Chrysotile (white asbestos)
<b>B00D - R0053 - Stairs (4.45 m2)</b>						
No Asbestos						
<b>B00D - R0054 - Stairs (9.05 m2)</b>						
No Asbestos						
<b>B00D - R0055 - Stairs (9.23 m2)</b>						

Product	Material Description	Extent	Location Reference	Material Condition	Risk Status	Control Priority
Sample No					Test Result	
No Asbestos						
<b>B00D - R0056 - Public Entry (19.67 m2)</b>						
No Asbestos						
<b>B00D - R0057 - Administration - Clerical (9.44 m2)</b>						
No Asbestos						
<b>B00D - R0058 - External Movement (79.61 m2)</b>						
No Asbestos						
<b>B00D - R0059 - Movement (21.96 m2)</b>						
No Asbestos						
<b>B00D - R0060 - General Learning Space (52.67 m2)</b>						
No Asbestos						
<b>B00D - R0061 - General Learning Space (39.91 m2)</b>						
No Asbestos						
<b>B00D - R0062 - Textiles Technology L.S. (84.52 m2)</b>						
No Asbestos						
<b>B00D - R0063 - Handwashing Facilities (4.09 m2)</b>						
No Asbestos						
<b>B00D - R0064 - Materials Store (2.83 m2)</b>						
No Asbestos						
<b>B00D - R0065 - Materials Store (4.29 m2)</b>						
No Asbestos						
<b>B00D - R0066 - Movement (54.08 m2)</b>						
No Asbestos						
<b>B00D - R0067 - Public Reception (24.66 m2)</b>						
No Asbestos						
<b>B00D - R0068 - Administration - Clerical (45.4 m2)</b>						
No Asbestos						
<b>B00D - R0069 - Staff Study (18.38 m2)</b>						
No Asbestos						
<b>B00D - R0070 - Toilet - Lobby (3.27 m2)</b>						
No Asbestos						
<b>B00D - R0071 - Staff - Toilet (8.12 m2)</b>						
Partition Walls (Cubicles)	Compressed AC Sheet		8117/B00D/R0071/Partition Walls (Cubicles)/S52			No Asbestos Detected
<b>B00D - R0072 - Staff - Toilet (6.57 m2)</b>						
Partition Walls (Cubicles)	Compressed AC Sheet		8117/B00D/R0072/Partition Walls (Cubicles)/S53			No Asbestos Detected
<b>B00D - R0073 - Toilet - Lobby (3.04 m2)</b>						
No Asbestos						
<b>B00D - R0074 - Tea Room (14.13 m2)</b>						
No Asbestos						
<b>B00D - R1002 - General Learning Space (65.85 m2)</b>						
No Asbestos						
<b>B00D - R1003 - General Learning Space (73.81 m2)</b>						
No Asbestos						
<b>B00D - R1004 - Movement (23.79 m2)</b>						
No Asbestos						
<b>B00D - R1005 - Movement (6.45 m2)</b>						

Product	Material Description	Extent	Location Reference	Material Condition	Risk Status	Control Priority
Sample No					Test Result	
No Asbestos						
<b>B00D - R1006 - General Learning Space (51.28 m2)</b>						
No Asbestos						
<b>B00D - R1007 - General Learning Space (51.84 m2)</b>						
No Asbestos						
<b>B00D - R1008 - General Learning Space (51.77 m2)</b>						
No Asbestos						
<b>B00D - R1009 - General Learning Space (51.7 m2)</b>						
No Asbestos						
<b>B00D - R1010 - General Learning Space (50.88 m2)</b>						
No Asbestos						
<b>B00D - R1011 - Interview/Office - Type 1 (11.24 m2)</b>						
No Asbestos						
<b>B00D - R1012 - Movement (6.13 m2)</b>						
No Asbestos						
<b>B00D - R1013 - Movement (84.56 m2)</b>						
No Asbestos						
<b>B00D - R1014 - Movement (6.05 m2)</b>						
No Asbestos						
<b>B00D - R1015 - Movement (6.07 m2)</b>						
No Asbestos						
<b>B00D - R1016 - Resources Store (18.34 m2)</b>						
No Asbestos						
<b>B00D - R1017 - Staff Study (50.33 m2)</b>						
No Asbestos						
<b>B00D - R1018 - Resources Store (19.75 m2)</b>						
No Asbestos						
<b>B00D - R1019 - Resources Store (16.93 m2)</b>						
No Asbestos						
<b>B00D - R1020 - Stairs (14.06 m2)</b>						
No Asbestos						
<b>B00D - R1021 - Stairs (13.47 m2)</b>						
No Asbestos						
<b>B00D - R1022 - Stairs (13.78 m2)</b>						
No Asbestos						
<b>B00D - R1023 - Movement (26.72 m2)</b>						
Ceiling Structures/Linings	Flat AC Sheeting	27m2	Throughout	Good Condition (1)	Low (1)	Low Priority (2-3)
8117/B00C/R0010/Ceiling Structures/Linings/S7					<b>Chrysotile (white asbestos)</b>	
<b>B00D - R1024 - Movement (19.36 m2)</b>						
No Asbestos						
<b>B00D - R1025 - General Learning Space (71.02 m2)</b>						
No Asbestos						

Product	Material Description	Extent	Location Reference	Material Condition	Risk Status	Control Priority
Sample No					Test Result	

**B00E - Physical Education/Staff Facilities - 1935 - Timber (Timber)**

**Exterior**

Eaves Linings	Flat AC Sheeting	22m2	North, South, East, West	Good Condition (1)	Low (1)	Low Priority (2-3)
	8117/B00E/Eaves Linings/S3					<b>Chrysotile (white asbestos)</b>
Ceiling Voids	No Asbestos Found					
Underfloor Voids	No Asbestos Found					

**Interior**

**B00E - R0003 - Staff Shower (4.46 m2)**

Wall Linings Internal	Flat AC Sheeting	10m2	Throughout	Good Condition (1)	Low (1)	Low Priority (2-3)
	8117/B00E/R0011/Wall Linings Internal/S1					<b>Chrysotile (white asbestos)</b>

**B00E - R0004 - Movement (11.62 m2)**

Wall Linings Internal	Flat AC Sheeting	22m2	Throughout	Good Condition (1)	Low (1)	Low Priority (2-3)
	8117/B00E/R0011/Wall Linings Internal/S1					<b>Chrysotile (white asbestos)</b>
Ceiling Structures/Linings	Flat AC Sheeting	1m2	Ceiling Access Hatch	Minimal Damage (2)	Low (1)	Low Priority (2-3)
	8117/B00E/R0004/Ceiling Structures/Linings/S54					<b>Chrysotile (white asbestos)</b>

**B00E - R0005 - Staff Study (29.82 m2)**

Wall Linings Internal	Flat AC Sheeting	22m2	Throughout, Variable positions	Good Condition (1)	Low (1)	Low Priority (2-3)
	8117/B00E/R0011/Wall Linings Internal/S1					<b>Chrysotile (white asbestos)</b>
Ceiling Structures/Linings	Flat AC Sheeting	30m2	Throughout	Good Condition (1)	Low (1)	Low Priority (2-3)
	8117/B00E/R0005/Ceiling Structures/Linings/S55					<b>Chrysotile (white asbestos)</b>
Electrical Backing Board	Resinous Board	8117/B00E/R0005/Electrical Backing Board/S56				<b>No Asbestos Detected</b>

**B00E - R0006 - Staff Study (15.79 m2)**

No Asbestos

**B00E - R0007 - Commonroom (11.15 m2)**

Wall Linings Internal	Flat AC Sheeting	5m2	Upper portion	Good Condition (1)	Low (1)	Low Priority (2-3)
	8117/B00E/R0011/Wall Linings Internal/S1					<b>Chrysotile (white asbestos)</b>

**B00E - R0008 - Staff Study (14.32 m2)**

Ceiling Structures/Linings	Flat AC Sheeting	15m2	Throughout	Good Condition (1)	Low (1)	Low Priority (2-3)
	8117/B00E/R0011/Ceiling Structures/Linings/S2					<b>Chrysotile (white asbestos)</b>
Wall Linings Internal	Flat AC Sheeting	22m2	Throughout	Good Condition (1)	Low (1)	Low Priority (2-3)
	8117/B00E/R0011/Wall Linings Internal/S1					<b>Chrysotile (white asbestos)</b>

**B00E - R0009 - Staff Study (5.13 m2)**

Ceiling Structures/Linings	Flat AC Sheeting	6m2	Throughout	Good Condition (1)	Low (1)	Low Priority (2-3)
	8117/B00E/R0011/Ceiling Structures/Linings/S2					<b>Chrysotile (white asbestos)</b>
Wall Linings Internal	Flat AC Sheeting	12m2	Throughout	Good Condition (1)	Low (1)	Low Priority (2-3)
	8117/B00E/R0011/Wall Linings Internal/S1					<b>Chrysotile (white asbestos)</b>

**B00E - R0010 - Staff - Toilet (1.72 m2)**

Wall Linings Internal	Flat AC Sheeting	6m2	Throughout	Good Condition (1)	Low (1)	Low Priority (2-3)
	8117/B00E/R0011/Wall Linings Internal/S1					<b>Chrysotile (white asbestos)</b>
Ceiling Structures/Linings	Flat AC Sheeting	2m2	Throughout	Good Condition (1)	Low (1)	Low Priority (2-3)
	8117/B00E/R0011/Ceiling Structures/Linings/S2					<b>Chrysotile (white asbestos)</b>



Product	Material Description	Extent	Location Reference	Material Condition	Risk Status	Control Priority
Sample No					Test Result	
<b>B00E - R0011 - Movement (2.38 m2)</b>						
Wall Linings Internal	Flat AC Sheeting	2m2	Throughout	Good Condition (1)	Low (1)	Low Priority (2-3)
8117/B00E/R0011/Wall Linings Internal/S1					<b>Chrysotile (white asbestos)</b>	
Ceiling Structures/Linings	Flat AC Sheeting	3m2	Throughout	Good Condition (1)	Low (1)	Low Priority (2-3)
8117/B00E/R0011/Ceiling Structures/Linings/S2					<b>Chrysotile (white asbestos)</b>	

**B00E - R0012 - Staff Study (26.4 m2)**

No Asbestos

2017

Product	Material Description	Extent	Location Reference	Material Condition	Risk Status	Control Priority
Sample No					Test Result	

**B00F - Agricultural Science - 2002 - Brick/Block (Brick/Block)**

**Exterior**

Wall Cladding	Flat AC Sheeting 8117/B00F/Wall Cladding/S18					<b>No Asbestos Detected</b>
Ceiling Voids	No Asbestos Found					
Underfloor Voids	No Asbestos Found					

**Interior**

**B00F - R0001 - Machine Storage (33.39 m2)**

No Asbestos

**B00F - R0002 - Agriculture Covered Area (35.3 m2)**

No Asbestos

**B00F - R0003 - Plant Space (16.74 m2)**

No Asbestos

2017

Product	Material Description	Extent	Location Reference	Material Condition	Risk Status	Control Priority
Sample No					Test Result	

**B00G - Support Unit - 2002 - Brick/Veneer (Brick/Veneer)**

**Exterior**

Ceiling Voids	No Asbestos Found
Underfloor Voids	No Asbestos Found

**Interior**

**B00G - R0001 - Home Base Store - S (5.91 m2)**

No Asbestos

**B00G - R0002 - General Learning Space - S/P (59.93 m2)**

Vinyl Tiles (Under Floor Covering/Carpet) No Asbestos Found

**B00G - R0003 - Practical Activity Area (19.03 m2)**

No Asbestos

**B00G - R0004 - Seminar - Type 3 (11.63 m2)**

Vinyl Tiles (Under Floor Covering/Carpet) No Asbestos Found

**B00G - R0005 - Practical Activity Area (19.07 m2)**

No Asbestos

**B00G - R0006 - General Learning Space - S/P (59.96 m2)**

Vinyl Tiles (Under Floor Covering/Carpet) No Asbestos Found

**B00G - R0007 - Home Base Store - S (5.91 m2)**

No Asbestos

**B00G - R0008 - Toilets-Disabled (27.59 m2)**

No Asbestos

**B00G - R0009 - Outdoor Learning Area (78.15 m2)**

No Asbestos

2017

Product	Material Description	Extent	Location Reference	Material Condition	Risk Status	Control Priority
Sample No					Test Result	

**B00H - Physical Education - 2013 - Steel (Steel)**

**Exterior**

Ceiling Void	No Asbestos Found
Underfloor Void	No Asbestos Found

**Interior**

**B00H - R0001 - Gymnasium (767.41 m2)**

No Asbestos

**B00H - R0002 - Student Change - Type 2 (159.9 m2)**

No Asbestos

**B00H - R0003 - Movement (34.97 m2)**

No Asbestos

**B00H - R0004 - Movement (34.97 m2)**

No Asbestos

2017

Product	Material Description	Extent	Location Reference	Material Condition	Risk Status	Control Priority
Sample No					Test Result	

**B00L - Library - 1940 - Brick/Block (Brick/Block)**

**Exterior**

Eaves Linings	Flat AC Sheeting	10m2	North & South	Good Condition (1)	Low (1)	Low Priority (2-3)
	8117/B00L/Eaves Linings/S23					<b>Chrysotile (white asbestos)</b>
Ceiling Voids	No Asbestos Found					
Underfloor Voids	No Asbestos Found					

**Interior**

**B00L - M0001 - Audio Visual Workroom (32.61 m2)**

No Asbestos

**B00L - M0002 - Study Space (152.87 m2)**

No Asbestos

**B00L - M0003 - Seminar (13.35 m2)**

No Asbestos

**B00L - M0004 - Seminar (12.84 m2)**

No Asbestos

**B00L - M0005 - Seminar (13.6 m2)**

No Asbestos

**B00L - M0006 - Stairs (9.39 m2)**

No Asbestos

**B00L - M0007 - Stairs (8 m2)**

No Asbestos

**B00L - R0001 - Distribution Board Cupboard (1.04 m2)**

Note: No inspection of live electrical installation.

Ceiling Structures/Linings Flat AC Sheeting  
8117/B00C/R0011/Ceiling Structures/Linings/S6

**No Asbestos Detected**

**B00L - R0002 - Staff - Toilet (2.02 m2)**

No Asbestos

**B00L - R0003 - Librarian (12.95 m2)**

No Asbestos

**B00L - R0004 - Main Area (376.87 m2)**

No Asbestos

**B00L - R0005 - Workroom (47.15 m2)**

No Asbestos

**B00L - R0006 - Tiered Learning Area (43.46 m2)**

No Asbestos

**B00L - R0007 - Cleaning Store - Distributed (2.01 m2)**

No Asbestos

**B00L - R0008 - Movement (1.41 m2)**

No Asbestos

**B00L - R0009 - Cleaning Store - Distributed (0.76 m2)**

Ceiling Structures/Linings Flat AC Sheeting  
8117/B00C/R0011/Ceiling Structures/Linings/S6

**No Asbestos Detected**

**B00L - R0010 - External Movement (3.54 m2)**

No Asbestos

**B00L - R0011 - External Movement (17.23 m2)**

Ceiling Structures/Linings Flat AC Sheeting  
8117/B00C/R0011/Ceiling Structures/Linings/S6

**No Asbestos Detected**

**B00L - R0012 - Stairs (0.55 m2)**

No Asbestos

Product	Material Description	Extent	Location Reference	Material Condition	Risk Status	Control Priority
Sample No					Test Result	
<b>B00L - R0013 - Stairs (0.55 m2)</b>						
No Asbestos						
<b>B00L - R0014 - External Movement (137.74 m2)</b>						
No Asbestos						
<b>B00L - R9001 - Plant Space (13.64 m2)</b>						
No Asbestos						

2017

Product	Material Description	Extent	Location Reference	Material Condition	Risk Status	Control Priority
Sample No					Test Result	

**B00T - Technological & Applied Studies - 1940 - Brick/Block (Brick/Block)**

**Exterior**

Eaves Linings	Flat AC Sheeting	60m2	Throughout	Good Condition (1)	Low (1)	Low Priority (2-3)
	8117/B00T/Eaves Linings/S24					<b>Chrysotile (white asbestos)</b>
Ceiling Voids	No Asbestos Found					
Underfloor Voids	No Asbestos Found					

**Interior**

**B00T - R0001 - Staff Study (47.75 m2)**

Ceiling Structures/Linings	Flat AC Sheeting					<b>No Asbestos Detected</b>
	8117/B00C/R0011/Ceiling Structures/Linings/S6					
Wall Linings Internal	Flat AC Sheeting	6m2	North, Upper portion	Good Condition (1)	Low (1)	Low Priority (2-3)
	8117/B00T/R0002/Wall Linings Internal/S12					<b>Chrysotile (white asbestos)</b>

**B00T - R0002 - Staff - Toilet (1.55 m2)**

Wall Linings Internal	Flat AC Sheeting					<b>No Asbestos Detected</b>
	8117/B00T/R0021/Ceiling Structures/Linings/S11					
Ceiling Structures/Linings	Flat AC Sheeting					<b>No Asbestos Detected</b>
	8117/B00C/R0011/Ceiling Structures/Linings/S6					

**B00T - R0003 - Cleaning Store - Distributed (3.84 m2)**

No Asbestos

**B00T - R0004 - Movement (26.68 m2)**

No Asbestos

**B00T - R0006 - Dust Extraction Space (6.22 m2)**

No Asbestos

**B00T - R0008 - Distribution Board Cupboard (0.83 m2)**

Note: No inspection of live electrical installation.

Ceiling Structures/Linings	Flat AC Sheeting	1m2	Throughout	Good Condition (1)	Low (1)	Low Priority (2-3)
	8117/B00C/R0010/Ceiling Structures/Linings/S7					<b>Chrysotile (white asbestos)</b>

**B00T - R0010 - Wood Technology Bay (16.91 m2)**

No Asbestos

**B00T - R0011 - Materials Technology L.S. (80.54 m2)**

Wall Linings Internal	Flat AC Sheeting	6m2	South, Upper portion	Good Condition (1)	Low (1)	Low Priority (2-3)
	8117/B00T/R0002/Wall Linings Internal/S12					<b>Chrysotile (white asbestos)</b>

**B00T - R0012 - Materials Store (23.23 m2)**

Ceiling Structures/Linings	Flat AC Sheeting					<b>No Asbestos Detected</b>
	8117/B00C/R0011/Ceiling Structures/Linings/S6					

**B00T - R0013 - Resources Store (19.18 m2)**

No Asbestos

**B00T - R0014 - Materials Technology L.S. (72.83 m2)**

No Asbestos

**B00T - R0015 - Movement (20.22 m2)**

Ceiling Structures/Linings	Flat AC Sheeting					<b>No Asbestos Detected</b>
	8117/B00C/R0011/Ceiling Structures/Linings/S6					

**B00T - R0016 - Computer Learning Space (83.18 m2)**

Floor Coverings Res/Textile	Vinyl Tiles					<b>No Asbestos Detected</b>
	8117/B00T/R0016/Floor Coverings Res/Textile/S13					

**B00T - R0017 - Seminar/Technology Space (15.49 m2)**

Ceiling Structures/Linings	Flat AC Sheeting					<b>No Asbestos Detected</b>
	8117/B00C/R0011/Ceiling Structures/Linings/S6					

Product	Material Description	Extent	Location Reference	Material Condition	Risk Status	Control Priority
Sample No					Test Result	
<b>B00T - R0018 - Computer Store (13.65 m2)</b>						
Ceiling Structures/Linings	Flat AC Sheeting					
	8117/B00C/R0011/Ceiling Structures/Linings/S6					<b>No Asbestos Detected</b>
<b>B00T - R0019 - Design L.S. (62.58 m2)</b>						
No Asbestos						
<b>B00T - R0021 - Metal Technology L.S. (86.56 m2)</b>						
Ceiling Structures/Linings	Vermiculite					
	8117/B00T/R0021/Ceiling Structures/Linings/S11					<b>Limited Samples Taken</b>
<i>Vermiculite Ceilings may contain asbestos. Asbestos testing MUST be conducted prior to any disturbance works</i>						
<b>B00T - R0024 - External Movement (3.85 m2)</b>						
Ceiling Structures/Linings	Flat AC Sheeting	4m2	Throughout	Good Condition (1)	Low (1)	Low Priority (2-3)
	8117/B00C/R0010/Ceiling Structures/Linings/S7					<b>Chrysotile (white asbestos)</b>
<b>B00T - R0027 - Welding Area (20.49 m2)</b>						
Ceiling Structures/Linings	Vermiculite					
	8117/B00T/R0021/Ceiling Structures/Linings/S11					<b>Limited Samples Taken</b>
<i>Vermiculite Ceilings may contain asbestos. Asbestos testing MUST be conducted prior to any disturbance works</i>						
<b>B00T - R0032 - Project Store - Type 1 (10.5 m2)</b>						
Ceiling Structures/Linings	Flat AC Sheeting	11m2	Throughout	Good Condition (1)	Low (1)	Low Priority (2-3)
	8117/B00T/R0032/Ceiling Structures/Linings/S57					<b>Chrysotile (white asbestos)</b>
<b>B00T - R0033 - Welding Area (11.78 m2)</b>						
Ceiling Structures/Linings	Flat AC Sheeting	12m2	Throughout	Good Condition (1)	Low (1)	Low Priority (2-3)
	8117/B00T/R0033/Ceiling Structures/Linings/S58					<b>Chrysotile (white asbestos)</b>
<b>B00T - R0034 - Welding Area (15.24 m2)</b>						
No Asbestos						
<b>B00T - R0035 - Maintenance Bulk Store (14.33 m2)</b>						
No Asbestos						
<b>B00T - R0036 - Workshop Area (123.7 m2)</b>						
No Asbestos						
<b>B00T - R0037 - External Movement (51.23 m2)</b>						
Recently Modified Space	Requires Inspection					
<b>B00T - R0038 - Covered Area (26.53 m2)</b>						
Recently Modified Space	Requires Inspection					

2017



Product	Material Description	Extent	Location Reference	Material Condition	Risk Status	Control Priority
Sample No					Test Result	

**B0AG - Agricultural Science - 1957 - Brick/Block (Brick/Block)**

**Exterior**

Ceiling Voids	No Asbestos Found
Underfloor Voids	No Asbestos Found

**Interior**

**B0AG - R0001 - Animal Space (8.44 m2)**

No Asbestos

**B0AG - R0002 - General Storeroom (12.63 m2)**

No Asbestos

**B0AG - R0003 - Class Tools Storage (21.02 m2)**

No Asbestos

**B0AG - R0006 - Class Tools Storage (12.87 m2)**

No Asbestos

**B0AG - R0008 - Agriculture Covered Area (34.18 m2)**

No Asbestos

**B0AG - R0009 - Agriculture Covered Area (27.18 m2)**

No Asbestos

**B0AG - R0010 - Staff Shower (5.8 m2)**

No Asbestos

**B0AG - R0011 - Staff - Toilet (2.38 m2)**

No Asbestos

**B0AG - R0012 - Animal Space (26.52 m2)**

No Asbestos

**B0AG - R0013 - Large Equipment Store (42.08 m2)**

No Asbestos

2017

Product	Material Description	Extent	Location Reference	Material Condition	Risk Status	Control Priority
Sample No					Test Result	

**B0HS - Technological & Applied Studies - 1940 - Brick/Block (Brick/Block)**

**Exterior**

Ceiling Voids	No Asbestos Found
Underfloor Voids	No Asbestos Found

**Interior**

**B0HS - R0001 - Kitchen - Type 1 (93.68 m2)**

No Asbestos

**B0HS - R0008 - Student Change - Type 2 (13.35 m2)**

No Asbestos

**B0HS - R0009 - Kitchen - Type 1 (105.79 m2)**

No Asbestos

**B0HS - R0011 - External Movement (6.18 m2)**

No Asbestos

**B0HS - R0012 - Movement (24.93 m2)**

No Asbestos

**B0HS - R0013 - Seminar/Technology Space (24.77 m2)**

No Asbestos

**B0HS - R0014 - Pantry (33.48 m2)**

No Asbestos

**B0HS - R0015 - Covered Area (39.67 m2)**

No Asbestos

**B0HS - R0016 - External Movement (28.64 m2)**

No Asbestos

2017

Product	Material Description	Extent	Location Reference	Material Condition	Risk Status	Control Priority
Sample No					Test Result	

**B0P1 - General Learning - 1957 - Timber (Timber)**

**Exterior**

Eaves Linings	Flat AC Sheeting	20m2	North, South, East, West	Good Condition (1)	Low (1)	Low Priority (2-3)
	8117/B00E/Eaves Linings/S3					<b>Chrysotile (white asbestos)</b>
Ceiling Voids	No Asbestos Found					
Underfloor Voids	No Asbestos Found					

**Interior**

**B0P1 - R0001 - General Storeroom (6.5 m2)**

No Asbestos

**B0P1 - R0002 - General Learning Space (53.41 m2)**

Wall Linings Internal	Flat AC Sheeting	30m2	Throughout	Good Condition (1)	Low (1)	Low Priority (2-3)
	8117/B0P1/R0002/Wall Linings Internal/S4					<b>Chrysotile (white asbestos)</b>

**B0P1 - R0003 - General Learning Space (53.41 m2)**

Floor Coverings Res/Textile	Vinyl Tiles					<b>No Asbestos Detected</b>
	8117/B0P1/R0003/Floor Coverings Res/Textile/S5					
Wall Linings Internal	Flat AC Sheeting	30m2	Throughout	Good Condition (1)	Low (1)	Low Priority (2-3)
	8117/B0P1/R0002/Wall Linings Internal/S4					<b>Chrysotile (white asbestos)</b>

**B0P1 - R0004 - General Storeroom (6.62 m2)**

Floor Coverings Res/Textile	Vinyl Tiles					<b>No Asbestos Detected</b>
	8117/B0P1/R0003/Floor Coverings Res/Textile/S5					

**B0P1 - R0005 - Resources Store (11.01 m2)**

Floor Coverings Res/Textile	Vinyl Tiles					<b>No Asbestos Detected</b>
	8117/B0P1/R0003/Floor Coverings Res/Textile/S5					

**B0P1 - R0006 - External Movement (26.52 m2)**

No Asbestos

**B0P1 - R0007 - External Movement (8.17 m2)**

No Asbestos

2017

Product	Material Description	Extent	Location Reference	Material Condition	Risk Status	Control Priority
Sample No					Test Result	

**B0P2 - General Learning - 1947 - Timber (Timber)**

**Exterior**

Ceiling Voids	No Asbestos Found
Underfloor Voids	No Asbestos Found

**Interior**

**B0P2 - R0001 - General Learning Space (52.31 m2)**

Wall Linings Internal	Flat AC Sheeting	30m2	Throughout	Good Condition (1)	Low (1)	Low Priority (2-3)
8117/B0P1/R0002/Wall Linings Internal/S4					<b>Chrysotile (white asbestos)</b>	

**B0P2 - R0002 - Staff Study (52.31 m2)**

Wall Linings Internal	Flat AC Sheeting	30m2	Throughout	Good Condition (1)	Low (1)	Low Priority (2-3)
8117/B0P1/R0002/Wall Linings Internal/S4					<b>Chrysotile (white asbestos)</b>	

Floor Coverings Res/Textile	Vinyl Tiles					<b>No Asbestos Detected</b>
8117/B0P1/R0003/Floor Coverings Res/Textile/S5						

**B0P2 - R0003 - General Storeroom (6.82 m2)**

Wall Linings Internal	Flat AC Sheeting	2m2	North	Good Condition (1)	Low (1)	Low Priority (2-3)
8117/B0P1/R0002/Wall Linings Internal/S4					<b>Chrysotile (white asbestos)</b>	

**B0P2 - R0004 - External Movement (28.01 m2)**

No Asbestos

**B0P2 - R0005 - External Movement (61.88 m2)**

No Asbestos

2017

Product	Material Description	Extent	Location Reference	Material Condition	Risk Status	Control Priority
Sample No					Test Result	

**B0P3 - General Learning - 1912 - Timber (Timber)****Exterior**

Eaves Linings	Flat AC Sheeting	6m2	North	Good Condition (1)	Low (1)	Low Priority (2-3)
	8117/B00E/Eaves Linings/S3					<b>Chrysotile (white asbestos)</b>
Ceiling Voids	No Asbestos Found					
Underfloor Voids	No Asbestos Found					

**Interior****B0P3 - R0001 - General Learning Space (52.31 m2)**

Wall Linings Internal	Flat AC Sheeting	30m2	Throughout	Minimal Damage (2)	Low (1)	Low Priority (2-3)
	8117/B0P1/R0002/Wall Linings Internal/S4					<b>Chrysotile (white asbestos)</b>

**B0P3 - R0002 - General Learning Space (52.31 m2)**

Wall Linings Internal	Flat AC Sheeting	30m2	Throughout	Good Condition (1)	Low (1)	Low Priority (2-3)
	8117/B0P1/R0002/Wall Linings Internal/S4					<b>Chrysotile (white asbestos)</b>

**B0P3 - R0003 - General Storeroom (7.65 m2)**

No Asbestos

**B0P3 - R0005 - External Movement (71.61 m2)**

No Asbestos

2017

Product	Material Description	Extent	Location Reference	Material Condition	Risk Status	Control Priority
Sample No					Test Result	

**B0P4 - General Learning - 1912 - Timber (Timber)**

**Exterior**

Eaves Linings	Flat AC Sheeting	5m2	Variable positions	Good Condition (1)	Low (1)	Low Priority (2-3)
	8117/B00E/Eaves Linings/S3					<b>Chrysotile (white asbestos)</b>
Ceiling Voids	No Asbestos Found					
Underfloor Voids	No Asbestos Found					

**Interior**

**B0P4 - R0003 - Cleaning Store - Distributed (7.57 m2)**

No Asbestos

**B0P4 - R0005 - External Movement (55.43 m2)**

No Asbestos

**B0P4 - R0006 - Movement (8.54 m2)**

No Asbestos

**B0P4 - R0007 - Art Entry/Display (105.33 m2)**

No Asbestos

**B0P4 - R0008 - Visual Arts Store (18.19 m2)**

No Asbestos

2017

Product	Material Description	Extent	Location Reference	Material Condition	Risk Status	Control Priority
Sample No					Test Result	

**B0SP - Physical Education/Shed - 1980 - Steel (Steel)**

**Exterior**

Electrical Backing Board	Resinous Board	1Unit	West	Minimal Damage (2)	Low (1)	Low Priority (2-3)
	8117/B0SP/Electrical Backing Board/S25					<b>Chrysotile (white asbestos)</b>
Ceiling Voids	No Asbestos Found					
Underfloor Voids	No Asbestos Found					

**Interior**

**B0SP - R0001 - Gymnasium (23.02 m2)**

No Asbestos

**B0SP - R0002 - Sport Equipment Store (62.66 m2)**

No Asbestos

**B0SP - R0003 - No Access (26.36 m2)**

No Asbestos

2017

Product	Material Description	Extent	Location Reference	Material Condition	Risk Status	Control Priority
Sample No					Test Result	

**BMPU - Multi Purpose Facilities - 1991 - Brick/Veneer (Brick/Veneer)**

**Exterior**

Ceiling Voids	No Asbestos Found
Underfloor Voids	No Asbestos Found

**Interior**

**BMPU - M0001 - Stage (6.56 m2)**

No Asbestos

**BMPU - M0002 - Stage (4.78 m2)**

No Asbestos

**BMPU - M0003 - Resources Store (1.22 m2)**

No Asbestos

**BMPU - R0001 - Multi-Purpose Space (490 m2)**

No Asbestos

**BMPU - R0002 - Staff Kitchen (15 m2)**

No Asbestos

**BMPU - R0003 - Cleaning Store - Distributed (3.48 m2)**

No Asbestos

**BMPU - R0004 - Toilets-Girls (21.38 m2)**

No Asbestos

**BMPU - R0005 - Shower/Change (30.48 m2)**

No Asbestos

**BMPU - R0006 - Movement (5.93 m2)**

No Asbestos

**BMPU - R0007 - Stage (70.93 m2)**

No Asbestos

**BMPU - R0009 - Shower/Change (30.64 m2)**

No Asbestos

**BMPU - R0010 - Toilets-Boys (21.45 m2)**

No Asbestos

**BMPU - R0011 - Distribution Board Cupboard (3.37 m2)**

Note: No inspection of live electrical installation.

No Asbestos

**BMPU - R0012 - Public Entry (16.07 m2)**

No Asbestos

**BMPU - R0013 - Toilets-Disabled (4.24 m2)**

No Asbestos

**BMPU - R0014 - Chair Store (51.48 m2)**

No Asbestos

**BMPU - R0015 - Staff Study (33.52 m2)**

Vinyl Tiles (Under Floor Covering/Carpet) No Asbestos Found

**BMPU - R0016 - Staff Shower (6.07 m2)**

No Asbestos

**BMPU - R0017 - Pupil Entry (16.18 m2)**

No Asbestos

**BMPU - R0018 - External Movement (267.28 m2)**

No Asbestos

**BMPU - R0019 - Movement (16.5 m2)**

No Asbestos



Product	Material Description	Extent	Location Reference	Material Condition	Risk Status	Control Priority
Sample No					Test Result	

BMPU - R0020 - Movement (44.93 m2)

No Asbestos

2017

Product	Material Description	Extent	Location Reference	Material Condition	Risk Status	Control Priority
Sample No					Test Result	

**Build+1 - Walkway**

**Exterior**

No Asbestos

**Interior**

**Build+1 - Room+1 - Movement**

Ceiling Structures/Linings Flat AC Sheeting  
 8117/B00C/R0011/Ceiling Structures/Linings/S6

**No Asbestos Detected**

2017

Product	Material Description	Extent	Location Reference	Material Condition	Risk Status	Control Priority
Sample No					Test Result	

### Demountables

Demountable details as per the AMS records as of 15 Feb 2017.

OS 601 - D10510 - Learning Unit - Standard/Withdrawal : Placement Date - 30/06/1995

#### Exterior

Step Treads	Compressed AC Sheet	Assumed Asbestos		1.08 m2
Landing	Compressed AC Sheet	Assumed Asbestos		1.2 m2
Eave Lining	Flat AC Sheet	Assumed Asbestos		11.52 m2

#### Interior

##### R1 - Entry

End wall panel	Flat AC Sheet	Assumed Asbestos		18 m2
Ceiling	Flat AC Sheet	Assumed Asbestos		8 m2

##### R2 - General Learning Space

End wall panel	Flat AC Sheet	Assumed Asbestos		18 m2
Ceiling	Flat AC Sheet	Assumed Asbestos		55 m2

##### R3 - Store

Ceiling	Flat AC Sheet	Assumed Asbestos		10 m2
---------	---------------	------------------	--	-------

2017

Product	Material Description	Extent	Location Reference	Material Condition	Risk Status	Control Priority
Sample No					Test Result	

***Listing of Electronic Attachments as of 22/03/2017***

**Available Asbestos Related Electronic Files**

8117\_ASB\_221112\_AMP.pdf

\* Note : Refer to AMS for details of the attachment(s).

2017