

# Asbestos Register

(Hazardous Materials and Risk Assessment)

**School :** Gladesville Public School (1990)  
**Region :** Northern Sydney  
**State Electorate :** Lane Cove  
**Local Government Area :** Ryde

**Initial Survey :** Noel Arnold & Associates : 23 - Feb - 2008  
**Reviewed By :** AECOM : 28 - Jun - 2016

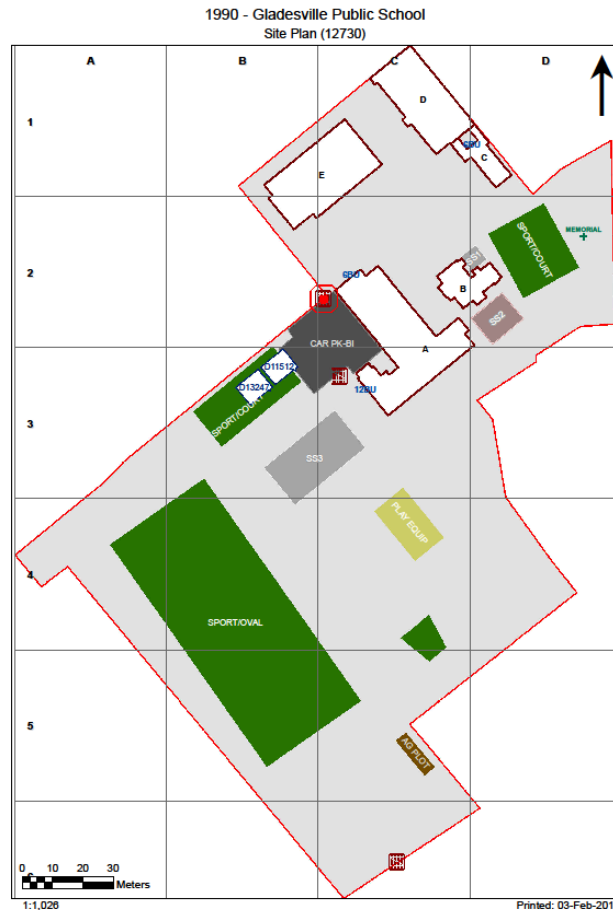

2017

Product	Material Description	Extent	Location Reference	Material Condition	Risk Status	Control Priority
Sample No				Test Result		

**B00A - General Learning/Administration - 1927 - Brick/Block (Brick/Block)**

**Exterior**

Underfloor Voids - Packing to Floor Joists	No Asbestos Found					
Ceiling Voids - Flat Roof	Non Accessible Area - Height Restriction void hatch located in AR0015					
Eaves Linings	Flat AC Sheeting 1990/B00A/Eaves Linings/S14				<b>No Asbestos Detected</b>	
Gable Ends	Flat AC Sheeting	10m2	East facing, West facing	Good Condition (1)	Low (1)	Low Priority (2-3)
	1990/B00A/Eaves Linings/S4				<b>Chrysotile (white asbestos)</b>	

**Interior**

**B00A - R0001 - Movement**

No Asbestos

**B00A - R0002 - Movement**

No Asbestos

**B00A - R0003 - Staff Toilet**

Partition Walls (Cubicles)	Compressed AC Sheet	3m2	All surfaces	Good Condition (1)	Low (1)	Low Priority (2-3)
	1990/B00A/R0012/Partition Walls (Cubicles)/S5				<b>Chrysotile (white asbestos)</b>	
Wall Linings Internal	Flat AC Sheeting	6m2	South facing, East facing	Minimal Damage (2)	Low (1)	Low Priority (2-3)
	1990/B00A/R0012/Wall Linings Internal/S6				<b>Chrysotile (white asbestos) , Amosite (brown asbestos)</b>	
Ceiling Structures/Linings	Flat AC Sheeting	7m2	All surfaces	Good Condition (1)	Low (1)	Low Priority (2-3)
	1990/B00A/R0012/Wall Linings Internal/S6				<b>Chrysotile (white asbestos) , Amosite (brown asbestos)</b>	

**B00A - R0004 - Movement**

No Asbestos

**B00A - R0005 - Staff Toilet**

Partition Walls (Cubicles)	Compressed AC Sheet	6m2	All surfaces	Some Damage / Unsealed (3)	Medium (2)	Medium Priority (4-5)
	1990/B00A/R0012/Partition Walls (Cubicles)/S5				<b>Chrysotile (white asbestos)</b>	
Wall Linings Internal	Flat AC Sheeting	12m2	East facing	Good Condition (1)	Low (1)	Low Priority (2-3)
	1990/B00A/R0012/Wall Linings Internal/S6				<b>Chrysotile (white asbestos) , Amosite (brown asbestos)</b>	

**B00A - R0006 - Principal**

No Asbestos

**B00A - R0007 - Movement**

No Asbestos

**B00A - R0008 - Raised Platform**

No Asbestos

**B00A - R0009 - Communal Space**

No Asbestos

**B00A - R0010 - General Storeroom**

No Asbestos

**B00A - R0012 - Toilets - Girls**

Wall Linings Internal	Flat AC Sheeting	30m2	South facing, East facing, West facing	Minimal Damage (2)	Low (1)	Low Priority (2-3)
	1990/B00A/R0012/Wall Linings Internal/S6				<b>Chrysotile (white asbestos) , Amosite (brown asbestos)</b>	

Product	Material Description	Extent	Location Reference	Material Condition	Risk Status	Control Priority
Sample No				Test Result		
Partition Walls (Cubicles)	Compressed AC Sheet	3m2	All surfaces	Some Damage / Unsealed (3)	Medium (2)	Medium Priority (4-5)
1990/B00A/R0012/Partition Walls (Cubicles)/S5				<b>Chrysotile (white asbestos)</b>		
<b>B00A - R0013 - Toilets - Boys</b>						
Partition Walls (Cubicles)	Compressed AC Sheet	2m2	All surfaces	Good Condition (1)	Low (1)	Low Priority (2-3)
1990/B00A/R0012/Partition Walls (Cubicles)/S5				<b>Chrysotile (white asbestos)</b>		
Wall Linings Internal	Flat AC Sheeting	20m2	North facing, East facing, West facing	Minimal Damage (2)	Low (1)	Low Priority (2-3)
1990/B00A/R0012/Wall Linings Internal/S6				<b>Chrysotile (white asbestos) , Amosite (brown asbestos)</b>		
<b>B00A - R0014 - Movement</b>						
No Asbestos						
<b>B00A - R0015 - Movement</b>						
No Asbestos						
<b>B00A - R0016 - Practical Activities - 1hb</b>						
No Asbestos						
<b>B00A - R0017 - Home Base</b>						
No Asbestos						
<b>B00A - R0018 - Home Base</b>						
No Asbestos						
<b>B00A - R0019 - Home Base</b>						
No Asbestos						
<b>B00A - R0020 - Home Base</b>						
No Asbestos						
<b>B00A - R0021 - Sports Store</b>						
No Asbestos						
<b>B00A - R0022 - General Storeroom</b>						
No Asbestos						
<b>B00A - R0023 - Movement</b>						
No Asbestos						
<b>B00A - R0024 - Movement</b>						
Ceiling Structures/Linings	Flat AC Sheeting	13m2	All surfaces	Good Condition (1)	Low (1)	Low Priority (2-3)
1990/B00A/Eaves Linings/S4				<b>Chrysotile (white asbestos)</b>		
<b>B00A - R0025 - Movement</b>						
No Asbestos						
<b>B00A - R0026 - Staff Room</b>						
No Asbestos						
<b>B00A - R0027 - Home Base</b>						
No Asbestos						
<b>B00A - R0028 - General Storeroom</b>						
Floor Coverings Res/Textile	Vinyl Tiles	10m2	All surfaces	Good Condition (1)	Low (1)	Low Priority (2-3)
1990/B00A/R1007/Floor Coverings Res/Textile/S7				<b>Chrysotile (white asbestos)</b>		
<b>B00A - R0029 - Interview</b>						
No Asbestos						
<b>B00A - R0030 - Movement</b>						
No Asbestos						
<b>B00A - R0031 - Sick Bay</b>						
No Asbestos						
<b>B00A - R0033 - Movement</b>						
No Asbestos						

Product	Material Description	Extent	Location Reference	Material Condition	Risk Status	Control Priority
Sample No					Test Result	
<b>B00A - R0035 - Clerical Office</b>						
No Asbestos						
<b>B00A - R0036 - Duplicating Workroom</b>						
No Asbestos						
<b>B00A - R1001 - General Storeroom</b>						
Floor Coverings Res/Textile	Vinyl Tiles	9m2	All surfaces	Good Condition (1)	Low (1)	Low Priority (2-3)
1990/B00A/R1007/Floor Coverings Res/Textile/S7					Chrysotile (white asbestos)	
<b>B00A - R1002 - General Storeroom</b>						
Floor Coverings Res/Textile	Vinyl Tiles	8m2	All surfaces	Good Condition (1)	Low (1)	Low Priority (2-3)
1990/B00A/R1007/Floor Coverings Res/Textile/S7					Chrysotile (white asbestos)	
<b>B00A - R1003 - Personal Effects Storage</b>						
No Asbestos						
<b>B00A - R1004 - Movement</b>						
No Asbestos						
<b>B00A - R1005 - Seminar/Study</b>						
No Asbestos						
<b>B00A - R1006 - Reading Area</b>						
No Asbestos						
<b>B00A - R1007 - Library Office/Workroom</b>						
Floor Coverings Res/Textile	Vinyl Tiles	16m2	All surfaces	Good Condition (1)	Low (1)	Low Priority (2-3)
1990/B00A/R1007/Floor Coverings Res/Textile/S7					Chrysotile (white asbestos)	
<b>B00A - R1008 - K.L.A. Store</b>						
Floor Coverings Res/Textile	Vinyl Tiles	9m2	All surfaces	Minimal Damage (2)	Low (1)	Low Priority (2-3)
1990/B00A/R1007/Floor Coverings Res/Textile/S7					Chrysotile (white asbestos)	
<b>B00A - R1010 - Movement</b>						
No Asbestos						
<b>B00A - R1011 - Toilets - Girls</b>						
Wall Linings Internal	Flat AC Sheeting	30m2	North facing, East facing, West facing	Minimal Damage (2)	Low (1)	Low Priority (2-3)
1990/B00A/R0012/Wall Linings Internal/S6					Chrysotile (white asbestos) , Amosite (brown asbestos)	
Partition Walls (Cubicles)	Compressed AC Sheet	3m2	All surfaces	Good Condition (1)	Low (1)	Low Priority (2-3)
1990/B00A/R0012/Partition Walls (Cubicles)/S5					Chrysotile (white asbestos)	
<b>B00A - R1012 - Toilets - Boys</b>						
Wall Linings Internal	Flat AC Sheeting	20m2	North facing, East facing, West facing	Minimal Damage (2)	Low (1)	Low Priority (2-3)
1990/B00A/R0012/Wall Linings Internal/S6					Chrysotile (white asbestos) , Amosite (brown asbestos)	
Partition Walls (Cubicles)	Compressed AC Sheet	2m2	All surfaces	Good Condition (1)	Low (1)	Low Priority (2-3)
1990/B00A/R0012/Partition Walls (Cubicles)/S5					Chrysotile (white asbestos)	
<b>B00A - R1013 - General Storeroom</b>						
No Asbestos						
<b>B00A - R1014 - Movement</b>						
No Asbestos						
<b>B00A - R1015 - Cleaning Distributed Store</b>						
No Asbestos						
<b>B00A - R1016 - Practical Activities - 1hb</b>						
No Asbestos						

Product	Material Description	Extent	Location Reference	Material Condition	Risk Status	Control Priority
Sample No					Test Result	
<b>B00A - R1017 - Home Base</b>						
No Asbestos						
<b>B00A - R1018 - Home Base</b>						
No Asbestos						
<b>B00A - R1019 - Home Base</b>						
No Asbestos						
<b>B00A - R1020 - Home Base</b>						
No Asbestos						
<b>B00A - R1021 - Craft Store</b>						
No Asbestos						
<b>B00A - R1022 - Movement</b>						
No Asbestos						
<b>B00A - R1023 - Kiln Room</b>						
No Asbestos						
<b>B00A - R1024 - Practical Activities - 1hb</b>						
No Asbestos						
<b>B00A - R1025 - Movement</b>						
No Asbestos						
<b>B00A - R1026 - Reading Area</b>						
No Asbestos						
<b>B00A - R1027 - Reading Area</b>						
No Asbestos						
<b>B00A - R1028 - Home Base</b>						
No Asbestos						
<b>B00A - R1029 - Home Base</b>						
No Asbestos						
<b>B00A - R9001 - General Storeroom</b>						
Ceiling Structures/Linings	Flat AC Sheeting	12m2	North facing, West facing	Some Damage / Unsealed (3)	Low (1)	Medium Priority (4-5)
1990/B00A/R9001/Ceiling Structures/Linings/S13					<b>Chrysotile (white asbestos)</b>	
<b>B00A - R9002 - General Assistant/Bulk Store</b>						
No Asbestos						
<b>B00A - R9003 - Cleaning Distributed Store</b>						
No Asbestos						
<b>B00A - R9004 - Movement</b>						
No Asbestos						
<b>B00A - R9005 - Movement</b>						
No Asbestos						
<b>B00A - R9006 - Movement</b>						
Ceiling Structures/Linings	Flat AC Sheeting	9m2	All surfaces	Good Condition (1)	Low (1)	Low Priority (2-3)
1990/B00A/Eaves Linings/S4					<b>Chrysotile (white asbestos)</b>	
<b>B00A - R9007 - General Storeroom</b>						
No Asbestos						
<b>B00A - R9008 - Movement</b>						
No Asbestos						
<b>B00A - R9009 - General Storeroom</b>						
Ceiling Structures/Linings	Flat AC Sheeting	13m2	All surfaces	Good Condition (1)	Low (1)	Low Priority (2-3)
1990/B00A/R9009/Ceiling Structures/Linings/S12					<b>Chrysotile (white asbestos)</b>	
<b>B00A - R9010 - Cleaning Distributed Store</b>						
No Asbestos						

Product	Material Description	Extent	Location Reference	Material Condition	Risk Status	Control Priority
Sample No					Test Result	
<b>B00A - R9011 - Toilets - Boys</b>						
Partition Walls (Cubicles)	Compressed AC Sheet	8m2	All surfaces	Some Damage / Unsealed (3)	Medium (2)	Medium Priority (4-5)
1990/B00A/R0012/Partition Walls (Cubicles)/S5					<b>Chrysotile (white asbestos)</b>	
<b>B00A - R9012 - Toilets - Girls</b>						
Partition Walls (Cubicles)	Compressed AC Sheet	7m2	All surfaces	Some Damage / Unsealed (3)	Medium (2)	Medium Priority (4-5)
1990/B00A/R0012/Partition Walls (Cubicles)/S5					<b>Chrysotile (white asbestos)</b>	

2017

Product	Material Description	Extent	Location Reference	Material Condition	Risk Status	Control Priority
Sample No					Test Result	

**B00B - Other-After School Care - 1879 - Sandstone (Sandstone)**

**Exterior**

Underfloor Voids - Slab on Ground	Non Accessible Area - Area inaccessible					
Ceiling Voids - Flat Roof	Non Accessible Area - Area inaccessible no void hatch located					
Eaves Linings	Flat AC Sheeting 1990/B00A/Eaves Linings/S4	4m2	South facing	Good Condition (1)	Low (1)	Low Priority (2-3) <b>Chrysotile (white asbestos)</b>

**Interior**

**B00B - R0001 - Practical Activities - 1hb**

No Asbestos

**B00B - R0002 - Toilets - Boys/Girls**

Wall Linings Internal	Flat AC Sheeting 1990/B00B/R0002/Wall Linings Internal/S9	8m2	East facing	Good Condition (1)	Low (1)	Low Priority (2-3) <b>Chrysotile (white asbestos) , Amosite (brown asbestos)</b>
-----------------------	--	-----	-------------	--------------------	---------	---

**B00B - R0003 - Personal Effects Storage**

No Asbestos

**B00B - R0004 - Staff Toilet**

Wall Linings Internal	Flat AC Sheeting 1990/B00B/R0004/Wall Linings Internal/S8					<b>No Asbestos Detected</b>
-----------------------	--	--	--	--	--	-----------------------------

**B00B - R0005 - Movement**

No Asbestos

**B00B - R0006 - General Storeroom**

No Asbestos

**B00B - R0007 - Staff Kitchen**

No Asbestos

**B00B - R0008 - Practical Activities - 1hb**

No Asbestos

**B00B - R0009 - Staff Room**

No Asbestos

**B00B - R0010 - Movement**

No Asbestos

**B00B - R0011 - Movement**

No Asbestos

**B00B - R0012 - Movement**

No Asbestos

2017

Product	Material Description	Extent	Location Reference	Material Condition	Risk Status	Control Priority
Sample No					Test Result	

**B00C - Pupil Facilities - 1978 - Brick/Block (Brick/Block)**

**Exterior**

Underfloor Voids - Slab on Ground	Non Accessible Area - Area inaccessible					
Ceiling Voids - Flat Roof	Non Accessible Area - Area inaccessible no void hatch located					

**Interior**

**B00C - R0003 - Toilets - Girls**

Ceiling Structures/Linings	Flat AC Sheeting 1990/B00C/R0003/Ceiling Structures/Linings/S10					<b>No Asbestos Detected</b>
----------------------------	--	--	--	--	--	-----------------------------

**B00C - R0004 - Toilets - Boys**

Ceiling Structures/Linings	Flat AC Sheeting 1990/B00C/R0003/Ceiling Structures/Linings/S10					<b>No Asbestos Detected</b>
----------------------------	--	--	--	--	--	-----------------------------

**B00C - R0005 - General Assistant/Bulk Store**

Ceiling Structures/Linings	Flat AC Sheeting 1990/B00C/R0003/Ceiling Structures/Linings/S10					<b>No Asbestos Detected</b>
----------------------------	--	--	--	--	--	-----------------------------

**B00C - R0006 - General Assistant/Bulk Store**

Ceiling Structures/Linings	Flat AC Sheeting 1990/B00C/R0003/Ceiling Structures/Linings/S10					<b>No Asbestos Detected</b>
----------------------------	--	--	--	--	--	-----------------------------

**B00C - R0007 - Movement**

Ceiling Structures/Linings	Flat AC Sheeting 1990/B00C/R0003/Ceiling Structures/Linings/S10					<b>No Asbestos Detected</b>
----------------------------	--	--	--	--	--	-----------------------------

**B00C - R0008 - Movement**

Ceiling Structures/Linings	Flat AC Sheeting 1990/B00C/R0003/Ceiling Structures/Linings/S10					<b>No Asbestos Detected</b>
----------------------------	--	--	--	--	--	-----------------------------

**B00C - R0009 - Movement**

No Asbestos

2017



Product	Material Description	Extent	Location Reference	Material Condition	Risk Status	Control Priority
Sample No					Test Result	

**B00D - General Learning - 1920 - Brick/Block (Brick/Block)**

**Exterior**

Ceiling Voids - Flat Roof	Non Accessible Area - Height Restriction Area inaccessible					
Underfloor Voids - Packing to Floor Joists	No Asbestos Found					
Eaves Linings	Flat AC Sheeting	50m2	All surfaces	Poor Condition - Extensive Damage (4)	Low (1)	Medium Priority (4-5)
	1990/B00A/Eaves Linings/S4					<b>Chrysotile (white asbestos)</b>
Wall Cladding	Flat AC Sheeting 1990/B00D/Wall Cladding/S11					<b>No Asbestos Detected</b>
Wall Cladding	Flat AC Sheeting	27m2	West under windows	Good Condition (1)	Low (1)	Low Priority (2-3)
	1990/B00D/R0013/Wall Linings Internal/S2					<b>Chrysotile (white asbestos)</b>

**Interior**

**B00D - R0001 - Movement**

No Asbestos

**B00D - R0002 - Cleaning Distributed Store**

No Asbestos

**B00D - R0003 - Movement**

Floor Coverings Res/Textile	Vinyl Tiles	2m2	All surfaces	Good Condition (1)	Low (1)	Low Priority (2-3)
	1990/B00D/R0003/Floor Coverings Res/Textile/S1					<b>Chrysotile (white asbestos)</b>

**B00D - R0004 - Staff Toilet**

Floor Coverings Res/Textile	Vinyl Tiles	4m2	All surfaces	Good Condition (1)	Low (1)	Low Priority (2-3)
	1990/B00D/R0003/Floor Coverings Res/Textile/S1					<b>Chrysotile (white asbestos)</b>

**B00D - R0005 - Movement**

No Asbestos

**B00D - R0006 - Craft Store**

No Asbestos

**B00D - R0007 - General Storeroom**

No Asbestos

**B00D - R0008 - General Storeroom**

No Asbestos

**B00D - R0009 - Sick Bay**

No Asbestos

**B00D - R0011 - Toilets - Boys/Girls**

Wall Linings Internal	Flat AC Sheeting 1990/B00D/Wall Cladding/S11					<b>No Asbestos Detected</b>
Ceiling Structures/Linings	Flat AC Sheeting 1990/B00D/Wall Cladding/S11					<b>No Asbestos Detected</b>

**B00D - R0012 - Movement**

No Asbestos

**B00D - R0013 - Home Base**

Wall Linings Internal	Flat AC Sheeting	9m2	West facing, lower portion, below window	Good Condition (1)	Low (1)	Low Priority (2-3)
	1990/B00D/R0013/Wall Linings Internal/S2					<b>Chrysotile (white asbestos)</b>
Wall Linings Internal	Flat AC Sheeting	2m2	Southwest, adjacent sink	Good Condition (1)	Low (1)	Low Priority (2-3)
	1990/B00D/R0013/Wall Linings Internal/S3					<b>Chrysotile (white asbestos) , Amosite (brown asbestos)</b>

**B00D - R0014 - Movement**

Product	Material Description	Extent	Location Reference	Material Condition	Risk Status	Control Priority
Sample No					Test Result	
Wall Linings Internal	Flat AC Sheeting	3m2	West facing, lower portion, below window	Good Condition (1)	Low (1)	Low Priority (2-3)
1990/B00D/R0013/Wall Linings Internal/S2					Chrysotile (white asbestos)	
<b>B00D - R0015 - Music Store</b>						
No Asbestos						
<b>B00D - R0016 - Practical Activities - 1hb</b>						
No Asbestos						
<b>B00D - R0017 - Home Base</b>						
No Asbestos						
<b>B00D - R0018 - Home Base</b>						
No Asbestos						
<b>B00D - R0019 - Home Base</b>						
No Asbestos						
<b>B00D - R0020 - Practical Activities - 1hb</b>						
No Asbestos						
<b>B00D - R0021 - Special Programs Room</b>						
No Asbestos						
<b>B00D - R1001 - Movement</b>						
No Asbestos						
<b>B00D - R1002 - General Storeroom</b>						
No Asbestos						
<b>B00D - R1003 - Movement</b>						
No Asbestos						
<b>B00D - R1004 - Staff Room</b>						
No Asbestos						
<b>B00D - R1005 - Practical Activities - 1hb</b>						
No Asbestos						
<b>B00D - R1006 - Movement</b>						
No Asbestos						
<b>B00D - R1007 - Special Programs Room</b>						
Wall Linings Internal	Flat AC Sheeting	12m2	West facing, lower portion, below window	Good Condition (1)	Low (1)	Low Priority (2-3)
1990/B00D/R0013/Wall Linings Internal/S2					Chrysotile (white asbestos)	
<b>B00D - R1008 - Movement</b>						
Wall Linings Internal	Flat AC Sheeting	3m2	West facing, lower portion, below window	Good Condition (1)	Low (1)	Low Priority (2-3)
1990/B00D/R0013/Wall Linings Internal/S2					Chrysotile (white asbestos)	
<b>B00D - R1009 - General Storeroom</b>						
No Asbestos						
<b>B00D - R1010 - Uniform Shop</b>						
No Asbestos						
<b>B00D - R1011 - Practical Activities - 1hb</b>						
No Asbestos						
<b>B00D - R1012 - Home Base</b>						
No Asbestos						
<b>B00D - R1013 - Home Base</b>						
No Asbestos						
<b>B00D - R1014 - Home Base</b>						
No Asbestos						
<b>B00D - R1015 - Home Base</b>						

Product	Material Description	Extent	Location Reference	Material Condition	Risk Status	Control Priority
	<b>Sample No</b>					<b>Test Result</b>

No Asbestos

**B00D - R9001 - Movement**

No Asbestos

**B00D - R9002 - General Storeroom**

No Asbestos

**B00D - R9003 - Hall Chair Store**

No Asbestos

**B00D - R9004 - Movement**

No Asbestos

2017

Product	Material Description	Extent	Location Reference	Material Condition	Risk Status	Control Priority
Sample No					Test Result	

**B00E - Communal Facilities - 2010 - Brick/Veneer (Brick/Veneer)**

**Exterior**

Underfloor Voids - Packing to Floor Joists	No Asbestos Found
Ceiling Voids	No Asbestos Found

**Interior**

**B00E - R0001 - Covered Outdoor Learning Area**

No Asbestos

**B00E - R0002 - Communal Space**

No Asbestos

**B00E - R0003 - Raised Platform**

No Asbestos

**B00E - R0004 - Chair Storeroom**

No Asbestos

**B00E - R0005 - Communal/Performance Store**

No Asbestos

**B00E - R0006 - P.E. Store**

No Asbestos

**B00E - R0007 - Toilet - Lobby**

No Asbestos

**B00E - R0008 - Toilets - Girls**

No Asbestos

**B00E - R0009 - Sound Cupboard**

No Asbestos

**B00E - R0010 - Toilet - Lobby**

No Asbestos

**B00E - R0011 - Toilets - Boys**

No Asbestos

**B00E - R0012 - Cleaning Distributed Store**

No Asbestos

**B00E - R0013 - General Storeroom**

No Asbestos

**B00E - R0014 - Main Switch Board**

No Asbestos

**B00E - R0015 - Disabled Shower/Toilet**

No Asbestos

**B00E - R0016 - External Movement**

No Asbestos

**B00E - R0017 - Movement**

No Asbestos

**B00E - R0018 - Movement**

No Asbestos

**B00E - R0019 - Movement**

No Asbestos

**B00E - R0020 - Canteen**

No Asbestos

**B00E - R0021 - Canteen Office/Store**

No Asbestos

Product	Material Description	Extent	Location Reference	Material Condition	Risk Status	Control Priority
Sample No					Test Result	

**Demountables**

**Demountable details as per the AMS records as of 15 Feb 2017.**

**OS 602 - D11512 - Learning Unit - Standard With P.A.A. : Placement Date - 24/12/2013**

Note: This refurbished demountable may have asbestos present in remnant mastic in window frames.

**Exterior**

No Asbestos Found.

**Interior**

**R1 - Learning space/withdrawal/entry**

No Asbestos Found.

**R2 - Home Base Store**

No Asbestos Found.

**OS 602 - D13247 - Learning Unit - Standard With P.A.A. : Placement Date - 19/02/2014**

Note: This refurbished demountable may have asbestos present in remnant mastic in window frames.

**Exterior**

No Asbestos Found.

**Interior**

**R1 - Learning space/withdrawal/entry**

No Asbestos Found.

**R2 - Home Base Store**

No Asbestos Found.

**- D15695 - : Placement Date - 7/09/2016**

Note: This refurbished demountable may have asbestos present in remnant mastic in window frames.

No Asbestos Found.

2017

Product	Material Description	Extent	Location Reference	Material Condition	Risk Status	Control Priority
Sample No					Test Result	

*Listing of Electronic Attachments as of 22/03/2017*

**There are no asbestos related file attachment(s) for this school.**

2017