

Asbestos Register

(Hazardous Materials and Risk Assessment)

School : Girraween Public School (1988)
Region : Western Sydney
State Electorate : Prospect
Local Government Area : Holroyd

Initial Survey : Noel Arnold & Associates : 22 - Apr - 2008
Reviewed By : Parsons Brinckerhoff : 14 - May - 2015

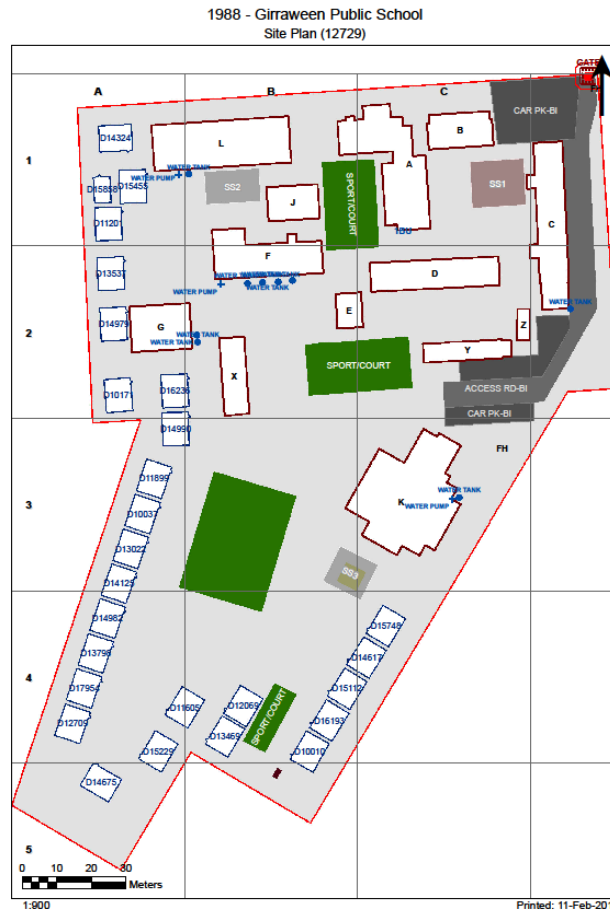

2017

Product	Material Description	Extent	Location Reference	Material Condition	Risk Status	Control Priority
Sample No					Test Result	

B00A - Library/General Learning - 1930 - Brick/Block (Brick/Block)**Exterior**

Gable Verge Lining	Flat AC Sheeting 1988/B00A/Gable Verge Lining/S20					No Asbestos Detected
Ceiling Voids	No Asbestos Found					
Underfloor Voids - Packing to Floor Joists	Flat AC Sheeting 1988/B00A/Underfloor Voids - Packing to Floor Joists/S21	1m2	Throughout	Some Damage - Unsealed (3)	Medium (2)	Medium Priority (4-5) Chrysotile (white asbestos) , Amosite (brown asbestos)
Underfloor Voids	Compressed AC Sheet 1988/B00A/Underfloor Voids/S22					No Asbestos Detected

Interior**B00A - R0001 - Movement**

No Asbestos

B00A - R0002 - Movement

Ceiling Structures/Linings	Flat AC Sheeting 1988/B00A/R0002/Ceiling Structures/Linings/S24	58m2	Throughout	Good Condition (1)	Low (1)	Low Priority (2-3) Chrysotile (white asbestos)
----------------------------	--	------	------------	--------------------	---------	--

B00A - R0003 - Community Clinic

Floor Coverings Res/Textile	Vinyl Tiles 1988/B00A/R0003/Floor Coverings Res/Textile/S1	16m2	Throughout	Good Condition (1)	Low (1)	Low Priority (2-3) Chrysotile (white asbestos)
-----------------------------	---	------	------------	--------------------	---------	--

B00A - R0004 - General Storeroom

No Asbestos

B00A - R0005 - Distribution Board

Note: No inspection of live electrical installation.

Ceiling Structures/Linings	Flat AC Sheeting 1988/B00A/R0002/Ceiling Structures/Linings/S24	2m2	Throughout	Good Condition (1)	Low (1)	Low Priority (2-3) Chrysotile (white asbestos)
----------------------------	--	-----	------------	--------------------	---------	--

B00A - R0006 - Home Base

Ceiling Structures/Linings	Flat AC Sheeting 1988/B00A/R0002/Ceiling Structures/Linings/S24	48m2	Throughout	Good Condition (1)	Low (1)	Low Priority (2-3) Chrysotile (white asbestos)
----------------------------	--	------	------------	--------------------	---------	--

B00A - R0007 - Home Base

Ceiling Structures/Linings	Flat AC Sheeting 1988/B00A/R0002/Ceiling Structures/Linings/S24	48m2	Throughout	Good Condition (1)	Low (1)	Low Priority (2-3) Chrysotile (white asbestos)
----------------------------	--	------	------------	--------------------	---------	--

B00A - R0008 - Movement

No Asbestos

B00A - R0009 - General Assistant/Bulk Store

Ceiling Structures/Linings	Flat AC Sheeting 1988/B00A/R0002/Ceiling Structures/Linings/S24	10m2	Throughout	Good Condition (1)	Low (1)	Low Priority (2-3) Chrysotile (white asbestos)
----------------------------	--	------	------------	--------------------	---------	--

B00A - R0010 - Security Store

Ceiling Structures/Linings	Flat AC Sheeting 1988/B00A/R0002/Ceiling Structures/Linings/S24	4m2	Throughout	Good Condition (1)	Low (1)	Low Priority (2-3) Chrysotile (white asbestos)
----------------------------	--	-----	------------	--------------------	---------	--

B00A - R0011 - Interview

Ceiling Structures/Linings	Flat AC Sheeting 1988/B00A/R0002/Ceiling Structures/Linings/S24	13m2	Throughout	Good Condition (1)	Low (1)	Low Priority (2-3) Chrysotile (white asbestos)
----------------------------	--	------	------------	--------------------	---------	--

B00A - R0016 - Movement

No Asbestos

B00A - R0017 - Movement

Ceiling Structures/Linings	Flat AC Sheeting 1988/B00A/R0002/Ceiling Structures/Linings/S24	2m2	Throughout	Good Condition (1)	Low (1)	Low Priority (2-3) Chrysotile (white asbestos)
----------------------------	--	-----	------------	--------------------	---------	--

Product	Material Description	Extent	Location Reference	Material Condition	Risk Status	Control Priority
Sample No					Test Result	
B00A - R0018 - Special Programs Room						
No Asbestos						
B00A - R0019 - Special Programs Store						
Ceiling Structures/Linings	Flat AC Sheeting	5m2	Throughout	Good Condition (1)	Low (1)	Low Priority (2-3)
1988/B00A/R0002/Ceiling Structures/Linings/S24					Chrysotile (white asbestos)	
B00A - R0020 - Staff Room						
No Asbestos						
B00A - R0021 - Staff Kitchen						
No Asbestos						
B00A - R0022 - Communications Room						
No Asbestos						
B00A - R0023 - Movement						
No Asbestos						
B00A - R0024 - Staff Toilet						
No Asbestos						
B00A - R0025 - Staff Toilet						
No Asbestos						

2017

Product	Material Description	Extent	Location Reference	Material Condition	Risk Status	Control Priority
Sample No					Test Result	

B00B - Administration - 1960 - Timber (Timber)**Exterior**

Eaves Linings	Flat AC Sheeting	10m2	North, South	Good Condition (1)	Low (1)	Low Priority (2-3)
	1988/B00B/Eaves Linings/S2				Chrysotile (white asbestos) , Amosite (brown asbestos)	
Eaves Linings	Flat AC Sheeting	30m2	North & South	Good Condition (1)	Low (1)	Low Priority (2-3)
	1988/B00B/Eaves Linings/S16				Chrysotile (white asbestos) , Amosite (brown asbestos)	
Ceiling Voids	No Asbestos Found					
Underfloor Voids	Compressed AC Sheet					
	1988/B00A/Underfloor Voids/S22				No Asbestos Detected	

Interior**B00B - R0001 - General Storeroom**

No Asbestos

B00B - R0002 - General Storeroom

No Asbestos

B00B - R0003 - Sick Bay

No Asbestos

B00B - R0004 - Staff Toilet

No Asbestos

B00B - R0005 - Staff Toilet

No Asbestos

B00B - R0006 - Interview

No Asbestos

B00B - R0007 - Deputy Principal

No Asbestos

B00B - R0008 - Deputy Principal

No Asbestos

B00B - R0009 - Principal

No Asbestos

B00B - R0010 - Entry Vestibule

No Asbestos

B00B - R0011 - Movement

No Asbestos

B00B - R0012 - Movement

Ceiling Structures/Linings	Flat AC Sheeting	31m2	Throughout	Good Condition (1)	Low (1)	Low Priority (2-3)
	1988/B00B/R0012/Ceiling Structures/Linings/S3				Chrysotile (white asbestos) , Amosite (brown asbestos)	

B00B - R0013 - Clerical Office

No Asbestos

B00B - R0014 - Duplicating Workroom

No Asbestos

Product	Material Description	Extent	Location Reference	Material Condition	Risk Status	Control Priority
Sample No					Test Result	

B00C - General Learning - 1960 - Brick/Block (Brick/Block)

Exterior

Gable Verge Lining	Flat AC Sheeting 1988/B00C/Gable Verge Lining/S19					No Asbestos Detected
Eaves Linings	Flat AC Sheeting 1988/B00C/Eaves Linings/S17	60m2	East, West	Good Condition (1)	Low (1)	Low Priority (2-3) Chrysotile (white asbestos) , Amosite (brown asbestos) , Crocidolite (blue asbestos)
Ceiling Voids	No Asbestos Found					
Underfloor Voids	No Asbestos Found					

Interior

B00C - R0001 - Home Base

Wall Linings Internal	Flat AC Sheeting 1988/B00C/R0001/Wall Linings Internal/S15	2m2	Behind heaters	Good Condition (1)	Low (1)	Low Priority (2-3) Chrysotile (white asbestos) , Amosite (brown asbestos)
-----------------------	---	-----	----------------	--------------------	---------	---

B00C - R0002 - Home Base Store

No Asbestos

B00C - R0003 - Personal Effects Storage

No Asbestos

B00C - R0004 - Movement

No Asbestos

B00C - R0005 - General Storeroom

No Asbestos

B00C - R0006 - Interview

No Asbestos

B00C - R0007 - Personal Effects Storage

No Asbestos

B00C - R0008 - Home Base Store

No Asbestos

B00C - R0009 - Home Base

Wall Linings Internal	Flat AC Sheeting 1988/B00C/R0001/Wall Linings Internal/S15	NA	Behind heaters	Good Condition (1)	Low (1)	Low Priority (2-3) Chrysotile (white asbestos) , Amosite (brown asbestos)
-----------------------	---	----	----------------	--------------------	---------	---

B00C - R0010 - Home Base

Wall Linings Internal	Flat AC Sheeting 1988/B00C/R0001/Wall Linings Internal/S15	2m2	Behind heaters	Good Condition (1)	Low (1)	Low Priority (2-3) Chrysotile (white asbestos) , Amosite (brown asbestos)
-----------------------	---	-----	----------------	--------------------	---------	---

B00C - R0011 - Home Base Store

No Asbestos

B00C - R0012 - Personal Effects Storage

No Asbestos

B00C - R0013 - Movement

No Asbestos

B00C - R0014 - Personal Effects Storage

No Asbestos

B00C - R0015 - Home Base Store

No Asbestos

B00C - R0016 - Home Base

Product	Material Description	Extent	Location Reference	Material Condition	Risk Status	Control Priority
Sample No					Test Result	
Wall Linings Internal	Flat AC Sheeting	2m2	Behind heaters	Good Condition (1)	Low (1)	Low Priority (2-3)
1988/B00C/R0001/Wall Linings Internal/S15				Chrysotile (white asbestos) , Amosite (brown asbestos)		

B00C - R0018 - Special Programs Store

No Asbestos

B00C - R0019 - Staff Toilet

No Asbestos

B00C - R0021 - Movement

Ceiling Structures/Linings	Flat AC Sheeting	8m2	Throughout	Good Condition (1)	Low (1)	Low Priority (2-3)
1988/B00F/R0009/Ceiling Structures/Linings/S5				Chrysotile (white asbestos) , Amosite (brown asbestos)		

B00C - R0022 - Movement

Ceiling Structures/Linings	Flat AC Sheeting	8m2	Throughout	Good Condition (1)	Low (1)	Low Priority (2-3)
1988/B00F/R0009/Ceiling Structures/Linings/S5				Chrysotile (white asbestos) , Amosite (brown asbestos)		

B00C - R0023 - Special Programs Room

No Asbestos

2017

Product	Material Description	Extent	Location Reference	Material Condition	Risk Status	Control Priority
Sample No					Test Result	

B00D - General Learning - 1960 - Brick/Block (Brick/Block)**Exterior**

Gable Verge Lining	Flat AC Sheeting 1988/B00C/Gable Verge Lining/S19					No Asbestos Detected
Eaves Linings	Flat AC Sheeting 1988/B00C/Eaves Linings/S17	60m2	North, South	Good Condition (1)	Low (1)	Low Priority (2-3)
Underfloor Voids - Packing to Floor Joists	Flat AC Sheeting 1988/B00D/Underfloor Voids - Packing to Floor Joists/S23	1m2	Throughout	Some Damage - Unsealed (3)	Low (1)	Medium Priority (4-5)
Ceiling Voids	No Asbestos Found					

Interior**B00D - R0001 - Withdrawal Space - 1hb**

Splashback Lining	Flat AC Sheeting 1988/B00D/R0001/Splashback/S12	2m2	West	Good Condition (1)	Low (1)	Low Priority (2-3)
-------------------	--	-----	------	--------------------	---------	--------------------

Chrysotile (white asbestos)**B00D - R0002 - General Storeroom**

Floor Coverings Res/Textile	Vinyl Tiles 1988/B00D/R0003/Floor Coverings Res/Textile/S11	7m2	Throughout	Good Condition (1)	Low (1)	Low Priority (2-3)
-----------------------------	--	-----	------------	--------------------	---------	--------------------

Chrysotile (white asbestos)**B00D - R0003 - General Storeroom**

Floor Coverings Res/Textile	Vinyl Tiles 1988/B00D/R0003/Floor Coverings Res/Textile/S11	14m2	Throughout	Good Condition (1)	Low (1)	Low Priority (2-3)
-----------------------------	--	------	------------	--------------------	---------	--------------------

Chrysotile (white asbestos)**B00D - R0004 - Home Base Store**

No Asbestos

B00D - R0005 - Home Base

No Asbestos

B00D - R0006 - Home Base

No Asbestos

B00D - R0007 - Home Base Store

No Asbestos

B00D - R0008 - Home Base Store

No Asbestos

B00D - R0009 - Home Base

No Asbestos

B00D - R0010 - Movement

Ceiling Structures/Linings	Flat AC Sheeting 1988/B00D/R0010/Ceiling Structures/Linings/S9	2m2	Throughout	Good Condition (1)	Low (1)	Low Priority (2-3)
----------------------------	---	-----	------------	--------------------	---------	--------------------

Chrysotile (white asbestos) , Amosite (brown asbestos)**B00D - R0011 - Movement**

No Asbestos

B00D - R0012 - Personal Effects Storage

No Asbestos

B00D - R0013 - Movement

Ceiling Structures/Linings	Flat AC Sheeting 1988/B00D/R0010/Ceiling Structures/Linings/S9	2m2	Throughout	Good Condition (1)	Low (1)	Low Priority (2-3)
----------------------------	---	-----	------------	--------------------	---------	--------------------

Chrysotile (white asbestos) , Amosite (brown asbestos)**B00D - R0014 - Personal Effects Storage**

No Asbestos

B00D - R0015 - Movement

Product	Material Description	Extent	Location Reference	Material Condition	Risk Status	Control Priority
Sample No				Test Result		

No Asbestos

B00D - R0016 - Staff Toilet

Ceiling Structures/Linings	Flat AC Sheeting	5m2	Throughout	Good Condition (1)	Low (1)	Low Priority (2-3)
1988/B00D/R0010/Ceiling Structures/Linings/S9				Chrysotile (white asbestos) , Amosite (brown asbestos)		

Wall Linings Internal	Flat AC Sheeting	30m2	Throughout	Good Condition (1)	Low (1)	Low Priority (2-3)
1988/B00D/R0016/Wall Linings Internal/S10				Chrysotile (white asbestos) , Amosite (brown asbestos)		

B00D - R0017 - Cleaning Distributed Store

Ceiling Structures/Linings	Flat AC Sheeting	2m2	Throughout	Good Condition (1)	Low (1)	Low Priority (2-3)
1988/B00D/R0010/Ceiling Structures/Linings/S9				Chrysotile (white asbestos) , Amosite (brown asbestos)		

Wall Linings Internal	Flat AC Sheeting	8m2	Throughout	Good Condition (1)	Low (1)	Low Priority (2-3)
1988/B00D/R0016/Wall Linings Internal/S10				Chrysotile (white asbestos) , Amosite (brown asbestos)		

B00D - R0018 - Staff Toilet

Ceiling Structures/Linings	Flat AC Sheeting	5m2	Throughout	Good Condition (1)	Low (1)	Low Priority (2-3)
1988/B00D/R0010/Ceiling Structures/Linings/S9				Chrysotile (white asbestos) , Amosite (brown asbestos)		

Wall Linings Internal	Flat AC Sheeting	30m2	Throughout	Good Condition (1)	Low (1)	Low Priority (2-3)
1988/B00D/R0016/Wall Linings Internal/S10				Chrysotile (white asbestos) , Amosite (brown asbestos)		

B00D - R0019 - Movement

Ceiling Structures/Linings	Flat AC Sheeting	2m2	Throughout	Good Condition (1)	Low (1)	Low Priority (2-3)
1988/B00D/R0010/Ceiling Structures/Linings/S9				Chrysotile (white asbestos) , Amosite (brown asbestos)		

2017

Product	Material Description	Extent	Location Reference	Material Condition	Risk Status	Control Priority
Sample No					Test Result	

B00E - Support Unit - 1960 - Timber (Timber)

Exterior

Ceiling Voids	No Asbestos Found
Underfloor Voids	No Asbestos Found

Interior

B00E - R0002 - Home Base

No Asbestos

B00E - R0003 - External Movement

No Asbestos

B00E - R0004 - Toilets-Unisex

No Asbestos

2017

Product	Material Description	Extent	Location Reference	Material Condition	Risk Status	Control Priority
Sample No					Test Result	

B00F - General Learning/Staff Facilities - 1919 - Brick/Block (Brick/Block)

Exterior

Gable Verge Lining	Flat AC Sheeting 1988/B00C/Gable Verge Lining/S19					No Asbestos Detected
Eaves Linings	Flat AC Sheeting 1988/B00F/Eaves Linings/S18	50m2	North, South	Good Condition (1)	Low (1)	Low Priority (2-3) Chrysotile (white asbestos)
Wall Cladding	Flat AC Sheeting 1988/B00F/Wall Cladding/S7					No Asbestos Detected
Thermacon Heater	Encapsulated Insulation material within unit Assumed Asbestos - Assumed ACM internally	7Unit	Underfloor Void	Minimal Damage (2)	Low (1)	Low Priority (2-3)
Ceiling Voids	No Asbestos Found					

Interior

B00F - R0001 - Withdrawal - S

No Asbestos

B00F - R0002 - Practical Activity Area

No Asbestos

B00F - R0003 - General Storeroom

No Asbestos

B00F - R0004 - Staff Toilet

No Asbestos

B00F - R0005 - Movement

No Asbestos

B00F - R0006 - Personal Effects Storage

No Asbestos

B00F - R0007 - Home Base

No Asbestos

B00F - R0008 - Home Base Store

No Asbestos

B00F - R0009 - Movement

Ceiling Structures/Linings	Flat AC Sheeting 1988/B00F/R0009/Ceiling Structures/Linings/S5	5m2	Throughout	Good Condition (1)	Low (1)	Low Priority (2-3) Chrysotile (white asbestos) , Amosite (brown asbestos)
----------------------------	---	-----	------------	--------------------	---------	---

B00F - R0010 - Home Base

Wall Linings Internal	Flat AC Sheeting 1988/B00F/R0010/Wall Linings Internal/S6	2m2	Behind heaters	Good Condition (1)	Low (1)	Low Priority (2-3) Chrysotile (white asbestos) , Amosite (brown asbestos)
-----------------------	--	-----	----------------	--------------------	---------	---

B00F - R0011 - Personal Effects Storage

No Asbestos

B00F - R0012 - Home Base Store

No Asbestos

B00F - R0013 - Movement

No Asbestos

B00F - R0014 - Cleaning Distributed Store

No Asbestos

B00F - R0015 - Toilets - Boys/Girls

No Asbestos

B00F - R0016 - Movement

Product	Material Description	Extent	Location Reference	Material Condition	Risk Status	Control Priority
Sample No					Test Result	
Ceiling Structures/Linings	Flat AC Sheeting	5m2	Throughout	Good Condition (1)	Low (1)	Low Priority (2-3)
1988/B00F/R0009/Ceiling Structures/Linings/S5				Chrysotile (white asbestos) , Amosite (brown asbestos)		

2017

Product	Material Description	Extent	Location Reference	Material Condition	Risk Status	Control Priority
Sample No					Test Result	

B00G - General Learning - 2006 - Fibre Cement Clad (Fibre Cement Clad)

Exterior

Ceiling Voids	No Asbestos Found
Underfloor Voids	No Asbestos Found

Interior

B00G - R0001 - Movement

No Asbestos

B00G - R0002 - Practical Activities - 1hb

No Asbestos

B00G - R0003 - Home Base Store

Vinyl Tiles (Under Floor Covering/Carpet) No Asbestos Found

B00G - R0004 - Home Base

Vinyl Tiles (Under Floor Covering/Carpet) No Asbestos Found

B00G - R0005 - Withdrawal Space - 2hb

Vinyl Tiles (Under Floor Covering/Carpet) No Asbestos Found

B00G - R0006 - Home Base

Vinyl Tiles (Under Floor Covering/Carpet) No Asbestos Found

B00G - R0007 - Home Base Store

Vinyl Tiles (Under Floor Covering/Carpet) No Asbestos Found

B00G - R0008 - Practical Activities - 1hb

No Asbestos

2017

Product	Material Description	Extent	Location Reference	Material Condition	Risk Status	Control Priority
Sample No					Test Result	

B00J - General Learning - 1960 - Steel (Steel)

Exterior

Ceiling Voids	No Asbestos Found
Underfloor Voids	No Asbestos Found

Interior

B00J - R0001 - General Storeroom

Floor Coverings Res/Textile	Vinyl Tiles	6m2	Throughout	Good Condition (1)	Low (1)	Low Priority (2-3)
1988/B00J/R0001/Floor Coverings Res/Textile/S4					Chrysotile (white asbestos)	

B00J - R0003 - Personal Effects Storage

No Asbestos

B00J - R0004 - Movement

No Asbestos

B00J - R0005 - Home Base Store

No Asbestos

B00J - R0006 - Home Base

No Asbestos

B00J - R0007 - Home Base

No Asbestos

2017

Product	Material Description	Extent	Location Reference	Material Condition	Risk Status	Control Priority
	Sample No					Test Result

B00K - Communal Facilities/Other - 2010 - Brick/Veneer (Brick/Veneer)**Exterior**

Ceiling Voids	No Asbestos Found
Underfloor Voids	No Asbestos Found

Interior**B00K - R0001 - Communal Space**

No Asbestos

B00K - R0002 - Raised Platform

No Asbestos

B00K - R0003 - Hall Chair Store

No Asbestos

B00K - R0004 - Cleaning Distributed Store

No Asbestos

B00K - R0005 - Toilets - Girls

No Asbestos

B00K - R0006 - Toilet - Lobby

No Asbestos

B00K - R0007 - Access Shower/Toilet

No Asbestos

B00K - R0008 - Sound Cupboard

No Asbestos

B00K - R0009 - Toilets - Boys

No Asbestos

B00K - R0010 - Toilet - Lobby

No Asbestos

B00K - R0011 - P.E. Store

No Asbestos

B00K - R0012 - Communal/Performance Store

No Asbestos

B00K - R0013 - Main Switch Board

No Asbestos

B00K - R0014 - Canteen

No Asbestos

B00K - R0015 - Canteen Office/Store

No Asbestos

B00K - R0016 - Covered Outdoor Learning Area

No Asbestos

B00K - R0017 - External Movement

No Asbestos

B00K - R0018 - Movement

No Asbestos

B00K - R0019 - Movement

No Asbestos

B00K - R0020 - Movement

No Asbestos

B00K - R0021 - Movement

No Asbestos

B00K - R0022 - External Movement

No Asbestos

B00K - R0023 - Canteen Covered Area

Product	Material Description	Extent	Location Reference	Material Condition	Risk Status	Control Priority
Sample No					Test Result	

No Asbestos

B00K - R0024 - External Movement

No Asbestos

2017

Product	Material Description	Extent	Location Reference	Material Condition	Risk Status	Control Priority
Sample No					Test Result	

B00L - Library/General Learning - 2010 - Brick/Veneer (Brick/Veneer)

Exterior

Ceiling Voids	No Asbestos Found
Underfloor Voids	No Asbestos Found

Interior

B00L - R0001 - Reading Area

No Asbestos

B00L - R0002 - Library Office/Workroom

No Asbestos

B00L - R0003 - Communications Room

No Asbestos

B00L - R0004 - K.L.A. Store

No Asbestos

B00L - R0005 - Main Switch Board

No Asbestos

B00L - R0006 - Movement

No Asbestos

B00L - R0007 - Staff Toilet

No Asbestos

B00L - R0008 - Cleaning Distributed Store

No Asbestos

B00L - R0009 - External Movement

No Asbestos

B00L - R0010 - Home Base

No Asbestos

B00L - R0011 - Home Base Store

No Asbestos

B00L - R0012 - Withdrawal Space - 1hb

No Asbestos

B00L - R0013 - Practical Activities - 1hb

No Asbestos

2017

Product	Material Description	Extent	Location Reference	Material Condition	Risk Status	Control Priority
Sample No					Test Result	

B00X - Pupil Facilities/Building Services - 1960 - Brick/Block (Brick/Block)

Exterior

Ceiling Voids	No Asbestos Found
Underfloor Voids	No Asbestos Found

Interior

B00X - R0001 - Sports Store

No Asbestos

B00X - R0002 - Drinking Facilities

No Asbestos

B00X - R0003 - Garden Store

No Asbestos

B00X - R0004 - Drinking Facilities

No Asbestos

B00X - R0005 - Toilets - Boys

No Asbestos

B00X - R0006 - Toilets - Girls

No Asbestos

2017

Product	Material Description	Extent	Location Reference	Material Condition	Risk Status	Control Priority
Sample No					Test Result	

B00Y - Pupil Facilities/Building Services - 1960 - Brick/Block (Brick/Block)

Exterior

Eaves Linings	Flat AC Sheeting	60m2	Throughout	Good Condition (1)	Low (1)	Low Priority (2-3)
	1988/B00C/Eaves Linings/S17					Chrysotile (white asbestos) , Amosite (brown asbestos) , Crocidolite (blue asbestos)
Ceiling Voids	No Asbestos Found					
Underfloor Voids	No Asbestos Found					

Interior

B00Y - R0001 - Sports Store

Ceiling Structures/Linings	Flat AC Sheeting					
	1988/B00Y/R0001/Ceiling Structures/Linings/S13					No Asbestos Detected

B00Y - R0002 - Toilets - Girls

Partition Walls (Cubicles)	Compressed AC Sheet	40m2	Throughout	Good Condition (1)	Low (1)	Low Priority (2-3)
	1988/B00Y/R0002/Partition Walls (Cubicles)/S14					Chrysotile (white asbestos) , Amosite (brown asbestos)

B00Y - R0003 - Cleaning Distributed Store

No Asbestos

B00Y - R0004 - Cleaning Supplies

No Asbestos

B00Y - R0005 - Toilets - Boys

Partition Walls (Cubicles)	Compressed AC Sheet	25m2	Throughout	Good Condition (1)	Low (1)	Low Priority (2-3)
	1988/B00Y/R0002/Partition Walls (Cubicles)/S14					Chrysotile (white asbestos) , Amosite (brown asbestos)

B00Y - R0006 - Cleaning Distributed Store

No Asbestos

2017

Product	Material Description	Extent	Location Reference	Material Condition	Risk Status	Control Priority
Sample No					Test Result	

B00Z - Communal Facilities - 1960 - Steel (Steel)

Exterior

Ceiling Voids	No Asbestos Found
Underfloor Voids	No Asbestos Found

Interior

B00Z - R0001 - Sports Store

No Asbestos

B00Z - R0002 - Hall Chair Store

No Asbestos

2017

Product	Material Description	Extent	Location Reference	Material Condition	Risk Status	Control Priority
Sample No					Test Result	

Demountables

Demountable details as per the AMS records as of 15 Feb 2017.

OS 602 - D10010 - Learning Unit - Standard With P.A.A. : Placement Date - 28/11/2014

Note: This refurbished demountable may have asbestos present in remnant mastic in window frames.

Exterior

No Asbestos Found.

Interior

R1 - Learning space/withdrawal/entry

No Asbestos Found.

R2 - Home Base Store

No Asbestos Found.

OS 603 - D10037 - Learning Unit - Standard With P.A.A. A/C : Placement Date - 18/11/2009

Note: This refurbished demountable may have asbestos present in remnant mastic in window frames.

Exterior

No Asbestos Found.

Interior

R1 - Learning space/withdrawal/entry

No Asbestos Found.

R2 - Home Base Store

No Asbestos Found.

OS 601 - D10171 - Learning Unit - Standard/Withdrawal : Placement Date - 19/01/2008

Exterior

Eave Lining	Flat AC Sheet	Assumed Asbestos	11.52 m2
Landing	Compressed AC Sheet	Assumed Asbestos	1.2 m2
Step Treads	Compressed AC Sheet	Assumed Asbestos	1.08 m2

Interior

R1 - Entry

End wall panel	Flat AC Sheet	Assumed Asbestos	18 m2
Ceiling	Flat AC Sheet	Assumed Asbestos	8 m2

R2 - General Learning Space

End wall panel	Flat AC Sheet	Assumed Asbestos	18 m2
Ceiling	Flat AC Sheet	Assumed Asbestos	55 m2

R3 - Store

Ceiling	Flat AC Sheet	Assumed Asbestos	10 m2
---------	---------------	------------------	-------

OS 601 - D11201 - Learning Unit - Standard/Withdrawal : Placement Date - 9/05/2005

Exterior

Eave Lining	Flat AC Sheet	Assumed Asbestos	11.52 m2
Landing	Compressed AC Sheet	Assumed Asbestos	1.2 m2
Step Treads	Compressed AC Sheet	Assumed Asbestos	1.08 m2

Product	Material Description	Extent	Location Reference	Material Condition	Risk Status	Control Priority
Sample No					Test Result	
Interior						
R1 - Entry						
End wall panel	Flat AC Sheet	Assumed Asbestos				18 m2
Ceiling	Flat AC Sheet	Assumed Asbestos				8 m2
R2 - General Learning Space						
End wall panel	Flat AC Sheet	Assumed Asbestos				18 m2
Ceiling	Flat AC Sheet	Assumed Asbestos				55 m2
R3 - Store						
Ceiling	Flat AC Sheet	Assumed Asbestos				10 m2
OS 602 - D11605 - Learning Unit - Standard With P.A.A. : Placement Date - 13/03/2013						
Exterior						
Eave Lining	Flat AC Sheet	Assumed Asbestos				11.52 m2
Landing	Compressed AC Sheet	Assumed Asbestos				1.2 m2
Step Treads	Compressed AC Sheet	Assumed Asbestos				1.08 m2
Interior						
R1 - Learning space/withdrawal/entry						
Ceiling	Flat AC Sheet	Assumed Asbestos				70 m2
R2 - Home Base Store						
End wall panel	Flat AC Sheet	Assumed Asbestos				18 m2
Ceiling	Flat AC Sheet	Assumed Asbestos				3 m2
OS 602 - D11899 - Learning Unit - Standard With P.A.A. : Placement Date - 16/11/2009						
Exterior						
Eave Lining	Flat AC Sheet	Assumed Asbestos				11.52 m2
Landing	Compressed AC Sheet	Assumed Asbestos				1.2 m2
Step Treads	Compressed AC Sheet	Assumed Asbestos				1.08 m2
Interior						
R1 - Learning space/withdrawal/entry						
Ceiling	Flat AC Sheet	Assumed Asbestos				70 m2
R2 - Home Base Store						
End wall panel	Flat AC Sheet	Assumed Asbestos				18 m2
Ceiling	Flat AC Sheet	Assumed Asbestos				3 m2
OS 602 - D12069 - Learning Unit - Standard With P.A.A. : Placement Date - 18/09/2014						
Note: This refurbished demountable may have asbestos present in remnant mastic in window frames.						
Exterior						
No Asbestos Found.						
Interior						
R1 - Learning space/withdrawal/entry						
No Asbestos Found.						
R2 - Home Base Store						
No Asbestos Found.						
OS 520 - D12116 - Staff Study : Placement Date - 3/01/2017						
Note: This refurbished demountable may have asbestos present in remnant mastic in window frames.						
Exterior						
No Asbestos Found.						
Interior						
R1 - Staff Room						
No Asbestos Found.						

Product	Material Description	Extent	Location Reference	Material Condition	Risk Status	Control Priority
Sample No					Test Result	
OS 602 - D12709 - Learning Unit - Standard With P.A.A. : Placement Date - 20/01/2012						
Exterior						
Eave Lining	Flat AC Sheet	Assumed Asbestos				11.52 m2
Landing	Compressed AC Sheet	Assumed Asbestos				1.2 m2
Step Treads	Compressed AC Sheet	Assumed Asbestos				1.08 m2
Interior						
R1 - Learning space/withdrawal/entry						
Ceiling	Flat AC Sheet	Assumed Asbestos				70 m2
R2 - Home Base Store						
End wall panel	Flat AC Sheet	Assumed Asbestos				18 m2
Ceiling	Flat AC Sheet	Assumed Asbestos				3 m2
OS 602 - D13022 - Learning Unit - Standard With P.A.A. : Placement Date - 6/01/2010						
Note: This refurbished demountable may have asbestos present in remnant mastic in window frames.						
Exterior						
No Asbestos Found.						
Interior						
R1 - Learning space/withdrawal/entry						
No Asbestos Found.						
R2 - Home Base Store						
No Asbestos Found.						
OS 602 - D13469 - Learning Unit - Standard With P.A.A. : Placement Date - 18/09/2014						
Note: This refurbished demountable may have asbestos present in remnant mastic in window frames.						
Exterior						
No Asbestos Found.						
Interior						
R1 - Learning space/withdrawal/entry						
No Asbestos Found.						
R2 - Home Base Store						
No Asbestos Found.						
OS 601 - D13537 - Learning Unit - Standard/Withdrawal : Placement Date - 16/01/2007						
Exterior						
Step Treads	Compressed AC Sheet	Assumed Asbestos				1.08 m2
Eave Lining	Flat AC Sheet	Assumed Asbestos				11.52 m2
Landing	Compressed AC Sheet	Assumed Asbestos				1.2 m2
Interior						
R1 - Entry						
End wall panel	Flat AC Sheet	Assumed Asbestos				18 m2
Ceiling	Flat AC Sheet	Assumed Asbestos				8 m2
R2 - General Learning Space						
End wall panel	Flat AC Sheet	Assumed Asbestos				18 m2
Ceiling	Flat AC Sheet	Assumed Asbestos				55 m2
R3 - Store						
Ceiling	Flat AC Sheet	Assumed Asbestos				10 m2
OS 603 - D13798 - Learning Unit - Standard With P.A.A. A/C : Placement Date - 30/03/2011						
Exterior						
No Asbestos Found.						

Product	Material Description	Extent	Location Reference	Material Condition	Risk Status	Control Priority
Sample No					Test Result	
Interior						
R1 - Learning space/withdrawal/entry						
No Asbestos Found.						
R2 - Home Base Store						
No Asbestos Found.						
OS 603 - D14125 - Learning Unit - Standard With P.A.A. A/C : Placement Date - 15/04/2010						
Exterior						
No Asbestos Found.						
Interior						
R1 - Learning space/withdrawal/entry						
No Asbestos Found.						
R2 - Home Base Store						
No Asbestos Found.						
OS 602 - D14324 - Learning Unit - Standard With P.A.A. : Placement Date - 28/11/2013						
Note: This refurbished demountable may have asbestos present in remnant mastic in window frames.						
Exterior						
No Asbestos Found.						
Interior						
R1 - Learning space/withdrawal/entry						
No Asbestos Found.						
R2 - Home Base Store						
No Asbestos Found.						
OS 602 - D14617 - Learning Unit - Standard With P.A.A. : Placement Date - 27/08/2015						
Note: This refurbished demountable may have asbestos present in remnant mastic in window frames.						
Exterior						
No Asbestos Found.						
Interior						
R1 - Learning space/withdrawal/entry						
No Asbestos Found.						
R2 - Home Base Store						
No Asbestos Found.						
OS 602 - D14675 - Learning Unit - Standard With P.A.A. : Placement Date - 18/07/2012						
Note: This refurbished demountable may have asbestos present in remnant mastic in window frames.						
Exterior						
No Asbestos Found.						
Interior						
R1 - Learning space/withdrawal/entry						
No Asbestos Found.						
R2 - Home Base Store						
No Asbestos Found.						
OS 601 - D14979 - Learning Unit - Standard/Withdrawal : Placement Date - 16/01/2007						
Exterior						
Eave Lining	Flat AC Sheet	Assumed Asbestos				11.52 m2
Landing	Compressed AC Sheet	Assumed Asbestos				1.2 m2
Step Treads	Compressed AC Sheet	Assumed Asbestos				1.08 m2

Product	Material Description	Extent	Location Reference	Material Condition	Risk Status	Control Priority
Sample No					Test Result	

Interior

R1 - Entry

End wall panel	Flat AC Sheet	Assumed Asbestos				18 m2
Ceiling	Flat AC Sheet	Assumed Asbestos				8 m2

R2 - General Learning Space

End wall panel	Flat AC Sheet	Assumed Asbestos				18 m2
Ceiling	Flat AC Sheet	Assumed Asbestos				55 m2

R3 - Store

Ceiling	Flat AC Sheet	Assumed Asbestos				10 m2
---------	---------------	------------------	--	--	--	-------

OS 602 - D14982 - Learning Unit - Standard With P.A.A. : Placement Date - 19/01/2011

Note: This refurbished demountable may have asbestos present in remnant mastic in window frames.

Exterior

No Asbestos Found.

Interior

R1 - Learning space/withdrawal/entry

No Asbestos Found.

R2 - Home Base Store

No Asbestos Found.

OS 602 - D14990 - Learning Unit - Standard With P.A.A. : Placement Date - 15/07/2009

Note: This refurbished demountable may have asbestos present in remnant mastic in window frames.

Exterior

No Asbestos Found.

Interior

R1 - Learning space/withdrawal/entry

No Asbestos Found.

R2 - Home Base Store

No Asbestos Found.

OS 602 - D15112 - Learning Unit - Standard With P.A.A. : Placement Date - 19/02/2015

Note: This refurbished demountable may have asbestos present in remnant mastic in window frames.

Exterior

No Asbestos Found.

Interior

R1 - Learning space/withdrawal/entry

No Asbestos Found.

R2 - Home Base Store

No Asbestos Found.

OS 603 - D15229 - Learning Unit - Standard With P.A.A. A/C : Placement Date - 7/12/2012

Exterior

No Asbestos Found.

Interior

R1 - Learning space/withdrawal/entry

No Asbestos Found.

R2 - Home Base Store

No Asbestos Found.

OS 601 - D15455 - Learning Unit - Standard/Withdrawal : Placement Date - 19/01/2001

Exterior

Product	Material Description	Extent	Location Reference	Material Condition	Risk Status	Control Priority
Sample No					Test Result	
Step Treads	Compressed AC Sheet	Assumed Asbestos				1.08 m2
Eave Lining	Flat AC Sheet	Assumed Asbestos				11.52 m2
Landing	Compressed AC Sheet	Assumed Asbestos				1.2 m2
Interior						
R1 - Entry						
End wall panel	Flat AC Sheet	Assumed Asbestos				18 m2
Ceiling	Flat AC Sheet	Assumed Asbestos				8 m2
R2 - General Learning Space						
End wall panel	Flat AC Sheet	Assumed Asbestos				18 m2
Ceiling	Flat AC Sheet	Assumed Asbestos				55 m2
R3 - Store						
Ceiling	Flat AC Sheet	Assumed Asbestos				10 m2
OS 602 - D15748 - Learning Unit - Standard With P.A.A. : Placement Date - 29/12/2015						
Note: This refurbished demountable may have asbestos present in remnant mastic in window frames.						
Exterior						
No Asbestos Found.						
Interior						
R1 - Learning space/withdrawal/entry						
No Asbestos Found.						
R2 - Home Base Store						
No Asbestos Found.						
OS 750 - D15858 - Learning Unit - ESL : Placement Date - 24/10/2002						
Exterior						
Eave Lining	Flat AC Sheet	Assumed Asbestos				5.76 m2
Landing	Compressed AC Sheet	Assumed Asbestos				1.2 m2
Step Treads	Compressed AC Sheet	Assumed Asbestos				1.08 m2
Interior						
R1 - Es1						
End wall panel	Flat AC Sheet	Assumed Asbestos				50 m2
Ceiling	Flat AC Sheet	Assumed Asbestos				36 m2
OS 602 - D15988 - Learning Unit - Standard With P.A.A. : Placement Date - 27/09/2016						
Note: This refurbished demountable may have asbestos present in remnant mastic in window frames.						
Exterior						
No Asbestos Found.						
Interior						
R1 - Learning space/withdrawal/entry						
No Asbestos Found.						
R2 - Home Base Store						
No Asbestos Found.						
OS 602 - D16193 - Learning Unit - Standard With P.A.A. : Placement Date - 28/11/2014						
Note: This refurbished demountable may have asbestos present in remnant mastic in window frames.						
Exterior						
No Asbestos Found.						

Product	Material Description	Extent	Location Reference	Material Condition	Risk Status	Control Priority
Sample No					Test Result	

Interior

R1 - Learning space/withdrawal/entry

No Asbestos Found.

R2 - Home Base Store

No Asbestos Found.

OS 602 - D16236 - Learning Unit - Standard With P.A.A. : Placement Date - 17/04/2009

Exterior

Eave Lining	Flat AC Sheet	Assumed Asbestos	11.52 m2
Landing	Compressed AC Sheet	Assumed Asbestos	1.2 m2
Step Treads	Compressed AC Sheet	Assumed Asbestos	1.08 m2

Interior

R1 - Learning space/withdrawal/entry

Ceiling	Flat AC Sheet	Assumed Asbestos	70 m2
---------	---------------	------------------	-------

R2 - Home Base Store

End wall panel	Flat AC Sheet	Assumed Asbestos	18 m2
Ceiling	Flat AC Sheet	Assumed Asbestos	3 m2

OS 603 - D17954 - Learning Unit - Standard With P.A.A. A/C : Placement Date - 20/01/2012

Note: This refurbished demountable may have asbestos present in remnant mastic in window frames.

Exterior

No Asbestos Found.

Interior

R1 - Learning space/withdrawal/entry

No Asbestos Found.

R2 - Home Base Store

No Asbestos Found.

2017

Product	Material Description	Extent	Location Reference	Material Condition	Risk Status	Control Priority
Sample No					Test Result	

Listing of Electronic Attachments as of 22/03/2017

There are no asbestos related file attachment(s) for this school.

2017