

Asbestos Register

(Hazardous Materials and Risk Assessment)

School : Bomaderry High School (8448)
Region : Illawarra and South East
State Electorate : Kiama
Local Government Area : Shoalhaven

Initial Survey : Noel Arnold & Associates : 18 - Dec - 2009
Reviewed By : Greencap-NAA : 27 - Aug - 2014

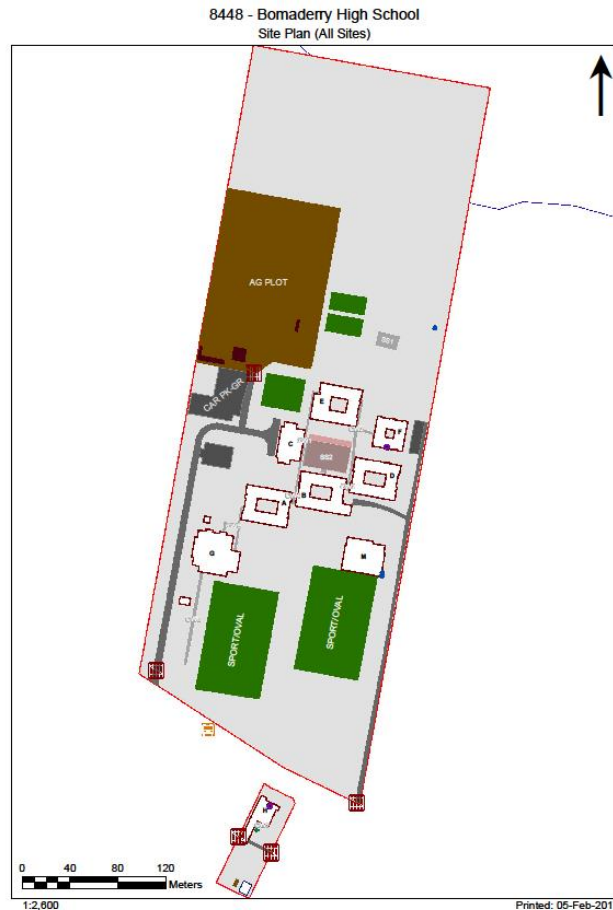

2017

Product	Material Description	Extent	Location Reference	Material Condition	Risk Status	Control Priority
Sample No					Test Result	

B00A - Administration/General Learning - 1967 - Brick/Block (Brick/Block)**Exterior**

Underfloor Voids - Slab on Ground	Non Accessible Area - Area inaccessible
Ceiling Voids - Flat Roof	Non Accessible Area - Area inaccessible

Interior**B00A - R0001 - Toilets-Boys (26.31 m2)**

Ceiling Structures/Linings	Vermiculite 8448/B00A/R1005/Ceiling Structures/Linings/S1					Limited Samples Taken <i>Vermiculite Ceilings may contain asbestos. Asbestos testing MUST be conducted prior to any disturbance works</i>
Partition Walls (Cubicles)	Compressed AC Sheet 8448/B00A/R0001/Partition Walls (Cubicles)/S3					No Asbestos Detected

B00A - R0002 - Apparatus Store (25.36 m2)

Ceiling Structures/Linings	Vermiculite 8448/B00A/R1005/Ceiling Structures/Linings/S1					Limited Samples Taken <i>Vermiculite Ceilings may contain asbestos. Asbestos testing MUST be conducted prior to any disturbance works</i>
Floor Coverings Res/Textile	Vinyl Tiles 8448/B00A/R0002/Floor Coverings Res/Textile/S4	26m2	Throughout	Good Condition (1)	Low (1)	Low Priority (2-3) Chrysotile (white asbestos)
Floor Coverings Res/Textile	Vinyl Tiles (Under Floor Covering/Carpet) 8448/B00A/R0022/Floor Coverings Res/Textile/S10					No Asbestos Detected

B00A - R0003 - Laboratory L.S. (92.61 m2)

Ceiling Structures/Linings	Vermiculite 8448/B00A/R1005/Ceiling Structures/Linings/S1					Limited Samples Taken <i>Vermiculite Ceilings may contain asbestos. Asbestos testing MUST be conducted prior to any disturbance works</i>
Fume Cupboard	Non Accessible Area - Area inaccessible					
Thermacon Heater	Encapsulated Insulation material within unit Assumed Asbestos - 2 Sealed units	2Unit	North East & North West	Good Condition (1)	Low (1)	Low Priority (2-3)

B00A - R0004 - Preparation (29.48 m2)

Ceiling Structures/Linings	Vermiculite 8448/B00A/R1005/Ceiling Structures/Linings/S1					Limited Samples Taken <i>Vermiculite Ceilings may contain asbestos. Asbestos testing MUST be conducted prior to any disturbance works</i>
----------------------------	--	--	--	--	--	--

B00A - R0005 - Preparation (8.82 m2)

Ceiling Structures/Linings	Vermiculite 8448/B00A/R1005/Ceiling Structures/Linings/S1					Limited Samples Taken <i>Vermiculite Ceilings may contain asbestos. Asbestos testing MUST be conducted prior to any disturbance works</i>
----------------------------	--	--	--	--	--	--

B00A - R0006 - Laboratory L.S. (85.01 m2)

Ceiling Structures/Linings	Vermiculite 8448/B00A/R1005/Ceiling Structures/Linings/S1					Limited Samples Taken <i>Vermiculite Ceilings may contain asbestos. Asbestos testing MUST be conducted prior to any disturbance works</i>
Fume Cupboard	Non Accessible Area - Area inaccessible					
Thermacon Heater	Encapsulated Insulation material within unit Assumed Asbestos - 2 Sealed units	2Unit	North East & North West	Good Condition (1)	Low (1)	Low Priority (2-3)

B00A - R0007 - Staff - Toilet (2.82 m2)

No Asbestos

B00A - R0008 - Distribution Board Cupboard (1.15 m2)

Note: No inspection of live electrical installation.

Product	Material Description	Extent	Location Reference	Material Condition	Risk Status	Control Priority
Sample No					Test Result	
Door Lining	Flat AC Sheeting 8448/B00A/R1020/Door backing/S2					No Asbestos Detected
B00A - R0009 - General Storeroom (1.61 m2)						
No Asbestos						
B00A - R0010 - Movement (10.59 m2)						
Ceiling Structures/Linings	Vermiculite 8448/B00A/R1005/Ceiling Structures/Linings/S1					Limited Samples Taken <i>Vermiculite Ceilings may contain asbestos. Asbestos testing MUST be conducted prior to any disturbance works</i>
Floor Coverings Res/Textile	Adhesive / Black 8448/B00A/R0022/Floor Coverings Res/Textile/S10					No Asbestos Detected
Floor Coverings Res/Textile	Vinyl Tiles (Under Floor Covering/Carpet) 8448/B00A/R0022/Floor Coverings Res/Textile/S9	10.59m2	Throughout	Good Condition (1)	Low (1)	Low Priority (2-3) Chrysotile (white asbestos)
B00A - R0011 - Leading Teacher (8.74 m2)						
Ceiling Structures/Linings	Vermiculite 8448/B00A/R1005/Ceiling Structures/Linings/S1					Limited Samples Taken <i>Vermiculite Ceilings may contain asbestos. Asbestos testing MUST be conducted prior to any disturbance works</i>
Floor Coverings Res/Textile	Adhesive / Black 8448/B00A/R0022/Floor Coverings Res/Textile/S10					No Asbestos Detected
Floor Coverings Res/Textile	Vinyl Tiles (Under Floor Covering/Carpet) 8448/B00A/R0022/Floor Coverings Res/Textile/S9	8.74m2	Throughout	Good Condition (1)	Low (1)	Low Priority (2-3) Chrysotile (white asbestos)
B00A - R0012 - Deputy Principal Office (14.17 m2)						
Ceiling Structures/Linings	Vermiculite 8448/B00A/R1005/Ceiling Structures/Linings/S1					Limited Samples Taken <i>Vermiculite Ceilings may contain asbestos. Asbestos testing MUST be conducted prior to any disturbance works</i>
Floor Coverings Res/Textile	Adhesive / Black 8448/B00A/R0022/Floor Coverings Res/Textile/S10					No Asbestos Detected
Floor Coverings Res/Textile	Vinyl Tiles (Under Floor Covering/Carpet) 8448/B00A/R0022/Floor Coverings Res/Textile/S9	14.17m2	Throughout	Good Condition (1)	Low (1)	Low Priority (2-3) Chrysotile (white asbestos)
B00A - R0013 - Interview/Office - Type 1 (4.72 m2)						
Ceiling Structures/Linings	Vermiculite 8448/B00A/R1005/Ceiling Structures/Linings/S1					Limited Samples Taken <i>Vermiculite Ceilings may contain asbestos. Asbestos testing MUST be conducted prior to any disturbance works</i>
Floor Coverings Res/Textile	Adhesive / Black 8448/B00A/R0022/Floor Coverings Res/Textile/S10					No Asbestos Detected
Floor Coverings Res/Textile	Vinyl Tiles (Under Floor Covering/Carpet) 8448/B00A/R0022/Floor Coverings Res/Textile/S9	4.72m2	Throughout	Good Condition (1)	Low (1)	Low Priority (2-3) Chrysotile (white asbestos)
B00A - R0014 - Ancillary Staff (12.58 m2)						
Ceiling Structures/Linings	Vermiculite 8448/B00A/R1005/Ceiling Structures/Linings/S1					Limited Samples Taken <i>Vermiculite Ceilings may contain asbestos. Asbestos testing MUST be conducted prior to any disturbance works</i>
Floor Coverings Res/Textile	Adhesive / Black 8448/B00A/R0022/Floor Coverings Res/Textile/S10					No Asbestos Detected
Floor Coverings Res/Textile	Vinyl Tiles (Under Floor Covering/Carpet) 8448/B00A/R0022/Floor Coverings Res/Textile/S9	12.58m2	Throughout	Good Condition (1)	Low (1)	Low Priority (2-3) Chrysotile (white asbestos)
B00A - R0015 - Clinic - Boys (11.9 m2)						

Product	Material Description	Extent	Location Reference	Material Condition	Risk Status	Control Priority
Sample No					Test Result	
Ceiling Structures/Linings	Vermiculite 8448/B00A/R1005/Ceiling Structures/Linings/S1					Limited Samples Taken <i>Vermiculite Ceilings may contain asbestos. Asbestos testing MUST be conducted prior to any disturbance works</i>
B00A - R0016 - Interview/Office - Type 1 (13.84 m2)						
Ceiling Structures/Linings	Vermiculite 8448/B00A/R1005/Ceiling Structures/Linings/S1					Limited Samples Taken <i>Vermiculite Ceilings may contain asbestos. Asbestos testing MUST be conducted prior to any disturbance works</i>
Floor Coverings Res/Textile	Adhesive / Black 8448/B00A/R0022/Floor Coverings Res/Textile/S10					No Asbestos Detected
Floor Coverings Res/Textile	Vinyl Tiles (Under Floor Covering/Carpet) 8448/B00A/R0022/Floor Coverings Res/Textile/S9	13.84m2	Throughout	Good Condition (1)	Low (1)	Low Priority (2-3) Chrysotile (white asbestos)
B00A - R0017 - Leading Teacher (12.32 m2)						
Ceiling Structures/Linings	Vermiculite 8448/B00A/R1005/Ceiling Structures/Linings/S1					Limited Samples Taken <i>Vermiculite Ceilings may contain asbestos. Asbestos testing MUST be conducted prior to any disturbance works</i>
Floor Coverings Res/Textile	Adhesive / Black 8448/B00A/R0022/Floor Coverings Res/Textile/S10					No Asbestos Detected
Floor Coverings Res/Textile	Vinyl Tiles (Under Floor Covering/Carpet) 8448/B00A/R0022/Floor Coverings Res/Textile/S9	12.32m2	Throughout	Good Condition (1)	Low (1)	Low Priority (2-3) Chrysotile (white asbestos)
B00A - R0018 - Commonroom (17.15 m2)						
Ceiling Structures/Linings	Vermiculite 8448/B00A/R1005/Ceiling Structures/Linings/S1					Limited Samples Taken <i>Vermiculite Ceilings may contain asbestos. Asbestos testing MUST be conducted prior to any disturbance works</i>
Floor Coverings Res/Textile	Adhesive / Black 8448/B00A/R0022/Floor Coverings Res/Textile/S10					No Asbestos Detected
Floor Coverings Res/Textile	Vinyl Tiles (Under Floor Covering/Carpet) 8448/B00A/R0022/Floor Coverings Res/Textile/S9	17.15m2	Throughout	Good Condition (1)	Low (1)	Low Priority (2-3) Chrysotile (white asbestos)
B00A - R0019 - Staff - Toilet (4.34 m2)						
Ceiling Structures/Linings	Vermiculite 8448/B00A/R1005/Ceiling Structures/Linings/S1					Limited Samples Taken <i>Vermiculite Ceilings may contain asbestos. Asbestos testing MUST be conducted prior to any disturbance works</i>
B00A - R0020 - Staff - Toilet (4.39 m2)						
Ceiling Structures/Linings	Vermiculite 8448/B00A/R1005/Ceiling Structures/Linings/S1					Limited Samples Taken <i>Vermiculite Ceilings may contain asbestos. Asbestos testing MUST be conducted prior to any disturbance works</i>
B00A - R0021 - Public Entry (46.66 m2)						
Ceiling Structures/Linings	Vermiculite 8448/B00A/R1005/Ceiling Structures/Linings/S1					Limited Samples Taken <i>Vermiculite Ceilings may contain asbestos. Asbestos testing MUST be conducted prior to any disturbance works</i>
Floor Coverings Res/Textile	Vinyl Tiles (Under Floor Covering/Carpet) 8448/B00A/R0022/Floor Coverings Res/Textile/S9	46.67m2	Throughout	Good Condition (1)	Low (1)	Low Priority (2-3) Chrysotile (white asbestos)
Floor Coverings Res/Textile	Adhesive / Black 8448/B00A/R0022/Floor Coverings Res/Textile/S10					No Asbestos Detected
B00A - R0022 - Administration - Clerical (28.4 m2)						
Ceiling Structures/Linings	Vermiculite 8448/B00A/R1005/Ceiling Structures/Linings/S1					Limited Samples Taken <i>Vermiculite Ceilings may contain asbestos. Asbestos testing MUST be conducted prior to any disturbance works</i>

Product	Material Description	Extent	Location Reference	Material Condition	Risk Status	Control Priority
Sample No					Test Result	
Floor Coverings Res/Textile	Vinyl Tiles (Under Floor Covering/Carpet) 8448/B00A/R0022/Floor Coverings Res/Textile/S9	28.4m2	Throughout	Good Condition (1)	Low (1)	Low Priority (2-3) Chrysotile (white asbestos)
Floor Coverings Res/Textile	Adhesive / Black 8448/B00A/R0022/Floor Coverings Res/Textile/S10					No Asbestos Detected
B00A - R0023 - Administration - Clerical (25.2 m2)						
Ceiling Structures/Linings	Vermiculite 8448/B00A/R1005/Ceiling Structures/Linings/S1					Limited Samples Taken Vermiculite Ceilings may contain asbestos. Asbestos testing MUST be conducted prior to any disturbance works
Floor Coverings Res/Textile	Adhesive / Black 8448/B00A/R0022/Floor Coverings Res/Textile/S10					No Asbestos Detected
Floor Coverings Res/Textile	Vinyl Tiles (Under Floor Covering/Carpet) 8448/B00A/R0022/Floor Coverings Res/Textile/S9	25.2m2	Throughout	Good Condition (1)	Low (1)	Low Priority (2-3) Chrysotile (white asbestos)
B00A - R0024 - Duplicating Workroom (32.13 m2)						
Ceiling Structures/Linings	Vermiculite 8448/B00A/R1005/Ceiling Structures/Linings/S1					Limited Samples Taken Vermiculite Ceilings may contain asbestos. Asbestos testing MUST be conducted prior to any disturbance works
Floor Coverings Res/Textile	Adhesive / Black 8448/B00A/R0022/Floor Coverings Res/Textile/S10					No Asbestos Detected
Floor Coverings Res/Textile	Vinyl Tiles (Under Floor Covering/Carpet) 8448/B00A/R0022/Floor Coverings Res/Textile/S9	32.14m2	Throughout	Good Condition (1)	Low (1)	Low Priority (2-3) Chrysotile (white asbestos)
B00A - R0025 - Principal Office (19.58 m2)						
Ceiling Structures/Linings	Vermiculite 8448/B00A/R1005/Ceiling Structures/Linings/S1					Limited Samples Taken Vermiculite Ceilings may contain asbestos. Asbestos testing MUST be conducted prior to any disturbance works
Floor Coverings Res/Textile	Adhesive / Black 8448/B00A/R0022/Floor Coverings Res/Textile/S10					No Asbestos Detected
Floor Coverings Res/Textile	Vinyl Tiles (Under Floor Covering/Carpet) 8448/B00A/R0022/Floor Coverings Res/Textile/S9	19.58m2	Throughout	Good Condition (1)	Low (1)	Low Priority (2-3) Chrysotile (white asbestos)
B00A - R0026 - General Storeroom (2.97 m2)						
Ceiling Structures/Linings	Vermiculite 8448/B00A/R1005/Ceiling Structures/Linings/S1					Limited Samples Taken Vermiculite Ceilings may contain asbestos. Asbestos testing MUST be conducted prior to any disturbance works
Floor Coverings Res/Textile	Adhesive / Black 8448/B00A/R0022/Floor Coverings Res/Textile/S10					No Asbestos Detected
Floor Coverings Res/Textile	Vinyl Tiles (Under Floor Covering/Carpet) 8448/B00A/R0022/Floor Coverings Res/Textile/S9	2.97m2	Throughout	Good Condition (1)	Low (1)	Low Priority (2-3) Chrysotile (white asbestos)
B00A - R0027 - Staff - Toilet (2.98 m2)						
Ceiling Structures/Linings	Vermiculite 8448/B00A/R1005/Ceiling Structures/Linings/S1					Limited Samples Taken Vermiculite Ceilings may contain asbestos. Asbestos testing MUST be conducted prior to any disturbance works
B00A - R0028 - General Learning Space (58.33 m2)						
Ceiling Structures/Linings	Vermiculite 8448/B00A/R1005/Ceiling Structures/Linings/S1					Limited Samples Taken Vermiculite Ceilings may contain asbestos. Asbestos testing MUST be conducted prior to any disturbance works
Floor Coverings Res/Textile	Adhesive / Black 8448/B00A/R0022/Floor Coverings Res/Textile/S10					No Asbestos Detected

Product	Material Description	Extent	Location Reference	Material Condition	Risk Status	Control Priority
Sample No					Test Result	
Floor Coverings Res/Textile	Vinyl Tiles (Under Floor Covering/Carpet) 8448/B00A/R0022/Floor Coverings Res/Textile/S9	58.34m2	Throughout	Good Condition (1)	Low (1)	Low Priority (2-3) Chrysotile (white asbestos)
B00A - R0029 - Cleaning Store - Distributed (2.82 m2)						
No Asbestos						
B00A - R0030 - Distribution Board Cupboard (1.15 m2) Note: No inspection of live electrical installation.						
Door Lining	Flat AC Sheeting 8448/B00A/R1020/Door backing/S2					No Asbestos Detected
B00A - R0031 - General Storeroom (1.62 m2)						
No Asbestos						
B00A - R0032 - Special Learning Space (52.62 m2)						
Ceiling Structures/Linings	Vermiculite 8448/B00A/R1005/Ceiling Structures/Linings/S1					Limited Samples Taken Vermiculite Ceilings may contain asbestos. Asbestos testing MUST be conducted prior to any disturbance works
Thermacon Heater	Encapsulated Insulation material within unit Assumed Asbestos - 2 sealed heater units	2Unit	North & South	Good Condition (1)	Low (1)	Low Priority (2-3)
Floor Coverings Res/Textile	Adhesive / Black 8448/B00A/R0022/Floor Coverings Res/Textile/S10					No Asbestos Detected
Floor Coverings Res/Textile	Vinyl Tiles (Under Floor Covering/Carpet) 8448/B00A/R0022/Floor Coverings Res/Textile/S9	52.63m2	Throughout	Good Condition (1)	Low (1)	Low Priority (2-3) Chrysotile (white asbestos)
B00A - R0033 - General Storeroom (11.43 m2)						
Ceiling Structures/Linings	Vermiculite 8448/B00A/R1005/Ceiling Structures/Linings/S1					Limited Samples Taken Vermiculite Ceilings may contain asbestos. Asbestos testing MUST be conducted prior to any disturbance works
Floor Coverings Res/Textile	Adhesive / Black 8448/B00A/R0022/Floor Coverings Res/Textile/S10					No Asbestos Detected
Floor Coverings Res/Textile	Vinyl Tiles (Under Floor Covering/Carpet) 8448/B00A/R0022/Floor Coverings Res/Textile/S9	11.43m2	Throughout	Good Condition (1)	Low (1)	Low Priority (2-3) Chrysotile (white asbestos)
B00A - R0034 - Movement (185.69 m2)						
Ceiling Structures/Linings	Vermiculite 8448/B00A/R1005/Ceiling Structures/Linings/S1					Limited Samples Taken Vermiculite Ceilings may contain asbestos. Asbestos testing MUST be conducted prior to any disturbance works
B00A - R0035 - Stairs (4.34 m2)						
No Asbestos						
B00A - R0036 - Stairs (4.34 m2)						
No Asbestos						
B00A - R1001 - Toilets-Girls (26.06 m2)						
Ceiling Structures/Linings	Vermiculite 8448/B00A/R1005/Ceiling Structures/Linings/S1					Limited Samples Taken Vermiculite Ceilings may contain asbestos. Asbestos testing MUST be conducted prior to any disturbance works
Incinerette	Encapsulated Insulation material within unit Assumed Asbestos - 1 sealed unit	1Unit(s)	Throughout	Friable Asbestos (5)	Low (1)	Low Priority (2-3)
Partition Walls (Cubicles)	Compressed AC Sheet 8448/B00A/R0001/Partition Walls (Cubicles)/S3					No Asbestos Detected
B00A - R1002 - General Learning Space (52.48 m2)						
Ceiling Structures/Linings	Vermiculite 8448/B00A/R1005/Ceiling Structures/Linings/S1					Limited Samples Taken Vermiculite Ceilings may contain asbestos. Asbestos testing MUST be conducted prior to any disturbance works

Product	Material Description	Extent	Location Reference	Material Condition	Risk Status	Control Priority
Sample No					Test Result	
Thermacon Heater	Encapsulated Insulation material within unit Assumed Asbestos - 2 sealed units	2Unit	North & South	Good Condition (1)	Low (1)	Low Priority (2-3)
Floor Coverings Res/Textile	Vinyl Tiles 8448/B00A/R1018/Floor Coverings Res/Textile/S11					No Asbestos Detected
B00A - R1003 - Staff Study (52.48 m2)						
Ceiling Structures/Linings	Vermiculite 8448/B00A/R1005/Ceiling Structures/Linings/S1 Vermiculite Ceilings may contain asbestos. Asbestos testing MUST be conducted prior to any disturbance works					Limited Samples Taken
Thermacon Heater	Encapsulated Insulation material within unit Assumed Asbestos - 1 sealed unit	1Unit	East	Good Condition (1)	Low (1)	Low Priority (2-3)
Floor Coverings Res/Textile	Vinyl Tiles 8448/B00A/R1018/Floor Coverings Res/Textile/S11					No Asbestos Detected
B00A - R1004 - Commonroom (138.56 m2)						
Ceiling Structures/Linings	Vermiculite 8448/B00A/R1005/Ceiling Structures/Linings/S1 Vermiculite Ceilings may contain asbestos. Asbestos testing MUST be conducted prior to any disturbance works					Limited Samples Taken
Thermacon Heater	Encapsulated Insulation material within unit Assumed Asbestos - 2 sealed units	2Unit	North & South	Good Condition (1)	Low (1)	Low Priority (2-3)
Floor Coverings Res/Textile	Vinyl Tiles 8448/B00A/R1018/Floor Coverings Res/Textile/S11					No Asbestos Detected
B00A - R1005 - Staff - Toilet (2.8 m2)						
Ceiling Structures/Linings	Vermiculite 8448/B00A/R1005/Ceiling Structures/Linings/S1 Vermiculite Ceilings may contain asbestos. Asbestos testing MUST be conducted prior to any disturbance works					Limited Samples Taken
Incinerett	Millboard Assumed Asbestos - Sealed unit	1Unit	West	Good Condition (1)	Low (1)	Low Priority (2-3)
B00A - R1006 - Distribution Board Cupboard (1.21 m2) Note: No inspection of live electrical installation.						
Door Lining	Flat AC Sheeting 8448/B00A/R1020/Door backing/S2					No Asbestos Detected
B00A - R1007 - General Learning Space (52.48 m2)						
Ceiling Structures/Linings	Vermiculite 8448/B00A/R1005/Ceiling Structures/Linings/S1 Vermiculite Ceilings may contain asbestos. Asbestos testing MUST be conducted prior to any disturbance works					Limited Samples Taken
Thermacon Heater	Encapsulated Insulation material within unit Assumed Asbestos - 2 sealed units	2Unit	North & South	Good Condition (1)	Low (1)	Low Priority (2-3)
Floor Coverings Res/Textile	Vinyl Tiles 8448/B00A/R1018/Floor Coverings Res/Textile/S11					No Asbestos Detected
B00A - R1008 - General Storeroom (5.54 m2)						
Ceiling Structures/Linings	Vermiculite 8448/B00A/R1005/Ceiling Structures/Linings/S1 Vermiculite Ceilings may contain asbestos. Asbestos testing MUST be conducted prior to any disturbance works					Limited Samples Taken
Floor Coverings Res/Textile	Vinyl Tiles 8448/B00A/R1018/Floor Coverings Res/Textile/S11					No Asbestos Detected
B00A - R1009 - Staff Study (12.85 m2)						

Product	Material Description	Extent	Location Reference	Material Condition	Risk Status	Control Priority
Sample No					Test Result	
Ceiling Structures/Linings	Vermiculite 8448/B00A/R1005/Ceiling Structures/Linings/S1					Limited Samples Taken <i>Vermiculite Ceilings may contain asbestos. Asbestos testing MUST be conducted prior to any disturbance works</i>
Floor Coverings Res/Textile	Vinyl Tiles 8448/B00A/R1018/Floor Coverings Res/Textile/S11					No Asbestos Detected
B00A - R1010 - General Learning Space (58.34 m2)						
Ceiling Structures/Linings	Vermiculite 8448/B00A/R1005/Ceiling Structures/Linings/S1					Limited Samples Taken <i>Vermiculite Ceilings may contain asbestos. Asbestos testing MUST be conducted prior to any disturbance works</i>
Thermacon Heater	Encapsulated Insulation material within unit	2Unit	East & West	Good Condition (1)	Low (1)	Low Priority (2-3) Assumed Asbestos - 2 sealed units
Floor Coverings Res/Textile	Vinyl Tiles 8448/B00A/R1018/Floor Coverings Res/Textile/S11					No Asbestos Detected
B00A - R1011 - General Storeroom (5.98 m2)						
Ceiling Structures/Linings	Vermiculite 8448/B00A/R1005/Ceiling Structures/Linings/S1					Limited Samples Taken <i>Vermiculite Ceilings may contain asbestos. Asbestos testing MUST be conducted prior to any disturbance works</i>
Floor Coverings Res/Textile	Vinyl Tiles 8448/B00A/R1018/Floor Coverings Res/Textile/S11					No Asbestos Detected
B00A - R1012 - General Learning Space (52.41 m2)						
Ceiling Structures/Linings	Vermiculite 8448/B00A/R1005/Ceiling Structures/Linings/S1					Limited Samples Taken <i>Vermiculite Ceilings may contain asbestos. Asbestos testing MUST be conducted prior to any disturbance works</i>
Thermacon Heater	Encapsulated Insulation material within unit	2Unit	East & West	Good Condition (1)	Low (1)	Low Priority (2-3) Assumed Asbestos - 2 sealed units
Floor Coverings Res/Textile	Vinyl Tiles 8448/B00A/R1018/Floor Coverings Res/Textile/S11					No Asbestos Detected
B00A - R1013 - General Storeroom (5.97 m2)						
Ceiling Structures/Linings	Vermiculite 8448/B00A/R1005/Ceiling Structures/Linings/S1					Limited Samples Taken <i>Vermiculite Ceilings may contain asbestos. Asbestos testing MUST be conducted prior to any disturbance works</i>
Floor Coverings Res/Textile	Vinyl Tiles 8448/B00A/R1018/Floor Coverings Res/Textile/S11					No Asbestos Detected
B00A - R1014 - General Learning Space (65.93 m2)						
Ceiling Structures/Linings	Vermiculite 8448/B00A/R1005/Ceiling Structures/Linings/S1					Limited Samples Taken <i>Vermiculite Ceilings may contain asbestos. Asbestos testing MUST be conducted prior to any disturbance works</i>
B00A - R1015 - Materials Store (2.94 m2)						
Ceiling Structures/Linings	Vermiculite 8448/B00A/R1005/Ceiling Structures/Linings/S1					Limited Samples Taken <i>Vermiculite Ceilings may contain asbestos. Asbestos testing MUST be conducted prior to any disturbance works</i>
B00A - R1016 - Materials Store (2.94 m2)						
Ceiling Structures/Linings	Vermiculite 8448/B00A/R1005/Ceiling Structures/Linings/S1					Limited Samples Taken <i>Vermiculite Ceilings may contain asbestos. Asbestos testing MUST be conducted prior to any disturbance works</i>
B00A - R1017 - Resource/Project Store (6.01 m2)						
Ceiling Structures/Linings	Vermiculite 8448/B00A/R1005/Ceiling Structures/Linings/S1					Limited Samples Taken <i>Vermiculite Ceilings may contain asbestos. Asbestos testing MUST be conducted prior to any disturbance works</i>

Product	Material Description	Extent	Location Reference	Material Condition	Risk Status	Control Priority
Sample No					Test Result	
Floor Coverings Res/Textile	Vinyl Tiles					
	8448/B00A/R1018/Floor Coverings Res/Textile/S11					No Asbestos Detected
B00A - R1018 - Design L.S. (71.61 m2)						
Ceiling Structures/Linings	Vermiculite					
	8448/B00A/R1005/Ceiling Structures/Linings/S1					Limited Samples Taken
	<i>Vermiculite Ceilings may contain asbestos. Asbestos testing MUST be conducted prior to any disturbance works</i>					
Thermacon Heater	Encapsulated Insulation material within unit	2Unit	North & South	Good Condition (1)	Low (1)	Low Priority (2-3)
	Assumed Asbestos - 2 sealed units					
Floor Coverings Res/Textile	Vinyl Tiles					
	8448/B00A/R1018/Floor Coverings Res/Textile/S11					No Asbestos Detected
B00A - R1019 - Cleaning Store - Distributed (2.74 m2)						
Ceiling Structures/Linings	Vermiculite					
	8448/B00A/R1005/Ceiling Structures/Linings/S1					Limited Samples Taken
	<i>Vermiculite Ceilings may contain asbestos. Asbestos testing MUST be conducted prior to any disturbance works</i>					
B00A - R1020 - Distribution Board Cupboard (1.19 m2)				Note: No inspection of live electrical installation.		
Door Lining	Flat AC Sheeting					
	8448/B00A/R1020/Door backing/S2					No Asbestos Detected
B00A - R1021 - Computer Learning Space (52.48 m2)						
Ceiling Structures/Linings	Vermiculite					
	8448/B00A/R1005/Ceiling Structures/Linings/S1					Limited Samples Taken
	<i>Vermiculite Ceilings may contain asbestos. Asbestos testing MUST be conducted prior to any disturbance works</i>					
B00A - R1022 - Computer Store (5.59 m2)						
Ceiling Structures/Linings	Vermiculite					
	8448/B00A/R1005/Ceiling Structures/Linings/S1					Limited Samples Taken
	<i>Vermiculite Ceilings may contain asbestos. Asbestos testing MUST be conducted prior to any disturbance works</i>					
B00A - R1023 - Secure Storeroom (5.71 m2)						
Ceiling Structures/Linings	Vermiculite					
	8448/B00A/R1005/Ceiling Structures/Linings/S1					Limited Samples Taken
	<i>Vermiculite Ceilings may contain asbestos. Asbestos testing MUST be conducted prior to any disturbance works</i>					
B00A - R1024 - Movement (170.87 m2)						
No Asbestos						
B00A - R1025 - Stairs (6.01 m2)						
No Asbestos						
B00A - R1026 - Stairs (6.01 m2)						
No Asbestos						

2017

Product	Material Description	Extent	Location Reference	Material Condition	Risk Status	Control Priority
Sample No					Test Result	

B00B - Technological & Applied Studies - 1967 - Brick/Block (Brick/Block)

Exterior

Underfloor Voids - Slab on Ground	Non Accessible Area - Area inaccessible					
Ceiling Voids - Flat Roof	Non Accessible Area - Area inaccessible					

Interior

B00B - R0001 - Materials Technology L.S. (81.02 m2)

Ceiling Structures/Linings	Vermiculite 8448/B00A/R1005/Ceiling Structures/Linings/S1					Limited Samples Taken <i>Vermiculite Ceilings may contain asbestos. Asbestos testing MUST be conducted prior to any disturbance works</i>
Wall Linings Internal	Flat AC Sheeting 8448/B00B/R0003/Wall Linings Internal/S13					No Asbestos Detected

B00B - R0002 - Welding Store (13.61 m2)

Ceiling Structures/Linings	Vermiculite 8448/B00A/R1005/Ceiling Structures/Linings/S1					Limited Samples Taken <i>Vermiculite Ceilings may contain asbestos. Asbestos testing MUST be conducted prior to any disturbance works</i>
----------------------------	--	--	--	--	--	--

B00B - R0003 - Welding Store (25.04 m2)

Ceiling Structures/Linings	Vermiculite 8448/B00A/R1005/Ceiling Structures/Linings/S1					Limited Samples Taken <i>Vermiculite Ceilings may contain asbestos. Asbestos testing MUST be conducted prior to any disturbance works</i>
Wall Linings Internal	Flat AC Sheeting 8448/B00B/R0003/Wall Linings Internal/S13					No Asbestos Detected

B00B - R0004 - Welding Area (3.91 m2)

Ceiling Structures/Linings	Vermiculite 8448/B00A/R1005/Ceiling Structures/Linings/S1					Limited Samples Taken <i>Vermiculite Ceilings may contain asbestos. Asbestos testing MUST be conducted prior to any disturbance works</i>
----------------------------	--	--	--	--	--	--

B00B - R0005 - Materials Technology L.S. (89.09 m2)

Ceiling Structures/Linings	Vermiculite 8448/B00A/R1005/Ceiling Structures/Linings/S1					Limited Samples Taken <i>Vermiculite Ceilings may contain asbestos. Asbestos testing MUST be conducted prior to any disturbance works</i>
----------------------------	--	--	--	--	--	--

B00B - R0006 - Welding Area (3.59 m2)

Ceiling Structures/Linings	Vermiculite 8448/B00A/R1005/Ceiling Structures/Linings/S1					Limited Samples Taken <i>Vermiculite Ceilings may contain asbestos. Asbestos testing MUST be conducted prior to any disturbance works</i>
----------------------------	--	--	--	--	--	--

Thermacon Heater	Encapsulated Insulation material within unit	2Unit	West	Good Condition (1)	Low (1)	Low Priority (2-3) <i>Assumed Asbestos - 2 sealed units</i>
------------------	--	-------	------	--------------------	---------	--

B00B - R0007 - Design L.S. (48.44 m2)

Ceiling Structures/Linings	Vermiculite 8448/B00A/R1005/Ceiling Structures/Linings/S1					Limited Samples Taken <i>Vermiculite Ceilings may contain asbestos. Asbestos testing MUST be conducted prior to any disturbance works</i>
Thermacon Heater	Encapsulated Insulation material within unit	1Unit	North	Good Condition (1)	Low (1)	Low Priority (2-3) <i>Assumed Asbestos - 1 sealed unit</i>

Floor Coverings Res/Textile	Vinyl Tiles 8448/B00A/R0002/Floor Coverings Res/Textile/S4	48.44m2	Throughout	Good Condition (1)	Low (1)	Low Priority (2-3) <i>Chrysotile (white asbestos)</i>
-----------------------------	---	---------	------------	--------------------	---------	--

B00B - R0008 - Resource/Project Store (9.3 m2)

Ceiling Structures/Linings	Vermiculite 8448/B00A/R1005/Ceiling Structures/Linings/S1					Limited Samples Taken <i>Vermiculite Ceilings may contain asbestos. Asbestos testing MUST be conducted prior to any disturbance works</i>
----------------------------	--	--	--	--	--	--

B00B - R0009 - Staff - Toilet (2.75 m2)

Product	Material Description	Extent	Location Reference	Material Condition	Risk Status	Control Priority
Sample No					Test Result	
No Asbestos						
B00B - R0010 - Distribution Board Cupboard (1.21 m2) Note: No inspection of live electrical installation.						
Door Lining	Flat AC Sheeting 8448/B00A/R1020/Door backing/S2					No Asbestos Detected
B00B - R0011 - General Storeroom (1.61 m2)						
No Asbestos						
B00B - R0012 - General Storeroom (5.98 m2)						
Ceiling Structures/Linings	Vermiculite 8448/B00A/R1005/Ceiling Structures/Linings/S1					Limited Samples Taken <i>Vermiculite Ceilings may contain asbestos. Asbestos testing MUST be conducted prior to any disturbance works</i>
Floor Coverings Res/Textile	Vinyl Tiles 8448/B00A/R0002/Floor Coverings Res/Textile/S4	5.98m2	Throughout	Good Condition (1)	Low (1)	Low Priority (2-3) Chrysotile (white asbestos)
B00B - R0013 - Staff Study (51.6 m2)						
Ceiling Structures/Linings	Vermiculite 8448/B00A/R1005/Ceiling Structures/Linings/S1					Limited Samples Taken <i>Vermiculite Ceilings may contain asbestos. Asbestos testing MUST be conducted prior to any disturbance works</i>
Floor Coverings Res/Textile	Vinyl Tiles 8448/B00A/R0002/Floor Coverings Res/Textile/S4	51.6m2	South	Good Condition (1)	Low (1)	Low Priority (2-3) Chrysotile (white asbestos)
B00B - R0014 - General Storeroom (6.26 m2)						
Ceiling Structures/Linings	Vermiculite 8448/B00A/R1005/Ceiling Structures/Linings/S1					Limited Samples Taken <i>Vermiculite Ceilings may contain asbestos. Asbestos testing MUST be conducted prior to any disturbance works</i>
Floor Coverings Res/Textile	Vinyl Tiles 8448/B00A/R0002/Floor Coverings Res/Textile/S4	6.26m2	South	Good Condition (1)	Low (1)	Low Priority (2-3) Chrysotile (white asbestos)
B00B - R0015 - Staff Study (31.62 m2)						
Ceiling Structures/Linings	Vermiculite 8448/B00A/R1005/Ceiling Structures/Linings/S1					Limited Samples Taken <i>Vermiculite Ceilings may contain asbestos. Asbestos testing MUST be conducted prior to any disturbance works</i>
Floor Coverings Res/Textile	Vinyl Tiles 8448/B00A/R0002/Floor Coverings Res/Textile/S4	31.62m2	South	Good Condition (1)	Low (1)	Low Priority (2-3) Chrysotile (white asbestos)
B00B - R0016 - Staff Study (25.69 m2)						
Floor Coverings Res/Textile	Vinyl Tiles 8448/B00A/R0002/Floor Coverings Res/Textile/S4	3m2	South	Good Condition (1)	Low (1)	Low Priority (2-3) Chrysotile (white asbestos)
Ceiling Structures/Linings	Vermiculite 8448/B00A/R1005/Ceiling Structures/Linings/S1					Limited Samples Taken <i>Vermiculite Ceilings may contain asbestos. Asbestos testing MUST be conducted prior to any disturbance works</i>
B00B - R0017 - Food Technology L.S. (66.02 m2)						
Ceiling Structures/Linings	Vermiculite 8448/B00A/R1005/Ceiling Structures/Linings/S1					Limited Samples Taken <i>Vermiculite Ceilings may contain asbestos. Asbestos testing MUST be conducted prior to any disturbance works</i>
B00B - R0018 - Food/Research Space (12.64 m2)						
Ceiling Structures/Linings	Vermiculite 8448/B00A/R1005/Ceiling Structures/Linings/S1					Limited Samples Taken <i>Vermiculite Ceilings may contain asbestos. Asbestos testing MUST be conducted prior to any disturbance works</i>
B00B - R0019 - Pantry (12.67 m2)						
Ceiling Structures/Linings	Vermiculite 8448/B00A/R1005/Ceiling Structures/Linings/S1					Limited Samples Taken <i>Vermiculite Ceilings may contain asbestos. Asbestos testing MUST be conducted prior to any disturbance works</i>
B00B - R0020 - Food Technology L.S. (79.57 m2)						

Product	Material Description	Extent	Location Reference	Material Condition	Risk Status	Control Priority
Sample No					Test Result	
Ceiling Structures/Linings	Vermiculite 8448/B00A/R1005/Ceiling Structures/Linings/S1					Limited Samples Taken <i>Vermiculite Ceilings may contain asbestos. Asbestos testing MUST be conducted prior to any disturbance works</i>
B00B - R0021 - General Storeroom (22.61 m2)						
Ceiling Structures/Linings	Vermiculite 8448/B00A/R1005/Ceiling Structures/Linings/S1					Limited Samples Taken <i>Vermiculite Ceilings may contain asbestos. Asbestos testing MUST be conducted prior to any disturbance works</i>
B00B - R0022 - Pantry (3.61 m2)						
Ceiling Structures/Linings	Vermiculite 8448/B00A/R1005/Ceiling Structures/Linings/S1					Limited Samples Taken <i>Vermiculite Ceilings may contain asbestos. Asbestos testing MUST be conducted prior to any disturbance works</i>
B00B - R0023 - Laundry (13.96 m2)						
Ceiling Structures/Linings	Vermiculite 8448/B00A/R1005/Ceiling Structures/Linings/S1					Limited Samples Taken <i>Vermiculite Ceilings may contain asbestos. Asbestos testing MUST be conducted prior to any disturbance works</i>
B00B - R0024 - General Storeroom (3.65 m2)						
Ceiling Structures/Linings	Vermiculite 8448/B00A/R1005/Ceiling Structures/Linings/S1					Limited Samples Taken <i>Vermiculite Ceilings may contain asbestos. Asbestos testing MUST be conducted prior to any disturbance works</i>
Floor Coverings Res/Textile	Vinyl Tiles 8448/B00A/R0002/Floor Coverings Res/Textile/S4	3.65m2	South	Good Condition (1)	Low (1)	Low Priority (2-3) Chrysotile (white asbestos)
B00B - R0025 - Cleaning Store - Distributed (2.77 m2)						
No Asbestos						
B00B - R0026 - Distribution Board Cupboard (1.25 m2) Note: No inspection of live electrical installation.						
Door Lining	Flat AC Sheeting 8448/B00A/R1020/Door backing/S2					No Asbestos Detected
B00B - R0027 - General Storeroom (1.58 m2)						
No Asbestos						
B00B - R0028 - Music Learning Space (52.63 m2)						
Ceiling Structures/Linings	Vermiculite 8448/B00A/R1005/Ceiling Structures/Linings/S1					Limited Samples Taken <i>Vermiculite Ceilings may contain asbestos. Asbestos testing MUST be conducted prior to any disturbance works</i>
Thermacon Heater	Encapsulated Insulation material within unit Assumed Asbestos - 2 sealed units	2Unit	North & South	Good Condition (1)	Low (1)	Low Priority (2-3)
Floor Coverings Res/Textile	Vinyl Tiles 8448/B00A/R0002/Floor Coverings Res/Textile/S4	52.63m2	South	Good Condition (1)	Low (1)	Low Priority (2-3) Chrysotile (white asbestos)
B00B - R0029 - Music Store (5.71 m2)						
Ceiling Structures/Linings	Vermiculite 8448/B00A/R1005/Ceiling Structures/Linings/S1					Limited Samples Taken <i>Vermiculite Ceilings may contain asbestos. Asbestos testing MUST be conducted prior to any disturbance works</i>
Floor Coverings Res/Textile	Vinyl Tiles 8448/B00A/R0002/Floor Coverings Res/Textile/S4	6m2	Throughout	Good Condition (1)	Low (1)	Low Priority (2-3) Chrysotile (white asbestos)
B00B - R0030 - Materials Store (5.61 m2)						
Ceiling Structures/Linings	Vermiculite 8448/B00A/R1005/Ceiling Structures/Linings/S1					Limited Samples Taken <i>Vermiculite Ceilings may contain asbestos. Asbestos testing MUST be conducted prior to any disturbance works</i>
Floor Coverings Res/Textile	Vinyl Tiles 8448/B00A/R0002/Floor Coverings Res/Textile/S4	5.61m2	South	Good Condition (1)	Low (1)	Low Priority (2-3) Chrysotile (white asbestos)
B00B - R0031 - Movement (186.06 m2)						

Product	Material Description	Extent	Location Reference	Material Condition	Risk Status	Control Priority
Sample No					Test Result	
Ceiling Structures/Linings	Vermiculite 8448/B00A/R1005/Ceiling Structures/Linings/S1					Limited Samples Taken <i>Vermiculite Ceilings may contain asbestos. Asbestos testing MUST be conducted prior to any disturbance works</i>
B00B - R0032 - Workshop Area (67.53 m2)						
No Asbestos						
B00B - R0033 - Stairs (4.19 m2)						
No Asbestos						
B00B - R0034 - Stairs (4.19 m2)						
No Asbestos						
B00B - R1001 - Materials Technology L.S. (84.47 m2)						
Ceiling Structures/Linings	Vermiculite 8448/B00A/R1005/Ceiling Structures/Linings/S1					Limited Samples Taken <i>Vermiculite Ceilings may contain asbestos. Asbestos testing MUST be conducted prior to any disturbance works</i>
B00B - R1002 - Wood Technology Bay (34.17 m2)						
Ceiling Structures/Linings	Vermiculite 8448/B00A/R1005/Ceiling Structures/Linings/S1					Limited Samples Taken <i>Vermiculite Ceilings may contain asbestos. Asbestos testing MUST be conducted prior to any disturbance works</i>
B00B - R1003 - Materials Store (17.3 m2)						
No Asbestos						
B00B - R1004 - Materials Technology L.S. (79.42 m2)						
Ceiling Structures/Linings	Vermiculite 8448/B00A/R1005/Ceiling Structures/Linings/S1					Limited Samples Taken <i>Vermiculite Ceilings may contain asbestos. Asbestos testing MUST be conducted prior to any disturbance works</i>
Thermacon Heater	Encapsulated Insulation material within unit	1Unit	North West	Friable Asbestos (5)	Low (1)	Low Priority (2-3) <i>Assumed Asbestos - 1 sealed unit</i>
B00B - R1005 - Computer Learning Space (58.33 m2)						
Ceiling Structures/Linings	Vermiculite 8448/B00A/R1005/Ceiling Structures/Linings/S1					Limited Samples Taken <i>Vermiculite Ceilings may contain asbestos. Asbestos testing MUST be conducted prior to any disturbance works</i>
Thermacon Heater	Encapsulated Insulation material within unit	2Unit	West & North	Friable Asbestos (5)	Low (1)	Low Priority (2-3) <i>Assumed Asbestos - 2 sealed units</i>
Floor Coverings Res/Textile	Vinyl Tiles 8448/B00A/R0002/Floor Coverings Res/Textile/S4	58.34m2	South	Good Condition (1)	Low (1)	Low Priority (2-3) <i>Chrysotile (white asbestos)</i>
B00B - R1006 - Staff - Toilet (2.75 m2)						
Ceiling Structures/Linings	Vermiculite 8448/B00A/R1005/Ceiling Structures/Linings/S1					Limited Samples Taken <i>Vermiculite Ceilings may contain asbestos. Asbestos testing MUST be conducted prior to any disturbance works</i>
Incinerette	Encapsulated Insulation material within unit	1Unit(s)	Throughout	Friable Asbestos (5)	Low (1)	Low Priority (2-3) <i>Assumed Asbestos - 1 sealed unit</i>
B00B - R1007 - Distribution Board Cupboard (1.15 m2)						
					Note: No inspection of live electrical installation.	
Door Lining	Flat AC Sheeting 8448/B00A/R1020/Door backing/S2					No Asbestos Detected
B00B - R1009 - Resources Space (5.46 m2)						
No Asbestos						
B00B - R1010 - Resources Store (5.98 m2)						
Ceiling Structures/Linings	Vermiculite 8448/B00A/R1005/Ceiling Structures/Linings/S1					Limited Samples Taken <i>Vermiculite Ceilings may contain asbestos. Asbestos testing MUST be conducted prior to any disturbance works</i>
B00B - R1011 - Staff Study (31.47 m2)						

Product	Material Description	Extent	Location Reference	Material Condition	Risk Status	Control Priority
Sample No					Test Result	
Ceiling Structures/Linings	Vermiculite 8448/B00A/R1005/Ceiling Structures/Linings/S1					Limited Samples Taken <i>Vermiculite Ceilings may contain asbestos. Asbestos testing MUST be conducted prior to any disturbance works</i>
Floor Coverings Res/Textile	Vinyl Tiles 8448/B00A/R0002/Floor Coverings Res/Textile/S4	31.48m2	South	Good Condition (1)	Low (1)	Low Priority (2-3) Chrysotile (white asbestos)
B00B - R1012 - General Storeroom (12.37 m2)						
Ceiling Structures/Linings	Vermiculite 8448/B00A/R1005/Ceiling Structures/Linings/S1					Limited Samples Taken <i>Vermiculite Ceilings may contain asbestos. Asbestos testing MUST be conducted prior to any disturbance works</i>
B00B - R1013 - Art Learning Space (52.77 m2)						
Ceiling Structures/Linings	Vermiculite 8448/B00A/R1005/Ceiling Structures/Linings/S1					Limited Samples Taken <i>Vermiculite Ceilings may contain asbestos. Asbestos testing MUST be conducted prior to any disturbance works</i>
Thermacon Heater	Encapsulated Insulation material within unit	2Unit	North East & South West	Friable Asbestos (5)	Low (1)	Low Priority (2-3) Assumed Asbestos - 2 sealed units
B00B - R1014 - Resources Store (11.72 m2)						
Ceiling Structures/Linings	Vermiculite 8448/B00A/R1005/Ceiling Structures/Linings/S1					Limited Samples Taken <i>Vermiculite Ceilings may contain asbestos. Asbestos testing MUST be conducted prior to any disturbance works</i>
B00B - R1015 - Kiln Space (26.69 m2)						
Ceiling Structures/Linings	Vermiculite 8448/B00A/R1005/Ceiling Structures/Linings/S1					Limited Samples Taken <i>Vermiculite Ceilings may contain asbestos. Asbestos testing MUST be conducted prior to any disturbance works</i>
B00B - R1016 - Art Learning Space (52.26 m2)						
Ceiling Structures/Linings	Vermiculite 8448/B00A/R1005/Ceiling Structures/Linings/S1					Limited Samples Taken <i>Vermiculite Ceilings may contain asbestos. Asbestos testing MUST be conducted prior to any disturbance works</i>
Thermacon Heater	Encapsulated Insulation material within unit	1Unit	North	Friable Asbestos (5)	Low (1)	Low Priority (2-3) Assumed Asbestos - 1 sealed unit
B00B - R1017 - Resources Store (6.12 m2)						
Ceiling Structures/Linings	Vermiculite 8448/B00A/R1005/Ceiling Structures/Linings/S1					Limited Samples Taken <i>Vermiculite Ceilings may contain asbestos. Asbestos testing MUST be conducted prior to any disturbance works</i>
B00B - R1018 - Art Learning Space (71.88 m2)						
Ceiling Structures/Linings	Vermiculite 8448/B00A/R1005/Ceiling Structures/Linings/S1					Limited Samples Taken <i>Vermiculite Ceilings may contain asbestos. Asbestos testing MUST be conducted prior to any disturbance works</i>
Thermacon Heater	Encapsulated Insulation material within unit	2Unit	East & West	Friable Asbestos (5)	Low (1)	Low Priority (2-3) Assumed Asbestos - 2 sealed units
B00B - R1019 - Resources Store (6.08 m2)						
Ceiling Structures/Linings	Vermiculite 8448/B00A/R1005/Ceiling Structures/Linings/S1					Limited Samples Taken <i>Vermiculite Ceilings may contain asbestos. Asbestos testing MUST be conducted prior to any disturbance works</i>
B00B - R1020 - Cleaning Store - Distributed (2.79 m2)						
Ceiling Structures/Linings	Vermiculite 8448/B00A/R1005/Ceiling Structures/Linings/S1					Limited Samples Taken <i>Vermiculite Ceilings may contain asbestos. Asbestos testing MUST be conducted prior to any disturbance works</i>
B00B - R1021 - Distribution Board Cupboard (1.21 m2)						
Door backing	Flat AC Sheeting 8448/B00A/R1020/Door backing/S2					Note: No inspection of live electrical installation. No Asbestos Detected
B00B - R1022 - Music Learning Space (52.63 m2)						

Product	Material Description	Extent	Location Reference	Material Condition	Risk Status	Control Priority
Sample No					Test Result	
Ceiling Structures/Linings	Vermiculite 8448/B00A/R1005/Ceiling Structures/Linings/S1					Limited Samples Taken Vermiculite Ceilings may contain asbestos. Asbestos testing MUST be conducted prior to any disturbance works
Thermacon Heater	Encapsulated Insulation material within unit	1Unit	South East	Friable Asbestos (5)	Low (1)	Low Priority (2-3) Assumed Asbestos - 1 sealed unit
Floor Coverings Res/Textile	Vinyl Tiles 8448/B00A/R0002/Floor Coverings Res/Textile/S4	52.63m2	South	Good Condition (1)	Low (1)	Low Priority (2-3) Chrysotile (white asbestos)
B00B - R1023 - Music Store (5.65 m2)						
Ceiling Structures/Linings	Vermiculite 8448/B00A/R1005/Ceiling Structures/Linings/S1					Limited Samples Taken Vermiculite Ceilings may contain asbestos. Asbestos testing MUST be conducted prior to any disturbance works
B00B - R1024 - Materials Store (5.63 m2)						
Ceiling Structures/Linings	Vermiculite 8448/B00A/R1005/Ceiling Structures/Linings/S1					Limited Samples Taken Vermiculite Ceilings may contain asbestos. Asbestos testing MUST be conducted prior to any disturbance works
B00B - R1025 - Movement (177.5 m2)						
No Asbestos						
B00B - R1026 - Photographic Studio (24.35 m2)						
Ceiling Structures/Linings	Vermiculite 8448/B00A/R1005/Ceiling Structures/Linings/S1					Limited Samples Taken Vermiculite Ceilings may contain asbestos. Asbestos testing MUST be conducted prior to any disturbance works
B00B - R1027 - Computer Room (26.13 m2)						
Ceiling Structures/Linings	Vermiculite 8448/B00A/R1005/Ceiling Structures/Linings/S1					Limited Samples Taken Vermiculite Ceilings may contain asbestos. Asbestos testing MUST be conducted prior to any disturbance works
B00B - R1028 - Photographic Studio (1.92 m2)						
Ceiling Structures/Linings	Vermiculite 8448/B00A/R1005/Ceiling Structures/Linings/S1					Limited Samples Taken Vermiculite Ceilings may contain asbestos. Asbestos testing MUST be conducted prior to any disturbance works
B00B - R1029 - Stairs (5.91 m2)						
No Asbestos						
B00B - R1030 - Stairs (5.91 m2)						
No Asbestos						

2017

Product	Material Description	Extent	Location Reference	Material Condition	Risk Status	Control Priority
Sample No					Test Result	

B00C - Pupil Facilities/Physical Education - 1967 - Brick/Block (Brick/Block)

Exterior

Underfloor Voids - Slab on Ground	Non Accessible Area - Area inaccessible
Ceiling Voids - Flat Roof	Non Accessible Area - Area inaccessible

Interior

B00C - R0001 - Movement (312.96 m2)

No Asbestos

B00C - R0002 - Movement (11.83 m2)

No Asbestos

B00C - R0003 - Cleaning Supplies Store (10.74 m2)

No Asbestos

B00C - R0004 - Main Switchroom (11.2 m2)

Electrical Backing Board	Resinous Board					
	8448/B00C/R0004/Electrical Backing Board/S15					No Asbestos Detected

B00C - R0005 - Sport Equipment Store (12.95 m2)

No Asbestos

B00C - R0006 - Sport Equipment Store (6.13 m2)

Ceiling Structures/Linings	Flat AC Sheeting	6.13m2	Throughout	Good Condition (1)	Low (1)	Low Priority (2-3)
	8448/B00C/R0007/Ceiling Structures/Linings/S14					Chrysotile (white asbestos)

B00C - R0007 - Student Canteen (56.52 m2)

Ceiling Structures/Linings	Flat AC Sheeting	56.53m2	Throughout	Good Condition (1)	Low (1)	Low Priority (2-3)
	8448/B00C/R0007/Ceiling Structures/Linings/S14					Chrysotile (white asbestos)

B00C - R0008 - Staff - Toilet (3.73 m2)

Ceiling Structures/Linings	Flat AC Sheeting	3.73m2	Throughout	Good Condition (1)	Low (1)	Low Priority (2-3)
	8448/B00C/R0007/Ceiling Structures/Linings/S14					Chrysotile (white asbestos)

B00C - R0009 - General Storeroom (4.33 m2)

Ceiling Structures/Linings	Flat AC Sheeting	4.33m2	Throughout	Good Condition (1)	Low (1)	Low Priority (2-3)
	8448/B00C/R0007/Ceiling Structures/Linings/S14					Chrysotile (white asbestos)

B00C - R0010 - General Storeroom (11.17 m2)

No Asbestos

B00C - R0011 - Distribution Board Cupboard (0.55 m2)

Note: No inspection of live electrical installation.

No Asbestos

B00C - R0012 - Movement (19.36 m2)

No Asbestos

B00C - R0013 - Movement (6.65 m2)

No Asbestos

B00C - R0014 - General Assistants (22.2 m2)

No Asbestos

B00C - R0015 - Movement (11.58 m2)

No Asbestos

B00C - R0016 - Store (1.44 m2)

No Asbestos

B00C - R0017 - Staff - Toilet (4.76 m2)

No Asbestos

Product	Material Description	Extent	Location Reference	Material Condition	Risk Status	Control Priority
Sample No					Test Result	
B00C - R0018 - Garden Store Room (14.28 m2)						
No Asbestos						
B00C - R0019 - Cleaning Supplies Store (10.7 m2)						
No Asbestos						
B00C - R0020 - Garden Store Room (11.1 m2)						
No Asbestos						
B00C - R0021 - Stairs (7.35 m2)						
No Asbestos						
B00C - R0022 - Stairs (8.16 m2)						
No Asbestos						
B00C - R1001 - Movement (12.98 m2)						
No Asbestos						
B00C - R1002 - Sport Equipment Store (11.06 m2)						
No Asbestos						
B00C - R1003 - Staff Shower (6.75 m2)						
Floor Coverings Res/Textile	Vinyl Tiles	7m2	Throughout	Good Condition (1)	Low (1)	Low Priority (2-3)
8448/B00A/R0002/Floor Coverings Res/Textile/S4					Chrysotile (white asbestos)	
B00C - R1004 - Cleaning Store - Distributed (1.08 m2)						
No Asbestos						
B00C - R1005 - Toilets-Girls (34.12 m2)						
Incinerette	Encapsulated Insulation material within unit	3Unit(s)	Throughout	Friable Asbestos (5)	Low (1)	Low Priority (2-3)
Assumed Asbestos - 3 sealed units						
Partition Walls (Cubicles)	Compressed AC Sheet					
8448/B00A/R0001/Partition Walls (Cubicles)/S3					No Asbestos Detected	
B00C - R1006 - General Storeroom (4.18 m2)						
No Asbestos						
B00C - R1007 - Shower/Change (33.97 m2)						
Partition Walls (Cubicles)	Compressed AC Sheet					
8448/B00A/R0001/Partition Walls (Cubicles)/S3					No Asbestos Detected	
B00C - R1008 - General Storeroom (4.19 m2)						
No Asbestos						
B00C - R1009 - Shower/Change (38.01 m2)						
No Asbestos						
B00C - R1010 - Toilets-Boys (34.11 m2)						
No Asbestos						
B00C - R1011 - General Storeroom (4.19 m2)						
No Asbestos						
B00C - R1012 - Cleaning Store - Distributed (1.09 m2)						
No Asbestos						
B00C - R1013 - Staff Shower (6.73 m2)						
Floor Coverings Res/Textile	Vinyl Tiles	7m2	Throughout	Good Condition (1)	Low (1)	Low Priority (2-3)
8448/B00A/R0002/Floor Coverings Res/Textile/S4					Chrysotile (white asbestos)	
B00C - R1014 - General Storeroom (10.93 m2)						
No Asbestos						
B00C - R1015 - Movement (13.25 m2)						
No Asbestos						
B00C - R1016 - Stairs (15.33 m2)						

Product	Material Description	Extent	Location Reference	Material Condition	Risk Status	Control Priority
	Sample No					Test Result

No Asbestos

B00C - R1017 - Stairs (15.34 m2)

No Asbestos

2017

Product	Material Description	Extent	Location Reference	Material Condition	Risk Status	Control Priority
Sample No					Test Result	

B00D - Science/Music - 1969 - Brick/Block (Brick/Block)**Exterior**

Underfloor Voids - Slab on Ground	Non Accessible Area - Area inaccessible
Ceiling Voids - Flat Roof	Non Accessible Area - Area inaccessible

Interior**B00D - R0001 - General Learning Space (57.74 m2)**

Ceiling Structures/Linings	Vermiculite 8448/B00A/R1005/Ceiling Structures/Linings/S1					Limited Samples Taken Vermiculite Ceilings may contain asbestos. Asbestos testing MUST be conducted prior to any disturbance works
Floor Coverings Res/Textile	Vinyl Tiles 8448/B00E/R1001/Floor Coverings Res/Textile/S6	57.74m2	Throughout	Good Condition (1)	Low (1)	Low Priority (2-3) Chrysotile (white asbestos)
Thermacon Heater	Encapsulated Insulation material within unit Assumed Asbestos - 1 sealed unit	1Unit	North West	Good Condition (1)	Low (1)	Low Priority (2-3)

B00D - R0006 - Staff - Toilet (2.79 m2)

No Asbestos

B00D - R0007 - Distribution Board Cupboard (1.15 m2)

Note: No inspection of live electrical installation.

Door Lining	Flat AC Sheeting 8448/B00A/R1020/Door backing/S2					No Asbestos Detected
-------------	---	--	--	--	--	-----------------------------

B00D - R0008 - General Storeroom (1.61 m2)

No Asbestos

B00D - R0009 - General Learning Space (52.34 m2)

Ceiling Structures/Linings	Vermiculite 8448/B00A/R1005/Ceiling Structures/Linings/S1					Limited Samples Taken Vermiculite Ceilings may contain asbestos. Asbestos testing MUST be conducted prior to any disturbance works
Thermacon Heater	Encapsulated Insulation material within unit Assumed Asbestos - 1 sealed unit	1Unit	South	Friable Asbestos (5)	Low (1)	Low Priority (2-3)
Floor Coverings Res/Textile	Vinyl Tiles 8448/B00E/R1001/Floor Coverings Res/Textile/S6	52.34m2	Throughout	Good Condition (1)	Low (1)	Low Priority (2-3) Chrysotile (white asbestos)

B00D - R0010 - Chemical Store (11.48 m2)

Ceiling Structures/Linings	Vermiculite 8448/B00A/R1005/Ceiling Structures/Linings/S1					Limited Samples Taken Vermiculite Ceilings may contain asbestos. Asbestos testing MUST be conducted prior to any disturbance works
Floor Coverings Res/Textile	Vinyl Tiles 8448/B00A/R0002/Floor Coverings Res/Textile/S4	12m2	Throughout	Good Condition (1)	Low (1)	Low Priority (2-3) Chrysotile (white asbestos)

B00D - R0011 - Toilets-Boys (40.06 m2)

Partition Walls (Cubicles)	Compressed AC Sheet 8448/B00A/R0001/Partition Walls (Cubicles)/S3					No Asbestos Detected
Ceiling Structures/Linings	Vermiculite 8448/B00A/R1005/Ceiling Structures/Linings/S1					Limited Samples Taken Vermiculite Ceilings may contain asbestos. Asbestos testing MUST be conducted prior to any disturbance works

B00D - R0012 - Apparatus Store (25.8 m2)

Ceiling Structures/Linings	Vermiculite 8448/B00A/R1005/Ceiling Structures/Linings/S1					Limited Samples Taken Vermiculite Ceilings may contain asbestos. Asbestos testing MUST be conducted prior to any disturbance works
----------------------------	--	--	--	--	--	---

Product	Material Description	Extent	Location Reference	Material Condition	Risk Status	Control Priority
Sample No					Test Result	
Floor Coverings Res/Textile	Vinyl Tiles	25.8m2	Throughout	Good Condition (1)	Low (1)	Low Priority (2-3)
8448/B00E/R1001/Floor Coverings Res/Textile/S6					Chrysotile (white asbestos)	
B00D - R0013 - Laboratory L.S. (92.47 m2)						
Ceiling Structures/Linings	Vermiculite					Limited Samples Taken
8448/B00A/R1005/Ceiling Structures/Linings/S1					Vermiculite Ceilings may contain asbestos. Asbestos testing MUST be conducted prior to any disturbance works	
Thermacon Heater	Encapsulated Insulation material within unit	2Unit	North & South	Friable Asbestos (5)	Low (1)	Low Priority (2-3)
Assumed Asbestos - 2 sealed units						
Moulded pipe	Moulded compressed pipe	1m	East	Good Condition (1)	Low (1)	Low Priority (2-3)
8448/B00D/R0013/Moulded pipe/S17					Chrysotile (white asbestos) , Amosite (brown asbestos)	
B00D - R0016 - Darkroom Space (12.44 m2)						
Ceiling Structures/Linings	Vermiculite					Limited Samples Taken
8448/B00A/R1005/Ceiling Structures/Linings/S1					Vermiculite Ceilings may contain asbestos. Asbestos testing MUST be conducted prior to any disturbance works	
B00D - R0017 - Toilets-Girls (39.91 m2)						
Incinerette	Encapsulated Insulation material within unit	1Unit(s)	South East corner	Friable Asbestos (5)	Low (1)	Low Priority (2-3)
Assumed Asbestos - 1 sealed unit						
Partition Walls (Cubicles)	Compressed AC Sheet					No Asbestos Detected
8448/B00A/R0001/Partition Walls (Cubicles)/S3						
Ceiling Structures/Linings	Vermiculite					Limited Samples Taken
8448/B00A/R1005/Ceiling Structures/Linings/S1					Vermiculite Ceilings may contain asbestos. Asbestos testing MUST be conducted prior to any disturbance works	
B00D - R0018 - Cleaning Store - Distributed (2.89 m2)						
No Asbestos						
B00D - R0019 - Distribution Board Cupboard (1.15 m2)						
Note: No inspection of live electrical installation.						
Door Lining	Flat AC Sheeting					No Asbestos Detected
8448/B00A/R1020/Door backing/S2						
B00D - R0020 - General Storeroom (1.6 m2)						
No Asbestos						
B00D - R0021 - General Learning Space (52.48 m2)						
Ceiling Structures/Linings	Vermiculite					Limited Samples Taken
8448/B00A/R1005/Ceiling Structures/Linings/S1					Vermiculite Ceilings may contain asbestos. Asbestos testing MUST be conducted prior to any disturbance works	
Thermacon Heater	Encapsulated Insulation material within unit	1Unit	North	Friable Asbestos (5)	Low (1)	Low Priority (2-3)
Assumed Asbestos - 1 sealed unit						
Floor Coverings Res/Textile	Vinyl Tiles	52.49m2	Throughout	Good Condition (1)	Low (1)	Low Priority (2-3)
8448/B00E/R1001/Floor Coverings Res/Textile/S6					Chrysotile (white asbestos)	
B00D - R0022 - General Storeroom (5.57 m2)						
Ceiling Structures/Linings	Vermiculite					Limited Samples Taken
8448/B00A/R1005/Ceiling Structures/Linings/S1					Vermiculite Ceilings may contain asbestos. Asbestos testing MUST be conducted prior to any disturbance works	
Floor Coverings Res/Textile	Vinyl Tiles					No Asbestos Detected
8448/B00D/R1008/Floor Coverings Res/Textile/S5						
B00D - R0023 - Staff Study (12.85 m2)						
Ceiling Structures/Linings	Vermiculite					Limited Samples Taken
8448/B00A/R1005/Ceiling Structures/Linings/S1					Vermiculite Ceilings may contain asbestos. Asbestos testing MUST be conducted prior to any disturbance works	

Product	Material Description	Extent	Location Reference	Material Condition	Risk Status	Control Priority
Sample No				Test Result		
Floor Coverings Res/Textile	Vinyl Tiles	12.85m2	Throughout	Good Condition (1)	Low (1)	Low Priority (2-3)
8448/B00E/R1001/Floor Coverings Res/Textile/S6				Chrysotile (white asbestos)		
B00D - R0024 - Movement (180.09 m2)						
Ceiling Structures/Linings	Vermiculite					Limited Samples Taken
8448/B00A/R1005/Ceiling Structures/Linings/S1				Vermiculite Ceilings may contain asbestos. Asbestos testing MUST be conducted prior to any disturbance works		
Shelving	Flat AC Sheeting	0.400m2	East	Good Condition (1)	Low (1)	Low Priority (2-3)
8448/B00D/R0024/Shelving/S19				Chrysotile (white asbestos)		
B00D - R0025 - Staff Study (52.77 m2)						
Floor Coverings Res/Textile	Vinyl Tiles (Under Floor Covering/Carpet)					No Asbestos Detected
8448/B00D/R0025/Floor Coverings Res/Textile/S18						
Ceiling Structures/Linings	Vermiculite					Limited Samples Taken
8448/B00A/R1005/Ceiling Structures/Linings/S1				Vermiculite Ceilings may contain asbestos. Asbestos testing MUST be conducted prior to any disturbance works		
B00D - R0026 - Stairs (4.38 m2)						
No Asbestos						
B00D - R0027 - Stairs (4.38 m2)						
No Asbestos						
B00D - R0028 - Laboratory L.S. (84.97 m2)						
No Asbestos						
B00D - R0029 - Preparation - Science (38.98 m2)						
No Asbestos						
B00D - R0030 - Laboratory L.S. (92.41 m2)						
No Asbestos						
B00D - R1001 - General Learning Space (58.18 m2)						
Ceiling Structures/Linings	Vermiculite					Limited Samples Taken
8448/B00A/R1005/Ceiling Structures/Linings/S1				Vermiculite Ceilings may contain asbestos. Asbestos testing MUST be conducted prior to any disturbance works		
Thermacon Heater	Encapsulated Insulation material within unit	2Unit	East & North West	Friable Asbestos (5)	Low (1)	Low Priority (2-3)
				Assumed Asbestos - 2 sealed units		
Floor Coverings Res/Textile	Vinyl Tiles	58.19m2	Throughout	Good Condition (1)	Low (1)	Low Priority (2-3)
8448/B00E/R1001/Floor Coverings Res/Textile/S6				Chrysotile (white asbestos)		
B00D - R1002 - General Learning Space (52.56 m2)						
Ceiling Structures/Linings	Vermiculite					Limited Samples Taken
8448/B00A/R1005/Ceiling Structures/Linings/S1				Vermiculite Ceilings may contain asbestos. Asbestos testing MUST be conducted prior to any disturbance works		
Thermacon Heater	Encapsulated Insulation material within unit	2Unit	South & West	Friable Asbestos (5)	Low (1)	Low Priority (2-3)
				Assumed Asbestos - 2 sealed units		
B00D - R1003 - General Learning Space (52.56 m2)						
Ceiling Structures/Linings	Vermiculite					Limited Samples Taken
8448/B00A/R1005/Ceiling Structures/Linings/S1				Vermiculite Ceilings may contain asbestos. Asbestos testing MUST be conducted prior to any disturbance works		
Thermacon Heater	Encapsulated Insulation material within unit	1Unit	Throughout	Friable Asbestos (5)	Low (1)	Low Priority (2-3)
				Assumed Asbestos - 1sealed unit		
Floor Coverings Res/Textile	Vinyl Tiles	52.56m2	Throughout	Good Condition (1)	Low (1)	Low Priority (2-3)
8448/B00E/R1001/Floor Coverings Res/Textile/S6				Chrysotile (white asbestos)		
B00D - R1004 - Darkroom Space (12.44 m2)						

Product	Material Description	Extent	Location Reference	Material Condition	Risk Status	Control Priority
Sample No				Test Result		
Ceiling Structures/Linings	Vermiculite 8448/B00A/R1005/Ceiling Structures/Linings/S1					Limited Samples Taken <i>Vermiculite Ceilings may contain asbestos. Asbestos testing MUST be conducted prior to any disturbance works</i>
B00D - R1005 - Staff Study (25.69 m2)						
Ceiling Structures/Linings	Vermiculite 8448/B00A/R1005/Ceiling Structures/Linings/S1					Limited Samples Taken <i>Vermiculite Ceilings may contain asbestos. Asbestos testing MUST be conducted prior to any disturbance works</i>
Floor Coverings Res/Textile	Vinyl Tiles 8448/B00D/R1008/Floor Coverings Res/Textile/S5					No Asbestos Detected
B00D - R1006 - General Storeroom (12.37 m2)						
Ceiling Structures/Linings	Vermiculite 8448/B00A/R1005/Ceiling Structures/Linings/S1					Limited Samples Taken <i>Vermiculite Ceilings may contain asbestos. Asbestos testing MUST be conducted prior to any disturbance works</i>
Floor Coverings Res/Textile	Vinyl Tiles 8448/B00D/R1008/Floor Coverings Res/Textile/S5					No Asbestos Detected
B00D - R1007 - General Learning Space (57.96 m2)						
Thermacon Heater	Encapsulated Insulation material within unit	2Unit	North East & South West	Friable Asbestos (5)	Low (1)	Low Priority (2-3) <i>Assumed Asbestos - 2 sealed units</i>
Ceiling Structures/Linings	Vermiculite 8448/B00A/R1005/Ceiling Structures/Linings/S1					Limited Samples Taken <i>Vermiculite Ceilings may contain asbestos. Asbestos testing MUST be conducted prior to any disturbance works</i>
Floor Coverings Res/Textile	Vinyl Tiles 8448/B00E/R1001/Floor Coverings Res/Textile/S6	57.97m2	Throughout	Good Condition (1)	Low (1)	Low Priority (2-3) <i>Chrysotile (white asbestos)</i>
B00D - R1008 - Staff - Toilet (2.75 m2)						
Ceiling Structures/Linings	Vermiculite 8448/B00A/R1005/Ceiling Structures/Linings/S1					Limited Samples Taken <i>Vermiculite Ceilings may contain asbestos. Asbestos testing MUST be conducted prior to any disturbance works</i>
Incinerette	Encapsulated Insulation material within unit	1Unit	South	Friable Asbestos (5)	Low (1)	Low Priority (2-3) <i>Assumed Asbestos - 1 sealed unit</i>
B00D - R1009 - Distribution Board Cupboard (1.21 m2)				Note: No inspection of live electrical installation.		
Door Lining	Flat AC Sheeting 8448/B00A/R1020/Door backing/S2					No Asbestos Detected
B00D - R1012 - General Learning Space (58.48 m2)						
Ceiling Structures/Linings	Vermiculite 8448/B00A/R1005/Ceiling Structures/Linings/S1					Limited Samples Taken <i>Vermiculite Ceilings may contain asbestos. Asbestos testing MUST be conducted prior to any disturbance works</i>
B00D - R1013 - General Learning Space (52.7 m2)						
Ceiling Structures/Linings	Vermiculite 8448/B00A/R1005/Ceiling Structures/Linings/S1					Limited Samples Taken <i>Vermiculite Ceilings may contain asbestos. Asbestos testing MUST be conducted prior to any disturbance works</i>
B00D - R1014 - Senior Study (25.81 m2)						
Ceiling Structures/Linings	Vermiculite 8448/B00A/R1005/Ceiling Structures/Linings/S1					Limited Samples Taken <i>Vermiculite Ceilings may contain asbestos. Asbestos testing MUST be conducted prior to any disturbance works</i>
Floor Coverings Res/Textile	Vinyl Tiles 8448/B00D/R1008/Floor Coverings Res/Textile/S5					No Asbestos Detected
Thermacon Heater	Encapsulated Insulation material within unit	1Unit	North	Friable Asbestos (5)	Low (1)	Low Priority (2-3) <i>Assumed Asbestos - 1 sealed unit</i>
B00D - R1017 - Staff Study (25.8 m2)						

Product	Material Description	Extent	Location Reference	Material Condition	Risk Status	Control Priority
Sample No					Test Result	
Ceiling Structures/Linings	Vermiculite 8448/B00A/R1005/Ceiling Structures/Linings/S1				Limited Samples Taken Vermiculite Ceilings may contain asbestos. Asbestos testing MUST be conducted prior to any disturbance works	
Thermacon Heater	Encapsulated Insulation material within unit	1Unit	South	Friable Asbestos (5)	Low (1)	Low Priority (2-3)
Assumed Asbestos - 1 sealed unit						
Floor Coverings Res/Textile	Vinyl Tiles 8448/B00E/R1001/Floor Coverings Res/Textile/S6	25.8m2	Throughout	Good Condition (1)	Low (1)	Low Priority (2-3)
Chrysotile (white asbestos)						
B00D - R1018 - General Storeroom (18.98 m2)						
Ceiling Structures/Linings	Vermiculite 8448/B00A/R1005/Ceiling Structures/Linings/S1				Limited Samples Taken Vermiculite Ceilings may contain asbestos. Asbestos testing MUST be conducted prior to any disturbance works	
Floor Coverings Res/Textile	Vinyl Tiles 8448/B00E/R1001/Floor Coverings Res/Textile/S6	18.98m2	Throughout	Good Condition (1)	Low (1)	Low Priority (2-3)
Chrysotile (white asbestos)						
B00D - R1019 - General Storeroom (6.12 m2)						
Ceiling Structures/Linings	Vermiculite 8448/B00A/R1005/Ceiling Structures/Linings/S1				Limited Samples Taken Vermiculite Ceilings may contain asbestos. Asbestos testing MUST be conducted prior to any disturbance works	
Ceiling Structures/Linings	Vermiculite 8448/B00A/R1005/Ceiling Structures/Linings/S1				Limited Samples Taken Vermiculite Ceilings may contain asbestos. Asbestos testing MUST be conducted prior to any disturbance works	
Thermacon Heater	Encapsulated Insulation material within unit	1Unit	South East	Friable Asbestos (5)	Low (1)	Low Priority (2-3)
Assumed Asbestos - 1 sealed unit						
Floor Coverings Res/Textile	Vinyl Tiles 8448/B00E/R1001/Floor Coverings Res/Textile/S6	58.04m2	Throughout	Good Condition (1)	Low (1)	Low Priority (2-3)
Chrysotile (white asbestos)						
B00D - R1021 - Cleaning Store - Distributed (2.86 m2)						
No Asbestos						
B00D - R1022 - Distribution Board Cupboard (1.17 m2)						
					Note: No inspection of live electrical installation.	
Door Lining	Flat AC Sheeting 8448/B00A/R1020/Door backing/S2				No Asbestos Detected	
B00D - R1023 - General Learning Space (52.41 m2)						
Ceiling Structures/Linings	Vermiculite 8448/B00A/R1005/Ceiling Structures/Linings/S1				Limited Samples Taken Vermiculite Ceilings may contain asbestos. Asbestos testing MUST be conducted prior to any disturbance works	
Floor Coverings Res/Textile	Vinyl Tiles 8448/B00E/R1001/Floor Coverings Res/Textile/S6	52.41m2	Throughout	Good Condition (1)	Low (1)	Low Priority (2-3)
Chrysotile (white asbestos)						
B00D - R1024 - General Storeroom (5.49 m2)						
Ceiling Structures/Linings	Vermiculite 8448/B00A/R1005/Ceiling Structures/Linings/S1				Limited Samples Taken Vermiculite Ceilings may contain asbestos. Asbestos testing MUST be conducted prior to any disturbance works	
Floor Coverings Res/Textile	Vinyl Tiles 8448/B00D/R1008/Floor Coverings Res/Textile/S5				No Asbestos Detected	
B00D - R1025 - Staff Study (12.85 m2)						
Ceiling Structures/Linings	Vermiculite 8448/B00A/R1005/Ceiling Structures/Linings/S1				Limited Samples Taken Vermiculite Ceilings may contain asbestos. Asbestos testing MUST be conducted prior to any disturbance works	
Floor Coverings Res/Textile	Vinyl Tiles 8448/B00E/R1001/Floor Coverings Res/Textile/S6	12.85m2	Throughout	Good Condition (1)	Low (1)	Low Priority (2-3)
Chrysotile (white asbestos)						

Product	Material Description	Extent	Location Reference	Material Condition	Risk Status	Control Priority
Sample No					Test Result	
B00D - R1026 - Movement (171.59 m2)						
Shelving	Flat AC Sheeting	171.6m2	East	Good Condition (1)	Low (1)	Low Priority (2-3)
8448/B00D/R0024/Shelving/S19					Chrysotile (white asbestos)	
B00D - R1027 - Aboriginal Resource Centre (25.59 m2)						
Ceiling Structures/Linings	Vermiculite					
8448/B00A/R1005/Ceiling Structures/Linings/S1					Limited Samples Taken	
Vermiculite Ceilings may contain asbestos. Asbestos testing MUST be conducted prior to any disturbance works						
Floor Coverings Res/Textile	Vinyl Tiles	25.59m2	Throughout	Good Condition (1)	Low (1)	Low Priority (2-3)
8448/B00A/R0002/Floor Coverings Res/Textile/S4					Chrysotile (white asbestos)	
B00D - R1028 - Stairs (6.13 m2)						
No Asbestos						
B00D - R1029 - Stairs (6.13 m2)						
No Asbestos						
B00D - R1030 - Tea Room (39.03 m2)						
Ceiling Structures/Linings	Vermiculite					
8448/B00A/R1005/Ceiling Structures/Linings/S1					Limited Samples Taken	
Vermiculite Ceilings may contain asbestos. Asbestos testing MUST be conducted prior to any disturbance works						
Floor Coverings Res/Textile	Vinyl Tiles	39.03m2	Throughout	Good Condition (1)	Low (1)	Low Priority (2-3)
8448/B00A/R0002/Floor Coverings Res/Textile/S4					Chrysotile (white asbestos)	
Thermacon Heater	Encapsulated Insulation material within unit	1Unit	North West	Friable Asbestos (5)	Low (1)	Low Priority (2-3)
Assumed Asbestos - 1 sealed unit						
B00D - R1031 - Chemical Store (24.5 m2)						
No Asbestos						

2017

Product	Material Description	Extent	Location Reference	Material Condition	Risk Status	Control Priority
Sample No					Test Result	

B00E - General Learning - 1973 - Brick/Block (Brick/Block)

Exterior

Underfloor Voids - Slab on Ground	Non Accessible Area - Area inaccessible					
Ceiling Voids - Flat Roof	Non Accessible Area - Area inaccessible					

Interior

B00E - R0001 - Staff Study (32.53 m2)

Ceiling Structures/Linings	Vermiculite 8448/B00A/R1005/Ceiling Structures/Linings/S1					Limited Samples Taken <i>Vermiculite Ceilings may contain asbestos. Asbestos testing MUST be conducted prior to any disturbance works</i>
Floor Coverings Res/Textile	Vinyl Tiles 8448/B00E/R1001/Floor Coverings Res/Textile/S6	32.53m2	Throughout	Good Condition (1)	Low (1)	Low Priority (2-3) Chrysotile (white asbestos)

B00E - R0002 - General Learning Space (52.56 m2)

Ceiling Structures/Linings	Vermiculite 8448/B00A/R1005/Ceiling Structures/Linings/S1					Limited Samples Taken <i>Vermiculite Ceilings may contain asbestos. Asbestos testing MUST be conducted prior to any disturbance works</i>
Floor Coverings Res/Textile	Vinyl Tiles 8448/B00E/R1001/Floor Coverings Res/Textile/S6	52.56m2	Throughout	Good Condition (1)	Low (1)	Low Priority (2-3) Chrysotile (white asbestos)

B00E - R0003 - Careers Advisers Office (19.21 m2)

Ceiling Structures/Linings	Vermiculite 8448/B00A/R1005/Ceiling Structures/Linings/S1					Limited Samples Taken <i>Vermiculite Ceilings may contain asbestos. Asbestos testing MUST be conducted prior to any disturbance works</i>
Floor Coverings Res/Textile	Vinyl Tiles 8448/B00E/R1001/Floor Coverings Res/Textile/S6	20m2	Throughout	Good Condition (1)	Low (1)	Low Priority (2-3) Chrysotile (white asbestos)

B00E - R0004 - Staff Study (12.49 m2)

Ceiling Structures/Linings	Vermiculite 8448/B00A/R1005/Ceiling Structures/Linings/S1					Limited Samples Taken <i>Vermiculite Ceilings may contain asbestos. Asbestos testing MUST be conducted prior to any disturbance works</i>
Floor Coverings Res/Textile	Vinyl Tiles 8448/B00E/R1001/Floor Coverings Res/Textile/S6	12.5m2	Throughout	Good Condition (1)	Low (1)	Low Priority (2-3) Chrysotile (white asbestos)

B00E - R0005 - Senior Study (25.8 m2)

Ceiling Structures/Linings	Vermiculite 8448/B00A/R1005/Ceiling Structures/Linings/S1					Limited Samples Taken <i>Vermiculite Ceilings may contain asbestos. Asbestos testing MUST be conducted prior to any disturbance works</i>
Thermacon Heater	Encapsulated Insulation material within unit <i>Assumed Asbestos - 1 sealed unit</i>	1Unit	East	Good Condition (1)	Low (1)	Low Priority (2-3)
Floor Coverings Res/Textile	Vinyl Tiles 8448/B00E/R1001/Floor Coverings Res/Textile/S6	25.8m2	Throughout	Good Condition (1)	Low (1)	Low Priority (2-3) Chrysotile (white asbestos)

B00E - R0006 - Performance Workspace (66.08 m2)

Ceiling Structures/Linings	Vermiculite 8448/B00A/R1005/Ceiling Structures/Linings/S1					Limited Samples Taken <i>Vermiculite Ceilings may contain asbestos. Asbestos testing MUST be conducted prior to any disturbance works</i>
Thermacon Heater	Encapsulated Insulation material within unit <i>Assumed Asbestos - 1 sealed unit</i>	1Unit	East	Friable Asbestos (5)	Low (1)	Low Priority (2-3)

Product	Material Description	Extent	Location Reference	Material Condition	Risk Status	Control Priority
Sample No				Test Result		
Floor Coverings Res/Textile	Vinyl Tiles	66.09m2	Throughout	Good Condition (1)	Low (1)	Low Priority (2-3)
8448/B00E/R1001/Floor Coverings Res/Textile/S6				Chrysotile (white asbestos)		
B00E - R0007 - Performing Arts Changeroom (32.75 m2)						
Ceiling Structures/Linings	Vermiculite					Limited Samples Taken
8448/B00A/R1005/Ceiling Structures/Linings/S1				Vermiculite Ceilings may contain asbestos. Asbestos testing MUST be conducted prior to any disturbance works		
Floor Coverings Res/Textile	Vinyl Tiles	32.75m2	Throughout	Good Condition (1)	Low (1)	Low Priority (2-3)
8448/B00E/R1001/Floor Coverings Res/Textile/S6				Chrysotile (white asbestos)		
B00E - R0008 - General Storeroom (13.32 m2)						
Ceiling Structures/Linings	Vermiculite					Limited Samples Taken
8448/B00A/R1005/Ceiling Structures/Linings/S1				Vermiculite Ceilings may contain asbestos. Asbestos testing MUST be conducted prior to any disturbance works		
B00E - R0009 - General Learning Space (51.39 m2)						
Ceiling Structures/Linings	Vermiculite					Limited Samples Taken
8448/B00A/R1005/Ceiling Structures/Linings/S1				Vermiculite Ceilings may contain asbestos. Asbestos testing MUST be conducted prior to any disturbance works		
Floor Coverings Res/Textile	Vinyl Tiles	51.39m2	Throughout	Good Condition (1)	Low (1)	Low Priority (2-3)
8448/B00E/R1001/Floor Coverings Res/Textile/S6				Chrysotile (white asbestos)		
B00E - R0010 - Store (5.27 m2)						
Ceiling Structures/Linings	Vermiculite					Limited Samples Taken
8448/B00A/R1005/Ceiling Structures/Linings/S1				Vermiculite Ceilings may contain asbestos. Asbestos testing MUST be conducted prior to any disturbance works		
Floor Coverings Res/Textile	Vinyl Tiles	6m2	Throughout	Good Condition (1)	Low (1)	Low Priority (2-3)
8448/B00E/R1001/Floor Coverings Res/Textile/S6				Chrysotile (white asbestos)		
B00E - R0011 - Toilets-Boys (11.14 m2)						
Partition Walls (Cubicles)	Compressed AC Sheet					No Asbestos Detected
8448/B00A/R0001/Partition Walls (Cubicles)/S3						
Ceiling Structures/Linings	Vermiculite					Limited Samples Taken
8448/B00A/R1005/Ceiling Structures/Linings/S1				Vermiculite Ceilings may contain asbestos. Asbestos testing MUST be conducted prior to any disturbance works		
B00E - R0012 - General Storeroom (2.42 m2)						
No Asbestos						
B00E - R0013 - Cleaning Store - Distributed (0.33 m2)						
No Asbestos						
B00E - R0014 - General Storeroom (4.19 m2)						
Ceiling Structures/Linings	Vermiculite					Limited Samples Taken
8448/B00A/R1005/Ceiling Structures/Linings/S1				Vermiculite Ceilings may contain asbestos. Asbestos testing MUST be conducted prior to any disturbance works		
Floor Coverings Res/Textile	Vinyl Tiles	4.19m2	Throughout	Good Condition (1)	Low (1)	Low Priority (2-3)
8448/B00A/R0002/Floor Coverings Res/Textile/S4				Chrysotile (white asbestos)		
B00E - R0015 - Staff Study (39.3 m2)						
Ceiling Structures/Linings	Vermiculite					Limited Samples Taken
8448/B00A/R1005/Ceiling Structures/Linings/S1				Vermiculite Ceilings may contain asbestos. Asbestos testing MUST be conducted prior to any disturbance works		
Floor Coverings Res/Textile	Vinyl Tiles	39.3m2	Throughout	Good Condition (1)	Low (1)	Low Priority (2-3)
8448/B00E/R1001/Floor Coverings Res/Textile/S6				Chrysotile (white asbestos)		
B00E - R0016 - Commonroom (17.66 m2)						

Product	Material Description	Extent	Location Reference	Material Condition	Risk Status	Control Priority
Sample No					Test Result	
Ceiling Structures/Linings	Vermiculite 8448/B00A/R1005/Ceiling Structures/Linings/S1				Limited Samples Taken <i>Vermiculite Ceilings may contain asbestos. Asbestos testing MUST be conducted prior to any disturbance works</i>	
Floor Coverings Res/Textile	Vinyl Tiles 8448/B00E/R1001/Floor Coverings Res/Textile/S6	18m2	Throughout	Good Condition (1)	Low (1)	Low Priority (2-3) Chrysotile (white asbestos)
B00E - R0017 - General Storeroom (13.94 m2)						
Ceiling Structures/Linings	Vermiculite 8448/B00A/R1005/Ceiling Structures/Linings/S1				Limited Samples Taken <i>Vermiculite Ceilings may contain asbestos. Asbestos testing MUST be conducted prior to any disturbance works</i>	
Floor Coverings Res/Textile	Vinyl Tiles 8448/B00E/R1001/Floor Coverings Res/Textile/S6	14m2	Throughout	Good Condition (1)	Low (1)	Low Priority (2-3) Chrysotile (white asbestos)
B00E - R0018 - General Learning Space (52.27 m2)						
Ceiling Structures/Linings	Vermiculite 8448/B00A/R1005/Ceiling Structures/Linings/S1				Limited Samples Taken <i>Vermiculite Ceilings may contain asbestos. Asbestos testing MUST be conducted prior to any disturbance works</i>	
B00E - R0019 - General Learning Space (52.69 m2)						
Ceiling Structures/Linings	Vermiculite 8448/B00A/R1005/Ceiling Structures/Linings/S1				Limited Samples Taken <i>Vermiculite Ceilings may contain asbestos. Asbestos testing MUST be conducted prior to any disturbance works</i>	
B00E - R0020 - General Learning Space (72.68 m2)						
Ceiling Structures/Linings	Vermiculite 8448/B00A/R1005/Ceiling Structures/Linings/S1				Limited Samples Taken <i>Vermiculite Ceilings may contain asbestos. Asbestos testing MUST be conducted prior to any disturbance works</i>	
B00E - R0021 - General Learning Space (53.21 m2)						
Ceiling Structures/Linings	Vermiculite 8448/B00A/R1005/Ceiling Structures/Linings/S1				Limited Samples Taken <i>Vermiculite Ceilings may contain asbestos. Asbestos testing MUST be conducted prior to any disturbance works</i>	
B00E - R0022 - General Storeroom (18.29 m2)						
Ceiling Structures/Linings	Vermiculite 8448/B00A/R1005/Ceiling Structures/Linings/S1				Limited Samples Taken <i>Vermiculite Ceilings may contain asbestos. Asbestos testing MUST be conducted prior to any disturbance works</i>	
Floor Coverings Res/Textile	Vinyl Tiles 8448/B00E/R1001/Floor Coverings Res/Textile/S6	19m2	Throughout	Good Condition (1)	Low (1)	Low Priority (2-3) Chrysotile (white asbestos)
B00E - R0023 - Toilets-Girls (11.24 m2)						
Partition Walls (Cubicles)	Compressed AC Sheet 8448/B00A/R0001/Partition Walls (Cubicles)/S3				No Asbestos Detected	
Ceiling Structures/Linings	Vermiculite 8448/B00A/R1005/Ceiling Structures/Linings/S1				Limited Samples Taken <i>Vermiculite Ceilings may contain asbestos. Asbestos testing MUST be conducted prior to any disturbance works</i>	
B00E - R0024 - Cleaning Store - Distributed (2.58 m2)						
No Asbestos						
B00E - R0025 - Cleaning Store - Distributed (0.34 m2)						
No Asbestos						
B00E - R0026 - General Storeroom (4.07 m2)						
Ceiling Structures/Linings	Vermiculite 8448/B00A/R1005/Ceiling Structures/Linings/S1				Limited Samples Taken <i>Vermiculite Ceilings may contain asbestos. Asbestos testing MUST be conducted prior to any disturbance works</i>	
B00E - R0027 - Movement (161.32 m2)						
Ceiling Structures/Linings	Vermiculite 8448/B00A/R1005/Ceiling Structures/Linings/S1				Limited Samples Taken <i>Vermiculite Ceilings may contain asbestos. Asbestos testing MUST be conducted prior to any disturbance works</i>	
B00E - R0028 - External Movement (91.17 m2)						

Product	Material Description	Extent	Location Reference	Material Condition	Risk Status	Control Priority
Sample No					Test Result	
No Asbestos						
B00E - R0029 - Stairs (4.36 m2)						
No Asbestos						
B00E - R0030 - Stairs (4.36 m2)						
No Asbestos						
B00E - R1001 - Laboratory L.S. (85.71 m2)						
Floor Coverings Res/Textile	Vinyl Tiles	86m2	Throughout	Good Condition (1)	Low (1)	Low Priority (2-3)
8448/B00E/R1001/Floor Coverings Res/Textile/S6					Chrysotile (white asbestos)	
Ceiling Structures/Linings	Vermiculite					
8448/B00A/R1005/Ceiling Structures/Linings/S1					Limited Samples Taken	
<i>Vermiculite Ceilings may contain asbestos. Asbestos testing MUST be conducted prior to any disturbance works</i>						
B00E - R1002 - Preparation (22.4 m2)						
Ceiling Structures/Linings	Vermiculite					
8448/B00A/R1005/Ceiling Structures/Linings/S1					Limited Samples Taken	
<i>Vermiculite Ceilings may contain asbestos. Asbestos testing MUST be conducted prior to any disturbance works</i>						
B00E - R1003 - General Storeroom (2.71 m2)						
Ceiling Structures/Linings	Vermiculite					
8448/B00A/R1005/Ceiling Structures/Linings/S1					Limited Samples Taken	
<i>Vermiculite Ceilings may contain asbestos. Asbestos testing MUST be conducted prior to any disturbance works</i>						
B00E - R1004 - Preparation (12.94 m2)						
Ceiling Structures/Linings	Vermiculite					
8448/B00A/R1005/Ceiling Structures/Linings/S1					Limited Samples Taken	
<i>Vermiculite Ceilings may contain asbestos. Asbestos testing MUST be conducted prior to any disturbance works</i>						
B00E - R1007 - Special Learning Space (32.75 m2)						
Ceiling Structures/Linings	Vermiculite					
8448/B00A/R1005/Ceiling Structures/Linings/S1					Limited Samples Taken	
<i>Vermiculite Ceilings may contain asbestos. Asbestos testing MUST be conducted prior to any disturbance works</i>						
B00E - R1008 - Cleaning Store - Distributed (5.19 m2)						
Ceiling Structures/Linings	Vermiculite					
8448/B00A/R1005/Ceiling Structures/Linings/S1					Limited Samples Taken	
<i>Vermiculite Ceilings may contain asbestos. Asbestos testing MUST be conducted prior to any disturbance works</i>						
Floor Coverings Res/Textile	Vinyl Tiles	6m2	Throughout	Good Condition (1)	Low (1)	Low Priority (2-3)
8448/B00E/R1001/Floor Coverings Res/Textile/S6					Chrysotile (white asbestos)	
B00E - R1009 - General Learning Space (51.39 m2)						
Ceiling Structures/Linings	Vermiculite					
8448/B00A/R1005/Ceiling Structures/Linings/S1					Limited Samples Taken	
<i>Vermiculite Ceilings may contain asbestos. Asbestos testing MUST be conducted prior to any disturbance works</i>						
Floor Coverings Res/Textile	Vinyl Tiles	51.39m2	Throughout	Good Condition (1)	Low (1)	Low Priority (2-3)
8448/B00E/R1001/Floor Coverings Res/Textile/S6					Chrysotile (white asbestos)	
B00E - R1010 - General Storeroom (5.89 m2)						
Ceiling Structures/Linings	Vermiculite					
8448/B00A/R1005/Ceiling Structures/Linings/S1					Limited Samples Taken	
<i>Vermiculite Ceilings may contain asbestos. Asbestos testing MUST be conducted prior to any disturbance works</i>						
Floor Coverings Res/Textile	Vinyl Tiles	6m2	Throughout	Good Condition (1)	Low (1)	Low Priority (2-3)
8448/B00E/R1001/Floor Coverings Res/Textile/S6					Chrysotile (white asbestos)	
B00E - R1011 - Distribution Board Cupboard (0.8 m2)						
				Note: No inspection of live electrical installation.		
Door Lining	Flat AC Sheeting					
8448/B00A/R1020/Door backing/S2					No Asbestos Detected	
B00E - R1012 - Cleaning Store - Distributed (0.39 m2)						
No Asbestos						

Product	Material Description	Extent	Location Reference	Material Condition	Risk Status	Control Priority
Sample No					Test Result	
B00E - R1013 - Staff - Toilet (3.52 m2)						
No Asbestos						
B00E - R1014 - Computer Learning Space (59.21 m2)						
Ceiling Structures/Linings	Vermiculite 8448/B00A/R1005/Ceiling Structures/Linings/S1				Limited Samples Taken <i>Vermiculite Ceilings may contain asbestos. Asbestos testing MUST be conducted prior to any disturbance works</i>	
Thermacon Heater	Encapsulated Insulation material within unit	1Unit	South West	Friable Asbestos (5)	Low (1)	Low Priority (2-3)
Assumed Asbestos - 1 sealed unit						
Floor Coverings Res/Textile	Vinyl Tiles 8448/B00E/R1001/Floor Coverings Res/Textile/S6	59.22m2	Throughout	Good Condition (1)	Low (1)	Low Priority (2-3)
Chrysotile (white asbestos)						
B00E - R1015 - Staff Study (25.8 m2)						
Ceiling Structures/Linings	Vermiculite 8448/B00A/R1005/Ceiling Structures/Linings/S1				Limited Samples Taken <i>Vermiculite Ceilings may contain asbestos. Asbestos testing MUST be conducted prior to any disturbance works</i>	
Floor Coverings Res/Textile	Vinyl Tiles 8448/B00E/R1001/Floor Coverings Res/Textile/S6	25.81m2	Throughout	Good Condition (1)	Low (1)	Low Priority (2-3)
Chrysotile (white asbestos)						
B00E - R1016 - General Learning Space (52.63 m2)						
Ceiling Structures/Linings	Vermiculite 8448/B00A/R1005/Ceiling Structures/Linings/S1				Limited Samples Taken <i>Vermiculite Ceilings may contain asbestos. Asbestos testing MUST be conducted prior to any disturbance works</i>	
Floor Coverings Res/Textile	Vinyl Tiles 8448/B00E/R1001/Floor Coverings Res/Textile/S6	52.64m2	Throughout	Good Condition (1)	Low (1)	Low Priority (2-3)
Chrysotile (white asbestos)						
B00E - R1017 - General Learning Space (52.63 m2)						
Ceiling Structures/Linings	Vermiculite 8448/B00A/R1005/Ceiling Structures/Linings/S1				Limited Samples Taken <i>Vermiculite Ceilings may contain asbestos. Asbestos testing MUST be conducted prior to any disturbance works</i>	
Floor Coverings Res/Textile	Vinyl Tiles 8448/B00E/R1001/Floor Coverings Res/Textile/S6	52.63m2	Throughout	Good Condition (1)	Low (1)	Low Priority (2-3)
Chrysotile (white asbestos)						
B00E - R1018 - General Learning Space (59.35 m2)						
Ceiling Structures/Linings	Vermiculite 8448/B00A/R1005/Ceiling Structures/Linings/S1				Limited Samples Taken <i>Vermiculite Ceilings may contain asbestos. Asbestos testing MUST be conducted prior to any disturbance works</i>	
Floor Coverings Res/Textile	Vinyl Tiles 8448/B00E/R1001/Floor Coverings Res/Textile/S6	59.36m2	Throughout	Good Condition (1)	Low (1)	Low Priority (2-3)
Chrysotile (white asbestos)						
B00E - R1019 - Staff Study (12.88 m2)						
Ceiling Structures/Linings	Vermiculite 8448/B00A/R1005/Ceiling Structures/Linings/S1				Limited Samples Taken <i>Vermiculite Ceilings may contain asbestos. Asbestos testing MUST be conducted prior to any disturbance works</i>	
Floor Coverings Res/Textile	Vinyl Tiles 8448/B00E/R1001/Floor Coverings Res/Textile/S6	12.88m2	Throughout	Good Condition (1)	Low (1)	Low Priority (2-3)
Chrysotile (white asbestos)						
B00E - R1020 - General Learning Space (51.45 m2)						
Ceiling Structures/Linings	Vermiculite 8448/B00A/R1005/Ceiling Structures/Linings/S1				Limited Samples Taken <i>Vermiculite Ceilings may contain asbestos. Asbestos testing MUST be conducted prior to any disturbance works</i>	
Thermacon Heater	Encapsulated Insulation material within unit	1Unit	East	Friable Asbestos (5)	Low (1)	Low Priority (2-3)
Assumed Asbestos - 1 sealed unit						
B00E - R1021 - General Storeroom (5 m2)						

Product	Material Description	Extent	Location Reference	Material Condition	Risk Status	Control Priority
Sample No					Test Result	
Ceiling Structures/Linings	Vermiculite 8448/B00A/R1005/Ceiling Structures/Linings/S1					Limited Samples Taken <i>Vermiculite Ceilings may contain asbestos. Asbestos testing MUST be conducted prior to any disturbance works</i>
Floor Coverings Res/Textile	Vinyl Tiles 8448/B00E/R1001/Floor Coverings Res/Textile/S6	5m2	Throughout	Good Condition (1)	Low (1)	Low Priority (2-3) Chrysotile (white asbestos)
B00E - R1022 - Distribution Board Cupboard (0.74 m2) Note: No inspection of live electrical installation.						
Door Lining	Flat AC Sheeting 8448/B00A/R1020/Door backing/S2					No Asbestos Detected
B00E - R1023 - Cleaning Store - Distributed (0.35 m2)						
No Asbestos						
B00E - R1024 - Staff - Toilet (3.42 m2)						
Ceiling Structures/Linings	Vermiculite 8448/B00A/R1005/Ceiling Structures/Linings/S1					Limited Samples Taken <i>Vermiculite Ceilings may contain asbestos. Asbestos testing MUST be conducted prior to any disturbance works</i>
B00E - R1025 - Movement (180.6 m2)						
No Asbestos						
B00E - R1026 - Laboratory L.S. (92.74 m2)						
Ceiling Structures/Linings	Vermiculite 8448/B00A/R1005/Ceiling Structures/Linings/S1					Limited Samples Taken <i>Vermiculite Ceilings may contain asbestos. Asbestos testing MUST be conducted prior to any disturbance works</i>
Floor Coverings Res/Textile	Vinyl Tiles 8448/B00E/R1001/Floor Coverings Res/Textile/S6	92.74m2	Throughout	Good Condition (1)	Low (1)	Low Priority (2-3) Chrysotile (white asbestos)
B00E - R1027 - Stairs (7.24 m2)						
No Asbestos						
B00E - R1028 - Stairs (7.24 m2)						
No Asbestos						

2017

Product	Material Description	Extent	Location Reference	Material Condition	Risk Status	Control Priority
Sample No					Test Result	

B00F - Library - 1982 - Brick/Block (Brick/Block)

Exterior

Underfloor Voids - Slab on Ground	Non Accessible Area - Area inaccessible
Ceiling Voids - Flat Roof	Non Accessible Area - Area inaccessible

Interior

B00F - R0001 - Main Area (401.16 m2)

No Asbestos

B00F - R0002 - Seminar (12.25 m2)

No Asbestos

B00F - R0003 - Seminar (12.11 m2)

No Asbestos

B00F - R0004 - Seminar (12.14 m2)

No Asbestos

B00F - R0005 - Librarian (14.33 m2)

No Asbestos

B00F - R0006 - Audio Visual Workroom (38.3 m2)

No Asbestos

B00F - R0007 - Workroom (42.85 m2)

No Asbestos

B00F - R0008 - Public Entry (14.68 m2)

No Asbestos

B00F - R0009 - Movement (1.64 m2)

No Asbestos

B00F - R0010 - Toilets-Disabled (2.79 m2)

No Asbestos

B00F - R0011 - Cleaning Store - Distributed (1.57 m2)

No Asbestos

B00F - R0012 - Distribution Board Cupboard (1.07 m2)

Note: No inspection of live electrical installation.

Ceiling Structures/Linings	Flat AC Sheeting 8448/B00F/R0012/Ceiling Structures/Linings/S16
----------------------------	--

No Asbestos Detected

2017

Product	Material Description	Extent	Location Reference	Material Condition	Risk Status	Control Priority
Sample No					Test Result	

B00G - Multi Purpose Facilities - 1985 - Brick/Block (Brick/Block)**Exterior**

Underfloor Voids - Slab on Ground	Non Accessible Area - Area inaccessible
Ceiling Voids - Flat Roof	Non Accessible Area - Area inaccessible

Interior**B00G - M0001 - Multi-Purpose Space (133.08 m2)**

No Asbestos

B00G - M0002 - Performing Arts Store (28.95 m2)

No Asbestos

B00G - M0003 - Movement (1.01 m2)

No Asbestos

B00G - M0004 - Stairs (5.96 m2)

No Asbestos

B00G - M0005 - Stairs (5.43 m2)

No Asbestos

B00G - R0001 - Staff Study (18.36 m2)

No Asbestos

B00G - R0002 - Student Canteen (12.45 m2)

No Asbestos

B00G - R0003 - Public Entry (24.78 m2)

No Asbestos

B00G - R0005 - Toilets-Girls (24.91 m2)

No Asbestos

B00G - R0006 - Toilets-Boys (16.96 m2)

No Asbestos

B00G - R0007 - Distribution Board Cupboard (0.96 m2)

Note: No inspection of live electrical installation.

No Asbestos

B00G - R0008 - Toilets-Disabled (4.24 m2)

No Asbestos

B00G - R0009 - Cleaning Store - Distributed (2.13 m2)

No Asbestos

B00G - R0010 - Sport Equipment Store (27.44 m2)

No Asbestos

B00G - R0011 - Movement (3.85 m2)

No Asbestos

B00G - R0012 - Multi-Purpose Space (478.83 m2)

No Asbestos

B00G - R0013 - Staff Shower (5.66 m2)

No Asbestos

B00G - R0014 - General Storeroom (7.14 m2)

No Asbestos

B00G - R0015 - Shower/Change (32.31 m2)

No Asbestos

B00G - R0016 - Stage (87.56 m2)

No Asbestos

B00G - R0017 - Movement (6.03 m2)

Product	Material Description	Extent	Location Reference	Material Condition	Risk Status	Control Priority
Sample No					Test Result	
Ceiling Structures/Linings	Flat AC Sheeting					
	8448/B00G/R0032/Ceiling Structures/Linings/S12					No Asbestos Detected
B00G - R0018 - Shower/Change (32.25 m2)						
No Asbestos						
B00G - R0019 - Movement (6.02 m2)						
No Asbestos						
B00G - R0020 - Chair Store (12.65 m2)						
No Asbestos						
B00G - R0021 - Movement (1.58 m2)						
No Asbestos						
B00G - R0022 - Stairs (6 m2)						
No Asbestos						
B00G - R0023 - Stairs (1.99 m2)						
No Asbestos						
B00G - R0024 - Stairs (1.99 m2)						
No Asbestos						
B00G - R0025 - Stairs (3.08 m2)						
No Asbestos						
B00G - R0026 - External Movement (10.94 m2)						
Ceiling Structures/Linings	Flat AC Sheeting					
	8448/B00G/R0032/Ceiling Structures/Linings/S12					No Asbestos Detected
B00G - R0027 - External Movement (10.9 m2)						
Ceiling Structures/Linings	Flat AC Sheeting					
	8448/B00G/R0032/Ceiling Structures/Linings/S12					No Asbestos Detected
B00G - R0028 - External Movement (33.08 m2)						
Ceiling Structures/Linings	Flat AC Sheeting					
	8448/B00G/R0032/Ceiling Structures/Linings/S12					No Asbestos Detected
B00G - R0031 - Stairs (5.37 m2)						
No Asbestos						
B00G - R0032 - External Movement (148.62 m2)						
Ceiling Structures/Linings	Flat AC Sheeting					
	8448/B00G/R0032/Ceiling Structures/Linings/S12					No Asbestos Detected
B00G - R0033 - External Movement (106.46 m2)						
Ceiling Structures/Linings	Flat AC Sheeting					
	8448/B00G/R0032/Ceiling Structures/Linings/S12					No Asbestos Detected

2017

Product	Material Description	Extent	Location Reference	Material Condition	Risk Status	Control Priority
Sample No					Test Result	

B00H - Support Unit/Administration - 1973 - Brick/Block (Brick/Block)**Exterior**

Ceiling Voids - Flat Roof	Non Accessible Area - Area inaccessible					
Underfloor Voids - Slab on Ground	Non Accessible Area - Area inaccessible					
Eaves Linings	Flat AC Sheeting 8448/B00H/Eaves Linings/S21	250m2	North South East & West	Good Condition (1)	Low (1)	Low Priority (2-3) Chrysotile (white asbestos) , Amosite (brown asbestos)

Interior**B00H - R0001 - Entry (10.89 m2)**

No Asbestos

B00H - R0002 - Administration - Clerical (16.31 m2)

No Asbestos

B00H - R0003 - Commonroom (42.1 m2)

Wall Linings Internal	Flat AC Sheeting 8448/B00H/R0003/Wall Linings Internal/S20					No Asbestos Detected
-----------------------	---	--	--	--	--	-----------------------------

B00H - R0004 - Staff Kitchen (9.06 m2)

No Asbestos

B00H - R0005 - Hydrotherapy (8.18 m2)

No Asbestos

B00H - R0006 - Cleaning Supplies Store (7.67 m2)

No Asbestos

B00H - R0007 - Staff - Toilet (5.18 m2)

No Asbestos

B00H - R0008 - General Storeroom (7.04 m2)

No Asbestos

B00H - R0009 - Therapy (8.33 m2)

No Asbestos

B00H - R0010 - Toilets-Disabled (5.29 m2)

No Asbestos

B00H - R0011 - Student Laundry - Type 3 (5.31 m2)

No Asbestos

B00H - R0012 - Toilets-Disabled (6.16 m2)

No Asbestos

B00H - R0013 - Movement (28.49 m2)

No Asbestos

B00H - R0014 - General Learning Space - S/P (41.82 m2)

No Asbestos

B00H - R0015 - Practical Activity Area (15.49 m2)

No Asbestos

B00H - R0016 - Practical Activity Area (15.52 m2)

No Asbestos

B00H - R0017 - General Learning Space - S/P (41.81 m2)

No Asbestos

B00H - R0018 - Movement (10.6 m2)

No Asbestos

B00H - R0019 - Toilets-Disabled (7.06 m2)

Product	Material Description	Extent	Location Reference	Material Condition	Risk Status	Control Priority
	Sample No					Test Result

No Asbestos

B00H - R0020 - Toilets-Disabled (8.83 m2)

No Asbestos

B00H - R0021 - Toilets-Disabled (5.76 m2)

No Asbestos

B00H - R0022 - Toilets-Disabled (2.14 m2)

No Asbestos

B00H - R0023 - Staff - Toilet (1.97 m2)

No Asbestos

B00H - R0024 - General Assistants (31.09 m2)

No Asbestos

B00H - R0025 - Movement (22.11 m2)

No Asbestos

B00H - R0026 - Movement (16.7 m2)

No Asbestos

B00H - R0027 - Covered Vehicle Area/Porte Cochere (32.24 m2)

No Asbestos

2017

Product	Material Description	Extent	Location Reference	Material Condition	Risk Status	Control Priority
Sample No					Test Result	

B00L - Other - 2003 - Metal Shed (Metal Shed)

Exterior

Underfloor Voids - Slab on Ground Non Accessible Area
 - Area inaccessible

Ceiling Voids No Asbestos Found

Interior

B00L - R0001 - General Storeroom (24.01 m2)

No Asbestos

2017

Product	Material Description	Extent	Location Reference	Material Condition	Risk Status	Control Priority
Sample No					Test Result	

B00M - Physical Education - 2011 - Brick/Veneer (Brick/Veneer)**Exterior**

Underfloor Voids - Slab on Ground Non Accessible Area
- Area inaccessible

Ceiling Voids No Asbestos Found

Interior**B00M - R0001 - Gymnasium (629.95 m2)**

No Asbestos

B00M - R0002 - Tea Room (33.5 m2)

No Asbestos

B00M - R0003 - First Aid (13.02 m2)

No Asbestos

B00M - R0004 - Toilets - Girls (29.44 m2)

No Asbestos

B00M - R0005 - Toilets - Boys (29.22 m2)

No Asbestos

B00M - R0006 - Fitness Store (24.68 m2)

No Asbestos

B00M - R0007 - Toilets-Disabled (9.42 m2)

No Asbestos

B00M - R0008 - Cleaning Store - Distributed (3.15 m2)

No Asbestos

B00M - R0009 - Plant (0.71 m2)

No Asbestos

B00M - R0010 - Distribution Board Cupboard (0.79 m2)

Note: No inspection of live electrical installation.

No Asbestos

B00M - R0011 - Plant (0.42 m2)

No Asbestos

B00M - R0012 - External Movement (69.9 m2)

No Asbestos

2017

Product	Material Description	Extent	Location Reference	Material Condition	Risk Status	Control Priority
Sample No					Test Result	

B00N - Storage - 2010 - Metal Shed (Metal Shed)

Exterior

Underfloor Voids - Slab on Ground Non Accessible Area
 - Area inaccessible

Wall Cladding No Asbestos Found

Interior

B00N - R0001 - No Access (52.51 m2)

No Asbestos

2017

Product	Material Description	Extent	Location Reference	Material Condition	Risk Status	Control Priority
Sample No					Test Result	

Demountables

Demountable details as per the AMS records as of 15 Feb 2017.

OS 601 - D13800 - Learning Unit - Standard/Withdrawal : Placement Date - 7/12/2007

Exterior

No Asbestos Found.

Interior

R1 - Entry

No Asbestos Found.

R2 - General Learning Space

No Asbestos Found.

R3 - Store

No Asbestos Found.

2017

Product	Material Description	Extent	Location Reference	Material Condition	Risk Status	Control Priority
Sample No					Test Result	

Listing of Electronic Attachments as of 22/03/2017

Available Asbestos Related Electronic Files

8448_ASB_301112_AMP.pdf

* Note : Refer to AMS for details of the attachment(s).

2017