

Asbestos Register

(Hazardous Materials and Risk Assessment)

School : Bega High School (8165)
Region : Illawarra and South East
State Electorate : Bega
Local Government Area : Bega Valley

Initial Survey : Noel Arnold & Associates : 18 - Dec - 2009
Reviewed By : Greencap-NAA : 27 - Aug - 2014

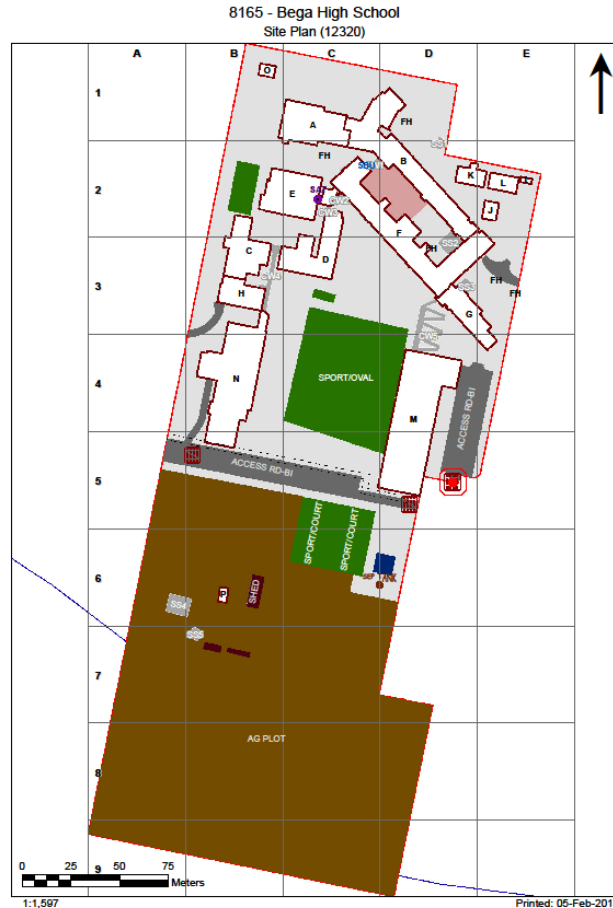

2017

Product	Material Description	Extent	Location Reference	Material Condition	Risk Status	Control Priority
Sample No					Test Result	

B00A - Multi Purpose Facilities - 1963 - Brick/Block (Brick/Block)**Exterior**

Ceiling Voids	Non Accessible Area - Height Restriction					
Wall lining	Flat AC Sheeting 8165/B00A/Wall lining/S27					No Asbestos Detected
Underfloor Voids	No Asbestos Found					

Interior**B00A - M0001 - Movement (7.02 m2)**

No Asbestos

B00A - M0002 - Control Room (7.64 m2)

No Asbestos

B00A - M0003 - Performing Arts Store (9.92 m2)

No Asbestos

B00A - R0001 - Multi-Purpose Space (250.83 m2)

Ceiling Structures/Linings	Flat AC Sheeting	60m2	West, Lower portion	Good Condition (1)	Low (1)	Low Priority (2-3)
----------------------------	------------------	------	---------------------	--------------------	---------	--------------------

Assumed Asbestos - Height Restriction**B00A - R0002 - Sport Equipment Store (10.59 m2)**

No Asbestos

B00A - R0003 - Student Canteen (13.79 m2)

No Asbestos

B00A - R0004 - Stage (103.19 m2)

No Asbestos

B00A - R0006 - Sport Equipment Store (11.59 m2)

Ceiling Structures/Linings	Flat AC Sheeting	12m2	Throughout	Minimal Damage (2)	Low (1)	Low Priority (2-3)
	8165/B00A/R0015/Ceiling Structures/Linings/S23					Chrysotile (white asbestos) , Amosite (brown asbestos) , Crocidolite (blue asbestos)

Floor Coverings Res/Textile	Vinyl Tiles	12m2	Throughout	Good Condition (1)	Low (1)	Low Priority (2-3)
	8165/B00A/R0006/Floor Coverings Res/Textile/S59					Chrysotile (white asbestos)

Floor Coverings Res/Textile	Adhesive					No Asbestos Detected
	8165/B00A/R0017/Floor Coverings Res/Textile/S25					

B00A - R0008 - Shower/Change (42.41 m2)

Ceiling Structures/Linings	Flat AC Sheeting	42.41m2	Throughout	Good Condition (1)	Low (1)	Low Priority (2-3)
	8165/B00A/R0015/Ceiling Structures/Linings/S23					Chrysotile (white asbestos) , Amosite (brown asbestos) , Crocidolite (blue asbestos)

B00A - R0009 - Staff Change (8.68 m2)

Ceiling Structures/Linings	Flat AC Sheeting	9m2	Throughout	Good Condition (1)	Low (1)	Low Priority (2-3)
	8165/B00A/R0015/Ceiling Structures/Linings/S23					Chrysotile (white asbestos) , Amosite (brown asbestos) , Crocidolite (blue asbestos)

Floor Coverings Res/Textile	Adhesive					No Asbestos Detected
	8165/B00A/R0017/Floor Coverings Res/Textile/S25					

Floor Coverings Res/Textile	Vinyl Tiles (Under Floor Covering/Carpet)	8.68m2	Throughout	Good Condition (1)	Low (1)	Low Priority (2-3)
	8165/B00A/R0006/Floor Coverings Res/Textile/S59					Chrysotile (white asbestos)

B00A - R0010 - Staff Change (2.59 m2)

Product	Material Description	Extent	Location Reference	Material Condition	Risk Status	Control Priority
Sample No					Test Result	
Ceiling Structures/Linings	Flat AC Sheeting	2.59m2	Throughout	Good Condition (1)	Low (1)	Low Priority (2-3)
8165/B00A/R0015/Ceiling Structures/Linings/S23				Chrysotile (white asbestos) , Amosite (brown asbestos) , Crocidolite (blue asbestos)		
B00A - R0011 - Movement (2.47 m2)						
No Asbestos						
B00A - R0012 - External Movement (28.42 m2)						
Ceiling Structures/Linings	Flat AC Sheeting					
8165/B00A/R0013/Ceiling Structures/Linings/S26				No Asbestos Detected		
B00A - R0013 - External Movement (29.86 m2)						
Ceiling Structures/Linings	Flat AC Sheeting					
8165/B00A/R0013/Ceiling Structures/Linings/S26				No Asbestos Detected		
B00A - R0014 - Stairs (3.98 m2)						
No Asbestos						
B00A - R0015 - Sport Equipment Store (12.52 m2)						
Ceiling Structures/Linings	Flat AC Sheeting	12.52m2	Throughout	Good Condition (1)	Low (1)	Low Priority (2-3)
8165/B00A/R0015/Ceiling Structures/Linings/S23				Chrysotile (white asbestos) , Amosite (brown asbestos) , Crocidolite (blue asbestos)		
B00A - R0016 - Music Store (6.05 m2)						
Ceiling Structures/Linings	Flat AC Sheeting	6.05m2	Throughout	Good Condition (1)	Low (1)	Low Priority (2-3)
8165/B00A/R0015/Ceiling Structures/Linings/S23				Chrysotile (white asbestos) , Amosite (brown asbestos) , Crocidolite (blue asbestos)		
B00A - R0017 - Uniform Shop (6.57 m2)						
Ceiling Structures/Linings	Flat AC Sheeting	6.57m2	Throughout	Good Condition (1)	Low (1)	Low Priority (2-3)
8165/B00A/R0015/Ceiling Structures/Linings/S23				Chrysotile (white asbestos) , Amosite (brown asbestos) , Crocidolite (blue asbestos)		
B00A - R0018 - Change (35.22 m2)						
Ceiling Structures/Linings	Flat AC Sheeting	35.22m2	Throughout	Good Condition (1)	Low (1)	Low Priority (2-3)
8165/B00A/R0015/Ceiling Structures/Linings/S23				Chrysotile (white asbestos) , Amosite (brown asbestos) , Crocidolite (blue asbestos)		
B00A - R0019 - Covered Area (6.41 m2)						
No Asbestos						
B00A - R9001 - Gymnasium (98.86 m2)						
No Asbestos						
B00A - R9002 - Movement (4.44 m2)						
No Asbestos						
B00A - R9003 - Stairs (3.98 m2)						
No Asbestos						

2017

Product	Material Description	Extent	Location Reference	Material Condition	Risk Status	Control Priority
Sample No				Test Result		

B00B - General Learning/Administration - 1951 - Brick/Block (Brick/Block)**Exterior**

Flue	Fibre Cement Pipe	2Unit(s)	Upper portion	Good Condition (1)	Low (1)	Low Priority (2-3)
------	-------------------	----------	---------------	--------------------	---------	--------------------

Assumed Asbestos - Height Restriction

Ceiling Voids	No Asbestos Found
---------------	-------------------

Underfloor Voids	No Asbestos Found
------------------	-------------------

Interior**B00B - R0001 - Public Entry (42.64 m2)**

No Asbestos

B00B - R0014 - Movement (46.89 m2)

No Asbestos

B00B - R0016 - General Learning Space (49.5 m2)

Floor Coverings Res/Textile	Vinyl Tiles (Under Floor Covering/Carpet) 8165/B00B/R0016/Floor Coverings Res/Textile/S29	49.5m2	Throughout	Good Condition (1)	Low (1)	Low Priority (2-3)
Chrysotile (white asbestos)						

B00B - R0017 - General Learning Space (49.35 m2)

Floor Coverings Res/Textile	Vinyl Tiles (Under Floor Covering/Carpet) 8165/B00B/R0016/Floor Coverings Res/Textile/S29	49.35m2	Throughout	Good Condition (1)	Low (1)	Low Priority (2-3)
Chrysotile (white asbestos)						

B00B - R0018 - General Learning Space (49.69 m2)

Floor Coverings Res/Textile	Vinyl Tiles (Under Floor Covering/Carpet) 8165/B00B/R0016/Floor Coverings Res/Textile/S29	49.6m2	Throughout	Good Condition (1)	Low (1)	Low Priority (2-3)
Chrysotile (white asbestos)						

B00B - R0019 - General Learning Space (49.5 m2)

Floor Coverings Res/Textile	Vinyl Tiles (Under Floor Covering/Carpet) 8165/B00B/R0016/Floor Coverings Res/Textile/S29	49.8m2	Throughout	Good Condition (1)	Low (1)	Low Priority (2-3)
Chrysotile (white asbestos)						

B00B - R0020 - General Learning Space (49.68 m2)

Floor Coverings Res/Textile	Vinyl Tiles (Under Floor Covering/Carpet) 8165/B00B/R0016/Floor Coverings Res/Textile/S29	49.68m2	Throughout	Good Condition (1)	Low (1)	Low Priority (2-3)
Chrysotile (white asbestos)						

B00B - R0021 - General Learning Space (49.49 m2)

Floor Coverings Res/Textile	Vinyl Tiles (Under Floor Covering/Carpet) 8165/B00B/R0016/Floor Coverings Res/Textile/S29	49.49m2	Throughout	Good Condition (1)	Low (1)	Low Priority (2-3)
Chrysotile (white asbestos)						

B00B - R0022 - General Learning Space (49.43 m2)

Floor Coverings Res/Textile	Vinyl Tiles (Under Floor Covering/Carpet) 8165/B00B/R0016/Floor Coverings Res/Textile/S29	49.43m2	Throughout	Good Condition (1)	Low (1)	Low Priority (2-3)
Chrysotile (white asbestos)						

B00B - R0023 - General Storeroom (13.36 m2)

Floor Coverings Res/Textile	Vinyl Tiles (Under Floor Covering/Carpet) 8165/B00B/R0016/Floor Coverings Res/Textile/S29	13.36m2	Throughout	Good Condition (1)	Low (1)	Low Priority (2-3)
Chrysotile (white asbestos)						

B00B - R0024 - No Access (1 m2)

No Asbestos

B00B - R0026 - Cleaning Store - Distributed (3.24 m2)

No Asbestos

B00B - R0034 - General Storeroom (9.56 m2)

Floor Coverings Res/Textile	Vinyl Tiles (Under Floor Covering/Carpet) 8165/B00B/R0016/Floor Coverings Res/Textile/S29	9.56m2	Throughout	Good Condition (1)	Low (1)	Low Priority (2-3)
Chrysotile (white asbestos)						

B00B - R0035 - Staff Study (24.76 m2)

No Asbestos

Product	Material Description	Extent	Location Reference	Material Condition	Risk Status	Control Priority
Sample No					Test Result	
B00B - R0038 - External Movement (3.07 m2)						
Ceiling Structures/Linings	Flat AC Sheeting	307m2	Throughout	Good Condition (1)	Low (1)	Low Priority (2-3)
8165/B00B/R0038/Ceiling Structures/Linings/S30					Chrysotile (white asbestos)	
B00B - R0039 - Stairs (2.7 m2)						
No Asbestos						
B00B - R0040 - Movement (161.5 m2)						
No Asbestos						
B00B - R0041 - General Storeroom (2.13 m2)						
No Asbestos						
B00B - R0042 - Stairs (4.25 m2)						
No Asbestos						
B00B - R0043 - External Movement (3.11 m2)						
No Asbestos						
B00B - R0046 - General Storeroom (4.21 m2)						
No Asbestos						
B00B - R0047 - External Movement (1.45 m2)						
No Asbestos						
B00B - R0049 - Public Entry (20 m2)						
No Asbestos						
B00B - R0050 - Interview/Meeting (14.13 m2)						
No Asbestos						
B00B - R0051 - Interview/Meeting (14.78 m2)						
No Asbestos						
B00B - R0052 - Principal Office (21.74 m2)						
No Asbestos						
B00B - R0053 - Movement (16.39 m2)						
No Asbestos						
B00B - R0054 - Administration - Executive (24.08 m2)						
No Asbestos						
B00B - R0055 - Staff Kitchen (4.02 m2)						
No Asbestos						
B00B - R0056 - Utility Space (16.29 m2)						
No Asbestos						
B00B - R0057 - Administration - Clerical (58.96 m2)						
No Asbestos						
B00B - R0058 - Student Reception (22.25 m2)						
No Asbestos						
B00B - R0059 - Student Waiting (13.6 m2)						
No Asbestos						
B00B - R0060 - Interview/Office - Type 1 (16.87 m2)						
No Asbestos						
B00B - R0061 - Deputy Principal Office (12.09 m2)						
No Asbestos						
B00B - R0062 - Distribution Board Cupboard (4.01 m2)					Note: No inspection of live electrical installation.	
No Asbestos						
B00B - R0063 - Utility Space (1.36 m2)						
No Asbestos						
B00B - R0064 - Movement (6.86 m2)						

Product	Material Description	Extent	Location Reference	Material Condition	Risk Status	Control Priority
Sample No						Test Result
No Asbestos						
B00B - R0065 - Clinic - Boys (11.97 m2)						
No Asbestos						
B00B - R0066 - Clinic - Girls (12.62 m2)						
No Asbestos						
B00B - R0067 - Access Student Shower/Toilet/Change (6.94 m2)						
No Asbestos						
B00B - R0068 - Movement (9.83 m2)						
No Asbestos						
B00B - R0069 - Secure Storeroom (13.61 m2)						
No Asbestos						
B00B - R0070 - Interview/Office - Type 1 (8.88 m2)						
No Asbestos						
B00B - R0071 - Interview/Office - Type 1 (12.23 m2)						
No Asbestos						
B00B - R0072 - Toilet - Lobby (1.56 m2)						
No Asbestos						
B00B - R0073 - Staff - Toilet (2.39 m2)						
No Asbestos						
B00B - R0074 - Toilet - Lobby (1.6 m2)						
No Asbestos						
B00B - R0075 - Staff - Toilet (2.39 m2)						
No Asbestos						
B00B - R0076 - Deputy Principal Office (13.28 m2)						
No Asbestos						
B00B - R0077 - Cleaning Store - Distributed (1.99 m2)						
No Asbestos						
B00B - R0078 - External Movement (8.54 m2)						
Ceiling Structures/Linings	Compressed AC Sheet					
	8165/B00B/R0078/Ceiling Structures/Linings/S28					No Asbestos Detected
B00B - R1009 - General Storeroom (9.82 m2)						
No Asbestos						
B00B - R1010 - General Learning Space (49.5 m2)						
No Asbestos						
B00B - R1011 - General Learning Space (49.5 m2)						
No Asbestos						
B00B - R1012 - Computer Learning Space (49.42 m2)						
No Asbestos						
B00B - R1013 - General Learning Space (49.69 m2)						
Fume Cupboard	Flat AC Sheeting	2Unit	East	Some Damage / Unsealed (3)	Low (1)	Low Priority (2-3)
	8165/B00B/R1013/Fume Cupboard/S31					Chrysotile (white asbestos) , Amosite (brown asbestos)
B00B - R1015 - General Storeroom (16.69 m2)						
No Asbestos						
B00B - R1017 - General Learning Space (49.62 m2)						
No Asbestos						
B00B - R1018 - General Storeroom (13.14 m2)						
No Asbestos						

Product	Material Description	Extent	Location Reference	Material Condition	Risk Status	Control Priority
Sample No					Test Result	
B00B - R1019 - General Storeroom (9.55 m2)						
No Asbestos						
B00B - R1020 - Cleaning Store - Distributed (2.4 m2)						
No Asbestos						
B00B - R1021 - Staff Study (24.29 m2)						
No Asbestos						
B00B - R1023 - Toilets-Boys (8.84 m2)						
Ceiling Structures/Linings	Flat AC Sheeting	8.84m2	Throughout	Good Condition (1)	Low (1)	Low Priority (2-3)
8165/B00B/R1023/Ceiling Structures/Linings/S32				Chrysotile (white asbestos) , Amosite (brown asbestos)		
B00B - R1024 - General Learning Space (51.13 m2)						
No Asbestos						
B00B - R1025 - Computer Store (32.5 m2)						
No Asbestos						
B00B - R1026 - Stairs (12.12 m2)						
No Asbestos						
B00B - R1027 - Stairs (15.14 m2)						
No Asbestos						
B00B - R1028 - Movement (173.78 m2)						
No Asbestos						
B00B - R1030 - Distribution Board Cupboard (1.51 m2)						
					Note: No inspection of live electrical installation.	
Flooring	Flat AC Sheeting	8165/B00B/R1030/Flooring/S33		No Asbestos Detected		
B00B - R1031 - Cleaning Store - Distributed (0.9 m2)						
No Asbestos						
B00B - R1032 - Staff Study (51.05 m2)						
No Asbestos						
B00B - R1033 - Commonroom (75.73 m2)						
Ceiling Structures/Linings	Vermiculite	8165/B00B/R1033/Ceiling Structures/Linings/S34		Limited Samples Taken		
Vermiculite Ceilings may contain asbestos. Asbestos testing MUST be conducted prior to any disturbance works						
B00B - R1034 - Staff Kitchen (14.88 m2)						
Ceiling Structures/Linings	Vermiculite	8165/B00B/R1033/Ceiling Structures/Linings/S34		Limited Samples Taken		
Vermiculite Ceilings may contain asbestos. Asbestos testing MUST be conducted prior to any disturbance works						
B00B - R1035 - Toilet - Lobby (2.62 m2)						
No Asbestos						
B00B - R1036 - Staff - Toilet (1.47 m2)						
No Asbestos						
B00B - R1037 - Movement (26.35 m2)						
No Asbestos						
B00B - R1038 - Toilet - Lobby (2.69 m2)						
No Asbestos						
B00B - R1039 - Staff - Toilet (3.71 m2)						
No Asbestos						

Product	Material Description	Extent	Location Reference	Material Condition	Risk Status	Control Priority
Sample No					Test Result	

B00C - General Learning/Staff Facilities - 1963 - Brick/Block (Brick/Block)**Exterior**

Eaves Linings	Flat AC Sheeting	50m2	East/West	Good Condition (1)	Low (1)	Low Priority (2-3)
	8165/B00C/Eaves Linings/S51					Chrysotile (white asbestos)
Ceiling Voids	No Asbestos Found					
Underfloor Voids - Packing to Floor Joists	Flat AC Sheeting	500m2	Variable positions	Good Condition (1)	Low (1)	Low Priority (2-3)
	8165/B00C/Underfloor Voids - Packing to Floor Joists/S53					Chrysotile (white asbestos) , Amosite (brown asbestos)

Interior**B00C - R0005 - Design L.S. (73.52 m2)**

Ceiling Structures/Linings	Flat AC Sheeting	73.52m2	Throughout	Good Condition (1)	Low (1)	Low Priority (2-3)
	8165/B00C/R0017/Ceiling Structures/Linings/S52					Chrysotile (white asbestos) , Amosite (brown asbestos)

B00C - R0015 - External Movement (27.35 m2)

Ceiling Structures/Linings	Flat AC Sheeting					No Asbestos Detected
	8165/B00C/R0027/Ceiling Structures/Linings/S50					

B00C - R0017 - General Learning Space - Type 1 (61.44 m2)

Ceiling Structures/Linings	Flat AC Sheeting	61.44m2	Throughout	Good Condition (1)	Low (1)	Low Priority (2-3)
	8165/B00C/R0017/Ceiling Structures/Linings/S52					Chrysotile (white asbestos) , Amosite (brown asbestos)

B00C - R0018 - Seminar - Type 1 (24.32 m2)

Ceiling Structures/Linings	Flat AC Sheeting	24.32m2	Throughout	Good Condition (1)	Low (1)	Low Priority (2-3)
	8165/B00C/R0017/Ceiling Structures/Linings/S52					Chrysotile (white asbestos) , Amosite (brown asbestos)

B00C - R0019 - General Learning Space - Type 1 (59.05 m2)

Ceiling Structures/Linings	Flat AC Sheeting	59.05m2	Throughout	Good Condition (1)	Low (1)	Low Priority (2-3)
	8165/B00C/R0017/Ceiling Structures/Linings/S52					Chrysotile (white asbestos) , Amosite (brown asbestos)

B00C - R0020 - G.L.S. Store (17.43 m2)

Ceiling Structures/Linings	Flat AC Sheeting	17.43m2	Throughout	Good Condition (1)	Low (1)	Low Priority (2-3)
	8165/B00C/R0017/Ceiling Structures/Linings/S52					Chrysotile (white asbestos) , Amosite (brown asbestos)

B00C - R0021 - General Learning Space - Type 1 (74.02 m2)

Ceiling Structures/Linings	Flat AC Sheeting	74.02m2	Throughout	Good Condition (1)	Low (1)	Low Priority (2-3)
	8165/B00C/R0017/Ceiling Structures/Linings/S52					Chrysotile (white asbestos) , Amosite (brown asbestos)

B00C - R0022 - Staff - Toilet (6.17 m2)

No Asbestos

B00C - R0023 - Distribution Board Cupboard (0.28 m2)

Note: No inspection of live electrical installation.

No Asbestos

B00C - R0024 - Staff Kitchen (19.78 m2)

No Asbestos

B00C - R0025 - Movement (48.17 m2)

No Asbestos

B00C - R0026 - Dust Extraction Space (13.41 m2)

No Asbestos

B00C - R0027 - External Movement (24.82 m2)

Product	Material Description	Extent	Location Reference	Material Condition	Risk Status	Control Priority
Sample No					Test Result	

Ceiling Structures/Linings Flat AC Sheeting
 8165/B00C/R0027/Ceiling Structures/Linings/S50

No Asbestos Detected

2017

Product	Material Description	Extent	Location Reference	Material Condition	Risk Status	Control Priority
Sample No					Test Result	

B00D - Science Learning - 1980 - Brick/Block (Brick/Block)**Exterior**

Eaves Linings	Flat AC Sheeting 8165/B00D/Eaves Linings/S54					No Asbestos Detected
Infill panels	Compressed AC Sheet 8165/B00D/Infill panels/S55	80m2	West	Good Condition (1)	Low (1)	Low Priority (2-3) Chrysotile (white asbestos)
Ceiling Voids	No Asbestos Found					
Underfloor Voids - Slab on Ground	No Asbestos Found					

Interior**B00D - R0001 - Laboratory L.S. (93.29 m2)**

No Asbestos

B00D - R0002 - Preparation (8.64 m2)

No Asbestos

B00D - R0003 - Preparation (17.32 m2)

No Asbestos

B00D - R0004 - Laboratory L.S. (53.36 m2)

Fume cupboard	Flat AC Sheeting 8165/B00D/R0004/Fume cupboard/S56	1Unit	North	Good Condition (1)	Low (1)	Low Priority (2-3) Chrysotile (white asbestos) , Amosite (brown asbestos)
---------------	---	-------	-------	--------------------	---------	---

B00D - R0005 - Laboratory L.S. (80.1 m2)

No Asbestos

B00D - R0006 - Preparation (22.76 m2)

Floor Coverings Res/Textile	Vinyl Tiles 8165/B00F/R0029/Floor Coverings Res/Textile/S4					No Asbestos Detected
-----------------------------	---	--	--	--	--	-----------------------------

B00D - R0007 - Distribution Board Cupboard (0.65 m2)

Note: No inspection of live electrical installation.

No Asbestos

B00D - R0008 - Apparatus Store (16.93 m2)

No Asbestos

B00D - R0009 - Staff Study (25.88 m2)

No Asbestos

B00D - R0011 - Growing/Breeding (25.74 m2)

No Asbestos

B00D - R0015 - Movement (57.18 m2)

No Asbestos

B00D - R0016 - External Movement (3.55 m2)

Ceiling Structures/Linings	Flat AC Sheeting 8165/B00D/R0017/Ceiling Structures/Linings/S57					No Asbestos Detected
----------------------------	--	--	--	--	--	-----------------------------

B00D - R0017 - External Movement (39.15 m2)

Ceiling Structures/Linings	Flat AC Sheeting 8165/B00D/R0017/Ceiling Structures/Linings/S57					No Asbestos Detected
----------------------------	--	--	--	--	--	-----------------------------

B00D - R0018 - Covered Area (16.23 m2)

No Asbestos

B00D - R0019 - Seminar - Type 1 (25.34 m2)

No Asbestos

B00D - R0020 - Staff Kitchen (5.86 m2)

No Asbestos

B00D - R0021 - Staff Study (60.75 m2)

Product	Material Description	Extent	Location Reference	Material Condition	Risk Status	Control Priority
Sample No					Test Result	

Floor Coverings Res/Textile	Vinyl Tiles (Under Floor Covering/Carpet)		8165/B00D/R0021/Floor Coverings Res/Textile/S58			No Asbestos Detected
-----------------------------	---	--	---	--	--	-----------------------------

2017

Product	Material Description	Extent	Location Reference	Material Condition	Risk Status	Control Priority
Sample No					Test Result	

B00E - Library/Science Learning - 1971 - Brick/Block (Brick/Block)**Exterior**

Ceiling Voids	No Asbestos Found
Underfloor Voids	No Asbestos Found

Interior**B00E - M1001 - Seminar (37.55 m2)**

No Asbestos

B00E - M1002 - Movement (69.25 m2)

No Asbestos

B00E - M1003 - Seminar (15.31 m2)

No Asbestos

B00E - M1004 - Stairs (2.9 m2)

No Asbestos

B00E - M1005 - Stairs (2.98 m2)

No Asbestos

B00E - R0001 - Laboratory L.S. (91.46 m2)

Ceiling Structures/Linings	Vermiculite					
	8165/B00F/R0029/Ceiling Structures/Linings/S3					Limited Samples Taken
Vermiculite Ceilings may contain asbestos. Asbestos testing MUST be conducted prior to any disturbance works						

B00E - R0002 - Laboratory L.S. (90.84 m2)

Ceiling Structures/Linings	Vermiculite					
	8165/B00F/R0029/Ceiling Structures/Linings/S3					Limited Samples Taken
Vermiculite Ceilings may contain asbestos. Asbestos testing MUST be conducted prior to any disturbance works						

B00E - R0004 - Preparation (44.82 m2)

Ceiling Structures/Linings	Vermiculite					
	8165/B00F/R0029/Ceiling Structures/Linings/S3					Limited Samples Taken
Vermiculite Ceilings may contain asbestos. Asbestos testing MUST be conducted prior to any disturbance works						

Floor Coverings Res/Textile	Vinyl Tiles	45m2	Throughout	Good Condition (1)	Low (1)	Low Priority (2-3)
	8165/B00E/R0008/Floor Coverings Res/Textile/S6					Chrysotile (white asbestos)

B00E - R0005 - Apparatus Store (3.14 m2)

Ceiling Structures/Linings	Vermiculite					
	8165/B00F/R0029/Ceiling Structures/Linings/S3					Limited Samples Taken
Vermiculite Ceilings may contain asbestos. Asbestos testing MUST be conducted prior to any disturbance works						

Floor Coverings Res/Textile	Vinyl Tiles	4m2	Throughout	Good Condition (1)	Low (1)	Low Priority (2-3)
	8165/B00E/R0008/Floor Coverings Res/Textile/S6					Chrysotile (white asbestos)

B00E - R0006 - Laboratory L.S. (91.12 m2)

Ceiling Structures/Linings	Vermiculite					
	8165/B00F/R0029/Ceiling Structures/Linings/S3					Limited Samples Taken
Vermiculite Ceilings may contain asbestos. Asbestos testing MUST be conducted prior to any disturbance works						

B00E - R0007 - Chemical Store (16.73 m2)

Floor Coverings Res/Textile	Vinyl Tiles	17m2	Throughout	Good Condition (1)	Low (1)	Low Priority (2-3)
	8165/B00E/R0008/Floor Coverings Res/Textile/S6					Chrysotile (white asbestos)

B00E - R0008 - Distribution Board Cupboard (0.51 m2)

Note: No inspection of live electrical installation.

Floor Coverings Res/Textile	Vinyl Tiles	1m2	Throughout	Good Condition (1)	Low (1)	Low Priority (2-3)
	8165/B00E/R0008/Floor Coverings Res/Textile/S6					Chrysotile (white asbestos)

B00E - R0009 - Laboratory L.S. (91.1 m2)

Ceiling Structures/Linings	Vermiculite					
	8165/B00F/R0029/Ceiling Structures/Linings/S3					Limited Samples Taken
Vermiculite Ceilings may contain asbestos. Asbestos testing MUST be conducted prior to any disturbance works						

Product	Material Description	Extent	Location Reference	Material Condition	Risk Status	Control Priority
Sample No					Test Result	
B00E - R0010 - Preparation (44.94 m2)						
Ceiling Structures/Linings	Vermiculite					
	8165/B00F/R0029/Ceiling Structures/Linings/S3					Limited Samples Taken
	<i>Vermiculite Ceilings may contain asbestos. Asbestos testing MUST be conducted prior to any disturbance works</i>					
Floor Coverings Res/Textile	Vinyl Tiles	45m2	Throughout	Good Condition (1)	Low (1)	Low Priority (2-3)
	8165/B00E/R0008/Floor Coverings Res/Textile/S6					Chrysotile (white asbestos)
B00E - R0011 - Apparatus Store (3.2 m2)						
Ceiling Structures/Linings	Vermiculite					
	8165/B00F/R0029/Ceiling Structures/Linings/S3					Limited Samples Taken
	<i>Vermiculite Ceilings may contain asbestos. Asbestos testing MUST be conducted prior to any disturbance works</i>					
Floor Coverings Res/Textile	Vinyl Tiles	4m2	Throughout	Good Condition (1)	Low (1)	Low Priority (2-3)
	8165/B00E/R0008/Floor Coverings Res/Textile/S6					Chrysotile (white asbestos)
B00E - R0012 - Plant (10.53 m2)						
No Asbestos						
B00E - R0013 - Movement (40.47 m2)						
Floor Coverings Res/Textile	Vinyl Tiles	41m2	Throughout	Good Condition (1)	Low (1)	Low Priority (2-3)
	8165/B00E/R0008/Floor Coverings Res/Textile/S6					Chrysotile (white asbestos)
B00E - R0014 - General Storeroom (7.92 m2)						
No Asbestos						
B00E - R0015 - Stairs (7.92 m2)						
No Asbestos						
B00E - R0016 - Lift (2.25 m2)						
No Asbestos						
B00E - R0017 - External Movement (7.07 m2)						
No Asbestos						
B00E - R0018 - External Movement (30.24 m2)						
No Asbestos						
B00E - R0019 - External Movement (3.04 m2)						
No Asbestos						
B00E - R0020 - Covered Area (20.92 m2)						
No Asbestos						
B00E - R1001 - Audio Visual Workroom (12.74 m2)						
No Asbestos						
B00E - R1002 - Workroom (17.91 m2)						
No Asbestos						
B00E - R1003 - Staff - Toilet (3.3 m2)						
No Asbestos						
B00E - R1004 - Staff - Toilet (3.29 m2)						
No Asbestos						
B00E - R1005 - Seminar (71.62 m2)						
Ceiling Structures/Linings	Vermiculite					
	8165/B00F/R0029/Ceiling Structures/Linings/S3					Limited Samples Taken
	<i>Vermiculite Ceilings may contain asbestos. Asbestos testing MUST be conducted prior to any disturbance works</i>					
B00E - R1006 - Main Area (328.08 m2)						
Ceiling Structures/Linings	Vermiculite					
	8165/B00F/R0029/Ceiling Structures/Linings/S3					Limited Samples Taken
	<i>Vermiculite Ceilings may contain asbestos. Asbestos testing MUST be conducted prior to any disturbance works</i>					
B00E - R1007 - Seminar (12.97 m2)						
No Asbestos						

Product	Material Description	Extent	Location Reference	Material Condition	Risk Status	Control Priority
Sample No					Test Result	
B00E - R1008 - Seminar (12.13 m2)						
No Asbestos						
B00E - R1009 - Plant (5.17 m2)						
No Asbestos						
B00E - R1010 - Plant (5.2 m2)						
No Asbestos						
B00E - R1011 - Cleaning Store - Distributed (0.33 m2)						
No Asbestos						
B00E - R1012 - Movement (4.6 m2)						
No Asbestos						
B00E - R1013 - Distribution Board Cupboard (0.24 m2)				Note: No inspection of live electrical installation.		
No Asbestos						
B00E - R1014 - Seminar (12.13 m2)						
No Asbestos						
B00E - R1015 - Seminar (12.71 m2)						
No Asbestos						
B00E - R1016 - Audio Visual Workroom (28.59 m2)						
No Asbestos						
B00E - R1017 - Librarian (11.27 m2)						
No Asbestos						
B00E - R1019 - Stairs (17.06 m2)						
No Asbestos						
B00E - R1020 - Lift (2.25 m2)						
No Asbestos						
B00E - R1021 - Stairs (0.34 m2)						
No Asbestos						
B00E - R1022 - Stairs (0.34 m2)						
No Asbestos						
B00E - R1023 - External Movement (29.35 m2)						
No Asbestos						
B00E - R1024 - External Movement (7.15 m2)						
No Asbestos						

2017

Product	Material Description	Extent	Location Reference	Material Condition	Risk Status	Control Priority
Sample No					Test Result	

B00F - General Learning/Art - 1963 - Brick/Block (Brick/Block)**Exterior**

Eaves Linings	Flat AC Sheeting	100m2	South, East, West	Good Condition (1)	Low (1)	Low Priority (2-3)
	8165/B00F/Eaves Linings/S37					Chrysotile (white asbestos)
Ceiling Voids - Raked Ceiling	Non Accessible Area					
	- Area inaccessible					
Underfloor Voids - Slab on Ground	Non Accessible Area					
	- Area inaccessible					

Interior**B00F - R0001 - Distribution Board Cupboard (1.25 m2)**

Note: No inspection of live electrical installation.

No Asbestos

B00F - R0002 - Movement (5.37 m2)

No Asbestos

B00F - R0003 - Student Canteen (60.5 m2)

Ceiling Structures/Linings	Vermiculite					
	8165/B00F/R0003/Ceiling Structures/Linings/S39					Limited Samples Taken
	Vermiculite Ceilings may contain asbestos. Asbestos testing MUST be conducted prior to any disturbance works					
Floor Coverings Res/Textile	Vinyl Sheet					
	8165/B00F/R0003/Floor Coverings Res/Textile/S40					No Asbestos Detected

B00F - R0004 - Maintenance Bulk Store (25.8 m2)

No Asbestos

B00F - R0005 - Staff Change (5.3 m2)

No Asbestos

B00F - R0006 - Staff - Toilet (3.47 m2)

Incinerette	Millboard	1Unit	West	Good Condition (1)	Low (1)	Low Priority (2-3)
						Assumed Asbestos - Area inaccessible

B00F - R0007 - Office/Store (4.48 m2)

Floor Coverings Res/Textile	Vinyl Sheet					
	8165/B00F/R0003/Floor Coverings Res/Textile/S40					No Asbestos Detected

B00F - R0008 - Movement (132.52 m2)

No Asbestos

B00F - R0009 - External Movement (219.38 m2)

No Asbestos

B00F - R0010 - Toilets-Girls (17.58 m2)

Partition Walls (Cubicles)	Compressed AC Sheet	12m2	Throughout	Good Condition (1)	Low (1)	Low Priority (2-3)
	8165/B00F/R1058/Partition Walls (Cubicles)/S38					Chrysotile (white asbestos)

B00F - R0011 - Staff - Toilet (5.91 m2)

Incinerator	Encapsulated Insulation material within unit	1Unit(s)	West	Friable Asbestos (5)	Low (1)	Low Priority (2-3)
						Assumed Asbestos - Area inaccessible

Partition Walls (Cubicles)	Compressed AC Sheet	5.91m2	Throughout	Good Condition (1)	Low (1)	Low Priority (2-3)
	8165/B00F/R1058/Partition Walls (Cubicles)/S38					Chrysotile (white asbestos)

B00F - R0012 - Distribution Board Cupboard (0.88 m2)

Note: No inspection of live electrical installation.

No Asbestos

B00F - R0014 - Toilets-Disabled (2.93 m2)

Product	Material Description	Extent	Location Reference	Material Condition	Risk Status	Control Priority
Sample No					Test Result	
No Asbestos						
B00F - R0015 - Design L.S. (67.37 m2)						
Ceiling Structures/Linings	Vermiculite	8165/B00F/R0029/Ceiling Structures/Linings/S3				Limited Samples Taken
<i>Vermiculite Ceilings may contain asbestos. Asbestos testing MUST be conducted prior to any disturbance works</i>						
B00F - R0016 - Materials Store (15.82 m2)						
Ceiling Structures/Linings	Vermiculite	8165/B00F/R0003/Ceiling Structures/Linings/S39				Limited Samples Taken
<i>Vermiculite Ceilings may contain asbestos. Asbestos testing MUST be conducted prior to any disturbance works</i>						
B00F - R0017 - Design L.S. (68.82 m2)						
Ceiling Structures/Linings	Vermiculite	8165/B00F/R0003/Ceiling Structures/Linings/S39				Limited Samples Taken
<i>Vermiculite Ceilings may contain asbestos. Asbestos testing MUST be conducted prior to any disturbance works</i>						
B00F - R0029 - General Storeroom (13.84 m2)						
Ceiling Structures/Linings	Vermiculite	8165/B00F/R0029/Ceiling Structures/Linings/S3				Limited Samples Taken
<i>Vermiculite Ceilings may contain asbestos. Asbestos testing MUST be conducted prior to any disturbance works</i>						
Floor Coverings Res/Textile	Vinyl Tiles	8165/B00F/R0029/Floor Coverings Res/Textile/S4				No Asbestos Detected
B00F - R0030 - Cleaning Store - Distributed (2.94 m2)						
Ceiling Structures/Linings	Vermiculite	8165/B00F/R0029/Ceiling Structures/Linings/S3				Limited Samples Taken
<i>Vermiculite Ceilings may contain asbestos. Asbestos testing MUST be conducted prior to any disturbance works</i>						
B00F - R0031 - Distribution Board Cupboard (0.69 m2)					Note: No inspection of live electrical installation.	
No Asbestos						
B00F - R0032 - Toilets-Boys (25.72 m2)						
No Asbestos						
B00F - R0033 - Shower/Change (31.95 m2)						
No Asbestos						
B00F - R0035 - Stairs (7.22 m2)						
No Asbestos						
B00F - R0036 - Stairs (7.39 m2)						
No Asbestos						
B00F - R0037 - Cleaning Store - Distributed (3.01 m2)						
No Asbestos						
B00F - R0040 - Visual Arts Store (10.82 m2)						
No Asbestos						
B00F - R0041 - General Learning Space - Type 4 (57.91 m2)						
Ceiling Structures/Linings	Vermiculite	8165/B00F/R0003/Ceiling Structures/Linings/S39				Limited Samples Taken
<i>Vermiculite Ceilings may contain asbestos. Asbestos testing MUST be conducted prior to any disturbance works</i>						
B00F - R0042 - Visual Arts Workshop (106.41 m2)						
Ceiling Structures/Linings	Vermiculite	8165/B00F/R0003/Ceiling Structures/Linings/S39				Limited Samples Taken
<i>Vermiculite Ceilings may contain asbestos. Asbestos testing MUST be conducted prior to any disturbance works</i>						
B00F - R0043 - General Learning Space - Type 5 (50.92 m2)						
Ceiling Structures/Linings	Vermiculite	8165/B00F/R0003/Ceiling Structures/Linings/S39				Limited Samples Taken
<i>Vermiculite Ceilings may contain asbestos. Asbestos testing MUST be conducted prior to any disturbance works</i>						
B00F - R0044 - Visual Arts Store (17.43 m2)						

Product	Material Description	Extent	Location Reference	Material Condition	Risk Status	Control Priority
Sample No					Test Result	
Ceiling Structures/Linings	Vermiculite					
	8165/B00F/R0003/Ceiling Structures/Linings/S39					Limited Samples Taken
Vermiculite Ceilings may contain asbestos. Asbestos testing MUST be conducted prior to any disturbance works						
B00F - R0045 - Art Learning Space (50.96 m2)						
Ceiling Structures/Linings	Vermiculite					
	8165/B00F/R0003/Ceiling Structures/Linings/S39					Limited Samples Taken
Vermiculite Ceilings may contain asbestos. Asbestos testing MUST be conducted prior to any disturbance works						
B00F - R0046 - General Storeroom (53.92 m2)						
Ceiling Structures/Linings	Vermiculite					
	8165/B00F/R0003/Ceiling Structures/Linings/S39					Limited Samples Taken
Vermiculite Ceilings may contain asbestos. Asbestos testing MUST be conducted prior to any disturbance works						
B00F - R0047 - Movement (3.24 m2)						
No Asbestos						
B00F - R0048 - Dark Room (27.75 m2)						
No Asbestos						
B00F - R0049 - General Storeroom (2.06 m2)						
No Asbestos						
B00F - R0050 - Project Store - Type 1 (50.31 m2)						
No Asbestos						
B00F - R0051 - General Storeroom (9.88 m2)						
No Asbestos						
B00F - R0052 - Kiln Space (8.71 m2)						
No Asbestos						
B00F - R0053 - Toilet - Lobby (2.45 m2)						
No Asbestos						
B00F - R0054 - Toilets-Girls (20.61 m2)						
No Asbestos						
B00F - R1001 - Music Learning Space (93.09 m2)						
No Asbestos						
B00F - R1002 - Music Store (7.83 m2)						
No Asbestos						
B00F - R1003 - General Storeroom (1.35 m2)						
No Asbestos						
B00F - R1004 - Movement (5.4 m2)						
No Asbestos						
B00F - R1005 - Music Learning Space (68.11 m2)						
No Asbestos						
B00F - R1006 - General Learning Space (65.58 m2)						
No Asbestos						
B00F - R1007 - General Storeroom (2.66 m2)						
No Asbestos						
B00F - R1008 - Cleaning Store - Distributed (3.1 m2)						
No Asbestos						
B00F - R1009 - Distribution Board Cupboard (0.78 m2)						
					Note: No inspection of live electrical installation.	
No Asbestos						
B00F - R1010 - Staff - Toilet (6.08 m2)						
Partition Walls (Cubicles)	Compressed AC Sheet	7m2	Throughout	Good Condition (1)	Low (1)	Low Priority (2-3)
	8165/B00F/R1058/Partition Walls (Cubicles)/S38					Chrysotile (white asbestos)
B00F - R1012 - External Movement (223.41 m2)						

Product	Material Description	Extent	Location Reference	Material Condition	Risk Status	Control Priority
Sample No					Test Result	
Ceiling Structures/Linings	Flat AC Sheeting	223.41m2	Throughout	Good Condition (1)	Low (1)	Low Priority (2-3)
8165/B00F/R1012/Ceiling Structures/Linings/S35					Chrysotile (white asbestos)	
B00F - R1013 - Computer Learning Space (53.92 m2)						
No Asbestos						
B00F - R1014 - General Learning Space (53.24 m2)						
No Asbestos						
B00F - R1015 - General Learning Space (51.22 m2)						
No Asbestos						
B00F - R1016 - Staff Study (18.22 m2)						
No Asbestos						
B00F - R1017 - External Movement (2.89 m2)						
No Asbestos						
B00F - R1018 - General Learning Space (51.59 m2)						
No Asbestos						
B00F - R1019 - General Learning Space (53.16 m2)						
No Asbestos						
B00F - R1020 - General Learning Space (53.31 m2)						
No Asbestos						
B00F - R1038 - Stairs (7.29 m2)						
Ceiling Structures/Linings	Flat AC Sheeting	8m2	Throughout	Good Condition (1)	Low (1)	Low Priority (2-3)
8165/B00F/R1012/Ceiling Structures/Linings/S35					Chrysotile (white asbestos)	
B00F - R1039 - Stairs (7.33 m2)						
Ceiling Structures/Linings	Flat AC Sheeting	8m2	Throughout	Good Condition (1)	Low (1)	Low Priority (2-3)
8165/B00F/R1012/Ceiling Structures/Linings/S35					Chrysotile (white asbestos)	
B00F - R1040 - Staff Study (164.19 m2)						
No Asbestos						
B00F - R1041 - General Storeroom (5 m2)						
No Asbestos						
B00F - R1042 - External Movement (3.67 m2)						
No Asbestos						
B00F - R1043 - Staff Kitchen (5.37 m2)						
No Asbestos						
B00F - R1044 - Archive Store (13.29 m2)						
No Asbestos						
B00F - R1045 - Interview/Office - Type 1 (14.59 m2)						
No Asbestos						
B00F - R1046 - Distribution Board Cupboard (0.64 m2)						
No Asbestos					Note: No inspection of live electrical installation.	
B00F - R1047 - Movement (13.38 m2)						
No Asbestos						
B00F - R1048 - Staff - Toilet (3.87 m2)						
Wall Linings Internal	Flat AC Sheeting	8165/B00F/R1052/Wall Linings Internal/S36			No Asbestos Detected	
B00F - R1049 - Preparation/Printing (43.23 m2)						
No Asbestos						
B00F - R1050 - External Movement (3.41 m2)						
No Asbestos						

Product	Material Description	Extent	Location Reference	Material Condition	Risk Status	Control Priority
Sample No					Test Result	
B00F - R1051 - Access Staff Shower/Toilet (6.65 m2)						
Wall Linings Internal	Flat AC Sheeting					
	8165/B00F/R1052/Wall Linings Internal/S36					No Asbestos Detected
B00F - R1052 - Staff - Toilet (5.41 m2)						
Wall Linings Internal	Flat AC Sheeting					
	8165/B00F/R1052/Wall Linings Internal/S36					No Asbestos Detected
B00F - R1053 - Staff - Toilet (3.97 m2)						
Wall Linings Internal	Flat AC Sheeting					
	8165/B00F/R1052/Wall Linings Internal/S36					No Asbestos Detected
B00F - R1054 - Staff - Toilet (3.96 m2)						
Wall Linings Internal	Flat AC Sheeting					
	8165/B00F/R1052/Wall Linings Internal/S36					No Asbestos Detected
B00F - R1055 - Interview/Meeting (10.99 m2)						
No Asbestos						
B00F - R1056 - Interview/Office - Type 1 (11.05 m2)						
No Asbestos						
B00F - R1057 - Toilet - Lobby (2.31 m2)						
No Asbestos						
B00F - R1058 - Toilets-Girls (15.63 m2)						
Partition Walls (Cubicles)	Compressed AC Sheet	12m2	East	Good Condition (1)	Low (1)	Low Priority (2-3)
	8165/B00F/R1058/Partition Walls (Cubicles)/S38					Chrysotile (white asbestos)
B00F - R9001 - Garden Store Room (13.27 m2)						
No Asbestos						

2017

Product	Material Description	Extent	Location Reference	Material Condition	Risk Status	Control Priority
Sample No					Test Result	

B00G - Support Unit (Is) - 1951 - Brick/Block (Brick/Block)**Exterior**

Eaves Linings	Flat AC Sheeting	80m2	North, South	Good Condition (1)	Low (1)	Low Priority (2-3)
	8165/B00G/Eaves Linings/S41				Chrysotile (white asbestos) , Amosite (brown asbestos)	
Ceiling Voids	No Asbestos Found					
Underfloor Voids - Packing to Floor Joists	Flat AC Sheeting	80m2	Variable positions	Good Condition (1)	Low (1)	Low Priority (2-3)
	8165/B00G/Underfloor Voids - Packing to Floor Joists/S43				Chrysotile (white asbestos)	

Interior**B00G - R0004 - Laundry (16.07 m2)**

No Asbestos

B00G - R0005 - Pantry (5.37 m2)

No Asbestos

B00G - R0012 - Home Base - S (70.3 m2)

No Asbestos

B00G - R0013 - Movement (24.22 m2)

No Asbestos

B00G - R0014 - Toilet - S (6.36 m2)

No Asbestos

B00G - R0015 - Laundry - S (23.3 m2)

No Asbestos

B00G - R0016 - Home Base Store - S (7.76 m2)

No Asbestos

B00G - R0017 - Home Base Store - S (7.06 m2)

No Asbestos

B00G - R0018 - Distribution Board Cupboard (0.55 m2)

Note: No inspection of live electrical installation.

Flooring	Compressed AC Sheet					
	8165/B00G/R0018/Flooring/S42					No Asbestos Detected

B00G - R0019 - Practical Activities - S - 1hb (29.1 m2)

No Asbestos

B00G - R0020 - Seminar - Type 1 (10.74 m2)

No Asbestos

B00G - R0021 - Home Base - S (56.58 m2)

No Asbestos

B00G - R0022 - External Movement (89.9 m2)

No Asbestos

2017

Product	Material Description	Extent	Location Reference	Material Condition	Risk Status	Control Priority
Sample No					Test Result	

B00H - Technological & Applied Studies - 1980 - Brick/Block (Brick/Block)**Exterior**

Ceiling Voids - Raked Ceiling	Non Accessible Area - Area inaccessible					
Downpipes	Flat AC Sheeting 8165/B00H/Downpipes/S48	25m2	South	Good Condition (1)	Low (1)	Low Priority (2-3) Chrysotile (white asbestos)
Underfloor Voids - Packing to Floor Joists	Flat AC Sheeting 8165/B00C/Underfloor Voids - Packing to Floor Joists/S53	300m2	Variable positions	Good Condition (1)	Low (1)	Low Priority (2-3) Chrysotile (white asbestos) , Amosite (brown asbestos)

Interior**B00H - R0001 - Distribution Board Cupboard (1.04 m2)** Note: No inspection of live electrical installation.

Ceiling Structures/Linings	Flat AC Sheeting 8165/B00H/R0001/Ceiling Structures/Linings/S47	1m2	Throughout	Good Condition (1)	Low (1)	Low Priority (2-3) Chrysotile (white asbestos)
----------------------------	--	-----	------------	--------------------	---------	--

Electrical Backing Board	Resinous Board	2m2	East	Good Condition (1)	Low (1)	Low Priority (2-3)
--------------------------	----------------	-----	------	--------------------	---------	--------------------

Assumed Asbestos - Electrical Hazard**B00H - R0002 - Materials Technology L.S. (63.43 m2)**

No Asbestos

B00H - R0003 - Welding Area (6.34 m2)

No Asbestos

B00H - R0005 - Materials Technology L.S. (61.35 m2)

No Asbestos

B00H - R0006 - Metal Technology Bay (50.97 m2)

Partition Walls (Cubicles)	Compressed AC Sheet 8165/B00H/R0006/Welding bays screen/S5	3m2	Throughout	Some Damage / Unsealed (3)	Low (1)	Low Priority (2-3) Chrysotile (white asbestos)
----------------------------	---	-----	------------	----------------------------	---------	--

B00H - R0008 - Materials Store (38.33 m2)

Ceiling Structures/Linings	Flat AC Sheeting 8165/B00H/R0011/Ceiling Structures/Linings/S46	38.33m2	Throughout	Good Condition (1)	Low (1)	Low Priority (2-3) Chrysotile (white asbestos)
----------------------------	--	---------	------------	--------------------	---------	--

B00H - R0009 - Welding Area (6.35 m2)

No Asbestos

B00H - R0010 - Welding Area (10.12 m2)

No Asbestos

B00H - R0011 - External Movement (29.59 m2)

Ceiling Structures/Linings	Flat AC Sheeting 8165/B00H/R0011/Ceiling Structures/Linings/S46	29.59m2	Throughout	Good Condition (1)	Low (1)	Low Priority (2-3) Chrysotile (white asbestos)
----------------------------	--	---------	------------	--------------------	---------	--

B00H - R9001 - Materials Store (34.95 m2)

No Asbestos

Product	Material Description	Extent	Location Reference	Material Condition	Risk Status	Control Priority
Sample No					Test Result	

B00I - Building Services - 2000 - Timber Shed (Timber Shed)

Exterior

Ceiling Voids	No Asbestos Found
Underfloor Voids	No Asbestos Found

Interior

B00I - R0001 - Maintenance Bulk Store (14.62 m2)

No Asbestos

2017

Product	Material Description	Extent	Location Reference	Material Condition	Risk Status	Control Priority
Sample No					Test Result	

B00J - Staff Facilities - 1950 - Timber (Timber)

Exterior

Underfloor Voids - Packing to Floor Joists	Flat AC Sheeting	60m2	Variable positions	Good Condition (1)	Low (1)	Low Priority (2-3)
	8165/B00K/Underfloor Voids - Packing to Floor Joists/S44				Chrysotile (white asbestos)	
Ceiling Voids	No Asbestos Found					

Interior

B00J - R0001 - Interview/Office - Type 1 (12.7 m2)

No Asbestos

B00J - R0002 - General Assistants (45.38 m2)

No Asbestos

B00J - R0003 - External Movement (4.26 m2)

No Asbestos

2017

Product	Material Description	Extent	Location Reference	Material Condition	Risk Status	Control Priority
Sample No					Test Result	

B00K - Performing Arts - 1951 - Timber (Timber)

Exterior

Underfloor Voids - Packing to Floor Joists	Flat AC Sheeting	80m2	Variable positions	Good Condition (1)	Low (1)	Low Priority (2-3)
	8165/B00K/Underfloor Voids - Packing to Floor Joists/S44				Chrysotile (white asbestos)	
Ceiling Voids - Raked Ceiling	Non Accessible Area					
	- Area inaccessible					

Interior

B00K - R0001 - Performing Arts Changeroom (15.77 m2)

No Asbestos

B00K - R0002 - Performance Workspace (74.64 m2)

No Asbestos

B00K - R0003 - Performing Arts Store (18.25 m2)

No Asbestos

B00K - R0004 - Movement (8.35 m2)

No Asbestos

B00K - R0005 - Covered Area (10.75 m2)

No Asbestos

2017

Product	Material Description	Extent	Location Reference	Material Condition	Risk Status	Control Priority
Sample No					Test Result	

B00L - Physical Education - 1912 - Timber (Timber)

Exterior

Underfloor Voids - Packing to Floor Joists	Flat AC Sheeting	80m2	Variable positions	Good Condition (1)	Low (1)	Low Priority (2-3)
	8165/B00K/Underfloor Voids - Packing to Floor Joists/S44					Chrysotile (white asbestos)
Ceiling Voids - Raked Ceiling	Non Accessible Area - Area inaccessible					

Interior

B00L - R0001 - External Movement (24.23 m2)

No Asbestos

B00L - R0002 - General Learning Space (46.85 m2)

No Asbestos

B00L - R0003 - General Learning Space (46.84 m2)

Electrical Backing Board	Resinous Board	1m2	West	Good Condition (1)	Low (1)	Low Priority (2-3)
	8165/B00L/R0003/Electrical Backing Board/S45					Chrysotile (white asbestos)

2017

Product	Material Description	Extent	Location Reference	Material Condition	Risk Status	Control Priority
	Sample No					Test Result

B00M - Multi Purpose Facilities - 2004 - Brick/Veneer (Brick/Veneer)

Exterior

Ceiling Voids	No Asbestos Found
Underfloor Voids	No Asbestos Found

Interior

B00M - R0001 - Sport Equipment Store (24.74 m2)

No Asbestos

B00M - R0002 - Garden Store Room (25.8 m2)

No Asbestos

B00M - R0003 - Sport Equipment Store (20.21 m2)

No Asbestos

B00M - R0004 - No Access (6.6 m2)

No Asbestos

B00M - R0005 - Cleaning Supplies Store (12.96 m2)

No Asbestos

B00M - R0006 - Gymnasium (483.04 m2)

No Asbestos

B00M - R0007 - Clinic-Waiting (13.56 m2)

No Asbestos

B00M - R0008 - Control Room (12.18 m2)

Vinyl Tiles (Under Floor Covering/Carpet) No Asbestos Found

B00M - R0009 - Chair Store (22.81 m2)

No Asbestos

B00M - R0010 - Shower/Change (22.38 m2)

No Asbestos

B00M - R0011 - Shower/Change (22.38 m2)

No Asbestos

B00M - R0012 - Shower/Change (14.01 m2)

No Asbestos

B00M - R0013 - Shower/Change (22.38 m2)

No Asbestos

B00M - R0014 - Shower/Change (22.38 m2)

No Asbestos

B00M - R0015 - Shower/Change (14.01 m2)

No Asbestos

B00M - R0016 - Toilets - Girls (28.37 m2)

No Asbestos

B00M - R0017 - Toilets - Boys (27.75 m2)

No Asbestos

B00M - R0018 - Disabled Toilet (5.58 m2)

No Asbestos

B00M - R0019 - Staff - Toilet (7.69 m2)

No Asbestos

B00M - R0020 - Plant (2.16 m2)

No Asbestos

B00M - R0021 - Cleaning Store - Distributed (3.04 m2)

No Asbestos

Product	Material Description	Extent	Location Reference	Material Condition	Risk Status	Control Priority
Sample No					Test Result	
B00M - R0022 - Office/Store (13.06 m2)						
No Asbestos						
B00M - R0023 - Student Canteen (57.46 m2)						
No Asbestos						
B00M - R0024 - Distribution Board Cupboard (0.51 m2)				Note: No inspection of live electrical installation.		
No Asbestos						
B00M - R0025 - Distribution Board Cupboard (0.51 m2)				Note: No inspection of live electrical installation.		
No Asbestos						
B00M - R0026 - Plant (1.4 m2)						
No Asbestos						
B00M - R0027 - External Movement (727.83 m2)						
No Asbestos						

2017

Product	Material Description	Extent	Location Reference	Material Condition	Risk Status	Control Priority
Sample No					Test Result	

B00N - Technological & Applied Studies - 2006 - Brick/Veneer (Brick/Veneer)

Exterior

Ceiling Voids	No Asbestos Found
Underfloor Voids - Slab on Ground	Non Accessible Area - Area inaccessible

Interior

B00N - R0001 - Dust Extraction Space (6.95 m2)

No Asbestos

B00N - R0003 - General Learning Space - Type 8 (52.24 m2)

No Asbestos

B00N - R0004 - Materials Workshop - Type 2 (137.04 m2)

No Asbestos

B00N - R0005 - General Learning Space - Type 9 (59.7 m2)

No Asbestos

B00N - R0006 - Distribution Board Cupboard (0.69 m2)

Note: No inspection of live electrical installation.

No Asbestos

B00N - R0007 - L.P.G. Store (1 m2)

No Asbestos

B00N - R0008 - Welding/Hot Metals Area (10.92 m2)

No Asbestos

B00N - R0009 - Project Store - Type 1 (13.53 m2)

No Asbestos

B00N - R0010 - Outdoor Workshop (87.34 m2)

No Asbestos

B00N - R0011 - Distribution Board Cupboard (0.84 m2)

Note: No inspection of live electrical installation.

No Asbestos

B00N - R0012 - Materials Store - Type 2 (39.72 m2)

No Asbestos

B00N - R0013 - Movement (3.56 m2)

No Asbestos

B00N - R0014 - Materials Workshop - Type 2 (136.97 m2)

No Asbestos

B00N - R0015 - General Learning Space - Type 9 (58.25 m2)

No Asbestos

B00N - R0016 - Distribution Board Cupboard (0.72 m2)

Note: No inspection of live electrical installation.

No Asbestos

B00N - R0017 - Dust Extraction Space (7.24 m2)

No Asbestos

B00N - R0018 - Project Store - Type 1 (43.73 m2)

No Asbestos

B00N - R0019 - General Learning Space - Type 8 (52.04 m2)

No Asbestos

B00N - R0020 - Wood Technology Bay (16.17 m2)

No Asbestos

B00N - R0021 - Lift (2.25 m2)

No Asbestos

B00N - R0022 - Wood Technology Bay (16.08 m2)

Product	Material Description	Extent	Location Reference	Material Condition	Risk Status	Control Priority
Sample No					Test Result	
	No Asbestos					
	B00N - R0023 - External Movement (9.35 m2)					
	No Asbestos					
	B00N - R0024 - External Movement (11.97 m2)					
	No Asbestos					
	B00N - R0026 - External Stairs (0.79 m2)					
	No Asbestos					
	B00N - R0027 - External Stairs (5.61 m2)					
	No Asbestos					
	B00N - R0028 - Project Store - Type 1 (32.68 m2)					
	No Asbestos					
	B00N - R0029 - Project Store - Type 1 (10.26 m2)					
	No Asbestos					
	B00N - R0030 - Workshop Area (231.79 m2)					
	No Asbestos					
	B00N - R0031 - External Movement (224.97 m2)					
	No Asbestos					
	B00N - R0032 - External Movement (7.57 m2)					
	No Asbestos					
	B00N - R1001 - Materials Store - Type 1 (13.96 m2)					
	No Asbestos					
	B00N - R1002 - General Learning Space - Type 7 (59.11 m2)					
	No Asbestos					
	B00N - R1003 - Kitchen - Type 2 (108.06 m2)					
	No Asbestos					
	B00N - R1004 - General Learning Space - Type 6 (58.96 m2)					
	No Asbestos					
	B00N - R1005 - Seminar - Type 1 (12.29 m2)					
	No Asbestos					
	B00N - R1006 - Seminar - Type 1 (10.37 m2)					
	No Asbestos					
	B00N - R1007 - Lift (2.25 m2)					
	No Asbestos					
	B00N - R1008 - Cleaning Store - Distributed (3.9 m2)					
	No Asbestos					
	B00N - R1009 - Movement (28.26 m2)					
	No Asbestos					
	B00N - R1010 - Pantry (4.92 m2)					
	No Asbestos					
	B00N - R1011 - Laundry (10.87 m2)					
	No Asbestos					
	B00N - R1012 - Preparation - Materials (31.54 m2)					
	No Asbestos					
	B00N - R1013 - General Learning Space - Type 6 (58.71 m2)					
	No Asbestos					
	B00N - R1014 - Kitchen - Type 1 (99.45 m2)					
	No Asbestos					
	B00N - R1015 - General Learning Space - Type 7 (59.96 m2)					

Product	Material Description	Extent	Location Reference	Material Condition	Risk Status	Control Priority
	Sample No					Test Result

No Asbestos

B00N - R1016 - Materials Store - Type 1 (14.63 m2)

No Asbestos

B00N - R1017 - Materials Store - Type 1 (14.74 m2)

No Asbestos

B00N - R1018 - Distribution Board Cupboard (0.58 m2)

Note: No inspection of live electrical installation.

No Asbestos

B00N - R1019 - Distribution Board Cupboard (0.56 m2)

Note: No inspection of live electrical installation.

No Asbestos

B00N - R1020 - External Movement (123.47 m2)

No Asbestos

B00N - R1021 - External Stairs (5.65 m2)

No Asbestos

B00N - R1022 - External Stairs (11.39 m2)

No Asbestos

2017

Product	Material Description	Extent	Location Reference	Material Condition	Risk Status	Control Priority
Sample No					Test Result	

B000 - Building Services - 2007 - Metal Shed (Metal Shed)

Exterior

Underfloor Voids - Slab on Ground Non Accessible Area
 - Area inaccessible

Ceiling Voids No Asbestos Found

Interior

B000 - R0001 - General Storeroom (45.24 m2)

No Asbestos

2017

Product	Material Description	Extent	Location Reference	Material Condition	Risk Status	Control Priority
Sample No					Test Result	

B00P - Agricultural Science - 2011 - Brick/Veneer (Brick/Veneer)

Exterior

Ceiling Voids	No Asbestos Found
Underfloor Voids - Slab on Ground	No Asbestos Found

Interior

B00P - R0001 - Shed Workshop (32.41 m2)

No Asbestos

2017

Product	Material Description	Extent	Location Reference	Material Condition	Risk Status	Control Priority
Sample No					Test Result	

Demountables

Demountable details as per the AMS records as of 15 Feb 2017.

OS 521 - D13425 - Staff Study : Placement Date - 22/04/2010

Exterior

Step Treads	Compressed AC Sheet	Assumed Asbestos		1.08 m2
Landing	Compressed AC Sheet	Assumed Asbestos		1.2 m2
Eave Lining	Flat AC Sheet	Assumed Asbestos		11.52 m2

Interior

R1 - Staff Room

End wall panel	Flat AC Sheet	Assumed Asbestos		18 m2
Ceiling	Flat AC Sheet	Assumed Asbestos		55 m2

R2 - Staff Toilet

Toilet partitions	Compressed AC Sheet	Assumed Asbestos		6 m2
Ceiling	Flat AC Sheet	Assumed Asbestos		4 m2

R3 - Staff Toilet

Toilet partitions	Compressed AC Sheet	Assumed Asbestos		6 m2
Ceiling	Flat AC Sheet	Assumed Asbestos		4 m2

R4 - Lobby

End wall panel	Flat AC Sheet	Assumed Asbestos		18 m2
Ceiling	Flat AC Sheet	Assumed Asbestos		10 m2

2017

Product	Material Description	Extent	Location Reference	Material Condition	Risk Status	Control Priority
Sample No					Test Result	

Listing of Electronic Attachments as of 22/03/2017

There are no asbestos related file attachment(s) for this school.

2017