

# Asbestos Register

(Hazardous Materials and Risk Assessment)

**School :** Broken Hill High School (8105)  
**Region :** Western NSW  
**State Electorate :** Barwon  
**Local Government Area :** Broken Hill

**Initial Survey :** Noel Arnold & Associates : 13 - May - 2008  
**Reviewed By :** Greencap-NAA : 03 - Mar - 2015

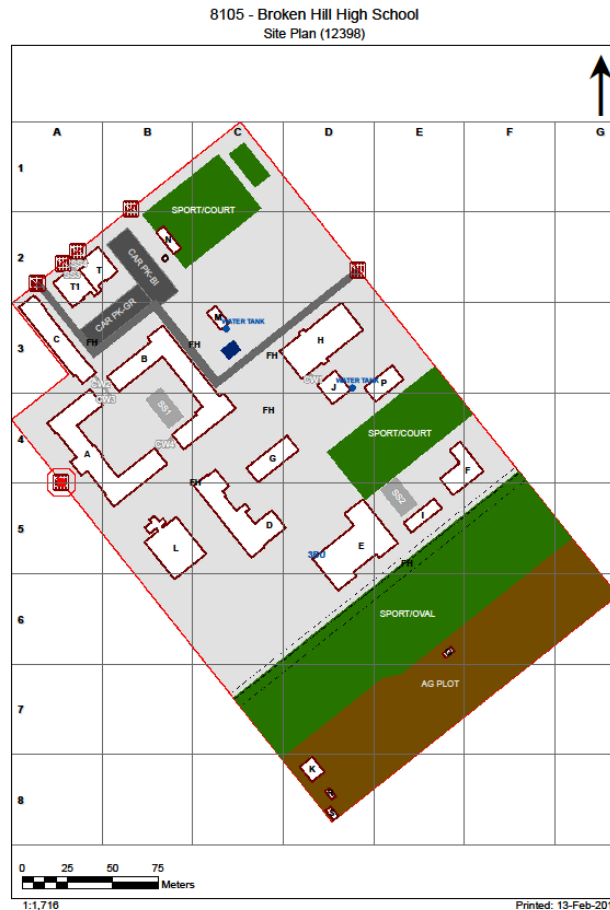

2017

Product	Material Description	Extent	Location Reference	Material Condition	Risk Status	Control Priority
Sample No					Test Result	

**B00A - Administration/General Learning - 1919 - Brick/Block (Brick/Block)**

**Exterior**

Ceiling Voids	Non Accessible Area - Area inaccessible					
Underfloor Voids	No Asbestos Found					
Downpipes	Encapsulated Insulation material within unit 8105/B00A/Downpipes/S20	4m	Throughout	Good Condition (1)	Low (1)	Low Priority (2-3) <b>Chrysotile (white asbestos)</b>

**Interior**

**B00A - R0001 - Senior Study (44.41 m2)**

No Asbestos

**B00A - R0002 - General Learning Space (48.49 m2)**

No Asbestos

**B00A - R0003 - General Learning Space (44.28 m2)**

No Asbestos

**B00A - R0004 - General Learning Space (44.27 m2)**

No Asbestos

**B00A - R0005 - Distribution Board Cupboard (0.41 m2)**

Note: No inspection of live electrical installation.

No Asbestos

**B00A - R0006 - General Learning Space (48.83 m2)**

No Asbestos

**B00A - R0007 - General Learning Space (48.55 m2)**

No Asbestos

**B00A - R0008 - Staff Study (20.31 m2)**

No Asbestos

**B00A - R0009 - Principal Office (23.37 m2)**

No Asbestos

**B00A - R0010 - Movement (3.36 m2)**

No Asbestos

**B00A - R0011 - Administration - Clerical (45.43 m2)**

No Asbestos

**B00A - R0012 - Administration - Clerical (12.09 m2)**

No Asbestos

**B00A - R0013 - Duplicating Workroom (31.18 m2)**

No Asbestos

**B00A - R0014 - Movement (114.91 m2)**

No Asbestos

**B00A - R0015 - Movement (51.55 m2)**

No Asbestos

**B00A - R0016 - Public Entry (42.6 m2)**

No Asbestos

**B00A - R0017 - Staff - Toilet (8.55 m2)**

Partition Walls (Cubicles)	Compressed AC Sheet	1m2	Throughout	Good Condition (1)	Low (1)	Low Priority (2-3) <b>Chrysotile (white asbestos)</b>
8105/B00A/R0017/Partition Walls (Cubicles)/S16						

**B00A - R0018 - Staff - Toilet (9.02 m2)**

Partition Walls (Cubicles)	Compressed AC Sheet	1m2	Throughout	Good Condition (1)	Low (1)	Low Priority (2-3) <b>Chrysotile (white asbestos)</b>
8105/B00A/R0017/Partition Walls (Cubicles)/S16						

Product	Material Description	Extent	Location Reference	Material Condition	Risk Status	Control Priority
Sample No					Test Result	
Incinerator	Encapsulated Insulation material within unit	1Unit(s)	East	Friable Asbestos (5)	Low (1)	Low Priority (2-3)
<b>Assumed Asbestos - Area inaccessible</b>						
<b>B00A - R0019 - Movement (51.87 m2)</b>						
No Asbestos						
<b>B00A - R0020 - Ancillary Staff (22.37 m2)</b>						
Floor Coverings Res/Textile	Vinyl Tiles	21m2	Throughout	Good Condition (1)	Low (1)	Low Priority (2-3)
8105/B00A/R0020/Floor Coverings Res/Textile/S1					<b>Chrysotile (white asbestos)</b>	
<b>B00A - R0021 - Senior Seminar (12.19 m2)</b>						
Floor Coverings Res/Textile	Vinyl Tiles	13m2	Throughout	Good Condition (1)	Low (1)	Low Priority (2-3)
8105/B00A/R0020/Floor Coverings Res/Textile/S1					<b>Chrysotile (white asbestos)</b>	
<b>B00A - R0022 - Interview/Office - Type 1 (12.38 m2)</b>						
Floor Coverings Res/Textile	Vinyl Tiles	13m2	Throughout	Good Condition (1)	Low (1)	Low Priority (2-3)
8105/B00A/R0020/Floor Coverings Res/Textile/S1					<b>Chrysotile (white asbestos)</b>	
<b>B00A - R0023 - General Storeroom (11.69 m2)</b>						
No Asbestos						
<b>B00A - R0024 - Careers Advisers Office (14.78 m2)</b>						
No Asbestos						
<b>B00A - R0025 - Interview/Office - Type 1 (11.57 m2)</b>						
No Asbestos						
<b>B00A - R0026 - Movement (9.85 m2)</b>						
Floor Coverings Res/Textile	Vinyl Tiles	10m2	Throughout	Good Condition (1)	Low (1)	Low Priority (2-3)
8105/B00A/R0020/Floor Coverings Res/Textile/S1					<b>Chrysotile (white asbestos)</b>	
<b>B00A - R0027 - Clinic (15.99 m2)</b>						
Floor Coverings Res/Textile	Vinyl Tiles	16m2	Throughout	Good Condition (1)	Low (1)	Low Priority (2-3)
8105/B00A/R0020/Floor Coverings Res/Textile/S1					<b>Chrysotile (white asbestos)</b>	
Partition Walls (Cubicles)	Compressed AC Sheet	1m2	Throughout	Good Condition (1)	Low (1)	Low Priority (2-3)
<b>Assumed Asbestos - Assumed Asbestos</b>						
<b>B00A - R0028 - Staff - Toilet (3.55 m2)</b>						
Partition Walls (Cubicles)	Compressed AC Sheet	1m2	Throughout	Good Condition (1)	Low (1)	Low Priority (2-3)
<b>Assumed Asbestos - Assumed Asbestos</b>						
Incinerator	Encapsulated Insulation material within unit	1Unit(s)	West	Friable Asbestos (5)	Low (1)	Low Priority (2-3)
<b>Assumed Asbestos - Assumed Asbestos</b>						
<b>B00A - R0029 - Staff Study (13.08 m2)</b>						
No Asbestos						
<b>B00A - R0030 - Duplicating Workroom (8.97 m2)</b>						
Floor Coverings Res/Textile	Vinyl Tiles	9m2	Throughout	Good Condition (1)	Low (1)	Low Priority (2-3)
8105/B00A/R0020/Floor Coverings Res/Textile/S1					<b>Chrysotile (white asbestos)</b>	
<b>B00A - R0031 - Movement (16.65 m2)</b>						
No Asbestos						
<b>B00A - R0032 - Deputy Principal Office (14.99 m2)</b>						
No Asbestos						
<b>B00A - R0033 - Staff Study (12.79 m2)</b>						
No Asbestos						
<b>B00A - R0034 - Cleaning Store - Distributed (2.51 m2)</b>						

Product	Material Description	Extent	Location Reference	Material Condition	Risk Status	Control Priority
Sample No					Test Result	

No Asbestos

**B00A - R0037 - General Storeroom (23.14 m2)**

Floor Coverings Res/Textile	Vinyl Tiles	24m2	Throughout	Good Condition (1)	Low (1)	Low Priority (2-3)
8105/B00A/R0020/Floor Coverings Res/Textile/S1					<b>Chrysotile (white asbestos)</b>	

**B00A - R0038 - Movement (88.26 m2)**

No Asbestos

**B00A - R0039 - Staff Study (21.6 m2)**

No Asbestos

**B00A - Room+1 - Storage under verandah**

Flue	Fibre Cement Pipe	4m	Redundnat, Variable Positions	Good Condition (1)	Low (1)	Low Priority (2-3)
<b>Assumed Asbestos - Height Restriction - Extreme Access</b>						

**B00A - Room+2 - Movement**

Ceiling Structures/Linings	Flat AC Sheeting	16m2	Throughout	Good Condition (1)	Low (1)	Low Priority (2-3)
8105/B00A/Room+2/Ceiling Structures/Linings/S17					<b>Chrysotile (white asbestos) , Amosite (brown asbestos)</b>	

2017

Product	Material Description	Extent	Location Reference	Material Condition	Risk Status	Control Priority
Sample No					Test Result	

**B00B - Music/Performing Arts - 1961 - Brick/Block (Brick/Block)**

**Exterior**

Eaves Linings	Flat AC Sheeting 8105/B00D/Eaves Linings/S29	80m2	North, South, East, West	Good Condition (1)	Low (1)	Low Priority (2-3) <b>Chrysotile (white asbestos) , Amosite (brown asbestos)</b>
Downpipes	Encapsulated Insulation material within unit 8105/B00B/Downpipes/S19	1m	East	Good Condition (1)	Low (1)	Low Priority (2-3) <b>Chrysotile (white asbestos)</b>
Ceiling Voids	Non Accessible Area - Area inaccessible					
Underfloor Voids	No Asbestos Found					

**Interior**

**B00B - R0001 - Music Store (16.42 m2)**

Floor Coverings Res/Textile	Vinyl Tiles 8105/B00B/R0001/Floor Coverings Res/Textile/S5					<b>No Asbestos Detected</b>
-----------------------------	---	--	--	--	--	-----------------------------

**B00B - R0002 - Movement (1.48 m2)**

No Asbestos

**B00B - R0003 - Movement (2.02 m2)**

No Asbestos

**B00B - R0004 - Cleaning Store - Distributed (9.84 m2)**

No Asbestos

**B00B - R0005 - General Storeroom (47.16 m2)**

No Asbestos

**B00B - R0006 - Toilets-Girls (48.44 m2)**

No Asbestos

**B00B - R0007 - Cleaning Store - Distributed (6.96 m2)**

No Asbestos

**B00B - R0008 - General Storeroom (7.71 m2)**

No Asbestos

**B00B - R0009 - Student Canteen (71.21 m2)**

Floor Coverings Res/Textile	Vinyl Tiles 8105/B00B/R0009/Floor Coverings Res/Textile/S6	72m2	Throughout	Good Condition (1)	Low (1)	Low Priority (2-3) <b>Chrysotile (white asbestos)</b>
-----------------------------	---	------	------------	--------------------	---------	--

**B00B - R0010 - Staff - Toilet (7.75 m2)**

No Asbestos

**B00B - R0011 - General Storeroom (17.18 m2)**

No Asbestos

**B00B - R0012 - Toilets-Boys (85.22 m2)**

No Asbestos

**B00B - R0013 - Cleaning Store - Distributed (5.6 m2)**

No Asbestos

**B00B - R0014 - General Storeroom (9.45 m2)**

No Asbestos

**B00B - R0015 - General Storeroom (21.48 m2)**

No Asbestos

**B00B - R0016 - Cleaning Supplies Store (53.41 m2)**

No Asbestos

**B00B - R0018 - Music Learning Space (55.62 m2)**

Product	Material Description	Extent	Location Reference	Material Condition	Risk Status	Control Priority
Sample No					Test Result	
No Asbestos						
<b>B00B - R0019 - Music Learning Space (55.39 m2)</b>						
No Asbestos						
<b>B00B - R0020 - Resources (28.66 m2)</b>						
No Asbestos						
<b>B00B - R0021 - Performance Workspace (108.23 m2)</b>						
No Asbestos						
<b>B00B - R0022 - Movement (22.98 m2)</b>						
No Asbestos						
<b>B00B - R0023 - Movement (429.73 m2)</b>						
No Asbestos						
<b>B00B - R0024 - Movement (7.75 m2)</b>						
No Asbestos						
<b>B00B - R0025 - Stairs (4.64 m2)</b>						
No Asbestos						
<b>B00B - R0026 - Stairs (5.1 m2)</b>						
No Asbestos						
<b>B00B - R1001 - General Storeroom (6.39 m2)</b>						
Ceiling Structures/Linings	Vermiculite					
	8105/B00B/R1021/Ceiling Structures/Linings/S4					Limited Samples Taken
<i>Vermiculite Ceilings may contain asbestos. Asbestos testing MUST be conducted prior to any disturbance works</i>						
<b>B00B - R1002 - Staff - Toilet (8.32 m2)</b>						
Ceiling Structures/Linings	Vermiculite					
	8105/B00B/R1021/Ceiling Structures/Linings/S4					Limited Samples Taken
<i>Vermiculite Ceilings may contain asbestos. Asbestos testing MUST be conducted prior to any disturbance works</i>						
Incinerator	Encapsulated Insulation material within unit	1Unit(s)	West	Friable Asbestos (5)	Low (1)	Low Priority (2-3)
<i>Assumed Asbestos - Area inaccessible</i>						
<b>B00B - R1003 - Movement (1.49 m2)</b>						
No Asbestos						
<b>B00B - R1004 - Staff Study (52.76 m2)</b>						
Floor Coverings Res/Textile	Vinyl Tiles	3m2	South	Good Condition (1)	Low (1)	Low Priority (2-3)
	8105/B00B/R1021/Floor Coverings Res/Textile/S3					Chrysotile (white asbestos)
Ceiling Structures/Linings	Vermiculite					
	8105/B00B/R1021/Ceiling Structures/Linings/S4					Limited Samples Taken
<i>Vermiculite Ceilings may contain asbestos. Asbestos testing MUST be conducted prior to any disturbance works</i>						
<b>B00B - R1005 - General Learning Space (73.04 m2)</b>						
Ceiling Structures/Linings	Vermiculite					
	8105/B00B/R1021/Ceiling Structures/Linings/S4					Limited Samples Taken
<i>Vermiculite Ceilings may contain asbestos. Asbestos testing MUST be conducted prior to any disturbance works</i>						
<b>B00B - R1006 - Design L.S. (71.45 m2)</b>						
Ceiling Structures/Linings	Vermiculite					
	8105/B00B/R1021/Ceiling Structures/Linings/S4					Limited Samples Taken
<i>Vermiculite Ceilings may contain asbestos. Asbestos testing MUST be conducted prior to any disturbance works</i>						
<b>B00B - R1007 - General Storeroom (26.78 m2)</b>						
Floor Coverings Res/Textile	Vinyl Tiles	27m2	Throughout	Good Condition (1)	Low (1)	Low Priority (2-3)
	8105/B00B/R1021/Floor Coverings Res/Textile/S3					Chrysotile (white asbestos)
Ceiling Structures/Linings	Vermiculite					
	8105/B00B/R1021/Ceiling Structures/Linings/S4					Limited Samples Taken
<i>Vermiculite Ceilings may contain asbestos. Asbestos testing MUST be conducted prior to any disturbance works</i>						
<b>B00B - R1008 - Laboratory L.S. (84.31 m2)</b>						

Product	Material Description	Extent	Location Reference	Material Condition	Risk Status	Control Priority
Sample No				Test Result		
Floor Coverings Res/Textile	Vinyl Tiles	85m2	Throughout	Good Condition (1)	Low (1)	Low Priority (2-3)
8105/B00B/R1021/Floor Coverings Res/Textile/S3				<b>Chrysotile (white asbestos)</b>		
Ceiling Structures/Linings	Vermiculite					<b>Limited Samples Taken</b>
8105/B00B/R1021/Ceiling Structures/Linings/S4				<b>Vermiculite Ceilings may contain asbestos. Asbestos testing MUST be conducted prior to any disturbance works</b>		
<b>B00B - R1009 - Apparatus Store (12.58 m2)</b>						
Floor Coverings Res/Textile	Vinyl Tiles	13m2	Throughout	Good Condition (1)	Low (1)	Low Priority (2-3)
8105/B00B/R1021/Floor Coverings Res/Textile/S3				<b>Chrysotile (white asbestos)</b>		
Ceiling Structures/Linings	Vermiculite					<b>Limited Samples Taken</b>
8105/B00B/R1021/Ceiling Structures/Linings/S4				<b>Vermiculite Ceilings may contain asbestos. Asbestos testing MUST be conducted prior to any disturbance works</b>		
<b>B00B - R1010 - Preparation (12.62 m2)</b>						
Floor Coverings Res/Textile	Vinyl Tiles	13m2	Throughout	Good Condition (1)	Low (1)	Low Priority (2-3)
8105/B00B/R1021/Floor Coverings Res/Textile/S3				<b>Chrysotile (white asbestos)</b>		
Ceiling Structures/Linings	Vermiculite					<b>Limited Samples Taken</b>
8105/B00B/R1021/Ceiling Structures/Linings/S4				<b>Vermiculite Ceilings may contain asbestos. Asbestos testing MUST be conducted prior to any disturbance works</b>		
<b>B00B - R1011 - General Learning Space (45.45 m2)</b>						
Ceiling Structures/Linings	Vermiculite					<b>Limited Samples Taken</b>
8105/B00B/R1021/Ceiling Structures/Linings/S4				<b>Vermiculite Ceilings may contain asbestos. Asbestos testing MUST be conducted prior to any disturbance works</b>		
<b>B00B - R1012 - Preparation (25.84 m2)</b>						
Floor Coverings Res/Textile	Vinyl Tiles	26m2	Throughout	Good Condition (1)	Low (1)	Low Priority (2-3)
8105/B00B/R1021/Floor Coverings Res/Textile/S3				<b>Chrysotile (white asbestos)</b>		
Ceiling Structures/Linings	Vermiculite					<b>Limited Samples Taken</b>
8105/B00B/R1021/Ceiling Structures/Linings/S4				<b>Vermiculite Ceilings may contain asbestos. Asbestos testing MUST be conducted prior to any disturbance works</b>		
<b>B00B - R1013 - Laboratory L.S. (84.1 m2)</b>						
Floor Coverings Res/Textile	Vinyl Tiles	84m2	Throughout	Good Condition (1)	Low (1)	Low Priority (2-3)
8105/B00B/R1021/Floor Coverings Res/Textile/S3				<b>Chrysotile (white asbestos)</b>		
Ceiling Structures/Linings	Vermiculite					<b>Limited Samples Taken</b>
8105/B00B/R1021/Ceiling Structures/Linings/S4				<b>Vermiculite Ceilings may contain asbestos. Asbestos testing MUST be conducted prior to any disturbance works</b>		
<b>B00B - R1014 - Staff Study (47.73 m2)</b>						
Floor Coverings Res/Textile	Vinyl Tiles	4m2	East	Good Condition (1)	Low (1)	Low Priority (2-3)
8105/B00B/R1021/Floor Coverings Res/Textile/S3				<b>Chrysotile (white asbestos)</b>		
Ceiling Structures/Linings	Vermiculite					<b>Limited Samples Taken</b>
8105/B00B/R1021/Ceiling Structures/Linings/S4				<b>Vermiculite Ceilings may contain asbestos. Asbestos testing MUST be conducted prior to any disturbance works</b>		
<b>B00B - R1015 - General Storeroom (8.86 m2)</b>						
Floor Coverings Res/Textile	Vinyl Tiles	9m2	Throughout	Good Condition (1)	Low (1)	Low Priority (2-3)
8105/B00B/R1021/Floor Coverings Res/Textile/S3				<b>Chrysotile (white asbestos)</b>		
Ceiling Structures/Linings	Vermiculite					<b>Limited Samples Taken</b>
8105/B00B/R1021/Ceiling Structures/Linings/S4				<b>Vermiculite Ceilings may contain asbestos. Asbestos testing MUST be conducted prior to any disturbance works</b>		
<b>B00B - R1016 - Staff Study (12.43 m2)</b>						
Ceiling Structures/Linings	Vermiculite					<b>Limited Samples Taken</b>
8105/B00B/R1021/Ceiling Structures/Linings/S4				<b>Vermiculite Ceilings may contain asbestos. Asbestos testing MUST be conducted prior to any disturbance works</b>		



Product	Material Description	Extent	Location Reference	Material Condition	Risk Status	Control Priority
Sample No					Test Result	
<b>B00B - R1017 - General Storeroom (8.19 m2)</b>						
Floor Coverings Res/Textile	Vinyl Tiles	9m2	Throughout	Good Condition (1)	Low (1)	Low Priority (2-3)
8105/B00B/R1021/Floor Coverings Res/Textile/S3					<b>Chrysotile (white asbestos)</b>	
Ceiling Structures/Linings	Vermiculite					<b>Limited Samples Taken</b>
8105/B00B/R1021/Ceiling Structures/Linings/S4					<b>Vermiculite Ceilings may contain asbestos. Asbestos testing MUST be conducted prior to any disturbance works</b>	
<b>B00B - R1018 - Staff - Toilet (3.97 m2)</b>						
Ceiling Structures/Linings	Vermiculite					<b>Limited Samples Taken</b>
8105/B00B/R1021/Ceiling Structures/Linings/S4					<b>Vermiculite Ceilings may contain asbestos. Asbestos testing MUST be conducted prior to any disturbance works</b>	
<b>B00B - R1019 - General Storeroom (11.79 m2)</b>						
Floor Coverings Res/Textile	Vinyl Tiles	12m2	Throughout	Good Condition (1)	Low (1)	Low Priority (2-3)
8105/B00B/R1021/Floor Coverings Res/Textile/S3					<b>Chrysotile (white asbestos)</b>	
Ceiling Structures/Linings	Vermiculite					<b>Limited Samples Taken</b>
8105/B00B/R1021/Ceiling Structures/Linings/S4					<b>Vermiculite Ceilings may contain asbestos. Asbestos testing MUST be conducted prior to any disturbance works</b>	
<b>B00B - R1020 - Laboratory L.S. (86.26 m2)</b>						
Floor Coverings Res/Textile	Vinyl Tiles	87m2	Throughout	Good Condition (1)	Low (1)	Low Priority (2-3)
8105/B00B/R1021/Floor Coverings Res/Textile/S3					<b>Chrysotile (white asbestos)</b>	
Ceiling Structures/Linings	Vermiculite					<b>Limited Samples Taken</b>
8105/B00B/R1021/Ceiling Structures/Linings/S4					<b>Vermiculite Ceilings may contain asbestos. Asbestos testing MUST be conducted prior to any disturbance works</b>	
<b>B00B - R1021 - Preparation (28.82 m2)</b>						
Floor Coverings Res/Textile	Vinyl Tiles	29m2	Throughout	Good Condition (1)	Low (1)	Low Priority (2-3)
8105/B00B/R1021/Floor Coverings Res/Textile/S3					<b>Chrysotile (white asbestos)</b>	
Ceiling Structures/Linings	Vermiculite					<b>Limited Samples Taken</b>
8105/B00B/R1021/Ceiling Structures/Linings/S4					<b>Vermiculite Ceilings may contain asbestos. Asbestos testing MUST be conducted prior to any disturbance works</b>	
<b>B00B - R1022 - General Learning Space (68.42 m2)</b>						
Ceiling Structures/Linings	Vermiculite					<b>Limited Samples Taken</b>
8105/B00B/R1021/Ceiling Structures/Linings/S4					<b>Vermiculite Ceilings may contain asbestos. Asbestos testing MUST be conducted prior to any disturbance works</b>	
<b>B00B - R1023 - Movement (285.88 m2)</b>						
Floor Coverings Res/Textile	Vinyl Tiles	286m2	Throughout	Good Condition (1)	Low (1)	Low Priority (2-3)
8105/B00B/R1023/Floor Coverings Res/Textile/S2					<b>Chrysotile (white asbestos)</b>	
Ceiling Structures/Linings	Vermiculite					<b>Limited Samples Taken</b>
8105/B00B/R1021/Ceiling Structures/Linings/S4					<b>Vermiculite Ceilings may contain asbestos. Asbestos testing MUST be conducted prior to any disturbance works</b>	
<b>B00B - R1024 - Stairs (12.44 m2)</b>						
No Asbestos						
<b>B00B - R1025 - Stairs (12.44 m2)</b>						
No Asbestos						
<b>B00B - R2001 - Commonroom (191.19 m2)</b>						
No Asbestos						
<b>B00B - R2002 - General Learning Space (72.93 m2)</b>						
No Asbestos						
<b>B00B - R2003 - General Storeroom (26.89 m2)</b>						
No Asbestos						
<b>B00B - R2004 - General Learning Space (54.15 m2)</b>						



Product	Material Description	Extent	Location Reference	Material Condition	Risk Status	Control Priority
Sample No					Test Result	

No Asbestos

**B00B - R2005 - General Learning Space (53.64 m2)**

No Asbestos

**B00B - R2006 - General Learning Space (53.85 m2)**

No Asbestos

**B00B - R2007 - General Learning Space (53.86 m2)**

No Asbestos

**B00B - R2008 - General Learning Space (54.15 m2)**

No Asbestos

**B00B - R2009 - Staff Study (48.08 m2)**

No Asbestos

**B00B - R2010 - General Storeroom (8.92 m2)**

No Asbestos

**B00B - R2011 - Staff Study (12.6 m2)**

No Asbestos

**B00B - R2012 - Staff Study (8.16 m2)**

No Asbestos

**B00B - R2013 - Staff - Toilet (4.08 m2)**

No Asbestos

**B00B - R2014 - General Storeroom (12.65 m2)**

No Asbestos

**B00B - R2015 - General Learning Space (56.9 m2)**

No Asbestos

**B00B - R2016 - General Learning Space (53.79 m2)**

No Asbestos

**B00B - R2017 - General Learning Space (75.87 m2)**

No Asbestos

**B00B - R2018 - Movement (244.06 m2)**

No Asbestos

**B00B - R2019 - Stairs (12.44 m2)**

No Asbestos

**B00B - R2020 - Stairs (12.44 m2)**

No Asbestos

**B00B - Room+1 - Movement**

Ceiling Structures/Linings	Flat AC Sheeting	16m2	Throughout	Good Condition (1)	Low (1)	Low Priority (2-3)
8105/B00B/Room+1/Ceiling Structures/Linings/S18				Chrysotile (white asbestos) , Amosite (brown asbestos)		

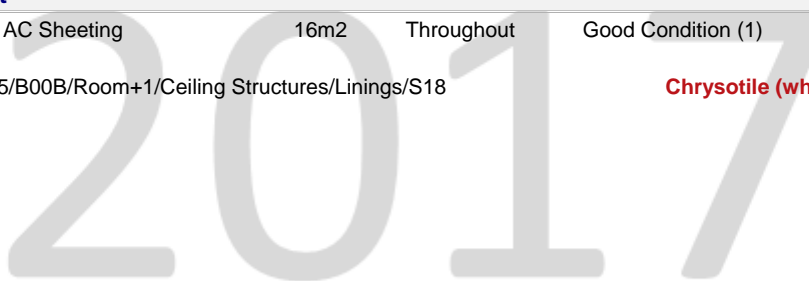

Product	Material Description	Extent	Location Reference	Material Condition	Risk Status	Control Priority
Sample No				Test Result		

**B00C - Technological & Applied Studies - 1957 - Brick/Block (Brick/Block)****Exterior**

Eaves Linings	Flat AC Sheeting 8105/B00D/Eaves Linings/S29	40m2	North, South, East, West	Good Condition (1)	Low (1)	Low Priority (2-3)
				<b>Chrysotile (white asbestos) , Amosite (brown asbestos)</b>		
Ceiling Voids	Non Accessible Area - Height Restriction					
Underfloor Voids	No Asbestos Found					

**Interior****B00C - R0001 - Movement (1.38 m2)**

Ceiling Structures/Linings	Flat AC Sheeting 8105/B00C/R0001/Ceiling Structures/Linings/S22	2m2	Throughout	Good Condition (1)	Low (1)	Low Priority (2-3)
				<b>Chrysotile (white asbestos) , Amosite (brown asbestos)</b>		

**B00C - R0002 - Staff - Toilet (3.86 m2)**

Partition Walls (Cubicles)	Compressed AC Sheet 8105/B00C/R0002/Partition Walls (Cubicles)/S21	1m2	Throughout	Good Condition (1)	Low (1)	Low Priority (2-3)
				<b>Chrysotile (white asbestos)</b>		
Ceiling Structures/Linings	Vermiculite 8105/B00C/R1006/Ceiling Structures/Linings/S8					<b>Limited Samples Taken</b>
				<b>Vermiculite Ceilings may contain asbestos. Asbestos testing MUST be conducted prior to any disturbance works</b>		

**B00C - R0003 - General Assistants (12.44 m2)**

Ceiling Structures/Linings	Vermiculite 8105/B00C/R1006/Ceiling Structures/Linings/S8					<b>Limited Samples Taken</b>
				<b>Vermiculite Ceilings may contain asbestos. Asbestos testing MUST be conducted prior to any disturbance works</b>		
Floor Coverings Res/Textile	Vinyl Tiles 8105/B00A/R0020/Floor Coverings Res/Textile/S1	13m2	Throughout	Good Condition (1)	Low (1)	Low Priority (2-3)
				<b>Chrysotile (white asbestos)</b>		

**B00C - R0004 - Movement (25.92 m2)**

Floor Coverings Res/Textile	Vinyl Tiles 8105/B00C/R1004/Floor Coverings Res/Textile/S7	26m2	Throughout	Good Condition (1)	Low (1)	Low Priority (2-3)
				<b>Chrysotile (white asbestos)</b>		
Ceiling Structures/Linings	Vermiculite 8105/B00C/R1006/Ceiling Structures/Linings/S8					<b>Limited Samples Taken</b>
				<b>Vermiculite Ceilings may contain asbestos. Asbestos testing MUST be conducted prior to any disturbance works</b>		

**B00C - R0005 - Materials Store (19.52 m2)**

Ceiling Structures/Linings	Vermiculite 8105/B00C/R1006/Ceiling Structures/Linings/S8					<b>Limited Samples Taken</b>
				<b>Vermiculite Ceilings may contain asbestos. Asbestos testing MUST be conducted prior to any disturbance works</b>		

**B00C - R0006 - Materials Technology L.S. (90.04 m2)**

Ceiling Structures/Linings	Vermiculite 8105/B00C/R1006/Ceiling Structures/Linings/S8					<b>Limited Samples Taken</b>
				<b>Vermiculite Ceilings may contain asbestos. Asbestos testing MUST be conducted prior to any disturbance works</b>		

**B00C - R0007 - Materials Store (21.7 m2)**

Ceiling Structures/Linings	Vermiculite 8105/B00C/R1006/Ceiling Structures/Linings/S8					<b>Limited Samples Taken</b>
				<b>Vermiculite Ceilings may contain asbestos. Asbestos testing MUST be conducted prior to any disturbance works</b>		

**B00C - R0012 - General Storeroom (2.38 m2)**

No Asbestos

**B00C - R0013 - Cleaning Store - Distributed (9.61 m2)**

No Asbestos

**B00C - R0014 - Movement (2.88 m2)**

No Asbestos

Product	Material Description	Extent	Location Reference	Material Condition	Risk Status	Control Priority
Sample No					Test Result	
<b>B00C - R0015 - Movement (81.47 m2)</b>						
Ceiling Structures/Linings	Vermiculite					
	8105/B00C/R1006/Ceiling Structures/Linings/S8					Limited Samples Taken
<b>Vermiculite Ceilings may contain asbestos. Asbestos testing MUST be conducted prior to any disturbance works</b>						
<b>B00C - R0016 - Stairs (1.18 m2)</b>						
No Asbestos						
<b>B00C - R0017 - Stairs (12.9 m2)</b>						
No Asbestos						
<b>B00C - R0018 - Metal Technology Bay (108.82 m2)</b>						
No Asbestos						
<b>B00C - R0019 - Metal Technology Bay (104.96 m2)</b>						
No Asbestos						
<b>B00C - R1001 - Movement (1.4 m2)</b>						
Ceiling Structures/Linings	Flat AC Sheeting	2m2	Throughout	Good Condition (1)	Low (1)	Low Priority (2-3)
	8105/B00C/R0001/Ceiling Structures/Linings/S22					Chrysotile (white asbestos) , Amosite (brown asbestos)
<b>B00C - R1002 - Staff - Toilet (8.63 m2)</b>						
Partition Walls (Cubicles)	Compressed AC Sheet	3m2	Throughout	Good Condition (1)	Low (1)	Low Priority (2-3)
	8105/B00C/R0002/Partition Walls (Cubicles)/S21					Chrysotile (white asbestos)
Ceiling Structures/Linings	Vermiculite					
	8105/B00C/R1006/Ceiling Structures/Linings/S8					Limited Samples Taken
<b>Vermiculite Ceilings may contain asbestos. Asbestos testing MUST be conducted prior to any disturbance works</b>						
Incinerator	Encapsulated Insulation material within unit	1Unit(s)	North	Friable Asbestos (5)	Low (1)	Low Priority (2-3)
<b>Assumed Asbestos - Area inaccessible</b>						
<b>B00C - R1003 - Staff - Toilet (9.93 m2)</b>						
Partition Walls (Cubicles)	Compressed AC Sheet	2m2	Throughout	Good Condition (1)	Low (1)	Low Priority (2-3)
	8105/B00C/R0002/Partition Walls (Cubicles)/S21					Chrysotile (white asbestos)
Ceiling Structures/Linings	Vermiculite					
	8105/B00C/R1006/Ceiling Structures/Linings/S8					Limited Samples Taken
<b>Vermiculite Ceilings may contain asbestos. Asbestos testing MUST be conducted prior to any disturbance works</b>						
<b>B00C - R1004 - Movement (23.51 m2)</b>						
Floor Coverings Res/Textile	Vinyl Tiles	24m2	Throughout	Good Condition (1)	Low (1)	Low Priority (2-3)
	8105/B00C/R1004/Floor Coverings Res/Textile/S7					Chrysotile (white asbestos)
Ceiling Structures/Linings	Vermiculite					
	8105/B00C/R1006/Ceiling Structures/Linings/S8					Limited Samples Taken
<b>Vermiculite Ceilings may contain asbestos. Asbestos testing MUST be conducted prior to any disturbance works</b>						
<b>B00C - R1005 - Dust Extraction Space (2.2 m2)</b>						
Ceiling Structures/Linings	Vermiculite					
	8105/B00C/R1006/Ceiling Structures/Linings/S8					Limited Samples Taken
<b>Vermiculite Ceilings may contain asbestos. Asbestos testing MUST be conducted prior to any disturbance works</b>						
<b>B00C - R1006 - Materials Store (18 m2)</b>						
Floor Coverings Res/Textile	Vinyl Tiles	18m2	Throughout	Good Condition (1)	Low (1)	Low Priority (2-3)
	8105/B00C/R1004/Floor Coverings Res/Textile/S7					Chrysotile (white asbestos)
Ceiling Structures/Linings	Vermiculite					
	8105/B00C/R1006/Ceiling Structures/Linings/S8					Limited Samples Taken
<b>Vermiculite Ceilings may contain asbestos. Asbestos testing MUST be conducted prior to any disturbance works</b>						
<b>B00C - R1007 - Materials Technology L.S. (84.24 m2)</b>						

Product	Material Description	Extent	Location Reference	Material Condition	Risk Status	Control Priority
Sample No					Test Result	
Ceiling Structures/Linings	Vermiculite 8105/B00C/R1006/Ceiling Structures/Linings/S8					Limited Samples Taken <i>Vermiculite Ceilings may contain asbestos. Asbestos testing MUST be conducted prior to any disturbance works</i>
<b>B00C - R1008 - Wood Technology Bay (14.14 m2)</b>						
Ceiling Structures/Linings	Vermiculite 8105/B00C/R1006/Ceiling Structures/Linings/S8					Limited Samples Taken <i>Vermiculite Ceilings may contain asbestos. Asbestos testing MUST be conducted prior to any disturbance works</i>
<b>B00C - R1009 - Materials Store (14.1 m2)</b>						
Floor Coverings Res/Textile	Vinyl Tiles 8105/B00C/R1004/Floor Coverings Res/Textile/S7	15m2	Throughout	Good Condition (1)	Low (1)	Low Priority (2-3) <i>Chrysotile (white asbestos)</i>
Ceiling Structures/Linings	Vermiculite 8105/B00C/R1006/Ceiling Structures/Linings/S8					Limited Samples Taken <i>Vermiculite Ceilings may contain asbestos. Asbestos testing MUST be conducted prior to any disturbance works</i>
<b>B00C - R1010 - Materials Technology L.S. (85.65 m2)</b>						
Ceiling Structures/Linings	Vermiculite 8105/B00C/R1006/Ceiling Structures/Linings/S8					Limited Samples Taken <i>Vermiculite Ceilings may contain asbestos. Asbestos testing MUST be conducted prior to any disturbance works</i>
<b>B00C - R1011 - General Storeroom (18.52 m2)</b>						
Ceiling Structures/Linings	Vermiculite 8105/B00C/R1006/Ceiling Structures/Linings/S8					Limited Samples Taken <i>Vermiculite Ceilings may contain asbestos. Asbestos testing MUST be conducted prior to any disturbance works</i>
Floor Coverings Res/Textile	Vinyl Tiles 8105/B00A/R0020/Floor Coverings Res/Textile/S1	19m2	Throughout	Good Condition (1)	Low (1)	Low Priority (2-3) <i>Chrysotile (white asbestos)</i>
<b>B00C - R1012 - Staff Study (33.19 m2)</b>						
Ceiling Structures/Linings	Vermiculite 8105/B00C/R1006/Ceiling Structures/Linings/S8					Limited Samples Taken <i>Vermiculite Ceilings may contain asbestos. Asbestos testing MUST be conducted prior to any disturbance works</i>
<b>B00C - R1013 - Duplicating Workroom (22.01 m2)</b>						
Ceiling Structures/Linings	Vermiculite 8105/B00C/R1006/Ceiling Structures/Linings/S8					Limited Samples Taken <i>Vermiculite Ceilings may contain asbestos. Asbestos testing MUST be conducted prior to any disturbance works</i>
Floor Coverings Res/Textile	Vinyl Tiles 8105/B00A/R0020/Floor Coverings Res/Textile/S1	22m2	Throughout	Good Condition (1)	Low (1)	Low Priority (2-3) <i>Chrysotile (white asbestos)</i>
<b>B00C - R1014 - Design L.S. (54.46 m2)</b>						
Ceiling Structures/Linings	Vermiculite 8105/B00C/R1006/Ceiling Structures/Linings/S8					Limited Samples Taken <i>Vermiculite Ceilings may contain asbestos. Asbestos testing MUST be conducted prior to any disturbance works</i>
<b>B00C - R1015 - Computer Store (2.31 m2)</b>						
Ceiling Structures/Linings	Vermiculite 8105/B00C/R1006/Ceiling Structures/Linings/S8					Limited Samples Taken <i>Vermiculite Ceilings may contain asbestos. Asbestos testing MUST be conducted prior to any disturbance works</i>
<b>B00C - R1016 - Movement (85.38 m2)</b>						
Floor Coverings Res/Textile	Vinyl Tiles 8105/B00C/R1004/Floor Coverings Res/Textile/S7	86m2	Throughout	Good Condition (1)	Low (1)	Low Priority (2-3) <i>Chrysotile (white asbestos)</i>
Ceiling Structures/Linings	Vermiculite 8105/B00C/R1006/Ceiling Structures/Linings/S8					Limited Samples Taken <i>Vermiculite Ceilings may contain asbestos. Asbestos testing MUST be conducted prior to any disturbance works</i>
<b>B00C - R1017 - Stairs (12.37 m2)</b>						
Ceiling Structures/Linings	Vermiculite 8105/B00C/R1006/Ceiling Structures/Linings/S8					Limited Samples Taken <i>Vermiculite Ceilings may contain asbestos. Asbestos testing MUST be conducted prior to any disturbance works</i>

Product	Material Description	Extent	Location Reference	Material Condition	Risk Status	Control Priority
Sample No					Test Result	
<b>B00C - R1018 - Stairs (13.81 m2)</b>						
Ceiling Structures/Linings	Vermiculite					
	8105/B00C/R1006/Ceiling Structures/Linings/S8					Limited Samples Taken
<i>Vermiculite Ceilings may contain asbestos. Asbestos testing MUST be conducted prior to any disturbance works</i>						
<b>B00C - R9001 - Movement (1.36 m2)</b>						
No Asbestos						
<b>B00C - R9002 - Movement (25 m2)</b>						
No Asbestos						
<b>B00C - R9003 - Cleaning Supplies Store (6.07 m2)</b>						
No Asbestos						
<b>B00C - R9004 - Garden Store Room (11.04 m2)</b>						
Floor Coverings Res/Textile	Vinyl Tiles	12m2	Throughout	Good Condition (1)	Low (1)	Low Priority (2-3)
	8105/B00A/R0020/Floor Coverings Res/Textile/S1					Chrysotile (white asbestos)
<b>B00C - R9005 - General Storeroom (2.85 m2)</b>						
No Asbestos						
<b>B00C - R9006 - Cleaning Supplies Store (19.05 m2)</b>						
No Asbestos						
<b>B00C - R9007 - General Storeroom (89.7 m2)</b>						
No Asbestos						
<b>B00C - R9008 - General Storeroom (32.85 m2)</b>						
No Asbestos						
<b>B00C - R9009 - Stairs (0.94 m2)</b>						
No Asbestos						

2017

Product	Material Description	Extent	Location Reference	Material Condition	Risk Status	Control Priority
Sample No					Test Result	

**B00D - Technological & Applied Studies - 1968 - Brick/Block (Brick/Block)**

**Exterior**

Eaves Linings	Flat AC Sheeting 8105/B00D/Eaves Linings/S29	40m2	North, South, East, West	Good Condition (1)	Low (1)	Low Priority (2-3)
Ceiling Voids	Non Accessible Area - Height Restriction					
Underfloor Voids	No Asbestos Found					

Chrysotile (white asbestos) , Amosite (brown asbestos)

**Interior**

**B00D - R0008 - Special Learning Space (31.43 m2)**

No Asbestos

**B00D - R0009 - Practical Activity Area (34.44 m2)**

No Asbestos

**B00D - R0013 - Movement (6.46 m2)**

No Asbestos

**B00D - R0014 - Movement (9.19 m2)**

No Asbestos

**B00D - R0020 - Study Space (26.8 m2)**

No Asbestos

**B00D - R0023 - Distribution Board Cupboard (0.38 m2)**

Note: No inspection of live electrical installation.

No Asbestos

**B00D - R0024 - Movement (1.1 m2)**

No Asbestos

**B00D - R0025 - Staff - Toilet (1.31 m2)**

No Asbestos

**B00D - R0026 - Staff Study (10.57 m2)**

No Asbestos

**B00D - R0028 - Movement (3.6 m2)**

No Asbestos

**B00D - R0029 - Toilets-Disabled (6.15 m2)**

No Asbestos

**B00D - R0030 - Toilets-Disabled (9.41 m2)**

No Asbestos

**B00D - R0031 - Movement (7.35 m2)**

No Asbestos

**B00D - R0032 - Toilets-Disabled (21.51 m2)**

No Asbestos

**B00D - R0033 - Entry (17.91 m2)**

No Asbestos

**B00D - R0034 - Practical Activities - M - 1hb (34.2 m2)**

No Asbestos

**B00D - R0035 - General Storeroom (6.45 m2)**

No Asbestos

**B00D - R0036 - General Learning Space (56.52 m2)**

No Asbestos

**B00D - R0037 - Staff Study (8.19 m2)**

No Asbestos

**B00D - R0038 - Laundry (11.6 m2)**

Product	Material Description	Extent	Location Reference	Material Condition	Risk Status	Control Priority
Sample No						Test Result
No Asbestos						
<b>B00D - R0039 - Movement (12.06 m2)</b>						
No Asbestos						
<b>B00D - R0040 - General Storeroom (15.04 m2)</b>						
No Asbestos						
<b>B00D - R0042 - Movement (104.71 m2)</b>						
No Asbestos						
<b>B00D - R0043 - Staff Study (26.62 m2)</b>						
No Asbestos						
<b>B00D - R0044 - Cleaning Store - Distributed (5.45 m2)</b>						
No Asbestos						
<b>B00D - R0046 - Food Technology L.S. (63.55 m2)</b>						
No Asbestos						
<b>B00D - R0047 - Stairs (2.52 m2)</b>						
No Asbestos						
<b>B00D - R0048 - Movement (2.32 m2)</b>						
No Asbestos						
<b>B00D - R0049 - Stairs (3.41 m2)</b>						
No Asbestos						
<b>B00D - R0050 - General Learning Space (37.47 m2)</b>						
No Asbestos						
<b>B00D - R0051 - Kitchen - Type 1 (83.17 m2)</b>						
No Asbestos						
<b>B00D - R0052 - Food/Research Space (18.96 m2)</b>						
No Asbestos						
<b>B00D - R0053 - Pantry (11.32 m2)</b>						
No Asbestos						
<b>B00D - R1001 - Cleaning Store - Distributed (4.94 m2)</b>						
Ceiling Structures/Linings	Flat AC Sheeting	5m2	Throughout	Good Condition (1)	Low (1)	Low Priority (2-3)
8105/B00D/R1002/Ceiling Structures/Linings/S28				<b>Chrysotile (white asbestos) , Amosite (brown asbestos)</b>		
<b>B00D - R1002 - Materials Store (8.07 m2)</b>						
Ceiling Structures/Linings	Flat AC Sheeting	9m2	Throughout	Good Condition (1)	Low (1)	Low Priority (2-3)
8105/B00D/R1002/Ceiling Structures/Linings/S28				<b>Chrysotile (white asbestos) , Amosite (brown asbestos)</b>		
<b>B00D - R1003 - Shower/Change (8.97 m2)</b>						
No Asbestos						
<b>B00D - R1004 - Materials Technology L.S. (67.15 m2)</b>						
No Asbestos						
<b>B00D - R1005 - Movement (3.82 m2)</b>						
Ceiling Structures/Linings	Flat AC Sheeting	4m2	Throughout	Good Condition (1)	Low (1)	Low Priority (2-3)
8105/B00D/Eaves Linings/S29				<b>Chrysotile (white asbestos) , Amosite (brown asbestos)</b>		
<b>B00D - R1006 - General Learning Space (67.14 m2)</b>						
No Asbestos						
<b>B00D - R1007 - General Storeroom (4.12 m2)</b>						



Product	Material Description	Extent	Location Reference	Material Condition	Risk Status	Control Priority
Sample No					Test Result	
Ceiling Structures/Linings	Flat AC Sheeting	5m2	Throughout	Good Condition (1)	Low (1)	Low Priority (2-3)
8105/B00D/R1002/Ceiling Structures/Linings/S28				<b>Chrysotile (white asbestos) , Amosite (brown asbestos)</b>		
<b>B00D - R1008 - Movement (3.14 m2)</b>						
No Asbestos						
<b>B00D - R1009 - General Storeroom (8.18 m2)</b>						
No Asbestos						
<b>B00D - R1010 - General Learning Space (46.16 m2)</b>						
No Asbestos						
<b>B00D - R1011 - Movement (87.22 m2)</b>						
No Asbestos						
<b>B00D - R1012 - General Storeroom (6.52 m2)</b>						
No Asbestos						
<b>B00D - R1013 - General Storeroom (7.13 m2)</b>						
Floor Coverings Res/Textile	Vinyl Tiles	8m2	South	Good Condition (1)	Low (1)	Low Priority (2-3)
8105/B00B/R1021/Floor Coverings Res/Textile/S3				<b>Chrysotile (white asbestos)</b>		
Ceiling Structures/Linings	Flat AC Sheeting	8m2	Throughout	Good Condition (1)	Low (1)	Low Priority (2-3)
8105/B00D/R1002/Ceiling Structures/Linings/S28				<b>Chrysotile (white asbestos) , Amosite (brown asbestos)</b>		
<b>B00D - R1014 - Stairs (14.1 m2)</b>						
Ceiling Structures/Linings	Flat AC Sheeting	15m2	Throughout	Good Condition (1)	Low (1)	Low Priority (2-3)
8105/B00D/Eaves Linings/S29				<b>Chrysotile (white asbestos) , Amosite (brown asbestos)</b>		
<b>B00D - R1015 - Stairs (11.99 m2)</b>						
No Asbestos						

2017

Product	Material Description	Extent	Location Reference	Material Condition	Risk Status	Control Priority
Sample No					Test Result	

**B00E - Music/General Learning - 1907 - Brick/Veneer (Brick/Veneer)**

**Exterior**

Ceiling Voids	Non Accessible Area - Area inaccessible
Underfloor Voids	No Asbestos Found

**Interior**

**B00E - R0001 - Movement (61.27 m2)**

No Asbestos

**B00E - R0002 - Sport Equipment Store (15.08 m2)**

No Asbestos

**B00E - R0003 - Cleaning Store - Distributed (6.92 m2)**

No Asbestos

**B00E - R0004 - General Storeroom (6.94 m2)**

No Asbestos

**B00E - R0005 - Movement (7.49 m2)**

No Asbestos

**B00E - R0006 - General Learning Space (52.3 m2)**

No Asbestos

**B00E - R0007 - General Learning Space (52.17 m2)**

No Asbestos

**B00E - R0008 - General Learning Space (52.97 m2)**

No Asbestos

**B00E - R0009 - Movement (25.44 m2)**

No Asbestos

**B00E - R0010 - Movement (56.36 m2)**

No Asbestos

**B00E - R0011 - General Learning Space (51.58 m2)**

No Asbestos

**B00E - R0012 - General Learning Space (51.65 m2)**

No Asbestos

**B00E - R0013 - Movement (35.37 m2)**

No Asbestos

**B00E - R0014 - Study Space (23.5 m2)**

Floor Coverings Res/Textile	Vinyl Tiles	2m2	Throughout	Good Condition (1)	Low (1)	Low Priority (2-3)
	8105/B00G/R1005/Floor Coverings Res/Textile/S10				<b>Chrysotile (white asbestos)</b>	
Floor Coverings Res/Textile	Vinyl Tiles	2m2	Throughout	Good Condition (1)	Low (1)	Low Priority (2-3)
	8105/B00A/R0020/Floor Coverings Res/Textile/S1				<b>Chrysotile (white asbestos)</b>	

**B00E - R0015 - Staff Study (51.69 m2)**

No Asbestos

**B00E - R0016 - General Storeroom (23.82 m2)**

No Asbestos

**B00E - R0017 - Movement (43.94 m2)**

No Asbestos

**B00E - R0018 - Movement (49.61 m2)**

Floor Coverings Res/Textile	Vinyl Tiles	6m2	Throughout	Good Condition (1)	Low (1)	Low Priority (2-3)
	8105/B00A/R0020/Floor Coverings Res/Textile/S1				<b>Chrysotile (white asbestos)</b>	

**B00E - R0019 - Movement (5.63 m2)**

Product	Material Description	Extent	Location Reference	Material Condition	Risk Status	Control Priority
Sample No					Test Result	

No Asbestos

**B00E - R0020 - General Storeroom (15.28 m2)**

Floor Coverings Res/Textile	Vinyl Tiles	16m2	Throughout	Good Condition (1)	Low (1)	Low Priority (2-3)
-----------------------------	-------------	------	------------	--------------------	---------	--------------------

8105/B00A/R0020/Floor Coverings Res/Textile/S1

**Chrysotile (white asbestos)**

**B00E - R0021 - General Learning Space (51.81 m2)**

No Asbestos

**B00E - R0022 - General Learning Space (69.69 m2)**

No Asbestos

**B00E - R0023 - Covered Area (52.15 m2)**

No Asbestos

2017

Product	Material Description	Extent	Location Reference	Material Condition	Risk Status	Control Priority
Sample No					Test Result	

**B00F - Physical Education - 1900 - Brick/Block (Brick/Block)****Exterior**

Ceiling Voids	Non Accessible Area - Extreme Access Issue - Height Restricted - Approx >10m
Ceiling Voids	Non Accessible Area - Height Restriction - Extreme Access Issue - Height Restricted - Approx >10m
Underfloor Voids	No Asbestos Found

**Interior****B00F - R0001 - Gymnasium (123.69 m2)**

No Asbestos

**B00F - R0002 - External Movement (74.13 m2)**

No Asbestos

**B00F - R0003 - Movement (18.94 m2)**

Floor Coverings Res/Textile	Vinyl Tiles	19m2	Throughout	Good Condition (1)	Low (1)	Low Priority (2-3)
8105/B00G/R1005/Floor Coverings Res/Textile/S10					<b>Chrysotile (white asbestos)</b>	

**B00F - R0004 - Cleaning Store - Distributed (3.24 m2)**

No Asbestos

**B00F - R0005 - Staff Study (53.52 m2)**

Floor Coverings Res/Textile	Vinyl Tiles	54m2	Throughout	Good Condition (1)	Low (1)	Low Priority (2-3)
8105/B00A/R0020/Floor Coverings Res/Textile/S1					<b>Chrysotile (white asbestos)</b>	

**B00F - R0006 - Stairs (3.24 m2)**

No Asbestos

**B00F - R1001 - General Learning Space (63.27 m2)**

No Asbestos

**B00F - R1002 - General Learning Space (61.39 m2)**

No Asbestos

**B00F - R1003 - Movement (72.54 m2)**

Wall Linings Internal	Flat AC Sheeting	3m2	South, Upper portion	Good Condition (1)	Low (1)	Low Priority (2-3)
<b>Assumed Asbestos - Height Restriction - Extreme Access</b>						

**B00F - R1004 - Movement (8.94 m2)**

No Asbestos

**B00F - R1005 - General Learning Space (53.91 m2)**

No Asbestos

**B00F - R1006 - Stairs (16.79 m2)**

No Asbestos

Product	Material Description	Extent	Location Reference	Material Condition	Risk Status	Control Priority
Sample No					Test Result	

**B00G - Art - 1909 - Brick/Block (Brick/Block)****Exterior**

Eaves Linings	Flat AC Sheeting 8105/B00G/Eaves Linings/S31	100m2	North, South, East, West	Good Condition (1)	Low (1)	Low Priority (2-3)
					<b>Chrysotile (white asbestos) , Amosite (brown asbestos) , Crocidolite (blue asbestos)</b>	
In-fill-panel	Flat AC Sheeting 8105/B00G/In-fill-panel/S32					<b>No Asbestos Detected</b>
Ceiling Voids	Non Accessible Area - Height Restriction					
Underfloor Voids	No Asbestos Found					

**Interior****B00G - R0001 - General Storeroom (4.52 m2)**

No Asbestos

**B00G - R0002 - Distribution Board Cupboard (0.47 m2)**

Note: No inspection of live electrical installation.

Floor Coverings Res/Textile	Vinyl Tiles 8105/B00G/R0002/Floor Coverings Res/Textile/S9	1m2	Throughout	Good Condition (1)	Low (1)	Low Priority (2-3)
						<b>Chrysotile (white asbestos)</b>

**B00G - R0003 - Darkroom Space (15.49 m2)**

Floor Coverings Res/Textile	Vinyl Tiles 8105/B00G/R0002/Floor Coverings Res/Textile/S9	16m2	Throughout	Good Condition (1)	Low (1)	Low Priority (2-3)
						<b>Chrysotile (white asbestos)</b>

**B00G - R0004 - General Storeroom (6.16 m2)**

No Asbestos

**B00G - R0005 - Resources Store (6.38 m2)**

No Asbestos

**B00G - R0006 - Workshop (6.45 m2)**

No Asbestos

**B00G - R0007 - Art Learning Space (66.38 m2)**

No Asbestos

**B00G - R0008 - Resources Store (6.27 m2)**

No Asbestos

**B00G - R0009 - General Storeroom (9.39 m2)**

Wall Linings Internal	Flat AC Sheeting 8105/B00G/R0009/Wall Linings Internal/S26					<b>No Asbestos Detected</b>
-----------------------	---	--	--	--	--	-----------------------------

Ceiling Structures/Linings	Flat AC Sheeting <b>Assumed Asbestos - Height Restriction</b>	2m2	South	Good Condition (1)	Low (1)	Low Priority (2-3)
----------------------------	--	-----	-------	--------------------	---------	--------------------

**B00G - R0010 - Staff Study (63.1 m2)**

No Asbestos

**B00G - R0011 - Movement (53.14 m2)**

Floor Coverings Res/Textile	Vinyl Tiles 8105/B00G/R0002/Floor Coverings Res/Textile/S9	10m2	East	Good Condition (1)	Low (1)	Low Priority (2-3)
						<b>Chrysotile (white asbestos)</b>

**B00G - R0012 - Movement (1.7 m2)**

No Asbestos

**B00G - R0013 - Stairs (6.16 m2)**

No Asbestos

**B00G - R1001 - Staff - Toilet (7.47 m2)**

Incinerator	Encapsulated Insulation material within unit <b>Assumed Asbestos - Area inaccessible</b>	1Unit(s)	North	Friable Asbestos (5)	Low (1)	Low Priority (2-3)
-------------	--	----------	-------	----------------------	---------	--------------------

Product	Material Description	Extent	Location Reference	Material Condition	Risk Status	Control Priority
Sample No					Test Result	
<b>B00G - R1002 - General Storeroom (0.41 m2)</b>						
Floor Coverings Res/Textile	Vinyl Tiles	1m2	Throughout	Good Condition (1)	Low (1)	Low Priority (2-3)
8105/B00G/R0002/Floor Coverings Res/Textile/S9					<b>Chrysotile (white asbestos)</b>	
<b>B00G - R1003 - Resources Store (14.11 m2)</b>						
Ceiling Structures/Linings	Flat AC Sheeting	15m2	Throughout	Good Condition (1)	Low (1)	Low Priority (2-3)
8105/B00G/R1003/Ceiling Structures/Linings/S33					<b>Chrysotile (white asbestos) , Amosite (brown asbestos)</b>	
<b>B00G - R1004 - Movement (14.28 m2)</b>						
Floor Coverings Res/Textile	Vinyl Tiles	15m2	Throughout	Good Condition (1)	Low (1)	Low Priority (2-3)
8105/B00G/R0002/Floor Coverings Res/Textile/S9					<b>Chrysotile (white asbestos)</b>	
<b>B00G - R1005 - Art Learning Space (76.3 m2)</b>						
Floor Coverings Res/Textile	Vinyl Tiles	75m2	Throughout	Good Condition (1)	Low (1)	Low Priority (2-3)
8105/B00G/R1005/Floor Coverings Res/Textile/S10					<b>Chrysotile (white asbestos)</b>	
<b>B00G - R1006 - Workshop (46.7 m2)</b>						
No Asbestos						
<b>B00G - R1007 - Kiln Space (8.71 m2)</b>						
No Asbestos						
<b>B00G - R1008 - Art Learning Space (75.83 m2)</b>						
Floor Coverings Res/Textile	Vinyl Tiles	76m2	Throughout	Good Condition (1)	Low (1)	Low Priority (2-3)
8105/B00G/R1005/Floor Coverings Res/Textile/S10					<b>Chrysotile (white asbestos)</b>	
<b>B00G - R1009 - Stairs (12.72 m2)</b>						
No Asbestos						

2017

Product	Material Description	Extent	Location Reference	Material Condition	Risk Status	Control Priority
Sample No					Test Result	

**B00H - Multi Purpose Facilities - 1964 - Brick/Block (Brick/Block)**

**Exterior**

Ceiling Voids	Non Accessible Area - Extreme Access Issue - Height Restricted - Approx >10m					
Ceiling Voids	Non Accessible Area - Height Restriction - Extreme Access Issue - Height Restricted - Approx >10m					
Underfloor Voids	No Asbestos Found					

**Interior**

**B00H - M0001 - Movement (134.11 m2)**

No Asbestos

**B00H - M0002 - Control Room (17.39 m2)**

Electrical Backing Board	Resinous Board	2m2	North	Good Condition (1)	Low (1)	Low Priority (2-3)
8105/B00H/M0002/Electrical Backing Board/S34					<b>Chrysotile (white asbestos)</b>	

**B00H - R0001 - Toilets-Girls (4.6 m2)**

Ceiling Structures/Linings	Vermiculite					
8105/B00H/R0006/Ceiling Structures/Linings/S14					<b>Limited Samples Taken</b>	
<b>Vermiculite Ceilings may contain asbestos. Asbestos testing MUST be conducted prior to any disturbance works</b>						

**B00H - R0002 - Movement (5.43 m2)**

Ceiling Structures/Linings	Vermiculite					
8105/B00H/R0006/Ceiling Structures/Linings/S14					<b>Limited Samples Taken</b>	
<b>Vermiculite Ceilings may contain asbestos. Asbestos testing MUST be conducted prior to any disturbance works</b>						

**B00H - R0003 - Chair Store (16.74 m2)**

Ceiling Structures/Linings	Vermiculite					
8105/B00H/R0006/Ceiling Structures/Linings/S14					<b>Limited Samples Taken</b>	
<b>Vermiculite Ceilings may contain asbestos. Asbestos testing MUST be conducted prior to any disturbance works</b>						

**B00H - R0004 - Movement (54.72 m2)**

Ceiling Structures/Linings	Vermiculite					
8105/B00H/R0006/Ceiling Structures/Linings/S14					<b>Limited Samples Taken</b>	
<b>Vermiculite Ceilings may contain asbestos. Asbestos testing MUST be conducted prior to any disturbance works</b>						

**B00H - R0005 - Chair Store (16.85 m2)**

Ceiling Structures/Linings	Vermiculite					
8105/B00H/R0006/Ceiling Structures/Linings/S14					<b>Limited Samples Taken</b>	
<b>Vermiculite Ceilings may contain asbestos. Asbestos testing MUST be conducted prior to any disturbance works</b>						

Floor Coverings Res/Textile	Vinyl Tiles	17m2	Throughout	Good Condition (1)	Low (1)	Low Priority (2-3)
8105/B00H/R0005/Floor Coverings Res/Textile/S15					<b>Chrysotile (white asbestos)</b>	

**B00H - R0006 - Movement (5.36 m2)**

Ceiling Structures/Linings	Vermiculite					
8105/B00H/R0006/Ceiling Structures/Linings/S14					<b>Limited Samples Taken</b>	
<b>Vermiculite Ceilings may contain asbestos. Asbestos testing MUST be conducted prior to any disturbance works</b>						

**B00H - R0007 - Toilets-Boys (4.62 m2)**

Ceiling Structures/Linings	Vermiculite					
8105/B00H/R0006/Ceiling Structures/Linings/S14					<b>Limited Samples Taken</b>	
<b>Vermiculite Ceilings may contain asbestos. Asbestos testing MUST be conducted prior to any disturbance works</b>						

**B00H - R0008 - Multi-Purpose Space (393.35 m2)**

No Asbestos

**B00H - R0009 - Stage (135.55 m2)**

No Asbestos

**B00H - R0010 - Movement (7.77 m2)**

No Asbestos

**B00H - R0011 - General Storeroom (6.38 m2)**



Product	Material Description	Extent	Location Reference	Material Condition	Risk Status	Control Priority
Sample No					Test Result	

No Asbestos

**B00H - R0012 - Shower/Change (32.61 m2)**

No Asbestos

**B00H - R0013 - No Access (19.55 m2)**

No Asbestos

**B00H - R0014 - Shower/Change (31.6 m2)**

Incinerator	Encapsulated Insulation material within unit	1Unit(s)	West	Friable Asbestos (5)	Low (1)	Low Priority (2-3)
<b>Assumed Asbestos - Area inaccessible</b>						

**B00H - R0015 - Cleaning Store - Distributed (6.37 m2)**

No Asbestos

**B00H - R0016 - Movement (7.72 m2)**

No Asbestos

**B00H - R0017 - Movement (5.06 m2)**

Ceiling Structures/Linings	Flat AC Sheeting	6m2	Throughout	Good Condition (1)	Low (1)	Low Priority (2-3)
8105/B00H/R0017/Ceiling Structures/Linings/S24						<b>Chrysotile (white asbestos)</b>

**B00H - R0018 - Movement (5.12 m2)**

Ceiling Structures/Linings	Flat AC Sheeting	6m2	Throughout	Good Condition (1)	Low (1)	Low Priority (2-3)
8105/B00H/R0017/Ceiling Structures/Linings/S24						<b>Chrysotile (white asbestos)</b>

2017

Product	Material Description	Extent	Location Reference	Material Condition	Risk Status	Control Priority
Sample No					Test Result	

**B001 - Pupil Facilities - 1961 - Brick/Block (Brick/Block)**

**Exterior**

Eaves Linings	Flat AC Sheeting 8105/B001/Eaves Linings/S35	40m2	North, South, East, West	Good Condition (1)	Low (1)	Low Priority (2-3)
					<b>Chrysotile (white asbestos) , Amosite (brown asbestos) , Crocidolite (blue asbestos)</b>	
In-fill-panel	Flat AC Sheeting	1m2	East, West	Good Condition (1)	Low (1)	Low Priority (2-3)
	<b>Assumed Asbestos - Area inaccessible</b>					
Ceiling Voids	Non Accessible Area - Area inaccessible					
Underfloor Voids	No Asbestos Found					

**Interior**

**B001 - R0005 - Toilets - Boys (8.48 m2)**

Ceiling Structures/Linings	Flat AC Sheeting 8105/B001/R0005/Ceiling Structures/Linings/S27					<b>No Asbestos Detected</b>
----------------------------	--	--	--	--	--	-----------------------------

**B001 - R0006 - Shower/Change (47.08 m2)**

Ceiling Structures/Linings	Flat AC Sheeting 8105/B001/R0005/Ceiling Structures/Linings/S27					<b>No Asbestos Detected</b>
----------------------------	--	--	--	--	--	-----------------------------

**B001 - R0007 - Office/Store (12.65 m2)**

Ceiling Structures/Linings	Flat AC Sheeting 8105/B001/R0005/Ceiling Structures/Linings/S27					<b>No Asbestos Detected</b>
----------------------------	--	--	--	--	--	-----------------------------

**B001 - R0008 - Shower/Change (47.93 m2)**

Ceiling Structures/Linings	Flat AC Sheeting 8105/B001/R0005/Ceiling Structures/Linings/S27					<b>No Asbestos Detected</b>
----------------------------	--	--	--	--	--	-----------------------------

**B001 - R0009 - Toilets - Girls (8.6 m2)**

Ceiling Structures/Linings	Flat AC Sheeting 8105/B001/R0005/Ceiling Structures/Linings/S27					<b>No Asbestos Detected</b>
----------------------------	--	--	--	--	--	-----------------------------

Partition Walls (Cubicles)	Compressed AC Sheet 8105/B001/R0009/Partition Walls (Cubicles)/S25	3m2	Throughout	Good Condition (1)	Low (1)	Low Priority (2-3)
					<b>Chrysotile (white asbestos)</b>	

2017

Product	Material Description	Extent	Location Reference	Material Condition	Risk Status	Control Priority
Sample No					Test Result	

**B00J - Computer Learning - 2010 - Brick/Veneer (Brick/Veneer)**

**Exterior**

Ceiling Voids	No Asbestos Found
Underfloor Voids	No Asbestos Found

**Interior**

**B00J - R0001 - Computer Learning Space (92.08 m2)**

No Asbestos

**B00J - R0002 - Seminar - Type 2 (19.1 m2)**

No Asbestos

**B00J - R0003 - Resources Store (10.02 m2)**

No Asbestos

**B00J - R0004 - Computer Store (9.01 m2)**

No Asbestos

**B00J - R0005 - External Movement (29.12 m2)**

No Asbestos

2017

Product	Material Description	Extent	Location Reference	Material Condition	Risk Status	Control Priority
Sample No					Test Result	

**B00K - Agricultural Science - 1980 - Brick/Block (Brick/Block)**

**Exterior**

Ceiling Voids	Non Accessible Area - Area inaccessible
Underfloor Voids	No Asbestos Found

**Interior**

**B00K - R0002 - General Storeroom (8.83 m2)**

No Asbestos

**B00K - R0003 - General Storeroom (9.04 m2)**

No Asbestos

**B00K - R0004 - Machine Storage (35.65 m2)**

No Asbestos

**B00K - R0005 - Movement (22.72 m2)**

No Asbestos

**B00K - R0006 - Plant Growing Space (13.52 m2)**

No Asbestos

2017

Product	Material Description	Extent	Location Reference	Material Condition	Risk Status	Control Priority
Sample No					Test Result	

**B00L - Library/Science Learning - 1961 - Brick/Block (Brick/Block)**

**Exterior**

Ceiling Voids	Non Accessible Area - Height Restriction
Underfloor Voids	No Asbestos Found

**Interior**

**B00L - M1001 - General Storeroom (15.88 m2)**

No Asbestos

**B00L - M1002 - Workroom (67.9 m2)**

No Asbestos

**B00L - M1003 - Workroom (38.02 m2)**

No Asbestos

**B00L - M1004 - Plant (3.96 m2)**

No Asbestos

**B00L - M1005 - Stairs (3.62 m2)**

No Asbestos

**B00L - M1006 - Stairs (3.35 m2)**

No Asbestos

**B00L - R0001 - Laboratory L.S. (91.49 m2)**

Ceiling Structures/Linings	Vermiculite 8105/B00L/R0005/Ceiling Structures/Linings/S11					Limited Samples Taken
<b>Vermiculite Ceilings may contain asbestos. Asbestos testing MUST be conducted prior to any disturbance works</b>						

**B00L - R0002 - Apparatus Store (17.1 m2)**

Floor Coverings Res/Textile	Vinyl Tiles	18m2	Throughout	Good Condition (1)	Low (1)	Low Priority (2-3)
8105/B00L/R0005/Floor Coverings Res/Textile/S12		<b>Chrysotile (white asbestos)</b>				

**B00L - R0003 - Distribution Board Cupboard (0.49 m2)**

Note: No inspection of live electrical installation.

Floor Coverings Res/Textile	Vinyl Tiles	1m2	Throughout	Good Condition (1)	Low (1)	Low Priority (2-3)
8105/B00L/R0005/Floor Coverings Res/Textile/S12		<b>Chrysotile (white asbestos)</b>				

**B00L - R0004 - Laboratory L.S. (91.21 m2)**

Ceiling Structures/Linings	Vermiculite 8105/B00L/R0005/Ceiling Structures/Linings/S11					Limited Samples Taken
<b>Vermiculite Ceilings may contain asbestos. Asbestos testing MUST be conducted prior to any disturbance works</b>						

**B00L - R0005 - Preparation (44.57 m2)**

Ceiling Structures/Linings	Vermiculite 8105/B00L/R0005/Ceiling Structures/Linings/S11					Limited Samples Taken
<b>Vermiculite Ceilings may contain asbestos. Asbestos testing MUST be conducted prior to any disturbance works</b>						
Floor Coverings Res/Textile	Vinyl Tiles	45m2	Throughout	Good Condition (1)	Low (1)	Low Priority (2-3)
8105/B00L/R0005/Floor Coverings Res/Textile/S12		<b>Chrysotile (white asbestos)</b>				

**B00L - R0006 - Chemical Store (3.19 m2)**

Ceiling Structures/Linings	Vermiculite 8105/B00L/R0005/Ceiling Structures/Linings/S11					Limited Samples Taken
<b>Vermiculite Ceilings may contain asbestos. Asbestos testing MUST be conducted prior to any disturbance works</b>						
Floor Coverings Res/Textile	Vinyl Tiles	4m2	Throughout	Good Condition (1)	Low (1)	Low Priority (2-3)
8105/B00L/R0005/Floor Coverings Res/Textile/S12		<b>Chrysotile (white asbestos)</b>				

**B00L - R0007 - Laboratory L.S. (91.2 m2)**

Ceiling Structures/Linings	Vermiculite 8105/B00L/R0005/Ceiling Structures/Linings/S11					Limited Samples Taken
<b>Vermiculite Ceilings may contain asbestos. Asbestos testing MUST be conducted prior to any disturbance works</b>						

**B00L - R0008 - Movement (40.12 m2)**

Product	Material Description	Extent	Location Reference	Material Condition	Risk Status	Control Priority
Sample No					Test Result	

No Asbestos

**B00L - R0009 - External Movement (31.89 m2)**

No Asbestos

**B00L - R0010 - Preparation (44.58 m2)**

Ceiling Structures/Linings Vermiculite  
 8105/B00L/R0005/Ceiling Structures/Linings/S11 **Limited Samples Taken**  
*Vermiculite Ceilings may contain asbestos. Asbestos testing MUST be conducted prior to any disturbance works*

Floor Coverings Res/Textile Vinyl Tiles 45m2 Throughout Good Condition (1) Low (1) Low Priority (2-3)  
 8105/B00L/R0005/Floor Coverings Res/Textile/S12 **Chrysotile (white asbestos)**

**B00L - R0011 - Chemical Store (3.2 m2)**

Ceiling Structures/Linings Vermiculite  
 8105/B00L/R0005/Ceiling Structures/Linings/S11 **Limited Samples Taken**  
*Vermiculite Ceilings may contain asbestos. Asbestos testing MUST be conducted prior to any disturbance works*

Floor Coverings Res/Textile Vinyl Tiles 4m2 Throughout Good Condition (1) Low (1) Low Priority (2-3)  
 8105/B00L/R0005/Floor Coverings Res/Textile/S12 **Chrysotile (white asbestos)**

**B00L - R0012 - Laboratory L.S. (91.22 m2)**

Ceiling Structures/Linings Vermiculite  
 8105/B00L/R0005/Ceiling Structures/Linings/S11 **Limited Samples Taken**  
*Vermiculite Ceilings may contain asbestos. Asbestos testing MUST be conducted prior to any disturbance works*

**B00L - R0013 - General Storeroom (7.71 m2)**

No Asbestos

**B00L - R0014 - Stairs (7.71 m2)**

No Asbestos

**B00L - R0015 - Lift (2.27 m2)**

Recently Modified Space Requires Inspection

**B00L - R1001 - Seminar (25.15 m2)**

No Asbestos

**B00L - R1002 - No Access (5.46 m2)**

No Asbestos

**B00L - R1003 - No Access (6.12 m2)**

No Asbestos

**B00L - R1004 - Cleaning Store - Distributed (0.36 m2)**

No Asbestos

**B00L - R1005 - Movement (4.61 m2)**

No Asbestos

**B00L - R1006 - Distribution Board Cupboard (0.3 m2)**

Note: No inspection of live electrical installation.

No Asbestos

**B00L - R1007 - Seminar (25.13 m2)**

No Asbestos

**B00L - R1008 - Main Area (291.37 m2)**

Ceiling Structures/Linings Vermiculite  
 8105/B00L/R0005/Ceiling Structures/Linings/S11 **Limited Samples Taken**  
*Vermiculite Ceilings may contain asbestos. Asbestos testing MUST be conducted prior to any disturbance works*

**B00L - R1009 - Audio Visual Workroom (28.36 m2)**

No Asbestos

**B00L - R1010 - General Storeroom (12.77 m2)**

No Asbestos

**B00L - R1011 - Staff Kitchen (17.3 m2)**

No Asbestos

Product	Material Description	Extent	Location Reference	Material Condition	Risk Status	Control Priority
Sample No					Test Result	
<b>B00L - R1012 - Librarian (11.32 m2)</b>						
No Asbestos						
<b>B00L - R1013 - Toilets-Girls (2.83 m2)</b>						
No Asbestos						
<b>B00L - R1014 - Entry (35.64 m2)</b>						
No Asbestos						
<b>B00L - R1015 - Movement (25.82 m2)</b>						
No Asbestos						
<b>B00L - R1016 - Toilets-Boys (2.83 m2)</b>						
No Asbestos						
<b>B00L - R1017 - Workroom (70.95 m2)</b>						
Ceiling Structures/Linings Vermiculite						
8105/B00L/R0005/Ceiling Structures/Linings/S11						
					<b>Limited Samples Taken</b>	
<i>Vermiculite Ceilings may contain asbestos. Asbestos testing MUST be conducted prior to any disturbance works</i>						
<b>B00L - R1018 - Stairs (15.64 m2)</b>						
No Asbestos						
<b>B00L - R1019 - Stairs (0.53 m2)</b>						
No Asbestos						
<b>B00L - R1020 - Stairs (0.53 m2)</b>						
No Asbestos						
<b>B00L - Room+1 - Storage area in ceiling cavity</b>						
No Asbestos						
<b>B00L - Room+2 - Storage area in ceiling cavity</b>						
No Asbestos						

2017



Product	Material Description	Extent	Location Reference	Material Condition	Risk Status	Control Priority
Sample No					Test Result	

**B00M - Building Services - 2009 - Steel (Steel)**

**Exterior**

Ceiling Voids	No Asbestos Found
Underfloor Voids	No Asbestos Found

**Interior**

**B00M - R0001 - General Storeroom (52.43 m2)**

No Asbestos

**B00M - R0002 - General Storeroom (17.48 m2)**

No Asbestos

2017

Product	Material Description	Extent	Location Reference	Material Condition	Risk Status	Control Priority
Sample No					Test Result	

**B00N - Building Services - 1940 - Brick/Block (Brick/Block)**

**Exterior**

Ceiling Voids	No Asbestos Found
Underfloor Voids	No Asbestos Found

**Interior**

**B00N - R0001 - General Storeroom (74.23 m2)**

No Asbestos

2017

Product	Material Description	Extent	Location Reference	Material Condition	Risk Status	Control Priority
Sample No					Test Result	

**B000 - Building Services - 1960 - Brick/Block (Brick/Block)**

**Exterior**

Ceiling Voids	No Asbestos Found
Underfloor Voids	No Asbestos Found

**Interior**

**B000 - R0001 - Garden Store Room (5.93 m2)**

No Asbestos

2017

Product	Material Description	Extent	Location Reference	Material Condition	Risk Status	Control Priority
Sample No					Test Result	

**B00P - Physical Education - 2016 - Steel (Steel)**

**Exterior**

Ceiling Void	No Asbestos Found
Underfloor Void	No Asbestos Found

**Interior**

**B00P - R0001 - Gymnasium (195.08 m2)**

No Asbestos

2017

Product	Material Description	Extent	Location Reference	Material Condition	Risk Status	Control Priority
Sample No					Test Result	

**B00Q - Agricultural Science - 1995 - Metal Shed (Metal Shed)**

**Exterior**

Ceiling Void	No Asbestos Found
Underfloor Void	No Asbestos Found

**Interior**

**B00Q - R0001 - Animal Space (17.63 m2)**

No Asbestos

2017

Product	Material Description	Extent	Location Reference	Material Condition	Risk Status	Control Priority
Sample No					Test Result	

**B00R - Storage - 1990 - Metal Shed (Metal Shed)**

**Exterior**

Ceiling Void	No Asbestos Found
Underfloor Void	No Asbestos Found

**Interior**

**B00R - R0001 - Shed Workshop (17.69 m2)**

No Asbestos

2017

Product	Material Description	Extent	Location Reference	Material Condition	Risk Status	Control Priority
Sample No					Test Result	

**B00S - Agricultural Science - 1980 - Greenhouse (Greenhouse)**

**Exterior**

Ceiling Void	Requires Inspection
Underfloor Void	Requires Inspection

**Interior**

**B00S - R0001 - Plant Growing Space (24.87 m2)**

Recently Modified Space	Requires Inspection
-------------------------	---------------------

2017



Product	Material Description	Extent	Location Reference	Material Condition	Risk Status	Control Priority
Sample No					Test Result	

***Demountables***

**There are no Demountable(s) located at this school as per the AMS records as of 15 Feb 2017.**

2017

Product	Material Description	Extent	Location Reference	Material Condition	Risk Status	Control Priority
Sample No					Test Result	

*Listing of Electronic Attachments as of 22/03/2017*

**There are no asbestos related file attachment(s) for this school.**

2017