

# Asbestos Register

(Hazardous Materials and Risk Assessment)

**School :** Beverley Park School (5508)  
**Region :** South Western Sydney  
**State Electorate :** Campbelltown  
**Local Government Area :** Campbelltown

**Initial Survey :** Noel Arnold & Associates : 13 - Mar - 2008  
**Reviewed By :** Parsons Brinckerhoff : 25 - Nov - 2016

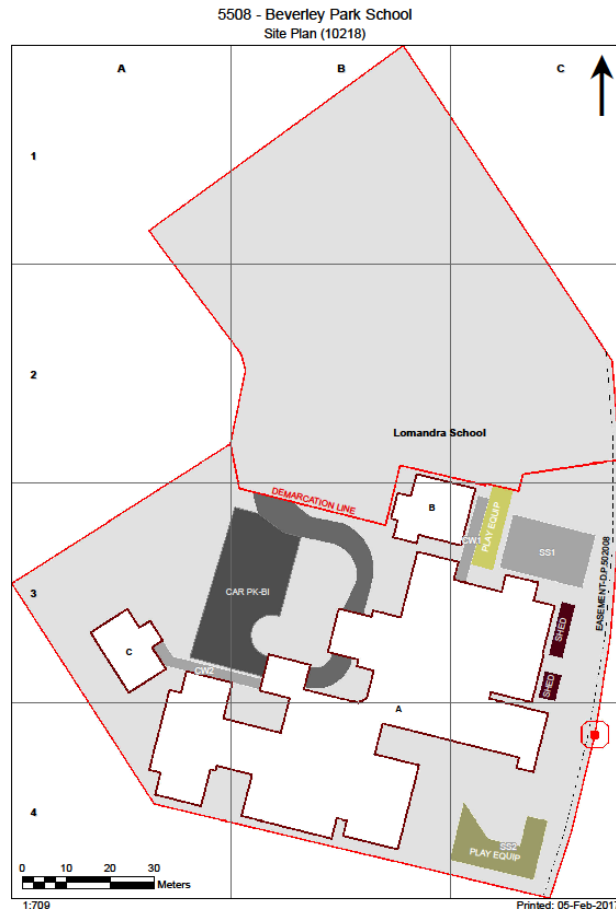

2017

Product	Material Description	Extent	Location Reference	Material Condition	Risk Status	Control Priority
Sample No					Test Result	

**B00A - Support Unit/Library - 1978 - Brick/Block (Brick/Block)****Exterior**

Ceiling Voids - Raked Ceiling	No Asbestos Found					
Underfloor Voids - Slab on Ground	Non Accessible Area - No Voids					
In-fill panels below windows	Flat AC Sheeting 5508/B00A/INFILL PANELS BELOW WINDOWS/S3	16m2	All surfaces, Lower portion	Good Condition (1)	Low (1)	Low Priority (2-3) <b>Chrysotile (white asbestos)</b>
Gable Ends	Flat AC Sheeting 5508/B00A/Gable Ends/S6	100m2	Variable positions	Good Condition (1)	Low (1)	Low Priority (2-3) <b>Chrysotile (white asbestos) , Amosite (brown asbestos)</b>

**Interior****B00A - R0001 - Computer Store**

No Asbestos

**B00A - R0002 - Home Base - M**

No Asbestos

**B00A - R0003 - Practical Activities - M - 1hb**

No Asbestos

**B00A - R0004 - Community Clinic**

No Asbestos

**B00A - R0005 - Community Clinic**

No Asbestos

**B00A - R0006 - Toilets - Girls**

No Asbestos

**B00A - R0007 - Shower/Change**

No Asbestos

**B00A - R0008 - Toilets - Boys**

No Asbestos

**B00A - R0009 - Cleaning Supplies**

No Asbestos

**B00A - R0010 - Movement**

No Asbestos

**B00A - R0011 - Home Base - M**

No Asbestos

**B00A - R0012 - General Storeroom**

No Asbestos

**B00A - R0013 - Staff Toilet**

No Asbestos

**B00A - R0014 - Staff Toilet**

No Asbestos

**B00A - R0015 - Staff Room**

No Asbestos

**B00A - R0016 - Entry Vestibule**

No Asbestos

**B00A - R0017 - Covered Vehicle Area/Porte Cochere**

Ceiling Structures/Linings	Flat AC Sheeting	62m2	All surfaces	Good Condition (1)	Low (1)	Low Priority (2-3) <b>Chrysotile (white asbestos) , Amosite (brown asbestos)</b>
	5508/B00A/R0017/Ceiling Structures/Linings/S7					

**B00A - R0021 - Movement**

Product	Material Description	Extent	Location Reference	Material Condition	Risk Status	Control Priority
Sample No					Test Result	
No Asbestos						
<b>B00A - R0023 - General Storeroom</b>						
No Asbestos						
<b>B00A - R0024 - Cleaning Distributed Store</b>						
No Asbestos						
<b>B00A - R0025 - Home Base - M</b>						
No Asbestos						
<b>B00A - R0026 - Practical Activities - M - 1hb</b>						
No Asbestos						
<b>B00A - R0027 - Home Base Store</b>						
No Asbestos						
<b>B00A - R0028 - Distribution Board</b>						
					Note: No inspection of live electrical installation.	
Door Lining	Flat AC Sheeting	2m2	Rear Surface	Good Condition (1)	Low (1)	Low Priority (2-3)
5508/B00A/R0028/Door Lining/S5					Chrysotile (white asbestos)	
<b>B00A - R0030 - General Storeroom</b>						
No Asbestos						
<b>B00A - R0031 - Distribution Board</b>						
					Note: No inspection of live electrical installation.	
No Asbestos						
<b>B00A - R0032 - Movement</b>						
No Asbestos						
<b>B00A - R0033 - Staff Room Annexe</b>						
No Asbestos						
<b>B00A - R0034 - Withdrawal - S</b>						
No Asbestos						
<b>B00A - R0035 - Practical Activities - S - 1hb</b>						
No Asbestos						
<b>B00A - R0036 - Home Base - S</b>						
No Asbestos						
<b>B00A - R0037 - Toilets - Girls</b>						
Ceiling Structures/Linings	Flat AC Sheeting	6m2	All surfaces	Good Condition (1)	Low (1)	Low Priority (2-3)
5508/B00A/R0039/Ceiling Structures/Linings/S2					Chrysotile (white asbestos)	
<b>B00A - R0038 - Toilets - Boys</b>						
Ceiling Structures/Linings	Flat AC Sheeting	5m2	All surfaces	Good Condition (1)	Low (1)	Low Priority (2-3)
5508/B00A/R0039/Ceiling Structures/Linings/S2					Chrysotile (white asbestos)	
<b>B00A - R0039 - Movement</b>						
Ceiling Structures/Linings	Flat AC Sheeting	5m2	All surfaces	Good Condition (1)	Low (1)	Low Priority (2-3)
5508/B00A/R0039/Ceiling Structures/Linings/S2					Chrysotile (white asbestos)	
<b>B00A - R0040 - Staff Room Annexe</b>						
No Asbestos						
<b>B00A - R0041 - Interview</b>						
No Asbestos						
<b>B00A - R0042 - Movement</b>						
No Asbestos						
<b>B00A - R0043 - Home Base Store - S</b>						
No Asbestos						
<b>B00A - R0044 - Practical Activities - S - 1hb</b>						
No Asbestos						
<b>B00A - R0045 - Home Base - S</b>						
No Asbestos						

Product	Material Description	Extent	Location Reference	Material Condition	Risk Status	Control Priority
Sample No					Test Result	
<b>B00A - R0046 - Home Base - M</b>						
No Asbestos						
<b>B00A - R0047 - Practical Activities - M - 1hb</b>						
No Asbestos						
<b>B00A - R0048 - Home Base Store - M</b>						
No Asbestos						
<b>B00A - R0049 - Movement</b>						
No Asbestos						
<b>B00A - R0050 - Movement</b>						
No Asbestos						
<b>B00A - R0051 - General Storeroom</b>						
No Asbestos						
<b>B00A - R0052 - Movement</b>						
Ceiling Structures/Linings	Flat AC Sheeting	26m2	All surfaces	Good Condition (1)	Low (1)	Low Priority (2-3)
5508/B00A/R0017/Ceiling Structures/Linings/S7				Chrysotile (white asbestos) , Amosite (brown asbestos)		
<b>B00A - R0053 - Reading Area</b>						
No Asbestos						
<b>B00A - R0054 - Library Office/Workroom</b>						
No Asbestos						
<b>B00A - R0055 - Library Office/Workroom</b>						
No Asbestos						
<b>B00A - R0056 - Communications Room</b>						
No Asbestos						
<b>B00A - R0057 - Library Office/Workroom</b>						
No Asbestos						
<b>B00A - R0058 - Staff Toilet</b>						
No Asbestos						
<b>B00A - R0059 - Cleaning Distributed Store</b>						
No Asbestos						
<b>B00A - R0060 - Home Base - S</b>						
No Asbestos						
<b>B00A - R0061 - Home Base - S</b>						
No Asbestos						
<b>B00A - R0062 - Movement</b>						
Ceiling Structures/Linings	Flat AC Sheeting	22m2	All surfaces	Good Condition (1)	Low (1)	Low Priority (2-3)
5508/B00A/R0017/Ceiling Structures/Linings/S7				Chrysotile (white asbestos) , Amosite (brown asbestos)		
<b>B00A - R0063 - Staff Toilet</b>						
No Asbestos						
<b>B00A - R0064 - Other-Commercial</b>						
No Asbestos						
<b>B00A - R0065 - Other-Commercial</b>						
No Asbestos						
<b>B00A - R0066 - General Assistant/Bulk Store</b>						
No Asbestos						
<b>B00A - R0067 - General Storeroom</b>						
No Asbestos						
<b>B00A - R0068 - Movement</b>						

Product	Material Description	Extent	Location Reference	Material Condition	Risk Status	Control Priority
Sample No				Test Result		
Ceiling Structures/Linings	Flat AC Sheeting	25m2	All surfaces	Good Condition (1)	Low (1)	Low Priority (2-3)
5508/B00A/R0017/Ceiling Structures/Linings/S7				Chrysotile (white asbestos) , Amosite (brown asbestos)		
<b>B00A - R0069 - Movement</b>						
No Asbestos						
<b>B00A - R0070 - Movement</b>						
No Asbestos						
<b>B00A - R0071 - General Storeroom</b>						
No Asbestos						
<b>B00A - R0072 - Staff Kitchen</b>						
No Asbestos						
<b>B00A - R0073 - Practical Activities - S - 1hb</b>						
No Asbestos						
<b>B00A - R0074 - Disabled Toilet</b>						
No Asbestos						
<b>B00A - R0075 - Movement</b>						
Ceiling Structures/Linings	Flat AC Sheeting	51m2	All surfaces	Good Condition (1)	Low (1)	Low Priority (2-3)
5508/B00A/R0017/Ceiling Structures/Linings/S7				Chrysotile (white asbestos) , Amosite (brown asbestos)		
<b>B00A - R0076 - Covered Vehicle Area/Porte Cochere</b>						
Ceiling Structures/Linings	Flat AC Sheeting	53m2	All surfaces	Good Condition (1)	Low (1)	Low Priority (2-3)
5508/B00A/R0017/Ceiling Structures/Linings/S7				Chrysotile (white asbestos) , Amosite (brown asbestos)		
<b>B00A - R0077 - Movement</b>						
Wall Linings Internal	Flat AC Sheeting	2m2	South facing	Good Condition (1)	Low (1)	Low Priority (2-3)
5508/B00A/R0077/Wall Linings Internal/S4				Chrysotile (white asbestos) , Amosite (brown asbestos)		
Ceiling Structures/Linings	Flat AC Sheeting	62m2	All surfaces	Good Condition (1)	Low (1)	Low Priority (2-3)
5508/B00A/R0017/Ceiling Structures/Linings/S7				Chrysotile (white asbestos) , Amosite (brown asbestos)		
<b>B00A - R0078 - Therapy</b>						
No Asbestos						
<b>B00A - R0079 - Therapy Store</b>						
No Asbestos						
<b>B00A - R0080 - Shower/Change</b>						
No Asbestos						
<b>B00A - R0081 - Cleaning Supplies</b>						
No Asbestos						
<b>B00A - R0082 - Toilets - Boys/Girls</b>						
No Asbestos						
<b>B00A - R0083 - General Storeroom</b>						
No Asbestos						
<b>B00A - R0084 - Staff Room Annexe</b>						
No Asbestos						
<b>B00A - R0085 - General Storeroom</b>						
No Asbestos						
<b>B00A - R0086 - Therapy</b>						
No Asbestos						
<b>B00A - R0087 - Clerical Office</b>						
No Asbestos						

Product	Material Description	Extent	Location Reference	Material Condition	Risk Status	Control Priority
Sample No					Test Result	
<b>B00A - R0088 - Principal</b>						
No Asbestos						
<b>B00A - R0089 - Communal Space</b>						
No Asbestos						
<b>B00A - R0090 - Covered Outdoor Learning Area</b>						
No Asbestos						
<b>B00A - R0091 - Covered Outdoor Learning Area</b>						
No Asbestos						
<b>B00A - R0092 - Covered Outdoor Learning Area</b>						
No Asbestos						
<b>B00A - R0093 - Covered Outdoor Learning Area</b>						
No Asbestos						

2017

Product	Material Description	Extent	Location Reference	Material Condition	Risk Status	Control Priority
Sample No					Test Result	

**B00B - Support Unit - 1999 - Brick/Veneer (Brick/Veneer)****Exterior**

Underfloor Voids - Slab on Ground Non Accessible Area

- No Voids

Ceiling Voids No Asbestos Found

**Interior****B00B - R0001 - Hydrotherapy - Pool**

Ceiling Structures/Linings Flat AC Sheeting 100m2 All surfaces Good Condition (1) Low (1) Low Priority (2-3)

5508/B00B/R0007/Ceiling Structures/Linings/S1

**Chrysotile (white asbestos)**

**B00B - R0002 - Shower/Change**

Ceiling Structures/Linings Flat AC Sheeting 10m2 All surfaces Good Condition (1) Low (1) Low Priority (2-3)

5508/B00B/R0007/Ceiling Structures/Linings/S1

**Chrysotile (white asbestos)**

**B00B - R0003 - Toilets - Girls**

Ceiling Structures/Linings Flat AC Sheeting 10m2 All surfaces Good Condition (1) Low (1) Low Priority (2-3)

5508/B00B/R0007/Ceiling Structures/Linings/S1

**Chrysotile (white asbestos)**

**B00B - R0004 - Toilets - Boys**

Ceiling Structures/Linings Flat AC Sheeting 10m2 All surfaces Good Condition (1) Low (1) Low Priority (2-3)

5508/B00B/R0007/Ceiling Structures/Linings/S1

**Chrysotile (white asbestos)**

**B00B - R0005 - Plant**

Ceiling Structures/Linings Flat AC Sheeting 10m2 All surfaces Good Condition (1) Low (1) Low Priority (2-3)

5508/B00B/R0007/Ceiling Structures/Linings/S1

**Chrysotile (white asbestos)**

**B00B - R0006 - Cleaning Supplies**

Ceiling Structures/Linings Flat AC Sheeting 10m2 All surfaces Good Condition (1) Low (1) Low Priority (2-3)

5508/B00B/R0007/Ceiling Structures/Linings/S1

**Chrysotile (white asbestos)**

**B00B - R0007 - Shower/Change**

Ceiling Structures/Linings Flat AC Sheeting 10m2 All surfaces Good Condition (1) Low (1) Low Priority (2-3)

5508/B00B/R0007/Ceiling Structures/Linings/S1

**Chrysotile (white asbestos)**

2017

Product	Material Description	Extent	Location Reference	Material Condition	Risk Status	Control Priority
Sample No					Test Result	

**B00C - Communal Facilities - 2010 - Brick/Veneer (Brick/Veneer)**

**Exterior**

Underfloor Voids - Slab on Ground	Non Accessible Area - No Voids
Ceiling Voids	No Asbestos Found

**Interior**

**B00C - R0001 - External Movement**

No Asbestos

**B00C - R0002 - Communal Space**

No Asbestos

**B00C - R0003 - Sound Cupboard**

No Asbestos

**B00C - R0004 - Access Shower/Toilet/Change**

No Asbestos

2017



Product	Material Description	Extent	Location Reference	Material Condition	Risk Status	Control Priority
	Sample No					Test Result

### ***Demountables***

**There are no Demountable(s) located at this school as per the AMS records as of 15 Feb 2017.**

2017

Product	Material Description	Extent	Location Reference	Material Condition	Risk Status	Control Priority
Sample No					Test Result	

*Listing of Electronic Attachments as of 22/03/2017*

**There are no asbestos related file attachment(s) for this school.**

2017