

# Asbestos Register

(Hazardous Materials and Risk Assessment)

**School :** Bexley North Public School (2308)  
**Region :** Sydney  
**State Electorate :** Rockdale  
**Local Government Area :** Rockdale

**Initial Survey :** Noel Arnold & Associates : 20 - Mar - 2008  
**Reviewed By :** Parsons Brinckerhoff : 07 - Feb - 2017

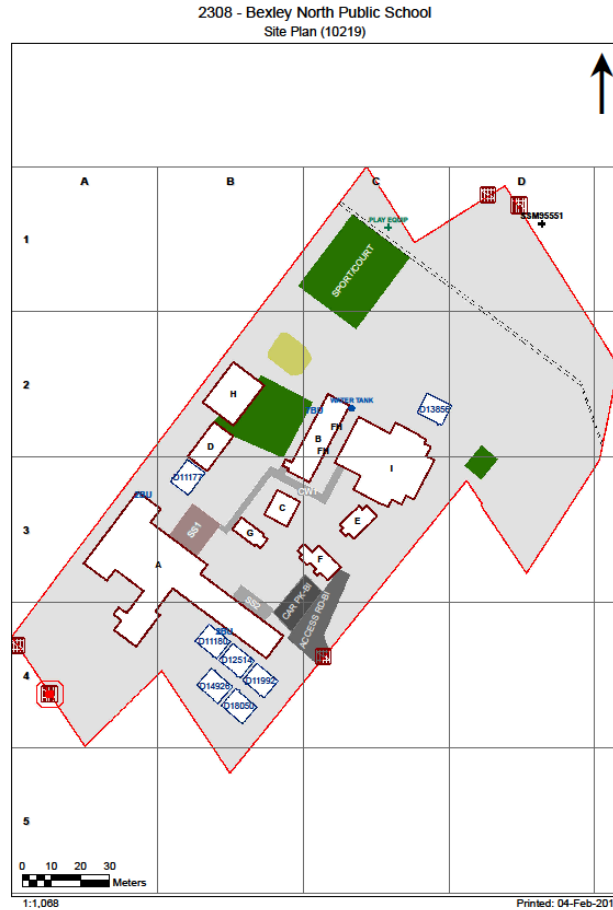

2017

Product	Material Description	Extent	Location Reference	Material Condition	Risk Status	Control Priority
Sample No					Test Result	

**B00A - Administration/General Learning - 1950 - Brick/Block (Brick/Block)**

**Exterior**

Ceiling Voids - Raked Ceiling	No Asbestos Found					
Eaves Linings	Flat AC Sheeting	200m2	Variable positions	Good Condition (1)	Low (1)	Low Priority (2-3)
	2308/B00A/Eaves Linings/S1			Chrysotile (white asbestos) , Amosite (brown asbestos)		
Underfloor Voids	No Asbestos Found					

**Interior**

<b>B00A - R0003 - Outdoor Learning Area</b>	No Asbestos					
<b>B00A - R0005 - Movement</b>	No Asbestos					
<b>B00A - R0006 - Movement</b>	No Asbestos					
<b>B00A - R0007 - Distribution Board</b>	Note: No inspection of live electrical installation.					
<b>B00A - R0008 - Cleaning Distributed Store</b>	No Asbestos					
<b>B00A - R0009 - Home Base</b>	No Asbestos					
<b>B00A - R0010 - Outdoor Learning Area</b>	No Asbestos					
<b>B00A - R0011 - Home Base</b>	No Asbestos					
<b>B00A - R0012 - Outdoor Learning Area</b>	No Asbestos					
<b>B00A - R0013 - Home Base</b>	No Asbestos					
<b>B00A - R0014 - Movement</b>	No Asbestos					
<b>B00A - R0016 - Security Store</b>	No Asbestos					
<b>B00A - R0017 - Home Base</b>	No Asbestos					
<b>B00A - R0018 - Home Base</b>	No Asbestos					
<b>B00A - R0019 - Staff Room</b>	No Asbestos					
<b>B00A - R0020 - Practical Activities - 1hb</b>	No Asbestos					
<b>B00A - R0022 - Disabled Toilet</b>	No Asbestos					
<b>B00A - R0023 - Security Store</b>	No Asbestos					
<b>B00A - R0024 - Staff Toilet</b>	No Asbestos					
<b>B00A - R0025 - Staff Kitchen</b>	No Asbestos					
<b>B00A - R0026 - Staff Toilet</b>	No Asbestos					

Product	Material Description	Extent	Location Reference	Material Condition	Risk Status	Control Priority
Sample No					Test Result	
No Asbestos						
<b>B00A - R0027 - Staff Shower/Change</b>						
No Asbestos						
<b>B00A - R0028 - Sick Bay</b>						
No Asbestos						
<b>B00A - R0029 - Clerical Office</b>						
No Asbestos						
<b>B00A - R0030 - Principal</b>						
No Asbestos						
<b>B00A - R0031 - Interview</b>						
No Asbestos						
<b>B00A - R0032 - Movement</b>						
Ceiling Structures/Linings	Flat AC Sheeting					
			2308/B00A/R0032/Ceiling Structures/Linings/S4			<b>No Asbestos Detected</b>
<b>B00A - R0033 - Entry Vestibule</b>						
No Asbestos						
<b>B00A - R0034 - Duplicating Workroom</b>						
No Asbestos						
<b>B00A - R0035 - Staff Room Annexe</b>						
No Asbestos						
<b>B00A - R0036 - Staff Room Annexe</b>						
No Asbestos						
<b>B00A - R0037 - Movement</b>						
No Asbestos						
<b>B00A - R0038 - Movement</b>						
Ceiling Structures/Linings	Flat AC Sheeting					
			2308/B00A/R0032/Ceiling Structures/Linings/S4			<b>No Asbestos Detected</b>
<b>B00A - R0041 - Movement</b>						
No Asbestos						
<b>B00A - R0042 - Stairs</b>						
No Asbestos						
<b>B00A - R0043 - Stairs</b>						
No Asbestos						
<b>B00A - R0044 - Stairs</b>						
No Asbestos						
<b>B00A - R0045 - Staff Toilet</b>						
No Asbestos						
<b>B00A - R0046 - Practical Activities</b>						
No Asbestos						
<b>B00A - R0047 - Home Base</b>						
No Asbestos						
<b>B00A - R0048 - Home Base</b>						
No Asbestos						
<b>B00A - R0049 - Home Base Store</b>						
No Asbestos						
<b>B00A - R0050 - Practical Activities</b>						
No Asbestos						
<b>B00A - R0051 - Withdrawal Space - 1hb</b>						
No Asbestos						
<b>B00A - R0052 - Practical Activities</b>						
No Asbestos						

Product	Material Description	Extent	Location Reference	Material Condition	Risk Status	Control Priority
Sample No					Test Result	
<b>B00A - R0053 - Home Base Store</b>						
No Asbestos						
<b>B00A - R0054 - Home Base</b>						
No Asbestos						
<b>B00A - R1001 - Staff Room Annexe</b>						
No Asbestos						
<b>B00A - R1002 - Movement</b>						
No Asbestos						
<b>B00A - R1003 - Home Base</b>						
No Asbestos						
<b>B00A - R1004 - Home Base</b>						
No Asbestos						
<b>B00A - R1005 - Home Base</b>						
No Asbestos						
<b>B00A - R1006 - Staff Room Annexe</b>						
No Asbestos						
<b>B00A - R1007 - Stairs</b>						
No Asbestos						
<b>B00A - R1008 - Stairs</b>						
No Asbestos						
<b>B00A - R1009 - Home Base Store</b>						
No Asbestos						
<b>B00A - R9001 - Cleaning Distributed Store</b>						
No Asbestos						
<b>B00A - R9002 - Movement</b>						
No Asbestos						
<b>B00A - R9003 - Out Of School Hours Care Centre</b>						
No Asbestos						
<b>B00A - R9004 - Movement</b>						
Wall Linings Internal	Vinyl Tiles					
2308/B00A/R9004/Wall Linings Internal/S3					No Asbestos Detected	
<b>B00A - R9005 - Canteen</b>						
No Asbestos						
<b>B00A - R9006 - Canteen Office/Store</b>						
No Asbestos						
<b>B00A - R9007 - Staff Toilet</b>						
No Asbestos						
<b>B00A - R9008 - Canteen Office/Store</b>						
No Asbestos						
<b>B00A - R9009 - Drinking Facilities</b>						
No Asbestos						
<b>B00A - R9010 - Cleaning Distributed Store</b>						
No Asbestos						
<b>B00A - R9011 - Toilets - Girls</b>						
No Asbestos						
<b>B00A - R9012 - Cleaning Distributed Store</b>						
No Asbestos						
<b>B00A - R9013 - Toilets - Boys</b>						
No Asbestos						
<b>B00A - R9014 - Handwashing Facilities</b>						
No Asbestos						

Product	Material Description	Extent	Location Reference	Material Condition	Risk Status	Control Priority
Sample No					Test Result	

**B00A - R9015 - Movement**

No Asbestos

**B00A - R9016 - Stairs**

No Asbestos

2017

Product	Material Description	Extent	Location Reference	Material Condition	Risk Status	Control Priority
Sample No					Test Result	

**B00B - General Learning/Library - 1962 - Brick/Veneer (Brick/Veneer)**

**Exterior**

Underfloor Voids - Packing to Floor Joists	No Asbestos Found					
Ceiling Voids - Raked Ceiling	No Asbestos Found					
Eaves Linings	Flat AC Sheeting	150m2	Upper portion, Variable positions	Good Condition (1)	Low (1)	Low Priority (2-3)
	2308/B00B/Eaves Linings/S14					<b>Chrysotile (white asbestos)</b>

**Interior**

**B00B - R0008 - Movement**

Ceiling Structures/Linings	Flat AC Sheeting	2m2	Upper portion	Good Condition (1)	Low (1)	Low Priority (2-3)
	2308/B00B/Eaves Linings/S14					<b>Chrysotile (white asbestos)</b>

**B00B - R0014 - Movement**

Ceiling Structures/Linings	Flat AC Sheeting	5m2	Upper portion	Good Condition (1)	Low (1)	Low Priority (2-3)
	2308/B00B/R0014/Ceiling Structures/Linings/S13					<b>Chrysotile (white asbestos)</b>

**B00B - R0015 - Reading Area**

No Asbestos

**B00B - R0016 - Library Office/Workroom**

No Asbestos

**B00B - R0017 - Special Programs Room**

No Asbestos

2017

Product	Material Description	Extent	Location Reference	Material Condition	Risk Status	Control Priority
Sample No					Test Result	

**B00C - General Learning/Communal Facilities - 1940 - Timber (Timber)**

**Exterior**

Underfloor Voids - Packing to Floor Joists	No Asbestos Found					
Ceiling Voids - Raked Ceiling	No Asbestos Found					
Eaves Linings	Flat AC Sheeting	15m2	North facing, South facing	Good Condition (1)	Low (1)	Low Priority (2-3)
	2308/B00C/Eaves Linings/S8			<b>Chrysotile (white asbestos) , Amosite (brown asbestos)</b>		

**Interior**

**B00C - R0001 - Movement**

Ceiling Structures/Linings	Flat AC Sheeting	22m2	Upper portion	Good Condition (1)	Low (1)	Low Priority (2-3)
	2308/B00C/R0001/Ceiling Structures/Linings/S7			<b>Chrysotile (white asbestos) , Amosite (brown asbestos)</b>		

**B00C - R0002 - General Storeroom**

No Asbestos

**B00C - R0003 - General Storeroom**

No Asbestos

**B00C - R0004 - Movement**

No Asbestos

**B00C - R0005 - Sports Store**

No Asbestos

**B00C - R0006 - Withdrawal Space - 1hb**

No Asbestos

2017

Product	Material Description	Extent	Location Reference	Material Condition	Risk Status	Control Priority
Sample No					Test Result	

**B00D - General Learning - 1940 - Timber (Timber)**

**Exterior**

Ceiling Voids - Raked Ceiling	No Asbestos Found					
Underfloor Voids - Packing to Floor Joists	No Asbestos Found					
Wall Cladding	Flat AC Sheeting 2308/B00D/Wall Cladding/S2					<b>No Asbestos Detected</b>

**Interior**

**B00D - R0001 - Movement**

No Asbestos

**B00D - R0002 - Home Base**

No Asbestos

**B00D - R0003 - Home Base**

No Asbestos

2017



Product	Material Description	Extent	Location Reference	Material Condition	Risk Status	Control Priority
Sample No					Test Result	

**B00E - Pupil Facilities - 1940 - Brick/Block (Brick/Block)**

**Exterior**

Ceiling Voids - Raked Ceiling No Asbestos Found

Underfloor Voids - Packing to Floor Joists No Asbestos Found

**Interior**

**B00E - R0001 - Garden Store**

No Asbestos

**B00E - R0002 - Toilets - Boys**

Ceiling Structures/Linings	Flat AC Sheeting	17m2	Upper portion	Good Condition (1)	Low (1)	Low Priority (2-3)
2308/B00E/R0002/Ceiling Structures/Linings/S12					<b>Chrysotile (white asbestos)</b>	

**B00E - R0003 - Staff Toilet**

Ceiling Structures/Linings	Flat AC Sheeting	2m2	Upper portion	Good Condition (1)	Low (1)	Low Priority (2-3)
2308/B00E/R0002/Ceiling Structures/Linings/S12					<b>Chrysotile (white asbestos)</b>	

**B00E - R0004 - Movement**

No Asbestos

**B00E - R0005 - Toilets - Boys**

Ceiling Structures/Linings	Flat AC Sheeting	25m2	Upper portion	Good Condition (1)	Low (1)	Low Priority (2-3)
2308/B00E/R0002/Ceiling Structures/Linings/S12					<b>Chrysotile (white asbestos)</b>	

2017

Product	Material Description	Extent	Location Reference	Material Condition	Risk Status	Control Priority
Sample No					Test Result	

**B00F - Pupil Facilities/Building Services - 1940 - Brick/Block (Brick/Block)**

**Exterior**

Ceiling Voids - Raked Ceiling	No Asbestos Found					
Underfloor Voids - Packing to Floor Joists	No Asbestos Found					
Eaves Linings	Flat AC Sheeting	20m2	North facing, South facing	Good Condition (1)	Low (1)	Low Priority (2-3)
	2308/B00F/Eaves Linings/S9			<b>Chrysotile (white asbestos) , Amosite (brown asbestos)</b>		

**Interior**

**B00F - R0001 - Toilets - Girls**

Ceiling Structures/Linings	Flat AC Sheeting	10m2	Upper portion	Good Condition (1)	Low (1)	Low Priority (2-3)
	2308/B00F/R0001/Ceiling Structures/Linings/S10			<b>Chrysotile (white asbestos)</b>		

**B00F - R0002 - Movement**

No Asbestos

**B00F - R0003 - Cleaning Supplies**

Ceiling Structures/Linings	Flat AC Sheeting	16m2	Upper portion	Good Condition (1)	Low (1)	Low Priority (2-3)
	2308/B00F/R0001/Ceiling Structures/Linings/S10			<b>Chrysotile (white asbestos)</b>		

**B00F - R0004 - Garden Store**

Ceiling Structures/Linings	Flat AC Sheeting	6m2	Upper portion	Good Condition (1)	Low (1)	Low Priority (2-3)
	2308/B00F/R0001/Ceiling Structures/Linings/S10			<b>Chrysotile (white asbestos)</b>		

**B00F - R0005 - General Assistant/Bulk Store**

Ceiling Structures/Linings	Flat AC Sheeting	14m2	Upper portion	Good Condition (1)	Low (1)	Low Priority (2-3)
	2308/B00F/R0001/Ceiling Structures/Linings/S10			<b>Chrysotile (white asbestos)</b>		

**B00F - R0006 - Movement**

No Asbestos

**B00F - R0007 - Toilets - Girls**

Ceiling Structures/Linings	Flat AC Sheeting	11m2	Upper portion	Good Condition (1)	Low (1)	Low Priority (2-3)
	2308/B00F/R0001/Ceiling Structures/Linings/S10			<b>Chrysotile (white asbestos)</b>		

Wall Linings Internal	Flat AC Sheeting					<b>No Asbestos Detected</b>
	2308/B00F/R0007/Wall Linings Internal/S11					

**B00F - R0008 - Handwashing Facilities**

Ceiling Structures/Linings	Flat AC Sheeting	6m2	Upper portion	Good Condition (1)	Low (1)	Low Priority (2-3)
	2308/B00F/R0001/Ceiling Structures/Linings/S10			<b>Chrysotile (white asbestos)</b>		

**B00F - R0009 - Staff Toilet**

Ceiling Structures/Linings	Flat AC Sheeting	3m2	Upper portion	Good Condition (1)	Low (1)	Low Priority (2-3)
	2308/B00F/R0001/Ceiling Structures/Linings/S10			<b>Chrysotile (white asbestos)</b>		

**B00F - R0010 - Movement**

No Asbestos

Product	Material Description	Extent	Location Reference	Material Condition	Risk Status	Control Priority
Sample No					Test Result	

**B00G - Building Services/Special Purpose - 1940 - Brick/Block (Brick/Block)**

**Exterior**

Ceiling Voids - Flat Roof	No Asbestos Found					
Underfloor Voids - Packing to Floor Joists	No Asbestos Found					
Eaves Linings	Flat AC Sheeting	30m2	Variable positions	Good Condition (1)	Low (1)	Low Priority (2-3)
	2308/B00G/Eaves Linings/S5			<b>Chrysotile (white asbestos) , Amosite (brown asbestos)</b>		
Wall Cladding	Flat AC Sheeting					
	2308/B00G/Wall Cladding/S6			<b>No Asbestos Detected</b>		

**Interior**

**B00G - R0001 - General Assistant/Bulk Store**

Ceiling Structures/Linings	Flat AC Sheeting	42m2	Upper portion	Good Condition (1)	Low (1)	Low Priority (2-3)
	2308/B00G/R0001/Ceiling Structures/Linings/S15			<b>Chrysotile (white asbestos) , Amosite (brown asbestos)</b>		

**B00G - R0002 - Craft Store**

Ceiling Structures/Linings	Flat AC Sheeting	6m2	Upper portion	Good Condition (1)	Low (1)	Low Priority (2-3)
	2308/B00G/R0001/Ceiling Structures/Linings/S15			<b>Chrysotile (white asbestos) , Amosite (brown asbestos)</b>		

2017

Product	Material Description	Extent	Location Reference	Material Condition	Risk Status	Control Priority
Sample No					Test Result	

**B00H - General Learning - 2006 - Fibre Cement Clad (Fibre Cement Clad)**

**Exterior**

Ceiling Voids	No Asbestos Found
Underfloor Voids	No Asbestos Found

**Interior**

**B00H - R0001 - Movement**

No Asbestos

**B00H - R0002 - Practical Activities - 1hb**

No Asbestos

**B00H - R0003 - Home Base Store**

Vinyl Tiles (Under Floor Covering/Carpet)      No Asbestos Found

**B00H - R0004 - Home Base**

Vinyl Tiles (Under Floor Covering/Carpet)      No Asbestos Found

**B00H - R0005 - Withdrawal Space - 2hb**

Vinyl Tiles (Under Floor Covering/Carpet)      No Asbestos Found

**B00H - R0006 - Home Base**

Vinyl Tiles (Under Floor Covering/Carpet)      No Asbestos Found

**B00H - R0007 - Home Base Store**

Vinyl Tiles (Under Floor Covering/Carpet)      No Asbestos Found

**B00H - R0008 - Practical Activities - 1hb**

No Asbestos

2017

Product	Material Description	Extent	Location Reference	Material Condition	Risk Status	Control Priority
Sample No					Test Result	

**B00I - Communal Facilities - 2011 - Brick/Veneer (Brick/Veneer)****Exterior**

Underfloor Voids - Packing to Floor Joists      No Asbestos Found

Ceiling Voids      No Asbestos Found

**Interior****B00I - R0001 - Access Shower/Toilet**

No Asbestos

**B00I - R0002 - Communications Cupboard**

No Asbestos

**B00I - R0003 - Toilets - Girls**

No Asbestos

**B00I - R0004 - Movement**

No Asbestos

**B00I - R0005 - Distribution Board**

Note: No inspection of live electrical installation.

No Asbestos

**B00I - R0006 - Cleaning Distributed Store**

No Asbestos

**B00I - R0007 - Plant**

No Asbestos

**B00I - R0008 - Hall Chair Store**

No Asbestos

**B00I - R0009 - Communal Space**

No Asbestos

**B00I - R0010 - Raised Platform**

No Asbestos

**B00I - R0011 - Movement**

No Asbestos

**B00I - R0012 - Toilets - Boys**

No Asbestos

**B00I - R0013 - P.E. Store**

No Asbestos

**B00I - R0014 - Communal/Performance Store**

No Asbestos

**B00I - R0015 - Covered Outdoor Learning Area**

No Asbestos

**B00I - R0016 - Kitchen - Pre**

No Asbestos

**B00I - R0017 - Movement**

No Asbestos

**B00I - R0018 - External Movement**

No Asbestos

**B00I - R0019 - Movement**

No Asbestos

**B00I - R0020 - Movement**

No Asbestos

**B00I - R0021 - Movement**

No Asbestos

**B00I - R0022 - External Movement**

No Asbestos

Product	Material Description	Extent	Location Reference	Material Condition	Risk Status	Control Priority
Sample No					Test Result	
<b>B001 - R0023 - External Movement</b>						
No Asbestos						
<b>B001 - R0024 - Plant</b>						
No Asbestos						
<b>B001 - R0025 - Ramp</b>						
No Asbestos						

2017

Product	Material Description	Extent	Location Reference	Material Condition	Risk Status	Control Priority
Sample No					Test Result	

## Demountables

**Demountable details as per the AMS records as of 15 Feb 2017.**

**OS 601 - D11177 - Learning Unit - Standard/Withdrawal : Placement Date - 20/12/1999**

### Exterior

Step Treads	Compressed AC Sheet	Assumed Asbestos	1.08 m2
Landing	Compressed AC Sheet	Assumed Asbestos	1.2 m2
Eave Lining	Flat AC Sheet	Assumed Asbestos	11.52 m2

### Interior

#### R1 - Entry

End wall panel	Flat AC Sheet	Assumed Asbestos	18 m2
Ceiling	Flat AC Sheet	Assumed Asbestos	8 m2

#### R2 - General Learning Space

End wall panel	Flat AC Sheet	Assumed Asbestos	18 m2
Ceiling	Flat AC Sheet	Assumed Asbestos	55 m2

#### R3 - Store

Ceiling	Flat AC Sheet	Assumed Asbestos	10 m2
---------	---------------	------------------	-------

**OS 603 - D11180 - Learning Unit - Standard With P.A.A. A/C : Placement Date - 20/12/2013**

Note: This refurbished demountable may have asbestos present in remnant mastic in window frames.

### Exterior

No Asbestos Found.

### Interior

#### R1 - Learning space/withdrawal/entry

No Asbestos Found.

#### R2 - Home Base Store

No Asbestos Found.

**OS 751 - D11992 - Learning Unit - ESL : Placement Date - 12/11/2007**

### Exterior

Step Treads	Compressed AC Sheet	Assumed Asbestos	1.08 m2
Landing	Compressed AC Sheet	Assumed Asbestos	1.2 m2
Eave Lining	Flat AC Sheet	Assumed Asbestos	11.52 m2

### Interior

#### R1 - Esl

End wall panel	Flat AC Sheet	Assumed Asbestos	18 m2
Ceiling	Flat AC Sheet	Assumed Asbestos	36 m2

#### R2 - Esl

End wall panel	Flat AC Sheet	Assumed Asbestos	18 m2
Ceiling	Flat AC Sheet	Assumed Asbestos	36 m2

**OS 603 - D12514 - Learning Unit - Standard With P.A.A. A/C : Placement Date - 13/12/2012**

Note: This refurbished demountable may have asbestos present in remnant mastic in window frames.

### Exterior

No Asbestos Found.

### Interior

#### R1 - Learning space/withdrawal/entry

No Asbestos Found.

#### R2 - Home Base Store

No Asbestos Found.

Product	Material Description	Extent	Location Reference	Material Condition	Risk Status	Control Priority
Sample No					Test Result	
<b>OS 602 - D13856 - Learning Unit - Standard With P.A.A. : Placement Date - 17/11/2015</b>						
Note: This refurbished demountable may have asbestos present in remnant mastic in window frames.						
<b>Exterior</b>						
No Asbestos Found.						
<b>Interior</b>						
<b>R1 - Learning space/withdrawal/entry</b>						
No Asbestos Found.						
<b>R2 - Home Base Store</b>						
No Asbestos Found.						
<b>OS 602 - D14483 - Learning Unit - Standard With P.A.A. : Placement Date - 3/12/2016</b>						
<b>Exterior</b>						
No Asbestos Found.						
<b>Interior</b>						
<b>R1 - Learning space/withdrawal/entry</b>						
No Asbestos Found.						
<b>R2 - Home Base Store</b>						
No Asbestos Found.						
<b>OS 602 - D14926 - Learning Unit - Standard With P.A.A. : Placement Date - 8/01/2011</b>						
Note: This refurbished demountable may have asbestos present in remnant mastic in window frames.						
<b>Exterior</b>						
No Asbestos Found.						
<b>Interior</b>						
<b>R1 - Learning space/withdrawal/entry</b>						
No Asbestos Found.						
<b>R2 - Home Base Store</b>						
No Asbestos Found.						
<b>OS 602 - D18050 - Learning Unit - Standard With P.A.A. : Placement Date - 11/12/2008</b>						
Note: This refurbished demountable may have asbestos present in remnant mastic in window frames.						
<b>Exterior</b>						
No Asbestos Found.						
<b>Interior</b>						
<b>R1 - Learning space/withdrawal/entry</b>						
No Asbestos Found.						
<b>R2 - Home Base Store</b>						
No Asbestos Found.						

2017



Product	Material Description	Extent	Location Reference	Material Condition	Risk Status	Control Priority
Sample No					Test Result	

***Listing of Electronic Attachments as of 22/03/2017***

**Available Asbestos Related Electronic Files**

2308\_ASB\_030113\_AMP.pdf

\* Note : Refer to AMS for details of the attachment(s).

2017