

Asbestos Register

(Hazardous Materials and Risk Assessment)

School : Brooklyn Public School (1377)
Region : Northern Sydney
State Electorate : Hornsby
Local Government Area : Hornsby

Initial Survey : Noel Arnold & Associates : 30 - May - 2008
Register Issue Date : 22 - Mar - 2017

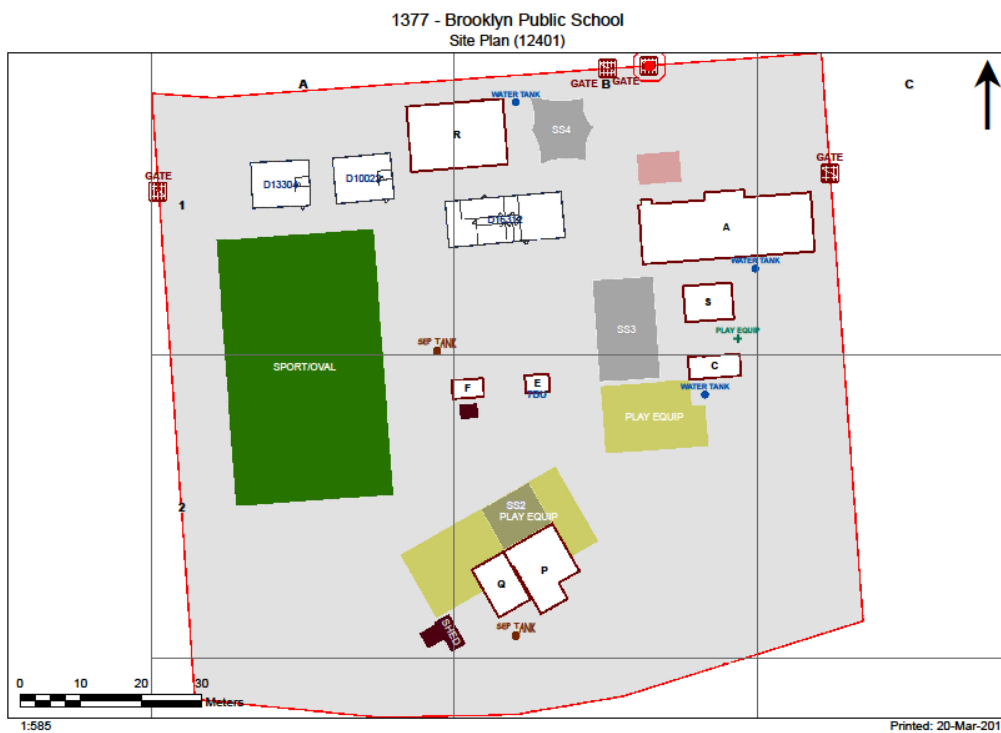

2017

Product	Material Description	Extent	Location Reference	Material Condition	Risk Status	Control Priority
Sample No					Test Result	

B00A - General Learning/Administration - 1928 - Brick/Block (Brick/Block)**Exterior**

Ceiling Voids	Requires Inspection
Underfloor Voids	Requires Inspection

Interior**B00A - R0001 - External Movement**

No Asbestos

B00A - R0002 - Entry Vestibule

Ceiling Structures/Linings	Flat AC Sheeting	3m2	All surfaces	Good Condition (1)	Low (1)	Low Priority (2-3)
1377/B00A/R0012/Ceiling Structures/Linings/S1					Chrysotile (white asbestos)	

B00A - R0003 - Clerical Office

Ceiling Structures/Linings	Flat AC Sheeting	10m2	All surfaces	Good Condition (1)	Low (1)	Low Priority (2-3)
1377/B00A/R0012/Ceiling Structures/Linings/S1					Chrysotile (white asbestos)	

B00A - R0004 - Principal

Ceiling Structures/Linings	Flat AC Sheeting	10m2	All surfaces	Good Condition (1)	Low (1)	Low Priority (2-3)
1377/B00A/R0012/Ceiling Structures/Linings/S1					Chrysotile (white asbestos)	

B00A - R0005 - Special Programs Room

Ceiling Structures/Linings	Flat AC Sheeting	48m2	All surfaces	Good Condition (1)	Low (1)	Low Priority (2-3)
1377/B00A/R0012/Ceiling Structures/Linings/S1					Chrysotile (white asbestos)	

B00A - R0006 - Home Base

Ceiling Structures/Linings	Flat AC Sheeting	48m2	All surfaces	Good Condition (1)	Low (1)	Low Priority (2-3)
1377/B00A/R0012/Ceiling Structures/Linings/S1					Chrysotile (white asbestos)	

B00A - R0007 - Home Base

Ceiling Structures/Linings	Flat AC Sheeting	48m2	All surfaces	Good Condition (1)	Low (1)	Low Priority (2-3)
1377/B00A/R0012/Ceiling Structures/Linings/S1					Chrysotile (white asbestos)	

B00A - R0008 - Staff Room

Ceiling Structures/Linings	Flat AC Sheeting	10m2	All surfaces	Good Condition (1)	Low (1)	Low Priority (2-3)
1377/B00A/R0012/Ceiling Structures/Linings/S1					Chrysotile (white asbestos)	

B00A - R0009 - General Storeroom

Ceiling Structures/Linings	Flat AC Sheeting	3m2	All surfaces	Good Condition (1)	Low (1)	Low Priority (2-3)
1377/B00A/R0012/Ceiling Structures/Linings/S1					Chrysotile (white asbestos)	

Floor Coverings Res/Textile	Vinyl Tiles	3m2	All surfaces	Good Condition (1)	Low (1)	Low Priority (2-3)
1377/B00A/R0009/Floor Coverings Res/Textile/S2					Chrysotile (white asbestos)	

Wall Linings Internal	Flat AC Sheeting	6m2	North facing, West facing	Good Condition (1)	Low (1)	Low Priority (2-3)
1377/B00A/R0009/Wall Linings Internal/S3					Chrysotile (white asbestos) , Amosite (brown asbestos)	

B00A - R0010 - Movement

Ceiling Structures/Linings	Flat AC Sheeting	3m2	All surfaces	Good Condition (1)	Low (1)	Low Priority (2-3)
1377/B00A/R0012/Ceiling Structures/Linings/S1					Chrysotile (white asbestos)	

Wall Linings Internal	Flat AC Sheeting	3m2	East facing	Good Condition (1)	Low (1)	Low Priority (2-3)
1377/B00A/R0009/Wall Linings Internal/S3					Chrysotile (white asbestos) , Amosite (brown asbestos)	

B00A - R0011 - Staff Room Annexe

Ceiling Structures/Linings	Flat AC Sheeting	7m2	All surfaces	Good Condition (1)	Low (1)	Low Priority (2-3)
1377/B00A/R0012/Ceiling Structures/Linings/S1					Chrysotile (white asbestos)	

Product	Material Description	Extent	Location Reference	Material Condition	Risk Status	Control Priority
Sample No					Test Result	
B00A - R0012 - Movement						
Ceiling Structures/Linings	Flat AC Sheeting	56m2	All surfaces	Good Condition (1)	Low (1)	Low Priority (2-3)
	1377/B00A/R0012/Ceiling Structures/Linings/S1					Chrysotile (white asbestos)
Panels Beneath Windows	Flat AC Sheeting	4m2	North facing	Good Condition (1)	Low (1)	Low Priority (2-3)
	1377/B00A/R0013/Panels Beneath Windows/S5					Chrysotile (white asbestos)
B00A - R0013 - External Movement						
Ceiling Structures/Linings	Flat AC Sheeting	9m2	All surfaces	Good Condition (1)	Low (1)	Low Priority (2-3)
	1377/B00A/R0013/Ceiling Structures/Linings/S4					Chrysotile (white asbestos)
Infill panels below windows	Flat AC Sheeting	4m2	South facing	Good Condition (1)	Low (1)	Low Priority (2-3)
	1377/B00A/R0013/Panels Beneath Windows/S5					Chrysotile (white asbestos)

2017

Product	Material Description	Extent	Location Reference	Material Condition	Risk Status	Control Priority
Sample No					Test Result	

B00B - Pupil Facilities - 1928 - Brick/Block (Brick/Block)

Exterior

Eaves Linings	Flat AC Sheeting	20m2	All surfaces	Good Condition (1)	Low (1)	Low Priority (2-3)
---------------	------------------	------	--------------	--------------------	---------	--------------------

Assumed Asbestos

Ceiling Voids	Requires Inspection					
---------------	---------------------	--	--	--	--	--

Underfloor Voids	Requires Inspection					
------------------	---------------------	--	--	--	--	--

Interior

B00B - R0001 - Drinking Facilities

Ceiling Structures/Linings	Flat AC Sheeting	8m2	All surfaces	Good Condition (1)	Low (1)	Low Priority (2-3)
----------------------------	------------------	-----	--------------	--------------------	---------	--------------------

1377/B00B/R0001/Ceiling Structures/Linings/S7

Chrysotile (white asbestos)

2017

Product	Material Description	Extent	Location Reference	Material Condition	Risk Status	Control Priority
Sample No					Test Result	

B00C - Pupil Facilities/Building Services - 1928 - Timber (Timber)

Exterior

Ceiling Voids	Requires Inspection
Underfloor Voids	Requires Inspection

Interior

B00C - R0001 - Canteen Covered Area

Ceiling Structures/Linings	Flat AC Sheeting	23m2	All surfaces	Good Condition (1)	Low (1)	Low Priority (2-3)
1377/B00C/R0001/Ceiling Structures/Linings/S6					Chrysotile (white asbestos)	

B00C - R0002 - Cleaning Distributed Store

Ceiling Structures/Linings	Flat AC Sheeting	8m2	All surfaces	Good Condition (1)	Low (1)	Low Priority (2-3)
1377/B00C/R0001/Ceiling Structures/Linings/S6					Chrysotile (white asbestos)	

2017

Product	Material Description	Extent	Location Reference	Material Condition	Risk Status	Control Priority
Sample No					Test Result	

B00D - Building Services - 1928 - Timber Shed (Timber Shed)

Exterior

Wall Cladding	Flat AC Sheeting 1377/B00D/Wall Cladding/S8	1m2	North facing, Lower portion	Some Damage / Unsealed (3)	Medium (2)	Medium Priority (4-5) Chrysotile (white asbestos)
Ceiling Voids	Requires Inspection					
Underfloor Voids	Requires Inspection					

Interior

B00D - R0001 - Garden Store

No Asbestos

2017

Product	Material Description	Extent	Location Reference	Material Condition	Risk Status	Control Priority
Sample No					Test Result	

B00E - Pupil Facilities - 1928 - Brick/Block (Brick/Block)

Exterior

Ceiling Voids	Requires Inspection
Underfloor Voids	Requires Inspection

Interior

B00E - R0001 - Toilets - Girls

No Asbestos

2017

Product	Material Description	Extent	Location Reference	Material Condition	Risk Status	Control Priority
Sample No					Test Result	

B00F - Pupil Facilities - 1928 - Brick/Block (Brick/Block)

Exterior

Ceiling Voids	Requires Inspection
Underfloor Voids	Requires Inspection

Interior

B00F - R0001 - Toilets - Boys

No Asbestos

2017

Product	Material Description	Extent	Location Reference	Material Condition	Risk Status	Control Priority
Sample No					Test Result	

B00P - Support Unit - 1928 - Brick/Veneer (Brick/Veneer)

Exterior

Ceiling Voids	Requires Inspection
Underfloor Voids	Requires Inspection

Interior

B00P - R0007 - Withdrawal - Pre

No Asbestos

B00P - R0009 - General Storeroom - Pre

No Asbestos

B00P - R0010 - Toilets - Boys/Girls - Pre

No Asbestos

B00P - R0011 - Kitchen - Pre

No Asbestos

B00P - R0012 - Staff Room - Pre

No Asbestos

B00P - R0013 - General Storeroom - Pre

No Asbestos

B00P - R0014 - Staff Toilet - Pre

No Asbestos

B00P - R0015 - Movement

No Asbestos

B00P - R0016 - Child Care Centre

No Asbestos

2017

Product	Material Description	Extent	Location Reference	Material Condition	Risk Status	Control Priority
Sample No					Test Result	

B00Q - Support Unit - 1928 - Brick/Veneer (Brick/Veneer)

Exterior

Ceiling Voids	Requires Inspection
Underfloor Voids	Requires Inspection

Interior

B00Q - R0001 - Laundry - Pre

No Asbestos

B00Q - R0002 - Toilets - Boys/Girls - Pre

No Asbestos

B00Q - R0003 - Child Care Centre

Vinyl Tiles (Under Floor Covering/Carpet) No Asbestos Found

B00Q - R0004 - Movement

No Asbestos

B00Q - R0005 - Staff Room - Pre

No Asbestos

B00Q - R0006 - Movement

No Asbestos

2017

Product	Material Description	Extent	Location Reference	Material Condition	Risk Status	Control Priority
Sample No					Test Result	

B00R - Library - 2010 - Fibre Cement Clad (Fibre Cement Clad)

Exterior

Ceiling Voids	No Asbestos Found
Underfloor Voids	Requires Inspection

Interior

B00R - R0001 - External Movement

No Asbestos

B00R - R0002 - Reading Area

No Asbestos

B00R - R0003 - Library Office/Workroom

No Asbestos

B00R - R0004 - Communications Room

No Asbestos

B00R - R0005 - K.L.A. Store

No Asbestos

2017

Product	Material Description	Extent	Location Reference	Material Condition	Risk Status	Control Priority
Sample No					Test Result	

Demountables

Demountable details as per the AMS records as of 15 Feb 2017.

OS 602 - D10022 - Learning Unit - Standard With P.A.A. : Placement Date - 24/12/2008

Note: This refurbished demountable may have asbestos present in remnant mastic in window frames.

Exterior

No Asbestos Found.

Interior

R1 - Learning space/withdrawal/entry

No Asbestos Found.

R2 - Home Base Store

No Asbestos Found.

OS 602 - D13304 - Learning Unit - Standard With P.A.A. : Placement Date - 21/02/2013

Note: This refurbished demountable may have asbestos present in remnant mastic in window frames.

Exterior

No Asbestos Found.

Interior

R1 - Learning space/withdrawal/entry

No Asbestos Found.

R2 - Home Base Store

No Asbestos Found.

OS 503 - D16312 - Admin Lib Staff/Principal/Clerk/Store : Placement Date - 17/11/1997

Exterior

Step Treads	Compressed AC Sheet	Assumed Asbestos	1.08 m2
Landing	Compressed AC Sheet	Assumed Asbestos	1.2 m2
Eave Lining	Flat AC Sheet	Assumed Asbestos	23.04 m2

Interior

R1 - Clerical Office

End wall panel	Flat AC Sheet	Assumed Asbestos	18 m2
Ceiling	Flat AC Sheet	Assumed Asbestos	24 m2

R2 - Principal

Ceiling	Flat AC Sheet	Assumed Asbestos	16 m2
---------	---------------	------------------	-------

R3 - Staff Toilet

Toilet partitions	Compressed AC Sheet	Assumed Asbestos	2 m2
Ceiling	Flat AC Sheet	Assumed Asbestos	5 m2

R4 - Staff Toilet

Toilet partitions	Compressed AC Sheet	Assumed Asbestos	2 m2
Ceiling	Flat AC Sheet	Assumed Asbestos	5 m2

R5 - Reading Area

Ceiling	Flat AC Sheet	Assumed Asbestos	55 m2
---------	---------------	------------------	-------

R6 - Security Store

Ceiling	Flat AC Sheet	Assumed Asbestos	8 m2
---------	---------------	------------------	------

R7 - Staff Room

Ceiling	Flat AC Sheet	Assumed Asbestos	27 m2
---------	---------------	------------------	-------

R8 - Entry

End wall panel	Flat AC Sheet	Assumed Asbestos	18 m2
Ceiling	Flat AC Sheet	Assumed Asbestos	6 m2

Product	Material Description	Extent	Location Reference	Material Condition	Risk Status	Control Priority
Sample No					Test Result	

Listing of Electronic Attachments as of 22/03/2017

Available Asbestos Related Electronic Files

1377_ASB_261112_AMP.pdf

* Note : Refer to AMS for details of the attachment(s).

2017