

Asbestos Register

(Hazardous Materials and Risk Assessment)

School : Blackheath Public School (1246)
Region : Western Sydney
State Electorate : Blue Mountains
Local Government Area : Blue Mountains

Initial Survey : Noel Arnold & Associates : 28 - May - 2015
Reviewed By : Parsons Brinckerhoff : 28 - May - 2015

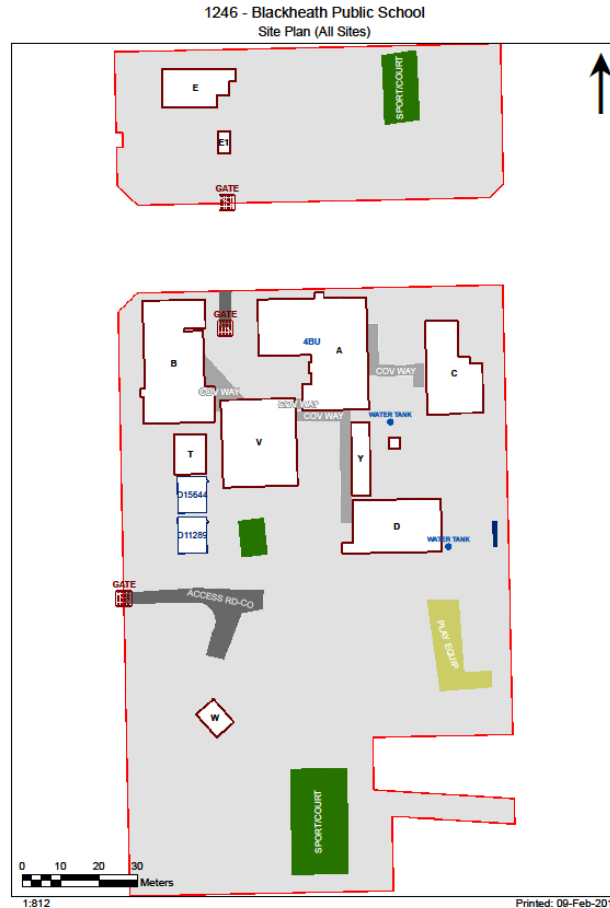

2017

Product	Material Description	Extent	Location Reference	Material Condition	Risk Status	Control Priority
Sample No				Test Result		

B00A - General Learning/Administration - 1975 - Brick/Block (Brick/Block)**Exterior**

Eaves Linings	Flat AC Sheeting	200m2	Throughout	Good Condition (1)	Low (1)	Low Priority (2-3)
	1246/B00C/Eaves Linings/S23					Chrysotile (white asbestos) , Amosite (brown asbestos) , Crocidolite (blue asbestos)
Ceiling Voids	No Asbestos Found					
Underfloor Voids	No Asbestos Found					

Interior**B00A - R0001 - Practical Activities (18.49 m2)**

Ceiling Structures/Linings	Vermiculite					Limited Samples Taken
	1246/B00A/R0009/Ceiling Structures/Linings/S1					Vermiculite Ceilings may contain asbestos. Asbestos testing MUST be conducted prior to any disturbance works
Floor Coverings Res/Textile	Vinyl Tiles	19m2	Throughout	Good Condition (1)	Low (1)	Low Priority (2-3)
	1246/B00A/R0015/Floor Coverings Res/Textile/S2					Chrysotile (white asbestos)

B00A - R0002 - Home Base (52.76 m2)

Ceiling Structures/Linings	Vermiculite					Limited Samples Taken
	1246/B00A/R0009/Ceiling Structures/Linings/S1					Vermiculite Ceilings may contain asbestos. Asbestos testing MUST be conducted prior to any disturbance works

B00A - R0003 - Toilets-Unisex (3.8 m2)

Ceiling Structures/Linings	Vermiculite					Limited Samples Taken
	1246/B00A/R0009/Ceiling Structures/Linings/S1					Vermiculite Ceilings may contain asbestos. Asbestos testing MUST be conducted prior to any disturbance works
Partition Walls (Cubicles)	Compressed AC Sheet	4m2	Throughout	Good Condition (1)	Low (1)	Low Priority (2-3)
	1246/B00A/R0010/Partition Walls (Cubicles)/S3					Chrysotile (white asbestos)

B00A - R0004 - General Storeroom (4.17 m2)

No Asbestos

B00A - R0006 - Home Base (52.76 m2)

Ceiling Structures/Linings	Vermiculite					Limited Samples Taken
	1246/B00A/R0009/Ceiling Structures/Linings/S1					Vermiculite Ceilings may contain asbestos. Asbestos testing MUST be conducted prior to any disturbance works

B00A - R0007 - Practical Activities (18.01 m2)

Ceiling Structures/Linings	Vermiculite					Limited Samples Taken
	1246/B00A/R0009/Ceiling Structures/Linings/S1					Vermiculite Ceilings may contain asbestos. Asbestos testing MUST be conducted prior to any disturbance works
Floor Coverings Res/Textile	Vinyl Tiles	18m2	Throughout	Good Condition (1)	Low (1)	Low Priority (2-3)
	1246/B00A/R0015/Floor Coverings Res/Textile/S2					Chrysotile (white asbestos)

B00A - R0009 - Duplicating Workroom (13.31 m2)

Ceiling Structures/Linings	Vermiculite					Limited Samples Taken
	1246/B00A/R0009/Ceiling Structures/Linings/S1					Vermiculite Ceilings may contain asbestos. Asbestos testing MUST be conducted prior to any disturbance works
Floor Coverings Res/Textile	Vinyl Tiles	14m2	Throughout	Good Condition (1)	Low (1)	Low Priority (2-3)
	1246/B00A/R0015/Floor Coverings Res/Textile/S2					Chrysotile (white asbestos)

B00A - R0010 - Staff Toilet (3.52 m2)

Ceiling Structures/Linings	Vermiculite					Limited Samples Taken
	1246/B00A/R0009/Ceiling Structures/Linings/S1					Vermiculite Ceilings may contain asbestos. Asbestos testing MUST be conducted prior to any disturbance works
Partition Walls (Cubicles)	Compressed AC Sheet	3m2	Throughout	Good Condition (1)	Low (1)	Low Priority (2-3)
	1246/B00A/R0010/Partition Walls (Cubicles)/S3					Chrysotile (white asbestos)

Product	Material Description	Extent	Location Reference	Material Condition	Risk Status	Control Priority
Sample No					Test Result	
B00A - R0011 - Sick Bay (13.19 m2)						
Ceiling Structures/Linings	Vermiculite					
	1246/B00A/R0009/Ceiling Structures/Linings/S1					Limited Samples Taken
<i>Vermiculite Ceilings may contain asbestos. Asbestos testing MUST be conducted prior to any disturbance works</i>						
B00A - R0012 - Deputy Principal (11.59 m2)						
Ceiling Structures/Linings	Vermiculite					
	1246/B00A/R0009/Ceiling Structures/Linings/S1					Limited Samples Taken
<i>Vermiculite Ceilings may contain asbestos. Asbestos testing MUST be conducted prior to any disturbance works</i>						
B00A - R0013 - Clerical Office (12.02 m2)						
Ceiling Structures/Linings	Vermiculite					
	1246/B00A/R0009/Ceiling Structures/Linings/S1					Limited Samples Taken
<i>Vermiculite Ceilings may contain asbestos. Asbestos testing MUST be conducted prior to any disturbance works</i>						
B00A - R0014 - Movement (10.8 m2)						
Ceiling Structures/Linings	Vermiculite					
	1246/B00A/R0009/Ceiling Structures/Linings/S1					Limited Samples Taken
<i>Vermiculite Ceilings may contain asbestos. Asbestos testing MUST be conducted prior to any disturbance works</i>						
B00A - R0015 - Security Store (13.15 m2)						
Ceiling Structures/Linings	Vermiculite					
	1246/B00A/R0009/Ceiling Structures/Linings/S1					Limited Samples Taken
<i>Vermiculite Ceilings may contain asbestos. Asbestos testing MUST be conducted prior to any disturbance works</i>						
Floor Coverings Res/Textile	Vinyl Tiles	14m2	Throughout	Good Condition (1)	Low (1)	Low Priority (2-3)
	1246/B00A/R0015/Floor Coverings Res/Textile/S2					Chrysotile (white asbestos)
B00A - R0016 - Entry Vestibule (19.99 m2)						
Ceiling Structures/Linings	Vermiculite					
	1246/B00A/R0009/Ceiling Structures/Linings/S1					Limited Samples Taken
<i>Vermiculite Ceilings may contain asbestos. Asbestos testing MUST be conducted prior to any disturbance works</i>						
B00A - R0017 - Movement (2.05 m2)						
No Asbestos						
B00A - R0018 - Principal (15.91 m2)						
Ceiling Structures/Linings	Vermiculite					
	1246/B00A/R0009/Ceiling Structures/Linings/S1					Limited Samples Taken
<i>Vermiculite Ceilings may contain asbestos. Asbestos testing MUST be conducted prior to any disturbance works</i>						
B00A - R0019 - General Storeroom (11.43 m2)						
Ceiling Structures/Linings	Vermiculite					
	1246/B00A/R0009/Ceiling Structures/Linings/S1					Limited Samples Taken
<i>Vermiculite Ceilings may contain asbestos. Asbestos testing MUST be conducted prior to any disturbance works</i>						
B00A - R0020 - Distribution Board Cupboard (1.6 m2)						
Note: No inspection of live electrical installation.						
Door Lining	Flat AC Sheeting	6m2	West	Good Condition (1)	Low (1)	Low Priority (2-3)
	1246/B00A/R0020/Door Lining/S4					Chrysotile (white asbestos)
Electrical Backing Board	Resinous Board	1Unit	South	Good Condition (1)	Low (1)	Low Priority (2-3)
	1246/B00A/R0020/Electrical Backing Board/S31					Chrysotile (white asbestos)
Ceiling Structures/Linings	Vermiculite					
	1246/B00A/R0032/Ceiling Structures/Linings/S32					Limited Samples Taken
<i>Vermiculite Ceilings may contain asbestos. Asbestos testing MUST be conducted prior to any disturbance works</i>						
B00A - R0021 - Cleaning Supplies Store (6.72 m2)						
No Asbestos						
B00A - R0023 - Canteen Office/Store (2.77 m2)						
Ceiling Structures/Linings	Vermiculite					
	1246/B00A/R0009/Ceiling Structures/Linings/S1					Limited Samples Taken
<i>Vermiculite Ceilings may contain asbestos. Asbestos testing MUST be conducted prior to any disturbance works</i>						

Product	Material Description	Extent	Location Reference	Material Condition	Risk Status	Control Priority
Sample No					Test Result	
Floor Coverings Res/Textile	Vinyl Tiles	3m2	Throughout	Good Condition (1)	Low (1)	Low Priority (2-3)
1246/B00A/R0015/Floor Coverings Res/Textile/S2					Chrysotile (white asbestos)	
B00A - R0024 - Staff Toilet (4.85 m2)						
Ceiling Structures/Linings	Vermiculite					
1246/B00A/R0009/Ceiling Structures/Linings/S1					Limited Samples Taken	
Vermiculite Ceilings may contain asbestos. Asbestos testing MUST be conducted prior to any disturbance works						
B00A - R0025 - Movement (2.68 m2)						
Ceiling Structures/Linings	Vermiculite					
1246/B00A/R0009/Ceiling Structures/Linings/S1					Limited Samples Taken	
Vermiculite Ceilings may contain asbestos. Asbestos testing MUST be conducted prior to any disturbance works						
Floor Coverings Res/Textile	Vinyl Tiles	3m2	Throughout	Good Condition (1)	Low (1)	Low Priority (2-3)
1246/B00A/R0015/Floor Coverings Res/Textile/S2					Chrysotile (white asbestos)	
B00A - R0026 - Movement (15.55 m2)						
No Asbestos						
B00A - R0027 - Covered Outdoor Learning Area (77.61 m2)						
No Asbestos						
B00A - R0028 - Covered Outdoor Learning Area (11.55 m2)						
No Asbestos						
B00A - R0029 - Movement (6.4 m2)						
In-fill-panel	Flat AC Sheeting					
1246/B00A/R0029/In-fill-panel/S5					No Asbestos Detected	
B00A - R0030 - Lift (2.1 m2)						
No Asbestos						
B00A - R0031 - Canteen (38.86 m2)						
No Asbestos						
B00A - R0032 - Movement (102.55 m2)						
Ceiling Structures/Linings	Vermiculite					
1246/B00A/R0032/Ceiling Structures/Linings/S32					Limited Samples Taken	
Vermiculite Ceilings may contain asbestos. Asbestos testing MUST be conducted prior to any disturbance works						
B00A - R1001 - Practical Activities (18 m2)						
Ceiling Structures/Linings	Vermiculite					
1246/B00A/R0009/Ceiling Structures/Linings/S1					Limited Samples Taken	
Vermiculite Ceilings may contain asbestos. Asbestos testing MUST be conducted prior to any disturbance works						
Floor Coverings Res/Textile	Vinyl Tiles	18m2	Throughout	Good Condition (1)	Low (1)	Low Priority (2-3)
1246/B00A/R0015/Floor Coverings Res/Textile/S2					Chrysotile (white asbestos)	
B00A - R1002 - Home Base (52.84 m2)						
Ceiling Structures/Linings	Vermiculite					
1246/B00A/R0009/Ceiling Structures/Linings/S1					Limited Samples Taken	
Vermiculite Ceilings may contain asbestos. Asbestos testing MUST be conducted prior to any disturbance works						
B00A - R1003 - Toilets - Girls (4.47 m2)						
Ceiling Structures/Linings	Vermiculite					
1246/B00A/R0009/Ceiling Structures/Linings/S1					Limited Samples Taken	
Vermiculite Ceilings may contain asbestos. Asbestos testing MUST be conducted prior to any disturbance works						
Partition Walls (Cubicles)	Compressed AC Sheet	3m2	Throughout	Good Condition (1)	Low (1)	Low Priority (2-3)
1246/B00A/R0010/Partition Walls (Cubicles)/S3					Chrysotile (white asbestos)	
B00A - R1004 - Movement (35.27 m2)						
Ceiling Structures/Linings	Vermiculite					
1246/B00A/R0009/Ceiling Structures/Linings/S1					Limited Samples Taken	
Vermiculite Ceilings may contain asbestos. Asbestos testing MUST be conducted prior to any disturbance works						

Product	Material Description	Extent	Location Reference	Material Condition	Risk Status	Control Priority
Sample No				Test Result		
Floor Coverings Res/Textile	Vinyl Tiles	36m2	Throughout	Good Condition (1)	Low (1)	Low Priority (2-3)
	1246/B00A/R0015/Floor Coverings Res/Textile/S2				Chrysotile (white asbestos)	
B00A - R1005 - Home Base (52.64 m2)						
Ceiling Structures/Linings	Vermiculite					Limited Samples Taken
	1246/B00A/R0009/Ceiling Structures/Linings/S1				Vermiculite Ceilings may contain asbestos. Asbestos testing MUST be conducted prior to any disturbance works	
B00A - R1006 - Practical Activities (17.68 m2)						
Ceiling Structures/Linings	Vermiculite					Limited Samples Taken
	1246/B00A/R0009/Ceiling Structures/Linings/S1				Vermiculite Ceilings may contain asbestos. Asbestos testing MUST be conducted prior to any disturbance works	
Floor Coverings Res/Textile	Vinyl Tiles	18m2	Throughout	Good Condition (1)	Low (1)	Low Priority (2-3)
	1246/B00A/R0015/Floor Coverings Res/Textile/S2				Chrysotile (white asbestos)	
B00A - R1007 - Reading Area (145.07 m2)						
Ceiling Structures/Linings	Vermiculite					Limited Samples Taken
	1246/B00A/R0009/Ceiling Structures/Linings/S1				Vermiculite Ceilings may contain asbestos. Asbestos testing MUST be conducted prior to any disturbance works	
B00A - R1008 - Library Office/Workroom (13.99 m2)						
Ceiling Structures/Linings	Vermiculite					Limited Samples Taken
	1246/B00A/R0009/Ceiling Structures/Linings/S1				Vermiculite Ceilings may contain asbestos. Asbestos testing MUST be conducted prior to any disturbance works	
B00A - R1009 - Audio Visual Workroom (9.22 m2)						
Ceiling Structures/Linings	Vermiculite					Limited Samples Taken
	1246/B00A/R0009/Ceiling Structures/Linings/S1				Vermiculite Ceilings may contain asbestos. Asbestos testing MUST be conducted prior to any disturbance works	
Floor Coverings Res/Textile	Vinyl Tiles	10m2	Throughout	Good Condition (1)	Low (1)	Low Priority (2-3)
	1246/B00A/R0015/Floor Coverings Res/Textile/S2				Chrysotile (white asbestos)	
B00A - R1010 - Distribution Board Cupboard (0.85 m2)						
	Note: No inspection of live electrical installation.					
Door Lining	Flat AC Sheeting	6m2	North	Good Condition (1)	Low (1)	Low Priority (2-3)
	1246/B00A/R0020/Door Lining/S4				Chrysotile (white asbestos)	
Ceiling Structures/Linings	Flat AC Sheeting	1m2	Throughout	Good Condition (1)	Low (1)	Low Priority (2-3)
	1246/B00A/R1010/Ceiling Structures/Linings/S27				Chrysotile (white asbestos)	
B00A - R1011 - General Storeroom (8.79 m2)						
Ceiling Structures/Linings	Vermiculite					Limited Samples Taken
	1246/B00A/R0009/Ceiling Structures/Linings/S1				Vermiculite Ceilings may contain asbestos. Asbestos testing MUST be conducted prior to any disturbance works	
Floor Coverings Res/Textile	Vinyl Tiles	9m2	Throughout	Good Condition (1)	Low (1)	Low Priority (2-3)
	1246/B00A/R0015/Floor Coverings Res/Textile/S2				Chrysotile (white asbestos)	
B00A - R1012 - Movement (14.22 m2)						
Ceiling Structures/Linings	Vermiculite					Limited Samples Taken
	1246/B00A/R0009/Ceiling Structures/Linings/S1				Vermiculite Ceilings may contain asbestos. Asbestos testing MUST be conducted prior to any disturbance works	
Floor Coverings Res/Textile	Vinyl Tiles	15m2	Throughout	Good Condition (1)	Low (1)	Low Priority (2-3)
	1246/B00A/R0015/Floor Coverings Res/Textile/S2				Chrysotile (white asbestos)	
B00A - R1013 - Cleaning Distributed Store (0.89 m2)						
Ceiling Structures/Linings	Flat AC Sheeting	1m2	Throughout	Good Condition (1)	Low (1)	Low Priority (2-3)
	1246/B00A/R1010/Ceiling Structures/Linings/S27				Chrysotile (white asbestos)	

Product	Material Description	Extent	Location Reference	Material Condition	Risk Status	Control Priority
Sample No				Test Result		
Floor Coverings Res/Textile	Vinyl Tiles	1m2	Throughout	Good Condition (1)	Low (1)	Low Priority (2-3)
1246/B00A/R0015/Floor Coverings Res/Textile/S2				Chrysotile (white asbestos)		
B00A - R1014 - Staff Toilet (4.17 m2)						
Ceiling Structures/Linings	Vermiculite					Limited Samples Taken
1246/B00A/R0009/Ceiling Structures/Linings/S1				Vermiculite Ceilings may contain asbestos. Asbestos testing MUST be conducted prior to any disturbance works		
Partition Walls (Cubicles)	Compressed AC Sheet	3m2	Throughout	Good Condition (1)	Low (1)	Low Priority (2-3)
1246/B00A/R0010/Partition Walls (Cubicles)/S3				Chrysotile (white asbestos)		
B00A - R1015 - Staff Toilet (4.05 m2)						
Ceiling Structures/Linings	Vermiculite					Limited Samples Taken
1246/B00A/R0009/Ceiling Structures/Linings/S1				Vermiculite Ceilings may contain asbestos. Asbestos testing MUST be conducted prior to any disturbance works		
Partition Walls (Cubicles)	Compressed AC Sheet	3m2	Throughout	Good Condition (1)	Low (1)	Low Priority (2-3)
1246/B00A/R0010/Partition Walls (Cubicles)/S3				Chrysotile (white asbestos)		
B00A - R1016 - Interview (13.99 m2)						
Ceiling Structures/Linings	Vermiculite					Limited Samples Taken
1246/B00A/R0009/Ceiling Structures/Linings/S1				Vermiculite Ceilings may contain asbestos. Asbestos testing MUST be conducted prior to any disturbance works		
B00A - R1017 - Reading Area (36.96 m2)						
Ceiling Structures/Linings	Vermiculite					Limited Samples Taken
1246/B00A/R0009/Ceiling Structures/Linings/S1				Vermiculite Ceilings may contain asbestos. Asbestos testing MUST be conducted prior to any disturbance works		
B00A - R1018 - Lift (2.1 m2)						
No Asbestos						
B00A - R1019 - Movement (6.2 m2)						
No Asbestos						

2017

Product	Material Description	Extent	Location Reference	Material Condition	Risk Status	Control Priority
Sample No					Test Result	

B00B - General Learning - 1895 - Brick/Block (Brick/Block)**Exterior**

Eaves Linings	Flat AC Sheeting	100m2	Throughout	Good Condition (1)	Low (1)	Low Priority (2-3)
	1246/B00B/Eaves Linings/S22					Chrysotile (white asbestos) , Amosite (brown asbestos) , Crocidolite (blue asbestos)
Ceiling Voids	Infill panels to Skylights	10m2	Above R0003	Some Damage - Unsealed (3)	Low (1)	Medium Priority (4-5)
	1246/B00B/R0003/In-fill-panel/S20					Chrysotile (white asbestos) , Amosite (brown asbestos)
Underfloor Voids	No Asbestos Found					

Interior**B00B - R0001 - Movement (31.89 m2)**

No Asbestos

B00B - R0002 - Home Base (47.58 m2)

No Asbestos

B00B - R0003 - Movement (56.32 m2)

In-fill-panel	Flat AC Sheeting	10m	Around Skylight	Good Condition (1)	Low (1)	Low Priority (2-3)
	1246/B00B/R0003/In-fill-panel/S20					Chrysotile (white asbestos) , Amosite (brown asbestos)

B00B - R0005 - Practical Activities - 1hb (28.98 m2)

Wall Linings Internal	Flat AC Sheeting	30m2	East	Good Condition (1)	Low (1)	Low Priority (2-3)
	1246/B00B/R0005/Wall Linings Internal/S6					Chrysotile (white asbestos)
Floor Coverings Res/Textile	Vinyl Tiles					No Asbestos Detected
	1246/B00B/R0005/Floor Coverings Res/Textile/S7					

B00B - R0008 - Movement (1.74 m2)

Ceiling Structures/Linings	Flat AC Sheeting					No Asbestos Detected
	1246/B00B/R0008/Ceiling Structures/Linings/S29					

B00B - R0009 - Home Base (54.68 m2)

No Asbestos

B00B - R0010 - Home Base (54.73 m2)

Ceiling Structures/Linings	Flat AC Sheeting	55m2	Throughout	Good Condition (1)	Low (1)	Low Priority (2-3)
	1246/B00B/R0010/Ceiling Structures/Linings/S28					Chrysotile (white asbestos)

B00B - R0012 - Withdrawal Space - 2hb (46.89 m2)

No Asbestos

B00B - R0013 - Home Base (64.57 m2)

No Asbestos

B00B - R0014 - Home Base Store (19.49 m2)

Wall Linings Internal	Flat AC Sheeting	30m2	West	Good Condition (1)	Low (1)	Low Priority (2-3)
	1246/B00B/R0005/Wall Linings Internal/S6					Chrysotile (white asbestos)

B00B - R0015 - External Movement (71.66 m2)

No Asbestos

Product	Material Description	Extent	Location Reference	Material Condition	Risk Status	Control Priority
Sample No				Test Result		

B00C - General Learning - 1964 - Brick/Veneer (Brick/Veneer)**Exterior**

In-fill-panel	Flat AC Sheeting	4m2	East	Good Condition (1)	Low (1)	Low Priority (2-3)
	1246/B00C/In-fill-panel/S18					Chrysotile (white asbestos)
Eaves Linings	Flat AC Sheeting	80m2	Throughout	Good Condition (1)	Low (1)	Low Priority (2-3)
	1246/B00C/Eaves Linings/S23					Chrysotile (white asbestos) , Amosite (brown asbestos) , Crocidolite (blue asbestos)
Gable Verge Lining	Flat AC Sheeting	10m2	North, South	Good Condition (1)	Low (1)	Low Priority (2-3)
	1246/B00C/Gable Verge Lining/S24					Chrysotile (white asbestos) , Amosite (brown asbestos) , Crocidolite (blue asbestos)
Gable Ends	Flat AC Sheeting	20m2	South	Minimal Damage (2)	Low (1)	Low Priority (2-3)
	1246/B00C/Gable Ends/S25					Chrysotile (white asbestos) , Amosite (brown asbestos) , Crocidolite (blue asbestos)
Ceiling Voids	No Asbestos Found					
Underfloor Voids	No Asbestos Found					

Interior**B00C - R0001 - Outdoor Learning Area (79.48 m2)**

Ceiling Structures/Linings	Flat AC Sheeting	80m2	North	Good Condition (1)	Low (1)	Low Priority (2-3)
	1246/B00C/R0001/Ceiling Structures/Linings/S11					Chrysotile (white asbestos) , Amosite (brown asbestos)

B00C - R0002 - Home Base (86.96 m2)

Heater Surround	Flat AC Sheeting	2m2	South, East	Good Condition (1)	Low (1)	Low Priority (2-3)
	1246/B00C/R0002/Heater Surround/S12					Chrysotile (white asbestos)

B00C - R0003 - Movement (12.08 m2)

Ceiling Structures/Linings	Vermiculite					Limited Samples Taken
	1246/B00C/R0003/Ceiling Structures/Linings/S13					Vermiculite Ceilings may contain asbestos. Asbestos testing MUST be conducted prior to any disturbance works

B00C - R0004 - Toilets-Unisex (1.92 m2)

Ceiling Structures/Linings	Vermiculite					Limited Samples Taken
	1246/B00C/R0004/Ceiling Structures/Linings/S13					Vermiculite Ceilings may contain asbestos. Asbestos testing MUST be conducted prior to any disturbance works

Wall Linings Internal	Flat AC Sheeting	5m2	Throughout, Lower portion	Good Condition (1)	Low (1)	Low Priority (2-3)
	1246/B00C/R0004/Wall Linings Internal/S14					Chrysotile (white asbestos)

B00C - R0005 - Distribution Board Cupboard (0.33 m2)

Note: No inspection of live electrical installation.

Wall Linings Internal	Flat AC Sheeting	4m2	Throughout	Good Condition (1)	Low (1)	Low Priority (2-3)
	1246/B00C/R0005/Wall Linings Internal/S15					Chrysotile (white asbestos)
Ceiling Structures/Linings	Flat AC Sheeting	1m2	Throughout	Some Damage - Unsealed (3)	Low (1)	Medium Priority (4-5)
	1246/B00C/R0005/Ceiling Structures/Linings/S30					Chrysotile (white asbestos)
Electrical Backing Board	Resinous Board	1Unit	North	Good Condition (1)	Low (1)	Low Priority (2-3)
	1246/B00A/R0020/Electrical Backing Board/S31					Chrysotile (white asbestos)

B00C - R0006 - General Storeroom (2.18 m2)

No Asbestos

B00C - R0007 - Toilets-Unisex (3.25 m2)

Ceiling Structures/Linings	Vermiculite					Limited Samples Taken
	1246/B00C/R0007/Ceiling Structures/Linings/S13					Vermiculite Ceilings may contain asbestos. Asbestos testing MUST be conducted prior to any disturbance works

Product	Material Description	Extent	Location Reference	Material Condition	Risk Status	Control Priority
Sample No					Test Result	
Floor Coverings Res/Textile	Vinyl Tiles	4m2	Throughout	Good Condition (1)	Low (1)	Low Priority (2-3)
1246/B00C/R0007/Floor Coverings Res/Textile/S16					Chrysotile (white asbestos)	
B00C - R0008 - Practical Activities (14.63 m2)						
Ceiling Structures/Linings	Vermiculite					Limited Samples Taken
1246/B00C/R0003/Ceiling Structures/Linings/S13					Vermiculite Ceilings may contain asbestos. Asbestos testing MUST be conducted prior to any disturbance works	
Floor Coverings Res/Textile	Vinyl Tiles	15m2	Throughout	Good Condition (1)	Low (1)	Low Priority (2-3)
1246/B00C/R0008/Floor Coverings Res/Textile/S17					Chrysotile (white asbestos)	
B00C - R0009 - Home Base (66.66 m2)						
Ceiling Structures/Linings	Vermiculite					Limited Samples Taken
1246/B00C/R0003/Ceiling Structures/Linings/S13					Vermiculite Ceilings may contain asbestos. Asbestos testing MUST be conducted prior to any disturbance works	

2017

Product	Material Description	Extent	Location Reference	Material Condition	Risk Status	Control Priority
	Sample No					Test Result

B00D - General Learning - 2010 - Brick/Veneer (Brick/Veneer)**Exterior**

Ceiling Voids	No Asbestos Found
Underfloor Voids	No Asbestos Found

Interior**B00D - R0001 - External Movement (78.22 m2)**

No Asbestos

B00D - R0002 - Practical Activities - 1hb (18.61 m2)

No Asbestos

B00D - R0003 - Home Base Store (6.22 m2)

No Asbestos

B00D - R0004 - Home Base (59.61 m2)

No Asbestos

B00D - R0005 - Withdrawal Space - 2hb (11.34 m2)

No Asbestos

B00D - R0006 - Home Base (59.61 m2)

No Asbestos

B00D - R0007 - Home Base Store (6.22 m2)

No Asbestos

B00D - R0008 - Practical Activities - 1hb (18.58 m2)

No Asbestos

B00D - R0009 - Special Programs Room (33.35 m2)

No Asbestos

B00D - R0010 - Special Programs Store (6.3 m2)

No Asbestos

2017

Product	Material Description	Extent	Location Reference	Material Condition	Risk Status	Control Priority
	Sample No					Test Result

B00E - Residential Facilities - 1960 - Brick/Block (Brick/Block)**Exterior**

Ceiling Void	Requires Inspection
Underfloor Void	Requires Inspection

Interior**B00E - R0001 - Residence - Movement (7.96 m2)**

Recently Modified Space Requires Inspection

B00E - R0002 - Residence - Bedroom (14.67 m2)

Recently Modified Space Requires Inspection

B00E - R0003 - Residence - Movement (4.41 m2)

Recently Modified Space Requires Inspection

B00E - R0004 - Residence - Bedroom (14.91 m2)

Recently Modified Space Requires Inspection

B00E - R0005 - Residence - Bedroom (14.91 m2)

Recently Modified Space Requires Inspection

B00E - R0006 - Residence - Living (17.88 m2)

Recently Modified Space Requires Inspection

B00E - R0007 - Residence - Kitchen (12.3 m2)

Recently Modified Space Requires Inspection

B00E - R0008 - Residence - Movement (7.4 m2)

Recently Modified Space Requires Inspection

B00E - R0009 - Residence - Bedroom (12.93 m2)

Recently Modified Space Requires Inspection

B00E - R0010 - Residence - Dining (11.91 m2)

Recently Modified Space Requires Inspection

B00E - R0011 - Residence - Movement (8.32 m2)

Recently Modified Space Requires Inspection

B00E - R0012 - Residence - Toilet (3.39 m2)

Recently Modified Space Requires Inspection

B00E - R0013 - Residence - Other (2.84 m2)

Recently Modified Space Requires Inspection

B00E - R0014 - Residence - Movement (3.06 m2)

Recently Modified Space Requires Inspection

B00E - R0015 - Residence - Toilet (1.56 m2)

Recently Modified Space Requires Inspection

2017

Product	Material Description	Extent	Location Reference	Material Condition	Risk Status	Control Priority
Sample No					Test Result	

B00T - General Learning - 1964 - Timber (Timber)

Exterior

Underfloor Voids	Flat AC Sheeting to Ceiling 1246/B00T/Underfloor Voids/S19					No Asbestos Detected
Ceiling Voids	No Asbestos Found					

Interior

B00T - R0001 - Movement (12.32 m2)

No Asbestos

B00T - R0002 - Staff Room (47.08 m2)

No Asbestos

B00T - R0003 - Out Of School Hours Care Centre (11.59 m2)

No Asbestos

B00T - R0004 - Toilets - Girls (5.38 m2)

No Asbestos

B00T - R0005 - Toilets - Boys (5.38 m2)

No Asbestos

2017

Product	Material Description	Extent	Location Reference	Material Condition	Risk Status	Control Priority
Sample No					Test Result	

B00V - Communal Facilities/Pupil Facilities - 1964 - Brick/Veneer (Brick/Veneer)**Exterior**

Eaves Linings	Flat AC Sheeting 1246/B00V/Eaves Linings/S21					No Asbestos Detected
Gable Ends	Flat AC Sheeting 1246/B00V/Gable Ends/S26					No Asbestos Detected
Ceiling Voids	No Asbestos Found					
Underfloor Voids	No Asbestos Found					
Roof	AC Fragments/Debris 1246/B00V/Gable Ends/S26					No Asbestos Detected

Interior**B00V - R0001 - Movement (108.8 m2)**

No Asbestos

B00V - R0002 - Communal Space (189.89 m2)

No Asbestos

B00V - R0003 - Control Room (0.32 m2)

No Asbestos

B00V - R0004 - Distribution Board Cupboard (0.32 m2)

Note: No inspection of live electrical installation.

No Asbestos

B00V - R0005 - Plant (0.32 m2)

No Asbestos

B00V - R0006 - Staff Kitchen (8.28 m2)

No Asbestos

B00V - R0007 - Chair Store (9.7 m2)

No Asbestos

B00V - R0008 - P.E. Store (11.24 m2)

No Asbestos

B00V - R0009 - Movement (2.85 m2)

No Asbestos

B00V - R0010 - Toilets - Boys (2.95 m2)

No Asbestos

B00V - R0011 - Stage (20.9 m2)

No Asbestos

B00V - R0012 - No Access (3.57 m2)

No Asbestos

B00V - R0013 - Toilets - Girls (2.96 m2)

No Asbestos

B00V - R0014 - General Assistants (12.78 m2)

No Asbestos

B00V - R0015 - Sports Store (12.45 m2)

No Asbestos

B00V - R0016 - Garden Store (6.31 m2)

No Asbestos

B00V - R0017 - Disabled Toilet (5.18 m2)

No Asbestos

Product	Material Description	Extent	Location Reference	Material Condition	Risk Status	Control Priority
Sample No					Test Result	

B00W - Pupil Facilities - 1986 - Timber (Timber)

Exterior

Ceiling Voids	No Asbestos Found
Underfloor Voids	No Asbestos Found

Interior

B00W - R0001 - Covered Area (45.26 m2)

No Asbestos

2017

Product	Material Description	Extent	Location Reference	Material Condition	Risk Status	Control Priority
Sample No					Test Result	

B00Y - Pupil Facilities - 1975 - Brick/Block (Brick/Block)**Exterior**

Ceiling Voids	No Asbestos Found
Underfloor Voids	No Asbestos Found

Interior**B00Y - R0001 - Toilets - Girls (21.25 m2)**

No Asbestos

B00Y - R0002 - Drinking Facilities (18.27 m2)

No Asbestos

B00Y - R0003 - Toilets - Boys (21.35 m2)

No Asbestos

B00Y - R0004 - Toilets-Unisex (14.62 m2)

No Asbestos

2017

Product	Material Description	Extent	Location Reference	Material Condition	Risk Status	Control Priority
Sample No					Test Result	

B0AA - Administration - 2010 - Metal Shed (Metal Shed)

Exterior

Ceiling Voids No Asbestos Found

Underfloor Voids No Asbestos Found

Interior

B0AA - R0001 - General Storeroom (8.71 m2)

No Asbestos

2017

Product	Material Description	Extent	Location Reference	Material Condition	Risk Status	Control Priority
Sample No					Test Result	

B0E1 - Residential Facilities - 1960 - Brick Shed (Brick Shed)

Exterior

Ceiling Void	Requires Inspection
Underfloor Void	Requires Inspection

Interior

B0E1 - R0001 - Residence - Garage (17.37 m2)

Recently Modified Space	Requires Inspection
-------------------------	---------------------

2017

Product	Material Description	Extent	Location Reference	Material Condition	Risk Status	Control Priority
Sample No					Test Result	

Demountables

Demountable details as per the AMS records as of 15 Feb 2017.

OS 602 - D11289 - Learning Unit - Standard With P.A.A. : Placement Date - 21/01/2014

Note: This refurbished demountable may have asbestos present in remnant mastic in window frames.

Exterior

No Asbestos Found.

Interior

R1 - Learning space/withdrawal/entry

No Asbestos Found.

R2 - Home Base Store

No Asbestos Found.

OS 602 - D15644 - Learning Unit - Standard With P.A.A. : Placement Date - 12/03/2010

Exterior

Step Treads	Compressed AC Sheet	Assumed Asbestos	1.08 m2
Landing	Compressed AC Sheet	Assumed Asbestos	1.2 m2
Eave Lining	Flat AC Sheet	Assumed Asbestos	11.52 m2

Interior

R1 - Learning space/withdrawal/entry

Ceiling	Flat AC Sheet	Assumed Asbestos	70 m2
---------	---------------	------------------	-------

R2 - Home Base Store

End wall panel	Flat AC Sheet	Assumed Asbestos	18 m2
Ceiling	Flat AC Sheet	Assumed Asbestos	3 m2

2017

Product	Material Description	Extent	Location Reference	Material Condition	Risk Status	Control Priority
Sample No					Test Result	

Listing of Electronic Attachments as of 22/03/2017

Available Asbestos Related Electronic Files

1246_ASB_150514_AMP.pdf

* Note : Refer to AMS for details of the attachment(s).

2017