

Asbestos Register

(Hazardous Materials and Risk Assessment)

School : Bellbrook Public School (1178)
Region : North Coast
State Electorate : Oxley
Local Government Area : Kempsey

Initial Survey : Noel Arnold & Associates : 24 - Apr - 2008
Register Issue Date : 22 - Mar - 2017

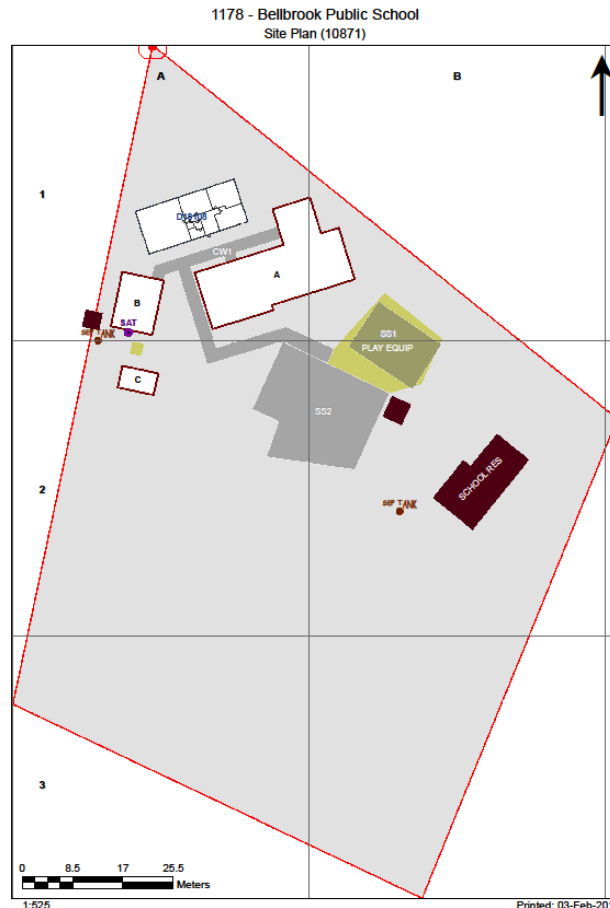

2017

Product	Material Description	Extent	Location Reference	Material Condition	Risk Status	Control Priority
Sample No					Test Result	

B00A - General Learning - 1913 - Timber (Timber)**Exterior**

Eaves Linings	Flat AC Sheeting	60m2	Throughout	Good Condition (1)	Low (1)	Low Priority (2-3)
	Assumed Asbestos					
Ceiling Voids	Requires Inspection					
Underfloor Voids	Requires Inspection					

Interior**B00A - R0001 - Cleaning Distributed Store**

Floor Coverings Res/Textile	Vinyl Tiles				
	1178/B00A/R0001/Floor Coverings Res/Textile/S1	No Asbestos Detected			
Wall Linings Internal	Flat AC Sheeting				
	1178/B00A/R0001/Wall Linings Internal/S2	No Asbestos Detected			

B00A - R0002 - Practical Activities - 1hb

Floor Coverings Res/Textile	Vinyl Tiles				
	1178/B00A/R0001/Floor Coverings Res/Textile/S1	No Asbestos Detected			

B00A - R0003 - Entry Vestibule

Floor Coverings Res/Textile	Vinyl Tiles				
	1178/B00A/R0001/Floor Coverings Res/Textile/S1	No Asbestos Detected			

B00A - R0004 - Practical Activities - 1hb

Floor Coverings Res/Textile	Vinyl Tiles					
	1178/B00A/R0001/Floor Coverings Res/Textile/S1	No Asbestos Detected				
Wall Linings Internal	Flat AC Sheeting					
	1178/B00A/R0001/Wall Linings Internal/S2	No Asbestos Detected				
Ceiling Structures/Linings	Flat AC Sheeting	24m2	Throughout	Good Condition (1)	Low (1)	Low Priority (2-3)
	1178/B00A/R0004/Ceiling Structures/Linings/S11				Chrysotile (white asbestos)	

B00A - R0005 - Home Base

Wall Linings Internal	Flat AC Sheeting	2m2	Southeast Corner	Minimal Damage (2)	Low (1)	Low Priority (2-3)
	1178/B00A/R0005/Wall Linings Internal/S3				Chrysotile (white asbestos)	

B00A - R0006 - Duplicating Workroom

No Asbestos

B00A - R0007 - Clerical Office

No Asbestos

B00A - R0008 - Sick Bay

No Asbestos

B00A - R0009 - Reading Area

No Asbestos

B00A - R0010 - Canteen

Floor Coverings Res/Textile	Vinyl Tiles				
	1178/B00A/R0001/Floor Coverings Res/Textile/S1	No Asbestos Detected			
Wall Linings Internal	Flat AC Sheeting				
	1178/B00A/R0001/Wall Linings Internal/S2	No Asbestos Detected			

B00A - R0011 - Home Base

Wall Linings Internal	Flat AC Sheeting	2m2	Northwest Corner	Good Condition (1)	Low (1)	Low Priority (2-3)
	1178/B00A/R0005/Wall Linings Internal/S3				Chrysotile (white asbestos)	

B00A - R0012 - External Movement

No Asbestos

Product	Material Description	Extent	Location Reference	Material Condition	Risk Status	Control Priority
Sample No					Test Result	

B00B - Pupil Facilities - 1978 - Brick/Block (Brick/Block)**Exterior**

Flue	Fibre Cement Pipe	5m	West	Good Condition (1)	Low (1)	Low Priority (2-3)
	1178/B00B/Air Vent Pipe/S4					Chrysotile (white asbestos)
Eaves Linings	Flat AC Sheeting	16m2	Throughout	Good Condition (1)	Low (1)	Low Priority (2-3)
	1178/B00B/Eaves Linings/S5					Chrysotile (white asbestos)
Ceiling Voids	Requires Inspection					
Underfloor Voids	Requires Inspection					

Interior**B00B - R0001 - Staff Toilet**

Ceiling Structures/Linings	Flat AC Sheeting	3m2	Throughout	Good Condition (1)	Low (1)	Low Priority (2-3)
	1178/B00B/R0001/Ceiling Structures/Linings/S6					Chrysotile (white asbestos)

B00B - R0002 - Toilets - Girls

Ceiling Structures/Linings	Flat AC Sheeting	18m2	Throughout	Good Condition (1)	Low (1)	Low Priority (2-3)
	1178/B00B/R0002/Ceiling Structures/Linings/S9					Chrysotile (white asbestos)
Partition Walls (Cubicles)	Flat AC Sheeting	2m2	Throughout	Some Damage / Unsealed (3)	Medium (2)	Low Priority (2-3)
	1178/B00B/R0002/Partition Walls (Cubicles)/S10					Chrysotile (white asbestos)

B00B - R0003 - External Movement

Ceiling Structures/Linings	Flat AC Sheeting	17m2	Throughout	Good Condition (1)	Low (1)	Low Priority (2-3)
	1178/B00B/R0002/Ceiling Structures/Linings/S9					Chrysotile (white asbestos)

B00B - R0004 - Toilets - Boys

Ceiling Structures/Linings	Flat AC Sheeting	20m2	Throughout	Good Condition (1)	Low (1)	Low Priority (2-3)
	1178/B00B/R0002/Ceiling Structures/Linings/S9					Chrysotile (white asbestos)
Partition Walls (Cubicles)	Flat AC Sheeting	2m2	Throughout	Some Damage / Unsealed (3)	Medium (2)	Low Priority (2-3)
	1178/B00B/R0002/Partition Walls (Cubicles)/S10					Chrysotile (white asbestos)

2017

Product	Material Description	Extent	Location Reference	Material Condition	Risk Status	Control Priority
Sample No					Test Result	

B00C - Administration - 1952 - Timber Shed (Timber Shed)

Exterior

Eaves Linings	Flat AC Sheeting 1178/B00C/Eaves Linings/S8					No Asbestos Detected
Ceiling Voids	Requires Inspection					
Underfloor Voids	Requires Inspection					

Interior

B00C - R0001 - Sports Store

Floor Coverings Res/Textile	Vinyl Tiles 1178/B00C/R0001/Floor Coverings Res/Textile/S7					No Asbestos Detected
--------------------------------	---	--	--	--	--	-----------------------------

2017

Product	Material Description	Extent	Location Reference	Material Condition	Risk Status	Control Priority
Sample No					Test Result	

Demountables

Demountable details as per the AMS records as of 15 Feb 2017.

OS 500 - D18108 - Admin - Library : Placement Date - 2/05/2002

Exterior

Step Treads	Compressed AC Sheet	Assumed Asbestos		1.08 m2
Landing	Compressed AC Sheet	Assumed Asbestos		1.2 m2
Eave Lining	Flat AC Sheet	Assumed Asbestos		20.16 m2

Interior

R1 - Entry

End wall panel	Flat AC Sheet	Assumed Asbestos		18 m2
Ceiling	Flat AC Sheet	Assumed Asbestos		13 m2

R2 - Principal

Ceiling	Flat AC Sheet	Assumed Asbestos		18 m2
---------	---------------	------------------	--	-------

R3 - Staff Room/Kitchen

Ceiling	Flat AC Sheet	Assumed Asbestos		19 m2
---------	---------------	------------------	--	-------

R4 - Clerical Office

Ceiling	Flat AC Sheet	Assumed Asbestos		18 m2
---------	---------------	------------------	--	-------

R5 - Library

Ceiling	Flat AC Sheet	Assumed Asbestos		54 m2
---------	---------------	------------------	--	-------

R6 - Storeroom

Ceiling	Flat AC Sheet	Assumed Asbestos		0 m2
---------	---------------	------------------	--	------

R7 - Staff Toilet

Toilet partitions	Compressed AC Sheet	Assumed Asbestos		6 m2
End wall panel	Flat AC Sheet	Assumed Asbestos		18 m2
Ceiling	Flat AC Sheet	Assumed Asbestos		4 m2

R8 - Entry to toilet

Ceiling	Flat AC Sheet	Assumed Asbestos		0 m2
---------	---------------	------------------	--	------

2017

Product	Material Description	Extent	Location Reference	Material Condition	Risk Status	Control Priority
Sample No					Test Result	

Listing of Electronic Attachments as of 22/03/2017

There are no asbestos related file attachment(s) for this school.

2017