

Asbestos Register

(Hazardous Materials and Risk Assessment)

School : Barraba Central School (1140)
Region : New England
State Electorate : Tamworth
Local Government Area : Tamworth

Initial Survey : Noel Arnold & Associates : 05 - Apr - 2008
Reviewed By : Greencap-NAA : 07 - May - 2015

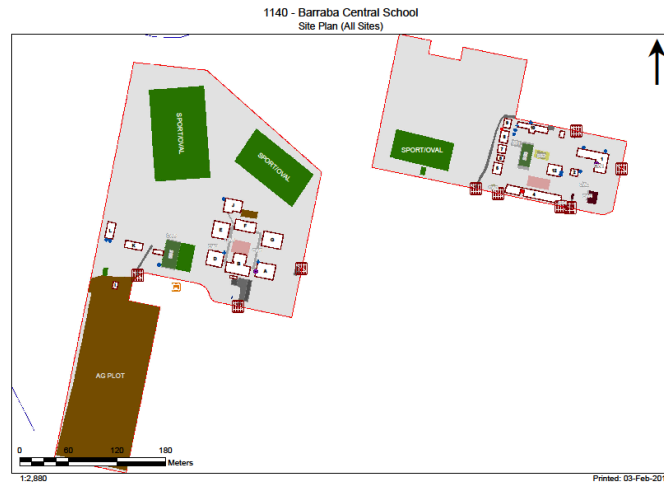

2017

Product	Material Description	Extent	Location Reference	Material Condition	Risk Status	Control Priority
Sample No					Test Result	

B001 - General Learning/Library - 1895 - Brick/Block (Brick/Block)**Exterior**

Ceiling Voids Non Accessible Area
- Height Restriction

Underfloor Voids Non Accessible Area
- Area inaccessible

Interior**B001 - R0001 - Staff Room Annexe**

Floor Coverings Res/Textile Vinyl Tiles (Under Floor Covering/Carpet)
1140/B001/R0005/Floor Coverings Res/Textile/S24 **No Asbestos Detected**

Floor Coverings Res/Textile Adhesive
1140/B001/R0005/Floor Coverings Res/Textile/S25 **No Asbestos Detected**

B001 - R0002 - Reading Area

No Asbestos

B001 - R0003 - Library Office/Workroom

No Asbestos

B001 - R0004 - Library Office/Workroom

No Asbestos

B001 - R0005 - Communications Room

Floor Coverings Res/Textile Vinyl Tiles (Under Floor Covering/Carpet)
1140/B001/R0005/Floor Coverings Res/Textile/S24 **No Asbestos Detected**

Floor Coverings Res/Textile Adhesive
1140/B001/R0005/Floor Coverings Res/Textile/S25 **No Asbestos Detected**

B001 - R0006 - Movement

Electrical Backing Board Resinous Board 1Unit North Good Condition (1) Low (1) Low Priority (2-3)

Assumed Asbestos - Electrical Hazard

B001 - R0007 - General Storeroom

No Asbestos

B001 - R0008 - General Storeroom

No Asbestos

B001 - R0009 - Home Base

Floor Coverings Res/Textile Vinyl Tiles (Under Floor Covering/Carpet)
1140/B001/R0005/Floor Coverings Res/Textile/S24 **No Asbestos Detected**

Floor Coverings Res/Textile Adhesive
1140/B001/R0005/Floor Coverings Res/Textile/S25 **No Asbestos Detected**

B001 - R0010 - Home Base

Floor Coverings Res/Textile Vinyl Tiles (Under Floor Covering/Carpet)
1140/B001/R0005/Floor Coverings Res/Textile/S24 **No Asbestos Detected**

Floor Coverings Res/Textile Adhesive
1140/B001/R0005/Floor Coverings Res/Textile/S25 **No Asbestos Detected**

B001 - R0011 - Home Base

Floor Coverings Res/Textile Vinyl Tiles (Under Floor Covering/Carpet)
1140/B001/R0005/Floor Coverings Res/Textile/S24 **No Asbestos Detected**

Floor Coverings Res/Textile Adhesive
1140/B001/R0005/Floor Coverings Res/Textile/S25 **No Asbestos Detected**

Product	Material Description	Extent	Location Reference	Material Condition	Risk Status	Control Priority
Sample No					Test Result	
B001 - R0012 - General Storeroom						
No Asbestos						
B001 - R0013 - Personal Effects Storage						
No Asbestos						
B001 - R0014 - Movement						
No Asbestos						

2017

Product	Material Description	Extent	Location Reference	Material Condition	Risk Status	Control Priority
Sample No					Test Result	

B002 - Special Purpose - 1944 - Timber (Timber)**Exterior**

Eaves Linings	Flat AC Sheeting	10m2	West	Good Condition (1)	Low (1)	Low Priority (2-3)
	1140/B002/R0004/Ceiling Structures/Linings/S26				Chrysotile (white asbestos) , Amosite (brown asbestos) , Crocidolite (blue asbestos)	
Ceiling Voids	No Asbestos Found					
Underfloor Voids	No Asbestos Found					

Interior**B002 - R0001 - General Storeroom**

Ceiling Structures/Linings	Flat AC Sheeting	3m2	Throughout	Good Condition (1)	Low (1)	Low Priority (2-3)
	1140/B002/R0004/Ceiling Structures/Linings/S26				Chrysotile (white asbestos) , Amosite (brown asbestos) , Crocidolite (blue asbestos)	

B002 - R0002 - Home Base

Floor Coverings Res/Textile	Vinyl Tiles					
	1140/B002/R0004/Floor Coverings Res/Textile/S10				No Asbestos Detected	
Floor Coverings Res/Textile	Adhesive					
	1140/B001/R0005/Floor Coverings Res/Textile/S25				No Asbestos Detected	
Electrical Backing Board	Resinous Board	1Unit	East	Good Condition (1)	Low (1)	Low Priority (2-3)
	Assumed Asbestos - Electrical Hazard					

B002 - R0003 - Movement

Ceiling Structures/Linings	Flat AC Sheeting	9m2	Throughout	Good Condition (1)	Low (1)	Low Priority (2-3)
	1140/B002/R0004/Ceiling Structures/Linings/S26				Chrysotile (white asbestos) , Amosite (brown asbestos) , Crocidolite (blue asbestos)	

B002 - R0004 - General Storeroom

Ceiling Structures/Linings	Flat AC Sheeting	5m2	Throughout	Good Condition (1)	Low (1)	Low Priority (2-3)
	1140/B002/R0004/Ceiling Structures/Linings/S26				Chrysotile (white asbestos) , Amosite (brown asbestos) , Crocidolite (blue asbestos)	

2017

Product	Material Description	Extent	Location Reference	Material Condition	Risk Status	Control Priority
Sample No					Test Result	

B004 - General Learning/Administration - 1957 - Timber (Timber)**Exterior**

Ceiling Voids	Non Accessible Area - Height Restriction
Underfloor Voids	No Asbestos Found

Interior**B004 - R0001 - Movement**

Ceiling Structures/Linings	Flat AC Sheeting	143m2	Throughout	Good Condition (1)	Low (1)	Low Priority (2-3)
	1140/B004/R0001/Ceiling Structures/Linings/S11			Chrysotile (white asbestos) , Amosite (brown asbestos)		

B004 - R0002 - Communal Space

Floor Coverings Res/Textile	Vinyl Tiles (Under Floor Covering/Carpet)					No Asbestos Detected
	1140/B004/R0002/Floor Coverings Res/Textile/S27					
Floor Coverings Res/Textile	Adhesive					No Asbestos Detected
	1140/B004/R0002/Floor Coverings Res/Textile/S28					

B004 - R0003 - Home Base

Floor Coverings Res/Textile	Vinyl Tiles (Under Floor Covering/Carpet)					No Asbestos Detected
	1140/B002/R0004/Floor Coverings Res/Textile/S10					
Floor Coverings Res/Textile	Adhesive					No Asbestos Detected
	1140/B004/R0002/Floor Coverings Res/Textile/S28					

B004 - R0004 - Staff Room

No Asbestos

B004 - R0005 - Staff Toilet

No Asbestos

B004 - R0006 - Staff Toilet

Incinerette	Encapsulated Insulation material within unit	1Unit(s)	to wall	Friable Asbestos (5)	Low (1)	Low Priority (2-3)
	Assumed Asbestos - Area inaccessible					

B004 - R0007 - Movement

No Asbestos

B004 - R0008 - Deputy Principal

Floor Coverings Res/Textile	Vinyl Tiles (Under Floor Covering/Carpet)					No Asbestos Detected
	1140/B002/R0004/Floor Coverings Res/Textile/S10					
Floor Coverings Res/Textile	Adhesive					No Asbestos Detected
	1140/B001/R0005/Floor Coverings Res/Textile/S25					

B004 - R0009 - Distribution Board

Note: No inspection of live electrical installation.

No Asbestos

B004 - R0010 - Clerical Office/Workroom

Floor Coverings Res/Textile	Adhesive					No Asbestos Detected
	1140/B001/R0005/Floor Coverings Res/Textile/S25					
Floor Coverings Res/Textile	Vinyl Tiles (Under Floor Covering/Carpet)					No Asbestos Detected
	1140/B002/R0004/Floor Coverings Res/Textile/S10					

B004 - R0011 - Home Base

No Asbestos

B004 - R0012 - General Storeroom

Product	Material Description	Extent	Location Reference	Material Condition	Risk Status	Control Priority
Sample No					Test Result	
Floor Coverings Res/Textile	Vinyl Tiles					
	1140/B002/R0004/Floor Coverings Res/Textile/S10				No Asbestos Detected	
Floor Coverings Res/Textile	Adhesive					
	1140/B004/R0002/Floor Coverings Res/Textile/S28				No Asbestos Detected	
B004 - R0013 - Home Base						
No Asbestos						
B004 - R0014 - Interview						
Floor Coverings Res/Textile	Vinyl Tiles (Under Floor Covering/Carpet)					
	1140/B002/R0004/Floor Coverings Res/Textile/S10				No Asbestos Detected	
Floor Coverings Res/Textile	Adhesive					
	1140/B004/R0002/Floor Coverings Res/Textile/S28				No Asbestos Detected	

2017

Product	Material Description	Extent	Location Reference	Material Condition	Risk Status	Control Priority
Sample No					Test Result	

B005 - General Learning - 1969 - Brick/Veneer (Brick/Veneer)**Exterior**

Eaves Linings	Flat AC Sheeting	5m2	West	Good Condition (1)	Low (1)	Low Priority (2-3)
	1140/B005/Eaves Linings/S31					Chrysotile (white asbestos)
Underfloor Voids - Slab on Ground	Non Accessible Area					
	- Area inaccessible					
Ceiling Voids	No Asbestos Found					

Interior**B005 - R0001 - Movement**

Ceiling Structures/Linings	Flat AC Sheeting	25m2	Throughout	Good Condition (1)	Low (1)	Low Priority (2-3)
	1140/B009/R0002/Ceiling Structures/Linings/S2					Chrysotile (white asbestos)

B005 - R0002 - Home Base

Floor Coverings Res/Textile	Vinyl Tiles (Under Floor Covering/Carpet)	90m2	Throughout	Good Condition (1)	Low (1)	Low Priority (2-3)
	1140/B005/R0002/Floor Coverings Res/Textile/S29					Chrysotile (white asbestos)
Floor Coverings Res/Textile	Adhesive					
	1140/B005/R0002/Floor Coverings Res/Textile/S30					No Asbestos Detected

B005 - R0003 - Toilets - Boys/Girls

No Asbestos

B005 - R0004 - Home Base Store

Floor Coverings Res/Textile	Adhesive					
	1140/B005/R0002/Floor Coverings Res/Textile/S30					No Asbestos Detected
Floor Coverings Res/Textile	Vinyl Tiles (Under Floor Covering/Carpet)	3m2	Throughout	Good Condition (1)	Low (1)	Low Priority (2-3)
	1140/B005/R0002/Floor Coverings Res/Textile/S29					Chrysotile (white asbestos)

B005 - R0005 - Movement

Floor Coverings Res/Textile	Vinyl Tiles (Under Floor Covering/Carpet)	7m2	Throughout	Good Condition (1)	Low (1)	Low Priority (2-3)
	1140/B005/R0002/Floor Coverings Res/Textile/S29					Chrysotile (white asbestos)
Floor Coverings Res/Textile	Adhesive					
	1140/B005/R0002/Floor Coverings Res/Textile/S30					No Asbestos Detected

2017

Product	Material Description	Extent	Location Reference	Material Condition	Risk Status	Control Priority
Sample No					Test Result	

B006 - Pupil Facilities - 1915 - Timber (Timber)**Exterior**

Eaves Linings	Flat AC Sheeting	10m2	Throughout	Good Condition (1)	Low (1)	Low Priority (2-3)
	1140/B007/R0001/Ceiling Structures/Linings/S5			Chrysotile (white asbestos) , Amosite (brown asbestos)		
Ceiling Voids	Non Accessible Area - Height Restriction					
Underfloor Voids	No Asbestos Found					

Interior**B006 - R0001 - Movement**

Ceiling Structures/Linings	Flat AC Sheeting	17m2	Throughout	Good Condition (1)	Low (1)	Low Priority (2-3)
	1140/B007/R0001/Ceiling Structures/Linings/S5			Chrysotile (white asbestos) , Amosite (brown asbestos)		

B006 - R0002 - Canteen

No Asbestos

B006 - R0003 - Canteen Office/Store

No Asbestos

2017

Product	Material Description	Extent	Location Reference	Material Condition	Risk Status	Control Priority
Sample No					Test Result	

B007 - General Learning - 1956 - Timber (Timber)

Exterior

Ceiling Voids	Non Accessible Area - Access Panel has been screwed into the ceiling.					
Eaves Linings	Flat AC Sheeting	10m2	Throughout	Good Condition (1)	Low (1)	Low Priority (2-3)
	1140/B007/R0001/Ceiling Structures/Linings/S5			Chrysotile (white asbestos) , Amosite (brown asbestos)		
Ceiling Voids	Non Accessible Area - Height Restriction - Access Panel has been screwed into the ceiling.					
Underfloor Voids	No Asbestos Found					

Interior

B007 - R0001 - Movement

Ceiling Structures/Linings	Flat AC Sheeting	21m2	Throughout	Good Condition (1)	Low (1)	Low Priority (2-3)
	1140/B007/R0001/Ceiling Structures/Linings/S5			Chrysotile (white asbestos) , Amosite (brown asbestos)		
Wall Linings Internal	Flat AC Sheeting 1140/B007/R0001/Wall Linings Internal/S33					No Asbestos Detected

B007 - R0002 - General Storeroom

No Asbestos

B007 - R0003 - General Storeroom

No Asbestos

B007 - R0004 - Home Base

Wall Linings Internal	Compressed AC Sheet	2m2	South west corner	Good Condition (1)	Low (1)	Low Priority (2-3)
	1140/B007/R0004/Wall Linings Internal/S32			Chrysotile (white asbestos) , Amosite (brown asbestos)		

2017

Product	Material Description	Extent	Location Reference	Material Condition	Risk Status	Control Priority
Sample No					Test Result	

B008 - General Learning - 1950 - Timber (Timber)

Exterior

Eaves Linings	Flat AC Sheeting	16m2	Throughout	Good Condition (1)	Low (1)	Low Priority (2-3)
	1140/B008/R0001/Ceiling Structures/Linings/S3				Chrysotile (white asbestos) , Amosite (brown asbestos)	
Ceiling Voids	Non Accessible Area - Height Restriction					
Underfloor Voids	No Asbestos Found					

Interior

B008 - R0001 - Movement

Ceiling Structures/Linings	Flat AC Sheeting	33m2	Throughout	Good Condition (1)	Low (1)	Low Priority (2-3)
	1140/B008/R0001/Ceiling Structures/Linings/S3				Chrysotile (white asbestos) , Amosite (brown asbestos)	
Wall Linings Internal	Flat AC Sheeting					No Asbestos Detected
	1140/B008/R0001/Wall Linings Internal/S4					

B008 - R0002 - Home Base

No Asbestos

B008 - R0003 - Home Base

No Asbestos

2017

Product	Material Description	Extent	Location Reference	Material Condition	Risk Status	Control Priority
Sample No					Test Result	

B009 - Pupil Facilities - 1969 - Brick/Block (Brick/Block)**Exterior**

Gable Verge Lining	Flat AC Sheeting	12m2	North, South	Good Condition (1)	Low (1)	Low Priority (2-3)
	1140/B009/Gable Verge Lining/S34					Chrysotile (white asbestos)
Eaves Linings	Flat AC Sheeting	5m2	West	Good Condition (1)	Low (1)	Low Priority (2-3)
	1140/B009/Eaves Linings/S35					Chrysotile (white asbestos)
Ceiling Voids	No Asbestos Found					
Underfloor Voids	No Asbestos Found					

Interior**B009 - R0001 - Movement**

Ceiling Structures/Linings	Flat AC Sheeting	19m2	Throughout	Good Condition (1)	Low (1)	Low Priority (2-3)
	1140/B009/R0002/Ceiling Structures/Linings/S2					Chrysotile (white asbestos)

B009 - R0002 - Toilets - Boys

Partition Walls (Cubicles)	Compressed AC Sheet	4m2	Throughout	Good Condition (1)	Low (1)	Low Priority (2-3)
	1140/B009/R0002/Partition Walls (Cubicles)/S1					Chrysotile (white asbestos)
Ceiling Structures/Linings	Flat AC Sheeting	34m2	Throughout	Good Condition (1)	Low (1)	Low Priority (2-3)
	1140/B009/R0002/Ceiling Structures/Linings/S2					Chrysotile (white asbestos)

B009 - R0003 - Toilets - Girls

Partition Walls (Cubicles)	Compressed AC Sheet	8m2	Throughout	Good Condition (1)	Low (1)	Low Priority (2-3)
	1140/B009/R0002/Partition Walls (Cubicles)/S1					Chrysotile (white asbestos)
Ceiling Structures/Linings	Flat AC Sheeting	30m2	Throughout	Good Condition (1)	Low (1)	Low Priority (2-3)
	1140/B009/R0002/Ceiling Structures/Linings/S2					Chrysotile (white asbestos)

B009 - R0004 - Staff Toilet

Ceiling Structures/Linings	Flat AC Sheeting	4m2	Throughout	Good Condition (1)	Low (1)	Low Priority (2-3)
	1140/B009/R0002/Ceiling Structures/Linings/S2					Chrysotile (white asbestos)
Incinerette	Encapsulated Insulation material within unit	1Unit(s)	Throughout	Friable Asbestos (5)	Low (1)	Low Priority (2-3)
	Assumed Asbestos - Area inaccessible					

2017

Product	Material Description	Extent	Location Reference	Material Condition	Risk Status	Control Priority
Sample No					Test Result	

B00A - Administration/Library - 1973 - Brick/Block (Brick/Block)**Exterior**

Gable Verge Lining	Flat AC Sheeting	12m2	North, South	Good Condition (1)	Low (1)	Low Priority (2-3)
	1140/B00E/Gable Verge Lining/S14					Chrysotile (white asbestos)
Eaves Linings	Flat AC Sheeting	20m2	West	Good Condition (1)	Low (1)	Low Priority (2-3)
	1140/B00E/Eaves Linings/S15					Chrysotile (white asbestos)
Ceiling Voids - Raked Ceiling	Non Accessible Area					
	- Area inaccessible					
Underfloor Voids - Slab on Ground	Non Accessible Area					
	- Area inaccessible					

Interior**B00A - R0001 - Duplicating Workroom**

Floor Coverings Res/Textile	Vinyl Tiles (Under Floor Covering/Carpet)	10m2	Throughout	Good Condition (1)	Low (1)	Low Priority (2-3)
	1140/B00A/R0012/Floor Coverings Res/Textile/S18					Chrysotile (white asbestos)
Floor Coverings Res/Textile	Adhesive					
	1140/B00A/R0012/Floor Coverings Res/Textile/S19					No Asbestos Detected

B00A - R0002 - Clerical Office

Floor Coverings Res/Textile	Vinyl Tiles (Under Floor Covering/Carpet)	21m2	Throughout	Good Condition (1)	Low (1)	Low Priority (2-3)
	1140/B00A/R0012/Floor Coverings Res/Textile/S18					Chrysotile (white asbestos)
Floor Coverings Res/Textile	Adhesive					
	1140/B00A/R0012/Floor Coverings Res/Textile/S19					No Asbestos Detected

B00A - R0003 - Staff Toilet

No Asbestos

B00A - R0004 - Staff Toilet

Incinerette	Encapsulated Insulation material within unit	1Unit(s)	East	Friable Asbestos (5)	Low (1)	Low Priority (2-3)
	Assumed Asbestos - Area inaccessible					

B00A - R0005 - Deputy Principal

No Asbestos

B00A - R0006 - Interview

No Asbestos

B00A - R0007 - Interview

No Asbestos

B00A - R0008 - Reading Area

No Asbestos

B00A - R0009 - Library Office/Workroom

No Asbestos

B00A - R0010 - Seminar/Study

No Asbestos

B00A - R0011 - Movement

No Asbestos

B00A - R0012 - Movement

Floor Coverings Res/Textile	Vinyl Tiles (Under Floor Covering/Carpet)	47m2	Throughout	Good Condition (1)	Low (1)	Low Priority (2-3)
	1140/B00A/R0012/Floor Coverings Res/Textile/S18					Chrysotile (white asbestos)
Floor Coverings Res/Textile	Adhesive					
	1140/B00A/R0012/Floor Coverings Res/Textile/S19					No Asbestos Detected

Product	Material Description	Extent	Location Reference	Material Condition	Risk Status	Control Priority
Sample No					Test Result	
B00A - R0013 - General Learning Space						
No Asbestos						
B00A - R0014 - Interview						
Floor Coverings Res/Textile	Adhesive					
	1140/B00A/R0012/Floor Coverings Res/Textile/S19					No Asbestos Detected
Floor Coverings Res/Textile	Vinyl Tiles (Under Floor Covering/Carpet)	13m2	Throughout	Good Condition (1)	Low (1)	Low Priority (2-3)
	1140/B00A/R0012/Floor Coverings Res/Textile/S18					Chrysotile (white asbestos)
B00A - R0015 - Community Clinic						
No Asbestos						
B00A - R0016 - General Storeroom						
Floor Coverings Res/Textile	Vinyl Tiles (Under Floor Covering/Carpet)	3m2	Throughout	Good Condition (1)	Low (1)	Low Priority (2-3)
	1140/B00A/R0012/Floor Coverings Res/Textile/S18					Chrysotile (white asbestos)
Floor Coverings Res/Textile	Adhesive					
	1140/B00A/R0012/Floor Coverings Res/Textile/S19					No Asbestos Detected
B00A - R0017 - Staff Toilet						
No Asbestos						
B00A - R0018 - Principal						
Floor Coverings Res/Textile	Vinyl Tiles (Under Floor Covering/Carpet)	19m2	Throughout	Good Condition (1)	Low (1)	Low Priority (2-3)
	1140/B00A/R0012/Floor Coverings Res/Textile/S18					Chrysotile (white asbestos)
Floor Coverings Res/Textile	Adhesive					
	1140/B00A/R0012/Floor Coverings Res/Textile/S19					No Asbestos Detected
B00A - R0019 - Cleaning Distributed Store						
No Asbestos						
B00A - R0020 - Movement						
Ceiling Structures/Linings	Flat AC Sheeting	3m2	Throughout	Good Condition (1)	Low (1)	Low Priority (2-3)
	1140/B00C/R0002/Ceiling Structures/Linings/S17					Chrysotile (white asbestos)
B00A - R0021 - Public Entry						
No Asbestos						
B00A - R0022 - Main Switch Board						
Electrical Backing Board	Resinous Board	4Unit	Variable positions	Good Condition (1)	Low (1)	Low Priority (2-3)
	Assumed Asbestos - Electrical Hazard					
Door Lining	Flat AC Sheeting	2m2	South	Minimal Damage (2)	Low (1)	Low Priority (2-3)
	1140/B00B/R0010/Door Lining/S16					Chrysotile (white asbestos)

2017

Product	Material Description	Extent	Location Reference	Material Condition	Risk Status	Control Priority
Sample No					Test Result	

B00B - Communal Facilities/Pupil Facilities - 1973 - Brick/Block (Brick/Block)**Exterior**

Gable Verge Lining	Flat AC Sheeting	20m2	North, South	Good Condition (1)	Low (1)	Low Priority (2-3)
	1140/B00E/Gable Verge Lining/S14				Chrysotile (white asbestos)	
Eaves Linings	Flat AC Sheeting	20m2	West	Good Condition (1)	Low (1)	Low Priority (2-3)
	1140/B00E/Eaves Linings/S15				Chrysotile (white asbestos)	
Ceiling Voids - Raked Ceiling	Non Accessible Area - Area inaccessible					
Underfloor Voids - Slab on Ground	Non Accessible Area - Area inaccessible					

Interior**B00B - R0001 - Movement**

No Asbestos

B00B - R0002 - Communal Space

No Asbestos

B00B - R0003 - Movement

No Asbestos

B00B - R0004 - Toilets - Girls

Partition Walls (Cubicles)	Compressed AC Sheet	12m2	Throughout	Good Condition (1)	Low (1)	Low Priority (2-3)
	1140/B00B/R0004/Partition Walls (Cubicles)/S12				Chrysotile (white asbestos)	
Incinerette	Encapsulated Insulation material within unit	1Unit	East	Friable Asbestos (5)	Low (1)	Low Priority (2-3)
	Assumed Asbestos - Area inaccessible					

B00B - R0005 - Sports Store

No Asbestos

B00B - R0006 - Canteen

Electrical Backing Board	Resinous Board	1Unit	West	Good Condition (1)	Low (1)	Low Priority (2-3)
	Assumed Asbestos - Electrical Hazard					

B00B - R0007 - Canteen Office/Store

No Asbestos

B00B - R0008 - Staff Toilet

No Asbestos

B00B - R0009 - Movement

No Asbestos

B00B - R0010 - Main Switch Board

Door Lining	Flat AC Sheeting	5m2	East	Minimal Damage (2)	Low (1)	Low Priority (2-3)
	1140/B00B/R0010/Door Lining/S16				Chrysotile (white asbestos)	
Electrical Backing Board	Resinous Board	4Unit	Variable positions	Good Condition (1)	Low (1)	Low Priority (2-3)
	Assumed Asbestos - Electrical Hazard					

B00B - R0011 - Sports Store

No Asbestos

B00B - R0012 - Toilets - Boys

Partition Walls (Cubicles)	Compressed AC Sheet	8m2	Throughout	Good Condition (1)	Low (1)	Low Priority (2-3)
	1140/B00B/R0004/Partition Walls (Cubicles)/S12				Chrysotile (white asbestos)	

B00B - R0013 - Movement

No Asbestos

Product	Material Description	Extent	Location Reference	Material Condition	Risk Status	Control Priority
Sample No					Test Result	
B00B - R0014 - Movement						
No Asbestos						
B00B - R0015 - Movement						
No Asbestos						
B00B - R0016 - Movement						
No Asbestos						
B00B - R0017 - Movement						
No Asbestos						

2017

Product	Material Description	Extent	Location Reference	Material Condition	Risk Status	Control Priority
Sample No					Test Result	

B00C - Building Services - 1973 - Brick/Block (Brick/Block)

Exterior

Ceiling Voids - Flat Roof	Non Accessible Area - Area inaccessible
Underfloor Voids - Slab on Ground	Non Accessible Area - Area inaccessible

Interior

B00C - R0001 - Plant

Ceiling Structures/Linings	Flat AC Sheeting	6m2	Throughout	Good Condition (1)	Low (1)	Low Priority (2-3)
1140/B00C/R0002/Ceiling Structures/Linings/S17					Chrysotile (white asbestos)	
Insulation to Pipework	Lagging	2m	Variable positions	Friable Asbestos (5)	Medium (2)	Medium Priority (4-5)
1140/B00C/R0001/Insulation to Pipework/S20					Chrysotile (white asbestos)	

B00C - R0002 - Cleaning Supplies

Ceiling Structures/Linings	Flat AC Sheeting	6m2	Throughout	Good Condition (1)	Low (1)	Low Priority (2-3)
1140/B00C/R0002/Ceiling Structures/Linings/S17					Chrysotile (white asbestos)	

B00C - R0003 - Cleaning Supplies

Ceiling Structures/Linings	Flat AC Sheeting	9m2	Throughout	Good Condition (1)	Low (1)	Low Priority (2-3)
1140/B00C/R0002/Ceiling Structures/Linings/S17					Chrysotile (white asbestos)	

2017

Product	Material Description	Extent	Location Reference	Material Condition	Risk Status	Control Priority
Sample No					Test Result	

B00D - Technological & Applied Studies/Art - 1973 - Brick/Block (Brick/Block)**Exterior**

Gable Verge Lining	Flat AC Sheeting	20m2	North, South	Good Condition (1)	Low (1)	Low Priority (2-3)
	1140/B00E/Gable Verge Lining/S14					Chrysotile (white asbestos)
Eaves Linings	Flat AC Sheeting	20m2	Throughout	Good Condition (1)	Low (1)	Low Priority (2-3)
	1140/B00E/Eaves Linings/S15					Chrysotile (white asbestos)
Ceiling Voids - Raked Ceiling	Non Accessible Area					
	- Area inaccessible					
Underfloor Voids - Slab on Ground	Non Accessible Area					
	- Area inaccessible					

Interior**B00D - R0001 - Resources Store**

Floor Coverings Res/Textile	Vinyl Tiles	6m2	West	Good Condition (1)	Low (1)	Low Priority (2-3)
	1140/B00D/R0001/Floor Coverings Res/Textile/S13					Chrysotile (white asbestos)
Floor Coverings Res/Textile	Adhesive					
	1140/B00A/R0012/Floor Coverings Res/Textile/S19					No Asbestos Detected

B00D - R0002 - Movement

No Asbestos

B00D - R0003 - Movement

No Asbestos

B00D - R0004 - Staff Toilet

Incinerette	Encapsulated Insulation material within unit	1Unit(s)	Throughout	Friable Asbestos (5)	Low (1)	Low Priority (2-3)
	Assumed Asbestos - Area inaccessible					

B00D - R0005 - Staff Toilet

No Asbestos

B00D - R0006 - Materials Store

Floor Coverings Res/Textile	Vinyl Tiles	15m2	Throughout	Good Condition (1)	Low (1)	Low Priority (2-3)
	1140/B00D/R0001/Floor Coverings Res/Textile/S13					Chrysotile (white asbestos)
Floor Coverings Res/Textile	Adhesive					
	1140/B00A/R0012/Floor Coverings Res/Textile/S19					No Asbestos Detected

B00D - R0007 - Welding Store

Wall Linings Internal	Flat AC Sheeting	3m2	North	Some Damage - Unsealed (3)	Low (1)	Medium Priority (4-5)
	1140/B00D/R0008/Wall Linings Internal/S21					Chrysotile (white asbestos)

B00D - R0008 - Welding Area

Wall Linings Internal	Flat AC Sheeting	3m2	South	Some Damage - Unsealed (3)	Low (1)	Medium Priority (4-5)
	1140/B00D/R0008/Wall Linings Internal/S21					Chrysotile (white asbestos)

B00D - R0009 - Materials Technology L.S.

Furnace	Encapsulated Insulation material within unit	2Unit	Variable positions	Minimal Damage (2)	Low (1)	Low Priority (2-3)
	Assumed Asbestos - Area inaccessible					

B00D - R0010 - Resources Store

Floor Coverings Res/Textile	Vinyl Tiles	16m2	Throughout	Good Condition (1)	Low (1)	Low Priority (2-3)
	1140/B00D/R0001/Floor Coverings Res/Textile/S13					Chrysotile (white asbestos)

Product	Material Description	Extent	Location Reference	Material Condition	Risk Status	Control Priority
Sample No					Test Result	
Floor Coverings Res/Textile	Adhesive					
	1140/B00A/R0012/Floor Coverings Res/Textile/S19					No Asbestos Detected
B00D - R0011 - Art Learning Space						
No Asbestos						
B00D - R0012 - Darkroom Space						
No Asbestos						
B00D - R0013 - Kiln Room						
No Asbestos						
B00D - R0014 - Distribution Board						
				Note: No inspection of live electrical installation.		
Electrical Backing Board	Resinous Board	4Unit	Variable positions	Good Condition (1)	Low (1)	Low Priority (2-3)
Assumed Asbestos - Electrical Hazard						
Door Lining	Flat AC Sheeting	3m2	East	Minimal Damage (2)	Low (1)	Low Priority (2-3)
	1140/B00B/R0010/Door Lining/S16					Chrysotile (white asbestos)
B00D - R0015 - Cleaning Distributed Store						
No Asbestos						

2017

Product	Material Description	Extent	Location Reference	Material Condition	Risk Status	Control Priority
Sample No					Test Result	

B00E - General Learning - 1973 - Brick/Block (Brick/Block)**Exterior**

Gable Verge Lining	Flat AC Sheeting	20m2	North, South	Good Condition (1)	Low (1)	Low Priority (2-3)
	1140/B00E/Gable Verge Lining/S14					Chrysotile (white asbestos)
Eaves Linings	Flat AC Sheeting	20m2	Throughout	Good Condition (1)	Low (1)	Low Priority (2-3)
	1140/B00E/Eaves Linings/S15					Chrysotile (white asbestos)
Ceiling Voids - Raked Ceiling	Non Accessible Area					
	- Area inaccessible					
Underfloor Voids - Slab on Ground	Non Accessible Area					
	- Area inaccessible					

Interior**B00E - R0001 - General Learning Space**

Floor Coverings Res/Textile	Vinyl Tiles (Under Floor Covering/Carpet)	54m2	Throughout	Good Condition (1)	Low (1)	Low Priority (2-3)
	1140/B00A/R0012/Floor Coverings Res/Textile/S18					Chrysotile (white asbestos)
Floor Coverings Res/Textile	Adhesive					
	1140/B00A/R0012/Floor Coverings Res/Textile/S19					No Asbestos Detected

B00E - R0002 - Movement

No Asbestos

B00E - R0003 - Movement

No Asbestos

B00E - R0004 - Cleaning Distributed Store

No Asbestos

B00E - R0005 - Seminar/Study

Floor Coverings Res/Textile	Vinyl Tiles	22m2	West	Good Condition (1)	Low (1)	Low Priority (2-3)
	1140/B00D/R0001/Floor Coverings Res/Textile/S13					Chrysotile (white asbestos)
Floor Coverings Res/Textile	Adhesive					
	1140/B00A/R0012/Floor Coverings Res/Textile/S19					No Asbestos Detected

B00E - R0006 - Distribution Board

Note: No inspection of live electrical installation.

Electrical Backing Board	Resinous Board	4Unit	Variable positions	Good Condition (1)	Low (1)	Low Priority (2-3)
	Assumed Asbestos - Electrical Hazard					
Door Lining	Flat AC Sheeting	3m2	East	Minimal Damage (2)	Low (1)	Low Priority (2-3)
	1140/B00B/R0010/Door Lining/S16					Chrysotile (white asbestos)

B00E - R0007 - Seminar/Technology Space

Floor Coverings Res/Textile	Vinyl Tiles	16m2	West	Good Condition (1)	Low (1)	Low Priority (2-3)
	1140/B00D/R0001/Floor Coverings Res/Textile/S13					Chrysotile (white asbestos)

B00E - R0008 - Food/Research Space

Floor Coverings Res/Textile	Vinyl Tiles	16m2	West	Good Condition (1)	Low (1)	Low Priority (2-3)
	1140/B00D/R0001/Floor Coverings Res/Textile/S13					Chrysotile (white asbestos)

B00E - R0009 - Food Technology L.S.

Floor Coverings Res/Textile	Vinyl Tiles	83m2	West	Good Condition (1)	Low (1)	Low Priority (2-3)
	1140/B00D/R0001/Floor Coverings Res/Textile/S13					Chrysotile (white asbestos)

B00E - R0010 - Laundry

No Asbestos

B00E - R0011 - Pantry

Product	Material Description	Extent	Location Reference	Material Condition	Risk Status	Control Priority
Sample No					Test Result	
Floor Coverings Res/Textile	Vinyl Tiles	9m2	West	Good Condition (1)	Low (1)	Low Priority (2-3)
1140/B00D/R0001/Floor Coverings Res/Textile/S13					Chrysotile (white asbestos)	
Floor Coverings Res/Textile	Adhesive					
1140/B00A/R0012/Floor Coverings Res/Textile/S19					No Asbestos Detected	
B00E - R0012 - Materials Store						
Floor Coverings Res/Textile	Vinyl Tiles	8m2	West	Good Condition (1)	Low (1)	Low Priority (2-3)
1140/B00D/R0001/Floor Coverings Res/Textile/S13					Chrysotile (white asbestos)	
Floor Coverings Res/Textile	Adhesive					
1140/B00A/R0012/Floor Coverings Res/Textile/S19					No Asbestos Detected	
B00E - R0013 - General Storeroom						
Floor Coverings Res/Textile	Vinyl Tiles	15m2	West	Good Condition (1)	Low (1)	Low Priority (2-3)
1140/B00D/R0001/Floor Coverings Res/Textile/S13					Chrysotile (white asbestos)	
Floor Coverings Res/Textile	Adhesive					
1140/B00A/R0012/Floor Coverings Res/Textile/S19					No Asbestos Detected	
B00E - R0014 - General Learning Space						
Floor Coverings Res/Textile	Adhesive					
1140/B00A/R0012/Floor Coverings Res/Textile/S19					No Asbestos Detected	
Floor Coverings Res/Textile	Vinyl Tiles (Under Floor Covering/Carpet)	67m2	Throughout	Good Condition (1)	Low (1)	Low Priority (2-3)
1140/B00A/R0012/Floor Coverings Res/Textile/S18					Chrysotile (white asbestos)	
B00E - R0015 - Staff Room Annexe						
Floor Coverings Res/Textile	Vinyl Tiles	20m2	West	Good Condition (1)	Low (1)	Low Priority (2-3)
1140/B00D/R0001/Floor Coverings Res/Textile/S13					Chrysotile (white asbestos)	
Floor Coverings Res/Textile	Adhesive					
1140/B00A/R0012/Floor Coverings Res/Textile/S19					No Asbestos Detected	

2017

Product	Material Description	Extent	Location Reference	Material Condition	Risk Status	Control Priority
Sample No					Test Result	

B00F - Science - 1973 - Brick/Veneer (Brick/Veneer)**Exterior**

Gable Verge Lining	Flat AC Sheeting	20m2	North, South	Good Condition (1)	Low (1)	Low Priority (2-3)
	1140/B00E/Gable Verge Lining/S14				Chrysotile (white asbestos)	
Eaves Linings	Flat AC Sheeting	20m2	Throughout	Good Condition (1)	Low (1)	Low Priority (2-3)
	1140/B00E/Eaves Linings/S15				Chrysotile (white asbestos)	
Ceiling Voids - Raked Ceiling	Non Accessible Area - Area inaccessible					
Underfloor Voids - Slab on Ground	Non Accessible Area - Area inaccessible					

Interior**B00F - R0001 - Laboratory L.S.**

Floor Coverings Res/Textile	Vinyl Tiles (Under Floor Covering/Carpet)	92m2	Throughout	Good Condition (1)	Low (1)	Low Priority (2-3)
	1140/B00F/R0001/Floor Coverings Res/Textile/S22				Chrysotile (white asbestos)	
Floor Coverings Res/Textile	Adhesive					
	1140/B00F/R0001/Floor Coverings Res/Textile/S23				No Asbestos Detected	

B00F - R0002 - Chemical Store

Floor Coverings Res/Textile	Vinyl Tiles	4m2	West	Good Condition (1)	Low (1)	Low Priority (2-3)
	1140/B00D/R0001/Floor Coverings Res/Textile/S13				Chrysotile (white asbestos)	
Floor Coverings Res/Textile	Adhesive					
	1140/B00A/R0012/Floor Coverings Res/Textile/S19				No Asbestos Detected	

B00F - R0003 - Staff Room Annexe

Floor Coverings Res/Textile	Vinyl Tiles	46m2	West	Good Condition (1)	Low (1)	Low Priority (2-3)
	1140/B00D/R0001/Floor Coverings Res/Textile/S13				Chrysotile (white asbestos)	
Floor Coverings Res/Textile	Adhesive					
	1140/B00A/R0012/Floor Coverings Res/Textile/S19				No Asbestos Detected	

B00F - R0004 - Distribution Board

Note: No inspection of live electrical installation.

Electrical Backing Board	Resinous Board	4Unit	Variable positions	Good Condition (1)	Low (1)	Low Priority (2-3)
	Assumed Asbestos - Electrical Hazard					
Door Lining	Flat AC Sheeting	2m2	South	Minimal Damage (2)	Low (1)	Low Priority (2-3)
	1140/B00B/R0010/Door Lining/S16				Chrysotile (white asbestos)	

B00F - R0005 - Laboratory L.S.

No Asbestos

B00F - R0006 - Movement

No Asbestos

Product	Material Description	Extent	Location Reference	Material Condition	Risk Status	Control Priority
Sample No					Test Result	

B00G - General Learning/Computer Learning - 1973 - Brick/Block (Brick/Block)**Exterior**

Gable Verge Lining	Flat AC Sheeting	20m2	North, South	Good Condition (1)	Low (1)	Low Priority (2-3)
	1140/B00E/Gable Verge Lining/S14					Chrysotile (white asbestos)
Eaves Linings	Flat AC Sheeting	20m2	Throughout	Good Condition (1)	Low (1)	Low Priority (2-3)
	1140/B00E/Eaves Linings/S15					Chrysotile (white asbestos)
Ceiling Voids - Raked Ceiling	Non Accessible Area					
	- Area inaccessible					
Underfloor Voids - Slab on Ground	Non Accessible Area					
	- Area inaccessible					

Interior**B00G - R0001 - Computer Learning Space**

Floor Coverings Res/Textile	Vinyl Tiles (Under Floor Covering/Carpet)	54m2	Throughout	Good Condition (1)	Low (1)	Low Priority (2-3)
	1140/B00D/R0001/Floor Coverings Res/Textile/S13					Chrysotile (white asbestos)
Floor Coverings Res/Textile	Adhesive					
	1140/B00A/R0012/Floor Coverings Res/Textile/S19					No Asbestos Detected

B00G - R0002 - Seminar/Study

Floor Coverings Res/Textile	Vinyl Tiles (Under Floor Covering/Carpet)	14m2	Throughout	Good Condition (1)	Low (1)	Low Priority (2-3)
	1140/B00A/R0012/Floor Coverings Res/Textile/S18					Chrysotile (white asbestos)
Floor Coverings Res/Textile	Adhesive					
	1140/B00A/R0012/Floor Coverings Res/Textile/S19					No Asbestos Detected

B00G - R0003 - General Learning Space

Floor Coverings Res/Textile	Vinyl Tiles (Under Floor Covering/Carpet)	54m2	Throughout	Good Condition (1)	Low (1)	Low Priority (2-3)
	1140/B00D/R0001/Floor Coverings Res/Textile/S13					Chrysotile (white asbestos)
Floor Coverings Res/Textile	Adhesive					
	1140/B00A/R0012/Floor Coverings Res/Textile/S19					No Asbestos Detected

B00G - R0004 - Distribution Board

Note: No inspection of live electrical installation.

Electrical Backing Board	Resinous Board	4Unit	Variable positions	Good Condition (1)	Low (1)	Low Priority (2-3)
	Assumed Asbestos - Electrical Hazard					
Door Lining	Flat AC Sheeting	3m2	North	Minimal Damage (2)	Low (1)	Low Priority (2-3)
	1140/B00B/R0010/Door Lining/S16					Chrysotile (white asbestos)

B00G - R0005 - General Storeroom

Floor Coverings Res/Textile	Vinyl Tiles	6m2	West	Good Condition (1)	Low (1)	Low Priority (2-3)
	1140/B00D/R0001/Floor Coverings Res/Textile/S13					Chrysotile (white asbestos)
Floor Coverings Res/Textile	Adhesive					
	1140/B00A/R0012/Floor Coverings Res/Textile/S19					No Asbestos Detected

B00G - R0006 - General Storeroom

Floor Coverings Res/Textile	Vinyl Tiles	6m2	West	Good Condition (1)	Low (1)	Low Priority (2-3)
	1140/B00D/R0001/Floor Coverings Res/Textile/S13					Chrysotile (white asbestos)
Floor Coverings Res/Textile	Adhesive					
	1140/B00A/R0012/Floor Coverings Res/Textile/S19					No Asbestos Detected

B00G - R0007 - General Learning Space

Product	Material Description	Extent	Location Reference	Material Condition	Risk Status	Control Priority
Sample No		Test Result				
Floor Coverings Res/Textile	Vinyl Tiles	53m2	West	Good Condition (1)	Low (1)	Low Priority (2-3)
1140/B00D/R0001/Floor Coverings Res/Textile/S13		Chrysotile (white asbestos)				
Floor Coverings Res/Textile	Adhesive					
1140/B00A/R0012/Floor Coverings Res/Textile/S19		No Asbestos Detected				
B00G - R0008 - General Storeroom						
Floor Coverings Res/Textile	Vinyl Tiles	13m2	West	Good Condition (1)	Low (1)	Low Priority (2-3)
1140/B00D/R0001/Floor Coverings Res/Textile/S13		Chrysotile (white asbestos)				
Floor Coverings Res/Textile	Adhesive					
1140/B00A/R0012/Floor Coverings Res/Textile/S19		No Asbestos Detected				
B00G - R0009 - Staff Room Annexe						
Floor Coverings Res/Textile	Vinyl Tiles	40m2	West	Good Condition (1)	Low (1)	Low Priority (2-3)
1140/B00D/R0001/Floor Coverings Res/Textile/S13		Chrysotile (white asbestos)				
B00G - R0010 - Movement						
Ceiling Structures/Linings	Flat AC Sheeting	2m2	Throughout	Good Condition (1)	Low (1)	Low Priority (2-3)
1140/B00C/R0002/Ceiling Structures/Linings/S17		Chrysotile (white asbestos)				
B00G - R0011 - Movement						
No Asbestos						
B00G - R0012 - General Learning Space						
Floor Coverings Res/Textile	Vinyl Tiles	53m2	West	Good Condition (1)	Low (1)	Low Priority (2-3)
1140/B00D/R0001/Floor Coverings Res/Textile/S13		Chrysotile (white asbestos)				
Floor Coverings Res/Textile	Adhesive					
1140/B00A/R0012/Floor Coverings Res/Textile/S19		No Asbestos Detected				
B00G - R0013 - General Learning Space						
Floor Coverings Res/Textile	Vinyl Tiles	53m2	West	Good Condition (1)	Low (1)	Low Priority (2-3)
1140/B00D/R0001/Floor Coverings Res/Textile/S13		Chrysotile (white asbestos)				
Floor Coverings Res/Textile	Adhesive					
1140/B00A/R0012/Floor Coverings Res/Textile/S19		No Asbestos Detected				
B00G - R0014 - Computer Store						
Floor Coverings Res/Textile	Adhesive					
1140/B00A/R0012/Floor Coverings Res/Textile/S19		No Asbestos Detected				
Floor Coverings Res/Textile	Vinyl Tiles	6m2	Throughout	Good Condition (1)	Low (1)	Low Priority (2-3)
1140/B00D/R0001/Floor Coverings Res/Textile/S13		Chrysotile (white asbestos)				
B00G - R0015 - General Storeroom						
Floor Coverings Res/Textile	Vinyl Tiles	6m2	West	Good Condition (1)	Low (1)	Low Priority (2-3)
1140/B00D/R0001/Floor Coverings Res/Textile/S13		Chrysotile (white asbestos)				
Floor Coverings Res/Textile	Adhesive					
1140/B00A/R0012/Floor Coverings Res/Textile/S19		No Asbestos Detected				
B00G - R0016 - Cleaning Distributed Store						
No Asbestos						

Product	Material Description	Extent	Location Reference	Material Condition	Risk Status	Control Priority
Sample No					Test Result	

B00H - Building Services - 1985 - Steel (Steel)

Exterior

Ceiling Voids	No Asbestos Found
Underfloor Voids - Slab on Ground	Non Accessible Area - Area inaccessible

Interior

B00H - R0001 - General Assistant/Bulk Store

No Asbestos

B00H - R0002 - Sports Store

No Asbestos

2017

Product	Material Description	Extent	Location Reference	Material Condition	Risk Status	Control Priority
Sample No					Test Result	

B00I - Agricultural Science - 1950 - Timber (Timber)

Exterior

Ceiling Voids	No Asbestos Found
Underfloor Voids - Slab on Ground	Non Accessible Area - Area inaccessible

Interior

B00I - R0001 - Class Tools Storage

No Asbestos

B00I - R0002 - Garden Store

No Asbestos

2017

Product	Material Description	Extent	Location Reference	Material Condition	Risk Status	Control Priority
Sample No					Test Result	

B00J - Science - 2010 - Brick/Veneer (Brick/Veneer)**Exterior**

Underfloor Voids - Slab on Ground	Non Accessible Area - Area inaccessible
Ceiling Voids - Raked Ceiling	Non Accessible Area - Area inaccessible

Interior**B00J - R0001 - General Learning Space**

No Asbestos

B00J - R0002 - Science Laboratory

No Asbestos

B00J - R0003 - Preparation - Science

No Asbestos

B00J - R0004 - Apparatus Store

No Asbestos

B00J - R0005 - Chemical Store

No Asbestos

B00J - R0006 - Staff Room

No Asbestos

B00J - R0007 - Seminar - Type 1

No Asbestos

B00J - R0008 - Outdoor Learning Space - Type 4

No Asbestos

B00J - R0009 - External Movement

No Asbestos

B00J - R0010 - Distribution Board

Note: No inspection of live electrical installation.

No Asbestos

2017

Product	Material Description	Extent	Location Reference	Material Condition	Risk Status	Control Priority
Sample No					Test Result	

B00K - Tech. & Applied Studies/Mechan - 2015 - Steel (Steel)

Exterior

Ceiling Void	No Asbestos Found
Underfloor Void	No Asbestos Found

Interior

B00K - R0001 - Materials Store

No Asbestos

B00K - R0002 - Workshop Area

No Asbestos

B00K - R0003 - Materials Learning Space - Type 1

No Asbestos

B00K - R0004 - Covered Area

No Asbestos

2017

Product	Material Description	Extent	Location Reference	Material Condition	Risk Status	Control Priority
Sample No					Test Result	

B00L - Agricultural Science - 2015 - Steel (Steel)

Exterior

Ceiling Void	No Asbestos Found
Underfloor Void	No Asbestos Found

Interior

B00L - R0001 - Animal Space

No Asbestos

2017

Product	Material Description	Extent	Location Reference	Material Condition	Risk Status	Control Priority
Sample No					Test Result	

B010 - Special Purpose/Pupil Facilities - 1957 - Timber (Timber)**Exterior**

Eaves Linings	Flat AC Sheeting 1140/B010/R0001/Ceiling Structures/Linings/S6					No Asbestos Detected
---------------	---	--	--	--	--	----------------------

Interior**B010 - R0001 - Disabled Toilet**

Ceiling Structures/Linings	Flat AC Sheeting 1140/B010/R0001/Ceiling Structures/Linings/S6					No Asbestos Detected
----------------------------	---	--	--	--	--	----------------------

Wall Linings Internal	Flat AC Sheeting 1140/B010/R0001/Wall Linings Internal/S7					No Asbestos Detected
-----------------------	--	--	--	--	--	----------------------

B010 - R0002 - General Storeroom

Ceiling Structures/Linings	Flat AC Sheeting 1140/B010/R0001/Ceiling Structures/Linings/S6					No Asbestos Detected
----------------------------	---	--	--	--	--	----------------------

Wall Linings Internal	Flat AC Sheeting 1140/B010/R0001/Wall Linings Internal/S7					No Asbestos Detected
-----------------------	--	--	--	--	--	----------------------

B010 - R0003 - Movement

Ceiling Structures/Linings	Flat AC Sheeting 1140/B010/R0001/Ceiling Structures/Linings/S6					No Asbestos Detected
----------------------------	---	--	--	--	--	----------------------

Wall Linings Internal	Flat AC Sheeting 1140/B010/R0001/Wall Linings Internal/S7					No Asbestos Detected
-----------------------	--	--	--	--	--	----------------------

B010 - R0004 - Toilets - Girls

Ceiling Structures/Linings	Flat AC Sheeting 1140/B010/R0001/Ceiling Structures/Linings/S6					No Asbestos Detected
----------------------------	---	--	--	--	--	----------------------

Wall Linings Internal	Flat AC Sheeting 1140/B010/R0001/Wall Linings Internal/S7					No Asbestos Detected
-----------------------	--	--	--	--	--	----------------------

Partition Walls (Cubicles)	Compressed AC Sheet 1140/B010/R0004/Partition Walls (Cubicles)/S8					No Asbestos Detected
----------------------------	--	--	--	--	--	----------------------

B010 - R0005 - Toilets - Boys

Ceiling Structures/Linings	Flat AC Sheeting 1140/B010/R0001/Ceiling Structures/Linings/S6					No Asbestos Detected
----------------------------	---	--	--	--	--	----------------------

Wall Linings Internal	Flat AC Sheeting 1140/B010/R0001/Wall Linings Internal/S7					No Asbestos Detected
-----------------------	--	--	--	--	--	----------------------

Partition Walls (Cubicles)	Compressed AC Sheet 1140/B010/R0004/Partition Walls (Cubicles)/S8					No Asbestos Detected
----------------------------	--	--	--	--	--	----------------------

B010 - R0006 - Cleaning Supplies

Ceiling Structures/Linings	Flat AC Sheeting 1140/B010/R0001/Ceiling Structures/Linings/S6					No Asbestos Detected
----------------------------	---	--	--	--	--	----------------------

Wall Linings Internal	Flat AC Sheeting 1140/B010/R0001/Wall Linings Internal/S7					No Asbestos Detected
-----------------------	--	--	--	--	--	----------------------

B010 - R0007 - Movement

Ceiling Structures/Linings	Flat AC Sheeting 1140/B010/R0001/Ceiling Structures/Linings/S6					No Asbestos Detected
----------------------------	---	--	--	--	--	----------------------

Wall Linings Internal	Flat AC Sheeting 1140/B010/R0001/Wall Linings Internal/S7					No Asbestos Detected
-----------------------	--	--	--	--	--	----------------------

B010 - R0008 - Cleaning Supplies

Ceiling Structures/Linings	Flat AC Sheeting 1140/B010/R0001/Ceiling Structures/Linings/S6					No Asbestos Detected
----------------------------	---	--	--	--	--	----------------------

Wall Linings Internal	Flat AC Sheeting 1140/B010/R0001/Wall Linings Internal/S7					No Asbestos Detected
-----------------------	--	--	--	--	--	----------------------

B010 - R0009 - Drinking Facilities

Ceiling Structures/Linings	Flat AC Sheeting 1140/B010/R0001/Ceiling Structures/Linings/S6					No Asbestos Detected
----------------------------	---	--	--	--	--	----------------------

Wall Linings Internal	Flat AC Sheeting 1140/B010/R0001/Wall Linings Internal/S7					No Asbestos Detected
-----------------------	--	--	--	--	--	----------------------

Product	Material Description	Extent	Location Reference	Material Condition	Risk Status	Control Priority
Sample No					Test Result	
Electrical Backing Board	Resinous Board	1Unit	North	Good Condition (1)	Low (1)	Low Priority (2-3)

Assumed Asbestos - Electrical Hazard

B010 - R0010 - Garden Store

Ceiling Structures/Linings	Flat AC Sheeting 1140/B010/R0001/Ceiling Structures/Linings/S6					No Asbestos Detected
Wall Linings Internal	Flat AC Sheeting 1140/B010/R0001/Wall Linings Internal/S7					No Asbestos Detected

B010 - R0011 - Music Store

Ceiling Structures/Linings	Flat AC Sheeting 1140/B010/R0001/Ceiling Structures/Linings/S6					No Asbestos Detected
Wall Linings Internal	Flat AC Sheeting 1140/B010/R0001/Wall Linings Internal/S7					No Asbestos Detected

B010 - R0012 - Music Learning Space

Ceiling Structures/Linings	Flat AC Sheeting 1140/B010/R0001/Ceiling Structures/Linings/S6					No Asbestos Detected
Wall Linings Internal	Flat AC Sheeting 1140/B010/R0001/Wall Linings Internal/S7					No Asbestos Detected

2017

Product	Material Description	Extent	Location Reference	Material Condition	Risk Status	Control Priority
Sample No					Test Result	

B011 - Communal Facilities - 1957 - Timber (Timber)**Exterior**

Eaves Linings	Flat AC Sheeting	5m2	West	Good Condition (1)	Low (1)	Low Priority (2-3)
	1140/B011/Eaves Linings/S37					Chrysotile (white asbestos)
Ceiling Voids	Non Accessible Area - Area inaccessible					
Underfloor Voids	Non Accessible Area - Area inaccessible					

Interior**B011 - R0001 - Toilets - Boys/Girls**

Floor Coverings Res/Textile	Vinyl Tiles	4m2	Throughout	Good Condition (1)	Low (1)	Low Priority (2-3)
	1140/B011/R0001/Floor Coverings Res/Textile/S9					Chrysotile (white asbestos)
Floor Coverings Res/Textile	Adhesive					No Asbestos Detected
	1140/B011/R0002/Floor Coverings Res/Textile/S36					

B011 - R0002 - Sports Store

Floor Coverings Res/Textile	Vinyl Tiles	19m2	Throughout	Good Condition (1)	Low (1)	Low Priority (2-3)
	1140/B011/R0001/Floor Coverings Res/Textile/S9					Chrysotile (white asbestos)
Floor Coverings Res/Textile	Adhesive					No Asbestos Detected
	1140/B011/R0002/Floor Coverings Res/Textile/S36					

B011 - R0003 - Sports Store

Floor Coverings Res/Textile	Vinyl Tiles	6m2	Throughout	Good Condition (1)	Low (1)	Low Priority (2-3)
	1140/B011/R0001/Floor Coverings Res/Textile/S9					Chrysotile (white asbestos)
Floor Coverings Res/Textile	Adhesive					No Asbestos Detected
	1140/B011/R0002/Floor Coverings Res/Textile/S36					

B011 - R0004 - Movement

No Asbestos

2017

Product	Material Description	Extent	Location Reference	Material Condition	Risk Status	Control Priority
Sample No					Test Result	

B012 - General Learning - 2011 - Fibre Cement Clad (Fibre Cement Clad)

Exterior

Ceiling Voids	No Asbestos Found
Underfloor Voids - Slab on Ground	Non Accessible Area - Area inaccessible

Interior

B012 - R0001 - Movement

No Asbestos Found

B012 - R0002 - Practical Activities - 1hb

No Asbestos Found

B012 - R0003 - Home Base Store

No Asbestos Found

B012 - R0004 - Home Base

No Asbestos Found

B012 - R0005 - Withdrawal Space - 2hb

No Asbestos Found

B012 - R0006 - Home Base

No Asbestos Found

B012 - R0007 - Home Base Store

No Asbestos Found

B012 - R0008 - Practical Activities - 1hb

No Asbestos Found

2017

Product	Material Description	Extent	Location Reference	Material Condition	Risk Status	Control Priority
Sample No					Test Result	

Demountables

Demountable details as per the AMS records as of 15 Feb 2017.

OS 780 - D10920 - Woodwork/Metalwork/Heat Area/Store : Placement Date - 30/06/1995

Exterior

Step Treads	Compressed AC Sheet	Assumed Asbestos		1.08 m2
Landing	Compressed AC Sheet	Assumed Asbestos		1.2 m2
Eave Lining	Flat AC Sheet	Assumed Asbestos		17.28 m2

Interior

R1 - Store

End wall panel	Flat AC Sheet	Assumed Asbestos		18 m2
Ceiling	Flat AC Sheet	Assumed Asbestos		18 m2

R2 - Materials Technology L.S.

End wall panel	Flat AC Sheet	Assumed Asbestos		18 m2
Ceiling	Flat AC Sheet	Assumed Asbestos		91 m2

2017

Product	Material Description	Extent	Location Reference	Material Condition	Risk Status	Control Priority
Sample No					Test Result	

Listing of Electronic Attachments as of 22/03/2017

There are no asbestos related file attachment(s) for this school.

2017