

Asbestos Register

(Hazardous Materials and Risk Assessment)

School : Balranald Central School (1115)
Region : Riverina
State Electorate : Murray
Local Government Area : Balranald

Initial Survey : Noel Arnold & Associates : 18 - Dec - 2007
Reviewed By : Parsons Brinckerhoff : 15 - Feb - 2017

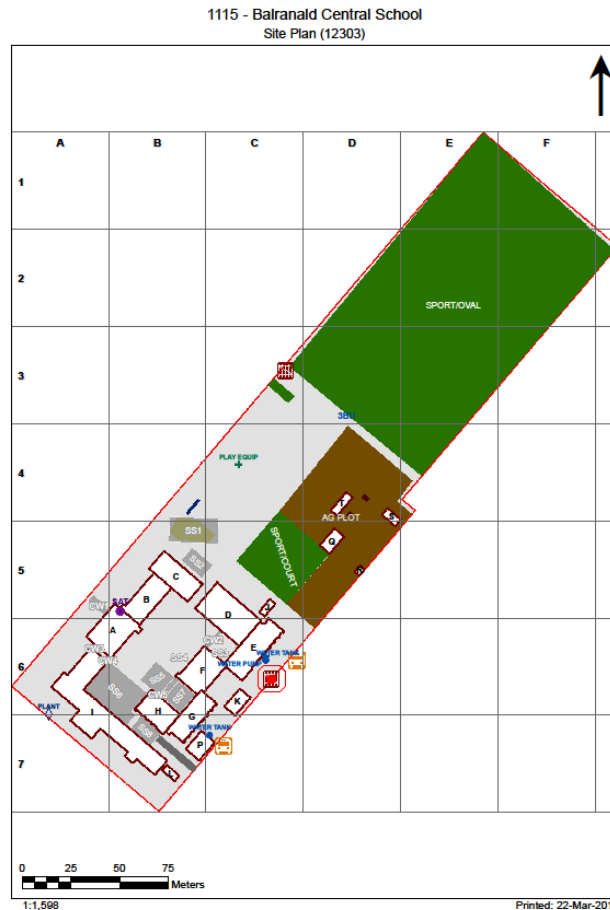

2017

Product	Material Description	Extent	Location Reference	Material Condition	Risk Status	Control Priority
Sample No					Test Result	

B00A - Administration/Library - 1975 - Brick/Block (Brick/Block)**Exterior**

Ceiling Voids - Flat Roof	No Asbestos Found
Underfloor Voids - Packing to Floor Joists	No Asbestos Found

Interior**B00A - R0001 - Movement (43.01 m2)**

No Asbestos

B00A - R0002 - Staff Room (77.9 m2)

Ceiling Structures/Linings	Vermiculite	1115/B00A/R0002/Ceiling Structures/Linings/S1	Limited Samples Taken
<i>Vermiculite Ceilings may contain asbestos. Asbestos testing MUST be conducted prior to any disturbance works</i>			

B00A - R0003 - Entry Vestibule (15.54 m2)

Ceiling Structures/Linings	Vermiculite	1115/B00A/R0002/Ceiling Structures/Linings/S1	Limited Samples Taken
<i>Vermiculite Ceilings may contain asbestos. Asbestos testing MUST be conducted prior to any disturbance works</i>			

B00A - R0004 - Principal (24.46 m2)

No Asbestos

B00A - R0005 - Clerical Office/Workroom (24.42 m2)

Ceiling Structures/Linings	Vermiculite	1115/B00A/R0002/Ceiling Structures/Linings/S1	Limited Samples Taken
<i>Vermiculite Ceilings may contain asbestos. Asbestos testing MUST be conducted prior to any disturbance works</i>			

B00A - R0006 - Staff Room Annexe (13.42 m2)

Ceiling Structures/Linings	Vermiculite	1115/B00A/R0002/Ceiling Structures/Linings/S1	Limited Samples Taken
<i>Vermiculite Ceilings may contain asbestos. Asbestos testing MUST be conducted prior to any disturbance works</i>			

B00A - R0007 - Community Clinic (6.85 m2)

Ceiling Structures/Linings	Vermiculite	1115/B00A/R0002/Ceiling Structures/Linings/S1	Limited Samples Taken
<i>Vermiculite Ceilings may contain asbestos. Asbestos testing MUST be conducted prior to any disturbance works</i>			

B00A - R0008 - Cleaning Distributed Store (2.43 m2)

No Asbestos

B00A - R0009 - Duplicating Workroom (7.38 m2)

No Asbestos

B00A - R0010 - Distribution Board (7.89 m2)

Note: No inspection of live electrical installation.

No Asbestos

B00A - R0011 - Plant (12.48 m2)

No Asbestos

B00A - R0014 - General Storeroom (14.5 m2)

No Asbestos

B00A - R0015 - Movement (40.8 m2)

No Asbestos

B00A - R0016 - Movement (14.99 m2)

Ceiling Structures/Linings	Vermiculite	1115/B00A/R0002/Ceiling Structures/Linings/S1	Limited Samples Taken
<i>Vermiculite Ceilings may contain asbestos. Asbestos testing MUST be conducted prior to any disturbance works</i>			

B00A - R0017 - Movement (25.22 m2)

No Asbestos

B00A - R0018 - Lift (2.24 m2)

No Asbestos

B00A - R0019 - Stairs (7.64 m2)

Product	Material Description	Extent	Location Reference	Material Condition	Risk Status	Control Priority
Sample No					Test Result	
No Asbestos						
B00A - R0020 - Toilet - Lobby (1.68 m2)						
No Asbestos						
B00A - R0021 - Staff - Toilet (1.38 m2)						
No Asbestos						
B00A - R0022 - Staff - Toilet (1.39 m2)						
No Asbestos						
B00A - R0023 - Toilet - Lobby (1.69 m2)						
No Asbestos						
B00A - R1003 - Seminar/Study (26.53 m2)						
No Asbestos						
B00A - R1004 - Library Office/Workroom (26.82 m2)						
No Asbestos						
B00A - R1005 - Communications Room (14.81 m2)						
No Asbestos						
B00A - R1006 - Library Office/Workroom (10.86 m2)						
No Asbestos						
B00A - R1007 - Security Store (12.48 m2)						
No Asbestos						
B00A - R1008 - Cleaning Distributed Store (1.72 m2)						
No Asbestos						
B00A - R1009 - Distribution Board (1.73 m2)						
					Note: No inspection of live electrical installation.	
No Asbestos						
B00A - R1010 - Movement (10.36 m2)						
No Asbestos						
B00A - R1011 - Staff Toilet (3.26 m2)						
Incinerator	Encapsulated Insulation material within unit	1Unit(s)	South facing, West facing	Good Condition (1)	Low (1)	Low Priority (2-3)
Assumed Asbestos - Not sampled due to no access to						
B00A - R1012 - Staff Toilet (3.22 m2)						
No Asbestos						
B00A - R1013 - Movement (24.07 m2)						
No Asbestos						
B00A - R1014 - Stairs (5.6 m2)						
No Asbestos						
B00A - R1015 - Lift (2.24 m2)						
No Asbestos						
B00A - R1016 - Reading Area (189.25 m2)						
No Asbestos						
B00A - R1017 - Library Office/Workroom (12.71 m2)						
No Asbestos						
B00A - R1018 - Librarian (12.38 m2)						
No Asbestos						

Product	Material Description	Extent	Location Reference	Material Condition	Risk Status	Control Priority
	Sample No					Test Result

B00B - General Learning - 1975 - Brick/Block (Brick/Block)**Exterior**

Underfloor Voids - Packing to Floor Joists
No Asbestos Found

Ceiling Voids - Raked Ceiling
No Asbestos Found

Interior**B00B - R0003 - Home Base (44.54 m2)**

Ceiling Structures/Linings Vermiculite
1115/B00A/R0002/Ceiling Structures/Linings/S1
Limited Samples Taken
Vermiculite Ceilings may contain asbestos. Asbestos testing MUST be conducted prior to any disturbance works

B00B - R0004 - Toilets - Boys (11.33 m2)

No Asbestos

B00B - R0005 - Toilets - Girls (12.35 m2)

No Asbestos

B00B - R0006 - No Access (2.36 m2)

No Asbestos

B00B - R0012 - Practical Activities - 1hb (26.05 m2)

Ceiling Structures/Linings Vermiculite
1115/B00A/R0002/Ceiling Structures/Linings/S1
Limited Samples Taken
Vermiculite Ceilings may contain asbestos. Asbestos testing MUST be conducted prior to any disturbance works

B00B - R0013 - General Storeroom (20.96 m2)

No Asbestos

B00B - R0014 - External Movement (57.99 m2)

No Asbestos

B00B - R0016 - Art Learning Space (65.5 m2)

No Asbestos

B00B - R0017 - General Storeroom (5.18 m2)

No Asbestos

B00B - R0018 - Kiln Room (6.86 m2)

No Asbestos

B00B - R0019 - External Movement (16.49 m2)

No Asbestos

B00B - R1001 - Movement (61.76 m2)

No Asbestos

B00B - R1002 - Staff Room Annexe (21.12 m2)

No Asbestos

B00B - R1003 - General Learning Space (70.72 m2)

Ceiling Structures/Linings Vermiculite
1115/B00A/R0002/Ceiling Structures/Linings/S1
Limited Samples Taken
Vermiculite Ceilings may contain asbestos. Asbestos testing MUST be conducted prior to any disturbance works

B00B - R1004 - General Learning Space (70.49 m2)

Ceiling Structures/Linings Vermiculite
1115/B00A/R0002/Ceiling Structures/Linings/S1
Limited Samples Taken
Vermiculite Ceilings may contain asbestos. Asbestos testing MUST be conducted prior to any disturbance works

B00B - R1005 - Plant (26.72 m2)

Ceiling Structures/Linings Vermiculite
1115/B00A/R0002/Ceiling Structures/Linings/S1
Limited Samples Taken
Vermiculite Ceilings may contain asbestos. Asbestos testing MUST be conducted prior to any disturbance works

Product	Material Description	Extent	Location Reference	Material Condition	Risk Status	Control Priority
Sample No					Test Result	

B00C - General Learning - 1975 - Brick/Block (Brick/Block)

Exterior

Underfloor Voids - Packing to Floor Joists No Asbestos Found

Ceiling Voids - Flat Roof No Asbestos Found

Interior

B00C - R0001 - Movement (60.55 m2)

No Asbestos

B00C - R0002 - Toilets - Boys/Girls (2.81 m2)

No Asbestos

B00C - R0003 - Plant (19.19 m2)

No Asbestos

B00C - R0006 - Distribution Board (1.51 m2)

Note: No inspection of live electrical installation.

No Asbestos

B00C - R0010 - Movement (19.24 m2)

No Asbestos

B00C - R0011 - Stairs (1.2 m2)

No Asbestos

B00C - R0016 - Home Base (73.28 m2)

No Asbestos

B00C - R0017 - Practical Activities (20.6 m2)

No Asbestos

B00C - R0018 - Home Base Store (5.22 m2)

No Asbestos

B00C - R0019 - Home Base (45.32 m2)

No Asbestos

B00C - R0020 - Practical Activities (20.32 m2)

No Asbestos

B00C - R0021 - Home Base Store (5.13 m2)

No Asbestos

B00C - R1001 - Movement (83.34 m2)

No Asbestos

B00C - R1002 - Security Store (11.24 m2)

Trolley Flat AC Sheeting 1Unit(s) South facing Good Condition (1) Low (1) Low Priority (2-3)

Assumed Asbestos - Not able to find trolley

B00C - R1003 - General Storeroom (2.02 m2)

No Asbestos

B00C - R1004 - Deputy Principal (12.04 m2)

Ceiling Structures/Linings Vermiculite
1115/B00A/R0002/Ceiling Structures/Linings/S1

Limited Samples Taken

Vermiculite Ceilings may contain asbestos. Asbestos testing MUST be conducted prior to any disturbance works

B00C - R1007 - Distribution Board (0.9 m2)

Note: No inspection of live electrical installation.

No Asbestos

B00C - R1010 - Stairs (6.45 m2)

No Asbestos

B00C - R1011 - Practical Activities (21.16 m2)

No Asbestos

B00C - R1012 - Home Base Store (5.15 m2)

Product	Material Description	Extent	Location Reference	Material Condition	Risk Status	Control Priority
	Sample No					Test Result

No Asbestos

B00C - R1013 - Home Base (45.42 m2)

No Asbestos

B00C - R1014 - Home Base (45.16 m2)

No Asbestos

B00C - R1015 - Practical Activities (20.19 m2)

No Asbestos

B00C - R1016 - Home Base Store (5.15 m2)

No Asbestos

2017

Product	Material Description	Extent	Location Reference	Material Condition	Risk Status	Control Priority
Sample No					Test Result	

B00D - Physical Education - 1985 - Brick/Block (Brick/Block)

Exterior

Ceiling Voids - Raked Ceiling No Asbestos Found

Underfloor Voids - Slab on Ground No Asbestos Found

Interior

B00D - R0001 - Movement (70.72 m2)

No Asbestos

B00D - R0003 - Plant (1.12 m2)

Ceiling Structures/Linings	Flat AC Sheeting	1.2m2	All surfaces	Good Condition (1)	Low (1)	Low Priority (2-3)
1115/B00D/R0002/Ceiling Structures/Linings/S2					Chrysotile (white asbestos)	

B00D - R0005 - Multi-Purpose Space (247.26 m2)

No Asbestos

B00D - R0006 - Hall Chair Store (9.51 m2)

No Asbestos

B00D - R0007 - General Storeroom (0.44 m2)

No Asbestos

B00D - R0008 - Sports Store (10.44 m2)

No Asbestos

B00D - R0010 - Cleaning Supplies (5.81 m2)

No Asbestos

B00D - R0011 - Cleaning Distributed Store (4.48 m2)

No Asbestos

B00D - R0012 - Staff Kitchen (9.34 m2)

No Asbestos

B00D - R0013 - Movement (18.33 m2)

No Asbestos

B00D - R0016 - Toilet - Lobby (3.31 m2)

Wall Linings Internal No Asbestos Found

B00D - R0017 - Student Shower (18.27 m2)

No Asbestos

B00D - R0018 - Student Shower (16.67 m2)

No Asbestos

B00D - R0019 - Toilet - Lobby (3.29 m2)

No Asbestos

B00D - R0020 - Stage (49.15 m2)

No Asbestos

B00D - R0021 - Lift (2.63 m2)

No Asbestos



Product	Material Description	Extent	Location Reference	Material Condition	Risk Status	Control Priority
Sample No					Test Result	

B00E - Science - 1970 - Brick/Block (Brick/Block)

Exterior

Underfloor Voids - Packing to Floor Joists No Asbestos Found

Ceiling Voids - Raked Ceiling No Asbestos Found

Interior

B00E - R0001 - Laboratory L.S. (98.01 m2)

Ceiling Structures/Linings Vermiculite
 1115/B00A/R0002/Ceiling Structures/Linings/S1 **Limited Samples Taken**
Vermiculite Ceilings may contain asbestos. Asbestos testing MUST be conducted prior to any disturbance works

B00E - R0002 - Preparation (47.97 m2)

Ceiling Structures/Linings Vermiculite
 1115/B00A/R0002/Ceiling Structures/Linings/S1 **Limited Samples Taken**
Vermiculite Ceilings may contain asbestos. Asbestos testing MUST be conducted prior to any disturbance works

B00E - R0003 - Laboratory L.S. (96.3 m2)

Ceiling Structures/Linings Vermiculite
 1115/B00A/R0002/Ceiling Structures/Linings/S1 **Limited Samples Taken**
Vermiculite Ceilings may contain asbestos. Asbestos testing MUST be conducted prior to any disturbance works

B00E - R0004 - No Access (8.47 m2)

Ceiling Structures/Linings	Flat AC Sheeting	10m2	All surfaces	Good Condition (1)	Low (1)	Low Priority (2-3)
						Chrysotile (white asbestos)
						1115/B00D/R0002/Ceiling Structures/Linings/S2

B00E - R0005 - Plant (13.07 m2)

Ceiling Structures/Linings	Flat AC Sheeting	13m2	All surfaces	Good Condition (1)	Low (1)	Low Priority (2-3)
						Chrysotile (white asbestos)
						1115/B00D/R0002/Ceiling Structures/Linings/S2

B00E - R0006 - Chemical Store (27.7 m2)

No Asbestos

B00E - R0007 - Movement (29.26 m2)

No Asbestos

B00E - R0008 - Distribution Board (0.82 m2)

Note: No inspection of live electrical installation.

Ceiling Structures/Linings	Flat AC Sheeting	1m2	All surfaces	Good Condition (1)	Low (1)	Low Priority (2-3)
						Chrysotile (white asbestos)
						1115/B00D/R0002/Ceiling Structures/Linings/S2

B00E - R0009 - Distribution Board (1.33 m2)

Note: No inspection of live electrical installation.

Ceiling Structures/Linings	Flat AC Sheeting	1m2	All surfaces	Good Condition (1)	Low (1)	Low Priority (2-3)
						Chrysotile (white asbestos)
						1115/B00D/R0002/Ceiling Structures/Linings/S2

B00E - R0010 - Movement (33.27 m2)

No Asbestos

B00E - R0011 - Movement (1.78 m2)

No Asbestos

B00E - R0012 - Movement (1.78 m2)

Ceiling Structures/Linings	Flat AC Sheeting	2m2	All surfaces	Good Condition (1)	Low (1)	Low Priority (2-3)
						Chrysotile (white asbestos)
						1115/B00D/R0002/Ceiling Structures/Linings/S2

Product	Material Description	Extent	Location Reference	Material Condition	Risk Status	Control Priority
Sample No					Test Result	
B00F - Pupil Facilities - 1970 - Brick/Block (Brick/Block)						
Exterior						
Ceiling Voids - Flat Roof	No Asbestos Found					
Underfloor Voids - Packing to Floor Joists	No Asbestos Found					
Interior						
B00F - R0001 - Movement (93.85 m2)						
Ceiling Structures/Linings	Flat AC Sheeting	20m2	South facing	Good Condition (1)	Low (1)	Low Priority (2-3)
	1115/B00F/R0008/Ceiling Structures/Linings/S7					Chrysotile (white asbestos)
B00F - R0002 - Toilets - Boys (34.66 m2)						
Ceiling Structures/Linings	Flat AC Sheeting	35m2	All surfaces	Good Condition (1)	Low (1)	Low Priority (2-3)
	1115/B00F/R0008/Ceiling Structures/Linings/S7					Chrysotile (white asbestos)
B00F - R0003 - Toilets - Boys (23.98 m2)						
Ceiling Structures/Linings	Flat AC Sheeting	25m2	All surfaces	Good Condition (1)	Low (1)	Low Priority (2-3)
	1115/B00F/R0008/Ceiling Structures/Linings/S7					Chrysotile (white asbestos)
B00F - R0004 - Movement (46.96 m2)						
No Asbestos						
B00F - R0005 - Staff Toilet (6.58 m2)						
Ceiling Structures/Linings	Flat AC Sheeting	7m2	All surfaces	Good Condition (1)	Low (1)	Low Priority (2-3)
	1115/B00F/R0008/Ceiling Structures/Linings/S7					Chrysotile (white asbestos)
Incinerator	Encapsulated Insulation material within unit	1Unit(s)	South facing, West facing	Good Condition (1)	Low (1)	Low Priority (2-3)
	Assumed Asbestos - Not sampled due to no access to					
B00F - R0006 - Cleaning Distributed Store (3.89 m2)						
Ceiling Structures/Linings	Flat AC Sheeting	4m2	All surfaces	Good Condition (1)	Low (1)	Low Priority (2-3)
	1115/B00F/R0008/Ceiling Structures/Linings/S7					Chrysotile (white asbestos)
B00F - R0007 - Staff Toilet (6.53 m2)						
Ceiling Structures/Linings	Flat AC Sheeting	7m2	All surfaces	Good Condition (1)	Low (1)	Low Priority (2-3)
	1115/B00F/R0008/Ceiling Structures/Linings/S7					Chrysotile (white asbestos)
B00F - R0008 - Toilets - Girls (24.01 m2)						
Ceiling Structures/Linings	Flat AC Sheeting	24m2	All surfaces	Good Condition (1)	Low (1)	Low Priority (2-3)
	1115/B00F/R0008/Ceiling Structures/Linings/S7					Chrysotile (white asbestos)
Incinerator	Encapsulated Insulation material within unit	1Unit(s)	South facing, West facing	Good Condition (1)	Low (1)	Low Priority (2-3)
	Assumed Asbestos - Not sampled due to no access to					
B00F - R0009 - Toilets - Girls (34.77 m2)						
Ceiling Structures/Linings	Flat AC Sheeting	35m2	All surfaces	Good Condition (1)	Low (1)	Low Priority (2-3)
	1115/B00F/R0008/Ceiling Structures/Linings/S7					Chrysotile (white asbestos)
B00F - R0010 - Cleaning Distributed Store (6.86 m2)						
Ceiling Structures/Linings	Flat AC Sheeting	7m2	All surfaces	Good Condition (1)	Low (1)	Low Priority (2-3)
	1115/B00F/R0008/Ceiling Structures/Linings/S7					Chrysotile (white asbestos)
B00F - R0011 - No Access (5.93 m2)						
Ceiling Structures/Linings	Flat AC Sheeting	8m2	All surfaces	Good Condition (1)	Low (1)	Low Priority (2-3)
	1115/B00F/R0008/Ceiling Structures/Linings/S7					Chrysotile (white asbestos)

Product	Material Description	Extent	Location Reference	Material Condition	Risk Status	Control Priority
Sample No					Test Result	
B00G - General Learning - 1970 - Brick/Block (Brick/Block)						
Exterior						
Underfloor Voids - Packing to Floor Joists	No Asbestos Found					
Ceiling Voids - Flat Roof	No Asbestos Found					
Interior						
B00G - R0002 - Special Learning Space (26.39 m2)						
Ceiling Structures/Linings	Vermiculite					Limited Samples Taken
	1115/B00A/R0002/Ceiling Structures/Linings/S1					
<i>Vermiculite Ceilings may contain asbestos. Asbestos testing MUST be conducted prior to any disturbance works</i>						
B00G - R0003 - Cleaning Distributed Store (0.93 m2)						
Ceiling Structures/Linings	Vermiculite					Limited Samples Taken
	1115/B00A/R0002/Ceiling Structures/Linings/S1					
<i>Vermiculite Ceilings may contain asbestos. Asbestos testing MUST be conducted prior to any disturbance works</i>						
B00G - R0004 - Withdrawal Space - 1hb (9.42 m2)						
Ceiling Structures/Linings	Vermiculite					Limited Samples Taken
	1115/B00A/R0002/Ceiling Structures/Linings/S1					
<i>Vermiculite Ceilings may contain asbestos. Asbestos testing MUST be conducted prior to any disturbance works</i>						
B00G - R0005 - General Learning Space (52.85 m2)						
Ceiling Structures/Linings	Vermiculite					Limited Samples Taken
	1115/B00A/R0002/Ceiling Structures/Linings/S1					
<i>Vermiculite Ceilings may contain asbestos. Asbestos testing MUST be conducted prior to any disturbance works</i>						
B00G - R0006 - General Learning Space (25.84 m2)						
Ceiling Structures/Linings	Vermiculite					Limited Samples Taken
	1115/B00A/R0002/Ceiling Structures/Linings/S1					
<i>Vermiculite Ceilings may contain asbestos. Asbestos testing MUST be conducted prior to any disturbance works</i>						
B00G - R0007 - Seminar/Study (26.79 m2)						
Ceiling Structures/Linings	Vermiculite					Limited Samples Taken
	1115/B00A/R0002/Ceiling Structures/Linings/S1					
<i>Vermiculite Ceilings may contain asbestos. Asbestos testing MUST be conducted prior to any disturbance works</i>						
B00G - R0008 - Movement (69.66 m2)						
Ceiling Structures/Linings	Vermiculite					Limited Samples Taken
	1115/B00A/R0002/Ceiling Structures/Linings/S1					
<i>Vermiculite Ceilings may contain asbestos. Asbestos testing MUST be conducted prior to any disturbance works</i>						
B00G - R0009 - General Storeroom (2.27 m2)						
Ceiling Structures/Linings	Vermiculite					Limited Samples Taken
	1115/B00A/R0002/Ceiling Structures/Linings/S1					
<i>Vermiculite Ceilings may contain asbestos. Asbestos testing MUST be conducted prior to any disturbance works</i>						
B00G - R0010 - Stairs (4.82 m2)						
No Asbestos						
B00G - R0011 - Other (15.11 m2)						
No Asbestos						
B00G - R0012 - Other (11.2 m2)						
No Asbestos						
B00G - R1001 - General Learning Space (54.03 m2)						
Ceiling Structures/Linings	Vermiculite					Limited Samples Taken
	1115/B00A/R0002/Ceiling Structures/Linings/S1					
<i>Vermiculite Ceilings may contain asbestos. Asbestos testing MUST be conducted prior to any disturbance works</i>						
B00G - R1002 - General Storeroom (7.12 m2)						
Ceiling Structures/Linings	Vermiculite					Limited Samples Taken
	1115/B00A/R0002/Ceiling Structures/Linings/S1					
<i>Vermiculite Ceilings may contain asbestos. Asbestos testing MUST be conducted prior to any disturbance works</i>						
B00G - R1003 - Distribution Board (1.44 m2)						
						Note: No inspection of live electrical installation.

Product	Material Description	Extent	Location Reference	Material Condition	Risk Status	Control Priority
Sample No					Test Result	

No Asbestos

B00G - R1004 - Cleaning Distributed Store (1.49 m2)

No Asbestos

B00G - R1005 - General Learning Space (52.93 m2)

Ceiling Structures/Linings Vermiculite

1115/B00A/R0002/Ceiling Structures/Linings/S1

Limited Samples Taken

Vermiculite Ceilings may contain asbestos. Asbestos testing MUST be conducted prior to any disturbance works

B00G - R1006 - General Learning Space (52.79 m2)

Ceiling Structures/Linings Vermiculite

1115/B00A/R0002/Ceiling Structures/Linings/S1

Limited Samples Taken

Vermiculite Ceilings may contain asbestos. Asbestos testing MUST be conducted prior to any disturbance works

B00G - R1008 - Stairs (4.13 m2)

No Asbestos

B00G - R1009 - Movement (62.38 m2)

No Asbestos

B00G - R1010 - Movement (9.29 m2)

No Asbestos

2017

Product	Material Description	Extent	Location Reference	Material Condition	Risk Status	Control Priority
Sample No					Test Result	

B00H - Pupil Facilities - 1970 - Brick/Block (Brick/Block)

Exterior

Ceiling Voids - Raked Ceiling No Asbestos Found

Underfloor Voids - Packing to Floor Joists No Asbestos Found

Interior

B00H - R0001 - Staff Toilet (3.98 m2)

No Asbestos

B00H - R0002 - Canteen (46.71 m2)

No Asbestos

B00H - R0003 - General Storeroom (4.13 m2)

Floor Coverings Res/Textile Vinyl Tiles 4m2 All surfaces Good Condition (1) Low (1) Low Priority (2-3)

1115/B00H/R0003/Floor Coverings Res/Textile/S5

Chrysotile (white asbestos)

B00H - R0004 - Movement (87.76 m2)

Wall Linings Internal Flat AC Sheeting
1115/B00H/R0004/Wall Linings Internal/S4

No Asbestos Detected

B00H - R0005 - Sports Store (34.74 m2)

No Asbestos

B00H - R0006 - Movement (43.49 m2)

No Asbestos

B00H - R0007 - Movement (1.66 m2)

No Asbestos

2017

Product	Material Description	Extent	Location Reference	Material Condition	Risk Status	Control Priority
Sample No					Test Result	

B00I - Technological & Applied Studies/General Learning - 1973 - Brick/Block (Brick/Block)

Exterior

Underfloor Voids - Slab on Ground No Asbestos Found

Ceiling Voids - Raked Ceiling No Asbestos Found

Interior

B00I - R0001 - Movement (183.38 m2)

Ceiling Structures/Linings No Asbestos Found

Wall Linings Internal No Asbestos Found

B00I - R0004 - Staff Room Annexe (25.77 m2)

No Asbestos

B00I - R0005 - General Storeroom (6.1 m2)

No Asbestos

B00I - R0006 - Toilets-Disabled (12.63 m2)

No Asbestos

B00I - R0007 - Distance Education Centre (52.71 m2)

No Asbestos

B00I - R0013 - Distribution Board (0.53 m2)

Note: No inspection of live electrical installation.

No Asbestos

B00I - R0016 - General Storeroom (7.9 m2)

No Asbestos

B00I - R0017 - Staff Room (11.75 m2)

No Asbestos

B00I - R0018 - Staff Room Annexe (14.68 m2)

No Asbestos

B00I - R0019 - Distribution Board (4.47 m2)

Note: No inspection of live electrical installation.

No Asbestos

B00I - R0024 - Materials Store (101.78 m2)

New Interior

Wall Linings Internal Flat AC Sheeting
1115/B00I/R0024/Wall Linings Internal/S6

No Asbestos Detected

B00I - R0025 - General Assistant/Bulk Store (26.28 m2)

No Asbestos

B00I - R0026 - General Storeroom (2.97 m2)

No Asbestos

B00I - R0027 - Staff - Toilet (3.03 m2)

No Asbestos

B00I - R0028 - Deputy Principal - Type 1 (25.77 m2)

No Asbestos

B00I - R0029 - Materials Store (14.35 m2)

No Asbestos

B00I - R0030 - Workshop Area (112.22 m2)

No Asbestos

B00I - R0031 - Seminar (58.62 m2)

No Asbestos

B00I - R0032 - Design/Technology L.S. (44.55 m2)

No Asbestos

B00I - R0033 - Interview (6.81 m2)

Product	Material Description	Extent	Location Reference	Material Condition	Risk Status	Control Priority
	Sample No					Test Result

No Asbestos

B001 - R0034 - Movement (28.28 m2)

No Asbestos

B001 - R0035 - General Storeroom (7.75 m2)

No Asbestos

B001 - R0036 - General Storeroom (7.01 m2)

No Asbestos

B001 - R0037 - Seminar (32.18 m2)

No Asbestos

B001 - R0038 - Food Technology L.S. (79.35 m2)

No Asbestos

B001 - R0039 - Preparation (18.39 m2)

No Asbestos

B001 - R0040 - Pantry (3.92 m2)

No Asbestos

B001 - R0041 - Laundry (2.85 m2)

No Asbestos

B001 - R0042 - Plant (5.97 m2)

No Asbestos

B001 - R0043 - Dust Extraction Space (8.19 m2)

No Asbestos

2017

Product	Material Description	Extent	Location Reference	Material Condition	Risk Status	Control Priority
Sample No					Test Result	

B00J - Administration - 2006 - Metal Shed (Metal Shed)

Exterior

Underfloor Voids - Slab on Ground No Asbestos Found

Ceiling Voids No Asbestos Found

Ceiling Voids - Flat Roof No Asbestos Found

Interior

B00J - R0001 - General Storeroom (30.24 m2)

No Asbestos

2017

Product	Material Description	Extent	Location Reference	Material Condition	Risk Status	Control Priority
Sample No					Test Result	

B00K - General Learning - 2009 - Steel (Steel)

Exterior

Underfloor Voids - Slab on Ground No Asbestos Found

Ceiling Voids No Asbestos Found

Ceiling Voids - Flat Roof No Asbestos Found

Interior

B00K - R0001 - Aboriginal Resource Centre (42.41 m2)

No Asbestos

B00K - R0002 - Aboriginal Resource Centre (42.84 m2)

No Asbestos

2017

Product	Material Description	Extent	Location Reference	Material Condition	Risk Status	Control Priority
Sample No					Test Result	

B00L - Administration - 2008 - Metal Shed (Metal Shed)

Exterior

Underfloor Voids - Slab on Ground No Asbestos Found

Ceiling Voids No Asbestos Found

Ceiling Voids - Flat Roof No Asbestos Found

Interior

B00L - R0001 - General Storeroom (29.13 m2)

No Asbestos

2017

Product	Material Description	Extent	Location Reference	Material Condition	Risk Status	Control Priority
Sample No					Test Result	

B00P - Shed - 1982 - Steel (Steel)

Exterior

Ceiling Voids - Raked Ceiling No Asbestos Found

Underfloor Voids - Slab on Ground No Asbestos Found

Interior

B00P - R0001 - Garden Store (107.41 m2)

No Asbestos

2017

Product	Material Description	Extent	Location Reference	Material Condition	Risk Status	Control Priority
Sample No					Test Result	

B00Q - Shed Workshop - 2016 - Steel (Steel)

Exterior

Ceiling Void	No Asbestos Found
Underfloor Void	No Asbestos Found

Interior

B00Q - R0001 - Shed Workshop (17.36 m2)

No Asbestos

B00Q - R0002 - Shed Workshop (28.62 m2)

No Asbestos

B00Q - R0003 - Shed Workshop (24.23 m2)

No Asbestos

2017

Product	Material Description	Extent	Location Reference	Material Condition	Risk Status	Control Priority
Sample No					Test Result	

B00R - Storage - 2016 - Timber Shed (Timber Shed)

Exterior

Ceiling Void	No Asbestos Found
Underfloor Void	No Asbestos Found

Interior

B00R - R0001 - General Storeroom (11.46 m2)

No Asbestos

2017

Product	Material Description	Extent	Location Reference	Material Condition	Risk Status	Control Priority
Sample No					Test Result	

B00S - Storage - 2016 - Steel (Steel)

Exterior

Ceiling Void	No Asbestos Found
Underfloor Void	No Asbestos Found

Interior

B00S - R0001 - Machine Storage (37.53 m2)

No Asbestos

2017

Product	Material Description	Extent	Location Reference	Material Condition	Risk Status	Control Priority
Sample No					Test Result	

B00T - Other - 2016 - Greenhouse (Greenhouse)

Exterior

Ceiling Void	No Asbestos Found
Underfloor Void	No Asbestos Found

Interior

B00T - R0001 - Growing/Breeding (52.33 m2)

No Asbestos

2017

Product	Material Description	Extent	Location Reference	Material Condition	Risk Status	Control Priority
Sample No					Test Result	

Demountables

There are no Demountable(s) located at this school as per the AMS records as of 15 Feb 2017.

2017

Product	Material Description	Extent	Location Reference	Material Condition	Risk Status	Control Priority
Sample No					Test Result	

Listing of Electronic Attachments as of 22/03/2017

There are no asbestos related file attachment(s) for this school.

2017