

Asbestos Register

(Hazardous Materials and Risk Assessment)

School : Austinmer Public School (1076)
Region : Illawarra and South East
State Electorate : Keira
Local Government Area : Wollongong

Initial Survey : Noel Arnold & Associates : 17 - Mar - 2008
Reviewed By : Grencap-NAA : 01 - Mar - 2017

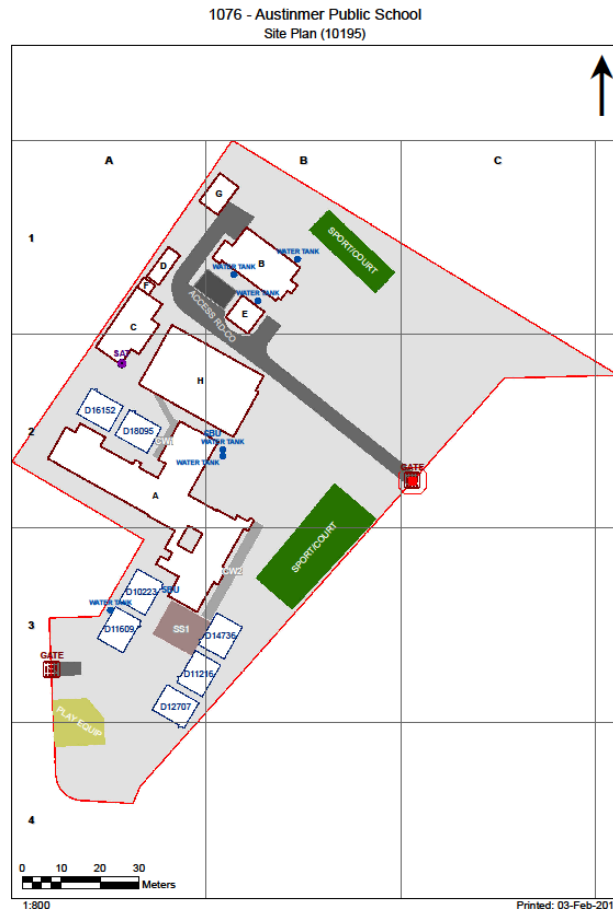

2017

Product	Material Description	Extent	Location Reference	Material Condition	Risk Status	Control Priority
Sample No				Test Result		

B00A - General Learning/Library - 1891 - Brick/Block (Brick/Block)**Exterior**

Ceiling Voids - Flat Roof	No Asbestos Found					
Underfloor Voids - Packing to Floor Joists	No Asbestos Found					
Eaves Linings	Flat AC Sheeting	140m2	North facing, South facing, East facing, West facing	Good Condition (1)	Low (1)	Low Priority (2-3)
	1076/B00C/Eaves Linings/S19					Chrysotile (white asbestos) , Amosite (brown asbestos) , Crocidolite (blue asbestos)

Interior**B00A - R0001 - Home Base**

Wall Linings Internal	Flat AC Sheeting	2m2	West facing, Middle portion	Good Condition (1)	Low (1)	Low Priority (2-3)
	1076/B00A/R0003/Wall Linings Internal/S4					Chrysotile (white asbestos)
Floor Coverings Res/Textile	Vinyl Tiles (Under Floor Covering/Carpet)	42.73m2	Throughout	Good Condition (1)	Low (1)	Low Priority (2-3)
	1076/B00A/R0015/Floor Coverings Res/Textile/S21					Chrysotile (white asbestos)

B00A - R0002 - Toilets - Boys/Girls

No Asbestos

B00A - R0003 - Distribution Board

Note: No inspection of live electrical installation.

Wall Linings Internal	Flat AC Sheeting	2m2	South facing	Good Condition (1)	Low (1)	Low Priority (2-3)
	1076/B00A/R0003/Wall Linings Internal/S4					Chrysotile (white asbestos)

B00A - R0004 - Home Base Store

Panels below windows	Compressed AC Sheet	2Unit(s)	North facing, West facing	Good Condition (1)	Low (1)	Low Priority (2-3)
	1076/B00A/R0006/Panels below windows/S2					Chrysotile (white asbestos)
Ceiling Structures/Linings	Flat AC Sheeting	7m2	All surfaces	Good Condition (1)	Low (1)	Low Priority (2-3)
	1076/B00A/R0006/Ceiling Structures/Linings/S3					Chrysotile (white asbestos)
Floor Coverings Res/Textile	Vinyl Tiles	7m2	All surfaces	Good Condition (1)	Low (1)	Low Priority (2-3)
	1076/B00A/R0023/Floor Coverings Res/Textile/S1					Chrysotile (white asbestos)

B00A - R0005 - Withdrawal Space - 1hb

Panels below windows	Compressed AC Sheet	5Unit(s)	West facing	Good Condition (1)	Low (1)	Low Priority (2-3)
	1076/B00A/R0006/Panels below windows/S2					Chrysotile (white asbestos)
Ceiling Structures/Linings	Flat AC Sheeting	12m2	All surfaces	Good Condition (1)	Low (1)	Low Priority (2-3)
	1076/B00A/R0006/Ceiling Structures/Linings/S3					Chrysotile (white asbestos)
Floor Coverings Res/Textile	Vinyl Tiles (Under Floor Covering/Carpet)	11.07m2	Throughout	Good Condition (1)	Low (1)	Low Priority (2-3)
	1076/B00A/R0015/Floor Coverings Res/Textile/S21					Chrysotile (white asbestos)

B00A - R0006 - Movement

Panels below windows	Compressed AC Sheet	4Unit(s)	West facing	Good Condition (1)	Low (1)	Low Priority (2-3)
	1076/B00A/R0006/Panels below windows/S2					Chrysotile (white asbestos)
Ceiling Structures/Linings	Flat AC Sheeting	29m2	All surfaces	Good Condition (1)	Low (1)	Low Priority (2-3)
	1076/B00A/R0006/Ceiling Structures/Linings/S3					Chrysotile (white asbestos)
Floor Coverings Res/Textile	Vinyl Tiles (Under Floor Covering/Carpet)	28.92m2	Throughout	Good Condition (1)	Low (1)	Low Priority (2-3)
	1076/B00A/R0015/Floor Coverings Res/Textile/S21					Chrysotile (white asbestos)

B00A - R0007 - Movement

Floor Coverings Res/Textile	Vinyl Tiles	5m2	All surfaces	Good Condition (1)	Low (1)	Low Priority (2-3)
	1076/B00A/R0023/Floor Coverings Res/Textile/S1					Chrysotile (white asbestos)

Product	Material Description	Extent	Location Reference	Material Condition	Risk Status	Control Priority
Sample No					Test Result	
Ceiling Structures/Linings	Flat AC Sheeting	5m2	All surfaces	Good Condition (1)	Low (1)	Low Priority (2-3)
1076/B00A/R0006/Ceiling Structures/Linings/S3					Chrysotile (white asbestos)	
B00A - R0008 - Withdrawal Space - 1hb						
Floor Coverings Res/Textile	Vinyl Tiles (Under Floor Covering/Carpet)	42.38m2	Throughout	Good Condition (1)	Low (1)	Low Priority (2-3)
1076/B00A/R0015/Floor Coverings Res/Textile/S21					Chrysotile (white asbestos)	
B00A - R0009 - Movement						
Ceiling Structures/Linings	Flat AC Sheeting	27m2	All surfaces	Good Condition (1)	Low (1)	Low Priority (2-3)
1076/B00A/R0006/Ceiling Structures/Linings/S3					Chrysotile (white asbestos)	
Floor Coverings Res/Textile	Vinyl Tiles (Under Floor Covering/Carpet)	26.07m2	Throughout	Good Condition (1)	Low (1)	Low Priority (2-3)
1076/B00A/R0015/Floor Coverings Res/Textile/S21					Chrysotile (white asbestos)	
B00A - R0010 - Movement						
No Asbestos						
B00A - R0011 - Reading Area						
No Asbestos						
B00A - R0012 - Movement						
No Asbestos						
B00A - R0013 - Library Office/Workroom						
No Asbestos						
B00A - R0014 - General Storeroom						
No Asbestos						
B00A - R0015 - Movement						
Floor Coverings Res/Textile	Vinyl Tiles (Under Floor Covering/Carpet)	8.01m2	Throughout	Good Condition (1)	Low (1)	Low Priority (2-3)
1076/B00A/R0015/Floor Coverings Res/Textile/S21					Chrysotile (white asbestos)	
B00A - R0016 - Movement						
No Asbestos						
B00A - R0017 - General Storeroom						
No Asbestos						
B00A - R0018 - Home Base						
Ceiling Structures/Linings	Flat AC Sheeting	49m2	All surfaces	Good Condition (1)	Low (1)	Low Priority (2-3)
1076/B00A/R0006/Ceiling Structures/Linings/S3					Chrysotile (white asbestos)	
Floor Coverings Res/Textile	Vinyl Tiles (Under Floor Covering/Carpet)	48.27m2	Throughout	Good Condition (1)	Low (1)	Low Priority (2-3)
1076/B00A/R0015/Floor Coverings Res/Textile/S21					Chrysotile (white asbestos)	
B00A - R0019 - Movement						
No Asbestos						
B00A - R0020 - Home Base						
Floor Coverings Res/Textile	Vinyl Tiles (Under Floor Covering/Carpet)	52.m2	Throughout	Good Condition (1)	Low (1)	Low Priority (2-3)
1076/B00A/R0023/Floor Coverings Res/Textile/S1					Chrysotile (white asbestos)	
B00A - R0021 - Personal Effects Storage						
Floor Coverings Res/Textile	Vinyl Tiles	8m2	All surfaces	Good Condition (1)	Low (1)	Low Priority (2-3)
1076/B00A/R0023/Floor Coverings Res/Textile/S1					Chrysotile (white asbestos)	
B00A - R0022 - General Storeroom						
Floor Coverings Res/Textile	Vinyl Tiles	12m2	All surfaces	Good Condition (1)	Low (1)	Low Priority (2-3)
1076/B00A/R0023/Floor Coverings Res/Textile/S1					Chrysotile (white asbestos)	
B00A - R0023 - Personal Effects Storage						

Product	Material Description	Extent	Location Reference	Material Condition	Risk Status	Control Priority
Sample No					Test Result	
Floor Coverings Res/Textile	Vinyl Tiles	10m2	All surfaces	Good Condition (1)	Low (1)	Low Priority (2-3)
1076/B00A/R0023/Floor Coverings Res/Textile/S1					Chrysotile (white asbestos)	
B00A - R0024 - Practical Activities - 1hb						
No Asbestos						
B00A - R0025 - Practical Activities - 1hb						
No Asbestos						
B00A - R0026 - Home Base						
Floor Coverings Res/Textile	Vinyl Tiles (Under Floor Covering/Carpet)	50.43m2	Throughout	Good Condition (1)	Low (1)	Low Priority (2-3)
1076/B00A/R0023/Floor Coverings Res/Textile/S1					Chrysotile (white asbestos)	
B00A - R0027 - Home Base						
Floor Coverings Res/Textile	Vinyl Tiles (Under Floor Covering/Carpet)	65.94m2	Throughout	Good Condition (1)	Low (1)	Low Priority (2-3)
1076/B00A/R0023/Floor Coverings Res/Textile/S1					Chrysotile (white asbestos)	
B00A - R0028 - Movement						
No Asbestos						
B00A - R0029 - Personal Effects Storage						
No Asbestos						
B00A - R0030 - Withdrawal Space - 1hb						
No Asbestos						
B00A - R0031 - Practical Activities - 1hb						
No Asbestos						
B00A - R0032 - Home Base Store						
No Asbestos						
B00A - R0033 - Movement						
Ceiling Structures/Linings	Flat AC Sheeting	4m2	All surfaces	Good Condition (1)	Low (1)	Low Priority (2-3)
1076/B00A/R0006/Ceiling Structures/Linings/S3					Chrysotile (white asbestos)	
B00A - R0034 - Movement						
In-fill panels below windows	Compressed AC Sheet	6m2	South facing	Good Condition (1)	Low (1)	Low Priority (2-3)
1076/B00A/R0006/Panels below windows/S2					Chrysotile (white asbestos)	
Ceiling Structures/Linings	Flat AC Sheeting	19m2	All surfaces	Good Condition (1)	Low (1)	Low Priority (2-3)
1076/B00A/R0006/Ceiling Structures/Linings/S3					Chrysotile (white asbestos)	
B00A - R0035 - Stairs						
No Asbestos						
B00A - R9001 - Home Base						
Floor Coverings Res/Textile	Vinyl Tiles (Under Floor Covering/Carpet)	63.37m2	Throughout	Good Condition (1)	Low (1)	Low Priority (2-3)
1076/B00A/R9003/Floor Coverings Res/Textile/S5					Chrysotile (white asbestos)	
B00A - R9002 - Practical Activities - 1hb						
No Asbestos						
B00A - R9003 - Movement						
Floor Coverings Res/Textile	Vinyl Tiles	23m2	All surfaces	Good Condition (1)	Low (1)	Low Priority (2-3)
1076/B00A/R9003/Floor Coverings Res/Textile/S5					Chrysotile (white asbestos)	
B00A - R9004 - Cleaning Distributed Store						
No Asbestos						
B00A - R9005 - Main Switch Board						
Wall Linings Internal	Flat AC Sheeting	4m2	West facing	Good Condition (1)	Low (1)	Low Priority (2-3)
1076/B00A/R0003/Wall Linings Internal/S4					Chrysotile (white asbestos)	

Product	Material Description	Extent	Location Reference	Material Condition	Risk Status	Control Priority
Sample No					Test Result	
Electrical Mounting Board	Resinous Board	1Unit	West facing	Good Condition (1)	Low (1)	Low Priority (2-3)
1076/B00A/R9005/Electrical Mounting Board/S20					Chrysotile (white asbestos)	
B00A - R9006 - Home Base						
Floor Coverings Res/Textile	Vinyl Tiles (Under Floor Covering/Carpet)	57.74m2	Throughout	Good Condition (1)	Low (1)	Low Priority (2-3)
1076/B00A/R9003/Floor Coverings Res/Textile/S5					Chrysotile (white asbestos)	
B00A - R9007 - Home Base Store						
Floor Coverings Res/Textile	Vinyl Tiles	8m2	All surfaces	Good Condition (1)	Low (1)	Low Priority (2-3)
1076/B00A/R9003/Floor Coverings Res/Textile/S5					Chrysotile (white asbestos)	
B00A - R9008 - Garden Store						
No Asbestos						
B00A - R9009 - Sports Store						
No Asbestos						
B00A - R9010 - Movement						
No Asbestos						
B00A - R9011 - Stairs						
No Asbestos						
B00A - R9012 - Movement						
No Asbestos						

2017

Product	Material Description	Extent	Location Reference	Material Condition	Risk Status	Control Priority
Sample No					Test Result	

B00B - Administration/Staff Facilities - 1891 - Brick/Block (Brick/Block)

Exterior

Ceiling Voids - Flat Roof	Non Accessible Area - Area inaccessible					
Underfloor Voids - Packing to Floor Joists	Non Accessible Area - Area inaccessible					
Eaves Linings	Flat AC Sheeting 1076/B00B/Eaves Linings/S16					No Asbestos Detected

Interior

B00B - R0001 - Entry Vestibule

No Asbestos

B00B - R0002 - Movement

Ceiling Structures/Linings	Flat AC Sheeting	6m2	All surfaces	Good Condition (1)	Low (1)	Low Priority (2-3)
	1076/B00B/R0016/Ceiling Structures/Linings/S9					Chrysotile (white asbestos) , Amosite (brown asbestos)

B00B - R0003 - Principal

No Asbestos

B00B - R0004 - Movement

No Asbestos

B00B - R0005 - Clerical Office

No Asbestos

B00B - R0006 - Deputy Principal

Floor Coverings Res/Textile	Vinyl Tiles (Under Floor Covering/Carpet) 1076/B00B/R0006/Floor Coverings Res/Textile/S13					No Asbestos Detected
Floor Coverings Res/Textile	Paper 1076/B00B/R0006/Floor Coverings Res/Textile/S14					No Asbestos Detected

B00B - R0007 - Clerical Office/Workroom

No Asbestos

B00B - R0008 - General Storeroom

Wall Linings Internal	Flat AC Sheeting 1076/B00B/R0009/Wall Linings Internal/S10					No Asbestos Detected
-----------------------	---	--	--	--	--	-----------------------------

B00B - R0009 - Sick Bay

Wall Linings Internal	Flat AC Sheeting 1076/B00B/R0009/Wall Linings Internal/S10					No Asbestos Detected
-----------------------	---	--	--	--	--	-----------------------------

B00B - R0010 - Staff Room

No Asbestos

B00B - R0011 - General Storeroom

No Asbestos

B00B - R0012 - Staff Kitchen

Ceiling Structures/Linings	Flat AC Sheeting	15m2	All surfaces	Good Condition (1)	Low (1)	Low Priority (2-3)
	1076/B00B/R0016/Ceiling Structures/Linings/S9					Chrysotile (white asbestos) , Amosite (brown asbestos)
Sink	Sink pad 1076/B00B/R0012/Sink/S15					No Asbestos Detected

B00B - R0013 - Movement

Wall Linings Internal	Flat AC Sheeting	10m2	All surfaces	Good Condition (1)	Low (1)	Low Priority (2-3)
	1076/B00B/R0016/Wall Linings Internal/S8					Chrysotile (white asbestos)

Product	Material Description	Extent	Location Reference	Material Condition	Risk Status	Control Priority
Sample No				Test Result		
Ceiling Structures/Linings	Flat AC Sheeting	3m2	All surfaces	Good Condition (1)	Low (1)	Low Priority (2-3)
	1076/B00B/R0016/Ceiling Structures/Linings/S9			Chrysotile (white asbestos) , Amosite (brown asbestos)		
B00B - R0014 - General Storeroom						
Wall Linings Internal	Flat AC Sheeting	10m2	All surfaces	Good Condition (1)	Low (1)	Low Priority (2-3)
	1076/B00B/R0016/Wall Linings Internal/S8			Chrysotile (white asbestos)		
Ceiling Structures/Linings	Flat AC Sheeting	4m2	All surfaces	Good Condition (1)	Low (1)	Low Priority (2-3)
	1076/B00B/R0016/Ceiling Structures/Linings/S9			Chrysotile (white asbestos) , Amosite (brown asbestos)		
B00B - R0015 - Staff Toilet						
Wall Linings Internal	Flat AC Sheeting	10m2	All surfaces	Good Condition (1)	Low (1)	Low Priority (2-3)
	1076/B00B/R0016/Wall Linings Internal/S8			Chrysotile (white asbestos)		
Ceiling Structures/Linings	Flat AC Sheeting	2m2	All surfaces	Good Condition (1)	Low (1)	Low Priority (2-3)
	1076/B00B/R0016/Ceiling Structures/Linings/S9			Chrysotile (white asbestos) , Amosite (brown asbestos)		
B00B - R0016 - Cleaning Distributed Store						
Wall Linings Internal	Flat AC Sheeting	10m2	All surfaces	Good Condition (1)	Low (1)	Low Priority (2-3)
	1076/B00B/R0016/Wall Linings Internal/S8			Chrysotile (white asbestos)		
Ceiling Structures/Linings	Flat AC Sheeting	3m2	All surfaces	Good Condition (1)	Low (1)	Low Priority (2-3)
	1076/B00B/R0016/Ceiling Structures/Linings/S9			Chrysotile (white asbestos) , Amosite (brown asbestos)		

2017

Product	Material Description	Extent	Location Reference	Material Condition	Risk Status	Control Priority
Sample No				Test Result		
B00C - Pupil Facilities - 1891 - Brick/Block (Brick/Block)						
Exterior						
Ceiling Voids - Flat Roof	Non Accessible Area - Area inaccessible					
Underfloor Voids - Packing to Floor Joists	Non Accessible Area - Area inaccessible					
Eaves Linings	Flat AC Sheeting	50m2	North facing, South facing, East facing, West facing	Good Condition (1)	Low (1)	Low Priority (2-3)
	1076/B00C/Eaves Linings/S19			Chrysotile (white asbestos) , Amosite (brown asbestos) , Crocidolite (blue asbestos)		
Interior						
B00C - R0001 - Communal Space						
Ceiling Structures/Linings	Flat AC Sheeting	62m2	All surfaces	Good Condition (1)	Low (1)	Low Priority (2-3)
	1076/B00C/R0004/Ceiling Structures/Linings/S6			Chrysotile (white asbestos) , Amosite (brown asbestos)		
B00C - R0002 - Kiln Room						
No Asbestos						
B00C - R0003 - Movement						
No Asbestos						
B00C - R0004 - Toilets - Boys						
Ceiling Structures/Linings	Flat AC Sheeting	36m2	All surfaces	Good Condition (1)	Low (1)	Low Priority (2-3)
	1076/B00C/R0004/Ceiling Structures/Linings/S6			Chrysotile (white asbestos) , Amosite (brown asbestos)		
Partition Walls (Cubicles)	Compressed AC Sheet 1076/B00C/R0004/Partition Walls (Cubicles)/S7					
				No Asbestos Detected		
B00C - R0005 - Staff Toilet						
Ceiling Structures/Linings	Flat AC Sheeting	2m2	All surfaces	Good Condition (1)	Low (1)	Low Priority (2-3)
	1076/B00C/R0004/Ceiling Structures/Linings/S6			Chrysotile (white asbestos) , Amosite (brown asbestos)		
B00C - R0006 - Toilets - Girls						
Ceiling Structures/Linings	Flat AC Sheeting	34m2	All surfaces	Good Condition (1)	Low (1)	Low Priority (2-3)
	1076/B00C/R0004/Ceiling Structures/Linings/S6			Chrysotile (white asbestos) , Amosite (brown asbestos)		
Partition Walls (Cubicles)	Compressed AC Sheet 1076/B00C/R0004/Partition Walls (Cubicles)/S7					
				No Asbestos Detected		
B00C - R0007 - Cleaning Distributed Store						
Ceiling Structures/Linings	Flat AC Sheeting	2m2	All surfaces	Good Condition (1)	Low (1)	Low Priority (2-3)
	1076/B00C/R0004/Ceiling Structures/Linings/S6			Chrysotile (white asbestos) , Amosite (brown asbestos)		
B00C - R0008 - Staff Toilet						
Ceiling Structures/Linings	Flat AC Sheeting	2m2	All surfaces	Good Condition (1)	Low (1)	Low Priority (2-3)
	1076/B00C/R0004/Ceiling Structures/Linings/S6			Chrysotile (white asbestos) , Amosite (brown asbestos)		

Product	Material Description	Extent	Location Reference	Material Condition	Risk Status	Control Priority
Sample No					Test Result	

B00D - General Learning - 1968 - Timber (Timber)

Exterior

Underfloor Voids - Packing to Floor Joists	No Asbestos Found					
Ceiling Voids - Flat Roof	Non Accessible Area - Area inaccessible					
Eaves Linings	Flat AC Sheeting 1076/B00D/Eaves Linings/S18					No Asbestos Detected

Interior

B00D - R0001 - Withdrawal Space - 1hb

No Asbestos

2017

Product	Material Description	Extent	Location Reference	Material Condition	Risk Status	Control Priority
Sample No					Test Result	

B00E - Pupil Facilities - 1958 - Brick/Block (Brick/Block)

Exterior

Ceiling Voids - Flat Roof	Non Accessible Area - Area inaccessible					
Underfloor Voids - Slab on Ground	Non Accessible Area - Area inaccessible					
Eaves Linings	Flat AC Sheeting	40m2	North facing, South facing, East facing, West facing	Good Condition (1)	Low (1)	Low Priority (2-3)
	1076/B00E/Eaves Linings/S17					Chrysotile (white asbestos)

Interior

B00E - R0001 - Canteen

Ceiling Structures/Linings	Flat AC Sheeting	23m2	All surfaces	Good Condition (1)	Low (1)	Low Priority (2-3)
	1076/B00E/R0001/Ceiling Structures/Linings/S11					Chrysotile (white asbestos)

B00E - R0002 - Canteen Office/Store

Ceiling Structures/Linings	Flat AC Sheeting	3m2	All surfaces	Good Condition (1)	Low (1)	Low Priority (2-3)
	1076/B00E/R0001/Ceiling Structures/Linings/S11					Chrysotile (white asbestos)

B00E - R0003 - Canteen Office/Store

Ceiling Structures/Linings	Flat AC Sheeting	4m2	All surfaces	Good Condition (1)	Low (1)	Low Priority (2-3)
	1076/B00E/R0001/Ceiling Structures/Linings/S11					Chrysotile (white asbestos)

B00E - R0004 - Movement

Ceiling Structures/Linings	Flat AC Sheeting	14m2	All surfaces	Good Condition (1)	Low (1)	Low Priority (2-3)
	1076/B00E/R0001/Ceiling Structures/Linings/S11					Chrysotile (white asbestos)

2017

Product	Material Description	Extent	Location Reference	Material Condition	Risk Status	Control Priority
Sample No					Test Result	

B00F - Communal Facilities - 1958 - Brick/Block (Brick/Block)

Exterior

Underfloor Voids - Slab on Ground	Non Accessible Area - Area inaccessible					
Ceiling Voids - Flat Roof	Non Accessible Area - Area inaccessible					
Eaves Linings	Flat AC Sheeting 1076/B00E/Eaves Linings/S17	6m2	East facing, West facing	Good Condition (1)	Low (1)	Low Priority (2-3) Chrysotile (white asbestos)

Interior

B00F - R0001 - Sports Store

Ceiling Structures/Linings	Flat AC Sheeting 1076/B00F/R0001/Ceiling Structures/Linings/S12	10m2	All surfaces	Good Condition (1)	Low (1)	Low Priority (2-3) Chrysotile (white asbestos)
----------------------------	--	------	--------------	--------------------	---------	--

2017

Product	Material Description	Extent	Location Reference	Material Condition	Risk Status	Control Priority
Sample No					Test Result	

B00G - Shed - 2010 - Metal Shed (Metal Shed)

Exterior

Underfloor Voids - Slab on Ground Non Accessible Area
 - Area inaccessible

Ceiling Voids No Asbestos Found

Interior

B00G - R0001 - General Storeroom

No Asbestos

2017

Product	Material Description	Extent	Location Reference	Material Condition	Risk Status	Control Priority
Sample No					Test Result	

B00H - Communal Facilities - 2010 - Brick/Veneer (Brick/Veneer)

Exterior

Underfloor Voids - Slab on Ground	Non Accessible Area - Area inaccessible
Ceiling Voids	No Asbestos Found

Interior

B00H - R0001 - Communal Space

No Asbestos

B00H - R0002 - Raised Platform

No Asbestos

B00H - R0003 - Chair Storeroom

No Asbestos

B00H - R0004 - Communal/Performance Store

No Asbestos

B00H - R0005 - P.E. Store

No Asbestos

B00H - R0006 - Toilet - Lobby

No Asbestos

B00H - R0007 - Toilets - Girls

No Asbestos

B00H - R0008 - Sound Cupboard

No Asbestos

B00H - R0009 - Toilet - Lobby

No Asbestos

B00H - R0010 - Toilets - Boys

No Asbestos

B00H - R0011 - Cleaning Distributed Store

No Asbestos

B00H - R0012 - Other

No Asbestos

B00H - R0013 - Main Switch Board

No Asbestos

B00H - R0014 - Access Shower/Toilet/Change

No Asbestos

B00H - R0015 - Covered Outdoor Learning Area

No Asbestos

B00H - R0016 - Movement

No Asbestos

B00H - R0017 - Movement

No Asbestos

B00H - R0018 - Ramp

No Asbestos



Product	Material Description	Extent	Location Reference	Material Condition	Risk Status	Control Priority
Sample No					Test Result	

Demountables

Demountable details as per the AMS records as of 15 Feb 2017.

OS 603 - D10223 - Learning Unit - Standard With P.A.A. A/C : Placement Date - 14/07/2010

Note: This refurbished demountable may have asbestos present in remnant mastic in window frames.

Exterior

No Asbestos Found.

Interior

R1 - Learning space/withdrawal/entry

No Asbestos Found.

R2 - Home Base Store

No Asbestos Found.

OS 602 - D11216 - Learning Unit - Standard With P.A.A. : Placement Date - 13/07/2010

Exterior

No Asbestos Found.

Interior

R1 - Learning space/withdrawal/entry

No Asbestos Found.

R2 - Home Base Store

No Asbestos Found.

OS 602 - D11609 - Learning Unit - Standard With P.A.A. : Placement Date - 13/07/2010

Exterior

No Asbestos Found.

Interior

R1 - Learning space/withdrawal/entry

No Asbestos Found.

R2 - Home Base Store

No Asbestos Found.

OS 602 - D12707 - Learning Unit - Standard With P.A.A. : Placement Date - 23/02/2010

Exterior

Step Treads	Compressed AC Sheet	Assumed Asbestos	1.08 m2
Landing	Compressed AC Sheet	Assumed Asbestos	1.2 m2
Eave Lining	Flat AC Sheet	Assumed Asbestos	11.52 m2

Interior

R1 - Learning space/withdrawal/entry

Ceiling	Flat AC Sheet	Assumed Asbestos	70 m2
---------	---------------	------------------	-------

R2 - Home Base Store

End wall panel	Flat AC Sheet	Assumed Asbestos	18 m2
Ceiling	Flat AC Sheet	Assumed Asbestos	3 m2

OS 602 - D14736 - Learning Unit - Standard With P.A.A. : Placement Date - 13/07/2010

Exterior

No Asbestos Found.

Product	Material Description	Extent	Location Reference	Material Condition	Risk Status	Control Priority
Sample No					Test Result	
Interior						
R1 - Learning space/withdrawal/entry						
No Asbestos Found.						
R2 - Home Base Store						
No Asbestos Found.						
OS 602 - D16152 - Learning Unit - Standard With P.A.A. : Placement Date - 12/02/2011						
Exterior						
No Asbestos Found.						
Interior						
R1 - Learning space/withdrawal/entry						
No Asbestos Found.						
R2 - Home Base Store						
No Asbestos Found.						
OS 602 - D18095 - Learning Unit - Standard With P.A.A. : Placement Date - 26/03/2011						
Exterior						
No Asbestos Found.						
Interior						
R1 - Learning space/withdrawal/entry						
No Asbestos Found.						
R2 - Home Base Store						
No Asbestos Found.						

2017

Product	Material Description	Extent	Location Reference	Material Condition	Risk Status	Control Priority
Sample No					Test Result	

Listing of Electronic Attachments as of 22/03/2017

Available Asbestos Related Electronic Files

1076_ASB_010313_AMP.pdf

* Note : Refer to AMS for details of the attachment(s).

2017